



FUEL INJECTION PERFORMANCE KIT

FIPK

GENERATION II™

INSTALLATION INSTRUCTIONS

57-1549

JEEP

2005-07 GRAND CHEROKEE

2006-07 COMMANDER

V8-5.7L

NOTE: This kit was not designed to fit vehicles with a body lift.

TOOLS NEEDED:

- 10mm Socket
- 8mm Socket
- 16mm Socket
- 4mm Allen Wrench
- Flat Blade Screwdriver
- Ratchet
- Extension
- 10mm Wrench

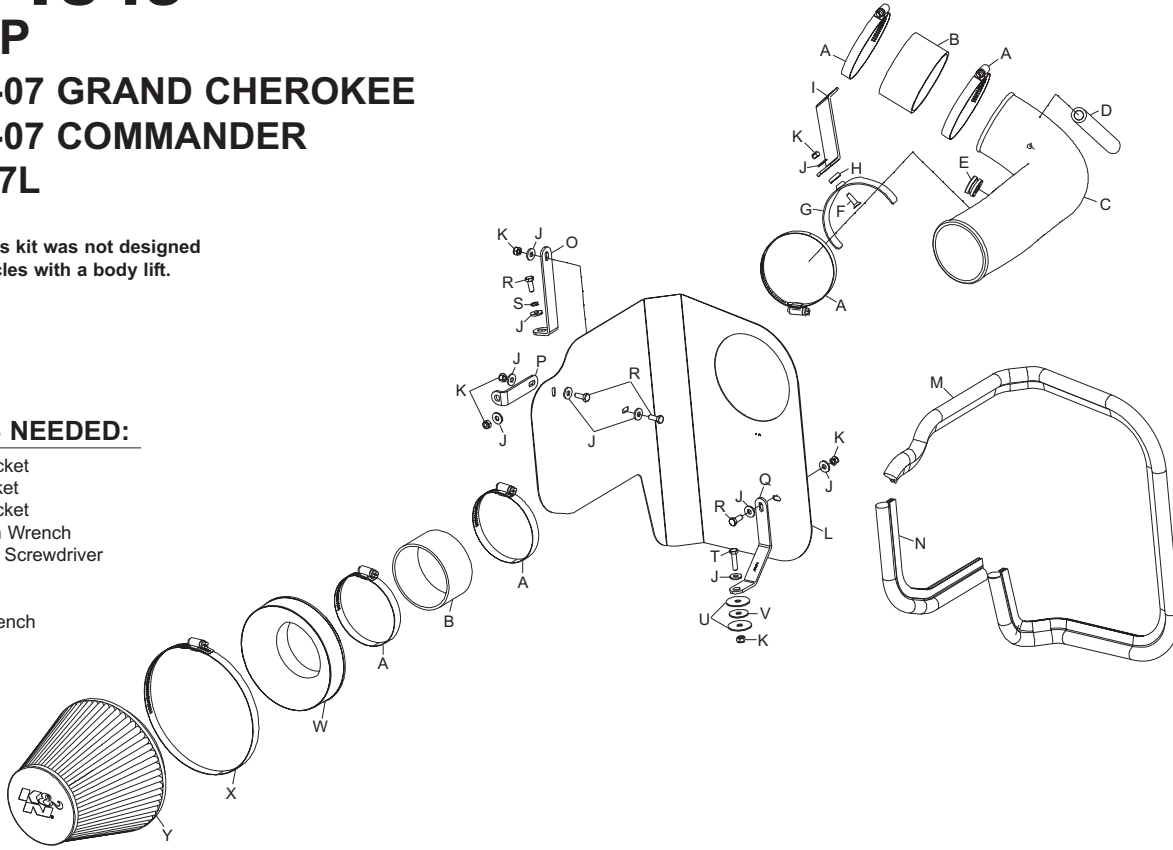

PARTS LIST:

Desc.	Qty.	Part #
A hose clamp; #56	5	08620
B hose; 3.5" id x 2' l, silicone	2	08630
C intake tube (FS)	1	087191
D hose; 1/2" id x 19" l, silicone	1	084075
E grommet	1	08064
F bolt; 6mm-1.00 X 16mm, f/h/a	1	08376
G saddle clamp	1	078855
H cup washer; black nylon	1	08180
I bracket; "Z"	1	26625
J washer; 1/4" id x 5/8" od flat	10	08275
K nut; 6mm nylock	6	07553
L heat shield	1	07671
M edge trim 44"	1	102486
N edge trim 17"	1	102474
O bracket; long "L"	1	26626
P bracket; short "L"	1	07158
Q bracket; "C"	1	07171
R bolt; 6mm-1.00 X 16mm, hex	4	07703
S washer; 1/4" split lock	1	08198
T bolt; 6mm-1.00 X 25mm, hex	1	07704
U washer; 1.25" od x .28" id, flat	2	08151
V washer; 1" od x .300" id x .100" thk	1	21685
W filter adapter #380	1	21512
X hose clamp #104	1	08697
Y air filter	1	RF-1048

NOTE: FAILURE TO FOLLOW INSTALLATION INSTRUCTIONS AND NOT USING THE PROVIDED HARDWARE MAY DAMAGE THE INTAKE TUBE, THROTTLE BODY AND ENGINE.

TO START:

1. Turn the ignition OFF and disconnect the vehicle's negative battery cable.

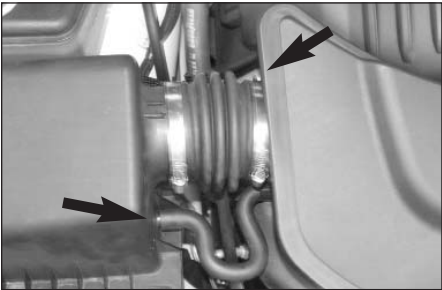

2. Loosen the hose clamp, which secures the stock intake tube to the intake plenum, and disconnect the crank case vent hose from the air box lid.



3. Remove the oil filler cap and then lift up the front of engine cover to gain access to the throttle body hose clamp intake plenum mounting bolt.

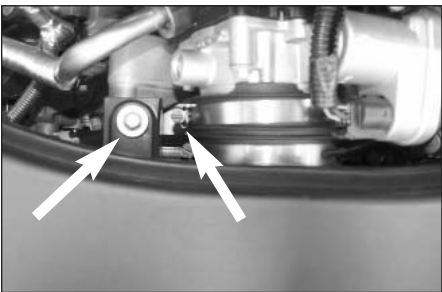

4. Remove the intake plenum-mounting bolt and loosen the intake plenum hose clamp at the throttle body.



5. Pull the intake plenum off the throttle body and rotate forward, then disconnect the crank case vent hose from the tube attached to the intake plenum.

NOTE: Do not completely remove the intake plenum at this time.



6. Disconnect the air temperature sensor electrical connection and then remove the intake plenum from the vehicle.



7. Remove the engine cover from the engine as shown.

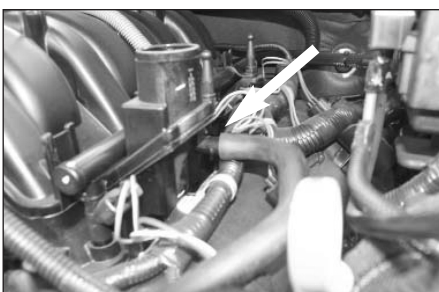

8. Remove the crank case vent hose from the engine as shown.



9. Unhook the air box lid retaining clamps and then remove air box lid and filter.

NOTE: K&N recommends that you do not discard your factory air intake.



10. Using a small screwdriver, release the center holding pins in the six grill retaining clips shown.



11. Remove the six grill retaining clips from the grill, then tilt the grill forward and lift to remove from the vehicle.



12. Pull the fresh air duct forward to disconnect it from the air box and then remove it from the vehicle.

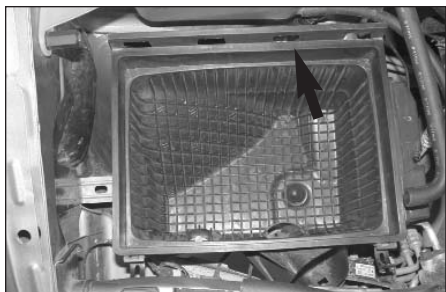

13. Remove the air box mounting bolt shown.



14. Lift the lower air box and remove it from the vehicle as shown.

NOTE: K&N recommends that customers do not discard factory air intake.



15. Install the supplied "C" bracket (07171) onto the heat shield as shown with the provided hardware.



16. Install the large "L" bracket (26626) onto the heat shield as shown with the provided hardware.

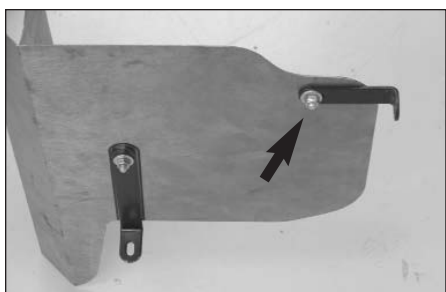

17. Install the small "L" bracket (07158) onto the heat shield as shown with the provided hardware.

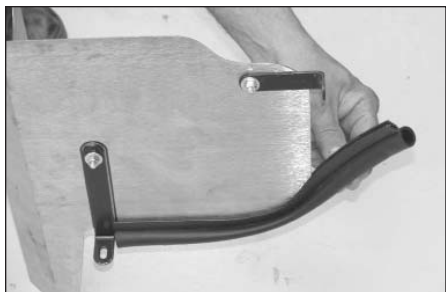

18. Install the short edge trim onto the heat shield assembly as shown.

NOTE: Some trimming of the edge trim may be necessary.



19. Install the long edge trim onto the heat shield assembly as shown.

NOTE: Some trimming of the edge trim may be necessary.



20. Remove the coolant reservoir-retaining nut and air box mounting grommet shown.

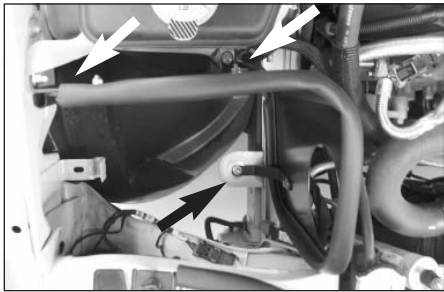

21. Install the heat shield assembly into the vehicle and secure to the lower and upper air box mounts and washer bottle stud with the provided hardware.



22. Install the silicone hose (08630) onto the throttle body and secure with the hose clamp provided.



23. Remove the nut, which secures the intake plenum-mount shown.

NOTE: This nut will be reused.



24. Install the saddle clamp onto the tube mounting bracket (26625) as shown with the provided hardware.



25. Install the tube mounting bracket assembly onto the plenum mount and secure with the factory nut removed in step #23.



26. Install the provided grommet into the K&N intake tube as shown.



27. Rotate the air temperature sensor counter clockwise and remove the sensor from the stock intake plenum as shown.

NOTE: Be very careful with the air temperature sensor, as it is very fragile.

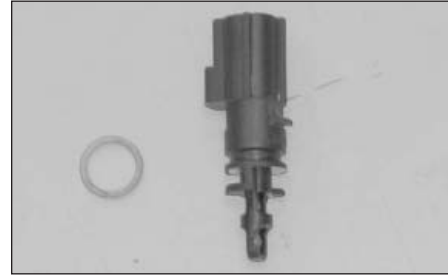

28. Remove the rubber sealing "O" ring from the air temperature sensor as shown.



29. Install the air temperature sensor into the K&N intake tube as shown.

NOTE: Be careful with the air temperature sensor, as it is very fragile.



30. Install the K&N intake tube into the silicone hose at the throttle body and onto the saddle clamp, then secure with the provided hose clamps.



31. Install the provided crank case vent hose onto the valve cover and then onto the K&N intake tube as shown.



32. Reconnect the air temperature sensor electrical connection as shown.



33. Install the filter adapter into the air filter as shown, secure with the provided hose clamp.

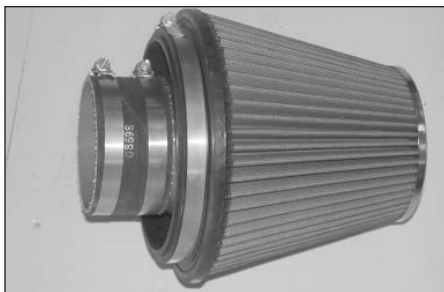

34. Install the silicone (08630) onto the air filter assembly and secure with the provided hose clamp.



35. Install the K&N air filter assembly onto the K&N intake tube as shown and secure with the provided hose clamp.

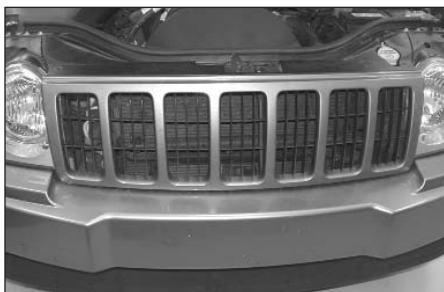

36. Reinstall the grill assembly with the factory retaining clips removed in step #5



37. Reinstall the engine cover, reconnect the vehicle's negative battery cable. Double check to make sure everything is tight and properly positioned before starting the vehicle.

38. The C.A.R.B. exemption sticker, (attached), must be visible under the hood so that an emissions inspector can see it when the vehicle is required to be tested for emissions. California requires testing every two years, other states may vary.

39. It will be necessary for all FIPK's to be checked periodically for realignment, clearance and tightening of all connections. Failure to follow the above instructions or proper maintenance may void warranty.

ROAD TESTING:

1. Start the engine with the transmission in neutral or park, and the parking brake engaged. Listen for air leaks or odd noises. For air leaks secure hoses and connections. For odd noises, find cause and repair before proceeding. This kit will function identically to the factory system except for being louder and much more responsive.

2. Test drive the vehicle. Listen for odd noises or rattles and fix as necessary.

3. If road test is fine, you can now enjoy the added power and performance from your kit.

4. K&N suggests checking the Air filter element periodically for excessive dirt build-up. When the element becomes covered in dirt (or once a year), service it according to the instructions on the Recharger service kit, part number 99-5050 or 99-5000.

FREE K&N DECAL To register your warranty, please see us online at knfilters.com/register. FREE K&N DECAL