



**BODY ARMOR 4X4 BY TOLAR MFG.**

**258 MARIAH CIRCLE, CORONA CA 92879**

**PH: 951-808-0750**

**CUSTOMER SERVICE HOURS:**

**7:30AM TO 4:30PM M-TH**

**8AM-12PM FRI. (PST)**

**[WWW.BODYARMOR4X4.COM](http://WWW.BODYARMOR4X4.COM)**



**INSTALLATION INSTRUCTIONS FOR TJ-2994/TJ-2961 REAR BUMPER**

**FITS 1988 - 1995 YJ, 1997- 2006 TJ**

**\*\* Inspect bumper and all parts prior to installation. Contact us at 951-808-0750 for missing parts.**

## Hardware list:

- 10mm Flat washers Qty 6
- 10mm Hex head bolts Qty 4
- 10mm Hex head nuts Qty 6
- 10mm Lock washers Qty 6
- Body Armor decal Qty 1

## Removing Factory bumper:

- 1 Remove Factory hardware attaching bumper to frame.
- 2 Clean mounting surfaces at this time to prep for installation.

## Bumper Installation for TJ-2994, TJ-2961:

We recommend you have help with lifting of the rear bumper to avoid injury or damage to bumper and vehicle.

- 1 **YJ Installation Only:** Using outside holes on rear passenger side of frame measure over to center of frame 8". Use center punch to mark hole. Measure down 1 3/16", use center punch to mark

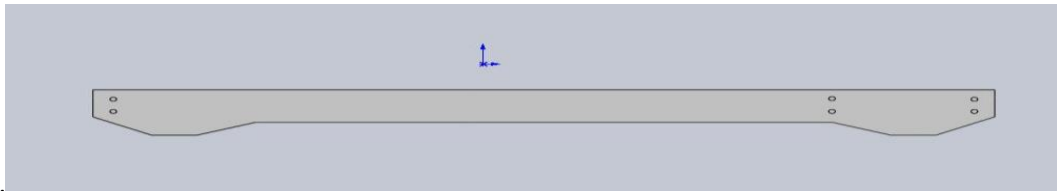

hole.

- 2 Drill hole to 7/16". (On some model years these holes may be existing, but needing to be opened to 7/16"). Deburr drilled holes.
- 3 **TJ & YJ Installation:** Locate stud plate and two nut plates and install on rear bumper. The two nut plates are used on the two outside hole locations on bumper. Install stud plate prior to installing bumper.

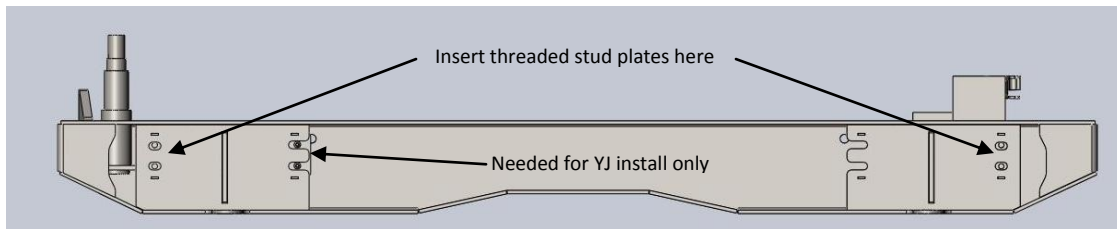

- 4 Using help lift the rear bumper into position inserting stud plate studs through drilled holes. With supplied hardware start outside bolts into nut plates and stud plates. Do not tighten at this time.
- 5 Check location of bumper and adjust as necessary. The rear cross member on some TJL's are not vertical. You may want to add a washer on the upper or lower bolts, depending on the angle of the cross member, between the bumper and cross member. This is optional not a required

adjustment, since the adjustments is optional washers are not included, 1/8" thick washers will work.

- 6 Tighten all bumper hardware to frame hardware at this time.

#### Installation of 5294 Swing Arm to TJ-2994:

- 1 Pre-lube the bearings with basic automotive grease. Make sure the pivot stub is clean prior to inserting the arm.
- 2 Install the large bearing in bottom side of swing arm hub. Install small bearing race in top of swing arm hub.
- 3 Install large bearing in bottom of swing arm followed by hub seal. Take care not to damage the seal

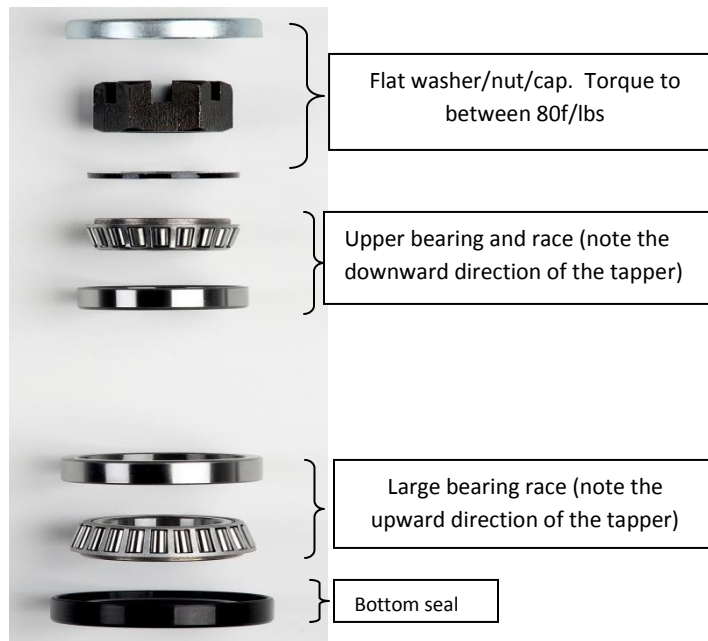

- 4 Install swing arm onto pivot post and install small bearing, large washer, and castle nut. Tighten castle nut to 80 ft/lbs.
- 5 Install dust cap with cup side down.
- 6 Install cam lock latch to swing arm using four button head screws with washers and tighten.

**Note: the properly adjusted cam lock will close the carrier tight against the stop and can be latched using one hand with 20 to 25 pounds of force.**

- 7 Loosely install the tire carrier plate to swing arm.
- 8 Set spare tire on tire carrier plate. With tire tight and square against swing arm leave 3/8" gap between wheel and carrier plate.
- 9 Tighten carrier plate at this time.

10 Tighten spare tire lug nuts at this time.

**Note: Recheck all hardware after the first couple hundred miles. It is advised to inspect the bumper and hardware periodically.**



**TJ-19531 Front Winch Bumper**