



**IMPORTANT WARRANTY & INSTALLATION
INSTRUCTIONS ATTACHED**

*Please Forward All Attached Information to Consumer
Warranty Not Valid Unless Returned to Volant Performance*

PROTECT YOUR PROOF OF PURCHASE



**For Full-Color Installation Instructions, Please Visit:
VOLANTPERFORMANCE.COM and Search by Part Number**

Please be sure to review the enclosed instructions prior to beginning the installation process. If you have any questions about the enclosed parts, instructions or encounter a problem during installation:
CALL VOLANT PERFORMANCE TECHNICAL ASSISTANCE AT 909.481.3888



Please take time to read and understand these installation instructions.

We recommend that the installation of this system be performed by a qualified service center or professional muffler installer who has the necessary equipment, tools and experienced personnel. However, if you decide to perform this install, the use of a hoist and an additional person will be required.

CAUTION: Never work on a hot exhaust system. Allow time for the vehicle to cool. Always wear eye protection when working under a vehicle.

Recommended Tools:

- Safety Glasses • 15mm Wrench or Deep Socket • Torque wrench • Soap & Water Solution

Please confirm that all parts are present before beginning the factory exhaust system removal and Volant Exhaust system installation.

Bill of Materials:

5	1SCE7006	BOX (NOT SHOWN)	
4	17CH7057	HARDWARE KIT	
3	17CH4210	PASSENGER SIDE TIP TUBE ASSEMBLY	
2	17CH3047	VOLANT ROLLED EDGE TIP	2
1	17CH2151	DUAL EXHAUST MUFFLER	
ITEM	PART NUMBER	DESCRIPTION	QTY.

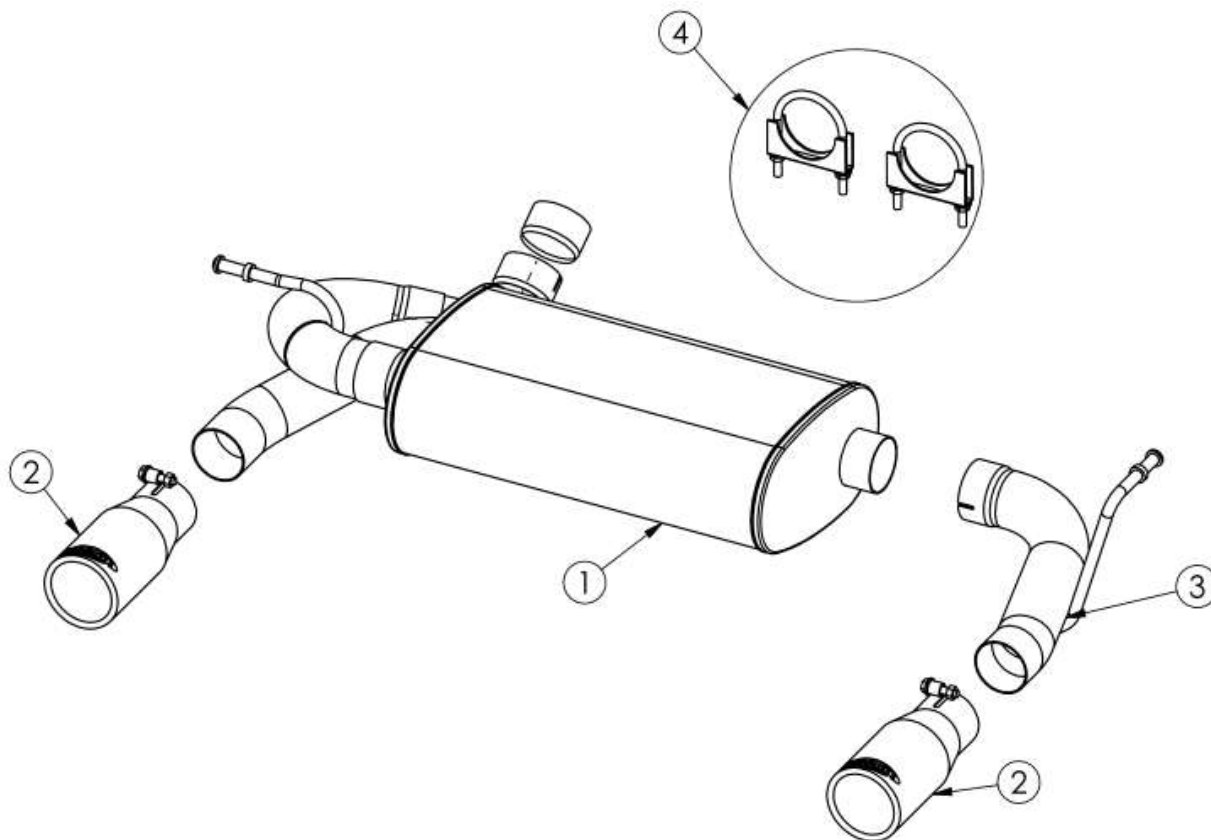

Removal of Stock System:

- 1) Using a 15mm socket, loosen the factory clamp at the inlet of the muffler.
- 2) Using grommet pullers or similar device, remove passenger side muffler hanger from rubber grommet. (See Fig A)

NOTE: Using soapy water solution on the grommet hole will make the job easier.

- 3) Using grommet pullers or similar device, remove driver side muffler hanger from rubber grommet. Carefully slide the muffler from clamped location. This completes the removal of the stock system. (See Fig B & C)

NOTE: Using soapy water solution on the grommet hole will make the job easier.



FIG. A



FIG. B



FIG. C

Installation of Volant Exhaust System:

NOTE: The supplied double edge clamps in this system will crush and permanently deform the exhaust piping as they are tightened. **DO NOT** tighten these clamps any more than is necessary to lightly hold the exhaust components in place, until the very end of this installation process. It will be difficult or impossible to make any positional or rotational adjustments to the exhaust system after these clamps have been tightened down.

VERY IMPORTANT: Align all clamps so that the open edge of the clamp bracket is parallel and aligned with the notch in the pipe, and the outside edge of the clamp bracket is approximately 1/8" from the end of the pipe expansion. (See Fig. 1) Failure to properly position or orient the clamps could result in a weak clamping load, or even a potential leak at the clamp joints.

IMPORTANT: Make sure that the small drain holes in the muffler are facing down when the muffler is installed. (See Fig. 2)

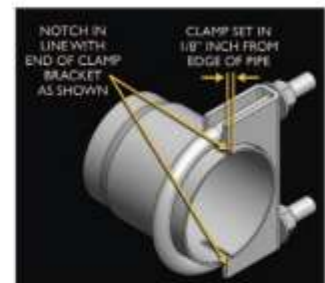

FIG. 1



FIG. 2

- 1) Locate the muffler and slide the expanded inlet end onto the factory pipe. Next, slide the hanger through the rubber grommet. Slide a 2.5" clamp over the expanded end of the muffler. Pre-tighten the clamp at this time. (See Fig D & E)

NOTE: Using soapy water solution on the grommet hole will make the job easier.

- 2) Locate passenger side tip tube and slide the hanger through the rubber grommet. Next, slide the expanded end over the outlet end of the muffler. Slide a 2.5" clamp over the expanded end of the tip tube. Pre-tighten the clamp at this time. (See Fig F)

➤ Repeat Step 3 for Driver Side

- 4) Starting from the muffler inlet and working back, tighten all the clamps to 35 ft-lbs. Tip clamp torque setting: 16-20 ft-lbs.
- 5) It is **strongly recommended** that all clamps be checked and tightened after road testing the vehicle once the system has cooled.

NOTE: During cold weather start-ups, you may experience an exhaust sound that is deeper and louder in tone than usual. This is temporary and will diminish to normal levels once your engine has reached its normal operating temperature. **NOTE:** Immediately following the installation of your exhaust system, you may experience a trace of smoke after initial start-up. **DO NOT** be alarmed. The smoke is caused by the burning of a small amount of forming oil residue used in the manufacturing process.



FIG. D



FIG. E



FIG. F



FIG. G