

Quadratec® Compact Cargo Receiver Rack

Assembly & Installation Manual: for 2" Receiver Hitches

#12033.1000



PARTS LIST:

A) 2" Main Tube	QTY 1	J) 2" Receiver Tube	QTY 1
B) Cargo Rack Halves	QTY 2	K) Plastic End Cap	QTY 1
C) Cross Brace	QTY 1	Hitch Pin & Cotter Pin - One Each	
D) M8 x 35 Bolt	QTY 2		
E) M8 Washer	QTY 4		
F) M8 Nylock Nut	QTY 4		
G) M10 x75 Bolts	QTY 6		
H) M10 Flat Washer	QTY 12		
I) M10 Nylock Nut	QTY 6		

REQUIRED TOOLS:

Safety Glasses
17mm Wrench & Socket
13mm Wrench or Socket
14mm Wrench or Socket

⚠ WARNING ⚠

TO REDUCE RISK OF SERIOUS INJURY OR PROPERTY DAMAGE: READ ALL SAFETY MESSAGES AND UNDERSTAND ALL INSTRUCTIONS AND PROCEDURE NOTICES BEFORE ATTEMPTING TO INSTALL OR USE THIS PRODUCT. FOLLOW ALL INSTRUCTIONS AND WARNINGS WITH PRODUCT & VEHICLE OWNERS MANUAL.

⚠ WARNING ⚠

REGARDING RECEIVERS: SEE PAGE 2 FOR URGENT RECEIVER CAPACITY WARNINGS. DO NOT ALLOW RECEIVER MOUNTED ACCESSORIES (RACKS, ETC.) TO BLOCK VEHICLE MIRRORS OR LIGHTS. READ AND UNDERSTAND ALL CAPACITY WARNINGS.

⚠ CAUTION ⚠

RISK OF EYE INJURY! SAFETY GLASSES MUST BE WORN AT ALL TIMES WHILE INSTALLING OR MAINTAINING THIS PRODUCT. TORQUE AND RECHECK FASTENERS AFTER 250 MILES AND FREQUENTLY THEREAFTER. INSPECT BUMPER AND MOUNT BEFORE USE. DO NOT USE IF DAMAGED.

NOTICE

CHECK STATE AND LOCAL HIGHWAY SAFETY LAWS REGARDING PERMITTED HITCH MOUNTED ACCESSORIES



The Trusted Source

A Few Words About Product Safety:

Your Receiver Mounted Cargo Rack is intended to enhance the utility and enjoyment of your off road capable vehicle. Before installation, please take a moment to review the following safety information, assembly and installation

instructions. Important safety information is generally preceded by one of three signal words indicating the relative risk of injury.

The signal words mean:

⚠ WARNING ⚠	a hazardous situation which, if not avoided, could result in death or serious injury. You CAN be KILLED or SERIOUSLY HURT if you don't follow instructions.
⚠ CAUTION ⚠	a hazardous situation which, if not avoided, could result in minor or moderate injury. You CAN be moderately HURT and also may suffer property damage if you don't follow instructions.
NOTICE	Careful attention is required to this instruction or operation but does generally not relate to personal injury. Damage to your Quadratec® product or other property may result if you don't follow instructions.

Before You Begin Installation:

Congratulations on your purchase of a Quadratec Cargo Receiver Rack. This version is specifically designed for use with a 2" receiver style hitch.

As cargo racks tend to be bulky, we suggest you get help for steps involving lifting, locating or holding the rack assembly during installation.

When unpacking, check to make sure all parts are included and not damaged due to shipping. If any part is missing or broken, please call Customer Service at 800-745-6037 as soon as possible.

Thank you again for your purchase and let's start the installation process.

⚠ WARNING ⚠	THIS IS DESIGNED FOR A CLASS II RECEIVER THE RACK IS RATED FOR A MAXIMUM OF 300 LBS CONSULT & NEVER EXCEED LESSER OF VEHICLE, RECEIVER OR TRAILER MAXIMUM TOW OR WEIGHT RATINGS.
⚠ WARNING ⚠	DO NOT BLOCK TAILLIGHTS OR LICENSE PLATE WITH CARGO LOAD. CONSULT AND FOLLOW ALL LIMITATIONS & WARNINGS IN YOUR VEHICLE OWNERS MANUAL AND SAFE TOWING SUPPLEMENT.
⚠ WARNING ⚠	SECURELY FASTEN LOAD TO CARGO CARRIER. ATTACH STRAPS AND/OR TIE DOWN HOOKS TO THE TUBULAR FRAME OF CARGO RACK. DO NOT CARRY ANY LOADS WIDER THAN YOUR VEHICLE.
⚠ WARNING ⚠	TO REDUCE RISK OF SERIOUS INJURY OR PROPERTY DAMAGE: INSTALL ACCORDING TO INSTRUCTIONS. TORQUE AND RECHECK FASTENERS AFTER 250 MILES AND FREQUENTLY THEREAFTER. INSPECT AND DO NOT USE RECEIVER/BUMPER IF DAMAGED.



The Trusted Source

Compact Cargo Rack Kits Contents:

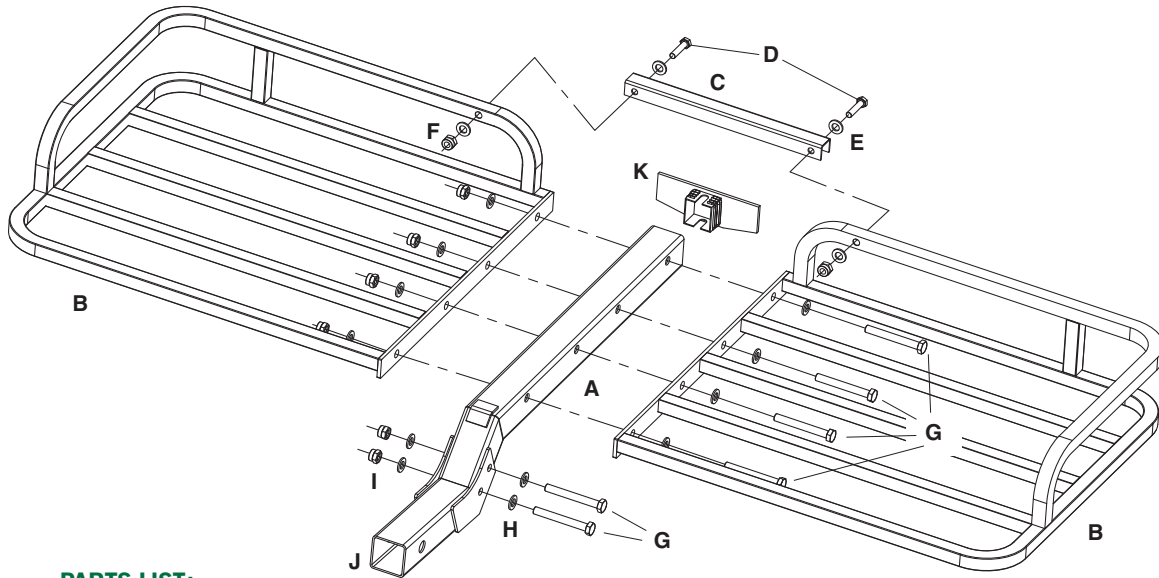

PARTS LIST:

A) 2" Main Tube	QTY 1
B) Cargo Rack Halves	QTY 2
C) Cross Brace	QTY 1
D) M8 x 35 Bolt	QTY 2
E) M8 Washer	QTY 4
F) M8 Nylock Nut	QTY 4
G) M10 x75 Bolts	QTY 6
H) M10 Flat Washer	QTY 12
I) M10 Nylock Nut	QTY 6
J) 2" Receiver Tube	QTY 1
K) Plastic End Cap	QTY 1
Hitch Pin & Cotter Pin	One Each

Note: Only finger tighten bolts until Carrier is fully assembled.

REQUIRED TOOLS:

- Safety Glasses
- 17mm Wrench & Socket
- 13mm Wrench or Socket
- 14mm Wrench or Socket

Assembly Instructions:

Put on safety glasses. Align mounting holes on the ends of the Right and Left rack halves (B) with the mounting holes along the sides of the Main Tube (A). Fasten the Rack Halves to the Main Tube using the M10 Bolts (G), Washers (H), and Nylock Nuts (I).

Set the Cross Brace (C) over the Rack Halves (B) and fasten the Cross Brace to the Halves using the M8 Bolts (E),

Washers (F), and Lock Nuts (G). Attach the 2" Receiver Tube (J) to Main Tube (A) with the remaining M10 Bolts (G), M10 Washers (H), and Nylock Nuts (I).

Use 13 & 14mm wrenches or sockets to tighten the M8 bolts, and two 17mm wrenches or sockets to tighten the M10 Bolts securely. Finally, insert the End Cap (K) into Main Tube (A).



The Trusted Source

Cargo Rack Installation:



The fully assembled rack should appear as shown above.



Install the rack into your 2" receiver hitch and secure with the supplied 5/8" receiver pin and cotter pin.



This convenient design allows swing-open tailgate access, when cargo is not installed in the rack.

©Quadratec, Inc. 2014. All Rights Reserved.
Instructions Part #12999.3018



The Trusted Source