



Part Included

- 1- Plastic Dash Adaptor
- 1-Custom Wiring Harness
- 1-Antenna Adaptor
- 1-Small Plastic Bag with 1 red connector
& 1 blue posi - tap

CFE PRODUCTS

P 1

MODELS : DKNAL- 11B & 11W

ALPINE NAV RADIO INSTALL KIT

with STEERING WHEEL CONTROL 2010 to 2017

Special Note - While this installation kit is mostly plug & play, we strongly advise that you thoroughly read the instructions that came with your new radio before proceeding. There are some wires that do not connect at this time, but may be used in the future.

1. Your NAV Radio comes with a Metal Sleeve that slides around the outside of the Radio. This will not be needed for your Jeep Installation. Remove the Sleeve. The Radio also has a Plastic Trim Ring which snaps on the front. This will not be used for your Installation. Unsnap the Trim Ring and remove.
2. Attach the Double DIN Brackets/Trim Plates to the side of the Radio using the Screws supplied with the Radio as shown in picture #1. There is a Left and Right Side Bracket. The Mounting Ear with 2 slots will be positioned at the top as shown in the Red Circle in picture #1. Adjust the Brackets so that they are flush with the Radio in the front and tighten Screws.
3. Install the Hands Free Microphone (see instructions included with the Radio for recommended placement) Run wires behind Dash to the Radio Opening.
4. Install NAV Antenna which was included with the Radio. The Blue Box in picture #2 shown an optional location that makes the Installation easy. The Jeep Dash and Roof are not made of metal so the signal will pass through them. The wire can be neatly positioned behind the Radio.
5. Using the Connector included in the Small Plastic Bag, install the RED Male Spade on the wire labeled "Speed Sensor" as shown in picture #4. (this wire is only on Radio's with built-in Navigation. If the Radio does not have built-in Navigation, the wire will not be there and the RED Male Spade will not be used. Wire is shown in picture #4)
6. **IMPORTANT: Only if your Radio has Built-in NAVIGATION, Plug the Red Connector into the Red Connector on the Installation Harness shown by the Yellow Line in picture #4 to #5. If your Radio does not have Built-in Navigation, skip this step and leave wires unconnected.**
7. Note that the Blue Connector shown in picture #5 is for future use. This will be used if you ever install an After-Market Subwoofer System.
8. Attach the supplied Antenna Adaptor (not shown) to Radio Antenna Plug shown in picture #2.
9. Verify that the Setting on the Blue Installation Module is Set to #1 as shown in picture #3.
10. Plug the 3.5mm Steering Wheel Remote Plug shown in the Orange Circle in picture #5 to the "Steering Remote" Jack shown in picture #4.
11. Plug the Black Radio Plug shown in the Red Circle in picture #5 into the Radio Harness Socket location shown in picture

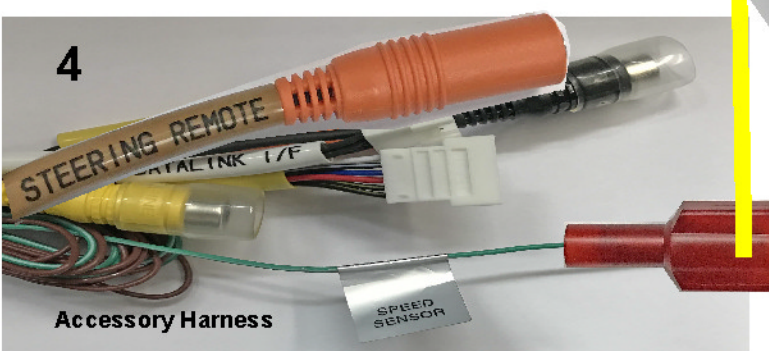
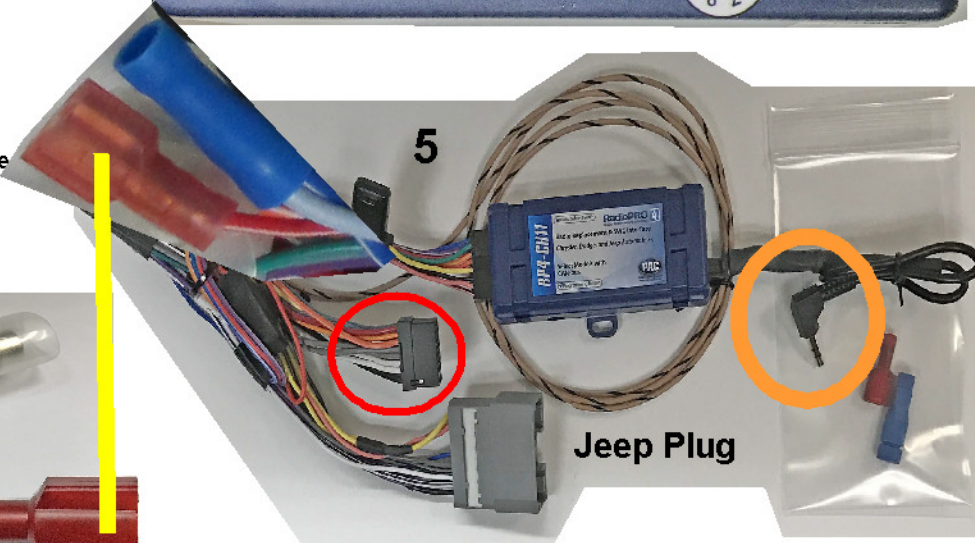
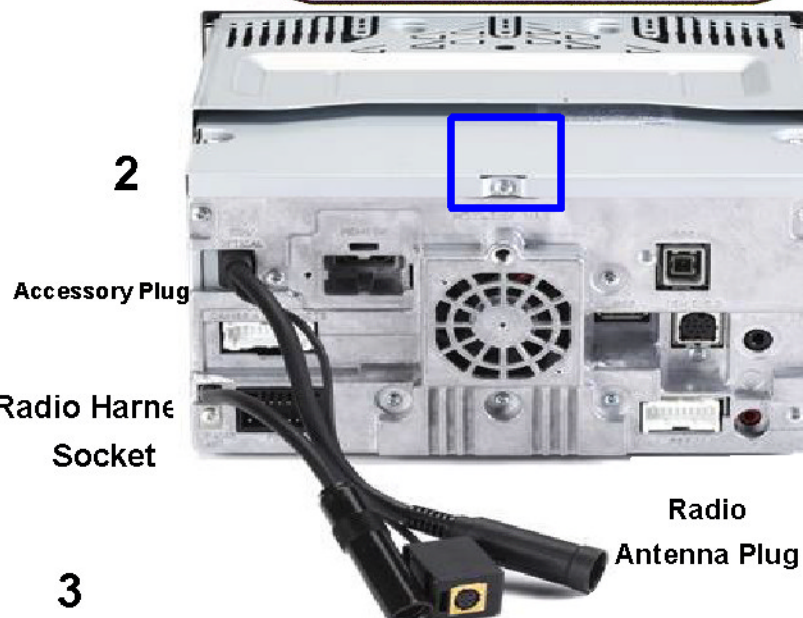
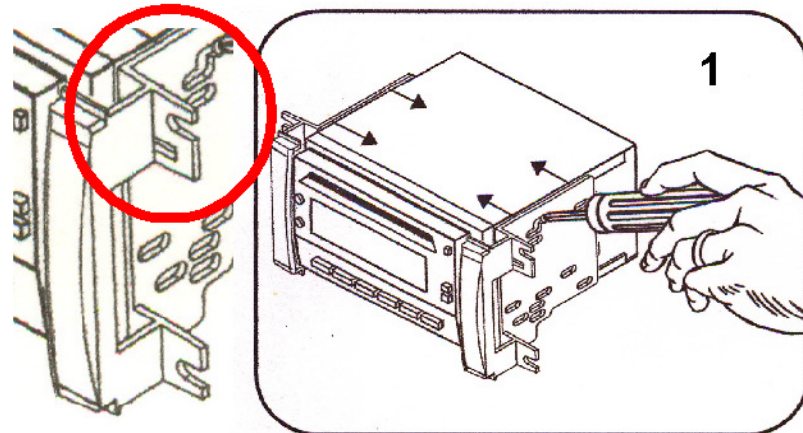

ANY QUESTIONS OR COMMENTS ,CALL BOB 610-358-1886

CFE PRODUCTS 1485 WILMINGTON PIKE WEST CHESTER PA. 19382



MODEL # DKNAL

P 1 b

ALPINE FOOT BRAKE CONNECTION 2007 to 2017

1. Using a flat edge or small trim tool, remove the Dash Panel below the Steering Wheel as shown in picture #1.
2. Using a 10mm socket, remove the two bolts holding the Steel Plate below the Steering Column and remove the Plate as shown in picture #2 & #3.
3. Locate the Brake Light Switch at the top of the Brake Peddle as shown in picture #4.
4. Unplug the Gray Plug from the Brake Light Switch. The Gray Plug is shown in picture #5.
5. Attach the Blue Posi-Tap Connector to the White Wire with Stripe as shown in picture #5 #6 & #7.
6. Connect the Long Tan Wire with the Brown Stripe that is attached to the Installation Harness using the Posi-Tap Connector to the open end of the Posi-Tap as shown in picture #8. Note that the wire has been pre stripped. Picture #9 shows the installed Posi-Tap Connector.

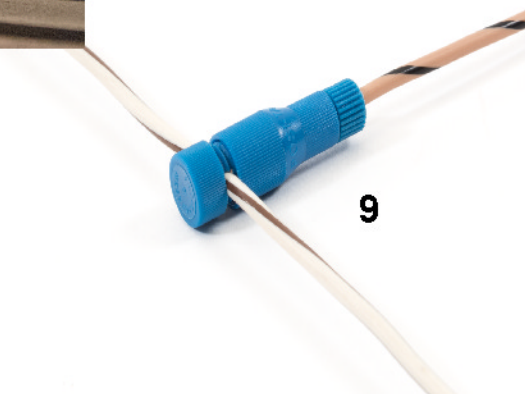
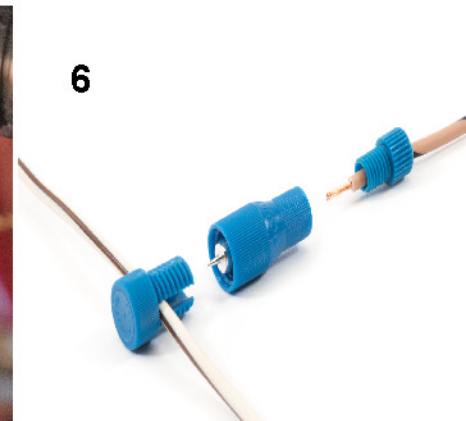
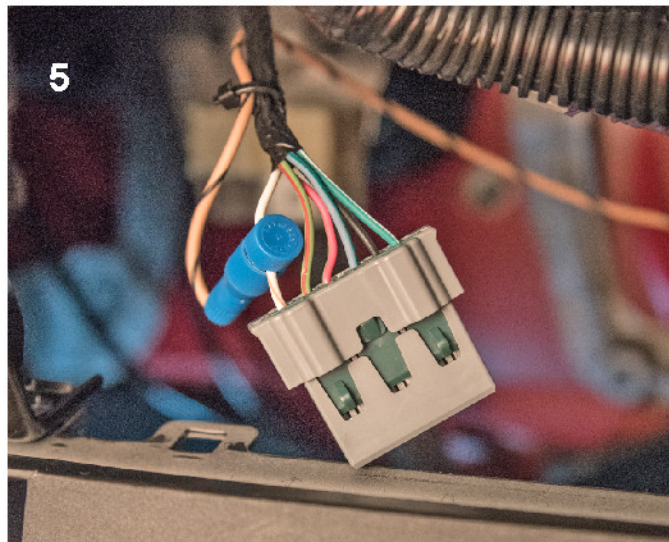
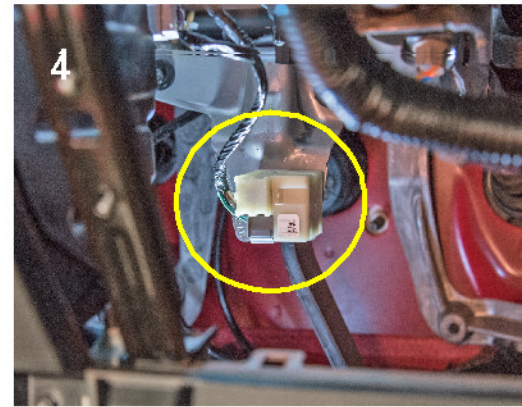
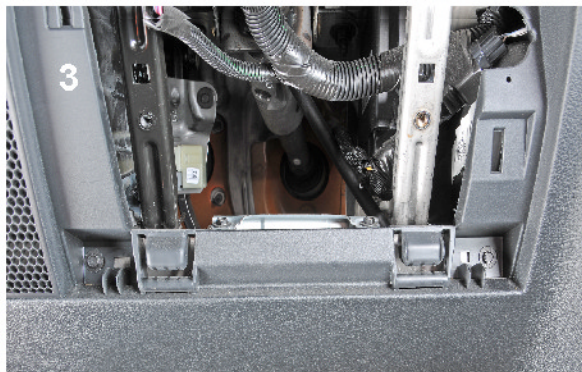
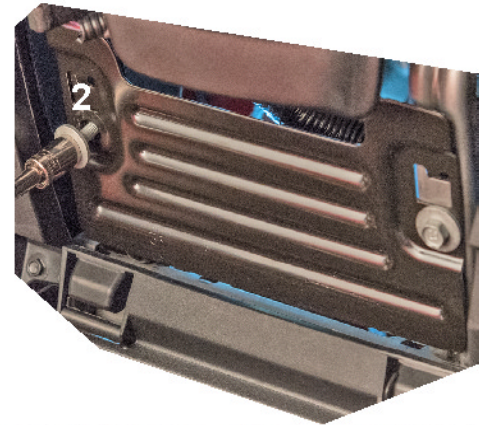

ANY QUESTIONS OR COMMENTS CALL BOB 610-358-1886
CFE PRODUCTS 1485 WILMINGTON PIKE WEST CHESTER PA. 19382



JK Wrangler 2011 & UP
With Steering Wheel Controls

WARNING: Before Proceeding With The Dashboard Disassembly, Disconnect And Isolate The Negative Battery And Wait Two Minutes For The Airbag System Capacitor To Discharge. Failure To Follow These Instructions May Result In Possible Serious Or Fatal Injury.

Remove Steering Column Cover

1. Using a trim stick or a flat edge screw driver, release the upper clips as shown in picture 1. Rotate the steering column opening cover down and remove from lower tabs as shown in picture 2.



Remove 3 Air Outlets

(1 on drivers side & 2 below the radio) Each air outlet is secured by a retaining tab located on the outlet, and a stop tab located on the back of the trim panel.

1. Access the retaining tab from the inside of the air outlet, through the square openings provided.

2. Rotate the louvers of the air outlet in the instrument panel to the eleven-o'clock position (pic 3).

3. Adjust the louvers partly downward for best access.

4. Working from the inside of the air outlet, place a small screwdriver or equivalent through the square opening located at the one-o'clock position (pic 4).

5. Carefully pry the retaining tab toward the center of the air outlet and rotate the outlet counterclockwise until the tip of the screwdriver reaches the eleven-o'clock position as shown in picture 5.

6. Pull the air outlet straight out of the instrument panel as shown in picture 6.



Remove 4 Dash Screws.

1. Using a 7 mm socket remove the top screw located under the storage bin mat as shown in picture 7.

2. Unsnap the switch opening plate from below the radio. If your vehicle has power windows, unplug the wiring harness from the switch plate. Pay attention to the red locking tab on the switch plate. Use a flat head screwdriver to push it up from the bottom (pic 8)

3. Remove the plug as shown in picture 9.





CFE PRODUCTS

MODEL # DKNAL - 11W & 11B

JK Wrangler 2011 & UP



P3

With Steering Wheel Controls

4. Remove the dash screw from behind the switch plate as shown in picture 10. Remove the 2 dash screws on either side of the steering wheel as shown in picture 11.

CAUTION: Do not use tools to release the lower bezel retaining clips or damage to the bezel and reinforcement ring can occur.

Remove Dash Bezel

1. Using two hands, reach through the vent openings and firmly grasp the lower bezel. Carefully pull the bezel back to release the lower retaining clips as shown in picture 12.
2. Using two hands on either side of the dash bezel, pull the dash bezel toward you from the bottom and remove the bezel as shown in picture 13.
3. Using a 7mm socket remove the 4 screws and slide the Factory Radio out (picture not shown).
4. Remove the Factory Antenna Connector(s). You will also have a Yellow Connector if you have Factory Satellite Radio. Squeeze the side of the plug to release the Plug and remove as shown in picture #14. Repeat the same procedure for the White Plug (am/fm antenna).
5. Remove the Gray Factory Radio Plug by Squeezing the bottom to release the Plug as shown in picture #15.
6. Remove the factory radio and set aside.

Install New Radio

1. Reconnect the White Antenna Cable from your Jeep to the Antenna Adaptor Cable which was already installed on the New Radio as shown in #16. If you also have a Yellow Connector it will not be used.
2. Plug the Gray 22 Pin Connector to the Jeeps corresponding Wiring Harness as shown in picture #17. Carefully tuck the Digital Adaptor Box behind the New Radio (picture not shown). This will allow room for the New Radio to slide into the Dash. Slide New Radio into the Dash making sure that none of the wires are pinched.
3. Re-Install One of the Radio Screws to hold radio in place.
4. Before going any further, test the New Radio to verify that all Functions are Operating Properly including Steering Wheel Controls.
5. If the Radio operates properly, Install the remaining 3 screws for the Radio and reassemble the Dash.

