

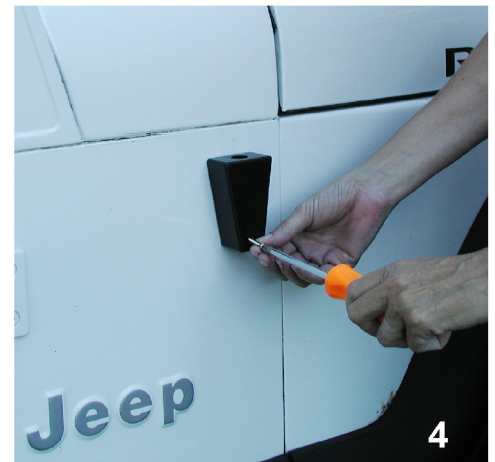

CFE PRODUCTS
YJ CUSTOM AM-FM ANTENNA
MODEL #YJ-ANT
Jeep Wrangler YJ
1988 / 1995

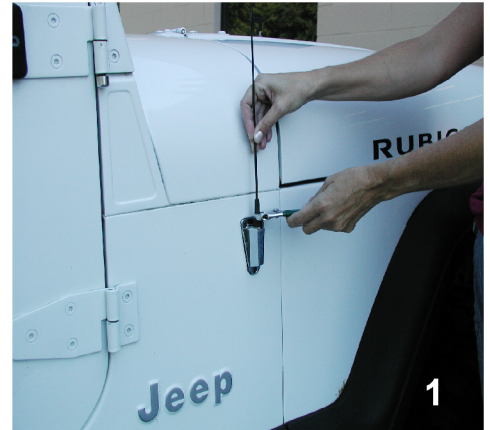

- 1 - Remove Factory AM-FM Antenna as shown in picture #1.
 - 2 - Remove the Bottom Phillips Head Screw from the Factory Mount as shown in picture # 2.
 - 3 - Install New Plastic Bezel using the Longer Phillips Screw supplied as shown in pictures #3 & #4.
 - 4 - Install supplied Antenna Nut and Stud as shown in picture # 5. Tighten just until it is snug.
 - 5 - Install New Antenna as shown in picture #6.
 - 6 - There is also an optional **Quick Disconnect** available.
- Quadratec Part # **96081.005**



Questions or Comments ? call CFE PRODUCTS
@ 610 358 1886 / ASK FOR BOB