

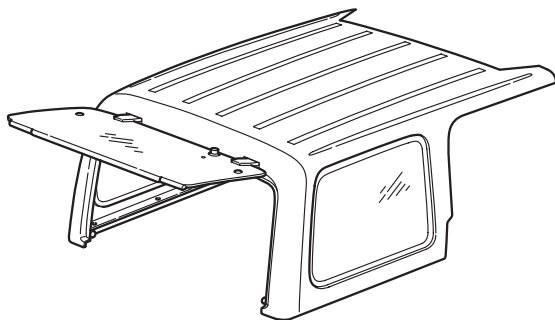

MOPAR®

# JEEP WRANGLER

## Hard Top



**A**

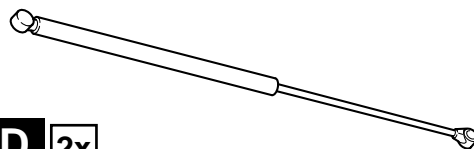

**D** 2x

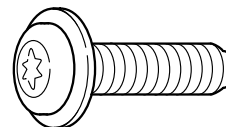

**E** 8x ONLY 6 REQUIRED ON 2-DR HARDTOP

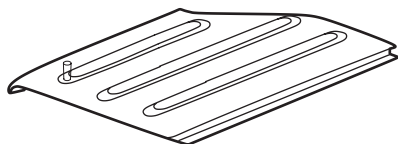

**B**

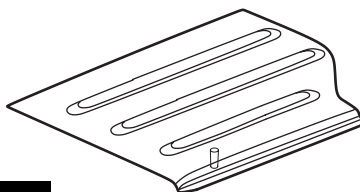

**C**

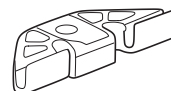

**F** 6x



**G** 2x

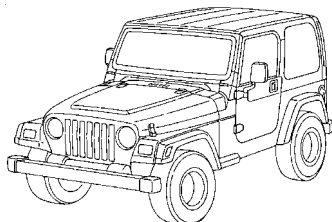

**ALSO ORDER SWITCH AND WIRING COMPONENTS KIT #82210215**

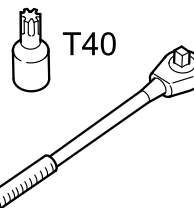

T40

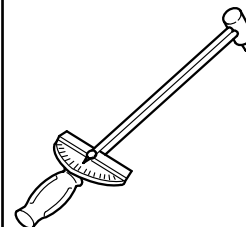

**REMOVE REAR VINYL WINDOW.**

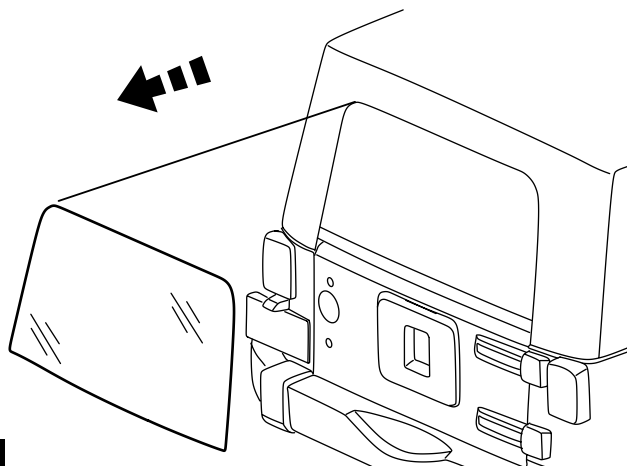

**1**

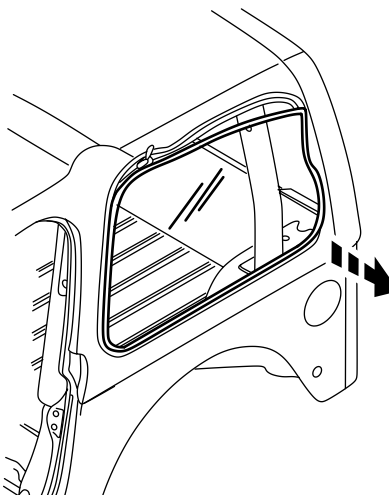

**REMOVE BOTH SIDE VINYL WINDOWS.**

**2**

4-DOOR MODEL SHOWN

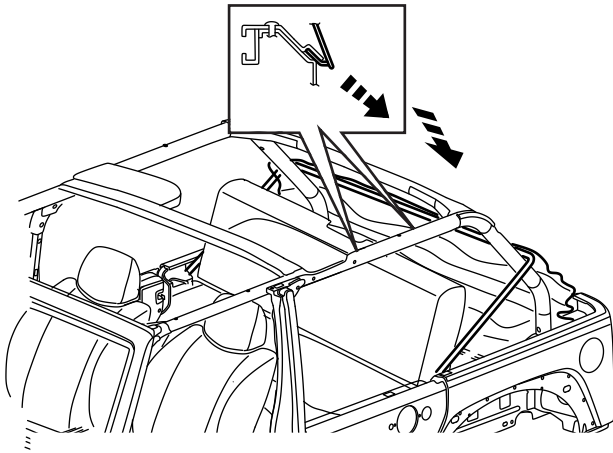

TOP IS DISENGAGED ALONG THE SIDES AND IN REAR SO IT CAN BE FOLDED AND STORED

3

4-DOOR MODEL SHOWN

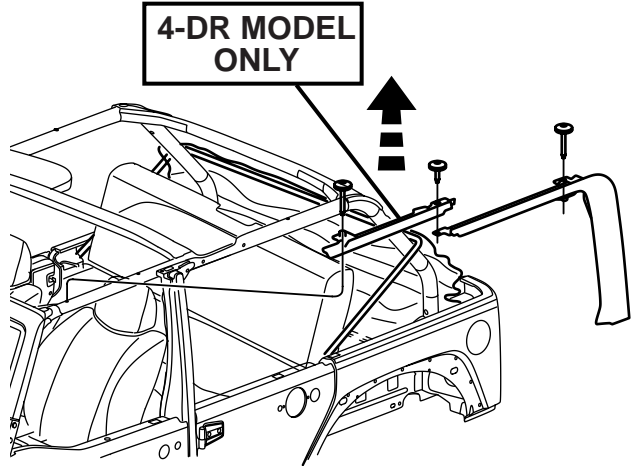

REMOVE THE SOFT TOP RAIL RETAINERS AS SHOWN (2-DR MODEL ONLY HAS 1 RETAINER PER SIDE)

4

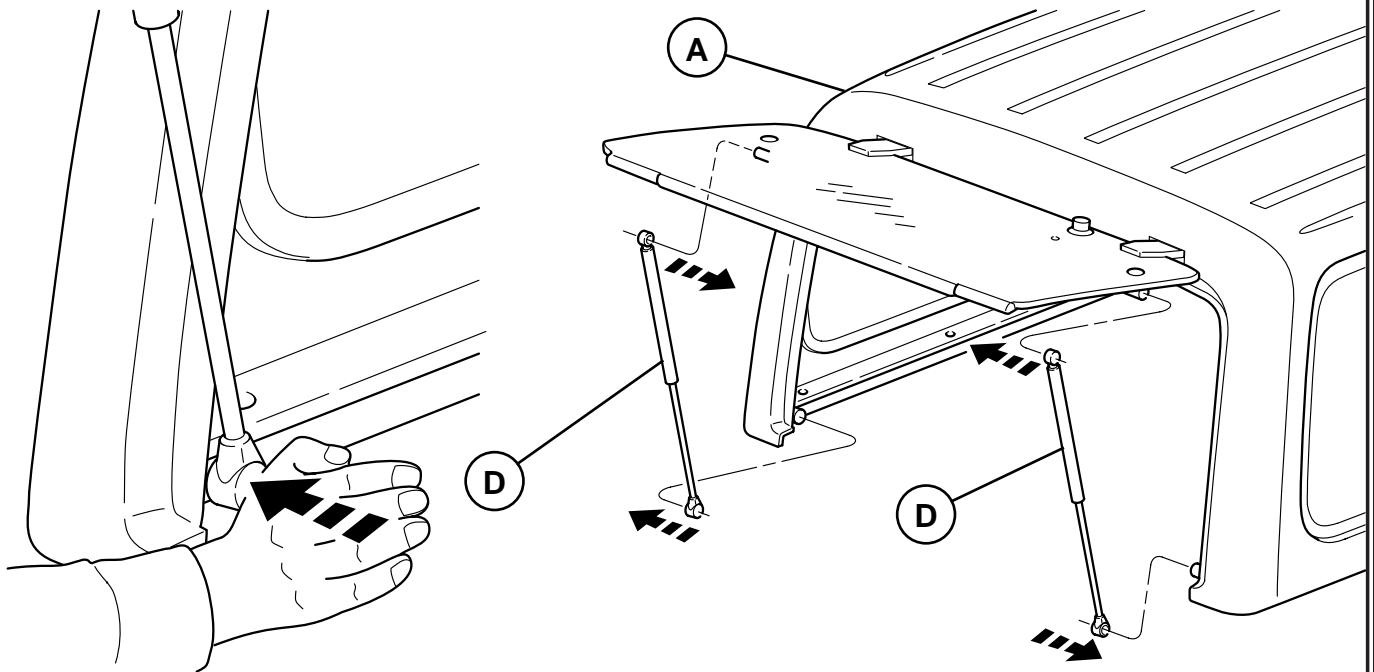

5

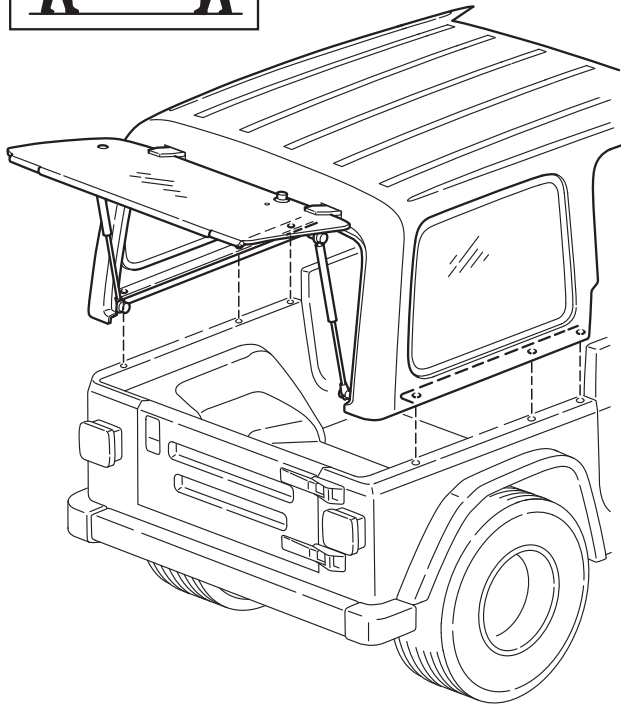
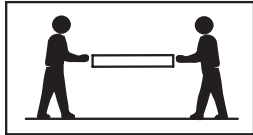

6

4-DOOR MODEL SHOWN

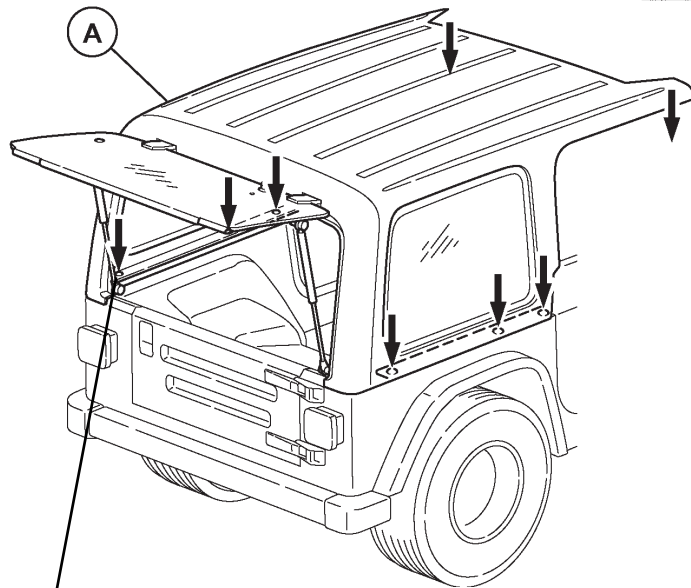

E 8x 70 in.-lbs. (8 N•m)

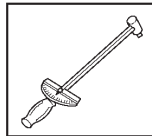
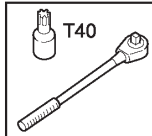

8

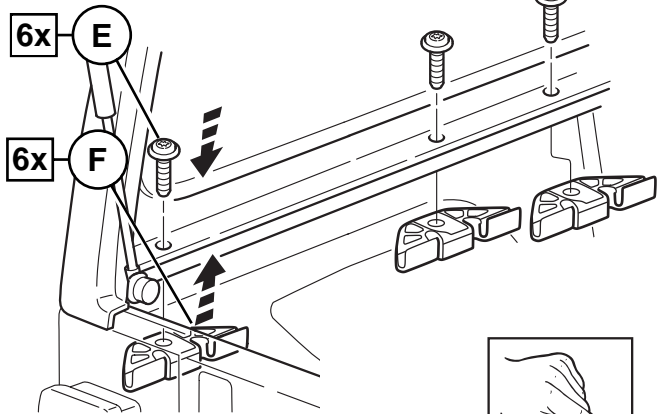
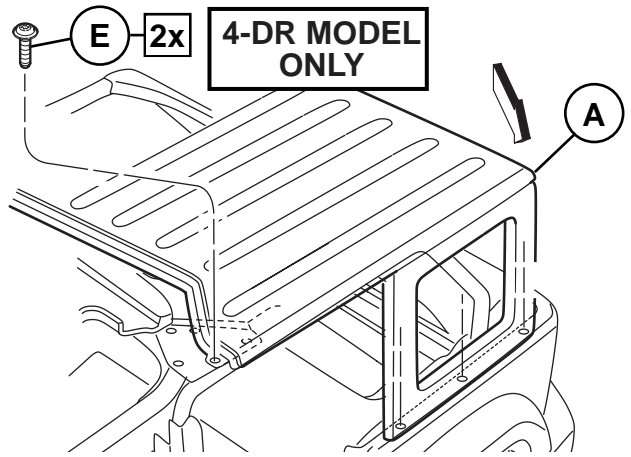

7 FINGER TIGHTEN SCREWS ONLY TO ALIGN ALL (8)

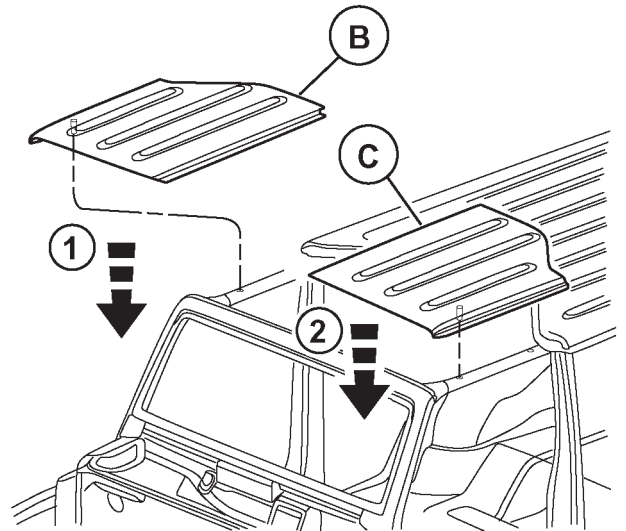

9

**SHOWN IN STEPS 10, 11, 12 IS THE RECOMMENDED SEQUENCE OF SECURING YOUR PANEL HARDWARE**

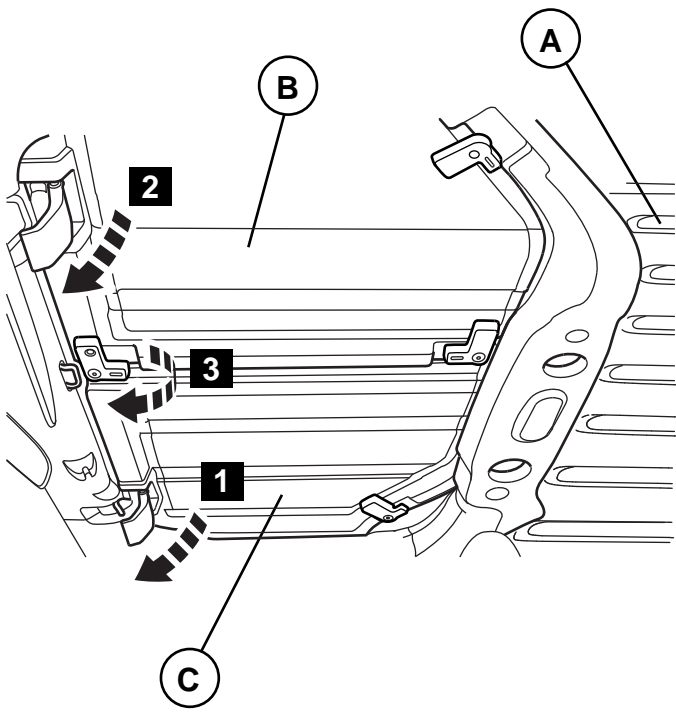

**10** ENGAGE THE FRONT OUTER LATCHES FIRST (SEQUENCE SHOWN) AND THEN, ROTATE THE FRONT CENTER LATCH TO "CLOSED" POSITION.

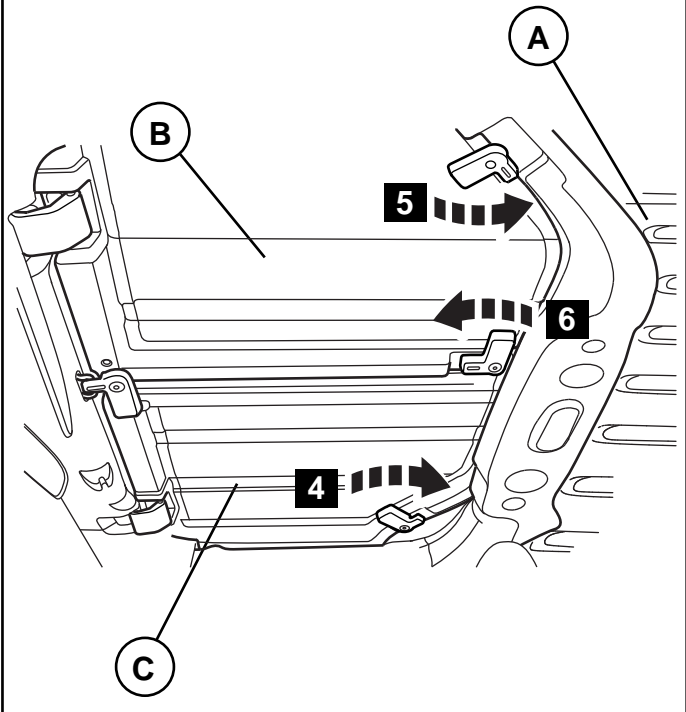

**11** ENGAGE THE REAR OUTER LATCHES FIRST (SEQUENCE SHOWN) AND THEN, ROTATE THE REAR CENTER LATCH TO THE "CLOSED" POSITION.

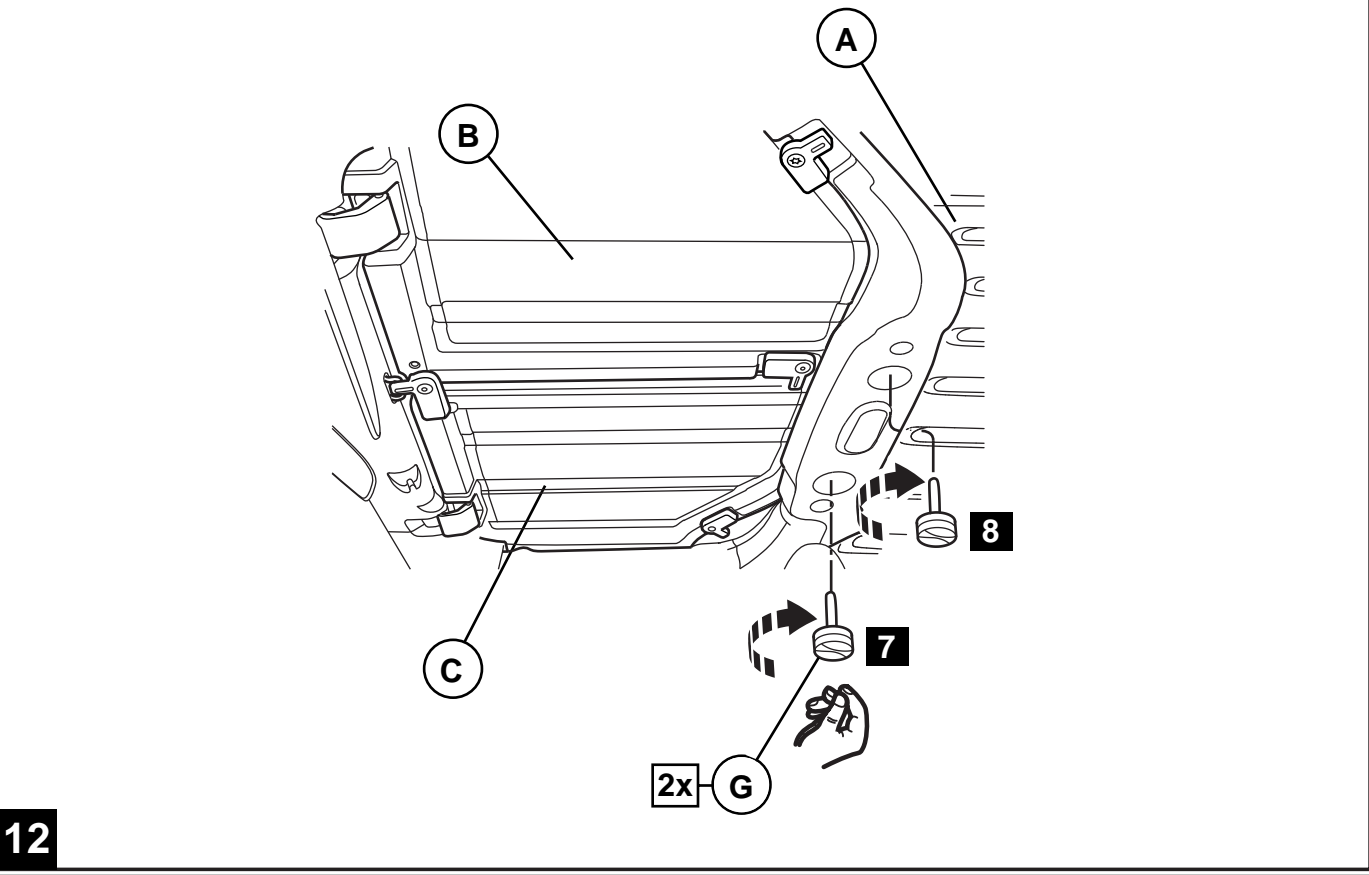

**12**