

# Jeep Wrangler TJ

Set Part # 10906  
Rev B 5-04

## Step 1: Prior to Installation:

**READ INSTRUCTIONS THOROUGHLY BEFORE BEGINNING INSTALLATION.**

**NOTE: These flares install OVER the factory flares. Do NOT remove the factory flares.**

- A) **Fit:** Verify the fit of the flares to vehicle by holding over the factory flares. (Some filing, sanding, or cutting may be necessary to ensure proper fit).
- B) **Painting:** (Optional) if paint is desired it must be done prior to installing flares on the vehicle clean outer surface with a good grade degreaser. **DO NOT USE LACQUER THINNER OR ENAMEL REDUCER AS A DEGREASER.** Wipe outer surface thoroughly with a tack rag prior to paint. Paint flares using a high quality enamel, or polyurethane automotive paint. (Application of a primer coat is optional) If painting edge trim (not recommended), use a flex additive.
- C) **Performance:** Using larger Tires may increase the area required to turn the vehicle. Some Tire/Rim combinations may require lowering bump stops and or installing steering stops to prevent tire from contacting flare.
- D) **Exhaust System:** Modifications may be necessary to maintain a minimum 4" clearance between flares and exhaust pipes. (Exhaust gases should not vent directly onto flares)

## TOOLS FOR EASY INSTALLATION

- Utility Knife
- 5/16" Wrench
- 10mm Wrench
- Electric Drill
- 1/4" Drill Bit
- Tape Measure
- Rubbing Alcohol

---

## FLARE INSTALLATION PROCEDURES

### Step 2: Edge Trim Installation (See Illustration #1)

- A) Remove factory installed edge trim when necessary.
- B) Peel two to three inches of red vinyl backing away from edge trim tape and affix to flare at one end. (With Adhesive Strip to the inside of flare, **See Illustration #1**)
- C) Press edge trim into place along edge of flare in one-foot increments, pulling red vinyl backing free as you continue to work your way around the flare.

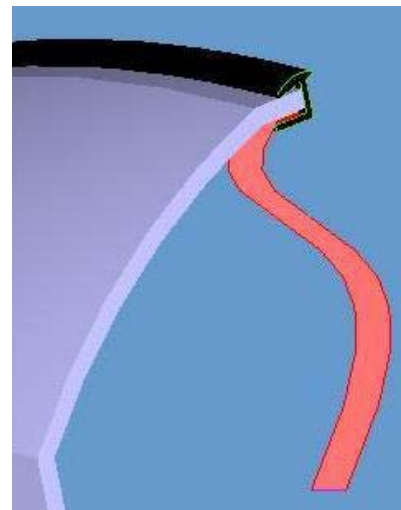

**Illustration #1**

### Step 3: Preparing the Work Area (See Illustrations #2 & #3)

- A) If the vehicle is equipped with 33" or taller tires, follow steps 3B, 3C, and 3D listed below. If not, skip to step 3E.
- B) Mark a line along the length of the factory flares 1" away from the sheet metal, parallel with the body. Cut along the marked line with a utility knife and remove the excess factory flares. Note: A minimum of 1" of the factory flares should remain to properly mount the Bushwacker fender flares.
- C) Cut the Bushwacker flares along the scribe lines formed into the inside surfaces using a utility knife.
- D) For best results, use a new razor blade in the utility knife. Make an initial pass with light pressure, then cut all the way through using the score as a guide.
- E) Clean and wash vehicle, making sure to remove all dirt and debris.
- F) Using a 10mm wrench, remove the marker light from both front factory flares and save. **See Illustration #2.**
- G) Using a 5/16" wrench, remove the front flare extension pieces from vehicle. **See Illustration #2.**
- H) Using a utility knife, extend slots 1" on the back side of the factory flare extension. **See Illustration #3.**

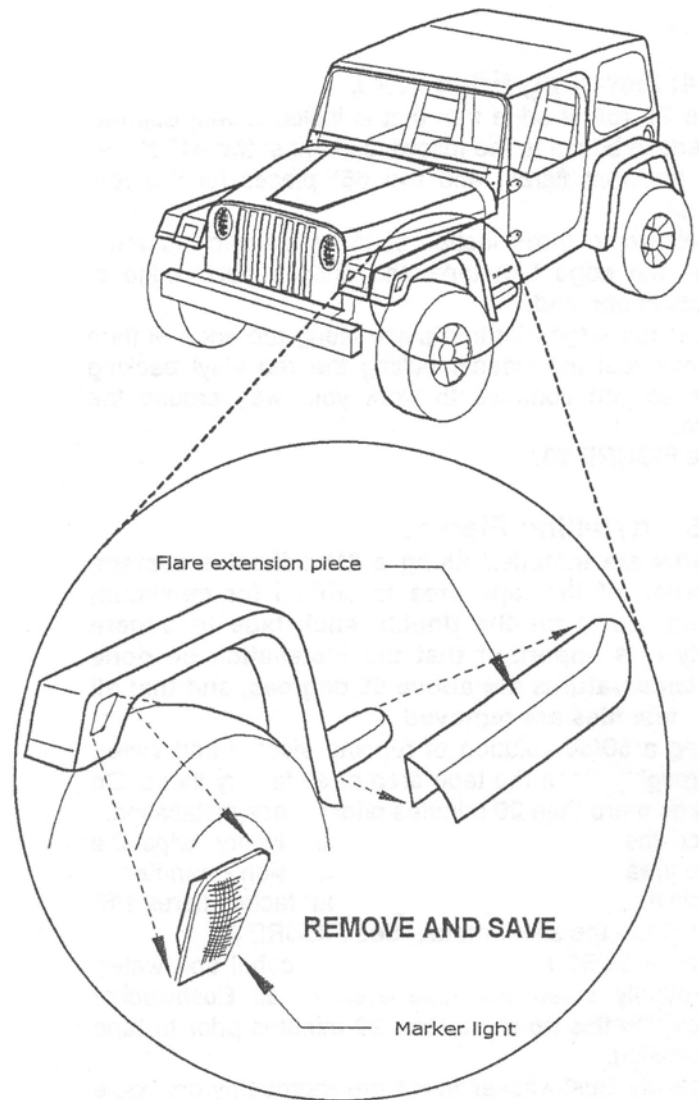

Illustration #2

### Step 4: Installing Flares (See Illustrations #4 and #5)

The flares are installed using a 3M adhesive tape system. Preparation of the tape area is critical for maximum adhesion. Note: For the double stick tape to adhere properly, it is important that the installation be done where temperatures are above 65 degrees, and that all car wax residues are removed.

- A) Using a 50/50 solution of rubbing alcohol and water, thoroughly clean the tape area of all factory flares. Do this no more than 20 minutes prior to tape installation.
- B) Once the factory flares are thoroughly dry, wipe the tape area using the supplied 3M Adhesion Promoter.
- C) Apply double stick tape along all four factory flares 1/8" away from the sheet metal. **See Illustration #4.**
- D) Using a 50/50 solution of rubbing alcohol and water, thoroughly clean the tape area of all Bushwacker flares. Do this no more than 20 minutes prior to tape installation.
- E) Once the factory flares are thoroughly dry, wipe the tape area using the supplied 3M Adhesion Promoter.
- F) Peel three inches of red vinyl backing from the tape on both ends of the factory flares. **See Illustration #4.**
- G) Place the Bushwacker flare over the factory flare leaving the ends of the red vinyl backing out over the top. **Be careful not to roll the tape while pushing on the flare.**

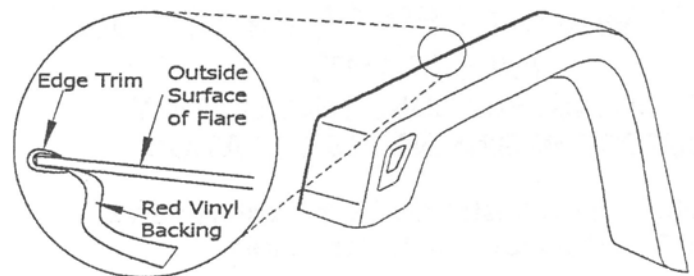
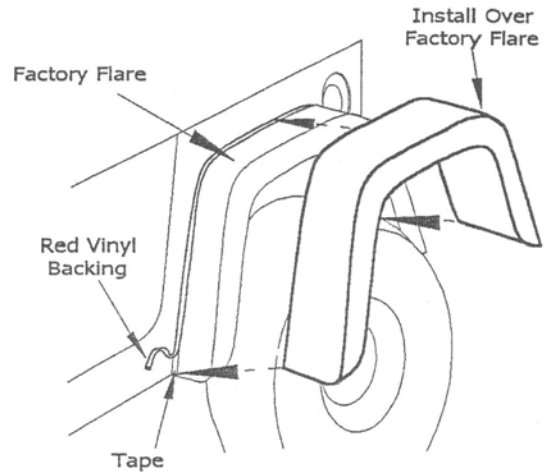
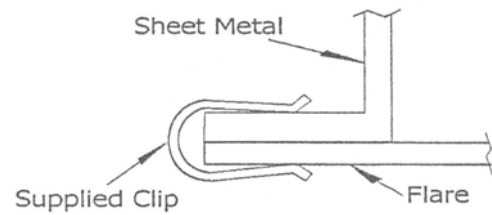

Illustration #3

- H) Once the flare is in place, peel the remaining red vinyl backing from under the Bushwacker flare. Apply a minimum of 30 pounds of pressure per 1" of tape to insure proper adhesion.
- I) Fasten with clips at the lower back corner of each flare. **See Illustration #5.**
- J) Drill a 1/4" hole through the front Bushwacker flares using the indent formed into the marker light recess as a guide. Reinstall marker lights into Bushwacker flares. Secure using factory fasteners.
- K) Reinstall factory flare extension pieces. Slide forward for correct fit to Bushwacker flares



**Illustration #4**



**Illustration #5**