

# Quadratec® Lightweight Cargo Receiver Rack

**Assembly & Installation Manual: for 2" Receiver Hitches**

#12033.1002



## **PARTS LIST:**

2" Receiver Main Tube - QTY 1  
Cargo Rack Base - QTY 1  
Rack Side Panels - QTY 2  
Rack Back Panel - QTY 1  
Rack Front Panel - QTY 1  
M5 Hex Bolts - QTY 16  
M5 Nylock Nuts - QTY 16  
M5 Flat Washers - QTY 32

M8 Allen Head Bolts - QTY 8  
M8 Flat Washers - QTY 16  
M8 Nylock Nuts - QTY 8  
Hitch Pin & Cotter Pin - One Each

## **REQUIRED TOOLS:**

Safety Glasses  
13mm Open Wrench  
7mm Open Wrenches or Sockets - QTY 2  
6mm Allen Wrench

### **⚠ WARNING ⚠**

**TO REDUCE RISK OF SERIOUS INJURY OR PROPERTY DAMAGE: READ ALL SAFETY MESSAGES AND UNDERSTAND ALL INSTRUCTIONS AND PROCEDURE NOTICES BEFORE ATTEMPTING TO INSTALL OR USE THIS PRODUCT. FOLLOW ALL INSTRUCTIONS AND WARNINGS WITH PRODUCT & VEHICLE OWNERS MANUAL.**

### **⚠ WARNING ⚠**

**REGARDING RECEIVERS: SEE PAGE 2 FOR URGENT RECEIVER CAPACITY WARNINGS. DO NOT ALLOW RECEIVER MOUNTED ACCESSORIES (RACKS, ETC.) TO BLOCK VEHICLE MIRRORS OR LIGHTS. READ AND UNDERSTAND ALL CAPACITY WARNINGS.**

### **⚠ CAUTION ⚠**

**RISK OF EYE INJURY! SAFETY GLASSES MUST BE WORN AT ALL TIMES WHILE INSTALLING OR MAINTAINING THIS PRODUCT. TORQUE AND RECHECK FASTENERS AFTER 250 MILES AND FREQUENTLY THEREAFTER. INSPECT BUMPER AND MOUNT BEFORE USE. DO NOT USE IF DAMAGED.**

### **NOTICE**

**CHECK STATE AND LOCAL HIGHWAY SAFETY LAWS REGARDING PERMITTED HITCH MOUNTED ACCESSORIES**



**The Trusted Source**

**A Few Words About Product Safety:**

Your Receiver Mounted Cargo Rack is intended to enhance the utility and enjoyment of your off road capable vehicle. Before installation, please take a moment to review the following safety information, assembly and installation

instructions. Important safety information is generally preceded by one of three signal words indicating the relative risk of injury.

The signal words mean:

<b>⚠ WARNING ⚠</b>	a hazardous situation which, if not avoided, could result in death or serious injury. You CAN be KILLED or SERIOUSLY HURT if you don't follow instructions.
<b>⚠ CAUTION ⚠</b>	a hazardous situation which, if not avoided, could result in minor or moderate injury. You CAN be moderately HURT and also may suffer property damage if you don't follow instructions.
<b>NOTICE</b>	Careful attention is required to this instruction or operation but does generally not relate to personal injury. Damage to your Quadratec® product or other property may result if you don't follow instructions.

**Before You Begin Installation:**

Congratulations on your purchase of a Quadratec Lightweight Cargo Rack. This version is specifically designed for use with a 2" receiver style hitch.

As cargo racks tend to be bulky, we suggest you get help for steps involving lifting, locating or holding the rack assembly during installation.

When unpacking, check to make sure all parts are included and not damaged due to shipping. If any part is missing or broken, please call Customer Service at 800-745-6037 as soon as possible.

Thank you again for your purchase and let's start the installation process.

<b>⚠ WARNING ⚠</b>	<b>THIS IS DESIGNED FOR A CLASS II RECEIVER THE RACK IS RATED FOR A MAXIMUM OF 500 LBS CONSULT &amp; NEVER EXCEED LESSER OF VEHICLE, RECEIVER OR TRAILER MAXIMUM TOW OR WEIGHT RATINGS.</b>
<b>⚠ WARNING ⚠</b>	<b>DO NOT BLOCK TAILLIGHTS OR LICENSE PLATE WITH CARGO LOAD.</b>
<b>⚠ WARNING ⚠</b>	<b>CONSULT AND FOLLOW ALL LIMITATIONS &amp; WARNINGS IN YOUR VEHICLE OWNERS MANUAL AND SAFE TOWING SUPPLEMENT.</b>
<b>⚠ WARNING ⚠</b>	<b>SECURELY FASTEN LOAD TO CARGO CARRIER. ATTACH STRAPS AND/OR TIE DOWN HOOKS TO THE TUBULAR FRAME OF CARGO RACK. DO NOT CARRY ANY LOADS WIDER THAN YOUR VEHICLE.</b>
<b>⚠ WARNING ⚠</b>	<b>TO REDUCE RISK OF SERIOUS INJURY OR PROPERTY DAMAGE: INSTALL ACCORDING TO INSTRUCTIONS. TORQUE AND RECHECK FASTENERS AFTER 250 MILES AND FREQUENTLY THEREAFTER. INSPECT AND DO NOT USE RECEIVER/BUMPER IF DAMAGED.</b>



**The Trusted Source**

**Cargo Rack Kits Contents:**

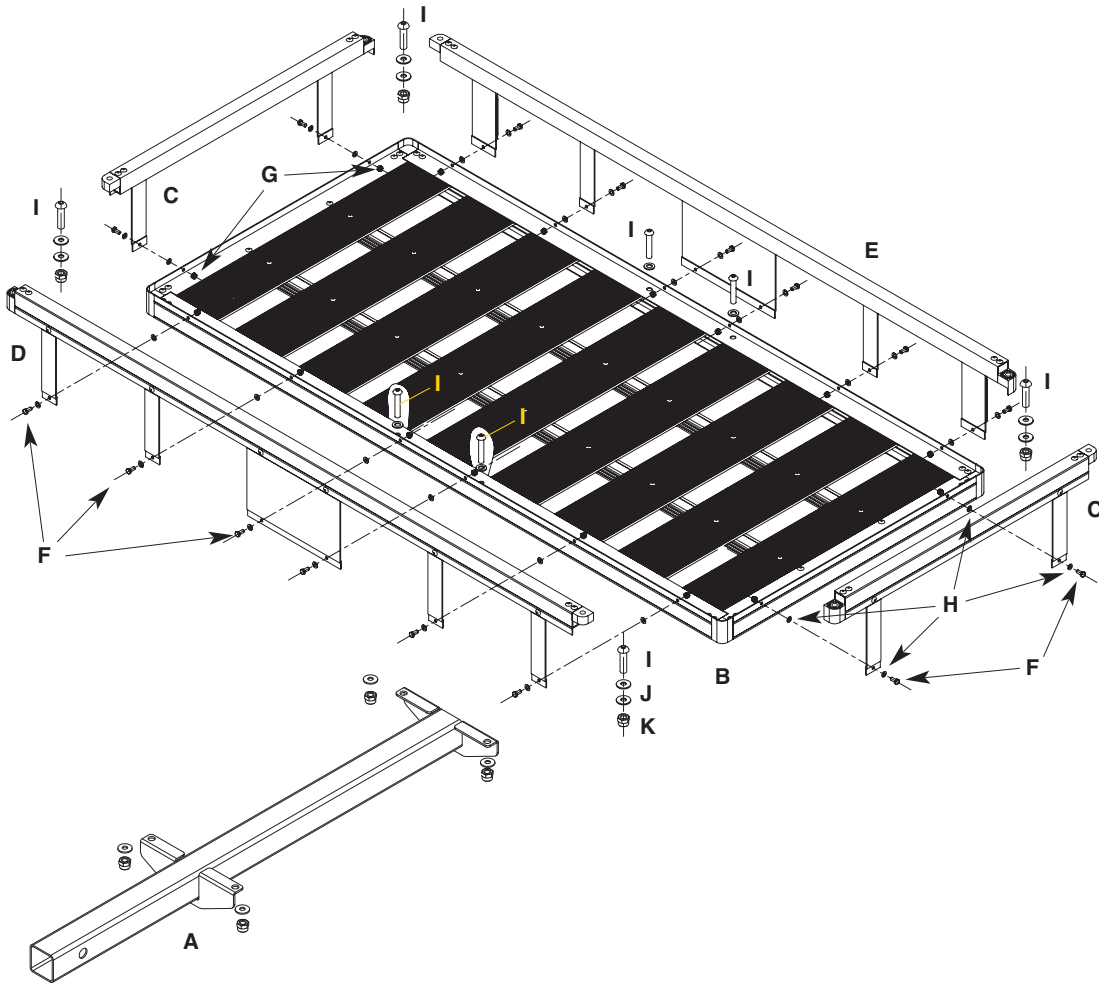

**PARTS LIST:**

- A) 2" Receiver Main Tube - QTY 1
- B) Cargo Rack Base - QTY 1
- C) Rack Side Panels - QTY 2
- D) Rack Back Panel - QTY 1
- E) Rack Front Panel - QTY 1
- F) M5 Hex Bolts - QTY 16
- G) M5 Nylock Nuts - QTY 16
- H) M5 Flat Washers - QTY 32
- I) M8 Allen Head Bolts - QTY 8
- J) M8 Flat Washers - QTY 16
- K) M8 Nylock Nuts - QTY 8

Hitch Pin & Cotter Pin - One Each

**REQUIRED TOOLS:**

- Safety Glasses
- 13mm Open Wrench
- 7mm Open Wrenches or Sockets - QTY 2
- 6mm Allen Wrench



**The Trusted Source**

## Cargo Rack Assembly & Installation:

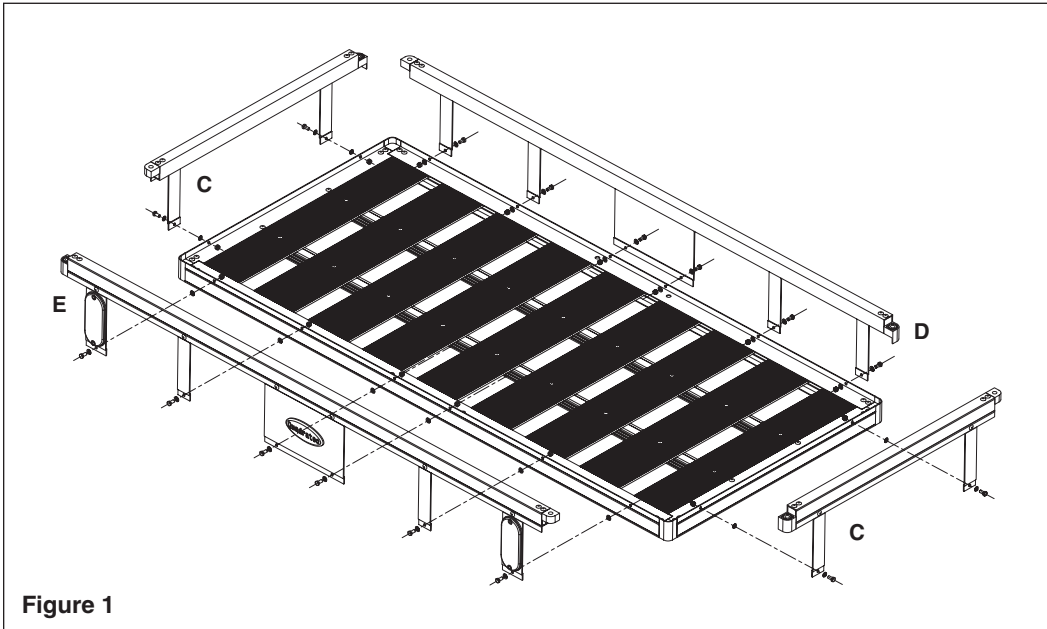

Figure 1

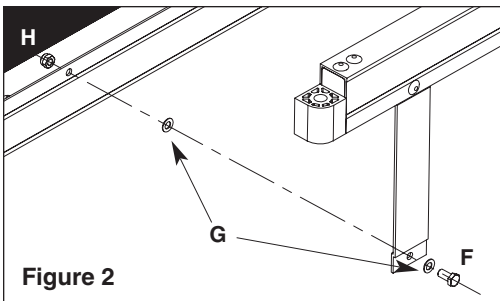

Figure 2

*Put on safety glasses. Lay rack base (B) flat, install the front (E), back (D), side (C) panels using (16) M5 hex bolts, (32) M5 flat washers and (16) M5 locknuts.*

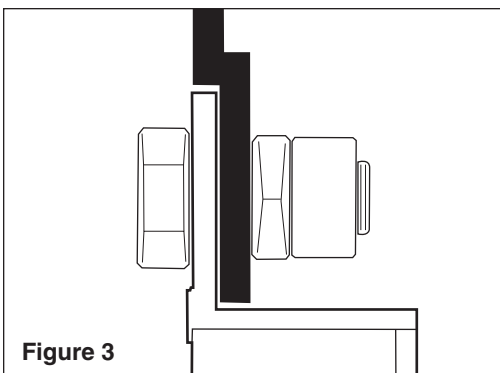

Figure 3

*Be sure all support plates on side panels are placed inside the rails of the rack base, then align all holes and progressively hand-tighten with nuts & bolts.*



**The Trusted Source**

**Cargo Rack Assembly & Installation:**

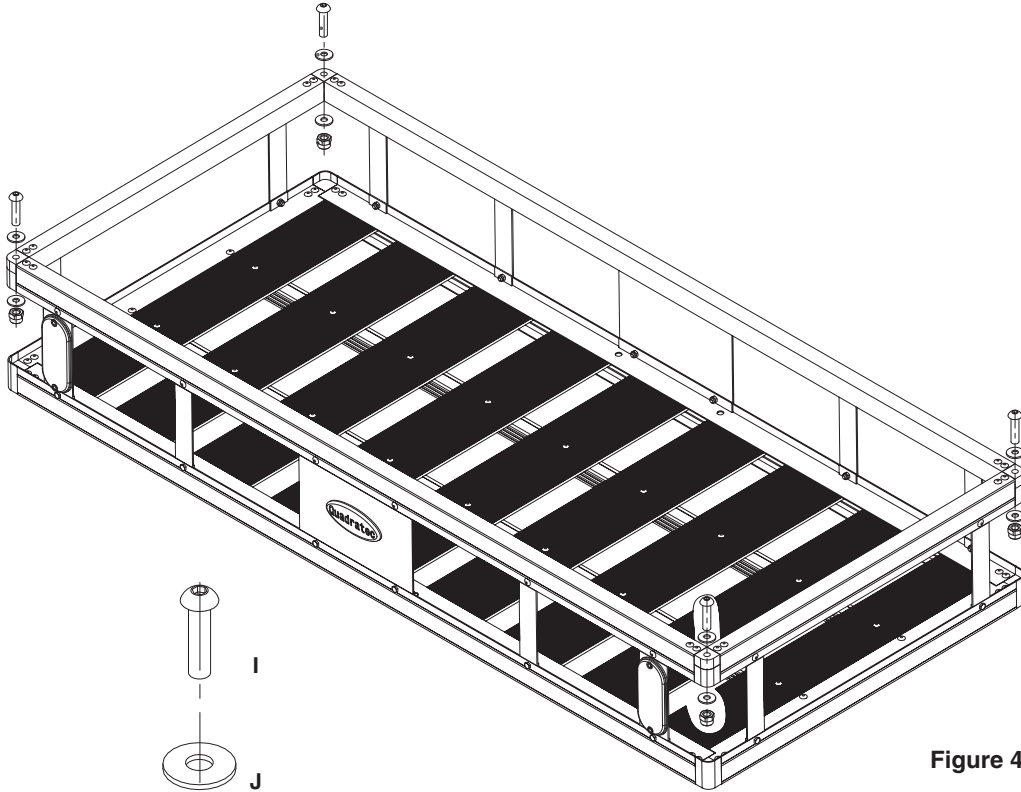

**Figure 4**

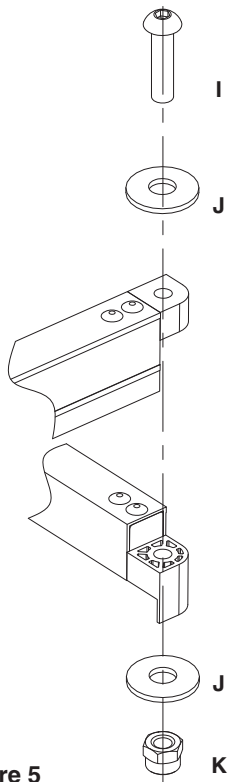

**Figure 5**

*Align holes on gray plastic hinges on the front, back and both side panels.*

*Insert M8 Allen-head bolts (I) in M8 Flat Washers above and below (J), screw M8 locknuts (K) on for positioning.*

*Install M8 bolts, washers and locknuts on the 4 corners of the base rack, and tighten all. See Figure 5 for detail.*



**The Trusted Source**

**Cargo Rack Assembly & Installation:**

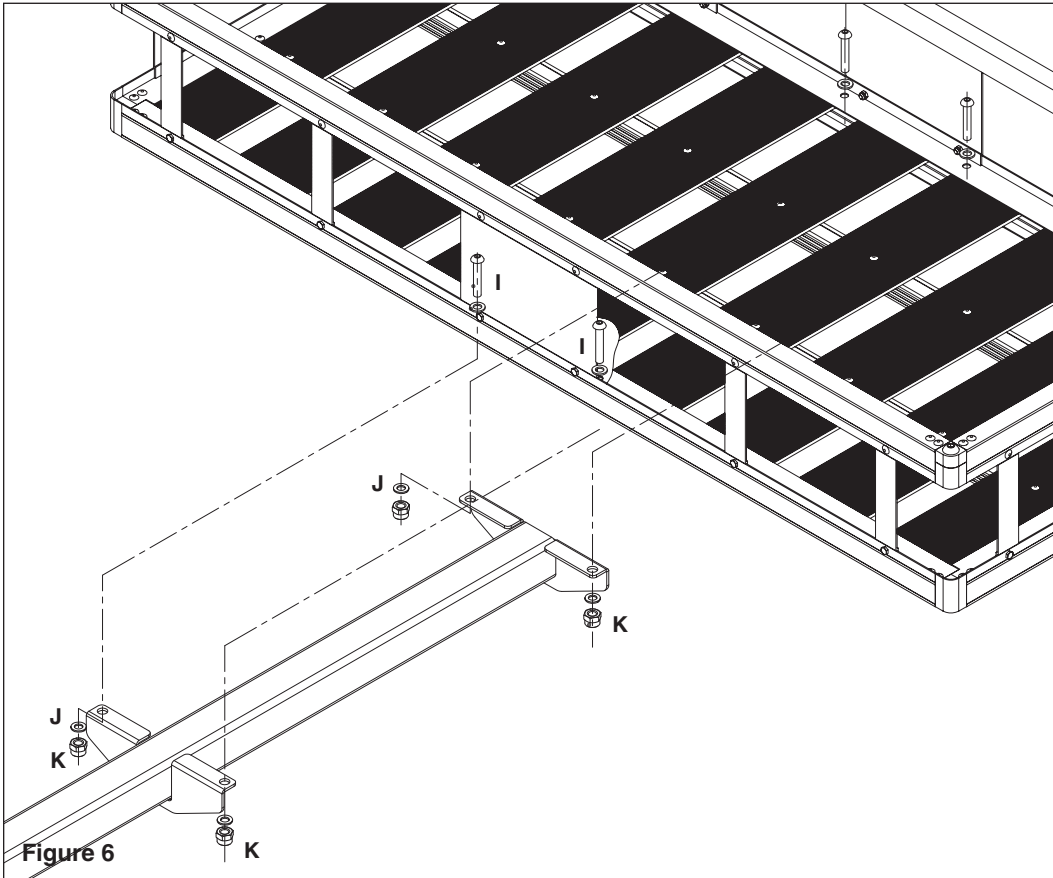

Place the assembled cargo carrier basket onto the 2" support tube (A). Line up the holes and use (4) M8 Allen head

bolts (I), (8) M8 flat washers (J), and (4) M8 locknuts (K) as shown in Figure 6.



**The Trusted Source**

**Cargo Rack Installation:**



*Install the completed rack into your 2" receiver hitch and secure with the supplied 5/8" receiver pin and cotter pin.*



**The Trusted Source**

# Quadratec® Exclusive Three Year Limited Warranty

Your Quadratec® branded accessories are covered by the following **Limited Warranty** provided exclusively by Quadratec, Inc., 1028 Saunders Lane, West Chester PA 19380.

This **Limited Warranty** is the only warranty made in connection with your purchase. Quadratec neither assumes nor authorizes any vendor, retailer or other person or entity to assume for it any other obligation or liability in connection with this product or **Limited Warranty**. This **Limited Warranty** does not apply and is not cumulative to any accessory or part distributed by Quadratec for which the Manufacturer provides a separate written warranty.

**What is Covered:** Subject to the terms, exclusions and limitations herein and with respect only to Quadratec branded accessories first sold in the United States, Quadratec warrants to the initial retail purchaser only that your Quadratec accessory shall be free of defects in material and workmanship: **for a period of three (3) years from date of retail purchase.**

This **Limited Warranty** is not assignable and shall terminate upon sale of the vehicle upon which the Quadratec accessory is installed or other transfer third persons.

All other warranties are hereby disclaimed, except to the extent prohibited by applicable law in which case any implied warranty of merchantability or fitness for a particular purpose on this product is limited to 3 year from date of initial retail sale. Quadratec reserves the rights to: (a.) require invoice or other proof your accessory is within the terms of this **Limited Warranty** as a condition of warranty service and, (b.) make future revisions to this product and **Limited Warranty** without prior notice or obligation to upgrade your product.

**What is Not Covered:**

Your Quadratec **Limited Warranty** does not cover products or parts Quadratec determines to have been damaged by or subjected to:

(a.) installation damage, alteration, modification, combination with other parts, failure to maintain or improper repair or service, (b.) normal wear & tear, cosmetic damage or damage from moisture or water immersion, (c.) Acts of God, accidents, misuse, negligence, inadequate mounting or impact with vehicle(s), obstacles or other aspects of the environment, (d.) theft, vandalism or other intentional damage.

**Remedy Limited to Repair/Replacement:**

**The exclusive remedy provided hereunder shall, upon Quadratec inspection and at Quadratec's option, be either repair or replacement of product or parts (new or refurbished) covered under this Limited Warranty.** Customers requesting warranty consideration should first contact Quadratec to obtain a RGA number (610-701-3336). All labor, removal, shipping and installation costs are customer's responsibility.

**Other Limitations - Exclusion of Damages - Your Rights Under State Law:**

In consideration of the purchase price paid, neither Quadratec nor any independent Quadratec distributor/licensee are responsible for any time loss, rental costs, or for any incidental, consequential, punitive or other damages you may have or incur in connection with any part or product purchased. Your exclusive remedy hereunder for covered parts is repair/replacement as described above.

This **Limited Warranty** gives you specific rights. You may also have other rights that vary from state to state. For example, some states do not allow limitations of how long an implied warranty lasts and /or do not allow the exclusion or limitation of incidental or consequential damages, so the limitations and exclusions herein may not apply to you.

©Quadratec, Inc. 2014. All Rights Reserved.

Instructions Part #12999.3020



**The Trusted Source**