



CFE PRODUCTS

MODEL # JK- 6.5CFG15

Jeep 2015 & up JK Wrangler KICKER Premium
" PLUG & PLAY " Upgrade Speaker System

Sound Bar Installation Instructions

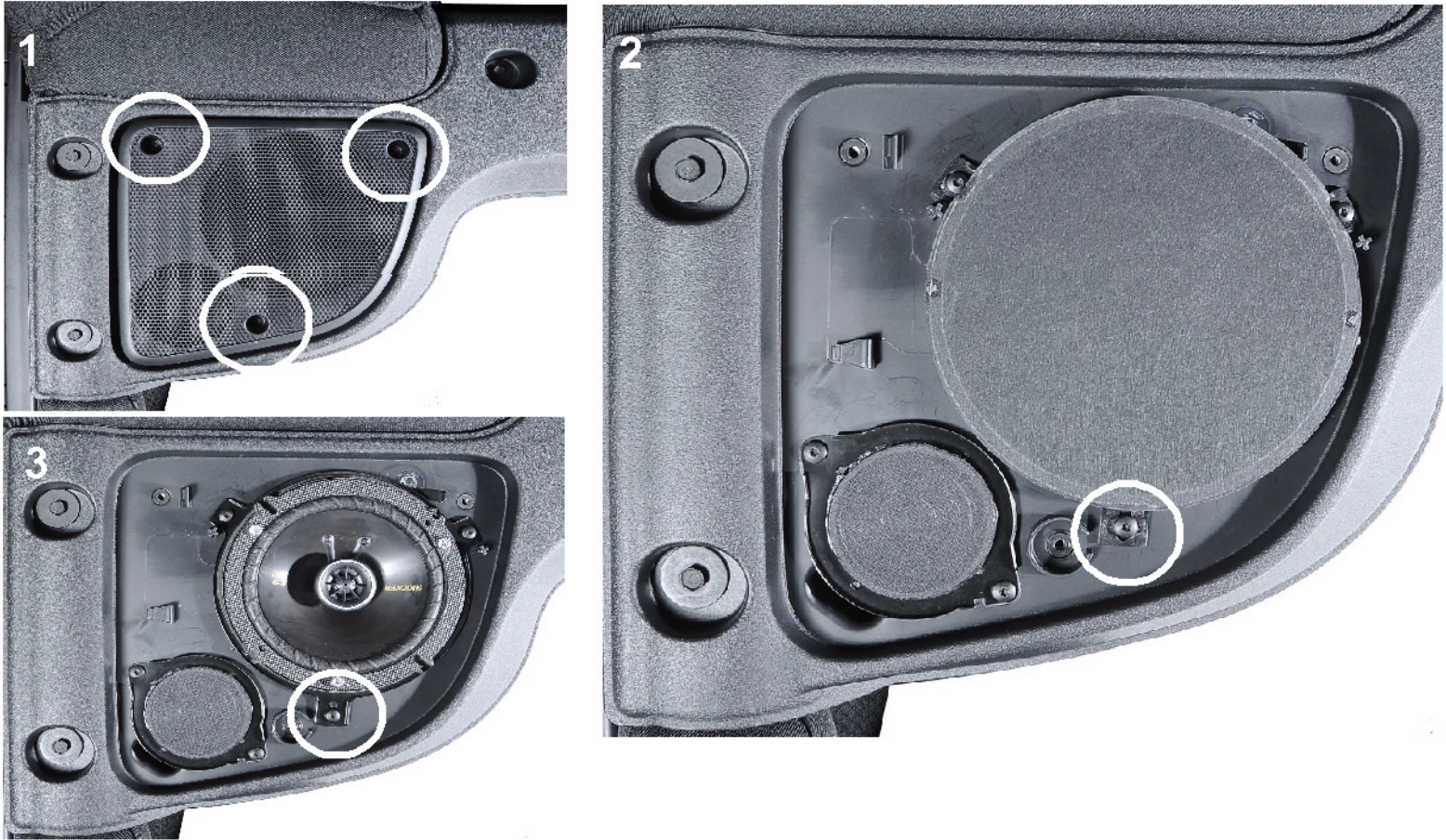

1. The Kicker Upgrade Speaker System is designed to be used with the Original Factory Grills only. This gives your Jeep an O.E. look and provides maximum protection for the speakers. The speakers were shipped with the Kicker grills, which was only done to protect the speakers in shipping and can not be used in this installation.
2. Using a #15 Torx Wrench remove 3 screws and the speaker grill shown in picture #1.
3. Using a #15 Torx Wrench remove the factory speaker and disconnect the plug. Pay attention to the mounting tabs on the speaker. One tab that is longer than the other two as noted in picture #2. Reconnect plug. When you install the New Speaker, make sure the long tab on the New Speaker is installed in the same position as shown in picture #3.