



# INSTALLATION INSTRUCTIONS

## JEEP WRANGLER TJ

### POCKET STYLE FLARE SET NUMBER 10908-07

#### TOOLS REQUIRED FOR INSTALLATION:

- #2 Phillips Bit
- 5/16" Wrench
- 5/16" Socket
- 7/16" Wrench
- 7/16" Socket
- Socket Driver

### FLARE INSTALLATION PROCEDURES

#### Step 1: Painting (Optional)

- It is recommended that painting be done prior to installation.
- Clean outer surface with a high-grade degreaser. **DO NOT USE LACQUER THINNER OR ENAMEL REDUCER AS A DEGREASER.** Wipe outer surface thoroughly with a tack rag prior to painting.
- Paint flares with a polypropylene primer, and let the primer flash.
- Paint flares with a high build primer.
- Color coat must have a flex additive to prevent paint cracking.**
- Paint flares using a high quality lacquer, enamel, or polyurethane automotive paint and clear coat.

#### Step 2: Preparing the Work Area (Front and Rear)

- Remove the rear wheel well skirting. Using a pry bar or claw hammer to release the Christmas tree fasteners. Save for re-installation.
- Remove the marker light from the front fender flare.
- Remove the factory fender flares and stone guards.

#### Step 3: Edge Trim Installation (See Illustration #1)

- Peel two to three inches of red vinyl backing away from edge trim tape and affix to outer edge of flare at one end.
- Press edge trim into place along edge of flare in one-foot increments, pulling red vinyl backing free as you continue to work your way around the flare. Repeat steps 3A and 3B for remaining flares.

#### Step 4: Flare and Stone Guard Installation

- For the Front Flare, place a supplied washer on a supplied screw and place screw through hole in pocket. Place a 3/8" thick spacer on the screw from the back side of the pocket.
- Holding the flare into position on the fender, insert the screws through the factory holes in the fender with the supplied screws. Start a supplied nut on screw but do not tighten until all screws have been installed. **Use caution:** Do not over tighten the screws. Over tightening will not allow the flare to expand and contract with temperature changes after the flare is installed.
- Install the marker light into the pocket formed in the flare.
- Fasten the stone guard to the vehicle with the factory screws that were previously removed.
- For the **Rear Flare**, repeat steps (A) and (B). Use the supplied nuts in the positions that do not have a threaded insert in the vehicle body.

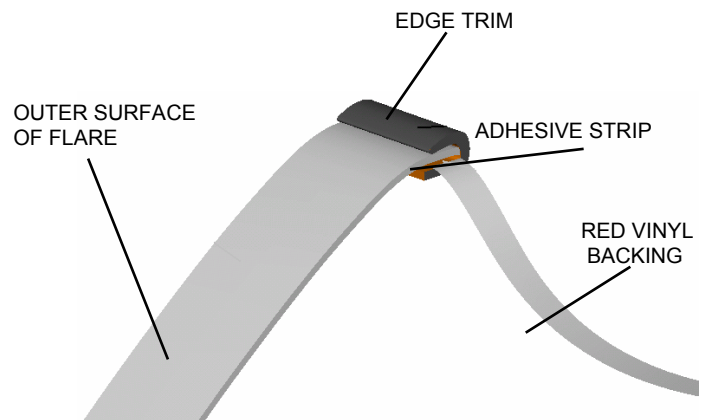

ILLUSTRATION #1

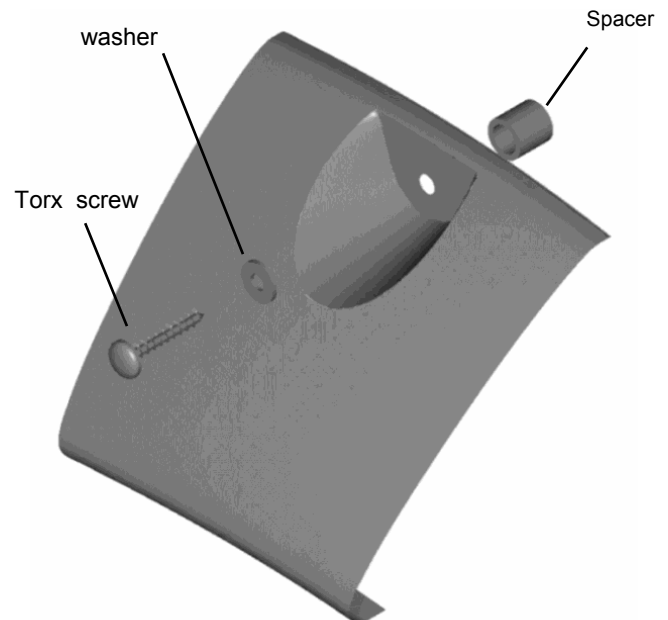

ILLUSTRATION #2