



Thank you for purchasing a Borla Performance Stainless Steel Header.

Precision manufactured using aircraft quality T-304 stainless steel; this header is designed to endure years of heavy use. Installing the Borla Performance Stainless Steel Header on your vehicle will eliminate the restrictive design of the stock exhaust manifolds, allowing your engine to discharge exhaust gas easier. The result is more horsepower and torque and longer engine life, with easy bolt-on installation. These installation instructions have been written to help you in the installation of your Borla Performance Stainless Steel Header. Please read it completely before attempting installation.

This Borla Performance Stainless Steel Header (Part number 17202) has been designed for the 2000-2006 Jeep Wrangler equipped with the 4.0L engine and automatic or standard transmissions.

Borla Performance Industries recommends that an exhaust shop or professional after market parts installer, who has all the necessary equipment, tools and experienced personnel needed for proper installation, should perform the installation of this system. However, if you decide to perform the installation, we recommend someone should help you. Ensure the installer uses all under car safety precautions including eye protection.

Please take time to read and understand the following...

By installing your Borla Performance Stainless Steel Header, you indicate that you have read this document and you agree with the terms stated below.

It is the responsibility of the purchaser to follow all installation instruction guidelines and safety procedures supplied with your Borla Performance Stainless Steel Header.

Borla Performance Industries assumes no responsibility for damages occurring from misuse, abuse, improper installation, improper operation, lack of responsible care, or all previously stated reasons resulting from incompatibility with other manufacturer's products and/or systems.

Included with your Borla Performance Stainless Steel Header is a warranty card. Please read it carefully before you begin any work on your vehicle. If you should have any questions regarding our warranty policy, installation, or any other matter pertaining to your new Borla performance Stainless Steel Header, please give us a call at the number provided on the warranty card.

Borla Performance Stainless Steel Header Bill of Materials

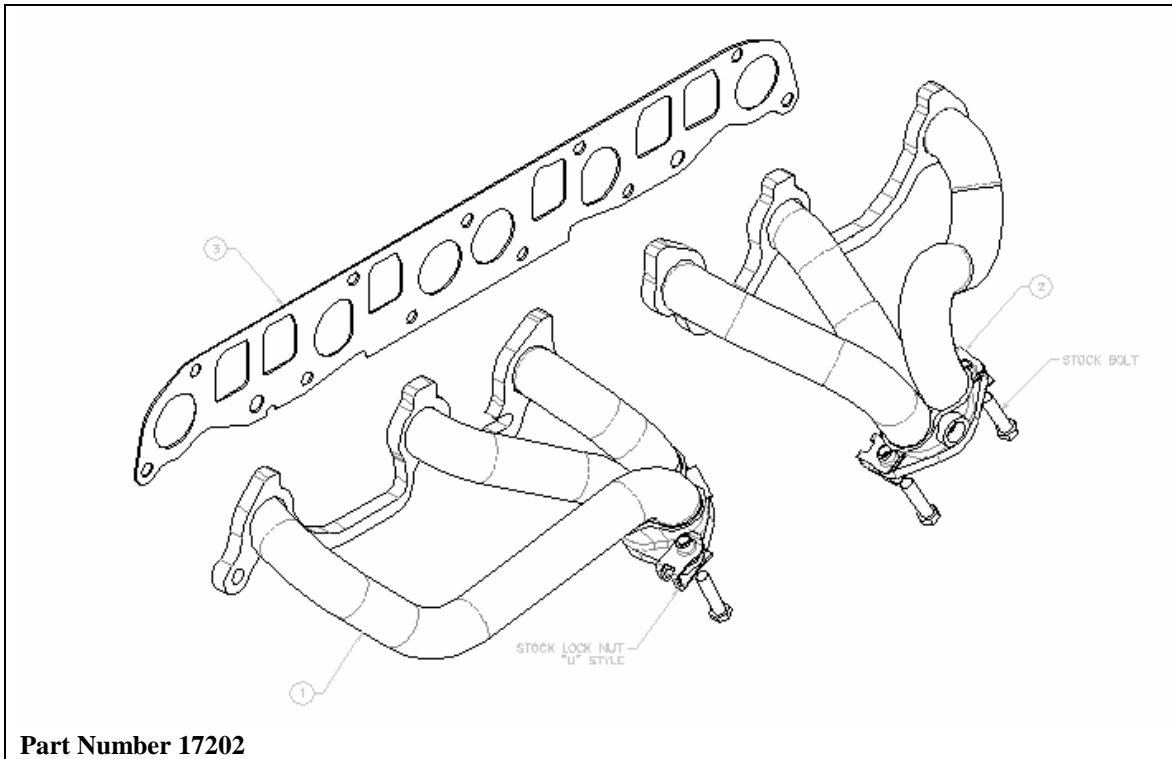

1. Front header assembly
2. Rear header assembly
3. Header gasket

Caution!!! Never work on a hot exhaust system. Serious injury in the form of burns can result If the vehicle has been in use and the exhaust system is hot, allow vehicle to cool for at least 1 hour. Always wear eye protection when working underneath any vehicle.

Note: It is our recommendation that you use a hoist or hydraulic lift to facilitate the installation of your new Borla Performance Stainless Steel Header.

Note: Before removing the original exhaust manifolds from your vehicle, please compare the parts you have received with the bill of materials provided on the previous page to assure that you have all the parts necessary for the installation of your new Borla Performance™ Stainless Steel Header.

Original Exhaust Manifold Removal

Note: With a used vehicle, we suggest a penetrating spray lubricant to be applied liberally to all exhaust fasteners and allowing a significant period of time for the chemical to lubricate the threads before attempting to disassemble.

1. Disconnect battery by removing negative cable from the battery terminal.
2. Remove air intake tube from vehicle as shown in figure 1.
3. Unbolt and remove the driver side hood support.
4. Disconnect all sensors and vacuum hoses from the intake manifold as shown in figure 2 and also remove the hose from the power brake booster.



Figure 1



Figure 2

5. Disconnect all cables from the throttle body linkage shown in figure 3 and unbolt the cable bracket from the intake manifold and set aside out of the way.
6. Unbolt wiring harness attached to intake manifold.
7. Disconnect oxygen sensor wiring from the front and rear of the wiring harness as shown in figure 4.



Figure 3

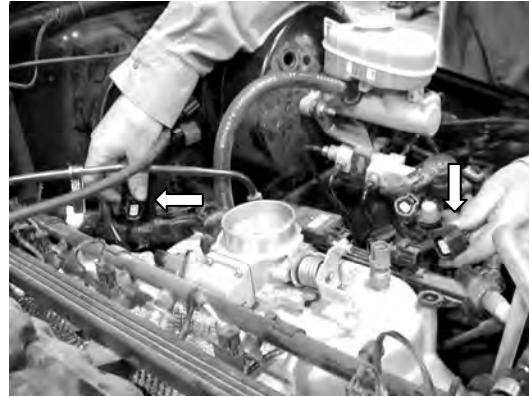

Figure 4

8. Loosen the belt tensioner and remove serpentine belt.
9. Unbolt and remove power steering pump assembly from intake manifold and set aside.
10. Disconnect the electrical plugs from the fuel injectors and unbolt fuel line attached on the side of the intake manifold.
11. Unbolt the fuel rail from the intake manifold and move it out of the way with the fuel injectors attached as shown 5. Some fuel injector o-rings may remain in the ports. Make sure to remove them and install them back on to the fuel injectors. Cover fuel rail and injectors with a plastic bag to prevent them from becoming contaminated.
12. Remove fuel injector wiring harness off of the studs and remove heat shield.
13. Remove exhaust/intake manifold bolts. Some may be more accessible from under the vehicle.
14. Once all the bolts have been removed, lift the intake manifold out as shown in figure 6. There is very little room so be patient and work it out paying attention not to damage the air conditioning hoses.



Figure 5

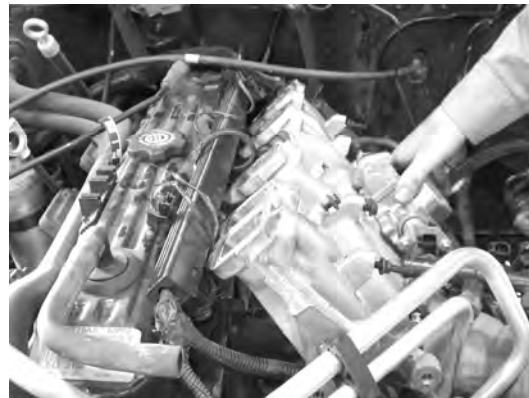

Figure 6

15. Taking all under car safety precautions, lift the vehicle using a hoist or hydraulic lift.
16. Unbolt the bottom flanges of exhaust manifolds shown in figure 7 connecting them to the remaining exhaust. Place the hardware to the side for use during the installation of your new headers.
17. Carefully lower the vehicle.
18. Remove manifolds from the vehicle as shown in figure 8.



Figure 7

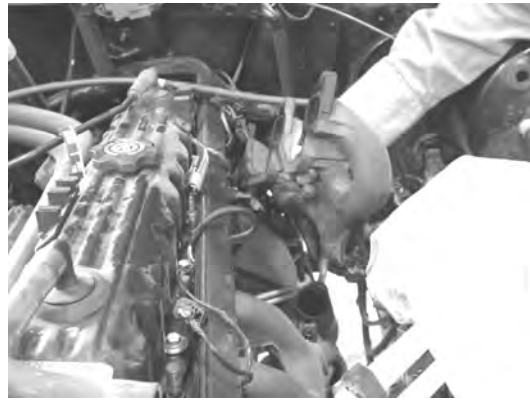

Figure 8

19. Remove oxygen sensors from the exhaust manifolds and the clip on bolts shown in figure 9. Set them to the side for use during the installation of your new headers.



Figure 9

Borla Performance Stainless Steel Header Installation

Warning: Use extreme caution during installation. Torque all fasteners according to manufacturer's torque values and tightening sequence. **DO NOT** use air impact tools to tighten fasteners on Borla Performance Stainless Steel Headers. Use of such tools may result in bent flanges or gasket contact areas leading to exhaust leaks.

1. Install oxygen sensors and clip on bolts onto headers.
2. Place the Borla Performance Stainless Steel headers in position as shown in figure 10 using the gasket supplied.
3. Place the intake manifold in position.
4. Install exhaust/intake manifold bolts. Tighten bolts to the vehicle manufacturer recommendations and sequence. Some may be more accessible from under the vehicle.
5. Using the original hardware, secure the flanges connecting the header to the rest of the exhaust to the vehicle manufacturer recommendations.
6. Install power steering pump assembly back into position shown in figure 11 and tighten bolts to the vehicle manufacturer recommendations.



Figure 10



Figure 11

7. Install serpentine belt and tighten belt tensioner.
8. Place heat shield into position and place fuel injector wiring harness back on to the studs.
9. Making sure all the fuel injectors have o-rings, install fuel rail and injectors back into position using the original hardware.
10. Reconnect the electrical plugs to each fuel injector and bolt fuel line shown in figure 12 back into place on the side of the intake manifold
11. Install cable bracket back on to the intake manifold. Connect all cables previously removed to the throttle body linkage
12. Reconnect all wiring to sensors and vacuum hoses.
13. Using the original hardware, install driver side hood support into position as shown in figure 13.
14. Install air intake hose.



Figure 12



Figure 13

15. Reconnect vehicles battery.
16. Before starting your vehicle, make sure to check all wires and hoses for safe clearance from the headers.
17. Start vehicle and check for any leaks. If any leaks are found, determine cause (such as loose hardware or incorrectly positioned gasket) and repair as necessary.

Note: When you first start your vehicle after the installation of your new Borla Performance Stainless Steel Header, there may be some smoke and fumes coming from the Header. This is a protective oil based coating used in the manufacturing of mandrel bent performance exhaust tubing. This is not a problem and will disappear within a very short period of time after the Header has reached normal operating temperatures.

Congratulations!!! You have completed the installation of the world famous Borla Performance Stainless Steel Header.