



advanced FLOW engineering BladeRunner – Charge Pipe Combo Kit

Instruction Manual P/N: 46-20724-B

Make: Toyota	Model: Land Cruiser (J250)	Year: 2024-2026	Engine: L4-2.4L (t) Hybrid
Make: Toyota	Model: Tacoma	Year: 2024-2026	Engine: L4-2.4L (t)
Make: Toyota	Model: Tacoma	Year: 2024-2026	Engine: L4-2.4L (t) Hybrid
Make: Toyota	Model: 4Runner	Year: 2025-2026	Engine: L4-2.4L (t)
Make: Toyota	Model: 4Runner	Year: 2025-2026	Engine: L4-2.4L (t) Hybrid



- Please read the entire instruction manual before proceeding.
- Ensure all components listed are present.
- For technical support please call 951-493-7185.
- Ensure you have all necessary tools before proceeding.
- Do not attempt to work on your vehicle when the engine is hot.
- Retain factory parts for future use.

Label	Qty.	UoM	Description	Part Number
A	1	Ea.	Tube, Hot Side ENG: 46-20728-B	05-61510B-1
B	1	Ea.	Tube, Hot Side IC: 46-20728-B	05-61510B-2
C	1	Ea.	Tube, Cold Side ENG: 46-20729-B	05-61511B-1
D	1	Ea.	Tube, Cold Side IC: 46-20729-B	05-61511B-2
E	1	Ea.	Coupling, Silicone Hump: 2.50"ID x 4"L	05-60439
F	1	Ea.	Coupling, Silicone Hump: 3"ID x 4"L	05-60012
G	2	Ea.	Clamp, SmartSeal, 044 (2.50" – 3.06")	03-50656
H	2	Ea.	Clamp, SmartSeal, 052 (2.88" – 3.56")	03-50786
J	2	Ea.	O-Ring, 55mm ID x 2.5mm W	05-61150
K	2	Ea.	O-Ring, 60mm ID x 4mm W	05-60615
M	2	Ea.	Plug, Hex Hd Socket: 1/8" NPT (Zn Plt)	03-50029

Installation will require the following tools:

8mm, 10mm sockets , 3/16" allen, ratchet, flat screwdriver, pick, teflon tape.

Warranty Information available at <https://afepower.com/contact#warranty>

Emissions Disclaimer: This product is not currently CARB exempt and is not available for purchase in California or for use on any vehicle registered with the California Department of Motor Vehicles.

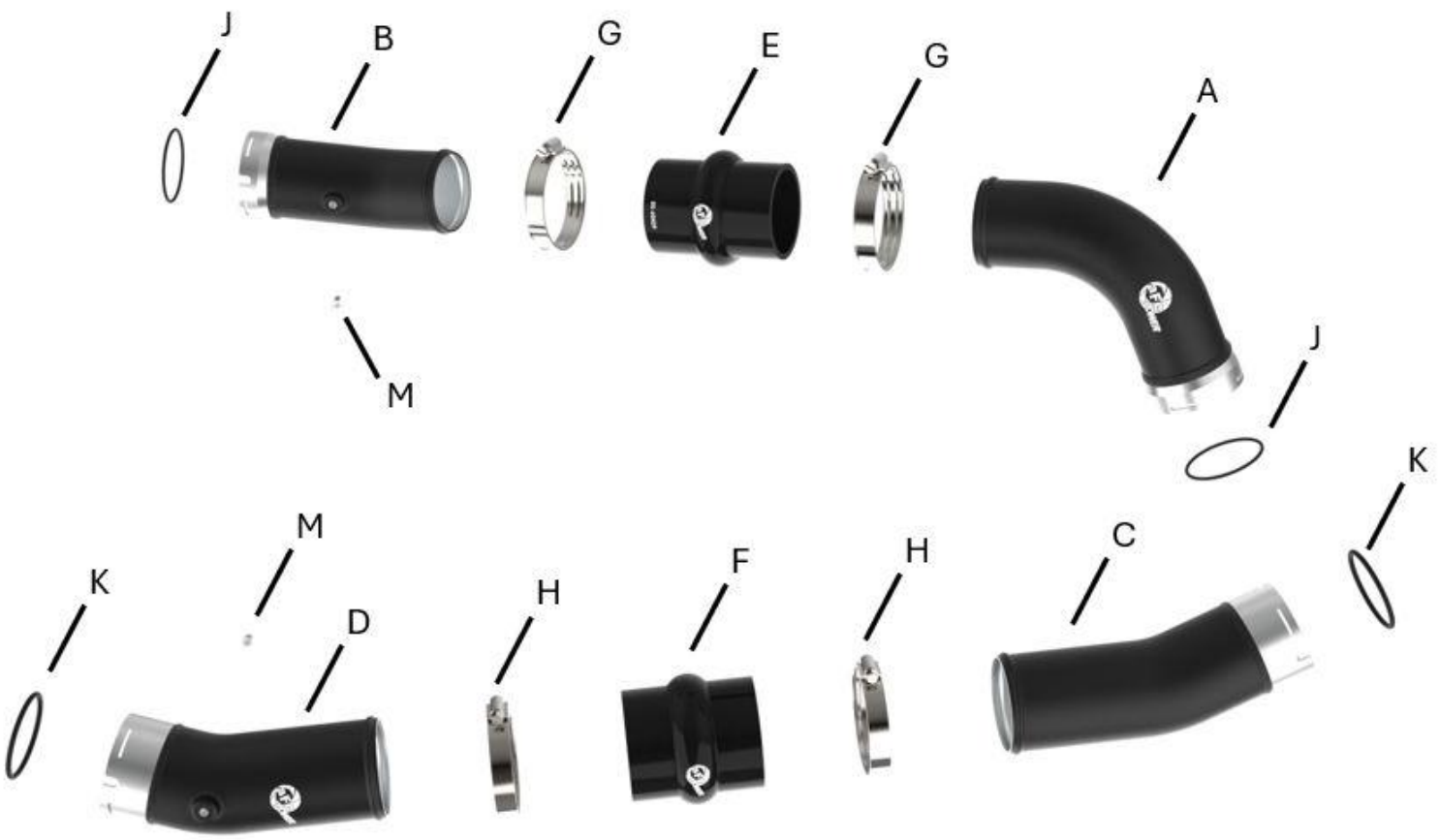

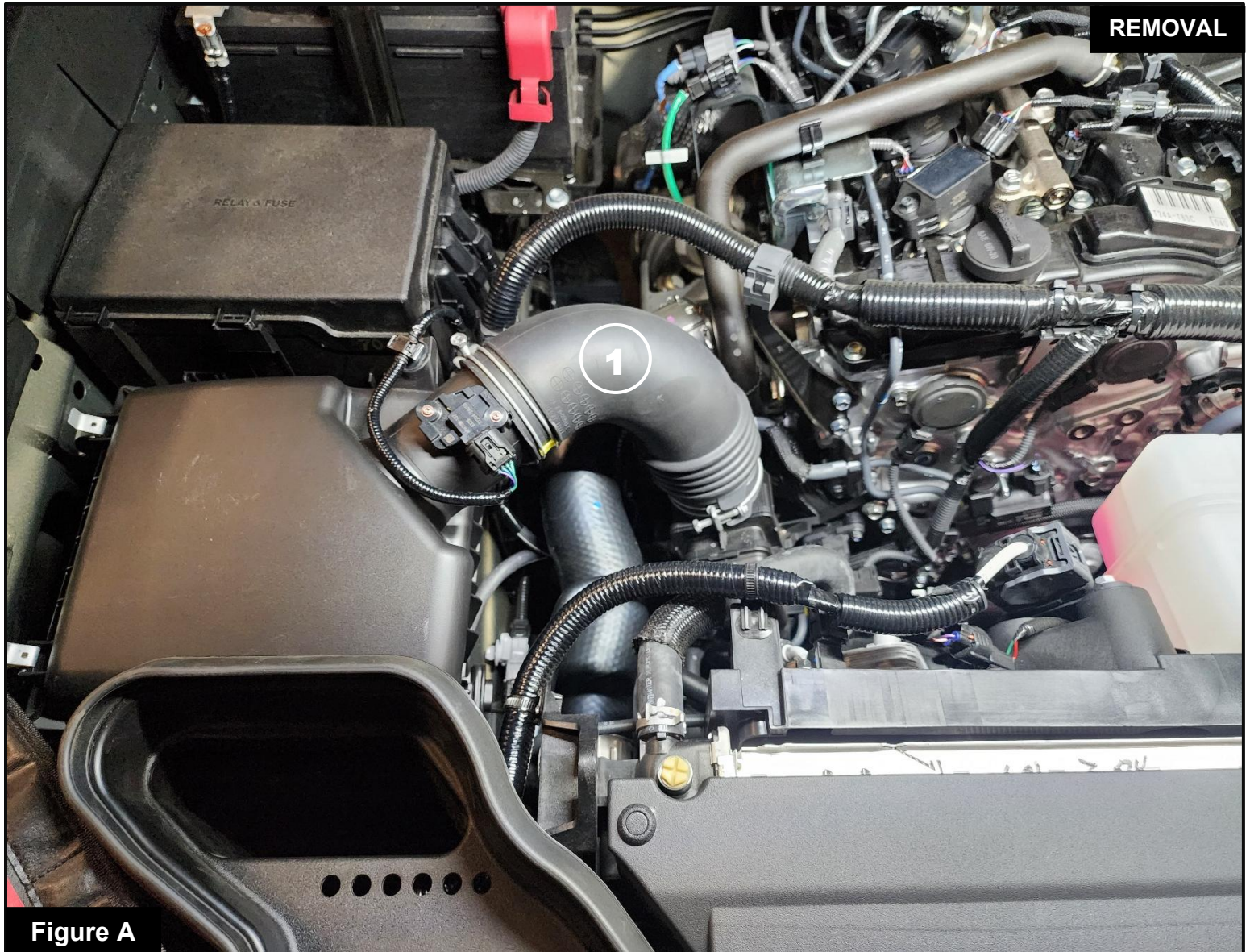

Figure A

Refer to Figure A for Steps 1-3

Step 1: Disconnect the negative battery cable.

Step 2: Loosen the clamps securing the air intake tube to the air box and turbo inlet (1).

Step 3: Remove the air intake tube from the vehicle.

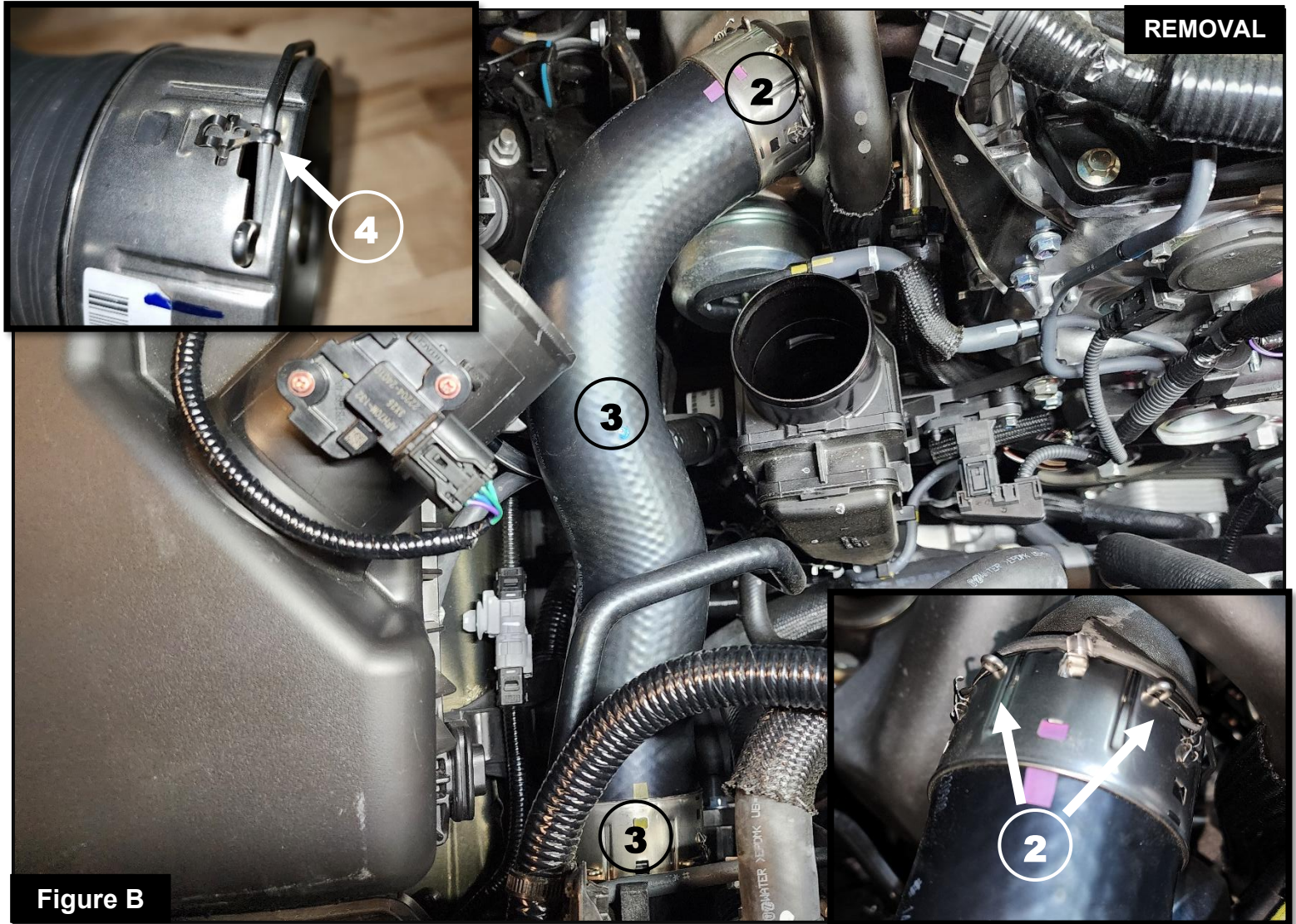

Figure B

Refer to Figure B for Steps 4-6

Step 4: Expand the retaining clip securing the hot side charge pipe onto the turbo outlet, then disconnect it from the turbo (2)

Step 5: Expand the retaining clip securing the hot side charge pipe onto the intercooler inlet (3) then remove the hot side charge pipe from the vehicle.

Step 6: Remove the factory retaining clips from the hot side charge pipe (4) Do this by gently lifting the tabs up on each side and sliding the clips out of the slots, set aside for later use.

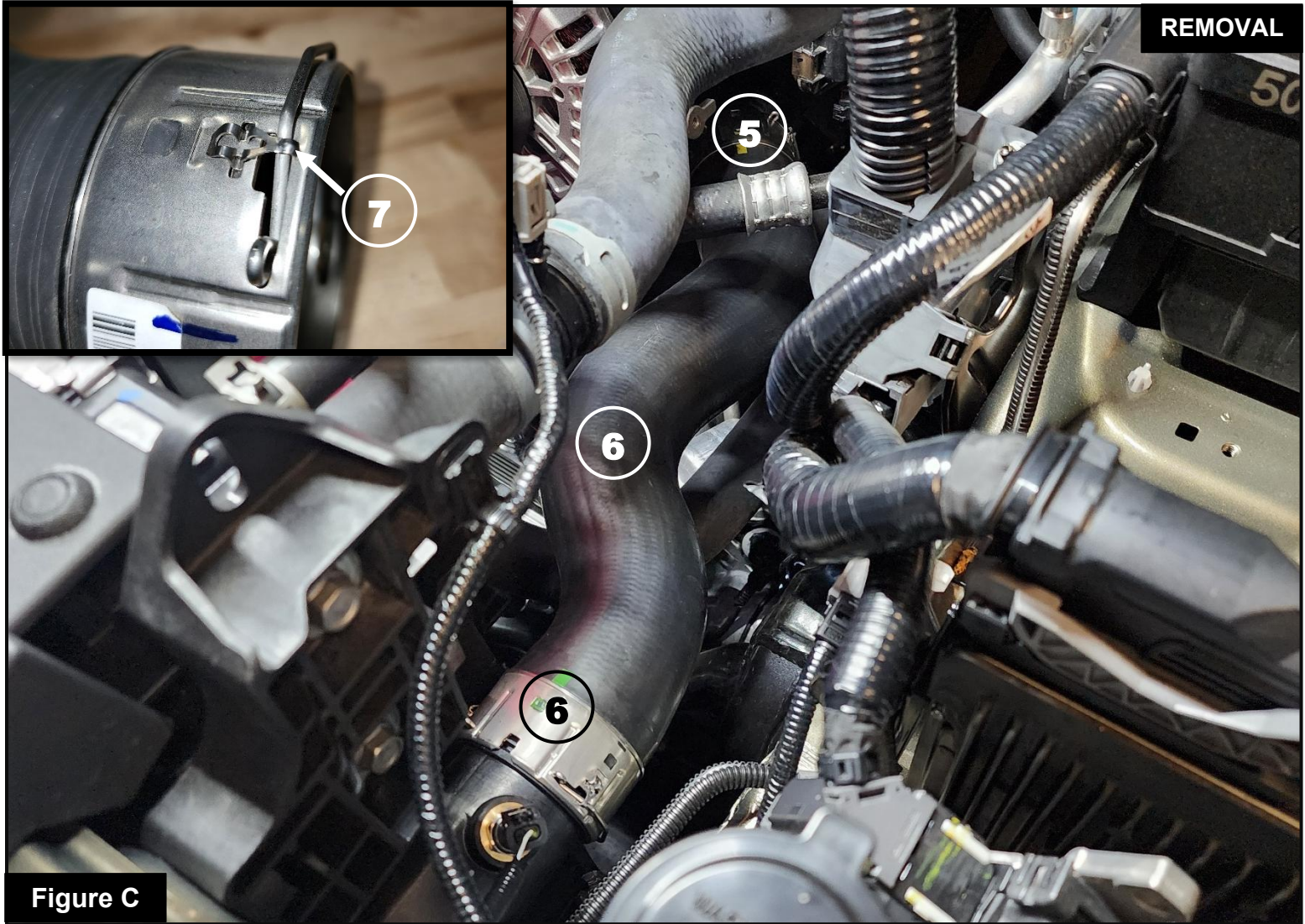

REMOVAL

Figure C

Refer to Figure C for Steps 7-9

Step 7: Expand the retaining clip securing the cold side charge pipe onto the throttle body, then disconnect it from the throttle body (5).

Step 8: Expand the retaining clip securing the cold side charge pipe onto the intercooler outlet, then remove the charge pipe from the vehicle (6).

Step 9: Remove the factory retaining clips from the cold side charge pipe (7). Do this by gently lifting the tabs up on each side and sliding the clips out of the slots, set aside for later use.

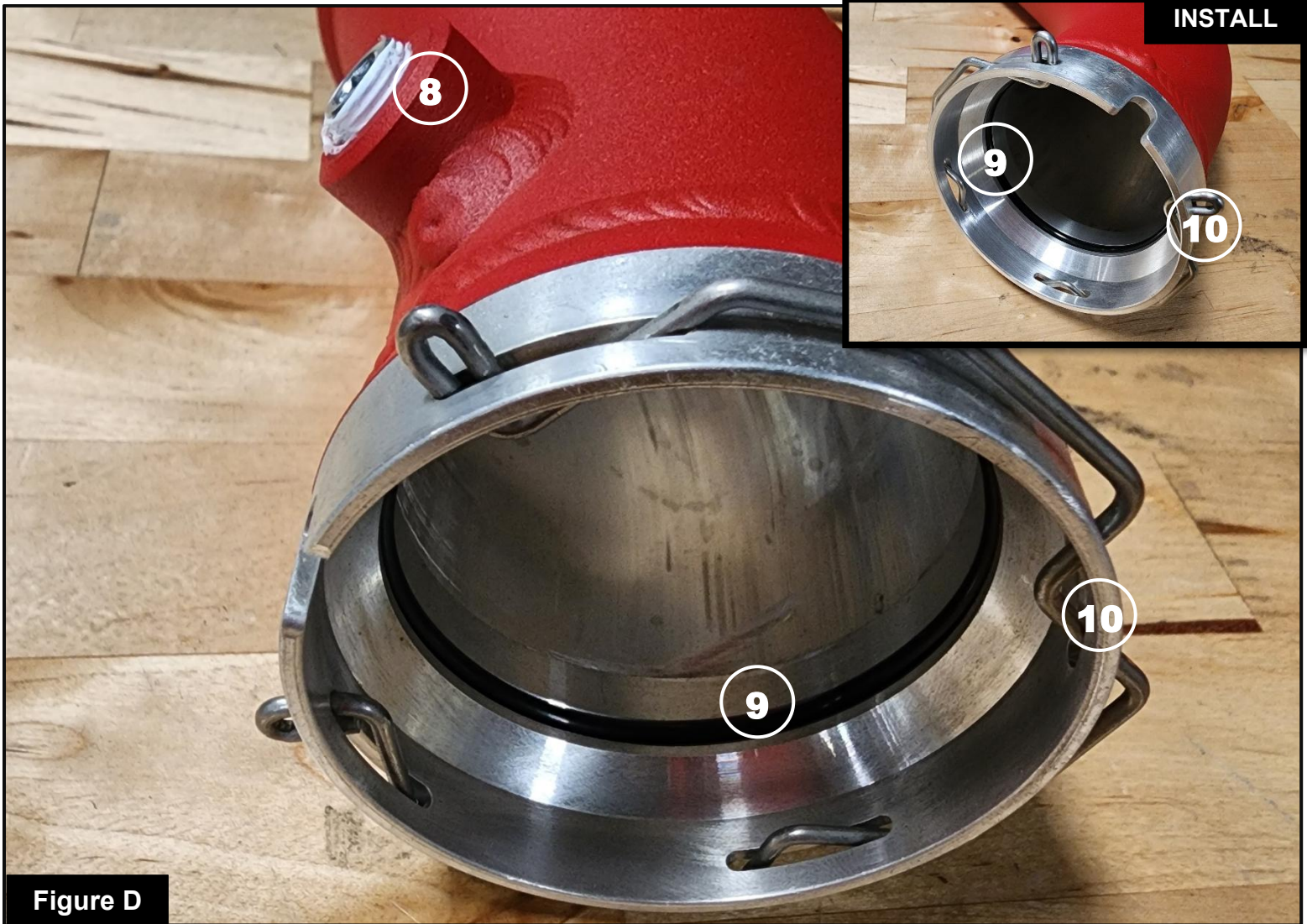

Figure D

Refer to Figure D for Steps 10-12

Note: Be sure to use thread sealant on the plug or sensor to prevent any leaking.

Step 10: If you are not using any aftermarket sensors, install the supplied 1/8" NPT plug into the threaded fitting on the aFe POWER IC hot side charge pipe (8.)

Note: Be sure to lubricate the O-rings with grease to prevent tearing during installation.

Step 11: Install the 55mm ID x 2.5mm W O-rings into the groove on the inside of each aFe POWER hot side charge pipe (9.)

Step 12: Install the factory retaining clips from Step 6 onto each aFe POWER hot side charge pipe (10)

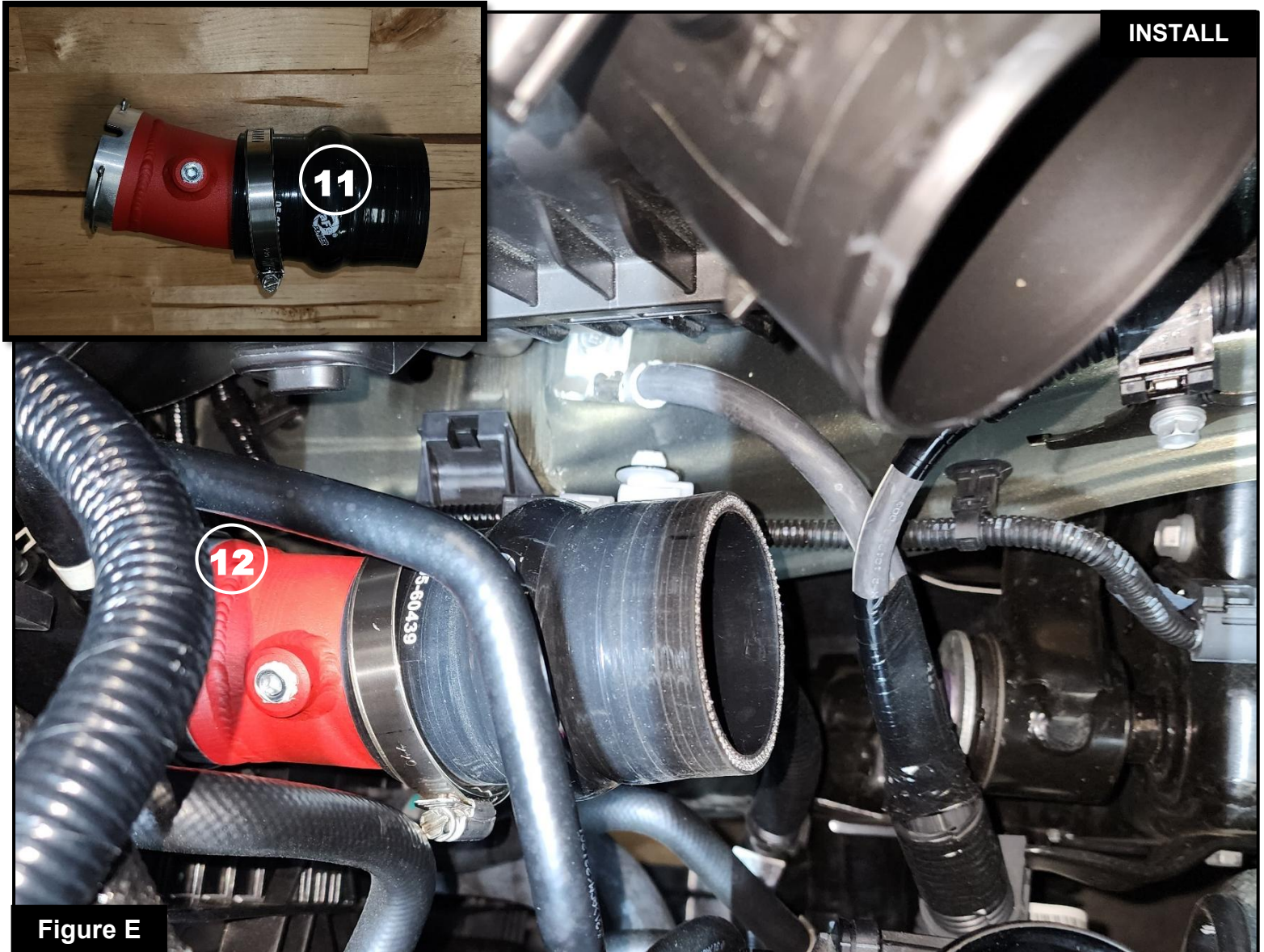

Figure E

Refer to Figure E for Steps 13-14

Step 13: Install the 2.50"ID x 4"L silicone hump coupling onto the aFe POWER IC hot side charge pipe along with one 044 SmartSeal clamp (11)

Step 14: Install the aFe POWER IC hot side charge pipe with coupling onto the intercooler inlet, and ensure the retaining clip snaps into place all the way around (12)

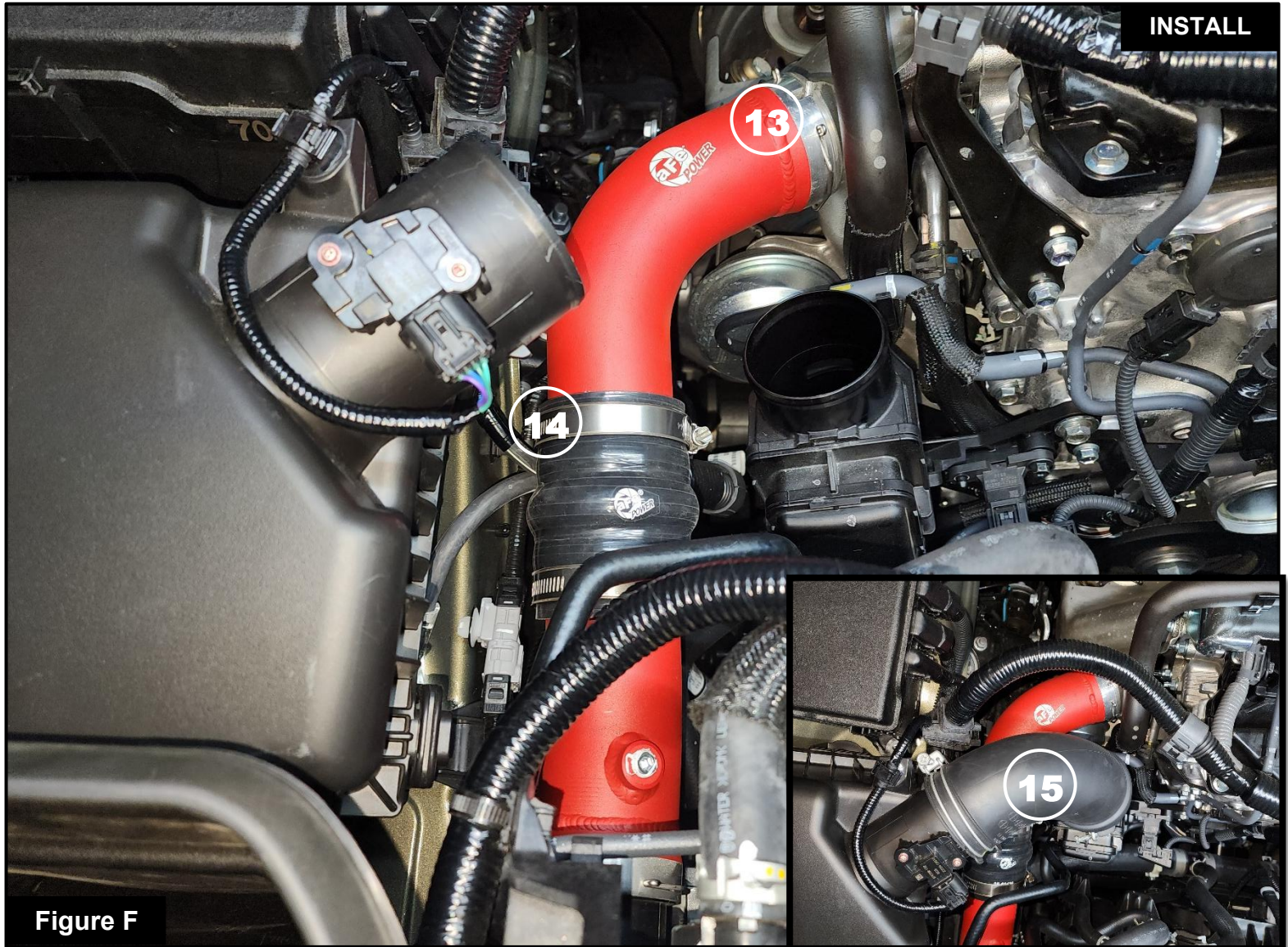

Figure F

Refer to Figure F for Steps 15-18

Step 15: Install the aFe POWER ENG hot side charge pipe onto the turbo, and ensure the retaining clip snaps into place all the way around (13)

Step 16: Install one 044 SmartSeal clamp onto the aFe POWER ENG hot side charge pipe, then connect the ENG hot side charge pipe to the coupling (14) from Step 13.

Step 17: Adjust and ensure the aFe POWER hot side charge pipes and coupling are not touching anything, then tighten the clamps.

Step 18: Install the air intake tube back into the vehicle (15) then tighten the clamps.

**Figure G****Refer to Figure G for Steps 19-22**

Note: Be sure to use thread sealant on the plug or sensor to prevent any leaking.

Step 19: If you are not using any aftermarket sensors, install the supplied 1/8" NPT plug into the threaded fitting on the aFe POWER IC cold side charge pipe (16)

Note: Be sure to lubricate the O-rings with grease to prevent tearing during installation.

Step 20: Install the 60mm ID x 4mm W O-rings into the groove on the inside of each aFe POWER cold side charge pipe (17)

Step 21: Install the factory retaining clips from Step 9 onto each aFe POWER cold side charge pipe (18)

Step 22: Install the 3"ID x 4"L silicone hump coupling onto the aFe POWER ENG cold side charge pipe along with one 052 SmartSeal clamp (19)

**Figure H**

Refer to Figure H for Steps 23-28

Step 23: Install the aFe POWER ENG cold side charge pipe with coupling onto the throttle body, and ensure the retaining clip snaps into place all the way around ②0

Step 24: Install the aFe POWER IC cold side charge pipe onto the intercooler outlet, and ensure the retaining clip snaps into place all the way around ②1

Step 25: Install one 052 SmartSeal clamp onto the aFe POWER IC cold side charge pipe, then connect the IC cold side charge pipe to the coupling ②2 from Step 22.

Step 26: Adjust and ensure the aFe POWER cold side charge pipes and coupling are not touching anything, then tighten the clamps.

Step 27: Reconnect the negative battery cable.

Step 28: Install is now complete.

NOTE: Check all clamps, and connectors are secure after 100-200 miles

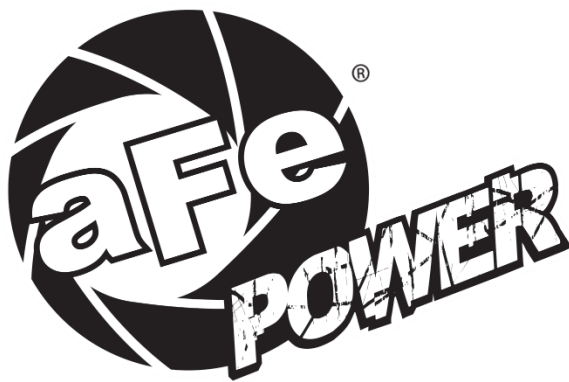

advanced FLOW engineering, inc.

Corona, CA 92879

<https://afepower.com/contact>