



advanced FLOW engineering BladeRunner – Cold Side Charge Pipe Kit

Instruction Manual P/N: 46-20729-B

Make: Toyota	Model: Land Cruiser (J250)	Year: 2024-2026	Engine: L4-2.4L (t) Hybrid
Make: Toyota	Model: Tacoma	Year: 2024-2026	Engine: L4-2.4L (t)
Make: Toyota	Model: Tacoma	Year: 2024-2026	Engine: L4-2.4L (t) Hybrid
Make: Toyota	Model: 4Runner	Year: 2025-2026	Engine: L4-2.4L (t)
Make: Toyota	Model: 4Runner	Year: 2025-2026	Engine: L4-2.4L (t) Hybrid



- Please read the entire instruction manual before proceeding.
- Ensure all components listed are present.
- For technical support please call 951-493-7185.
- Ensure you have all necessary tools before proceeding.
- Do not attempt to work on your vehicle when the engine is hot.
- Retain factory parts for future use.

Label	Qty.	UoM	Description	Part Number
A	1	Ea.	Tube, Cold Side ENG: 46-20729-B	05-61511B-1
B	1	Ea.	Tube, Cold Side IC: 46-20729-B	05-61511B-2
C	1	Ea.	Coupling, Silicone Hump: 3"ID x 4"L	05-60012
D	2	Ea.	Clamp, SmartSeal, 052 (2.88" – 3.56")	03-50786
E	2	Ea.	O-Ring, 60mm ID x 4mm W	05-60615
F	1	Ea.	Plug, Hex Hd Socket: 1/8" NPT (Zn Plt)	03-50029

Installation will require the following tools:

8mm, socket , 3/16" allen, ratchet, flat screwdriver, pick, teflon tape.

Warranty Information available at <https://afepower.com/contact#warranty>

Emissions Disclaimer: This product is not currently CARB exempt and is not available for purchase in California or for use on any vehicle registered with the California Department of Motor Vehicles.

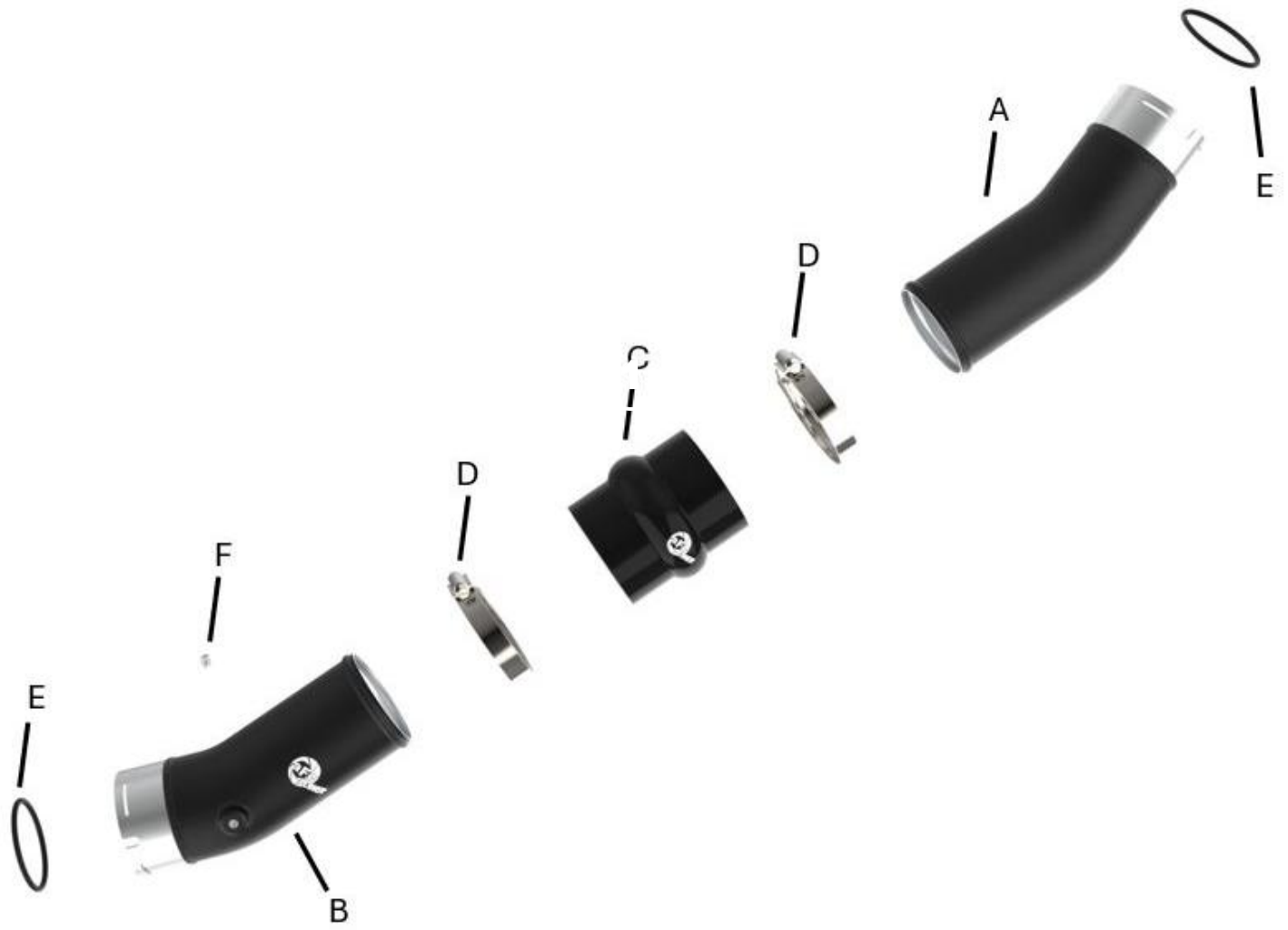

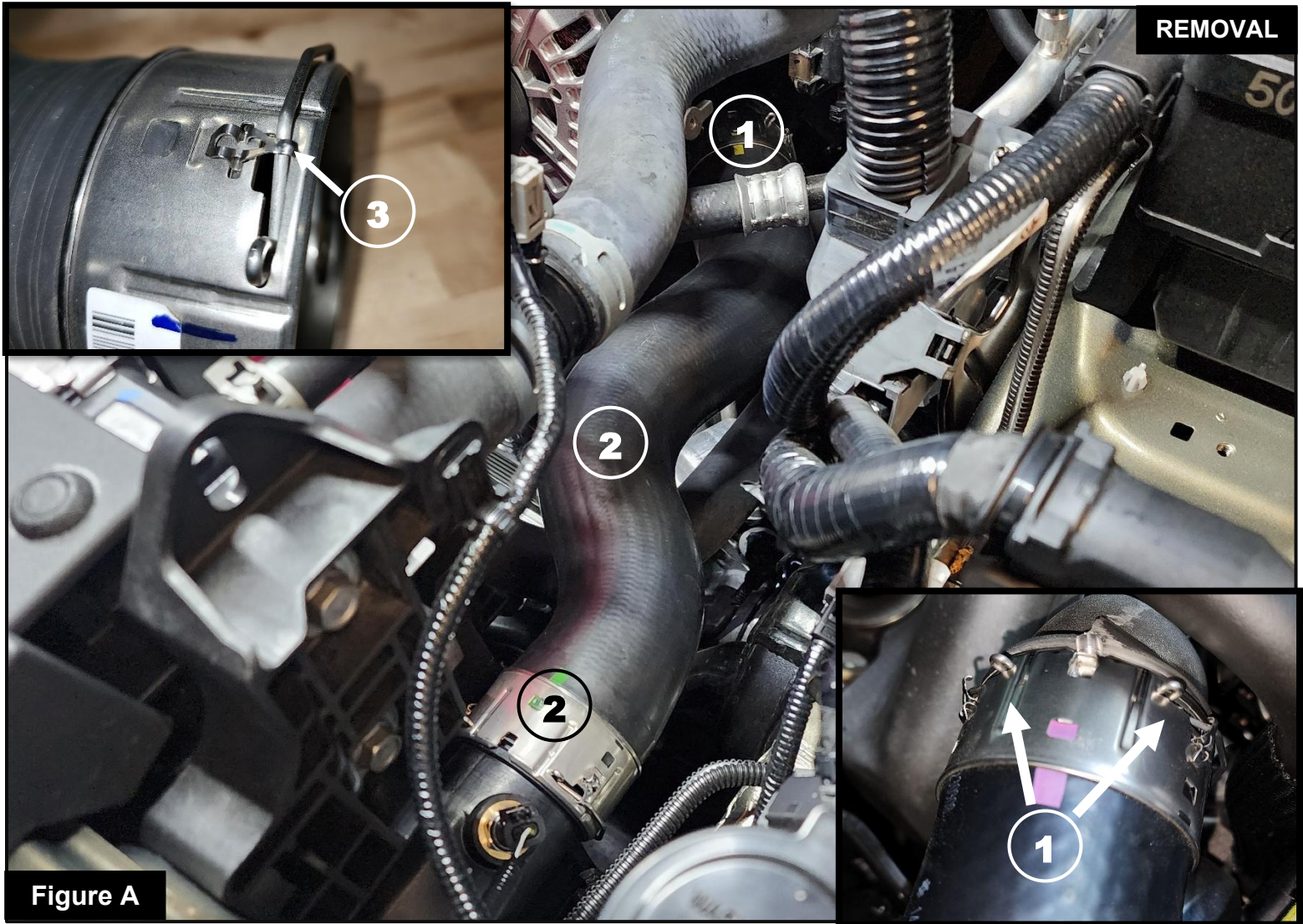

Figure A

Refer to Figure A for Steps 1-4

Step 1: Disconnect the negative battery cable.

Step 2: Expand the retaining clip securing the cold side charge pipe onto the throttle body, then disconnect it from the throttle body (1).

Step 3: Expand the retaining clip securing the cold side charge pipe onto the intercooler outlet, then remove the charge pipe from the vehicle (2).

Step 4: Remove the factory retaining clips from the cold side charge pipe (3). Do this by gently lifting the tabs up on each side and sliding the clips out of the slots, set aside for later use.

**Figure B****Refer to Figure B for Steps 5-8**

Note: Be sure to use thread sealant on the plug or sensor to prevent any leaking.

Step 5: If you are not using any aftermarket sensors, install the supplied 1/8" NPT plug into the threaded fitting on the aFe POWER IC cold side charge pipe (4).

Note: Be sure to lubricate the O-rings with grease to prevent tearing during installation.

Step 6: Install the 60mm ID x 4mm W O-rings into the groove on the inside of each aFe POWER cold side charge pipe (5).

Step 7: Install the factory retaining clips from Step 4 onto each aFe POWER cold side charge pipe (6).

Step 8: Install the 3"ID x 4"L silicone hump coupling onto the aFe POWER ENG cold side charge pipe along with one 052 SmartSeal clamp (7).

**Figure C**

Refer to Figure C for Steps 9-12

Step 9: Install the aFe POWER ENG cold side charge pipe with coupling onto the throttle body, and ensure the retaining clip snaps into place all the way around **8**

Step 10: Install the aFe POWER IC cold side charge pipe onto the intercooler outlet, and ensure the retaining clip snaps into place all the way around **9**.

Step 11: Install one 052 SmartSeal clamp onto the aFe POWER IC cold side charge pipe, then connect the IC cold side charge pipe to the coupling **10** from Step 8.

Step 12: Adjust and ensure the aFe POWER cold side charge pipes and coupling are not touching anything, then tighten the clamps.

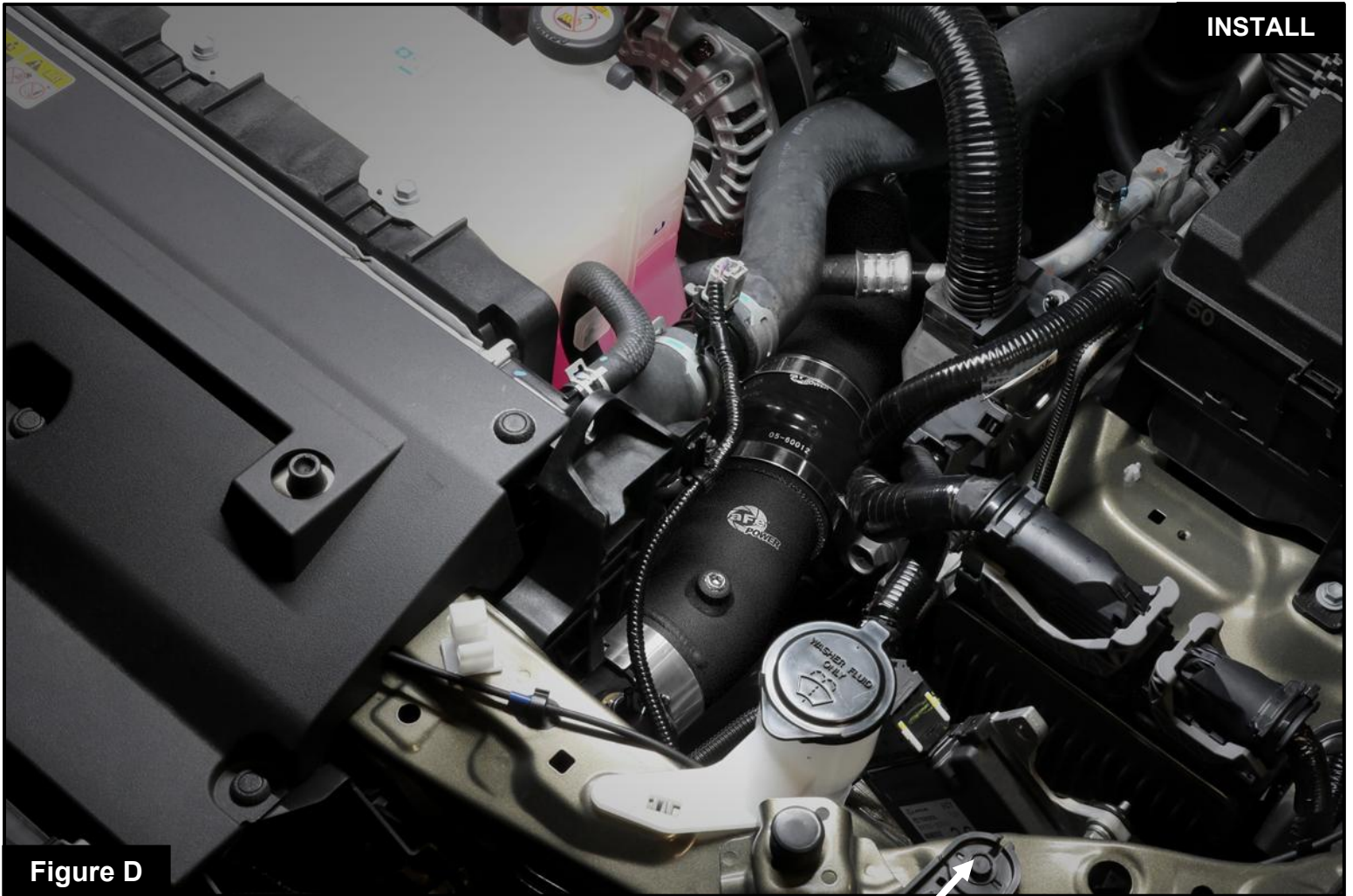

Figure D

Refer to Figure D for Steps 13-14

Step 13: Reconnect the negative battery cable.

Step 14: Install is now complete.

NOTE: Check all clamps, and connectors are secure after 100-200 miles

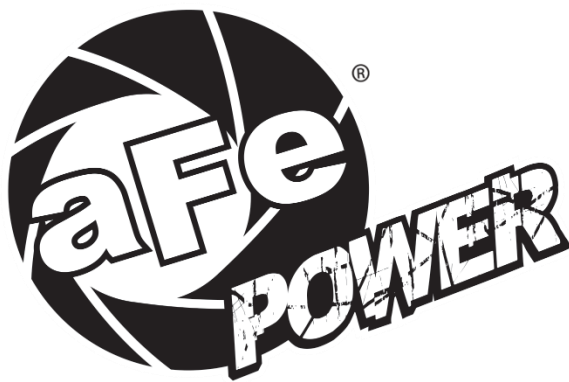

advanced FLOW engineering, inc.

Corona, CA 92879

<https://afepower.com/contact>