



# INSTALLATION INSTRUCTIONS

APPLICATION: 1984-00 JEEP CHEROKEE/WAGONER/SPORT 2/4 DR

## AUTOMOTIVE PRODUCTS, INC.

### STEP BAR ASSEMBLIES

25-1130  
25-1135  
25-1140  
25-1145

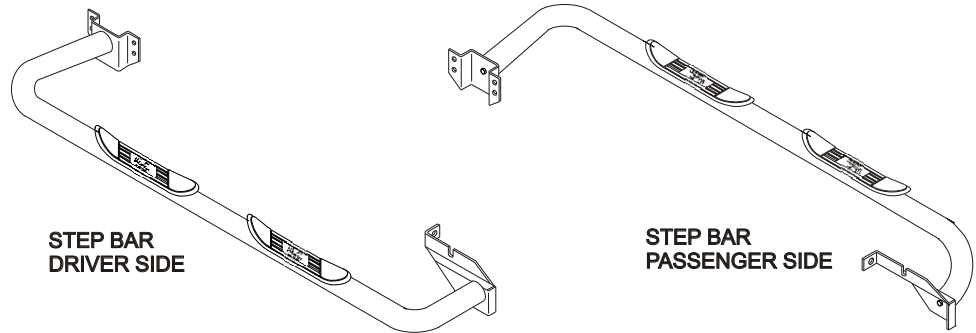

### PARTS KIT CONTENTS

#### QTY

#### DESCRIPTION

#### TOOLS REQUIRED

1	STEP BAR ASSEMBLY, PASSENGER
1	STEP BAR ASSEMBLY, DRIVER
2	FRONT MOUNT BRACKET
1	REAR MOUNT BRACKET, PASSENGER
1	REAR MOUNT BRACKET, DRIVER
4	1/2-13 X 2.00" HEX HEAD BOLT
4	1/2" SAE FLAT WASHER
4	1/2" LOCK WASHER
10	3/8-16 X 1.00" HEX HEAD BOLT, SELF TAPPING

RATCHET  
TORQUE WRENCH  
9/16" SOCKET  
3/4" SOCKET  
13/16" SOCKET  
3/4" COMBINATION WRENCH  
5/16" DRILL BIT  
ELECTRIC DRILL

- STEP 1. Remove the contents from the box and check for any damage. Verify all parts against the parts list.
- STEP 2. Read and understand instructions completely before beginning installation.
- STEP 3. Install both Front and Rear Mounting Brackets onto Step Bars using (4) 1/2-13 x 2.00" Hex Head Bolts, (4) 1/2" Flat Washers and (4) 1/2" Lock Washers. Leave loose. **See Figure 1.**
- STEP 4. Loosen Rear Shackle Bolt and turn until slotted top edge of Rear Bracket can slide under bolt head. NOTE: Do not remove bolt. **See Figure 2.**
- STEP 5. Place rear of Step Bar up to rear suspension point and tighten Shackle Bolt until it holds Rear Step Bar Bracket in place. **See Figure 2.**
- STEP 6. Hold up front end of Step Bar to front frame. Check to be sure Step Bar is properly aligned with body. Mark hole locations. **See Figure 2.**
- STEP 7. Drill holes for Front and Rear mounts using 5/16" Drill Bit and Electric Drill.
- STEP 8. Secure Front Mount Brackets to frame using (4) 3/8-16 x 1.00" Self Tapping Bolts. NOTE: Do not over tighten.
- STEP 9. Tighten and torque 1/2" fasteners to 65 FT. LBS, 3/8-16 x 1.00" Hex Head Bolt Self Tapping to 20 FT. LBS and Shackle Bolt to 70 FT. LBS.

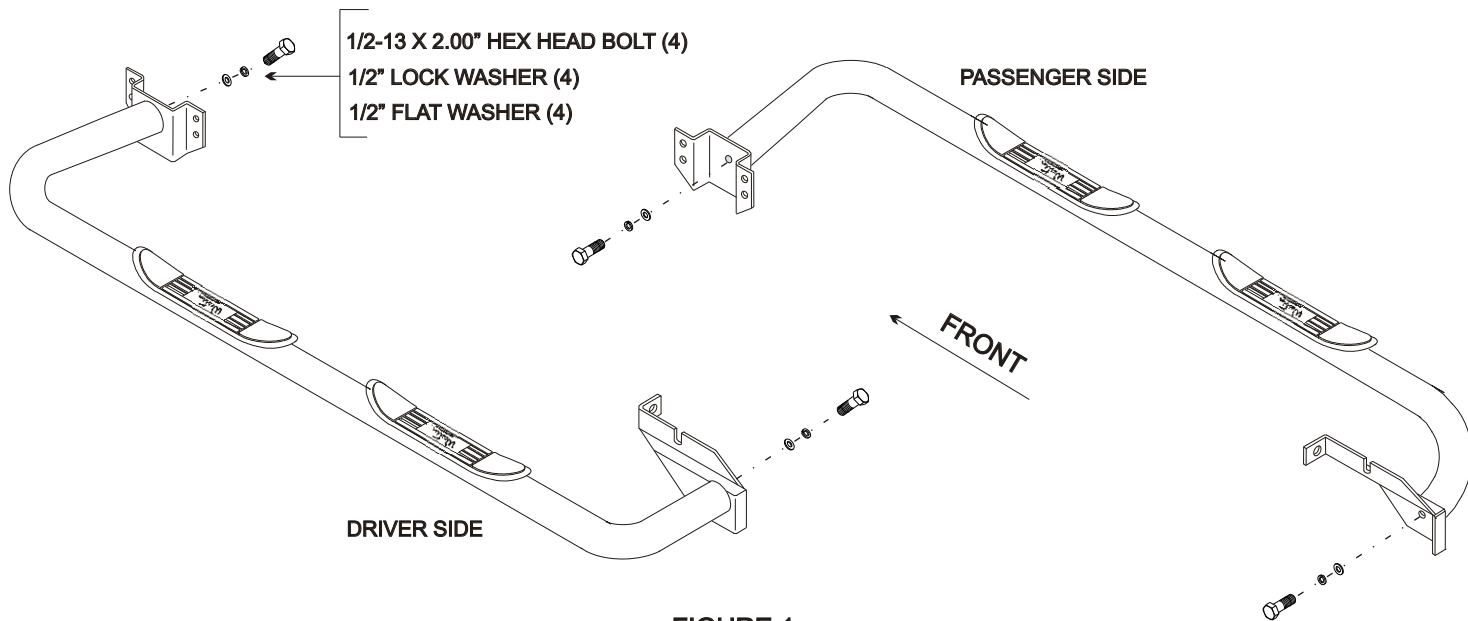

FIGURE 1

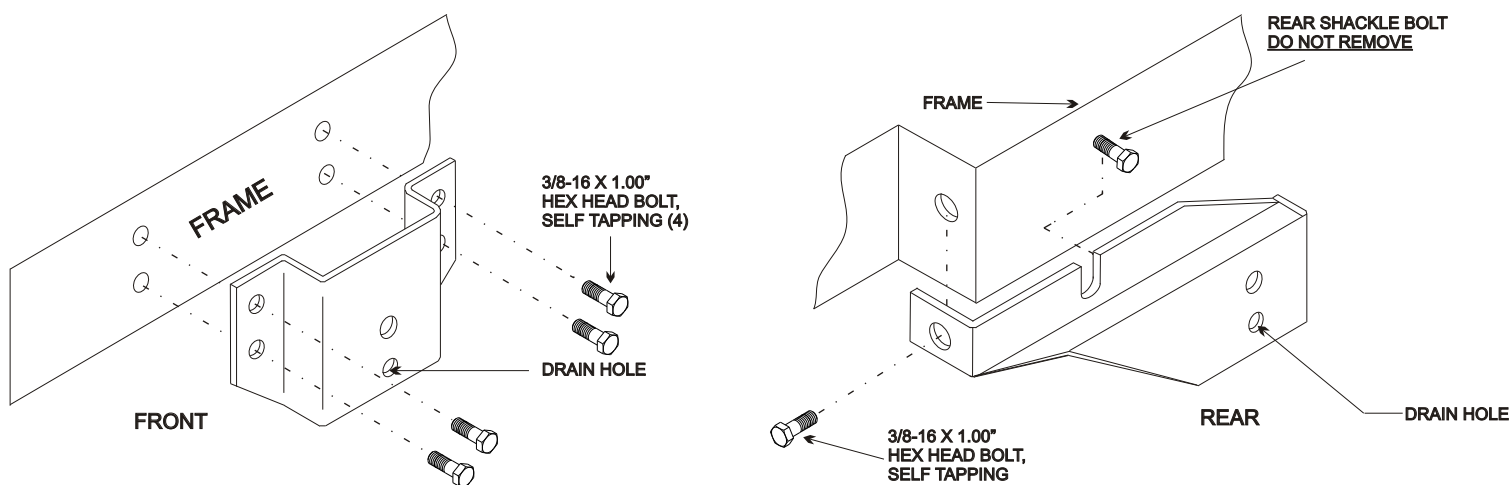

FIGURE 2

**ASSEMBLY AND INSTALLATION VIEW OF DRIVER SIDE - PASSENGER OPPOSITE**

Finish protection - Westin products have a high quality finish that must be cared for like any other exposed finish on the vehicle. Protect the finish with a non-abrasive automotive wax (pure carnauba, for example) on a regular basis. The use of cleaner wax or any compound which contains an abrasive is detrimental, as the compounds scratch the finish and open it to corrosion.



Westin Automotive Products, Inc.  
5200 N. Irwindale Ave. Suite 220  
Irwindale, Ca. 91706

Thank You for choosing Westin products  
For additional installation assistance please call  
Customer service (800) 793-7846 or (507) 375-3559