



JEEP FOUR DOOR WRANGLER

TUBULAR SIDE STEPS
ESTRIBOS LATERALES TUBULARES
MARCHEPIEDS TUBULAIRES

A 2X		B			
C 2X	D 9X	E 9X	F 6X	G 6X	H 12X
I REAR PARTE TRASERA ARRIÈRE		PASSENGER'S SIDE LADO DEL PASAJERO CÔTÉ PASSAGER		FRONT PARTE DELANTERA AVANT	
A 2X		B			
C 2X	D 9X	E 9X	F 6X	G 6X	H 12X
J FRONT PARTE DELANTERA AVANT		DRIVER'S SIDE LADO DEL CONDUCTOR CÔTÉ CONDUCTEUR		REAR PARTE TRASERA ARRIÈRE	

PROBLEMS? QUESTIONS? PLEASE CALL:

PROBLEMAS? ¿PREGUNTAS? PÓNGASE EN CONTACTO CON:

DES PROBLÈMES ? DES QUESTION ? VEUILLEZ CONTACTER:

1-866-639-8896

FAX

FAX 1-515-299-4594

FAX

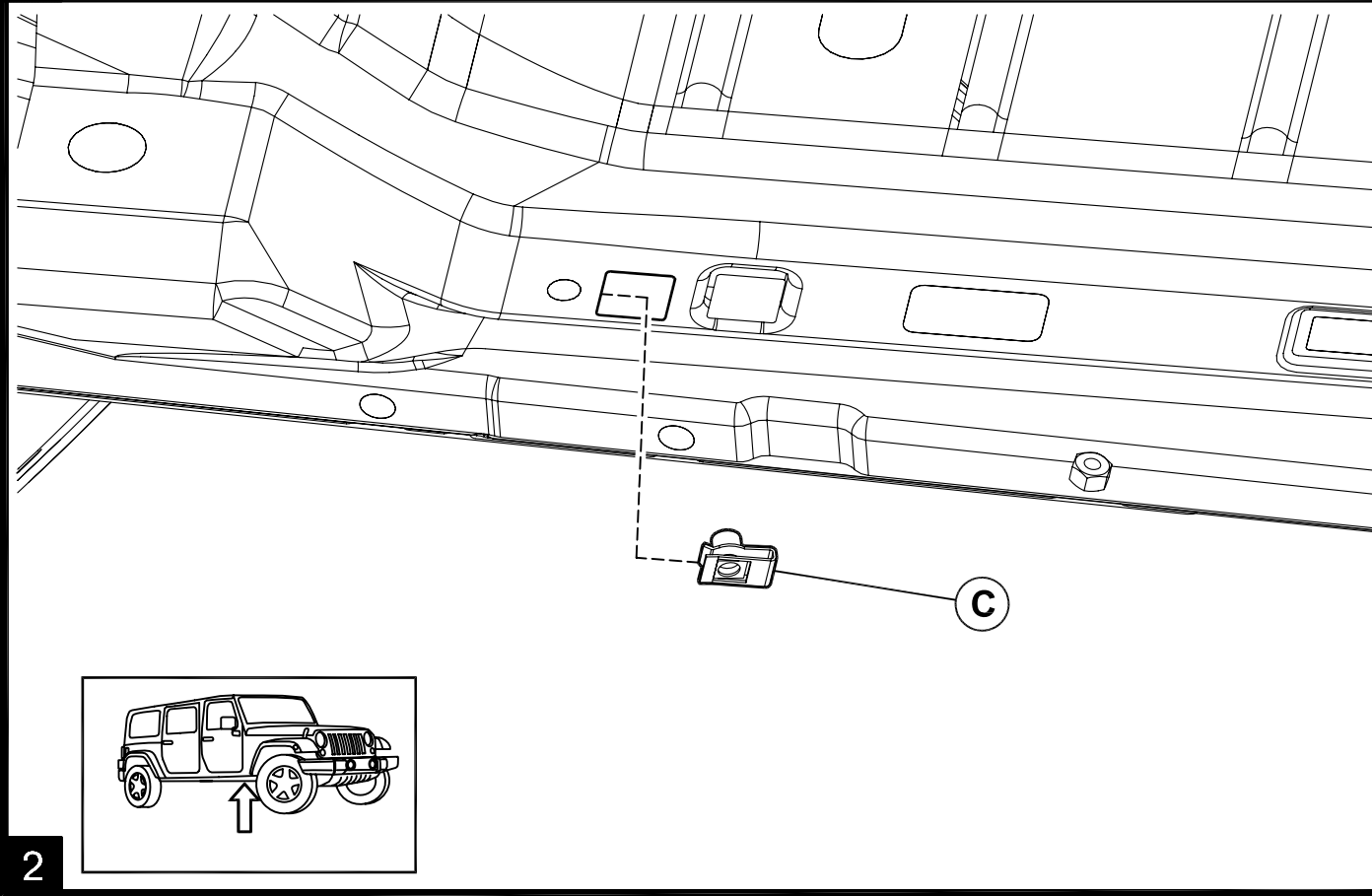
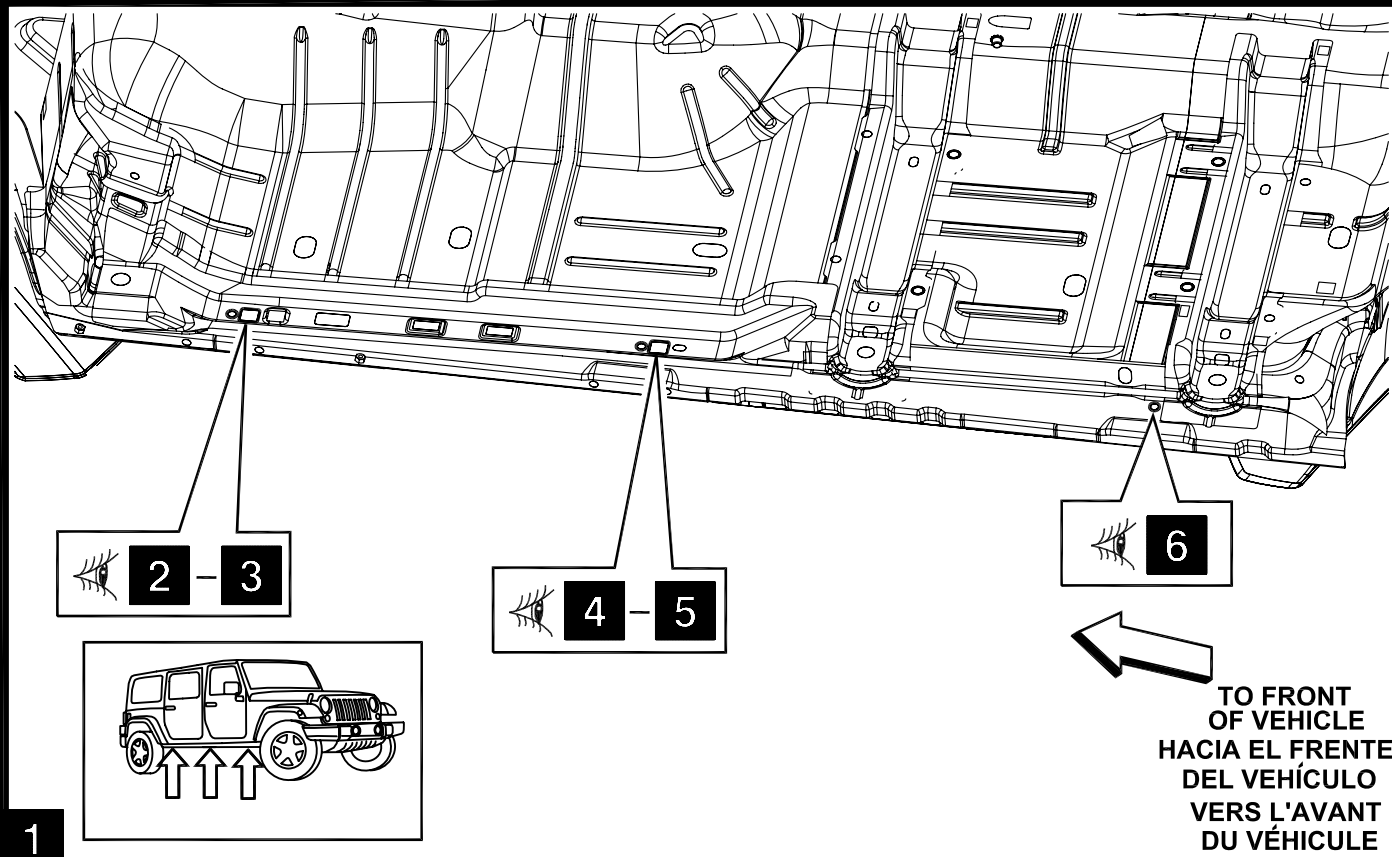

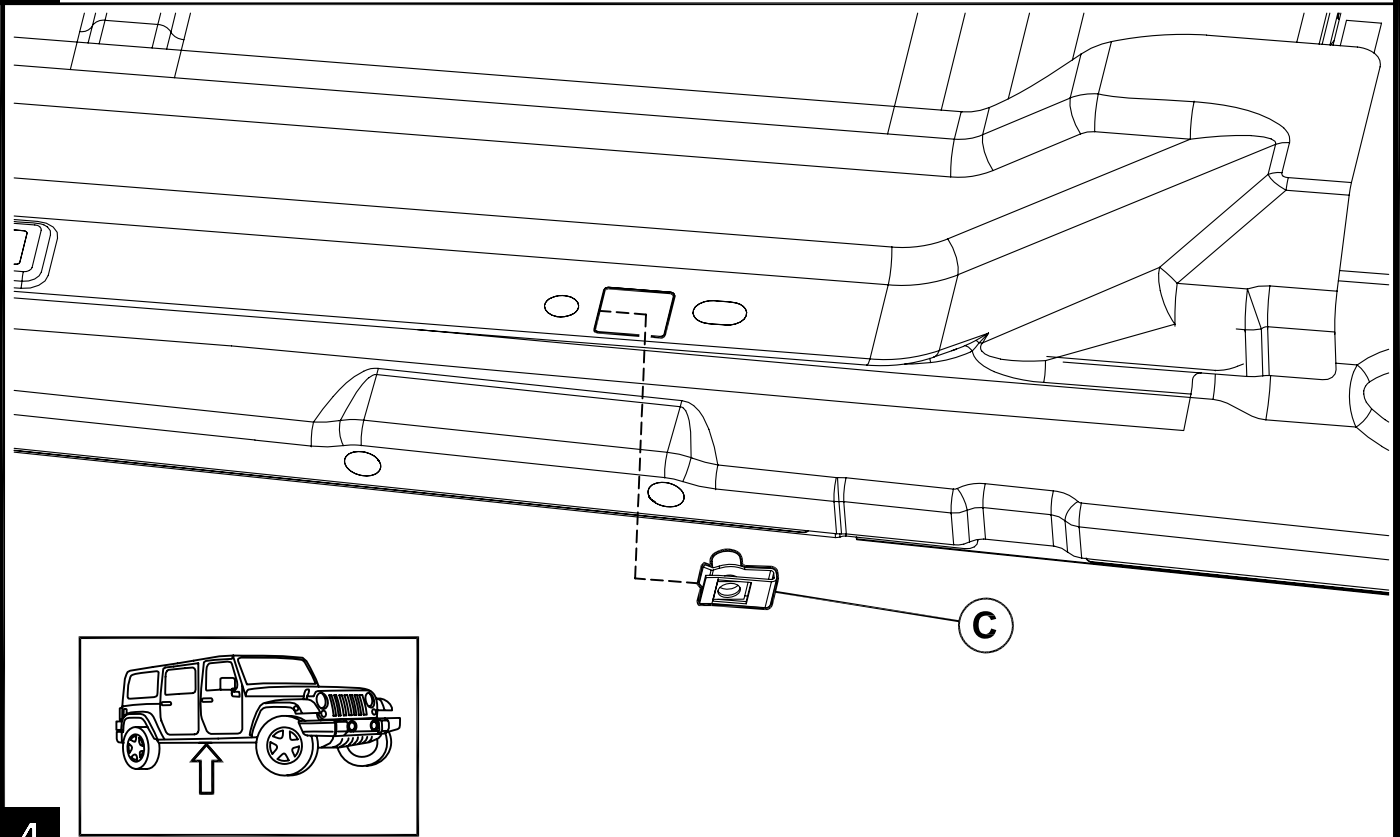
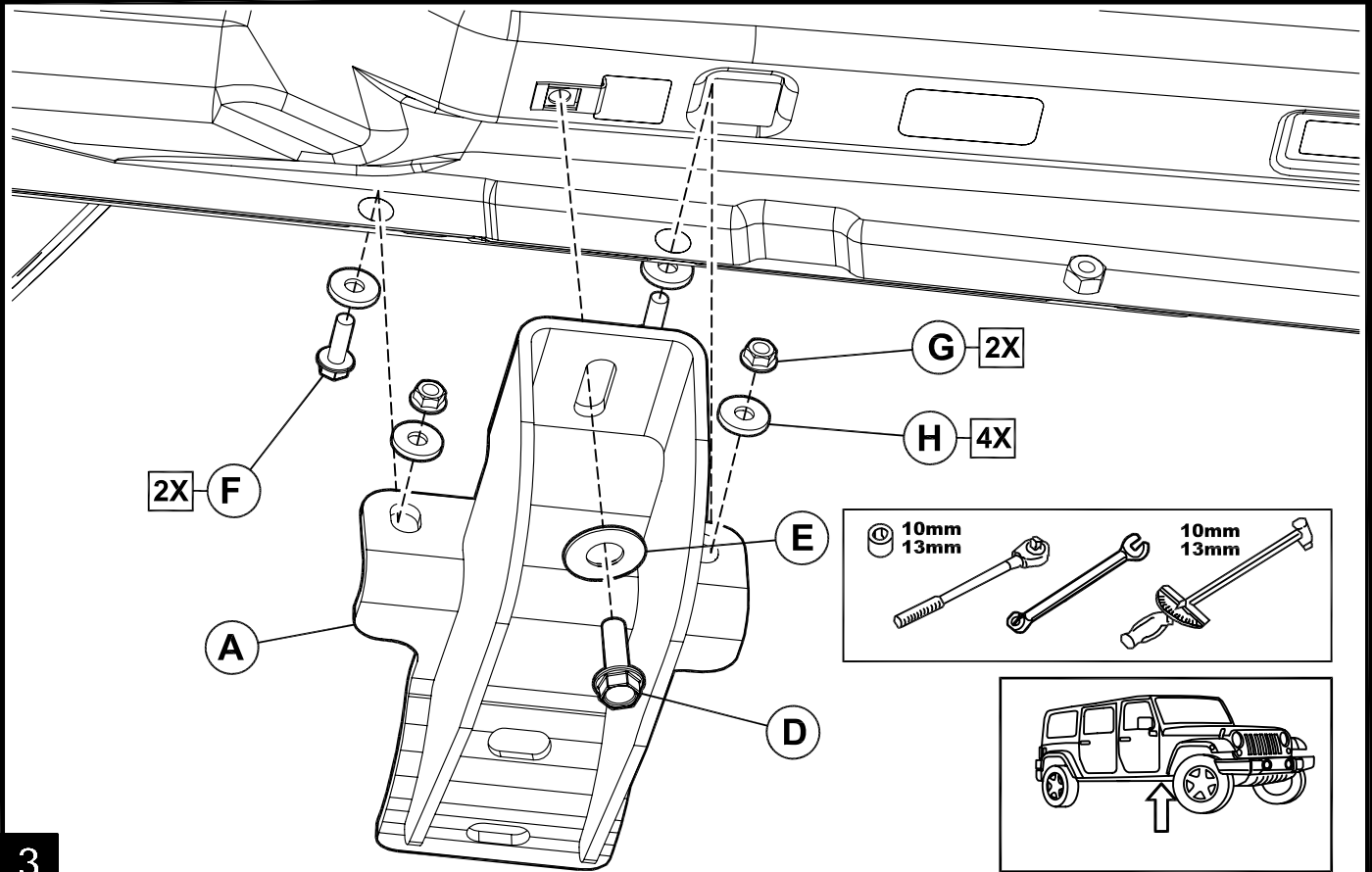

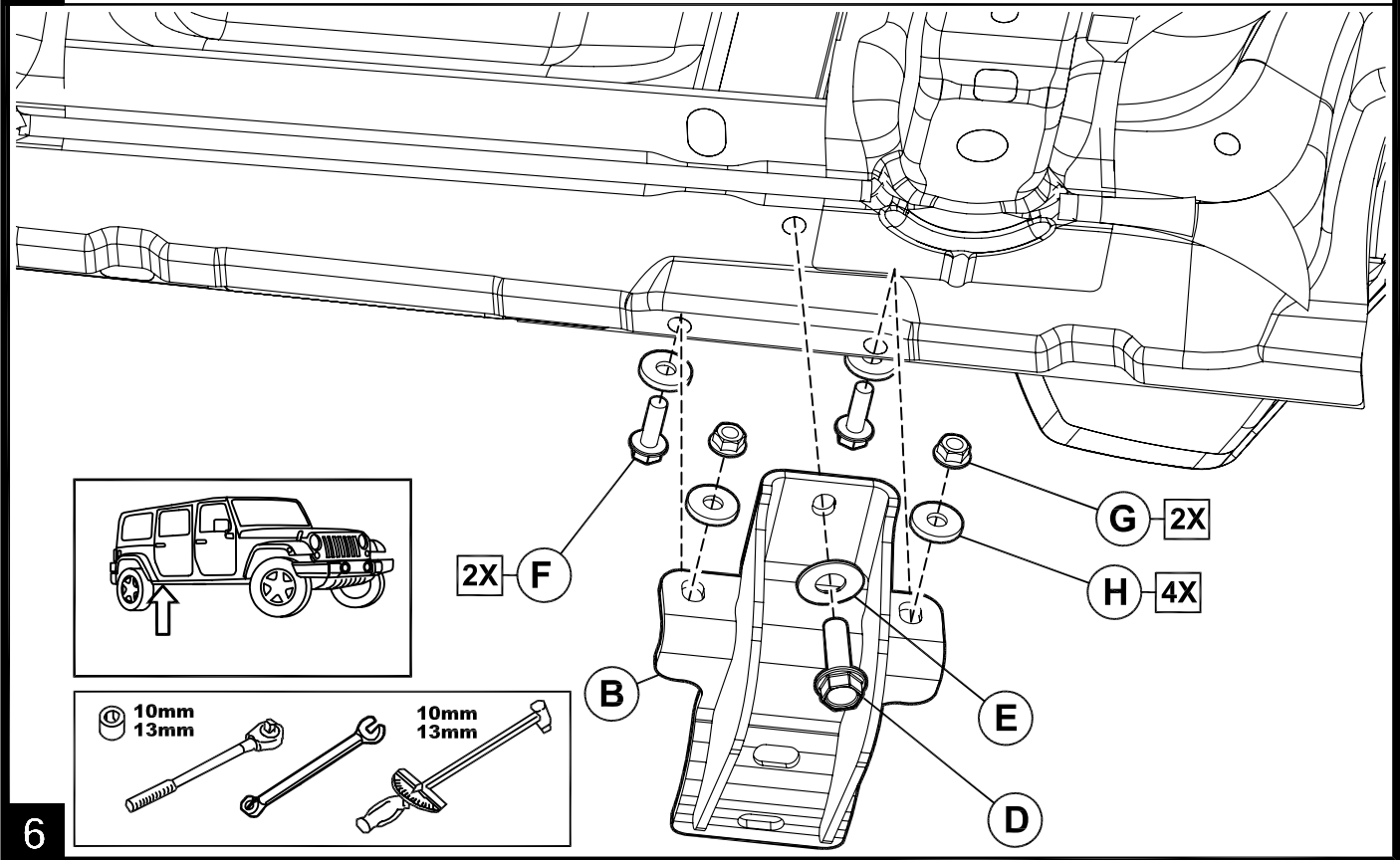
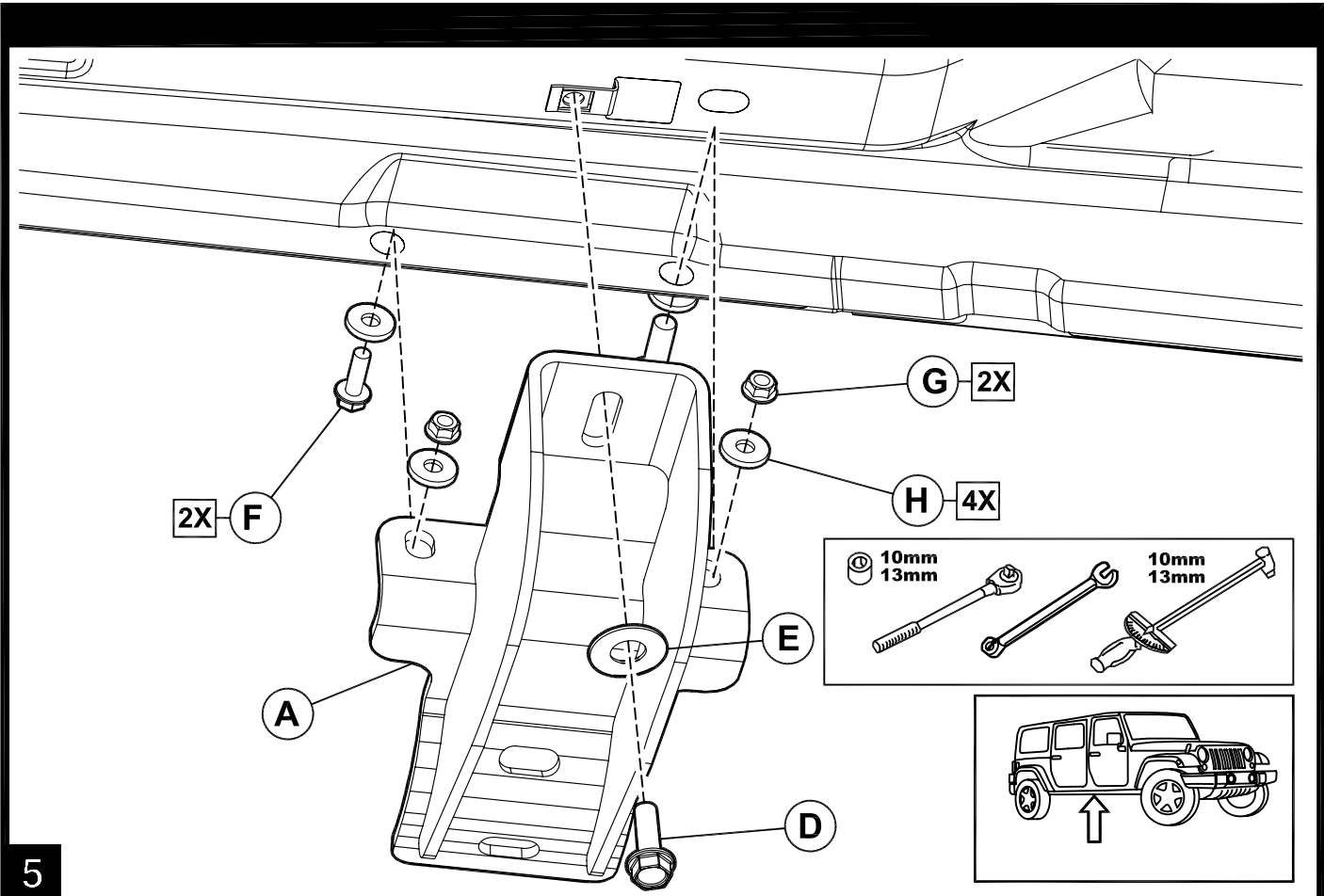

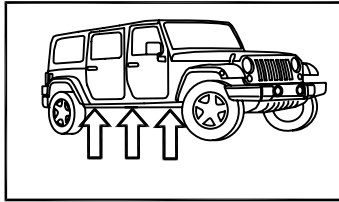
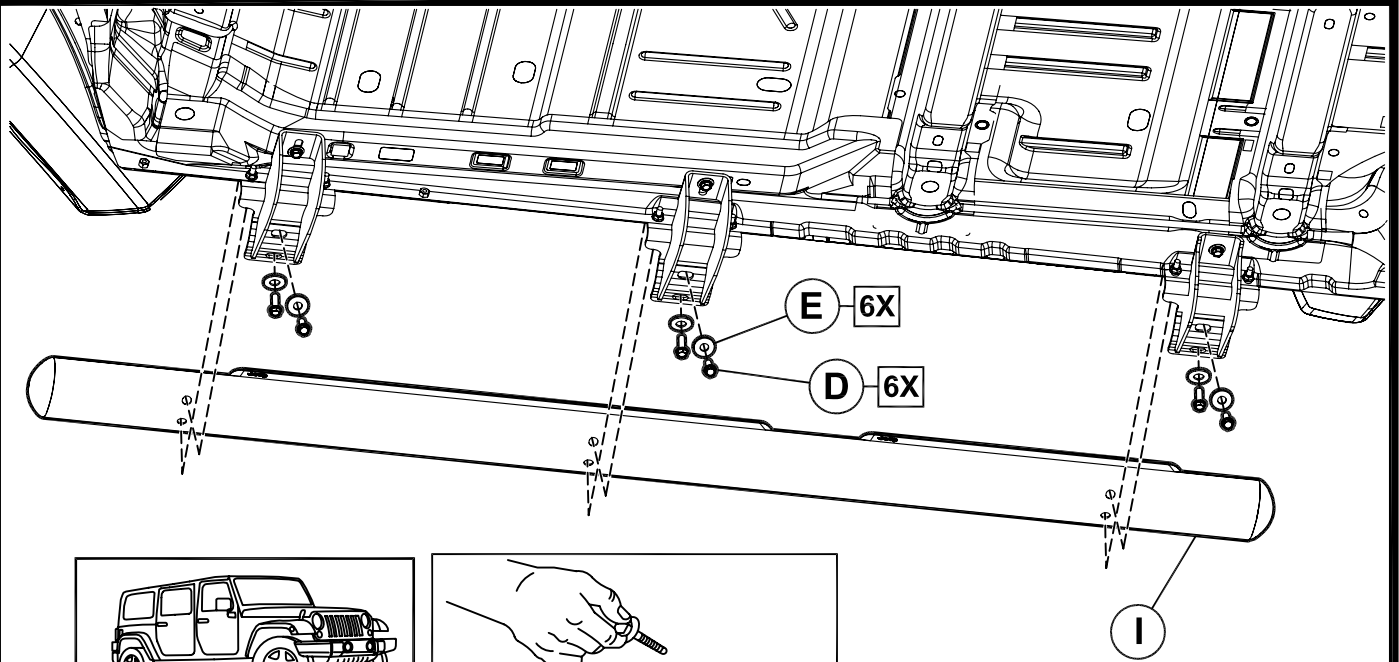

7

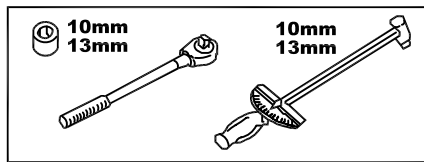
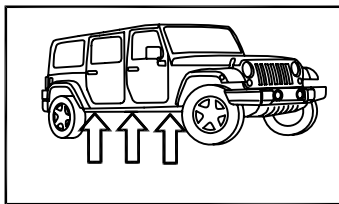
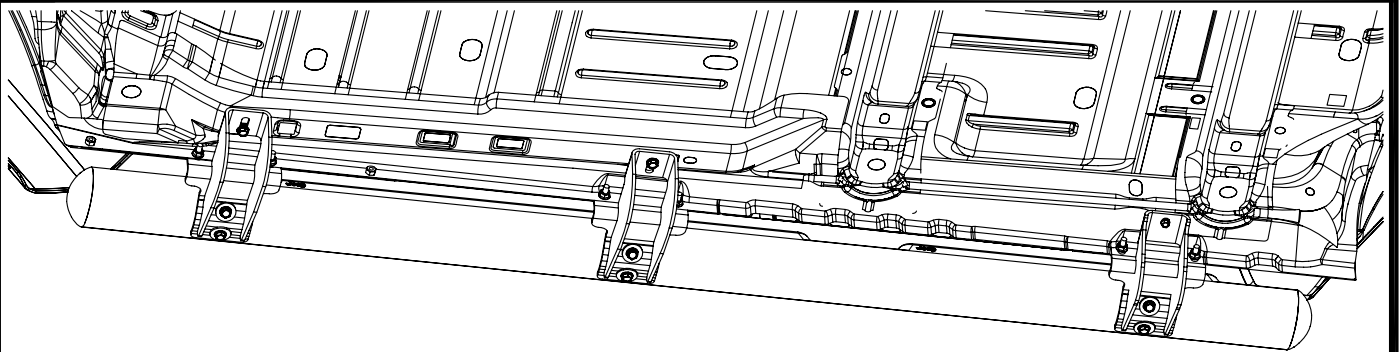

Tighten fasteners labeled "D" to 16 ft-lbs. (22 N-m). Tighten fasteners labeled "F" to 13 ft-lbs. (17 N-m). Repeat for driver's side.
CAUTION - Do Not Overtorque

Apriete los tornillos con la marca "D" a 16 pies-libras. (22N-m). Apriete los tornillos con la marca "F" a 13 pies-libras. (17 N-m).

Repita el procedimiento en el lado del conductor.

Precaución: No apriete demasiado

Resserrez les attaches "D" jusqu'à 16 ft-lbs. (22 N-m). Resserrez les attaches "F" jusqu'à 13 ft'lbs. (17 N-m). Répétez l'opération du côté conducteur.

8

Attention: Ne pas surcoupler