

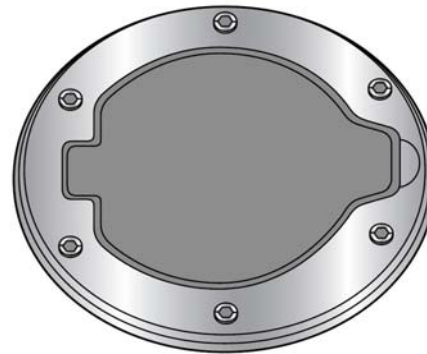

2007-UP JK Wrangler Fuel Door Installation Instructions

Polished Aluminum
Black

Part Number: 43103-00
Part Number: 43103-01



Installation Tips

Before you begin installing this product, read all instructions thoroughly. Bellow are a few tip to make this installation easier.

Clean the installation area before installing this product.

Have all necessary tools on hand

	WARNING
This product is designed to enhance the appearance of the vehicle. Do not rely in any way on the components of this product to contain occupants within the vehicle, or to protect against injury or death in the event of an accident. Never operate vehicle in excess of manufacturer's specifications.	
WEAR SEAT BELTS AT ALL TIMES	
Read and follow, precisely, all installation instructions provided when installing this product. Failure to do so could place occupants of the vehicle in a potentially dangerous situation. After installing or reinstalling, check to make sure it has been properly installed.	

Table of Contents

Fuel Door parts list.....	Page 2
Fuel Door Tools Needed.....	Page 2
Fuel Door Installation.....	Page 2
Fuel Door warranty.....	Page 4

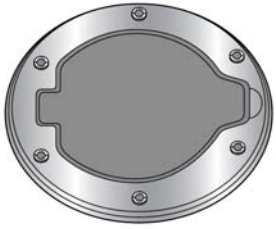

Fuel Door Assembly, Qty-1



Parts List and Hardware Identification.

Tools Needed

- 4mm Allen Wrench
- #2 Philips head screwdriver
- Razor Blade
- Safety Glasses
- Small flat blade screwdriver

Installation

Step One Remove taillight

Unscrew the two Philips screw
Closest to the center of the vehicle
That retains the taillight.

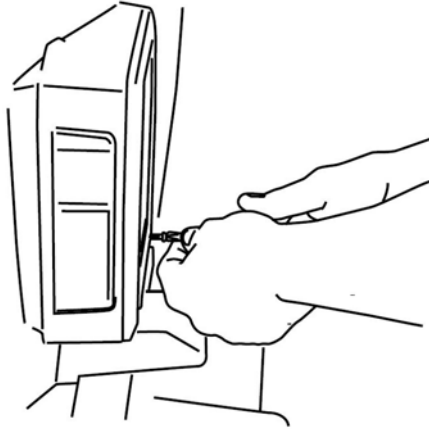

Step Two Unplug Taillight

Unplug the taillight from the Vehicle
And place to the side for use later.

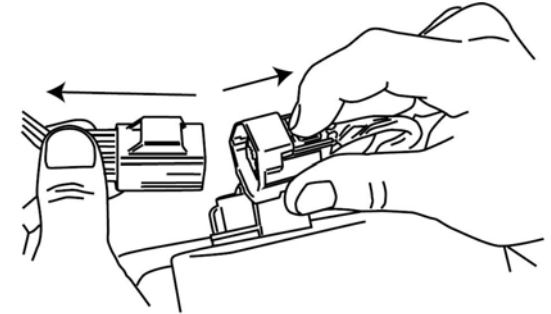

Step Three Remove Gas Cap

Unscrew the gas cap.
Remove the gas cap tether
from the old fuel cup.
Push your thumb between
the tether and the cup until
it comes free.

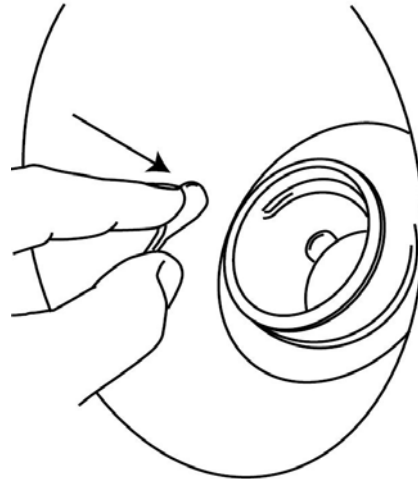

Step Four Remove original fuel cup.

Reach inside the rear of the
body panel using the taillight
opening for access. (fig A)
Push down on the two plastic
tabs on the fuel door cup.(fig B)
Then pull on the cup from the
outside using your other hand
(fig C)

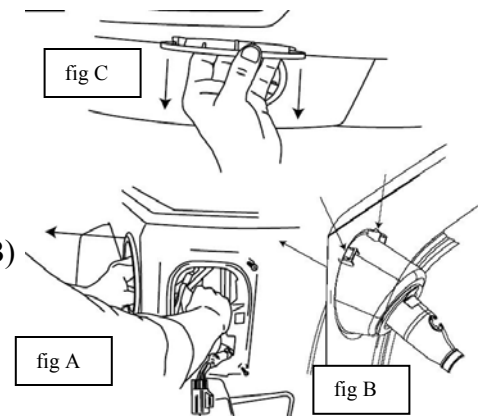

Step Five

Use a 4mm allen wrench to Remove the four (4) bolts that attach the fuel door to the replacement cup. Set the screws aside to be used later.

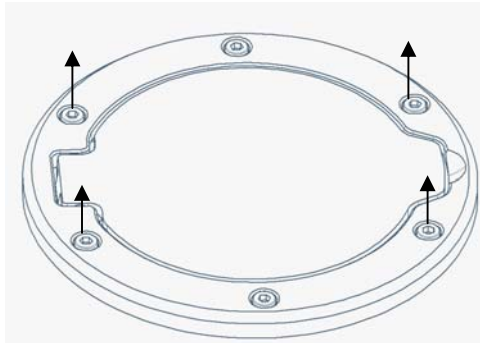

Step Six Remove Rubber Sealing Ring

Remove the rubber sealing ring from the original fuel door cup. Reinstall this rubber ring on the new fuel door cup provided.

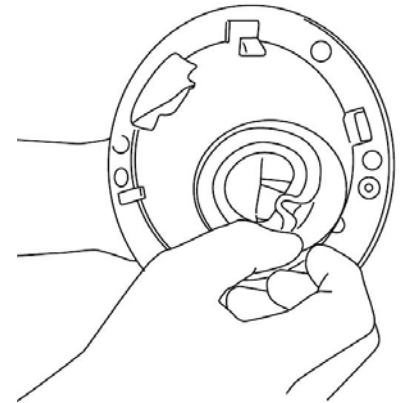

Step Seven (Trim fuel door cup 4 doors only) (Remove screw 2 doors only)

On 4 door models the post on the back of the replacement fuel door cup will need to be trimmed flush. Use a razor blade or side cutters to trim the part shown in the picture.

On two door models remove the plastic screw with a small flat blade screwdriver. (Do not cut plastic tab).

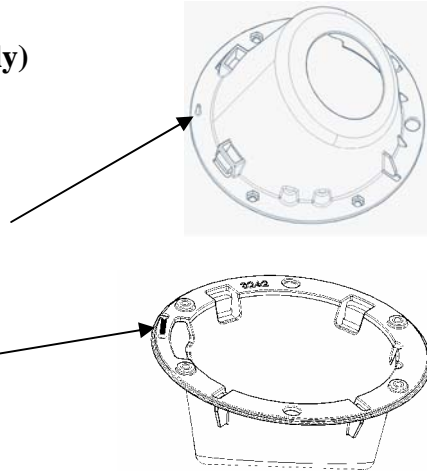

Step Eight Install the Replacement Fuel Door Cup

Slide the cup over the filler neck . Tilt the cup so that the notches on the bottom slide over the sheet metal (A) Then finish installing the cup by pushing on the top of the cup so that the plastic snaps snap behind the sheet metal. (B) Also make sure that the plastic post on 2 door models or the plastic screw on 4 door models go into the alignment hole in the body sheet metal.

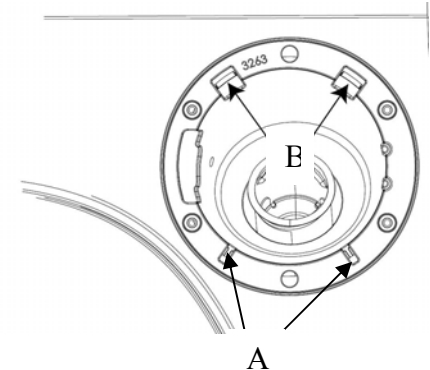

Step Nine Install the Fuel Door

Line up door with the installed fuel door cup. Reinstall the four (4) screws removed in step five. Tighten each bolt to 20in/lbs (2.25 Nm)

Reinstall fuel cap tether by pushing the end through the new hole in the fuel door cup.

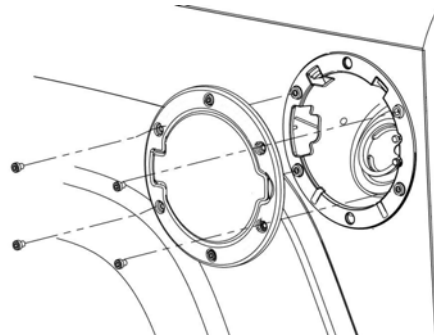

Step Ten Final Inspection

Check all the bolts/ screws that were removed to make sure they are tight.

Check that the door functions properly.
Make sure that the fuel door tether is properly secured in the mounting hole.

LIMITED WARRANTY

We warrant our product to be free from defects in material and workmanship, for terms specified below, provided there has been normal use and proper maintenance. This warranty applies to the original purchaser only. All remedies under this warranty are limited to the repair or replacement of any item or items found by the factory to be defective within the time period specified.

If you have a warranty claim, first you must call our factory at the number below for instructions. You must retain proof of purchase and submit a copy with any items returned for warranty work. Upon completion of warranty work, if any, we will return the repaired or replaced item or items to you freight prepaid. Damage to our products caused by accidents, fire, vandalism, negligence, misinstallation, misuse, Acts of God, or by defective parts not manufactured by us, is not covered under this warranty.

THE WARRANTY TIME PERIOD IS AS FOLLOWS: ALL "HARD GOODS" MANUFACTURED BY OUR COMPANY (USING PRIMARILY VINYL, PLASTICS, AND/OR FOAM): ONE YEAR FROM DATE OF PURCHASE.

ANY IMPLIED WARRANTIES OF MERCHANTABILITY AND/OR FITNESS FOR A PARTICULAR PURPOSE CREATED HEREBY ARE LIMITED IN DURATION TO THE SAME DURATION AND SCOPE AS THE EXPRESS WRITTEN WARRANTY. OUR COMPANY SHALL NOT BE LIABLE FOR ANY INCIDENTAL OR CONSEQUENTIAL DAMAGE.

Some states do not allow limitations on how long an implied warranty lasts, or the exclusion or limitation of incidental or consequential damages, so the above limitations or exclusions may not apply to you.

This warranty gives you specific legal rights, and you may also have other rights which vary from state to state.

For further information or request for warranty work, please contact: Bestop Inc.
Customer Service
(800)346-3910
(303)465-1755