

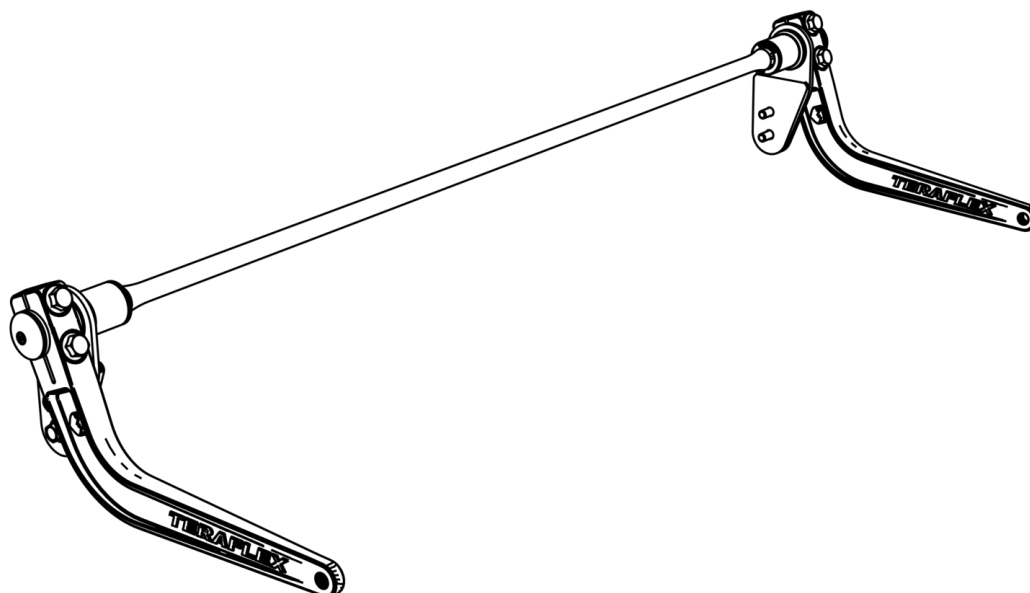

JK Rear Sway Bar

www.TERAFLEX.com

1790000
1790001
1790002
1790003
1790004
1790005



Important Notes:

Prior to beginning this install, or any installation, read the instructions thoroughly to familiarize yourself with the required steps. Evaluate if you are experienced and capable to personally perform these modifications. A factory service manual should be used in conjunction with these installation instructions.

This product will change the highway handling characteristics of your vehicle, exercise caution. After altering the suspension it is always advisable to have an alignment done by a competent 4 wheel drive shop or by an alignment shop that is experienced with lifted 4 wheel drive vehicles.

Refer to the parts list to ensure that all necessary components and hardware has been included. If any parts are missing please contact your local TeraFlex dealer for assistance.

When reinstalling OEM hardware, refer to the torque specs given in the Factory Service Manual.

Tools Needed:

Metric Sockets

Torque Wrench

Cut Off Wheel or Body Saw

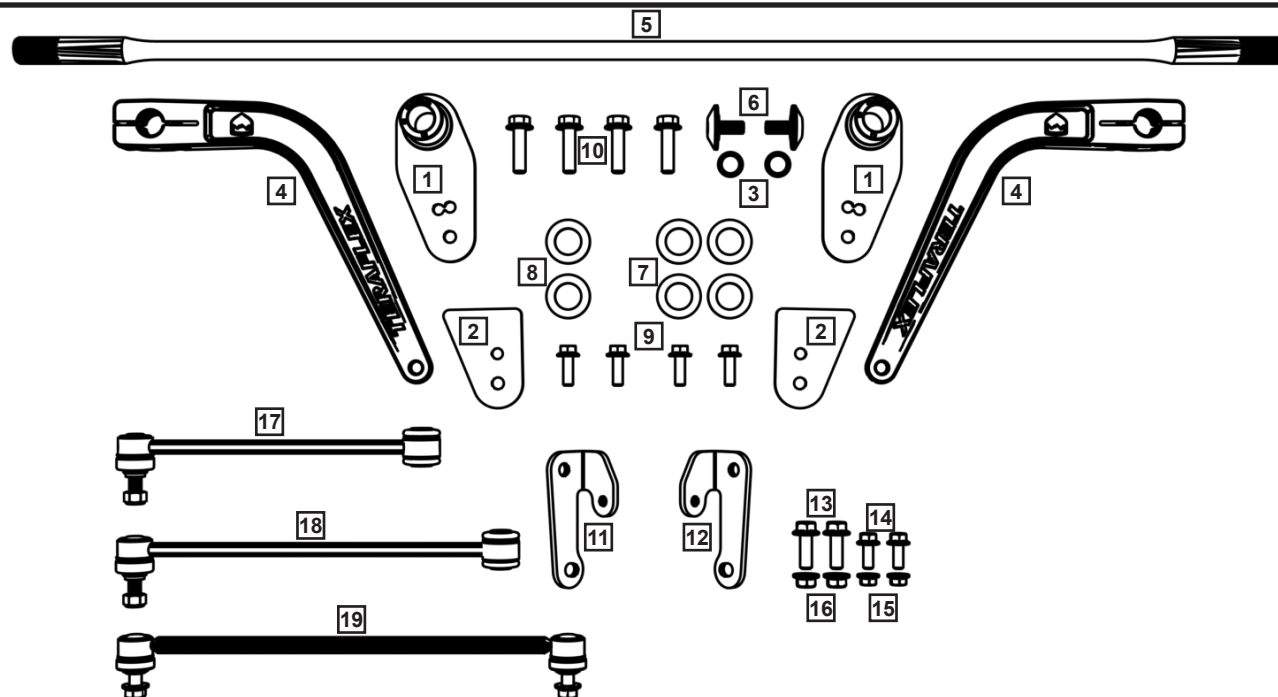

Number	Part #	Name	Qty.
Included in 1790000, 1790002, 1790003, 1790004 & 1790005			
1	15-19-003-012	Bracket (S), Assembly, Jeep JK, Bushing Bracket Assembly	2
2	15-23-003-004	Bracket (S), Sway Bar, Jeep JK, Bushing Bracket Spacer	2
3	16-01-07-043-1	O-Ring (STD) English, Round X-Section, .070" Width (T), .426" ID, 70 Durometer Nitrile - Stat	2
4	21-04-005-001	Sway Bar (S), Arm, Jeep JK Wrangler, Rear Arm	2
5	21-05-001-001	Sway Bar (S), Torsion Bar, Jeep JL Wrangler, Torsion Bar	1
6	21-08-001-001	Sway Bar (S), Retainer, Jeep JL Wrangler, Rear Arm Retainer	2
7	21-09-001-001	Sway Bar (S), Spacer, Jeep JL Wrangler, 1.75" OD / 1.06" ID / 4mm Thick / Mild Steel	4
8	21-09-001-002	Sway Bar (S), Spacer, Jeep JL Wrangler, 1.75" OD / 1.06" ID / 4mm Thick / UHMW Plastic	2
9	45-02-004-002	Hardware (S), Hex Flange Bolt, Alloy Steel / PS11036B, M10 x 1.5 x 30mm Class 10.9	4
10	45-02-009-010	Hardware (S), Hex Flange Bolt, M12 x 1.75 x 45mm, Class 10.9	4
Included in 1790001, 1790002, 1790003 & 1790004			
11	15-23-003-005	Bracket (S), Sway Bar, Jeep JK, Axle Relocation Bracket, Left	1
12	15-23-003-006	Bracket (S), Sway Bar, Jeep JK, Axle Relocation Bracket, Right	1
13	45-02-005-006	Hardware (S), Hex Flange Bolt, Alloy Steel/ PS11036-S, M12 x 1.75 x 35mm	2
14	45-02-005-019	Hardware (S), Hex Flange Bolt, Alloy Steel / PS11036-S, M10 x 1.50 x 25mm	2
15	45-08-004-004	Hardware (S), Flange Top Lock Nut, Alloy Steel / PS11036-S, M10 x 1.5	2
16	45-08-004-006	Hardware (S), Flange Top Lock Nut, Alloy Steel / PS11036-S, M12 X 1.75	2
Included in 179002			
17	21-01-001-115	Sway Bar (S), Link, Swivel Stud, 11.5" Length C-C	2
Included in 179003			
18	754420	Swaybar Link with Swivel Stud for JK Rear 6" lift 14.75" C-C	2
Included in 179004 & 179005			
19	21-01-001-174	Sway Bar (S), Link, Swivel Stud, 17.38" Length C-C / Offset	2

FITMENT REQUIREMENTS:

**The JK Rear Sway Bar requires wheels with minimum 4 3/4" back spacing.
The OEM Rear Axle requires wheel spacers.**

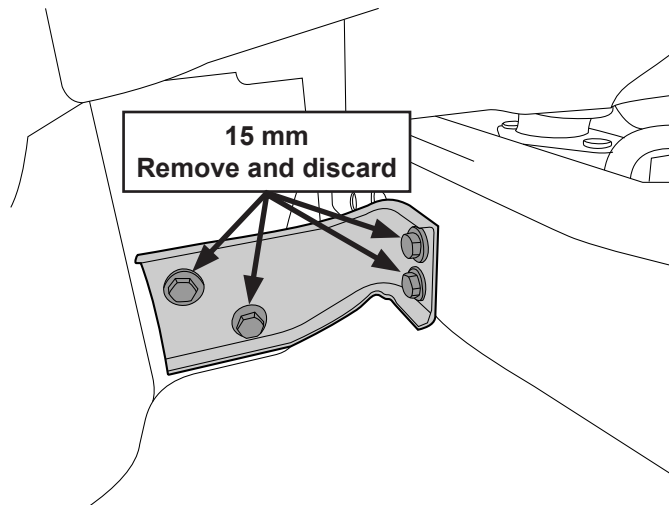
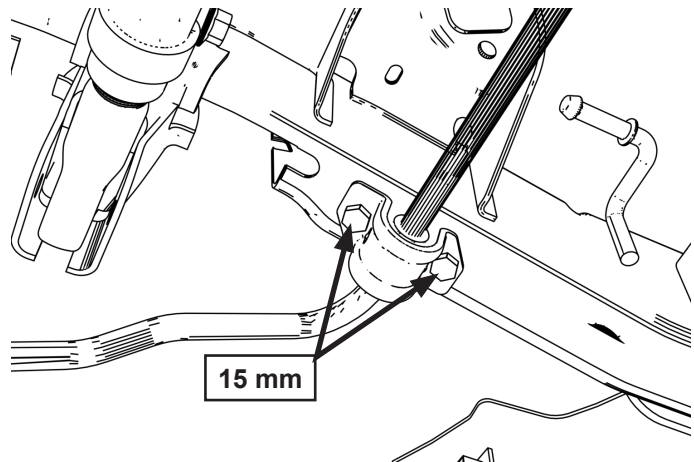
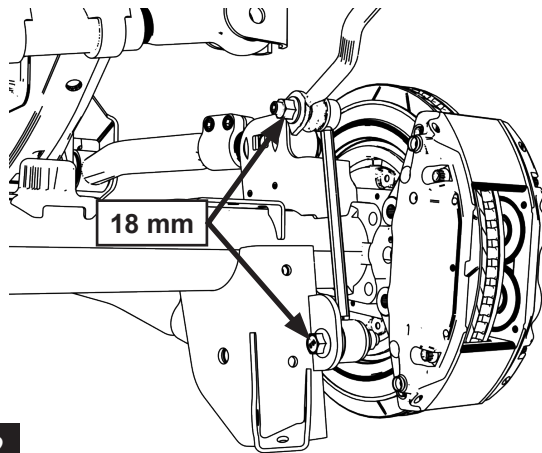
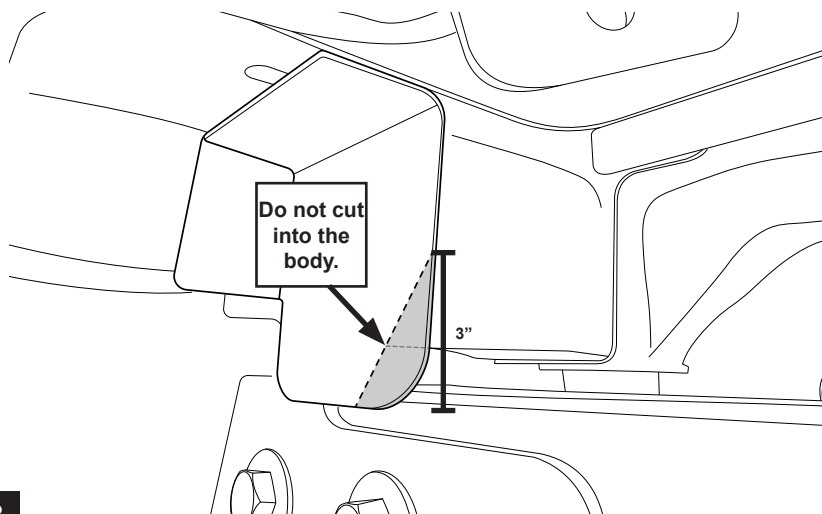
REMOVE THE FACTORY BUMPER BRACES**1****REMOVE THE FACTORY REAR SWAY BAR****2****TRIM THE PINCH WELD JUST ABOVE THE BUMPER
BRACE MOUNTING FRAME HOLES**

Measure up 3" from the bottom and trim the pinch weld at an angle to the edge of the body and then continue along the same angle to the bottom to make it look clean.

Round over sharp edges and then prime and paint.

3

INSTALL THE BRACKET ONTO ONE SIDE OF THE BAR

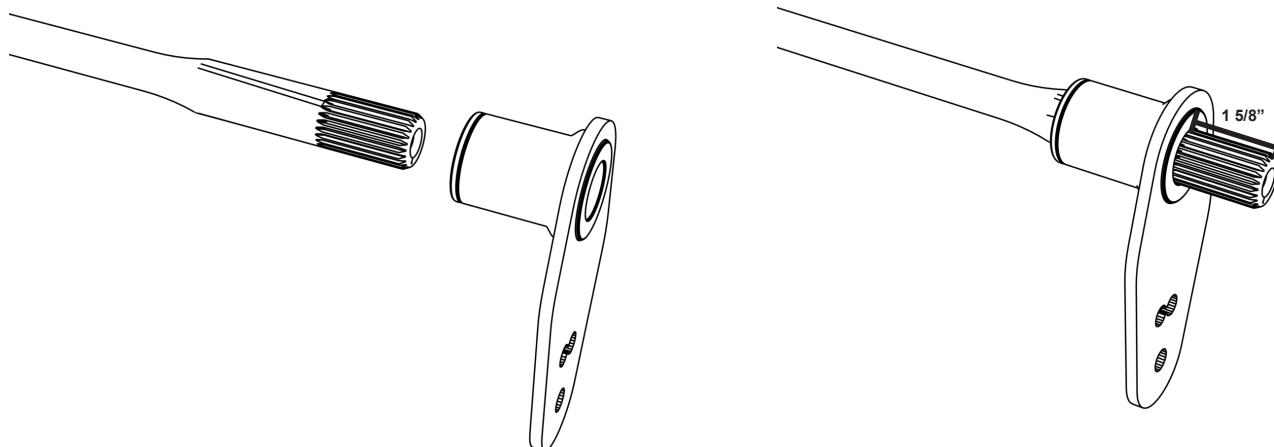

Put anti-seize or mineral oil on the bushing. Have a second person hold the bar or place in a vise and install one bracket onto the bar. It should be about 1 5/8" from the end of the bar. This will help get the bar centered.

4

INSTALL THE BRACKET WITH THE BAR ONTO ONE SIDE OF THE VEHICLE

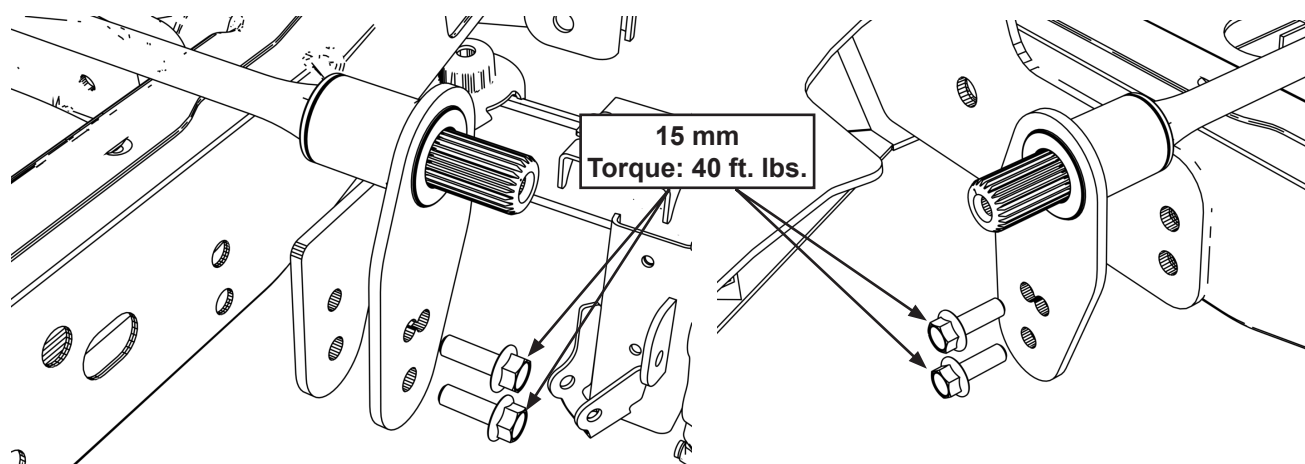

The brackets are NOT side specific. Be sure it angles towards the front of the vehicle and not the rear.

If installing with the TeraFlex JK Rear Bumper, then do not install the backing plate.

5

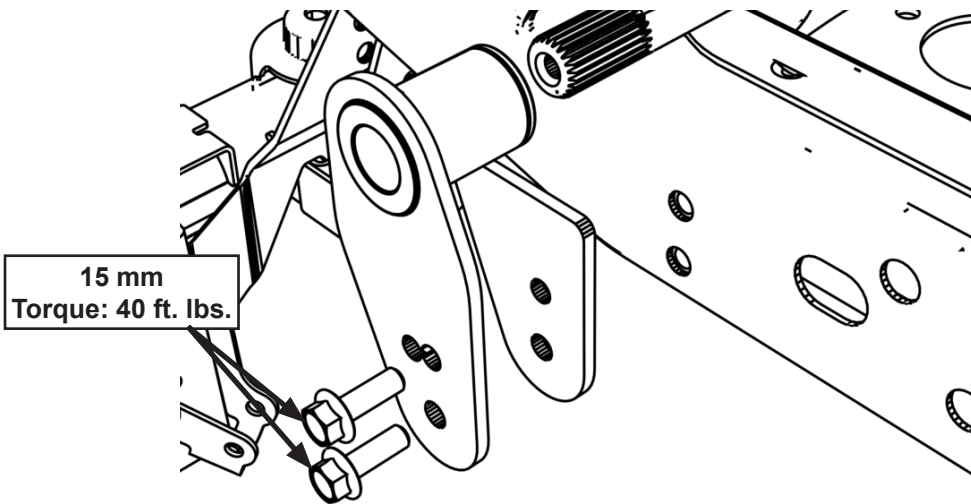
INSTALL THE OTHER BRACKET ON THE OTHER SIDE OF THE VEHICLE

Once installed, check that the bar is centered by measuring from the end of the bar to the bracket. If it matches then the bar is centered. If it is within 1/4" of the other side then it will self center when the end caps are tightened. Adjust the bar's position using a non-scarring dead-blow hammer.

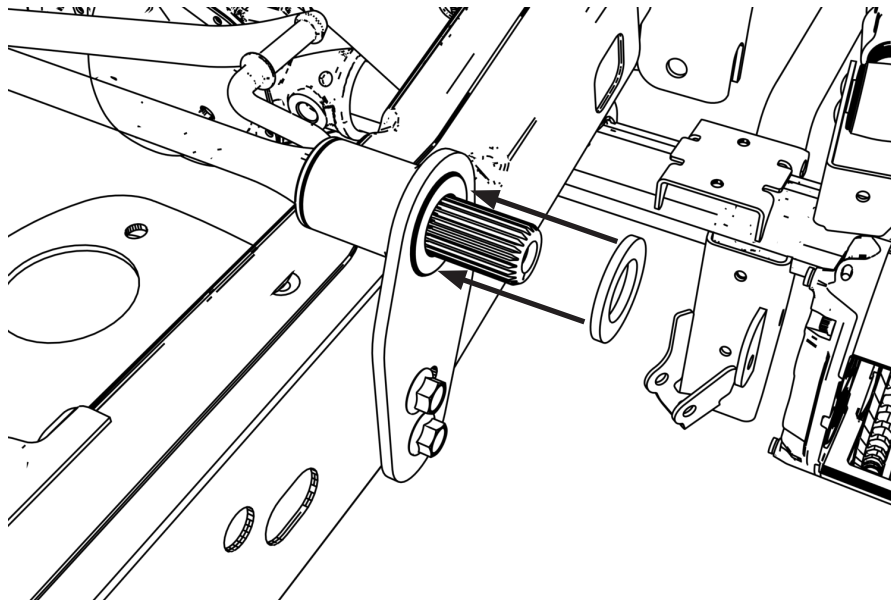
6**INSTALL THE PLASTIC SPACER****7**

SLIDE THE ARM ONTO BAR THE USING THE ALIGNMENT MARK ON THE BAR TO LINE UP THE ARM CORRECTLY

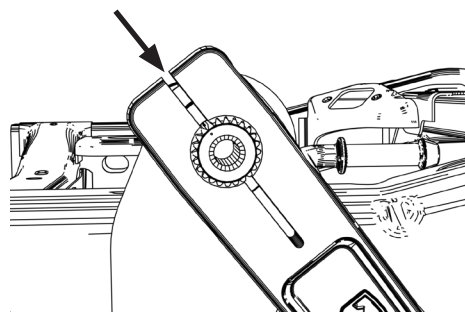
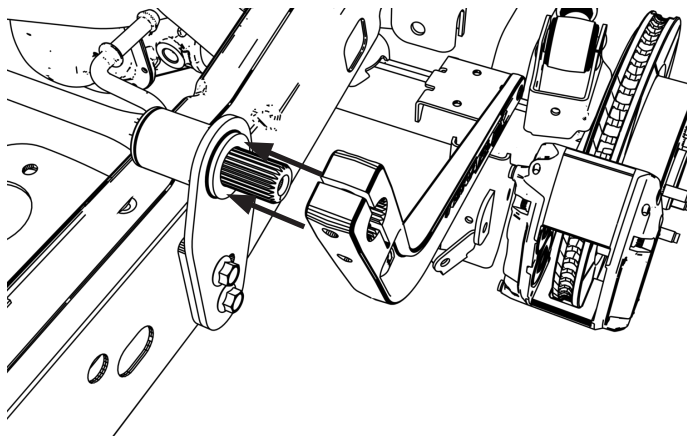

Align the mark on the bar with the gap in the arm. (Mark can align with either gap.)

8

INSTALL THE TWO METAL SPACERS

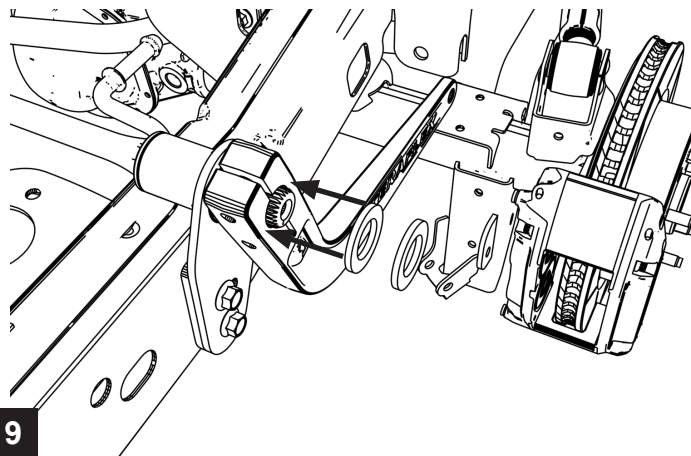

NOTE

The metal spacers can be installed between the arm and the plastic spacer to provide more space between the arm and the frame, but it is recommended that you only do this when you are prevented from having the arm in all the way (e.g. if installing with a coil over kit).

Spacing the arm out could cause the sway bar link and/or arm to rub on the tire. If you need the arm spaced out further, it is recommended that you cycle the rear suspension to check for rubbing.

9

INSTALL O-RINGS AND END CAPS

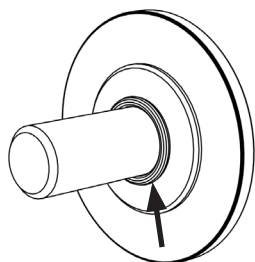

Install O Ring onto end cap before installing onto the Sway Bar.

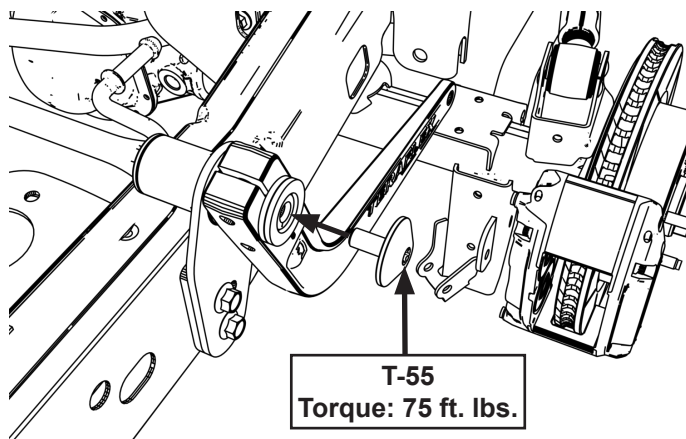

Apply anti-seize onto the threads of the end cap as well as the threads of the bar.

Torque only when both end caps have been installed onto the bar.

10

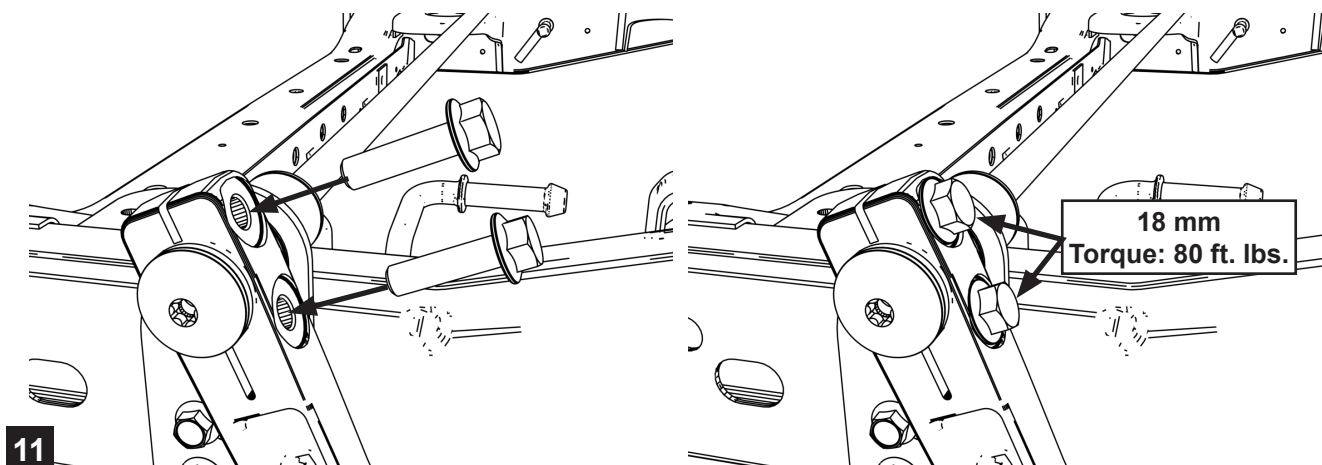
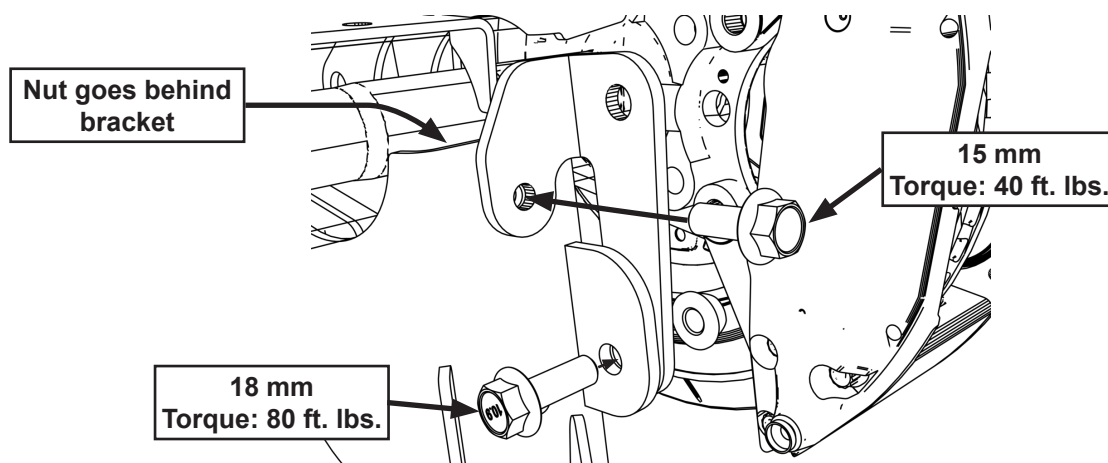
INSTALL THE ARM BOLTS AND TORQUE**INSTALL THE SWAY BAR LINK AXLE BRACKET ONTO THE AXLE****12**

1790005 does not include the Axle Bracket.

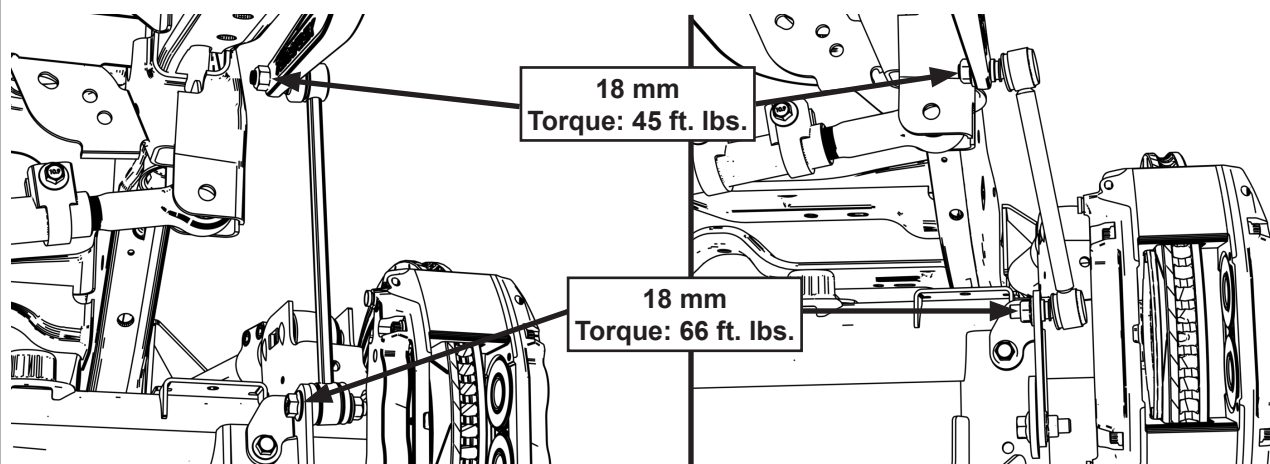
INSTALL THE SWAY BAR LINKS**13**

1790002 and 1790003
Reuse the factory bolt to attach the lower end
of the sway bar link to the bracket.

1790004 and 1790005

TERAFLEX

PRODUCT INFORMATION

MAINTENANCE INFORMATION:

It is the buyer's responsibility to have all suspension, drivetrain, steering, and other components checked for proper tightness and torque after the first 100 miles and every 3000 miles after that.

NOTICE TO INSTALLER:

The enclosed "Warning to Driver" sticker must be installed in the vehicle in driver's view. This sticker is to act as a constant safety reminder when operating the vehicle. It is your responsibility as the equipment installer to install the provided sticker and to forward the product instructions to the vehicle's owner for review. If a "Warning to Driver" sticker or product installation guide were not included in the kit, FREE replacement stickers and instructions are available by request. It is the installer's duty to ensure a safe and controllable vehicle after the modifications have been performed.

WARNING:

Neither the seller nor the manufacturer will be liable for any loss, damage, or injury directly or indirectly arising from the use of or inability to determine the use of these products. Before using, the user shall determine the suitability of the products for its intended use, and the user shall assume all responsibility and risk in connection therewith.

WARNING TO DRIVER:

This vehicle has been modified to enhance off road performance and has unique handling characteristics. Use in harsh environments can cause extreme stress on the components. Vehicle should be inspected after being off road to make sure that all the components are in working order and safe to travel on the highway. All fasteners should be checked so that they are at the correct torque specifications as the vibration and stresses from off roading may cause critical fasteners to work loose. Extra care should be taken to inspect the critical components, steering, and brake systems. During each oil change components such as arms, tie rod ends, etc should be greased and checked for excessive wear. Any worn components should be replaced. When returning to the pavement always set or restore tire air pressure to the factory recommendation and connect or engage any disabled sway bar mechanisms. Because of the higher center of gravity and larger tires, this vehicle handles and reacts differently than many passenger cars, both on and off road. You must drive it safely! Extreme care should be taken to prevent vehicle rollover or loss of control, which can result in serious injury or death. Avoid sudden sharp turns or abrupt maneuvers. Generally, braking performance and capabilities are decreased when significantly larger/heavier tires are used, especially when used in combination with transfer case low-range reduction kits. Take this into consideration while driving. Do not add, alter or fabricate any factory or aftermarket parts to increase vehicle height over the intended height of the TeraFlex product purchased. Mixing component brand is not recommended. TeraFlex Inc. will not be responsible for any altered product or any improper installation or use of our products. We will be happy to answer any questions concerning the design, function, and correct use of our products. It is ultimately the buyer's responsibility to have all bolts/nuts checked for tightness after the first 100 miles and then every 3000 miles. Wheel alignment, steering system, suspension and drive line systems must be inspected by a qualified professional mechanic at least every 3000 miles.

TERAFLEX PRODUCT WARRANTY:

TeraFlex Inc. warrants TeraFlex Suspension products to the original retail purchaser to be free of defects in material and workmanship for as long as the original purchaser owns the vehicle on which products were originally installed.

Failure to complete regular maintenance (grease every 3000 miles) on TeraFlex FlexArms will void this warranty. All other conditions of the standard TeraFlex product warranty apply.

All TeraLow products are covered by the TeraFlex two (2) year warranty to be free of defects in material and workmanship for two years from date purchased.

TeraFlex axles are covered by a 12-month warranty to be free of defects in materials and workmanship.

This warranty does not cover or include product finish, improperly installed or applied products, improperly maintained products, products or components used for racing or competition or damage due to abuse or neglect, products that fail due to the use of larger tire and wheel combinations.

All returns must be accompanied by an original invoice. It is the customer's responsibility to remove the product from the vehicle. Shipping charges are the responsibility of the customer. TeraFlex Inc. will pay the return freight if the product meets the terms of warranty.

This warranty is for the replacement or repair of defective TeraFlex products only and does not include freight charges, labor charges for removal of or installation of TeraFlex or related products or components, costs incurred due to down time of the vehicle, or lost profits due to vehicle down time.

A returned goods authorization number (RGA#) must accompany any returned products. For more information please contact a TeraFlex customer service representative.

COPYRIGHT

©Copyright 2014. All rights reserved, TeraFlex Inc. Reproduction of this catalog and/or any of its contents without written permission is strictly prohibited.

TeraFlex® is a registered trademark of TeraFlex Inc. All trade names and logos including but not limited to TeraFlex, FlexArms, RockGuard, Monster, and LCG are protected by law and duplication of trade names and/or logos are strictly prohibited.

TeraFlex Inc. reserves the right to update, discontinue, redesign, modify finish, part number or component build parts if deemed necessary without written notice. TeraFlex Inc., and any associated dealers are not responsible for misprints or typographical errors that may have inadvertently been made within this instruction sheet.

Jeep® and the Jeep® grill are registered trademarks of Fiat Chrysler Automobiles N.V., and have no affiliation with TeraFlex Inc.

TERAFLEX, Inc.
5680 West Dannon Way
West Jordan, UT. 84081
Phone/801.713.3314
Fax/801.713.2313
www.teraflex.com