

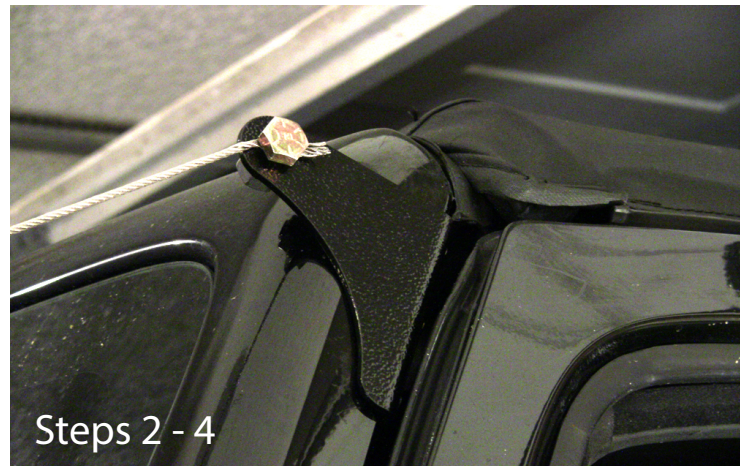

JK LIMB RISER INSTRUCTIONS

1. Remove the hood portion of the hood latch. Install the lower limb riser bracket between the hood and the hood latch and reinstall the hood latch.
2. Position the upper limb riser bracket on the side of the windshield frame all the way up to the rubber portion at the top.
3. Using a pen, mark the location of the three holes. Use a center punch and mark the three holes and drill them out with a 1/8" drill bit. Reposition the upper limb riser bracket in place and install the bracket using three stainless steel rivets.

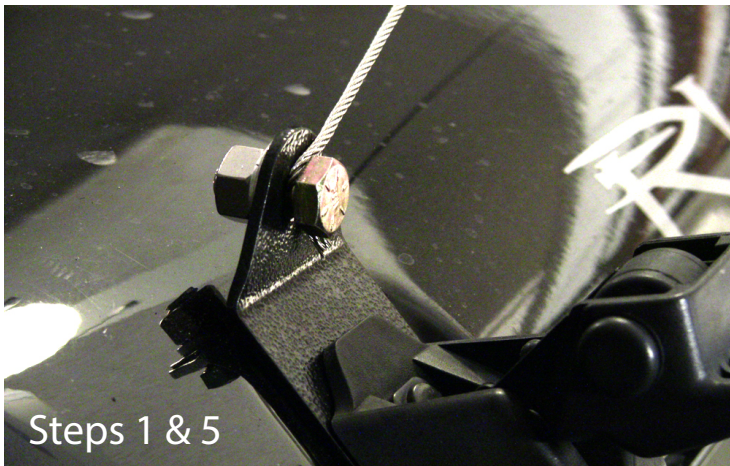

4. Take one of the enclosed 3/8" bolts and slide one flat washer onto the bolt until it reaches the head of the bolt. Insert one end of the enclosed length of cable through the hole in the bolt approximately 1/2". Put the bolt through the hole in the upper limb riser bracket. Put a washer, lock washer, and nut on the other side of the bolt and tighten.
5. Repeat this process on the lower limb riser bracket. Making sure that the cable is taut when the hood is fully latched. The cable excess can then be trimmed to the desired length.
6. Repeat these steps to complete the other side.

Note: It is the owner's responsibility to ensure the safe use and installation of this product.