



## Custom Seat Cover Installation



<b>Custom Seat Cover Installation</b>	<b>3</b>
<b>Removing a Headrest</b>	<b>4</b>
<b>Backrest Cover Installation</b>	<b>7</b>
<b>Seat Bottom Cover</b>	<b>10</b>
<b>Solid Bench</b>	<b>11</b>
<b>Console Cover Installation</b>	<b>12</b>
<b>Special Instructions - 1</b>	<b>13</b>
<b>Special Instructions - 2</b>	<b>14</b>
<b>Finishing Touches</b>	<b>15</b>



**Custom Seat Cover**

Also Available



**Custom Car Cover**

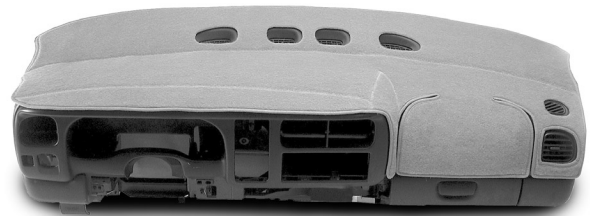

**Custom Dash Cover**



**Custom Sun Shield**



**Custom Floor Mats**

COPYRIGHT 2005 SHRIN CORPORATION



# Custom Seat Cover Installation



Buckets

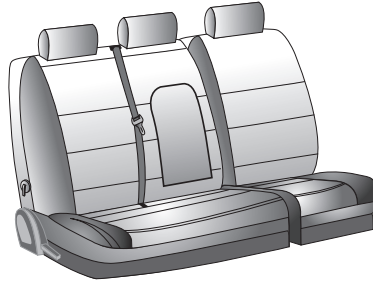

Split Bench  
w/ integrated belts

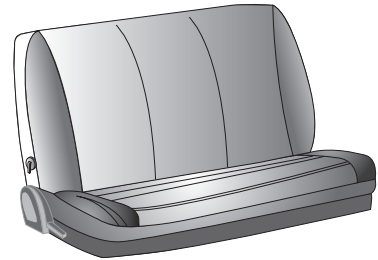

Solid Bench



Buckets  
w/o headrests

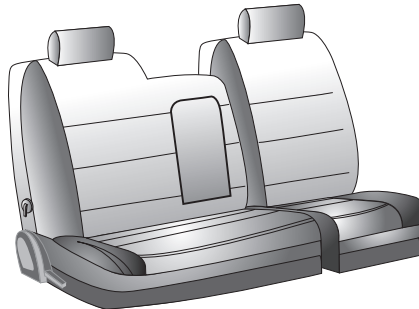

60/40 Split Bench

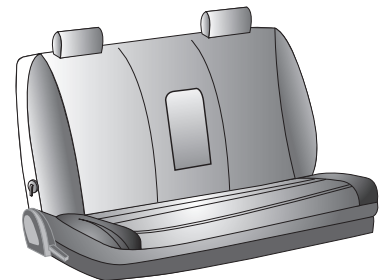

Solid Bench  
w/ headrests



Buckets  
w/ seatbelts

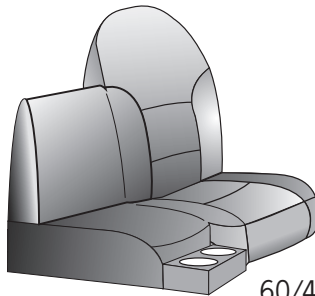

60/40 Split Bench



60/40 Split Bench  
w/ integrated belts

COPYRIGHT 2005 SHRIN CORPORATION

## Removing a Headrest

TABs  
Depress one or both side tabs while lifting headrest. This may require more than one person.

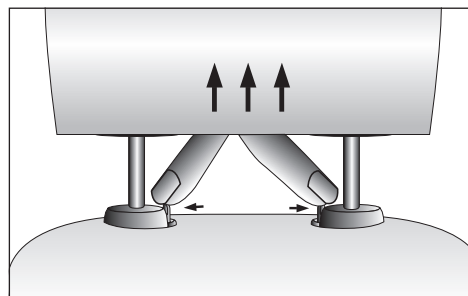
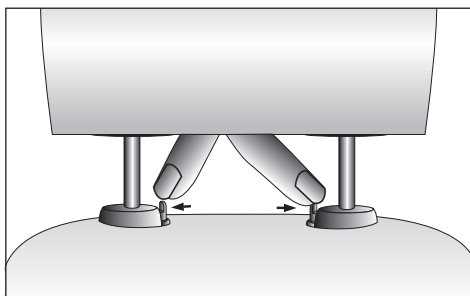
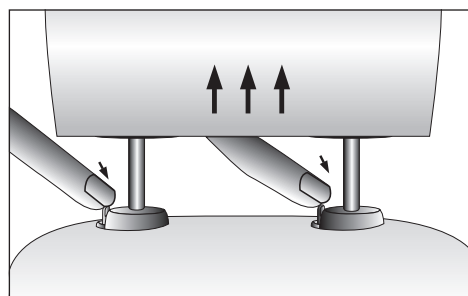
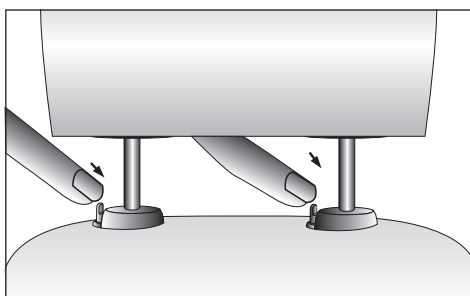
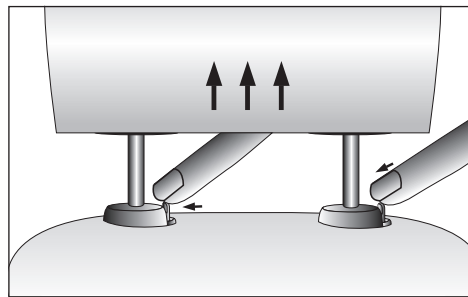
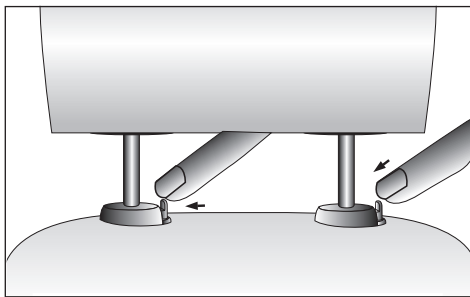
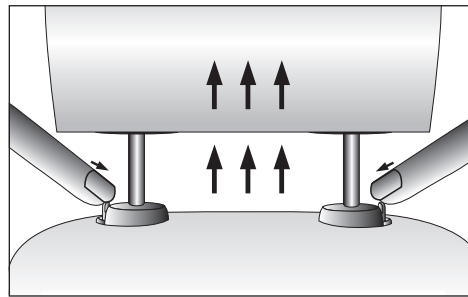
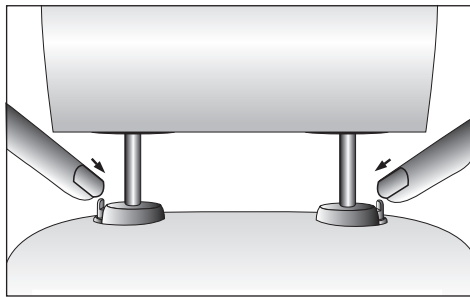
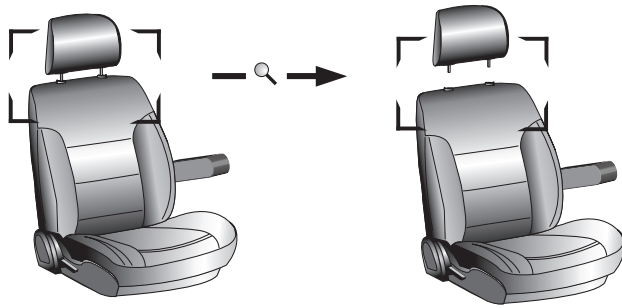

**COPYRIGHT 2005 SHRIN CORPORATION**

## Removing a Headrest

**PIN HOLES on Headrest**  
Insert a paperclip end into the hole on the side of the headrest top.  
While pressing the paper clip, lift headrest

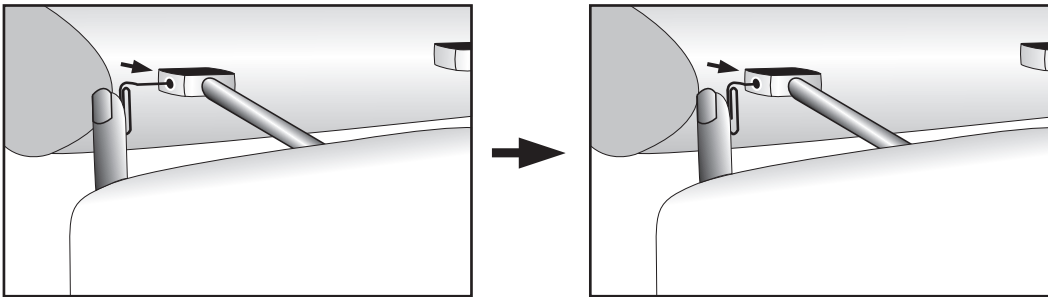
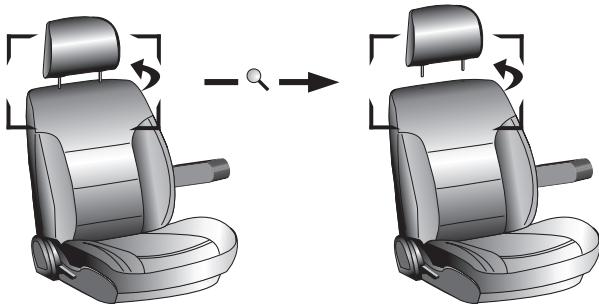

## Removing a Headrest

**SLOT and TAB**  
Depress the tab and press into the slot at the same time, and lift headrest. This requires two or more people.

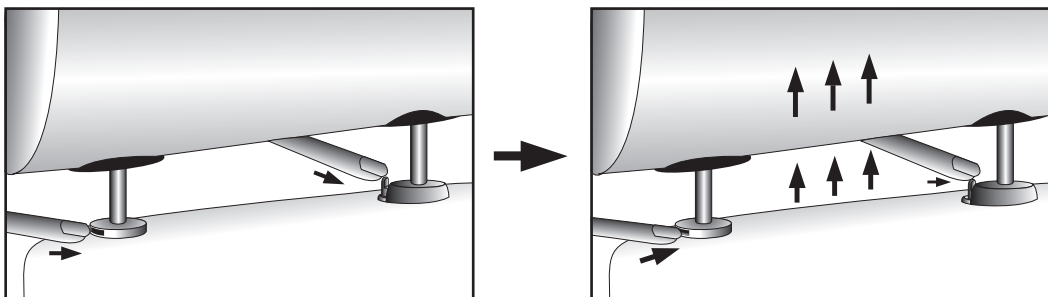
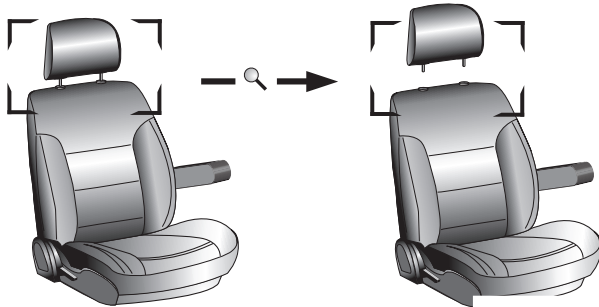

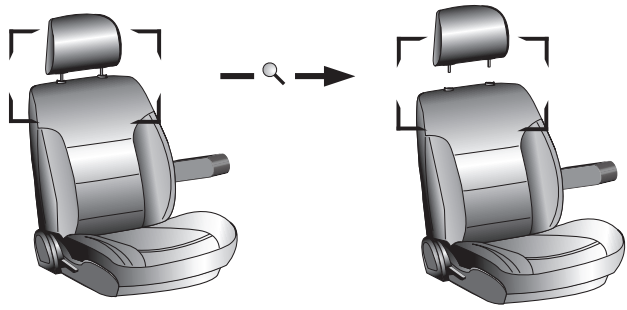

## Removing a Headrest

PIN HOLE and TAB

Insert a paperclip end into the hole on the side of the headrest base. While pressing the paperclip, press the tab on the other base. While pressing both, lift the headrest. This requires two or more people.

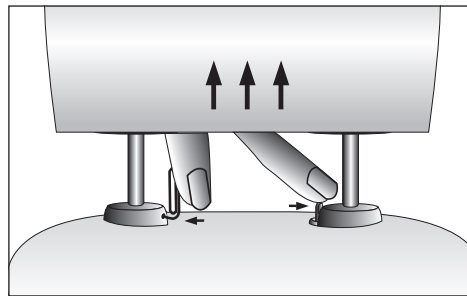
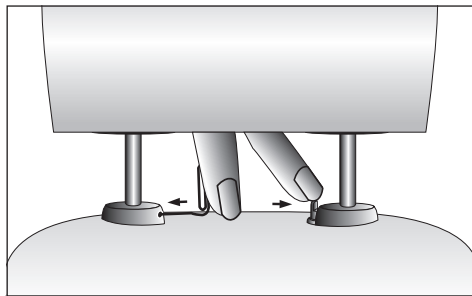
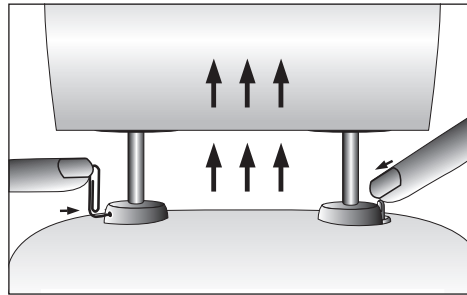
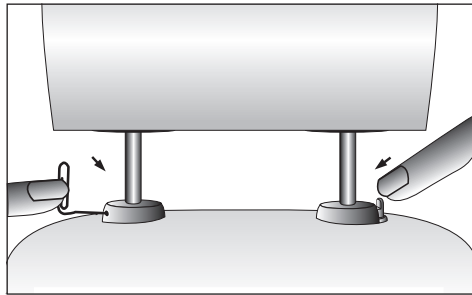

COPYRIGHT 2005 SHRIN CORPORATION



## Backrest Cover Installation

Bucket Seats with  
Non-Removeable Headrest

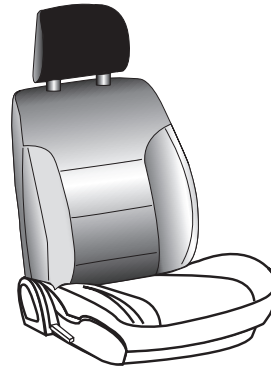
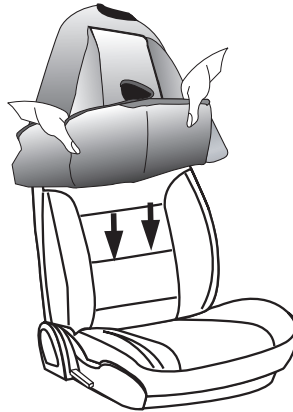
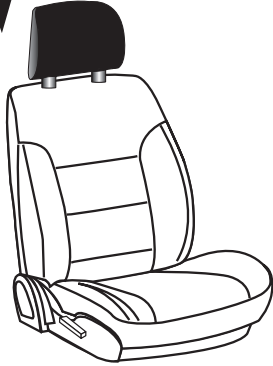
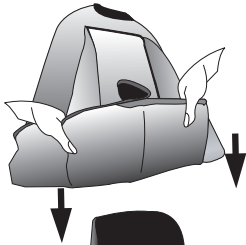

*TIP: Fold the seatback forward to gain better access while passing the flap through*



## Backrest Cover Installation

Certain Seats Required to be  
Folded forward for proper installation

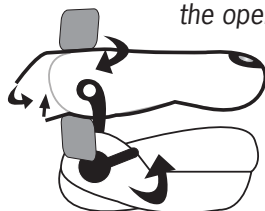
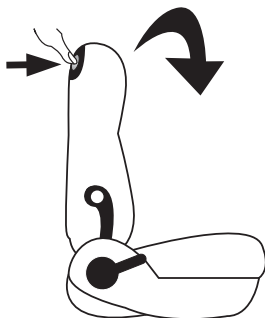
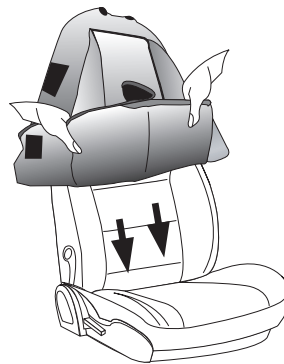
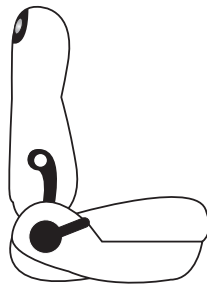
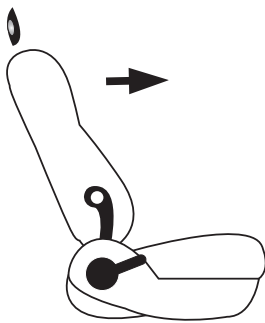

*Attach velcro to the flap which is passed through the opening between seatback and seat bottom.*

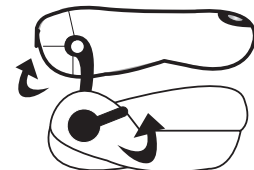
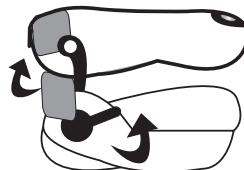



COPYRIGHT 2005 SHRIN CORPORATION

## Backrest Cover Installation

### Bucket Seats w/ Integrated Seat Belts

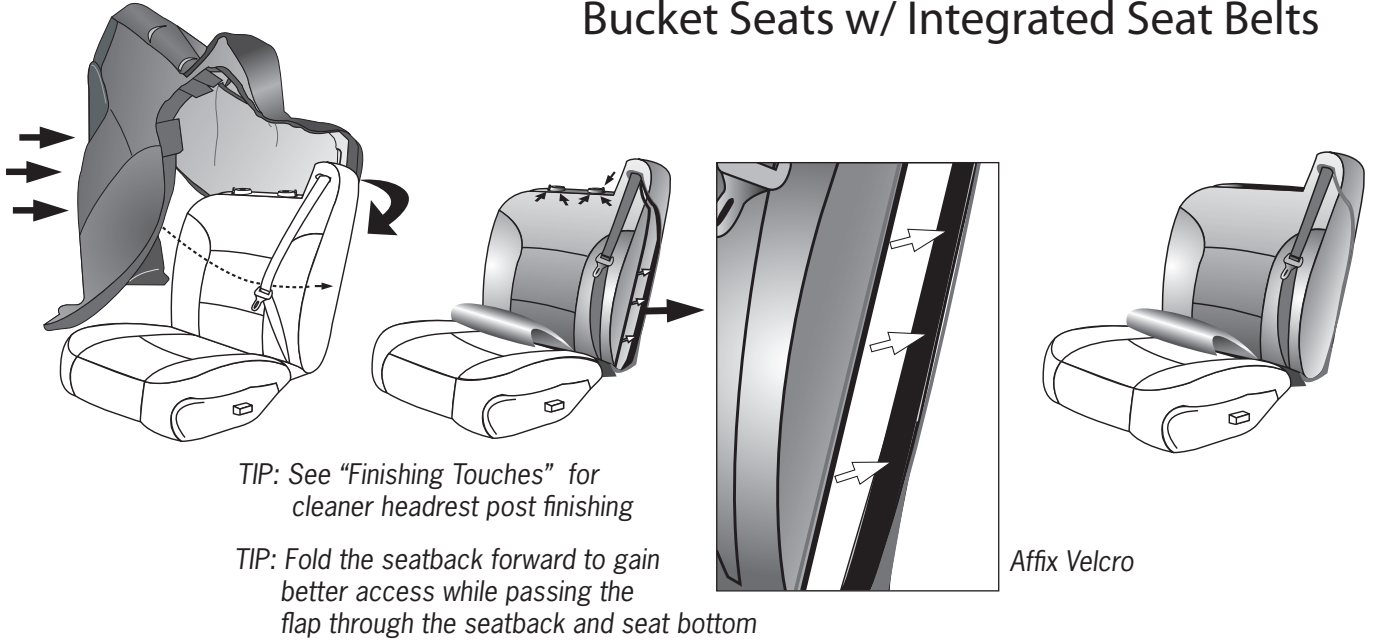

## Backrest Cover Installation

### High-Back Bucket Seats

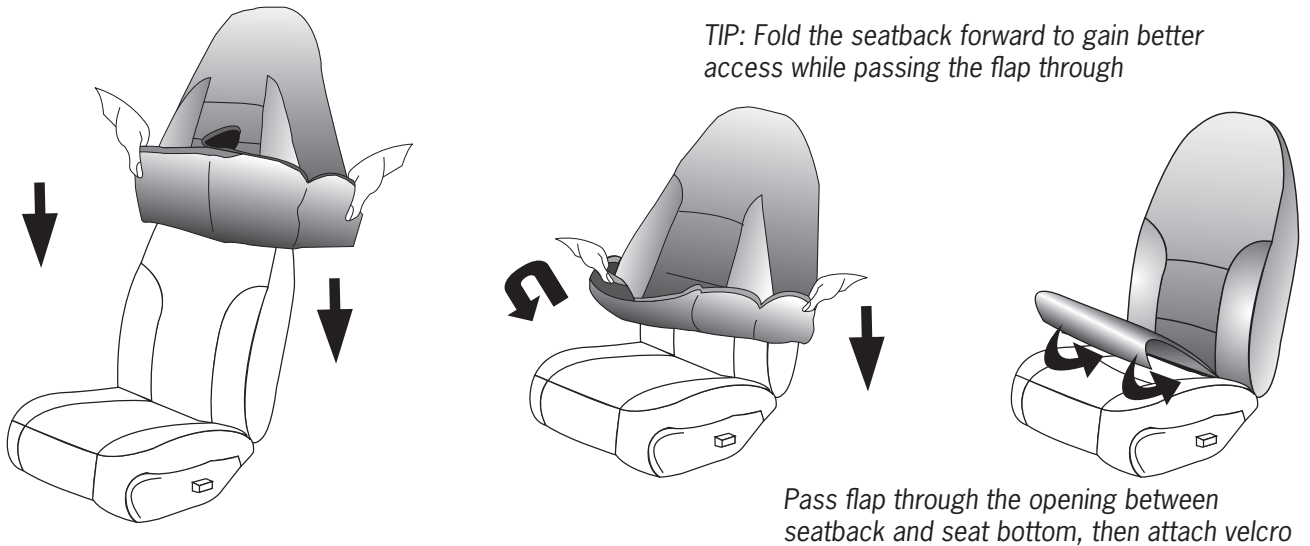



**COPYRIGHT 2005 SHRIN CORPORATION**



## Backrest Cover Installation 60/40 Split Bench

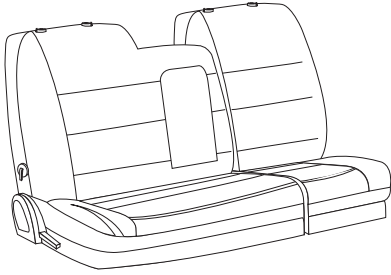

See "Removing a Headrest" section for details on removing headrests.

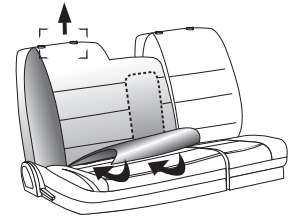
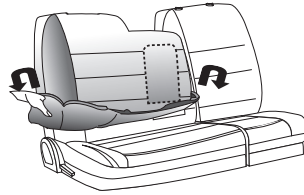
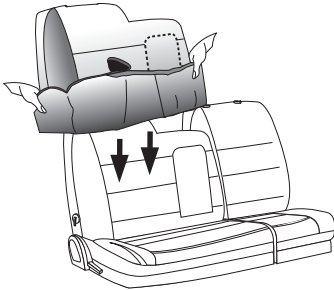

*TIP: Fold the seatback forward to gain better access while passing the flap through*

*Pass flap through the opening between seatback and seat bottom, then attach velcro*



## Backrest Cover Installation Special - for older Jeep models

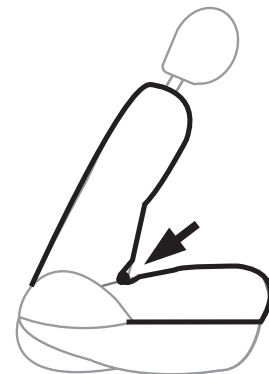
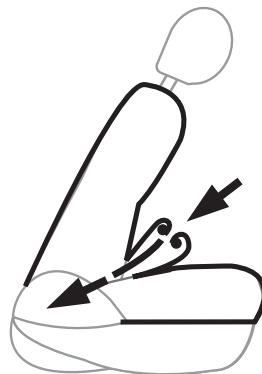

COPYRIGHT 2005 SHRIN CORPORATION

# Seat Bottom Cover

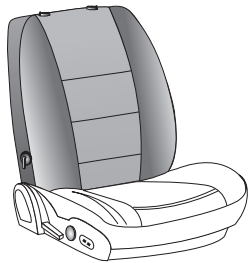

*TIP: Fold the seatback forward to gain better access while passing the flap through*

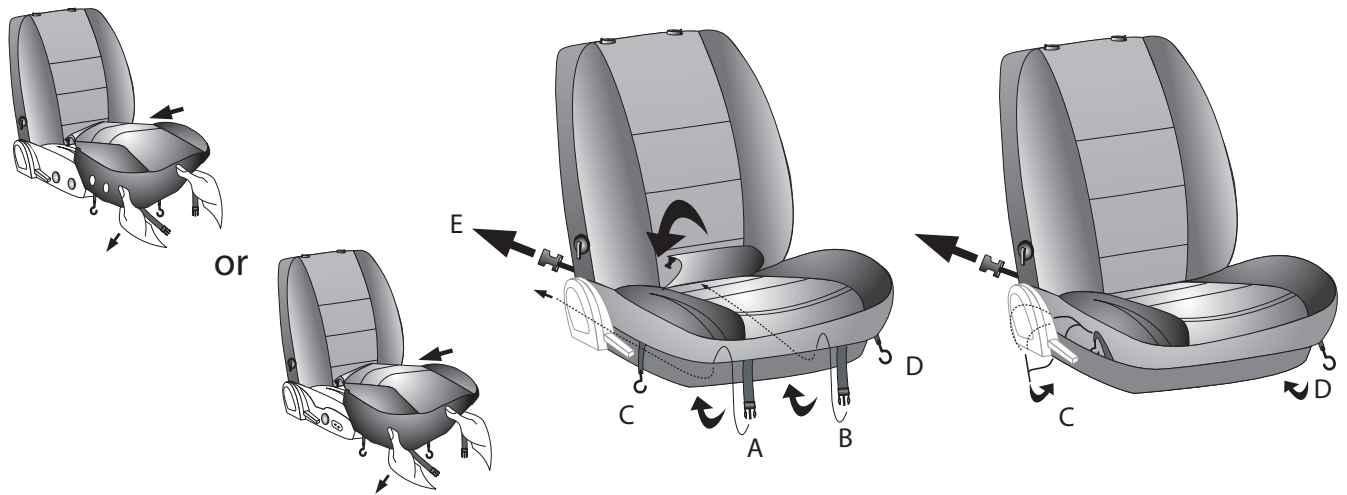

Note: Some seat bases are not covered.

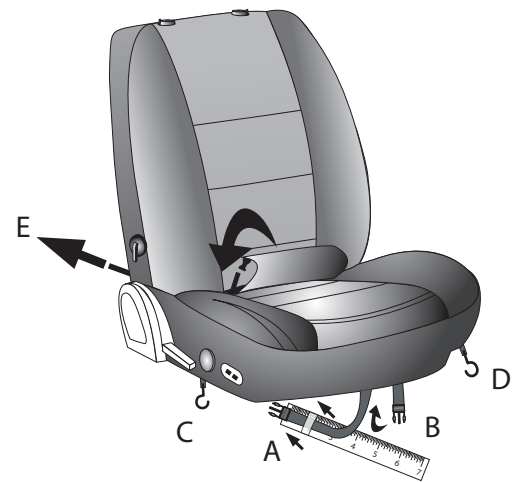
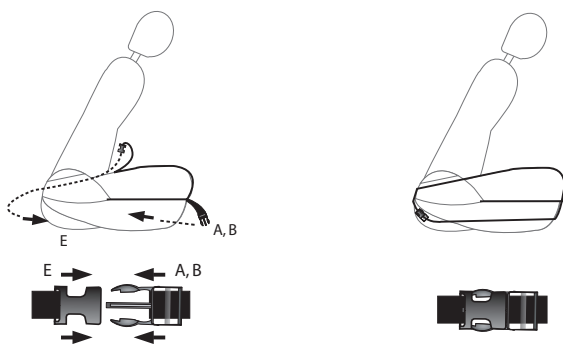

Position cover over seat bottom. Pass flap through and attach buckles and hooks.

*TIP: Tuck excess material behind plastic trim pieces for an extra custom look.*

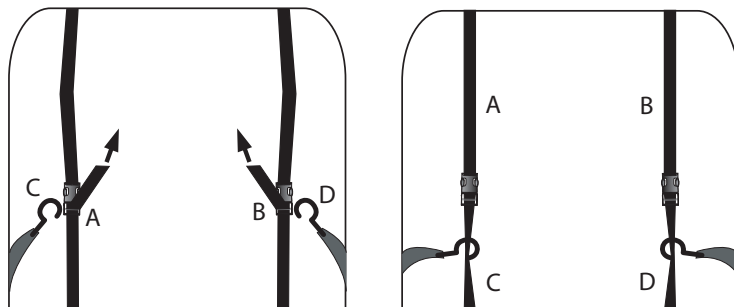

**COPYRIGHT 2005 SHRIN CORPORATION**

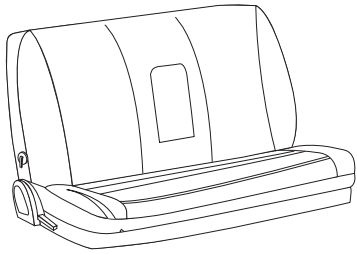

## Solid Bench

Follow these simple instructions if you have a solid bench seat (Three people can sit on the seat) (with and without headrests)

*TIP: Fold the seatback forward for easier access*

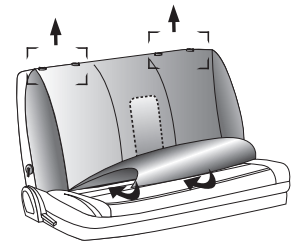
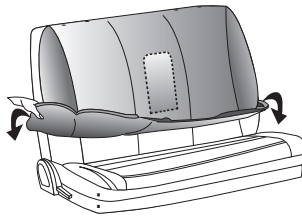
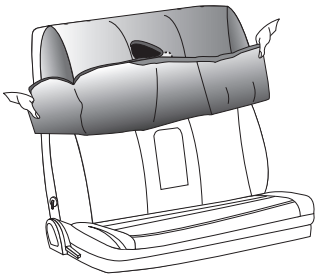

Place backrest cover over backrest. If the seat has a folding armrest, place it in the “up” position. If seat has headrests, remove headrests prior to installation (see “Headrest Removal” instructions)

Tuck flap through the opening between seatback and seat bottom.

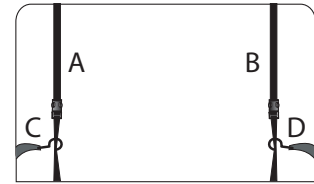
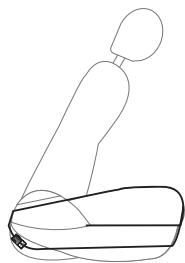
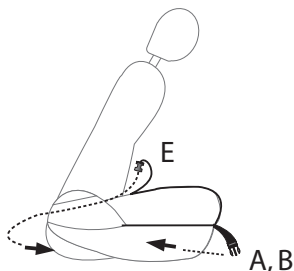
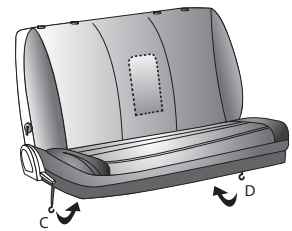
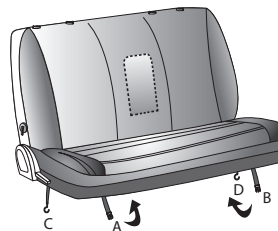
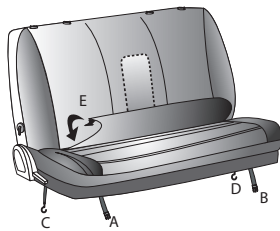
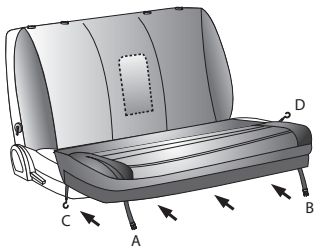

Place seat bottom cover over seat bottom, and affix straps.

See “Finishing Touches” instructions for extra tips



COPYRIGHT 2005 SHRIN CORPORATION  
**Console Cover Installation**

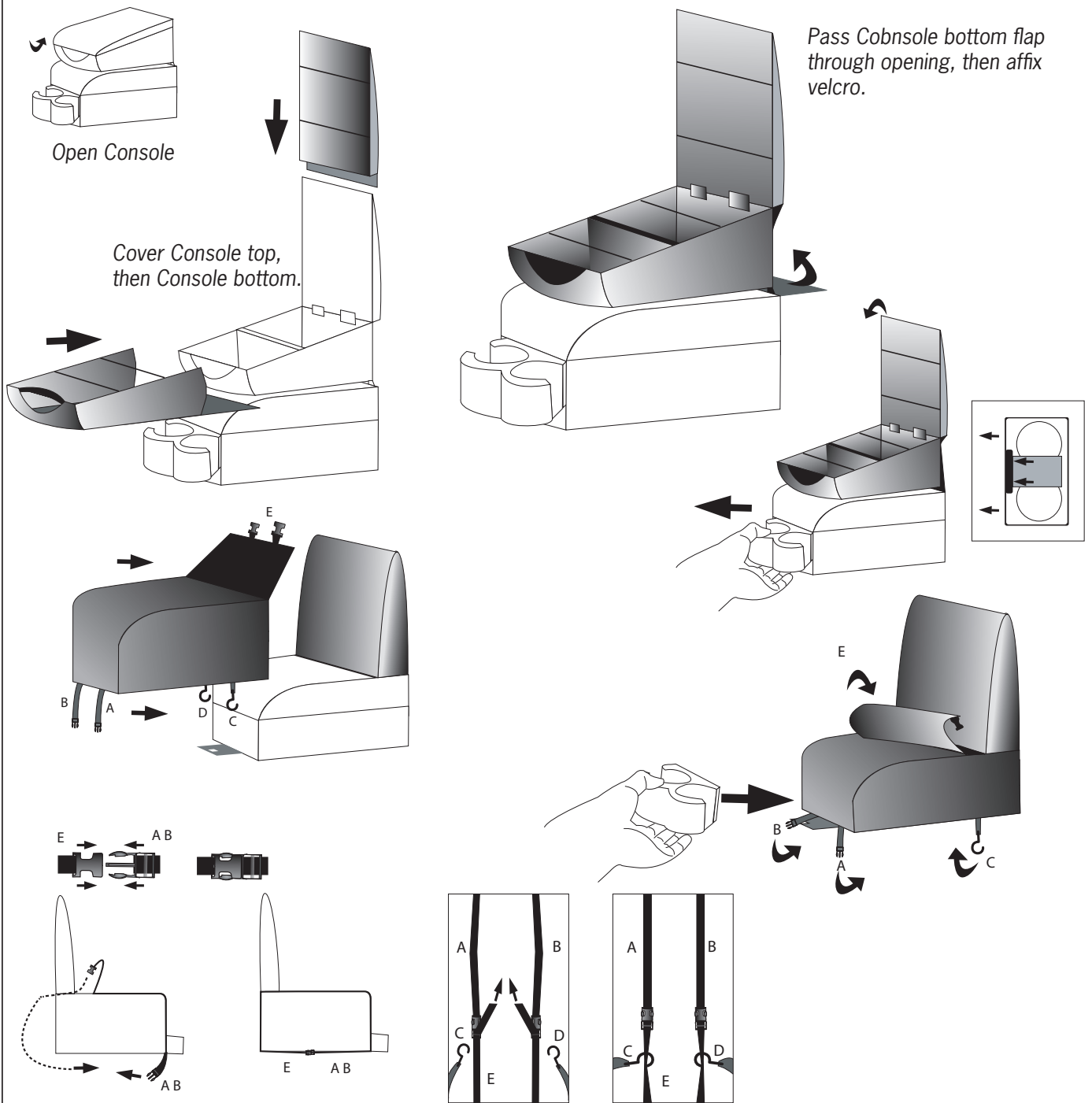
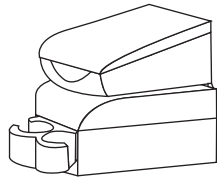

**COPYRIGHT 2005 SHRIN CORPORATION**

# Special Instructions - 1

Seats with Airbags, Lumbar Supports and Armrests require special instructions:



**A**

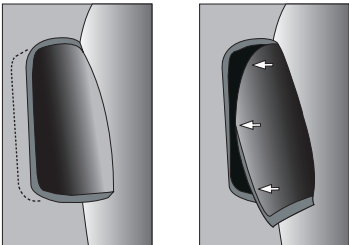

Seats with Integrated Seat Airbags must be covered only with seat covers designed with opening flaps. The flap inserts inside the cutout, and should be able to open freely in case of deployment.

If your vehicle has seat mounted airbags, be certain that the seat covers have airbag cutouts or flaps! **DO NOT COVER SEAT AIRBAGS**

**B**

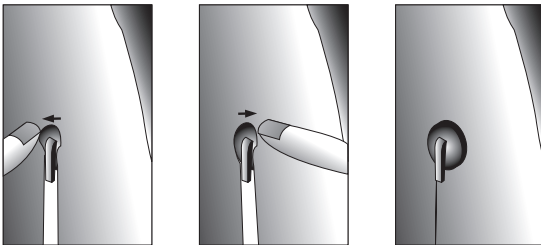

Some levers or controls may require a slit in the seat cover.

**C**

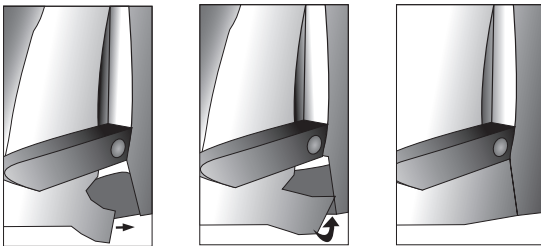

Installing backrest cover around armrests.

**D**

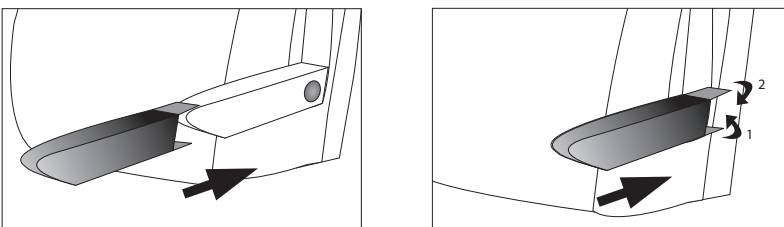

Installing armrest covers, affixing velcro.

**COPYRIGHT 2005 SHRIN CORPORATION**

## Special Instructions - 2

Certain Late-Model vehicles, including Lexus, Toyota, Infiniti, Nissan Hyundai and others have a piece of fabric which prevents the seat cover flap from going through the opening of the seatback and seat bottom.

This flap will need to be removed to install the seat cover. Below are instructions detailing the methods used to remove this fabric

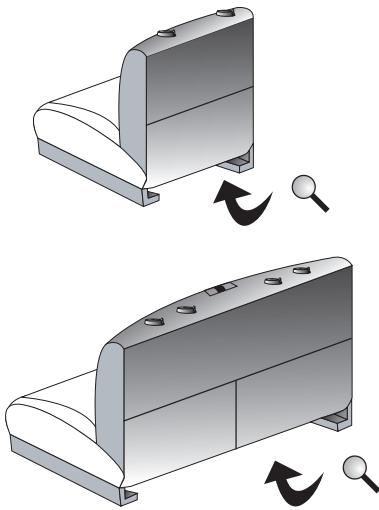

The views shown below are looking at the bottom of the seat

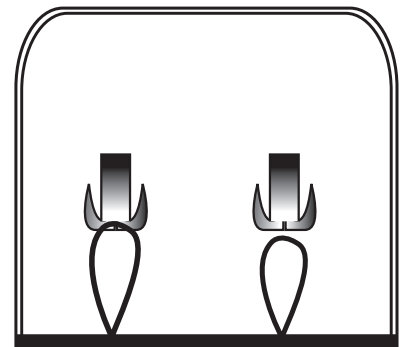
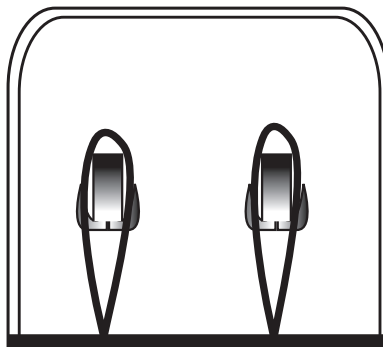
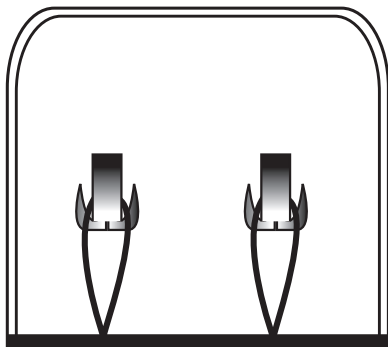

**CONDITION 1** - An elastic strap holds the flap of fabric to some permanently mounted hooks. To remove, simply pull the elastic forward and remove the elastic loop from the hook.

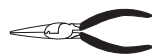
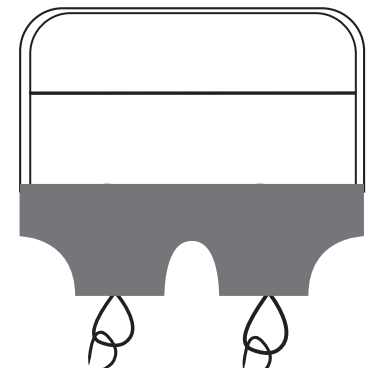
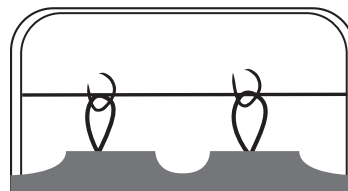
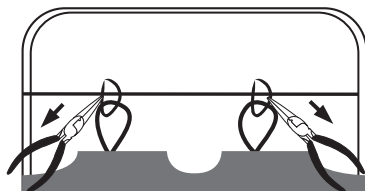

Pliers required

**CONDITION 2** - Metal hoops hold the flap of fabric to a steel support under the seat. To remove, use a set of pliers to open the hoop, and remove the fabric.

**COPYRIGHT 2005 SHRIN CORPORATION**

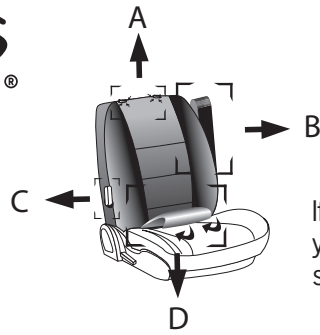

## Finishing Touches

If you have extra time and a little mechanical inclination, your seat covers can fit even better by following these simple finishing touches:

**A**

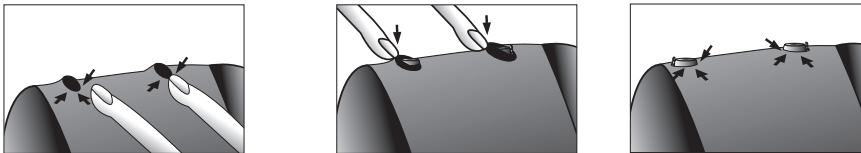

Material around the headrest posts can be stretched over the base and tucked underneath.

**B**

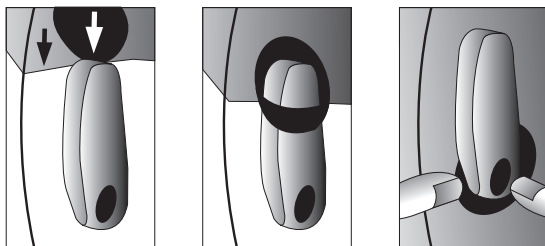

Adjust material around armrests by tucking excessive material around the base.

**C**

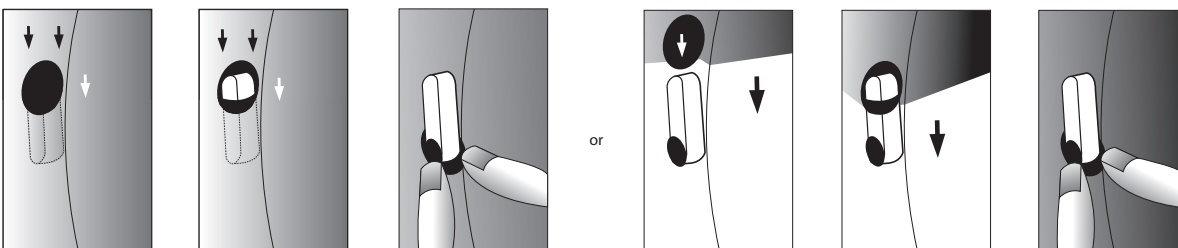

Pay special attention to small levers, such as lumbar support. Material should be tucked under the lever.

**D**

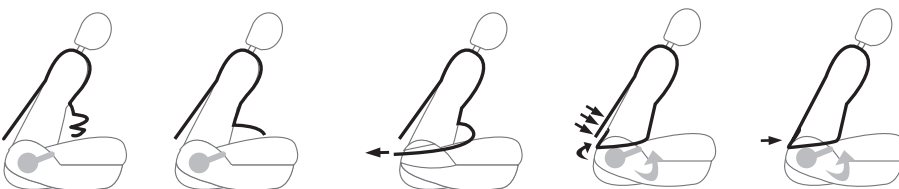

*TIP: Fold the seatback forward for easier access*

After the first two weeks of use, tighten the seat back covers by releasing them, and - using the assistance of another person - pull the material very tight, and affix the Velcro fastener.



**Tel: 1.800.COVERKING**

**Fax: 714.850.0828**

**900 E. Arlee Place**

**Anaheim, CA 92805**

**[www.coverking.com](http://www.coverking.com)**