

SPEC SERIES WINCH FRONT BUMPER

2021+ BRONCO

FBBR-05



TOOLS REQUIRED

- 13mm, 15mm, 16mm, 18mm Socket
- 19mm Deep Socket
- 4mm Allen Bit
- T40 Torx Bit
- Trim Clip Tool

SKILL LEVEL

- Novice/Intermediate
- 2 persons

Little skill level required, however, assistance is required for installation and removal of bumpers.

TIME REQUIRED

- 4 Hours

Time to install this should only take about 4 hours.

WARNINGS/CAUTIONS BEFORE STARTING INSTALLATION

Before you install this kit — Read and understand all instructions, warnings, cautions, and notes contained in this installation instruction guide. Consult your vehicle owner's manual for proper disconnection of electrical and lifting of vehicle if required for installation of this product.

This install may require some technical skills and knowledge of basic mechanical work. If you do not feel that you are capable of performing this install please take this product to a trained professional.

After reading this guide please contact us with any questions or concerns before installing product.
Customer Service: 855-680-9595

DV8 Offroad is not responsible for any bodily injury or harm to you or your vehicle as a result of an improper install.

Proper installation of this kit required knowledge of the factory recommended procedures for removal and installation of original equipment components. We recommend that the factory shop manual and any special tools needed to service your vehicle be on hand during the installation. Installation of this kit without proper knowledge of the factory recommended procedures may affect the performance of these components and the safety of the vehicle

- Always wear eye protection when operating power tools

Inspect all contents of this package to make sure product is not damaged and all installation hardware has been included. If parts are missing from kit, please be prepared to provide the following information

1. Name of purchase location
2. Bar Code on side of box
3. Date above bar code
4. Date inside box cover



INSTALLATION **MANUAL**

STEP 1

REMOVAL OF FACTORY STEEL BUMPER

Begin by removing the front plastic d-ring guards. Using a screwdriver or push pin remover, remove the (2) pins on the bottom and (2) near the top of the d-ring mount.

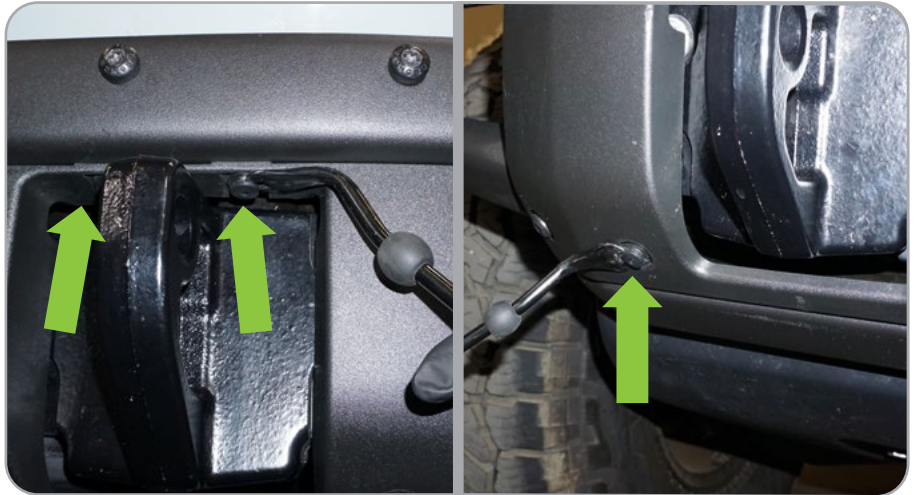

Pull the top half away from the Bronco and set to the side. Repeat for the other side.



STEP 2

Using a 15mm socket, loosen the (3) bolts on each side.

Note: When you do this, the bumper can become free from the vehicle and can fall. Ensure you have another person holding it, or the bumper secure to prevent falling and injury.



INSTALLATION MANUAL

STEP 3

Once all bolts are loose, remove the plug for the fog lights and front sensors if equipped. This is located at the back end of the grill on the driver side.



STEP 4

Once unplugged, remove all (6) bumper bolts and d-rings mounts. Set bumper face down off to the side.



INSTALLATION MANUAL

STEP 5

Remove the rubber/plastic shroud under the grill by pulling the tabs on the shroud away (up/down) from vehicle while pulling the shroud from the vehicle.

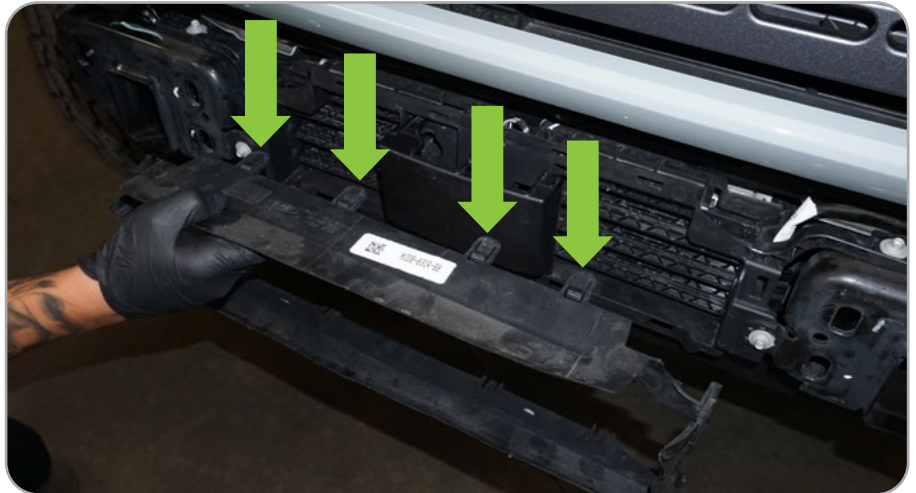

STEP 6

If you do not have adaptive cruise control, remove the plastic cover by pushing the clip on the top down while pulling away from Bronco, and set off to the side.

Note: If you have adaptive cruise control, you will need to relocate the module using our ABBR-01 to retain the functionality (Adaptive Cruise Control Relocation Bracket).



STEP 7

Reach behind each bumper mount on the frame rail and remove the factory nut plate.



INSTALLATION MANUAL

STEP 8

If equipped with sensors, remove the main bumper brackets from the backside of the bumper using a 13mm socket, remove the (4) hex head bolts.

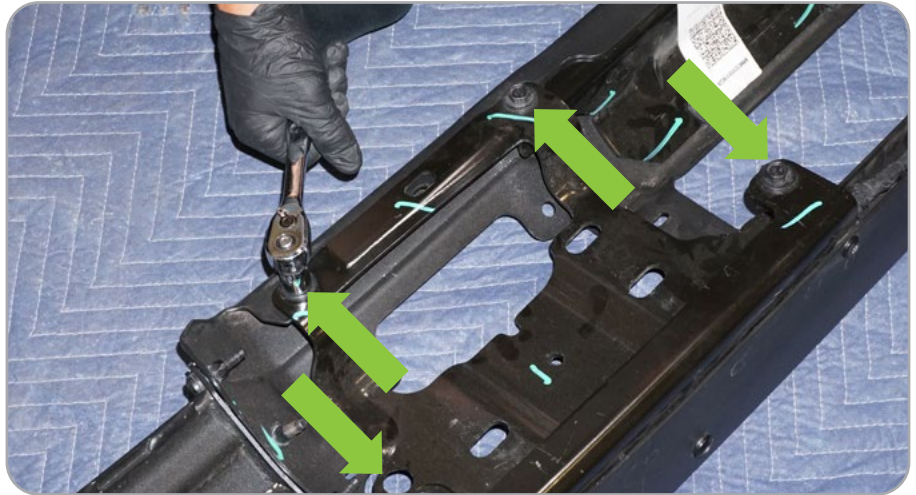

STEP 9

Next, using a T40 torx bit, remove the (6) bolts securing the mount in place. Once removed, gently separate mount from bumper, and set off to the side.



INSTALLATION MANUAL

STEP 10

To remove the wire harness, using a flat head screwdriver or pin puller, remove all the retaining clips securing the harness to the bumper.



STEP 11

To remove the sensors, spread the two tabs on the sensor bezel and gently pull up on the sensor. Make sure that the rubber ring around the sensor head remains on the sensor.



STEP 12

Lastly, gently squeeze the same two tabs on the sensor bezel and push the backside of the sensor to remove the bezel. Continue the same steps on the remaining sensors.



INSTALLATION MANUAL

STEP 1

Begin by unpacking all items and inspecting for missing pieces or damage. If you have any concerns, please contact the company the product was purchased from.

Hardware Included:	(3) M8x40 Hex
(4) M12x35 Hex	(3) M8 Flat Washers
(8) M12 Flat Washers	(9) M8 Spring Washers
(4) M12 Nylon Nuts	(10) M8x30 Allen
(6) M10x40 Hex	(20) M8 Flat Washers
(6) M10 Flat Washers	(10) M8 Serrated Nuts
(6) M10 Spring Washers	(16) M6x20 Allen
(6) M10 Flat Nuts	(4) M6 Serrated Nuts
	(20) M6 Flat Washers



STEP 2

Apply the adhesive side of the provided foam pieces to the wings of the bumper.



STEP 3

Use an 18mm and 19mm deep socket with the provided M12 hardware to loosely secure the wings to the bumper.

Adjust the wings so that they sit flush with the bumper and then finish securing the hardware.

Note: A deep socket is needed to access the nut in the recessed area of the bumper.



INSTALLATION MANUAL

STEP 4

Apply the adhesive side of the provided foam to the bull bar.



STEP 5

Use the provided M6 hardware with a 4mm allen bit to secure the bull bar to the bumper.



STEP 6

Install the flat nuts by pressing them into place on the bumper mounts.

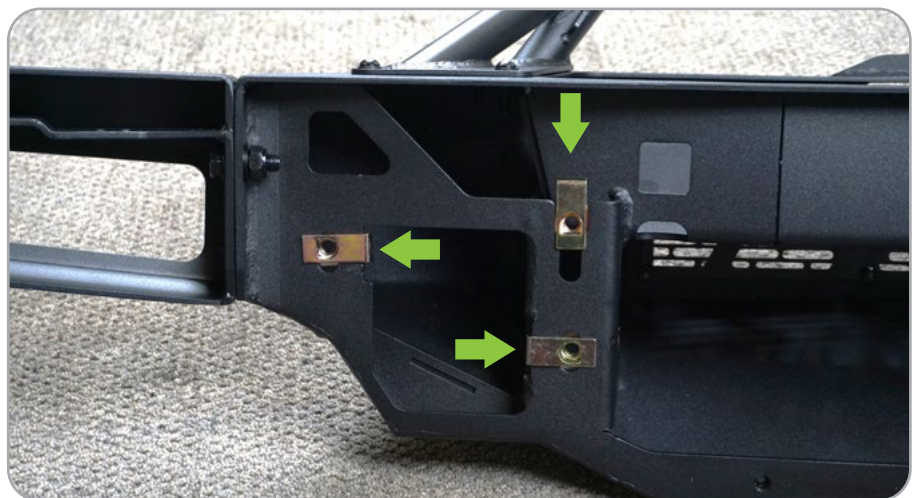

INSTALLATION MANUAL

STEP 7

If you are installing pod lights in the wings, do so at this time using the hardware provided with the lights.

If you are not installing pod lights, skip to the next step.

*Note: We are using 3" elite series amber pod lights for our install.
Part Number: BE3EW40W-A*



STEP 8

Feed the bumper wiring harness through the access holes in the bumper.

The plug that connects to the vehicle should be on the driver side. The sensors should be at their approximate location of install.

If you do not have a wiring harness, skip to the next step.



INSTALLATION MANUAL

STEP 9

Install the sensors bezels by pressing them into place.

These are keyed for installation, and should easily pop into place.

You can also reference the bezel for correct placement,

Example: “ROR” means “Rear Outer Right”

If not equipped with sensors, use provided sensor plugs.



STEP 10

Press the sensors into their bezels until they are secure. They should “clip” into place.

If you do not have sensors, skip to the next step.

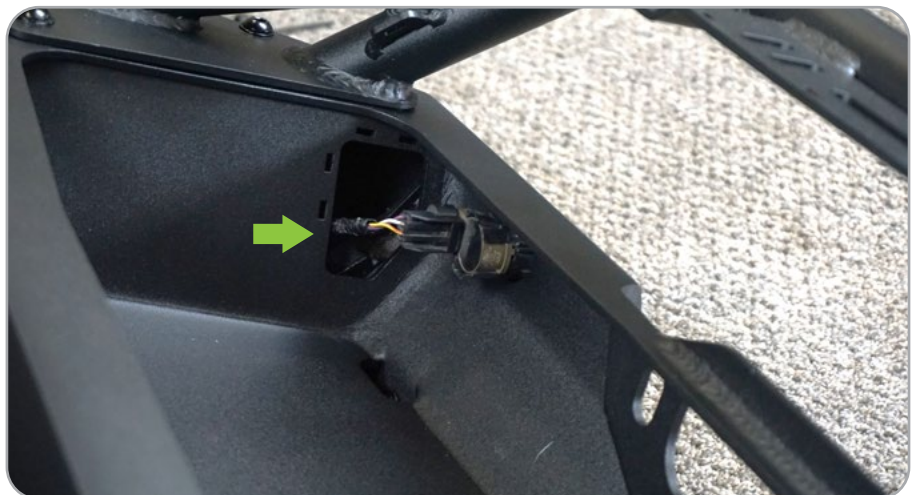

INSTALLATION MANUAL

STEP 11

Ensure any wiring is secure and will not be pinched during the install of the bumper using the wiring access holes.

Utilize zip tie tabs, if desired.



STEP 12

If you are installing a 20" single row LED light bar, do so at this time using the provided mounting bracket.

Install the bracket into the bumper and secure using the provided M6 hardware and a 4mm allen bit.

Mount the light bar onto the bracket using the hardware provided with the light.

Adjust the light until you are satisfied with the fitment and then finish securing the hardware.

We also offer additional brackets for additional light mounting solutions.

If you are not installing a 20" single row LED bar, skip to the next step.



INSTALLATION MANUAL

STEP 13

If you are installing a winch, do so at this time using the hardware provided with the winch.

There is an additional access hole near the passenger side mount for running the wiring from the winch.

If you are not installing a winch, skip to the next step.



STEP 14

Install the side caps on the skid plate using the provided M6 hardware with a 4mm allen bit.



INSTALLATION MANUAL

STEP 15

With assistance, lift the bumper to the vehicle and loosely secure it using the provided M10 hardware with a 16mm socket.

Ensure the wiring is not being pinched between the bumper and vehicle. Adjust the bumper up/down as necessary to sit even.

There should be no large gaps between the bumper/wings and vehicle. Finish securing hardware when bumper is adjusted as desired.

Note: Assistance is required to prevent injury and damage to the product and vehicle.

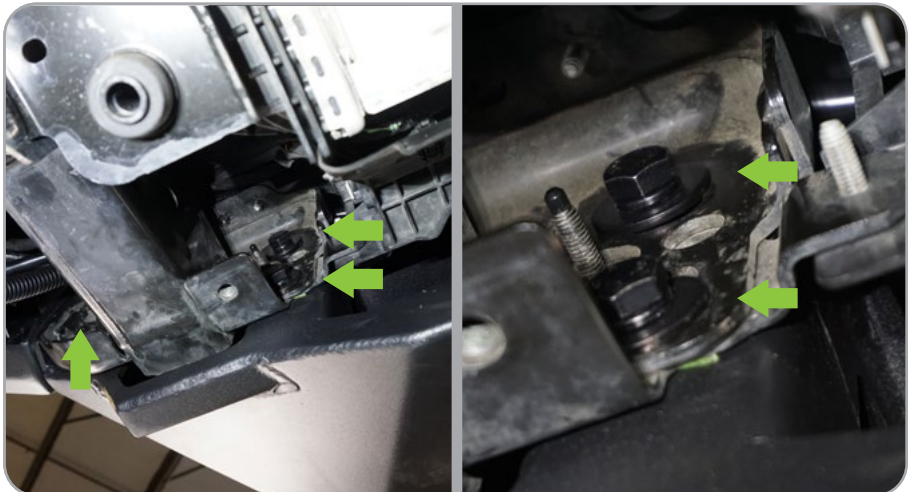

STEP 16

Lift the skid plate under the vehicle and loosely secure it using the factory hardware with a 16mm socket and factory mounting locations.



INSTALLATION MANUAL

STEP 17

Secure the skid plate to the bumper using the provided M8 hardware with a 13mm socket.

The holes in the skid plate allow for access to reach the mounting locations.

Then finish securing the skid plate by securing the factory hardware and a 16mm socket.

Note: Do not over-tighten these three bolts. They should be secure, but over torquing them can result in breaking off the weld on the nut.

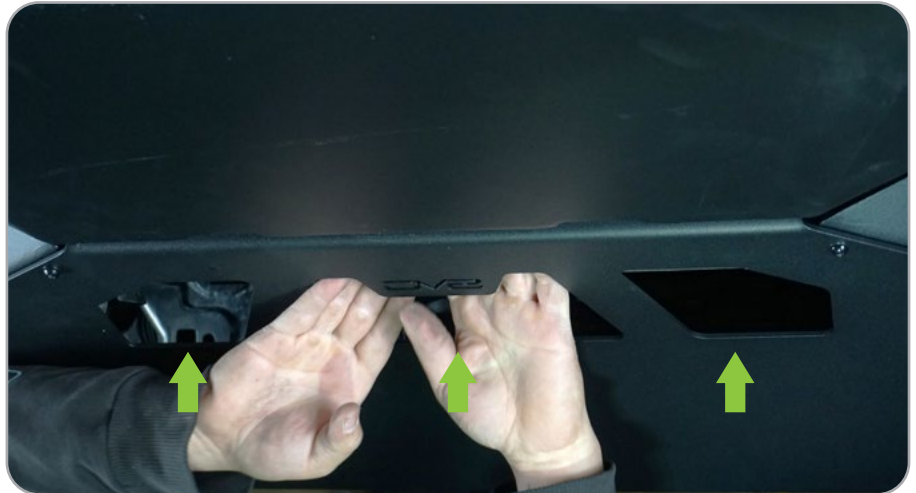

STEP 18

If you are installing a fairlead, do so at this time using the hardware provided with the fairlead.

If you are not installing a fairlead, skip to the next step.



INSTALLATION MANUAL

STEP 19

Double check fitment and all hardware is secure.

Congratulations, you are finished with the install of the 2021+ Ford Bronco Spec Series Front Winch Bumper.

