

Electric Life JE13-KIT

2007 and up Jeep Wrangler 2 door & 4 door front Installation Instructions

Installing the motor and regulator assembly

1. Remove door panels. Remove inner door panel.
2. With window lowered, remove screws securing the window from positions 6 & 7. Lift window out of mounts and secure window to top of door.
3. Remove screws from positions 1, 2, 3, 4 & 5 and remove window regulator from the backside of panel. Save screws.
4. Insert window motor into position 1, 2 and 3 on the outside of the inner panel. Use large nuts in kit to attach motor to position 1, 2 and 3.
5. Install new power window regulator onto backside of panel and secure with original screws into positions 4 & 5.
6. Carefully cut tie strap off of cable spool assembly. Do not allow spool to move away from the guides on the plate. If this happens the cables on the spool may unwind. Place motor plate and spool over the motor shaft and gear. Make sure that the spool and motor gears are aligned properly. Do not force into place. Attach plate to motor with bolts supplied in kit to positions 1, 2 & 3.
7. Reinstall the inner door panel (complete with regulator and motor) onto the door.
8. Lower window into the saddles on the regulator and install bolts into positions 6 & 7
9. Remove the trim rings from the door panels (where the crank handle used to be) and install the panel caps provided in the kit.

Installing switches and wiring

1. Snap the switches into the appropriate bezels. The dual switch mounts in the drivers door and should angle towards the driver.
2. Mount switch mounting bezels into the positions shown in the diagram. The holes may have to be slightly enlarged to allow access to the back of the switches.
3. Run wiring under dashboard and into doors as shown. The relay assembly should be under the left side of the dashboard.
4. Connect the red wire to a constant power source such as the battery or a very large gauge wire under the dashboard.
5. Connect the red/blue wire to a power source that is "ON" when the ignition key is "on".
6. Connect the brown wire to a good chassis ground point.
7. Attach blue and black motor wires to the switches as shown in wiring diagram.
8. Check for proper operation before re-installing door panels.

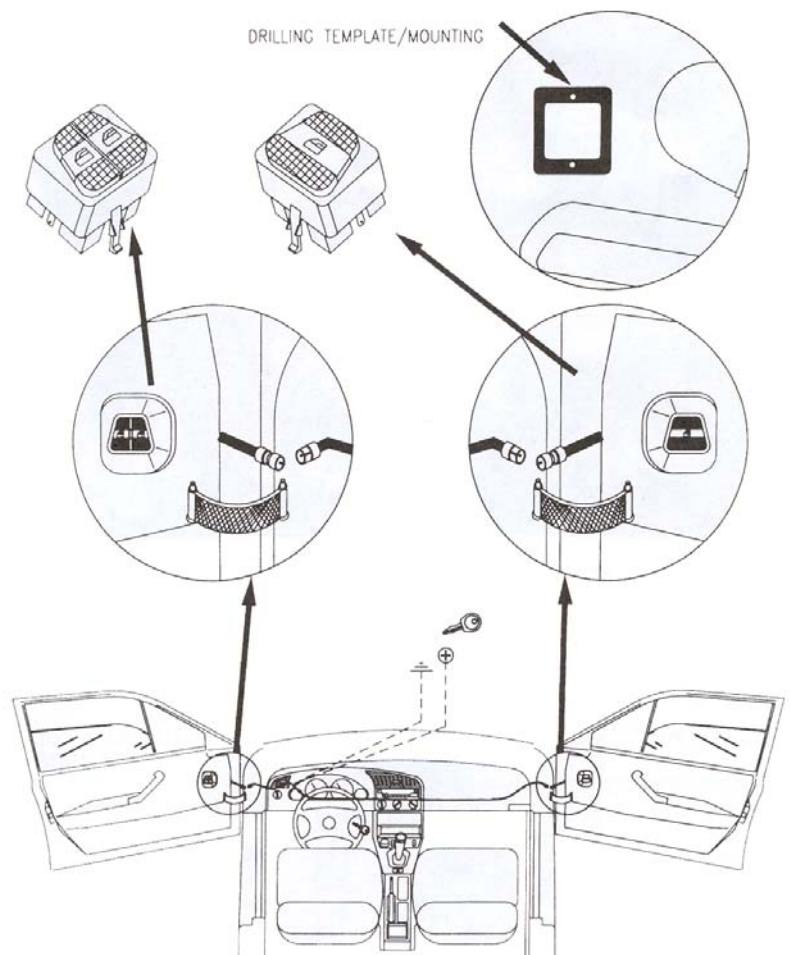

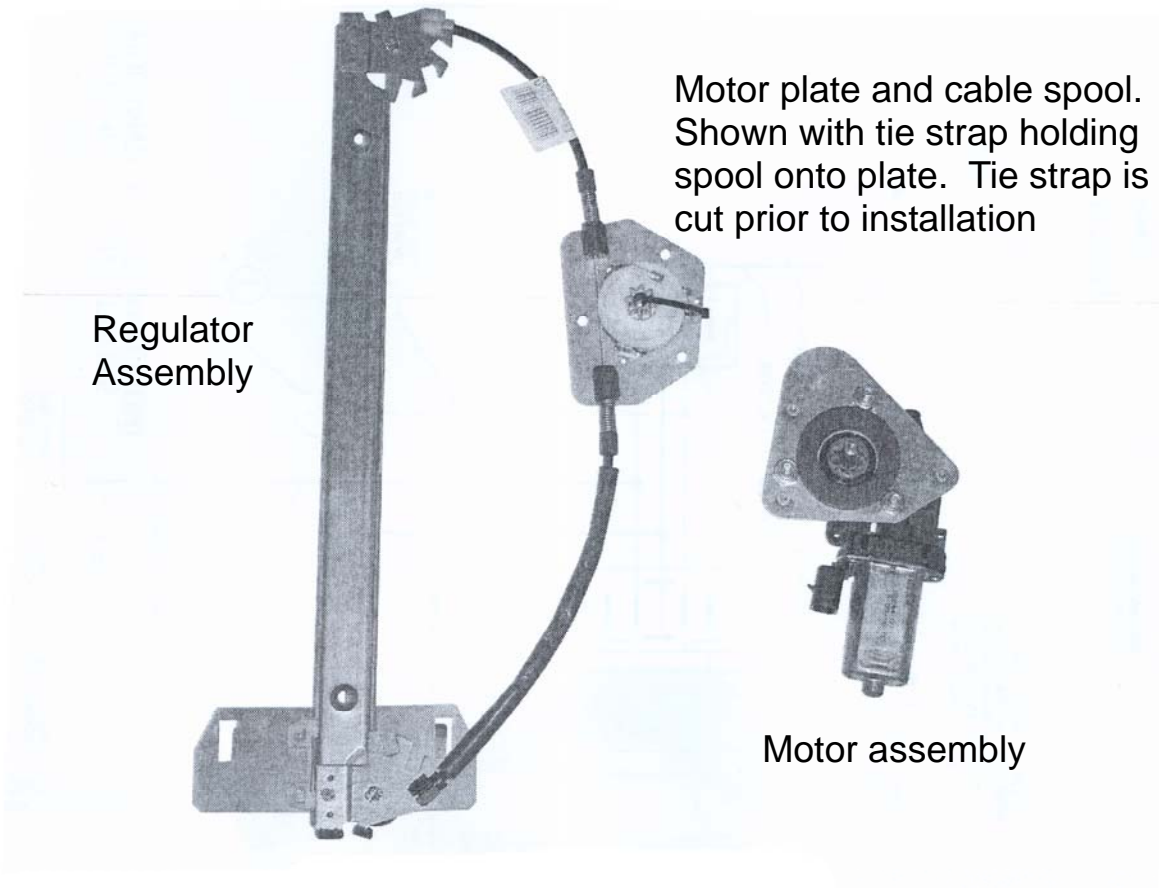

Regulator Assembly

Motor plate and cable spool. Shown with tie strap holding spool onto plate. Tie strap is cut prior to installation

Motor assembly

The motor must be mounted to the panel using the large nuts provided in the kit into positions 1, 2 & 3

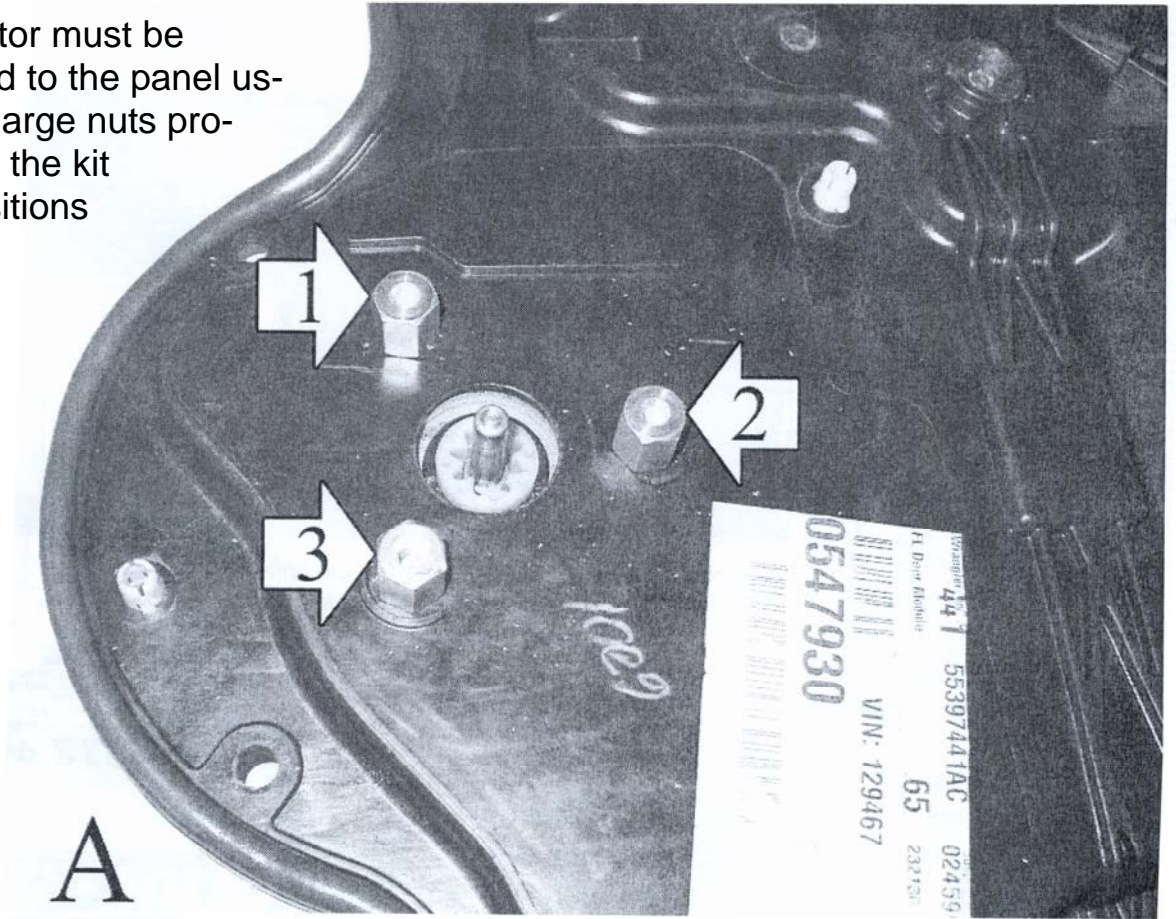

A

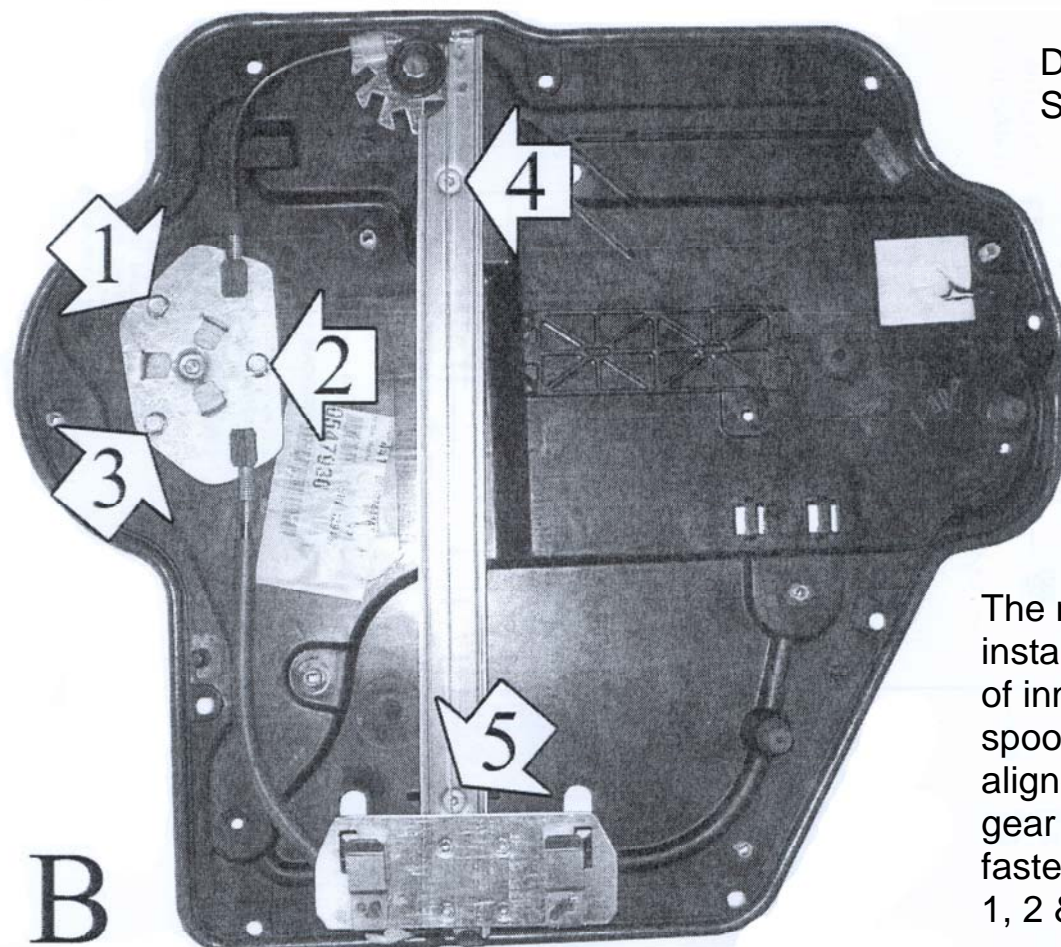

Drivers (Left) Door Shown

The regulator channel is mounted to the panel into positions 4 & 5.

The motor plate is installed on the back side of inner door panel. The spool gear must be aligned with the motor gear before bolts are fastened to positions 1, 2 & 3

B

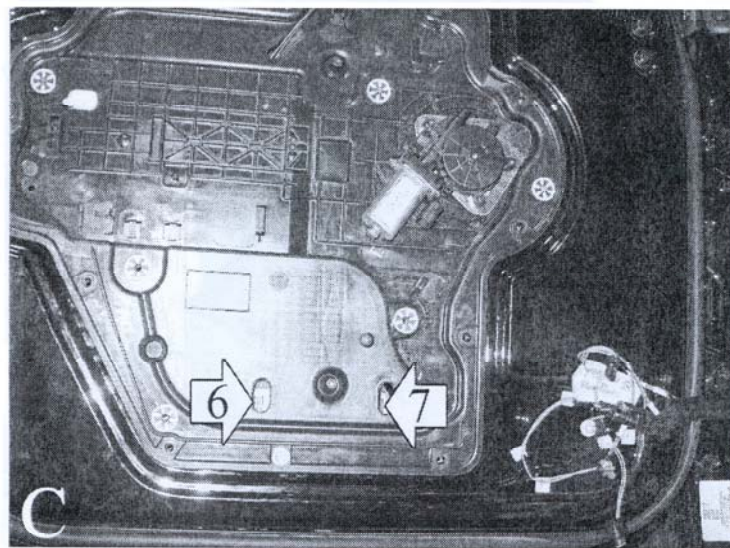

Note the motor mounting orientation on the inner door panel.

6 & 7 show the access holes for the screws that hold the window glass onto the regulator.

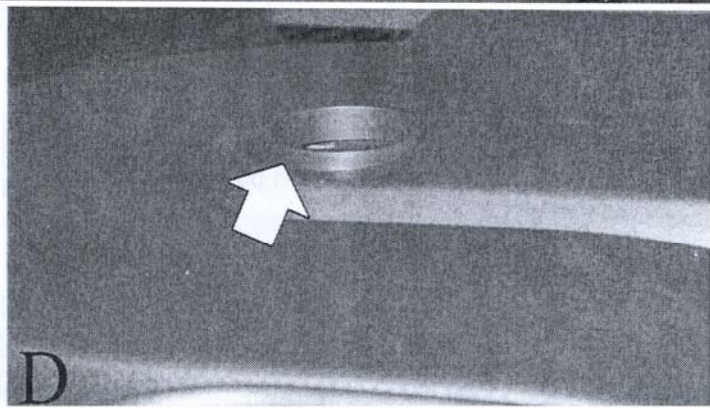

The trim ring on the door panel (where the crank handle used to be) must be removed prior to installing the panel cap.

D

JE13-KIT Wiring Diagram

