

# DOOR PANEL SET

## INSTALLATION MANUAL

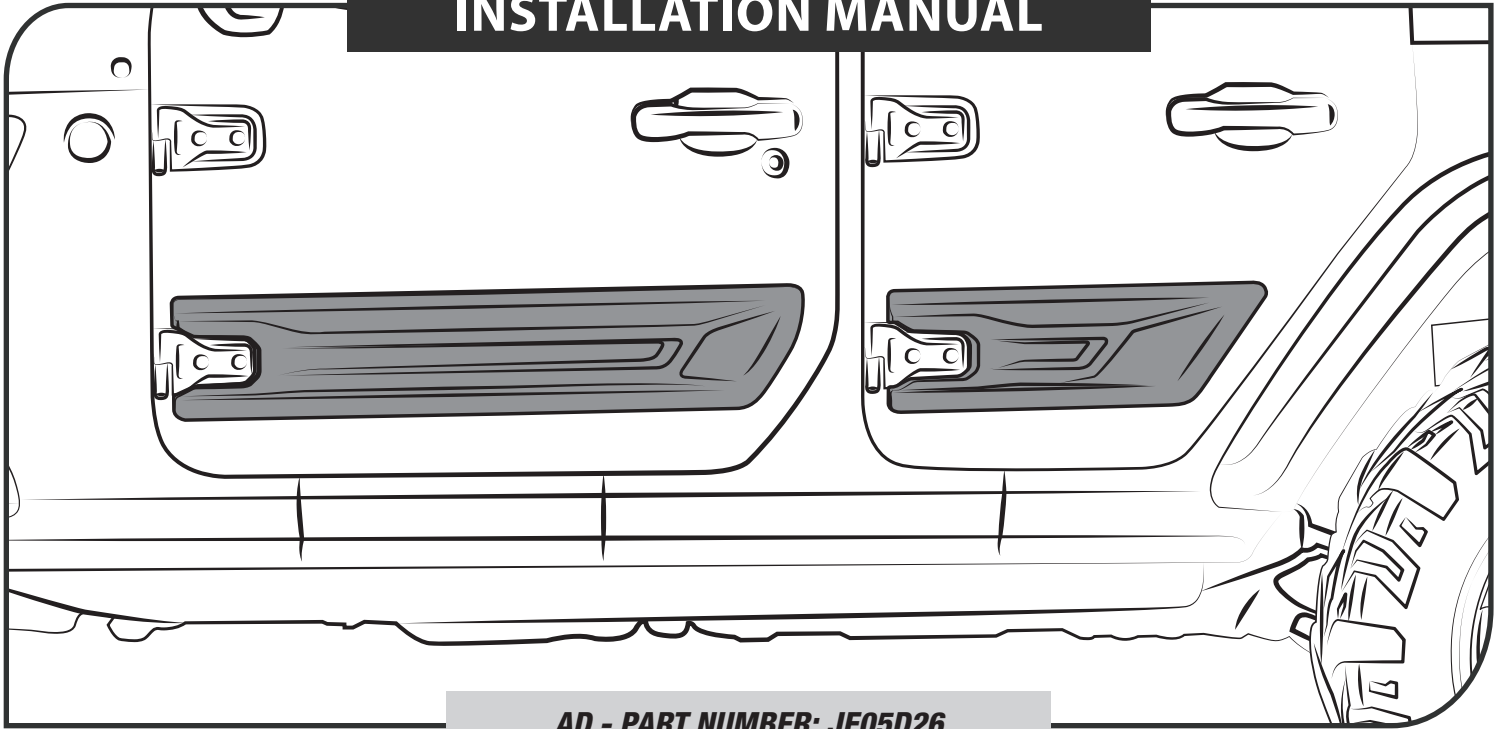

AD - PART NUMBER: JE05D26



**READ CAREFULLY  
BEFORE INSTALLATION**



**WASH BEFORE  
INSTALLING**



**WE RECOMMEND  
2 PERSONS FOR  
INSTALLATION**

### AFTER INSTALLING

**DO NOT WASH CAR**



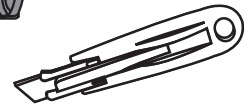
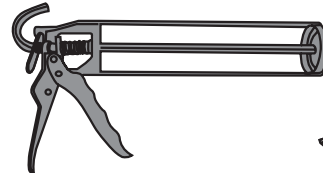

**24 hrs**

### TOOLS



### CHECK LIST

ITEM	DESCRIPTION	DRAWING	AMOUNT
A	*VHB TAPE		N/A
B	GREASE PENCIL		1 PC
C	POLYURETHANE ADHESIVE 310 ml		1 PC

*\*ALREADY INSTALLED ON THE PART*



The ideal temperature range of the part and the vehicle when installing must be 16°C (60°F) to 40°C (104°F), this guarantees a correct assembly.

## FRONT DOOR PANEL

### 1 MEASURE

  
MEASURE 21 cm  
FROM THE DOOR  
HANDLE AND MARK

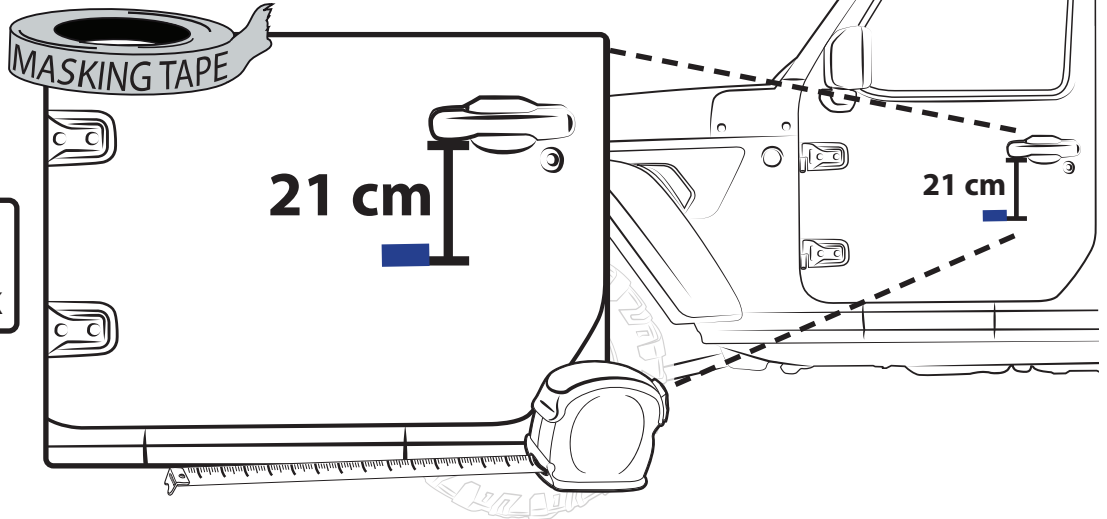

### 2 CLEAN THE INSTALLATION ZONE



  
CLEAN IN ONE DIRECTION TO  
REMOVE DIRT PROPERLY

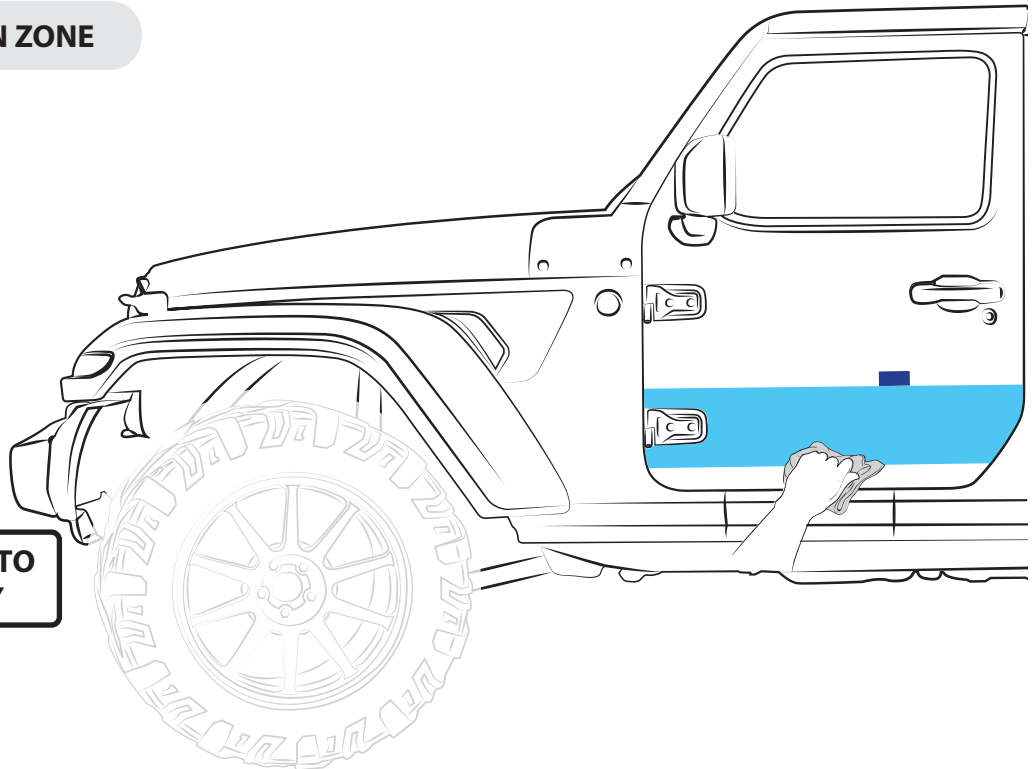

### 3 TEST FIT THE DOOR PANEL

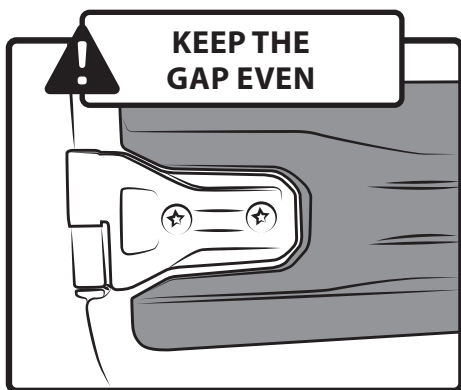

  
ALIGN WITH  
THE MARKING

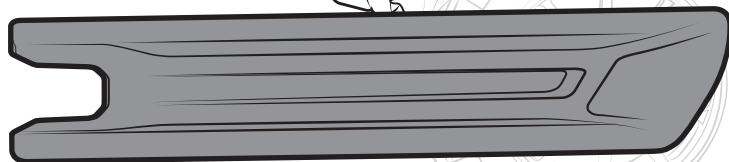

# DOOR PANEL SET - WRANGLER JL 2018+ INSTALLATION MANUAL

## 4 MARK THE OUTLINE

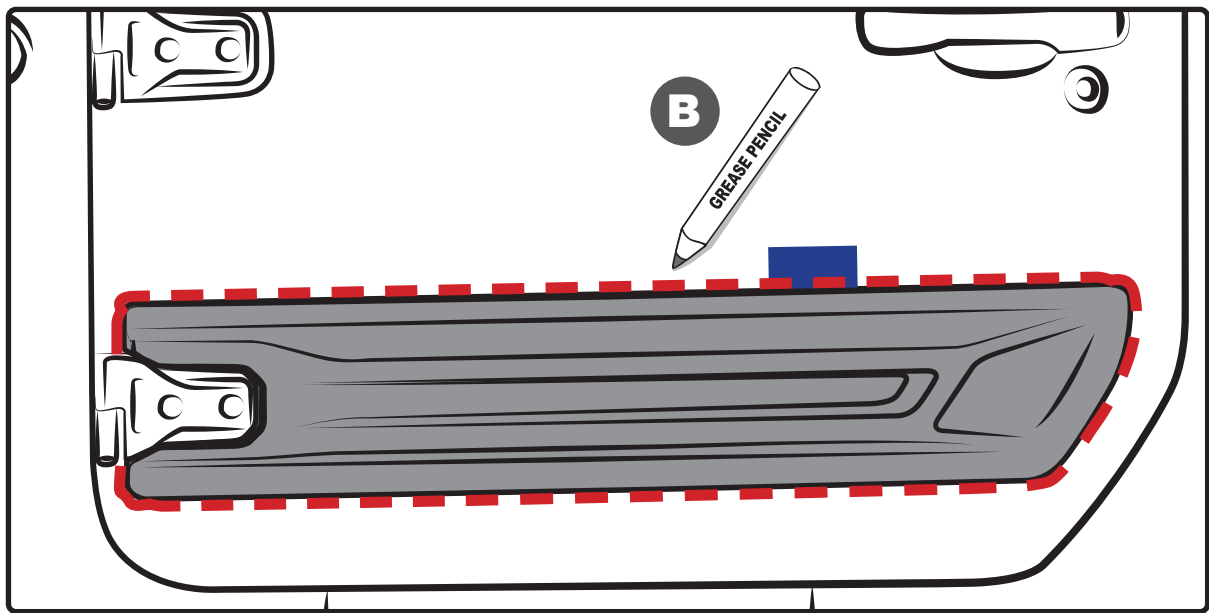

## 5 REMOVE THE DOOR PANEL

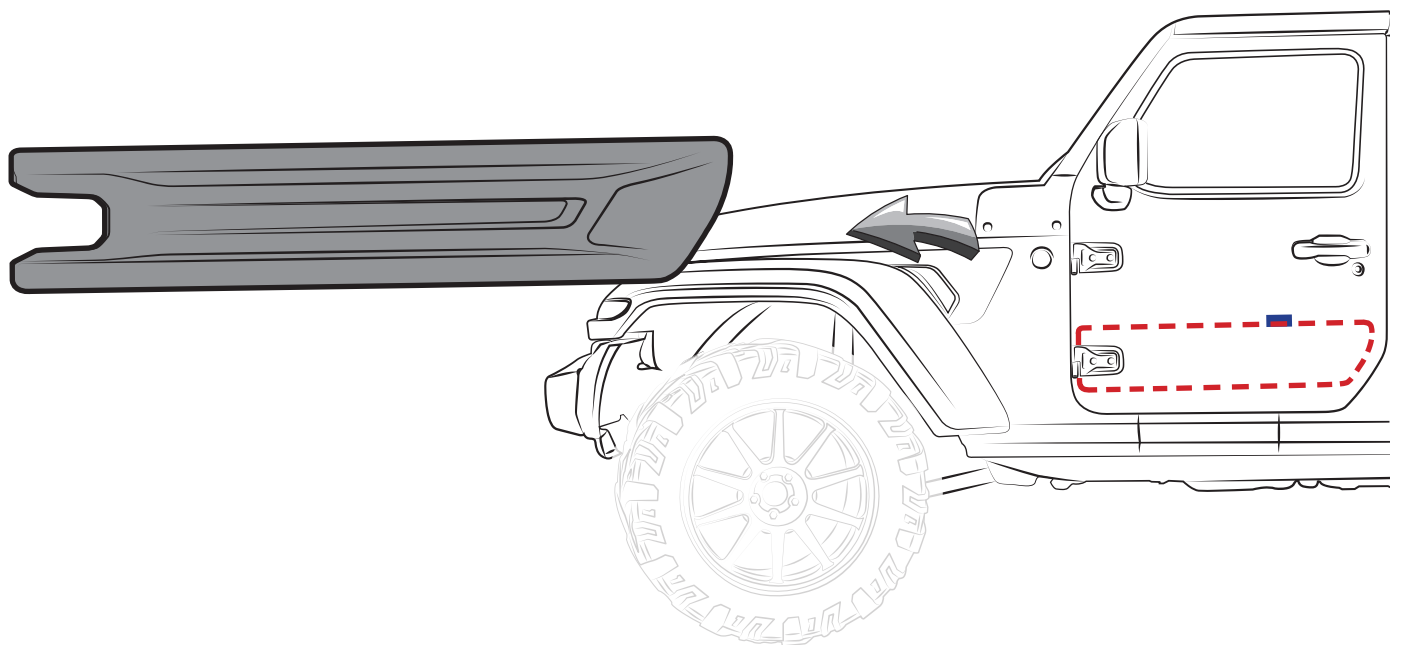

## 6 CLEAN THE ADHESIVE CHANNEL

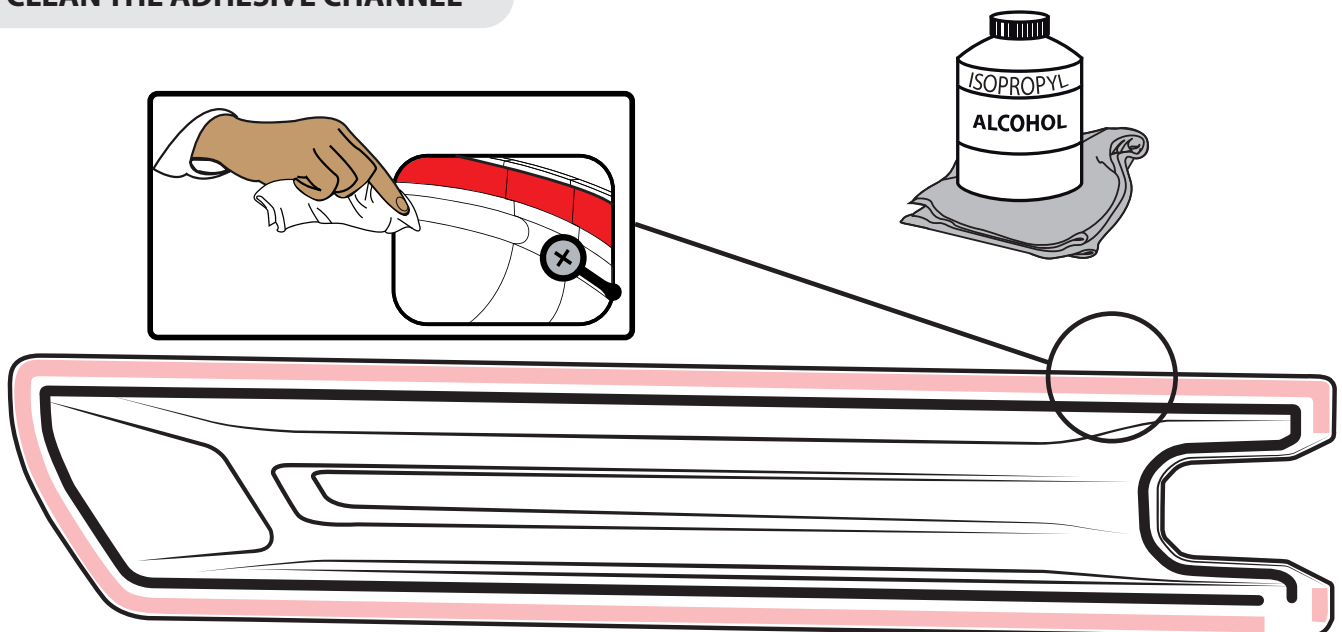

## 7 APPLY POLYURETHANE ADHESIVE

**! POLYURETHANE ADHESIVE MUST NEVER TOUCH THE DOUBLE SIDED TAPE**

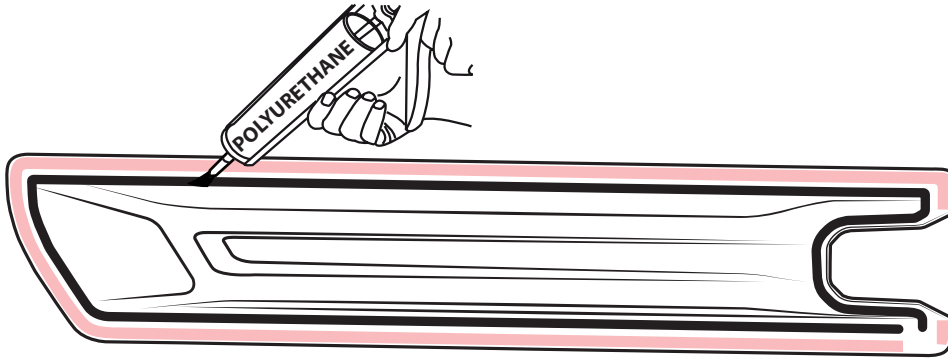

**! DO NOT APPLY POLYURETHANE IN THE DRAINAGE CHANNELS**

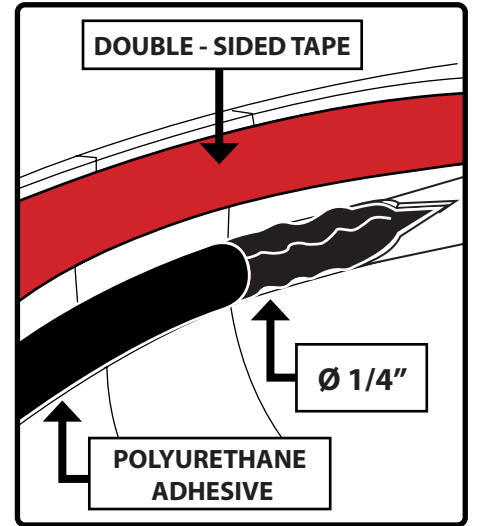
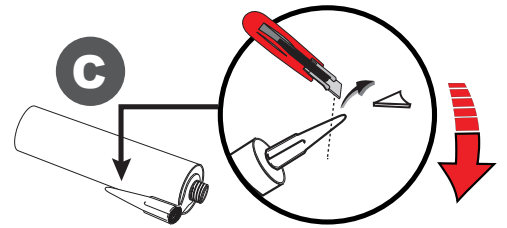

## 8 PEEL THE LINER LEADS

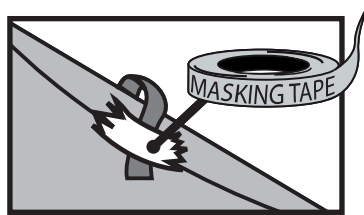
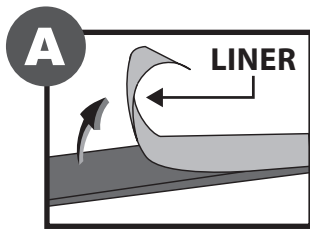

**! STICK THE LINER LEAD ON THE OUTSIDE**

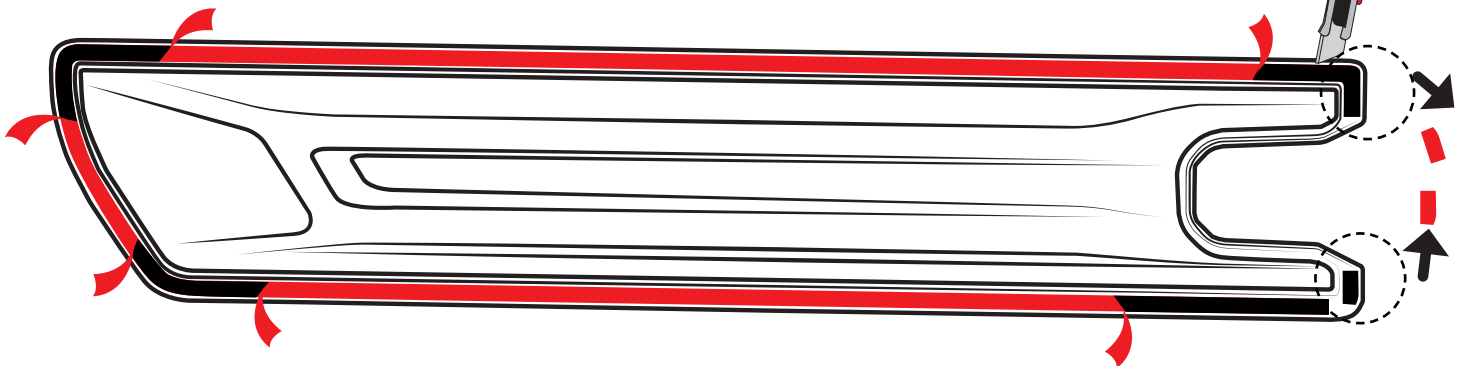

## 9 PLACE THE DOOR PANEL

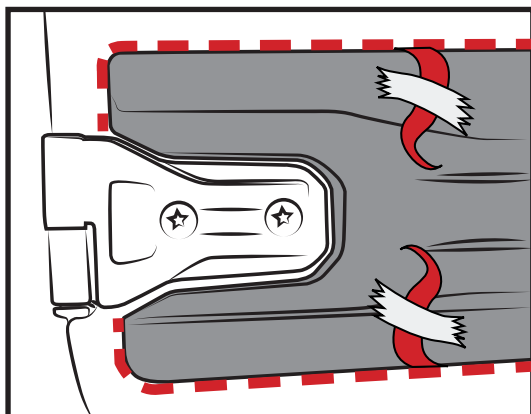

**! VERIFY ASSEMBLY**

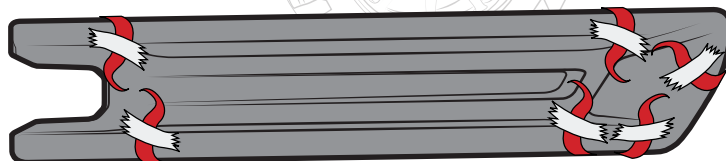
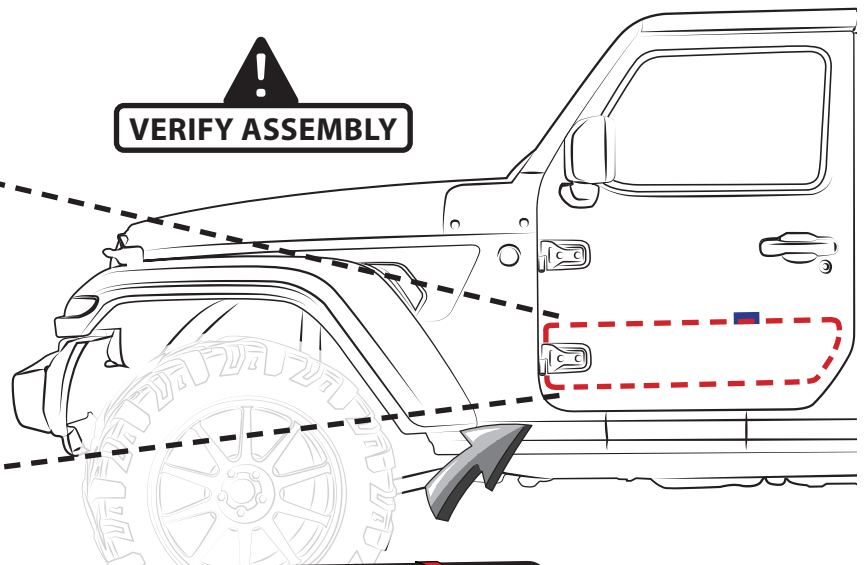

# DOOR PANEL SET - WRANGLER JL 2018+ INSTALLATION MANUAL

## 10 REMOVE THE LINER

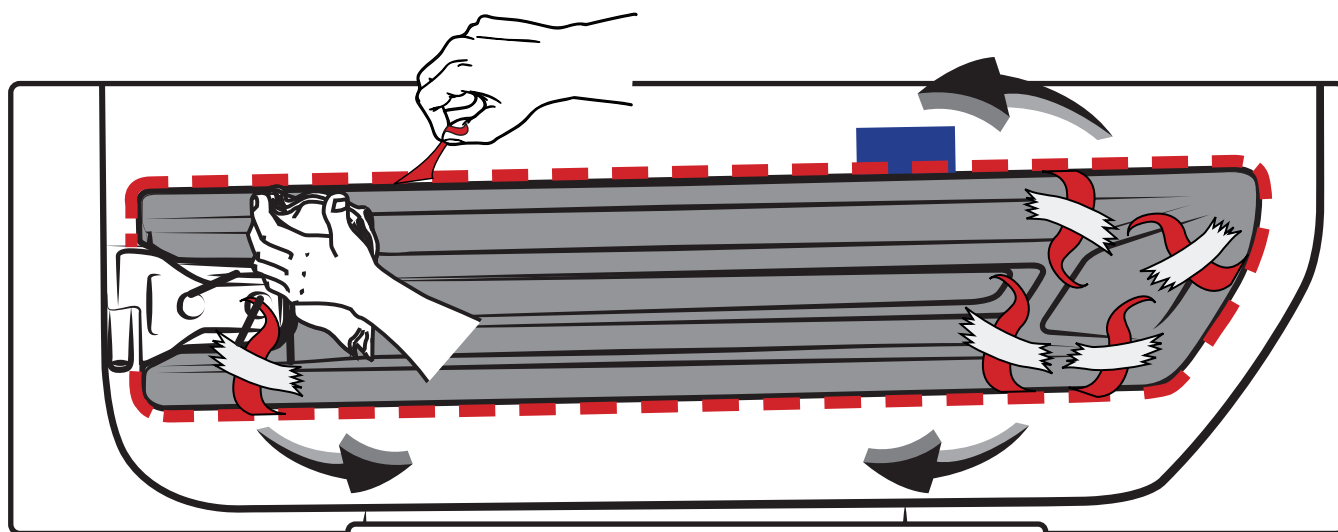

**APPLY LIGHT PRESSURE BEHIND TAPE TAB  
AS IT IS REMOVED TO ADHERE THE TAPE TO  
THE VEHICLE SURFACE**

## 11 PRESS FIRMLY ALL OVER THE EDGE

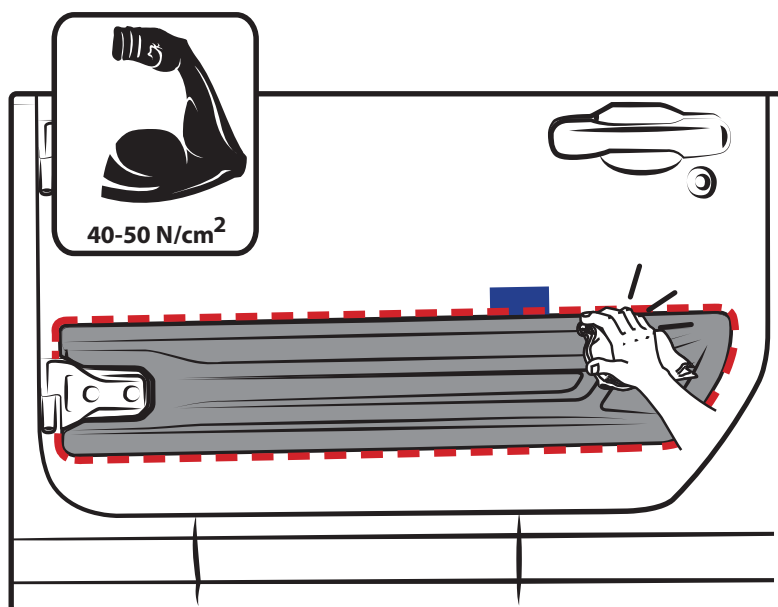

**DURING APPLICATION, THE VEHICLE,  
ADD ON PARTS AND TAPE MUST BE  
AT OR ABOVE 16 °C OR 60 °F. A FULL  
SURFACE CONTACT BETWEEN TAPE  
AND SUBSTRATE IS IMPORTANT FOR  
GOOD ADHESION PERFORMANCE.**

**CONTACT IS ACHIEVED BY APPLYING  
PRESSURE. IN PRACTICE, A PRESSURE  
BETWEEN 40 AND 50 N/CM<sup>2</sup> IS  
USUALLY NEEDED.**

## 12 CLEAN THE MARKINGS

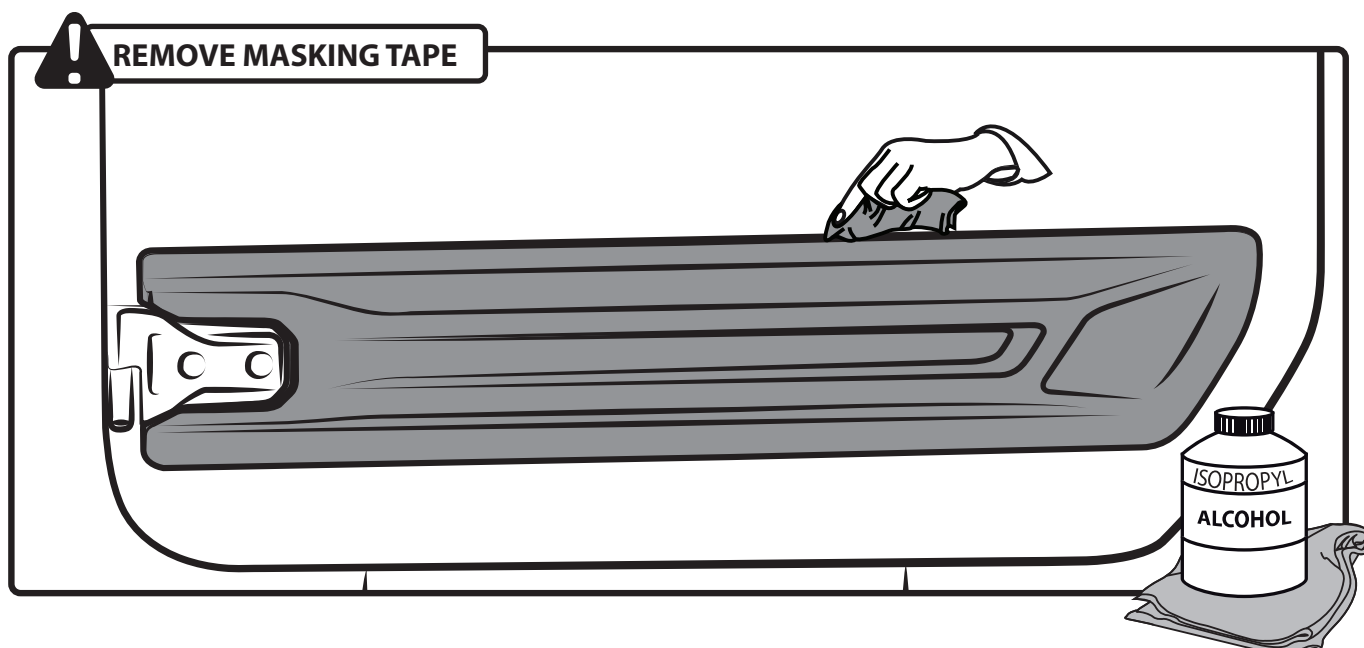

# REAR DOOR PANEL

## 1 MEASURE

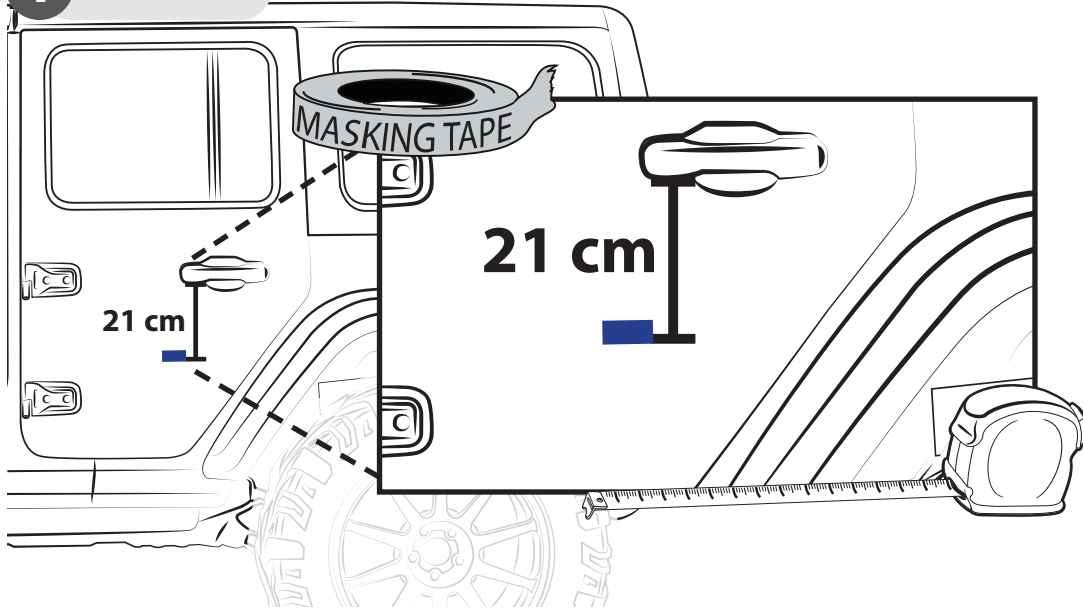

**MEASURE 21 cm  
FROM THE DOOR  
HANDLE AND MARK**

## 2 CLEAN THE INSTALLATION ZONE

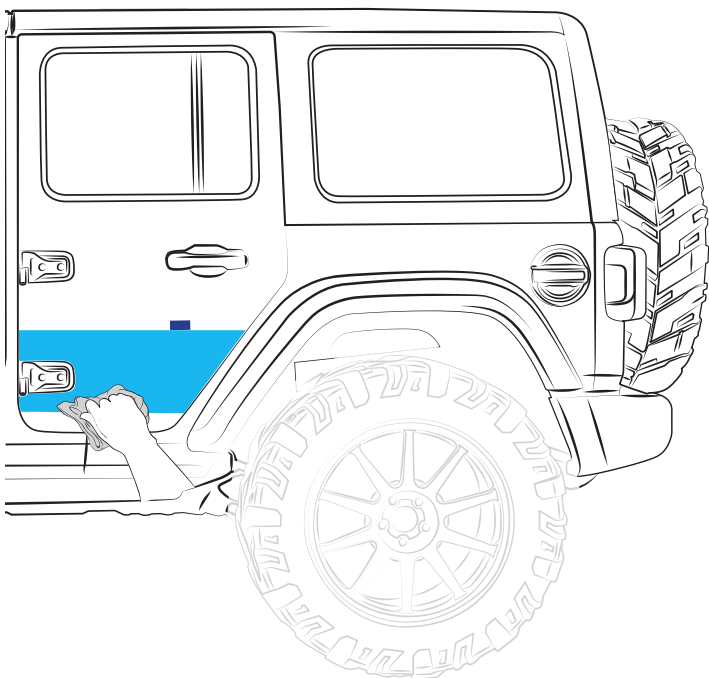

**CLEAN IN ONE DIRECTION TO  
REMOVE DIRT PROPERLY**

## 3 TEST FIT THE DOOR PANEL

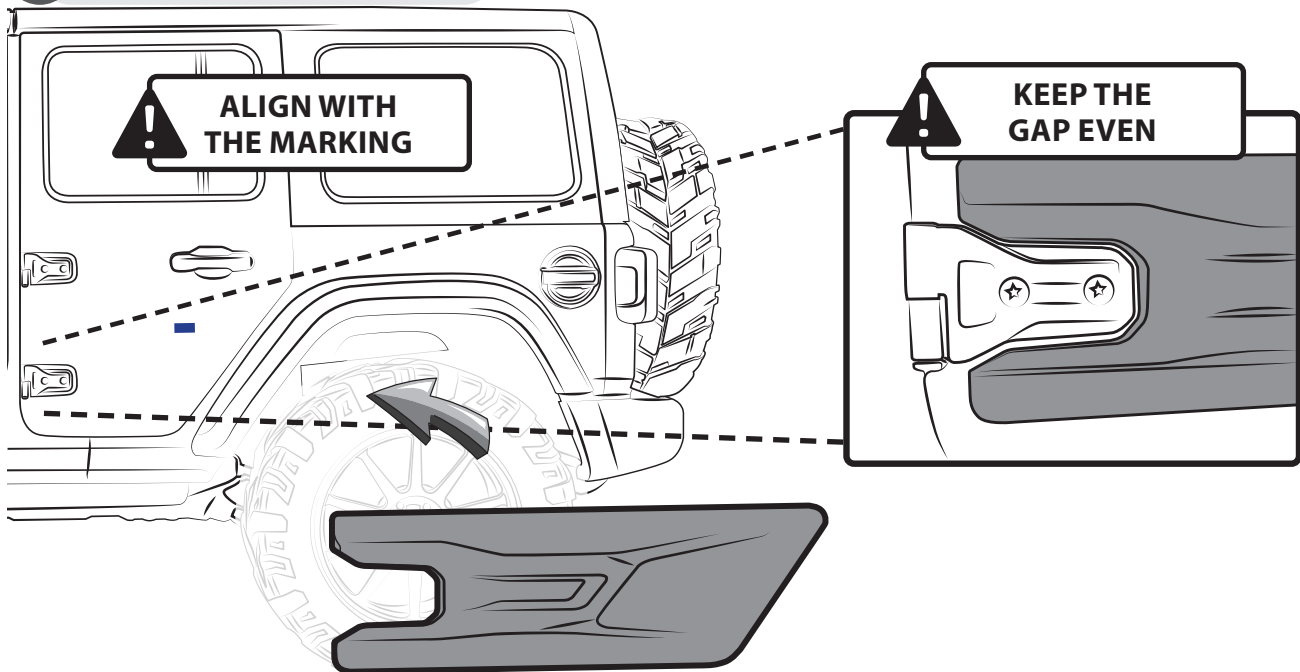

# DOOR PANEL SET - WRANGLER JL 2018+ INSTALLATION MANUAL

## 4 MARK THE OUTLINE

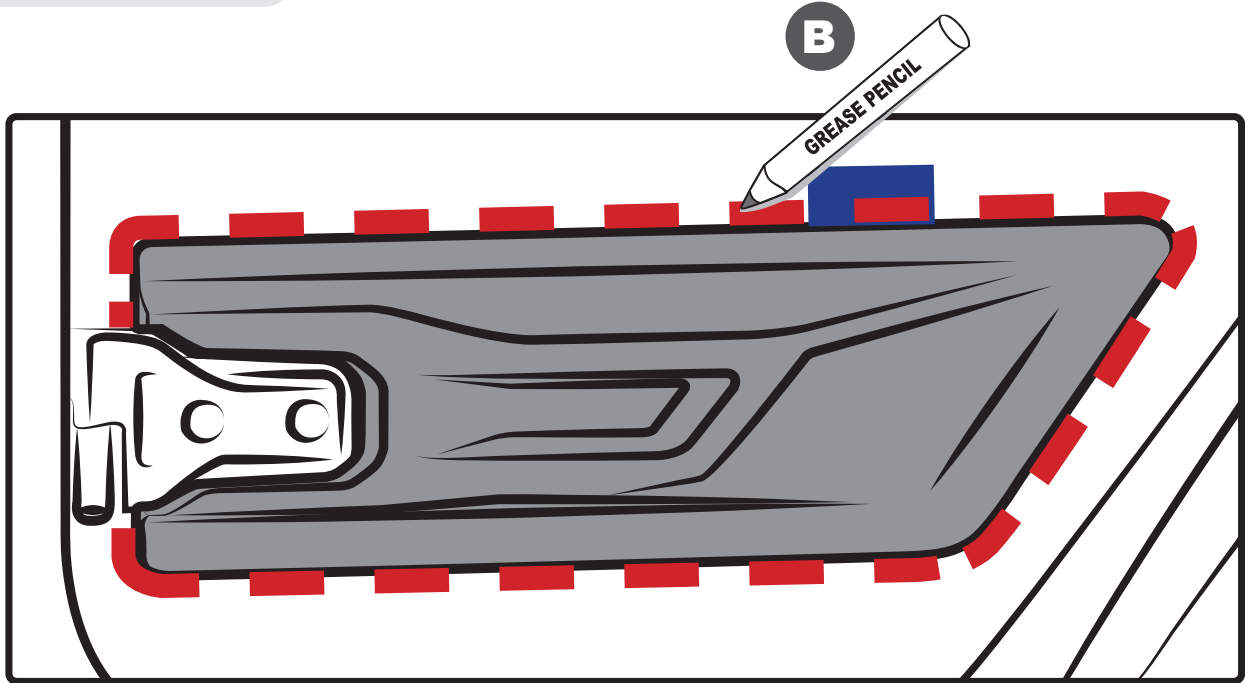

## 5 REMOVE THE DOOR PANEL

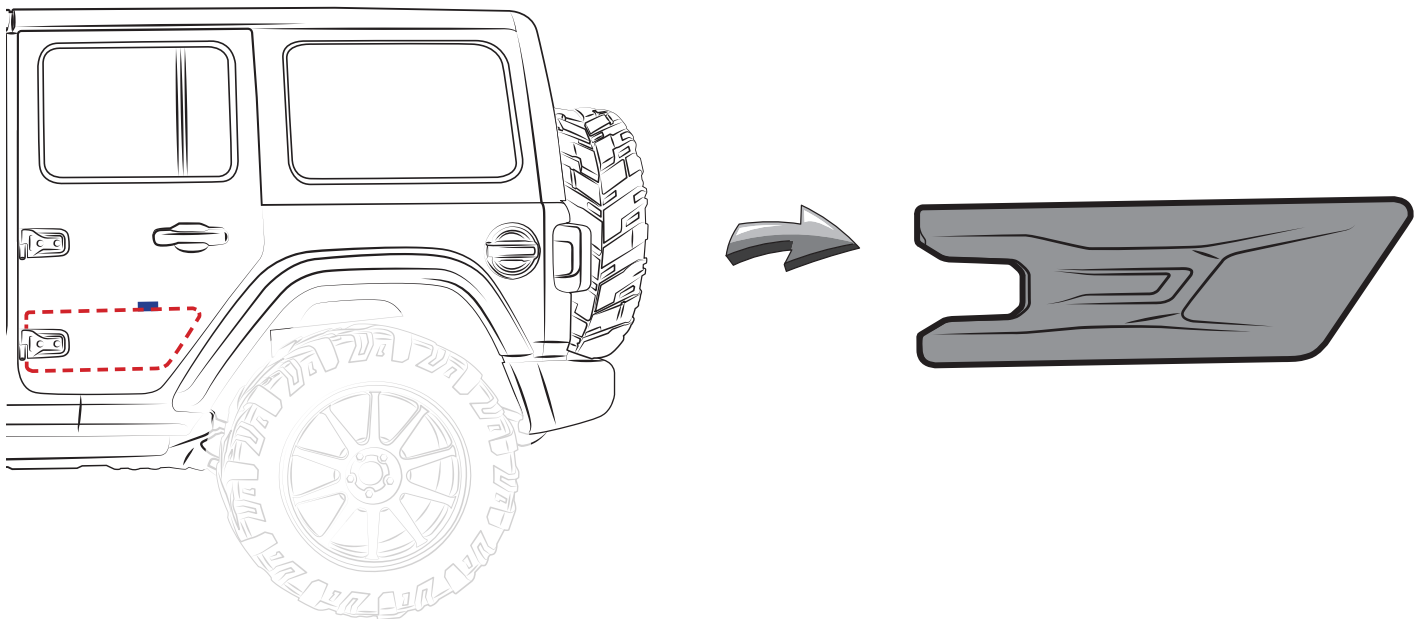

## 6 CLEAN ADHESIVE CHANNEL

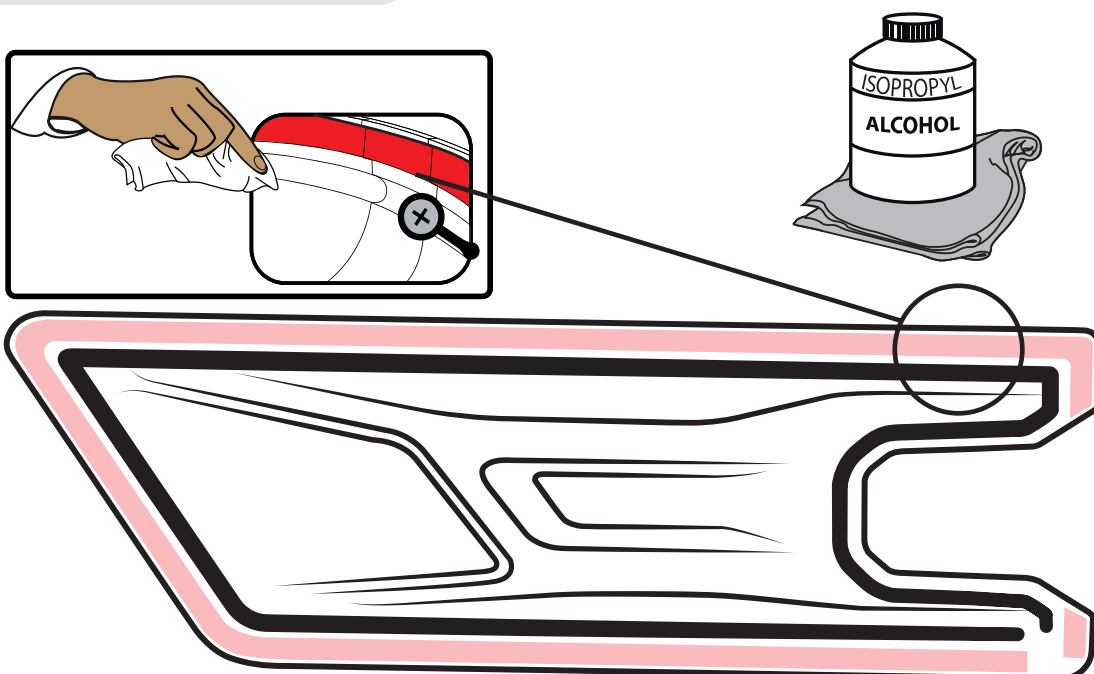

## 7 APPLY POLYURETHANE ADHESIVE

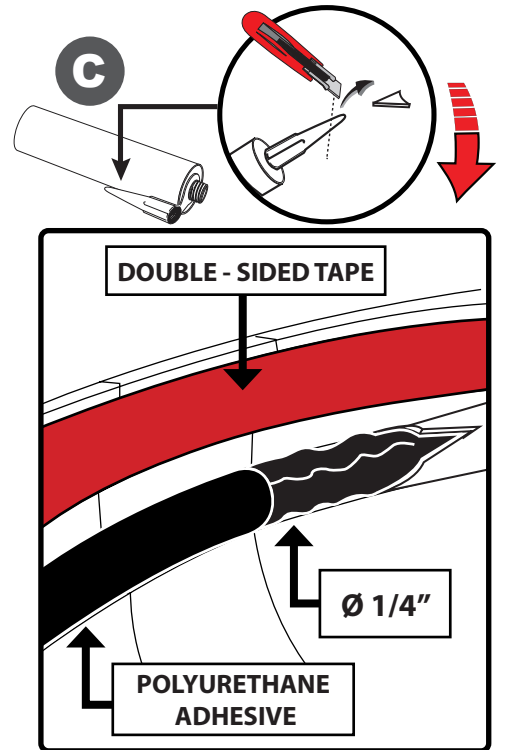
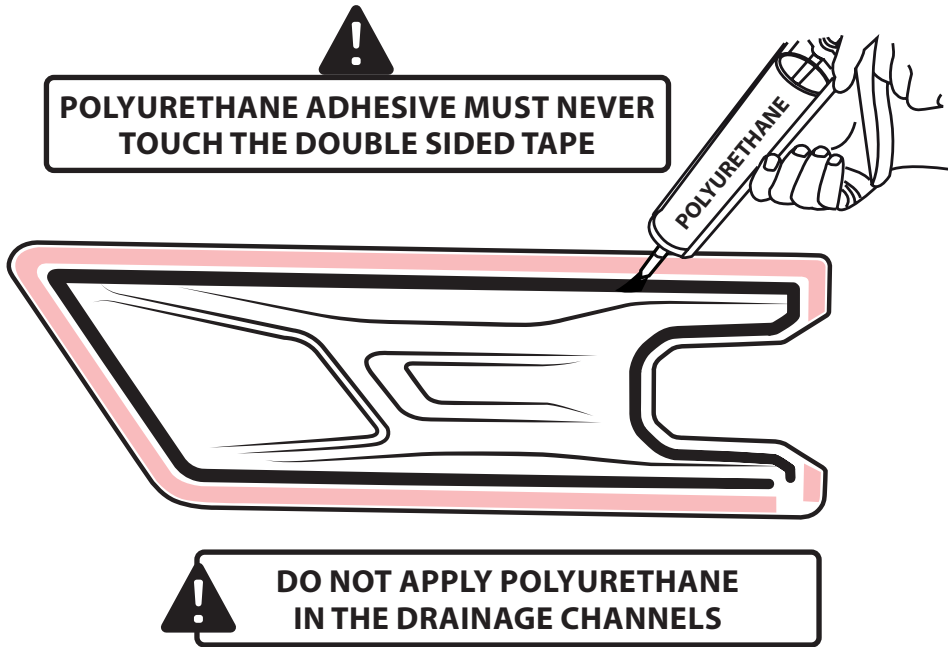

## 8 PEEL THE LINER LEADS

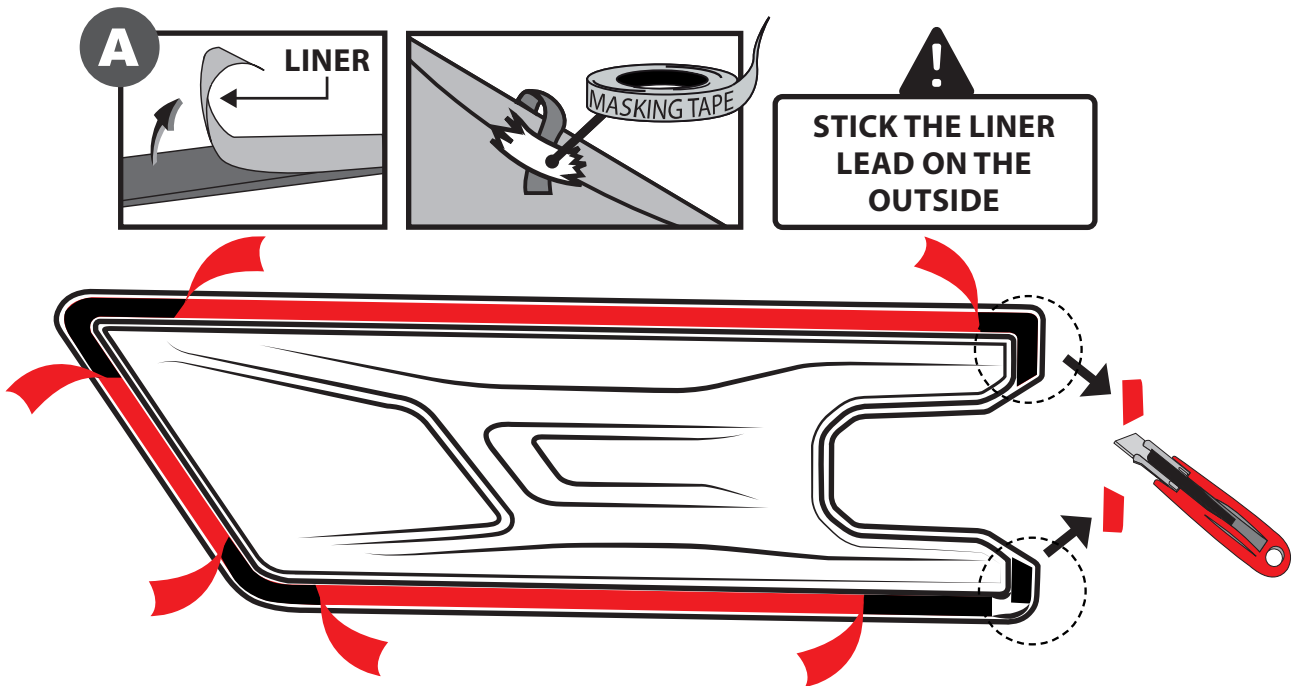

## 9 PLACE THE DOOR PANEL

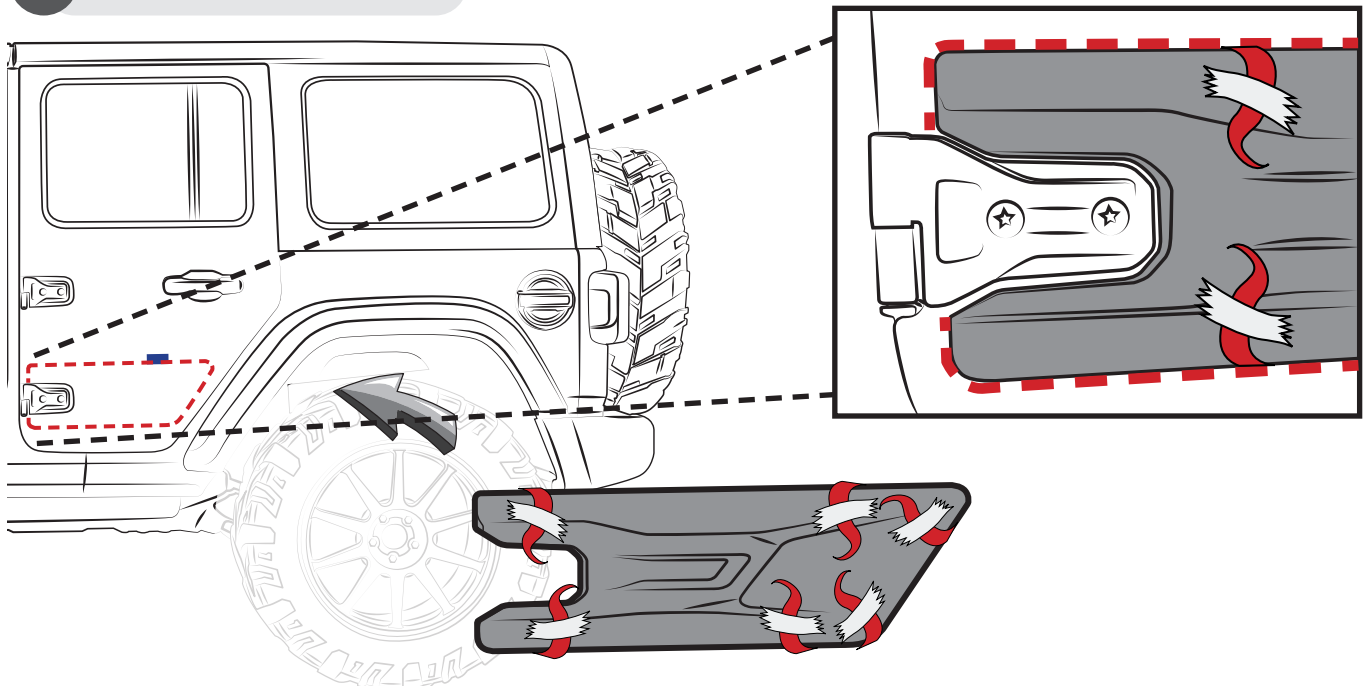



# DOOR PANEL SET - WRANGLER JL 2018+ INSTALLATION MANUAL

## 10 REMOVE THE LINER AND PRESS

**APPLY LIGHT PRESSURE BEHIND TAPE TAB  
AS IT IS REMOVED TO ADHERE THE TAPE  
TO THE VEHICLE SURFACE**

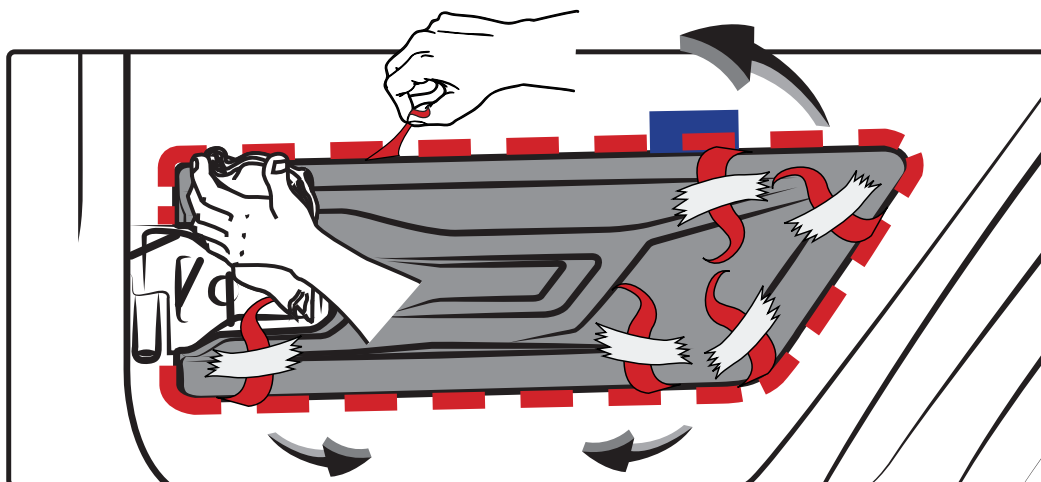

## 11 PRESS FIRMLY ALL OVER THE EDGE

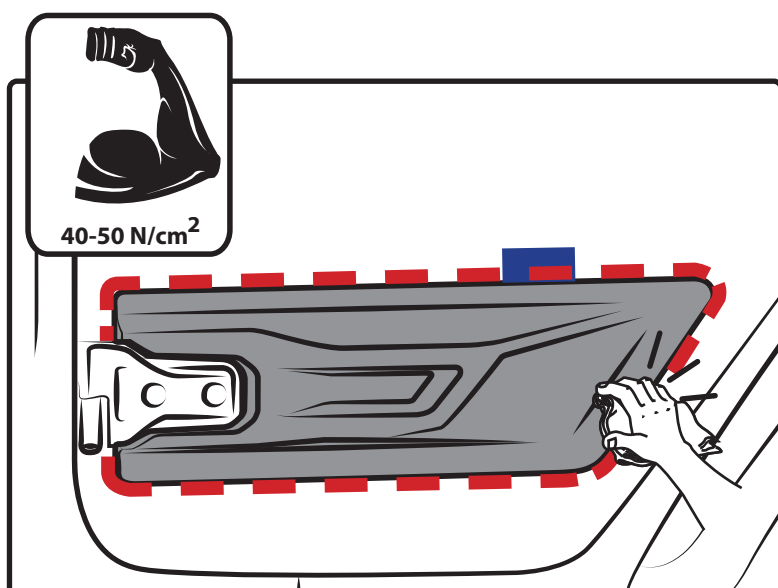

**DURING APPLICATION, THE VEHICLE,  
ADD ON PARTS AND TAPE MUST BE  
AT OR ABOVE 16 °C OR 60 °F. A FULL  
SURFACE CONTACT BETWEEN TAPE  
AND SUBSTRATE IS IMPORTANT FOR  
GOOD ADHESION PERFORMANCE.**

**CONTACT IS ACHIEVED BY APPLYING  
PRESSURE. IN PRACTICE, A PRESSURE  
BETWEEN 40 AND 50 N/CM² IS  
USUALLY NEEDED.**

## 12 CLEAN THE MARKINGS

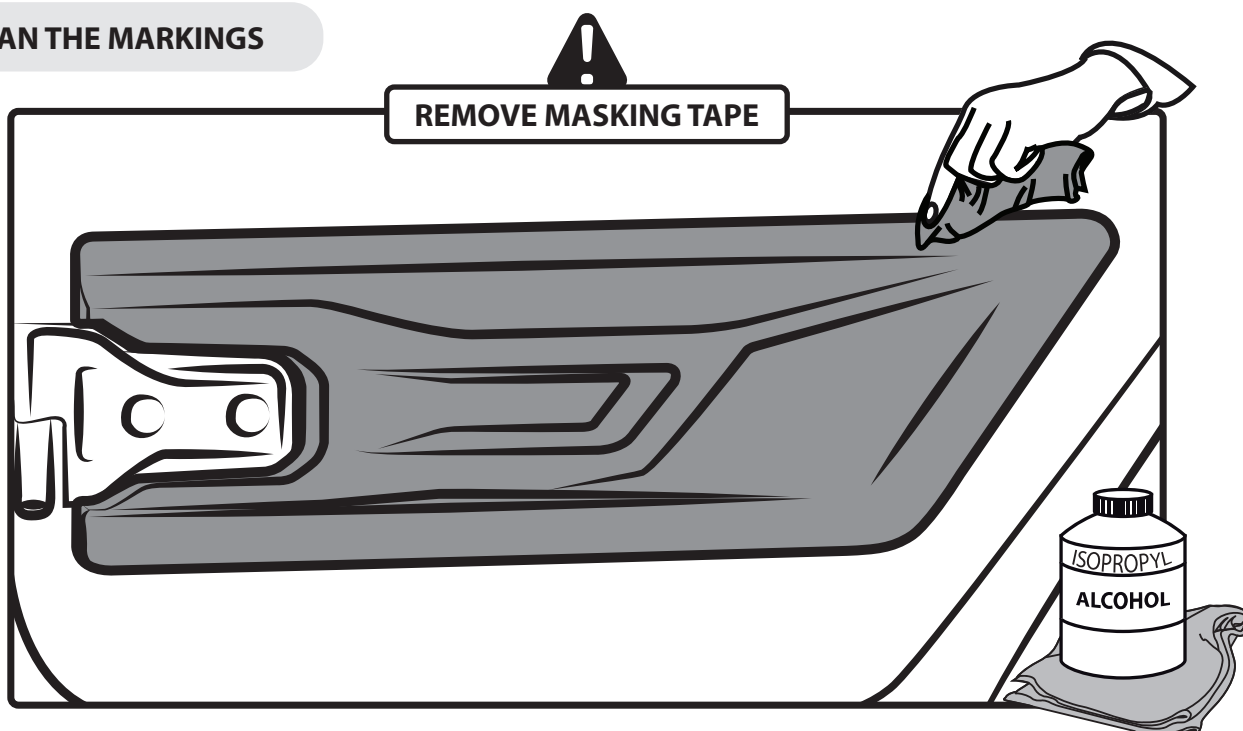

## INSTALLED PART

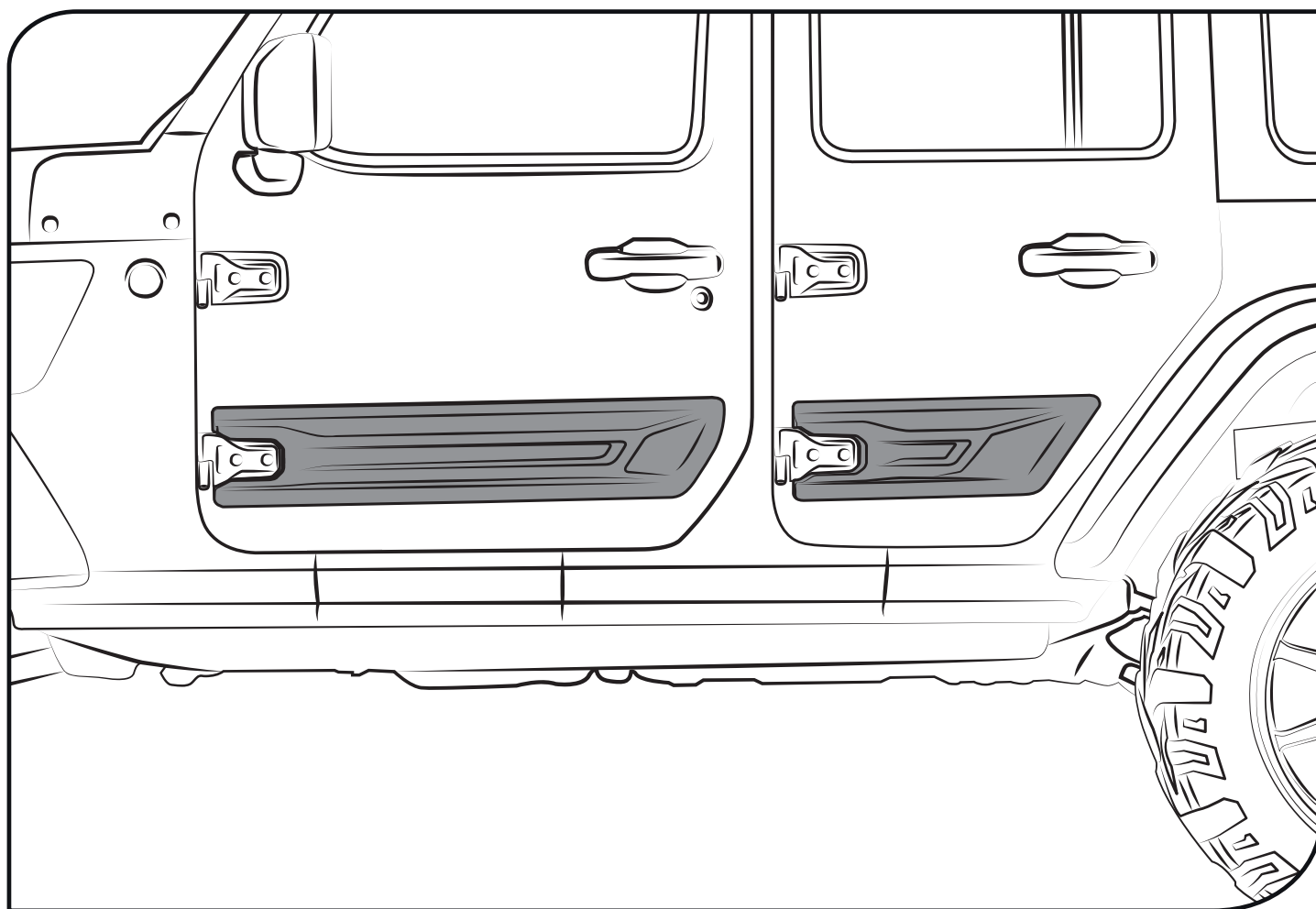

**REPEAT ALL STEPS  
FOR RH SIDE**

# DOOR PANEL SET - WRANGLER JL 2018+

## INSTALLATION MANUAL

IF REQUIRED BEFORE INSTALLATION, APPLY THE FOLLOWING PROCESS



PLEASE READ CAREFULLY BEFORE STARTING WITH PAINTING PROCESS

### BODY COLOR PAINTING INSTRUCTIONS



**1** GENTLY SAND THE PART USING 400 GRIT SAND PAPER OR RED SCOTCH-BRITE SPONGE. BE CAREFUL NOT TO DAMAGE SURROUNDING FACTORY FINISHES. CLEAN WITH ISOPROPYL ALCOHOL AFTERWARD.

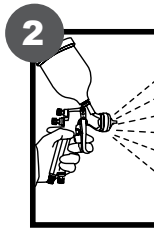

**2** APPLY A GOOD QUALITY 2K PRIMER.



**3** CAREFULLY INSPECT THE PARTS, THEY MUST HAVE A SMOOTH PAINT-READY SURFACE.



**4** REMOVE ANY POWDER PARTICLES USING A LINT-FREE FLANNEL TOWEL BEFORE APPLYING THE PAINT.

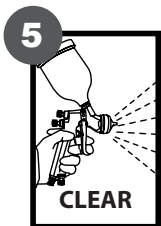

**5** APPLY BASE COAT TO GET A SMOOTH AND FINE FINISH.

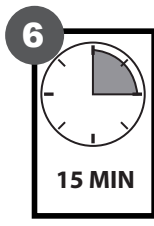

**6** WAIT 15 MINUTES, CAREFULLY INSPECT AND DETAIL WHERE NECESSARY.

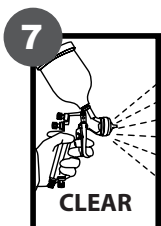

**7** APPLY A THIN LAYER OF CLEAR COAT.

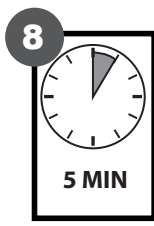

**8** WAIT 5 MORE MINUTES.



**9** APPLY ADDITIONAL CLEAR COAT AS NECESSARY TO ACHIEVE DESIRED GLOSS LEVEL. WAIT 5 MORE MINUTES.

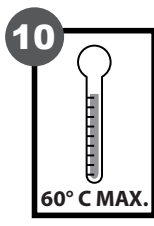

**10** CURE AT A MAXIMUM TEMPERATURE OF 60°C (140°F) FOR 15 MINUTES. DO NOT EXCEED SUGGESTED TEMPERATURE.



#### IMPORTANT

MAKE SURE THE PART IS SECURED CORRECTLY TO THE VEHICLE OR RACK DURING PAINT AND CURE PROCESS TO AVOID ANY RISK OF FALLING.

# JEEP-WRANGLER JL 2018+

## GRIVE HIVE STYLE

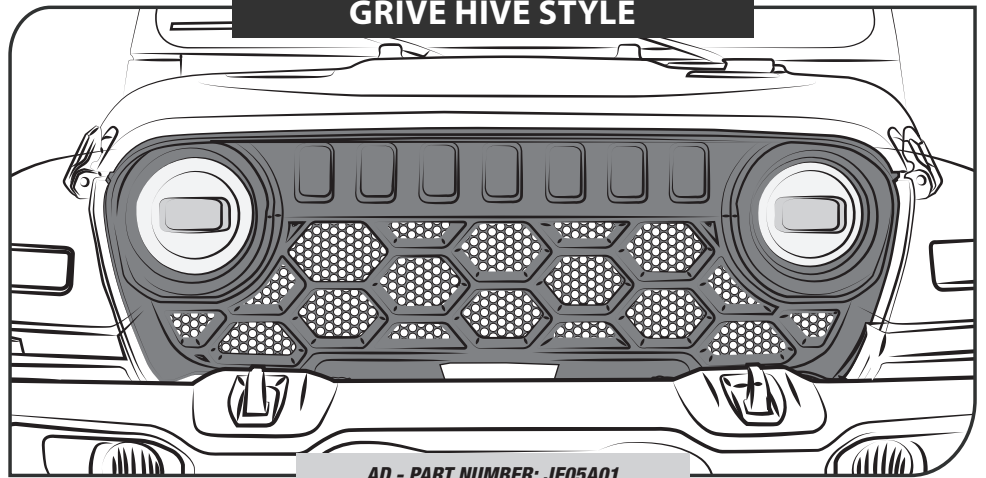

AD - PART NUMBER: JE05A01

## DOOR PANEL SET

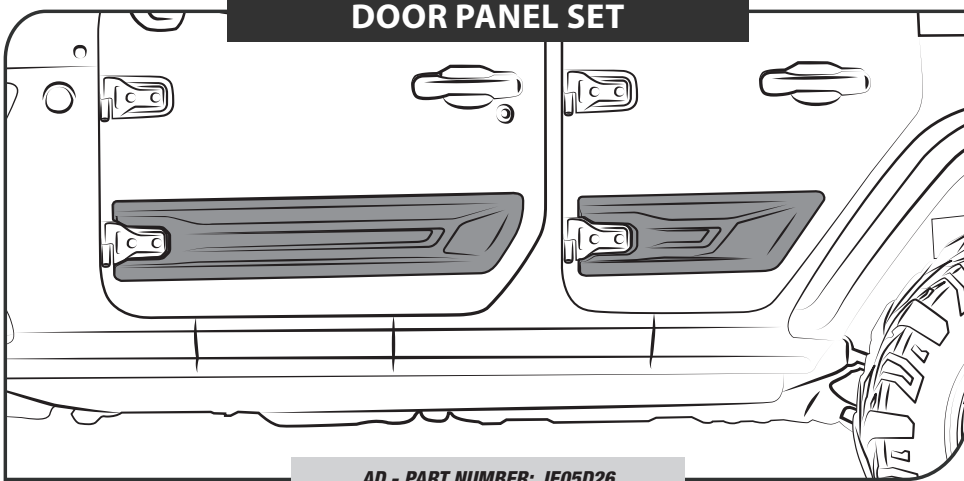

AD - PART NUMBER: JE05D26

### **IMPORTANT:**

**IF YOU INSTALL BOTH SETS, ALWAYS START WITH INSTALLATION FROM THE FLAT TOP HIGH FLARE SET**

## 1. FLAT TOP HIGH FLARE SET

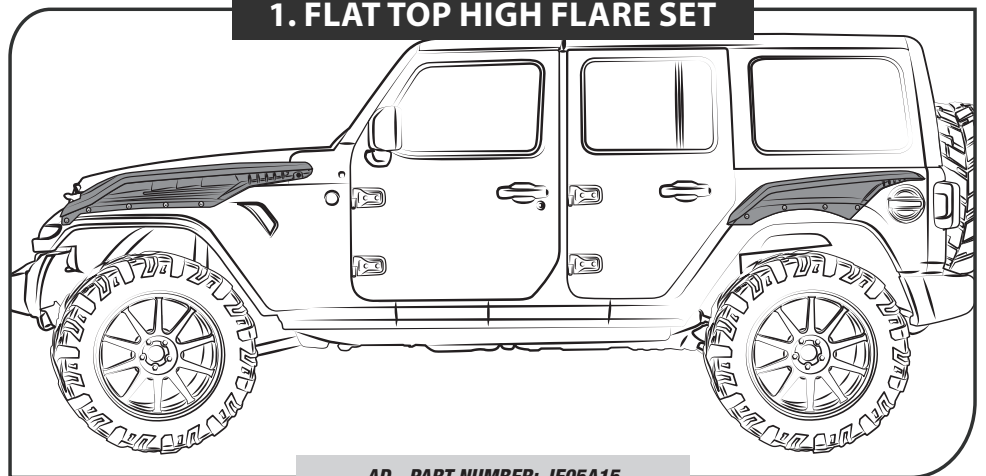

AD - PART NUMBER: JE05A15

## 2. INNER FENDER LINER SET

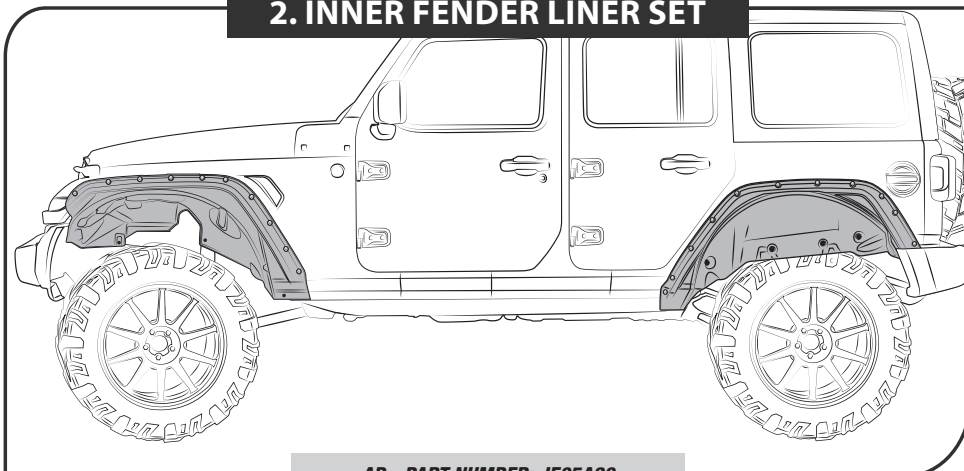

AD - PART NUMBER: JE05A20