

# **CRAWLTEK**

## REVOLUTION

491 W. GARFIELD AVE., COLDWATER, MI 49036 • 517.278.1039  
CRAWLTEKREVOLUTION.COM • E-MAIL: TECH-CRAWLTEK@RIDEFOX.COM

### INSTALLATION INSTRUCTIONS

## PYRO FRONT BUMPER

**JL10101 - STUBBY**  
**JL10201 - MIDWIDTH**  
**JL10301 - FULLWIDTH**

FOR USE WITH  
JL AND JLU MODELS FROM 2018+

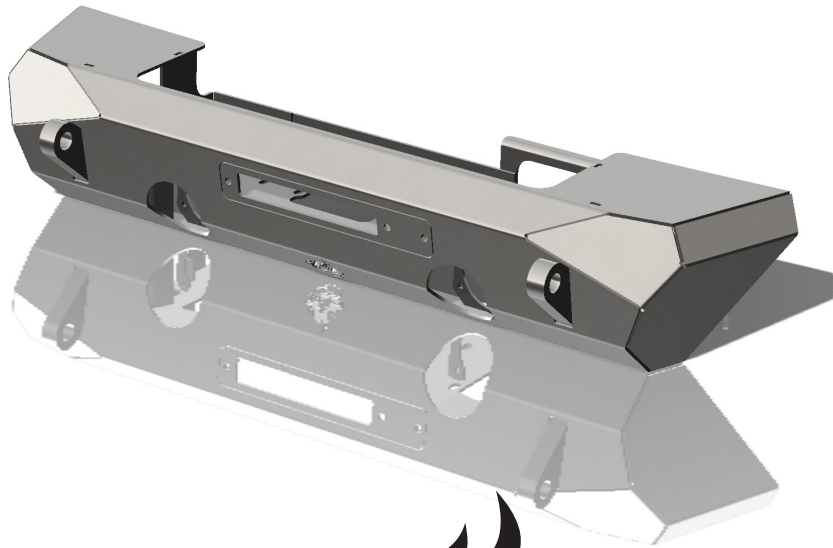

CrawlTek YouTube

**PLEASE READ THROUGH INSTRUCTIONS BEFORE INSTALLING**

2024-05-28

## WHAT'S IN THE BOX?

PLEASE VERIFY KIT CONTENTS BEFORE BEGINNING INSTALLATION

PART #	Qty	DESCRIPTION
06032/06033/06034	1	BUMPER - JL FRONT - PYRO
06025	2	ADAPTER PLATES
06030	1	JK PYRO FRONT BUMPER NUTSTRIP - YELLOW ZINC
06031	1	JK PYRO FRONT BUMPER FAIRLEAD MOUNT
06177	1	CRAWLTEK SS LOGO 3.5"
C0042	1	LOGO RIVETS
06011	2	PYRO BAJA DESIGNS LIGHT BRACKET
C0064	1	LIGHT BRACKET HARDWARE
CWLU30010	1	DECAL: CRAWLTEK GEARSHIFT 3.5" X 3.5"
CWLU30020	1	DECAL: CRAWLTEK EYES 6" X 2"
CWLU30030	1	DECAL: CRAWLTEK JAX 3.75" X 2.8"
C0044	<b>1</b>	<b>BOLT PACK</b>
	8	7/16"-14 X 1-1/2" GRADE 8 HEX CAP SCREW
	8	7/16"-14 SERRATED FLANGE NUT
	8	7/16" PUSHNUT BOLT RETAINER
	8	7/16"-14 X 1" GRADE 8 HEX CAP SCREW
	8	7/16" SAE FLAT WASHER
	1	3/8"-16 X 1-1/4" GRADE 5 HEX CAP SCREW
	2	3/8"-16 X 3/4" STAINLESS STEEL BUTTON SOCKET CAP SCREW
	1	3/8" SAE FLAT WASHER
	2	3/8"-16 SERRATED FLANGE NUT
	1	M6-1.0 X 50MM CLASS 10.9 HEX CAP SCREW
	1	M6 FLAT WASHER
	1	M6-1.0 FREE SPINNING WASHER NUT
	8	NYLON NUT #6 SCREW SIZE

## TOOLS REQUIRED

SAFETY GLASSES

18MM SOCKET OR WRENCH

10MM SOCKET OR WRENCH

11/16" SOCKET OR WRENCH

5/8" SOCKET OR WRENCH

9/16" WRENCH

7/16" SOCKET

3/16" ALLEN HEAD SOCKET

FLAT HEAD SCREWDRIVER

SMALL HAMMER



## PRE-INSTALLATION NOTES

1. IF INSTALLING A LARGE BODIED WINCH ADDITIONAL CUTTING MAY BE REQUIRED TO THE TOP OF THE FRAME HORNS.
2. THE PYRO BUMPER IS NOT COMPATIBLE WITH THE OE LED OR OE HALOGEN JL/JT FACTORY FOG LIGHTS. INCLUDED FOG LIGHT POCKET BRACKETS (06011) ARE COMPATIBLE WITH BAJA DESIGNS SQUADRON AND BAJA DESIGNS S2 AUXILIARY LIGHTS.

## FACTORY FRONT BUMPER REMOVAL

### STEP 3:

REMOVE THE TOP TWO (2) PINS HOLDING THE BUMPER VALENCE BRIDGING THE GAP BETWEEN BUMPER AND BOTTOM OF THE FRONT GRILL ASSEMBLY (**FIG 1**).



**FIGURE 1**

### STEP 4:

REMOVE THE EIGHT (8) PUSH PINS THAT ATTACH THE FRONT LOWER VALENCE TO THE BOTTOM OF THE STOCK FRONT BUMPER. NEXT, REMOVE THE TWO (2) SCREWS THAT CONNECT THE LOWER VALENCE TO THE FRAME CROSSMEMBER (**FIG 2**).

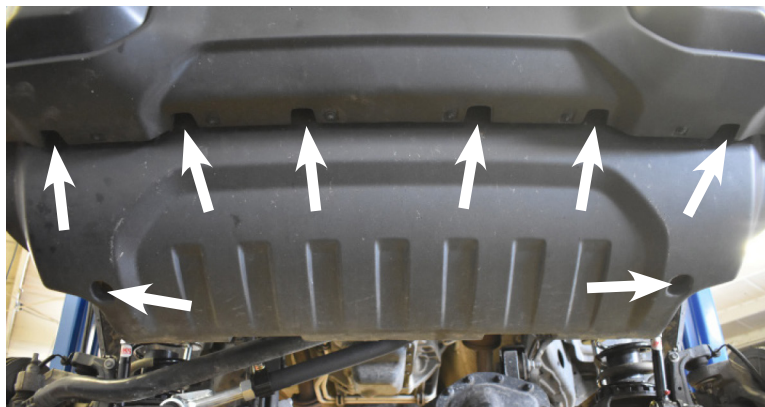

**FIGURE 2**



**STEP 5:**

DISCONNECT THE STOCK FOG LIGHT WIRING HARNESS RUNNING ALONG THE PASSENGER SIDE FRAME RAIL FROM THE PIGTAIL CONNECTOR ON THE FACTORY BUMPER (**FIG 3**).



**FIGURE 3**

**STEP 6:**

REMOVE EIGHT (8) FACTORY BUMPER NUTS. REMOVE BUMPER FROM THE VEHICLE (**FIG 4**).



**FIGURE 4**

**STEP 7:**

OPTIONAL: REMOVE TWO BOLTS THAT MOUNT CROSSMEMBER TO EACH FRAME RAIL AND REMOVE CROSSMEMBER PLATE, LOCATED BELOW THE FRONT BUMPER (**FIG 5**).

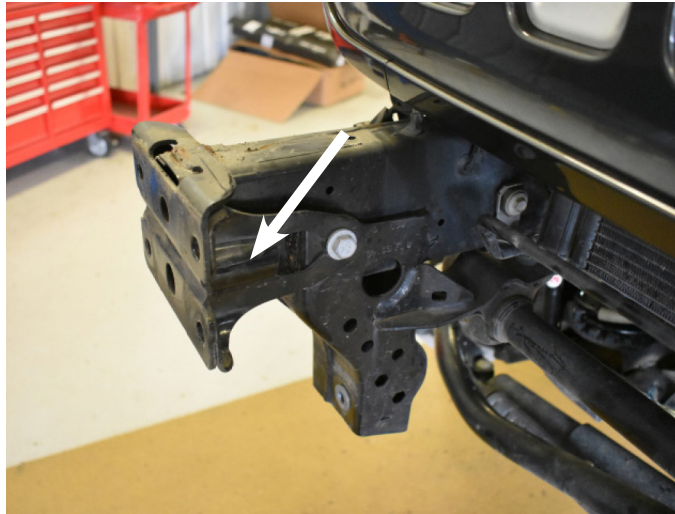



**FIGURE 5**

**STEP 8:**

REMOVE THE TWO FACTORY BUMPER BRACKETS, ONE ON EACH FRAME HORN (**FIG 6**). THESE WILL NOT BE USED TO INSTALL THE NEW CRAWLTEK BLAZE FRONT BUMPER.



**FIGURE 6**

**STEP 9:**

REMOVE FACTORY FOG LIGHTS AND HARNESS FROM FACTORY BUMPER, KEEP (8) FACTORY SCREWS.

## ASSEMBLING THE PYRO FRONT BUMPER

**STEP 10:**

INSTALL (8) NYLON NUTS INTO BUMPER FOGLIGHT MOUNTING BRACKETS. (**FIG. 7**)







**FIGURE 7**

**STEP 11:**

INSTALL FACTORY FOG LIGHTS REUSING (8) FACTORY SCREWS. **(FIG. 8)**

*OE MANUFACTURER OFFERS 3 DIFFERENT FACTORY FOG LIGHTS. THE PYRO BUMPER IS COMPATIBLE WITH THE 4 BOLT MOUNTING HALOGEN FOG LIGHTS ONLY. IS NOT COMPATIBLE WITH FACTORY 4 BOLT MOUNTING LED FOG LIGHT OR 3 BOLT MOUNTING FOG LIGHT.*



**FIGURE 8**

## BAJA DESIGNS LIGHT INSTALLATION (OPTIONAL)

**STEP 12:**

FOR UPGRADING FROM FACTORY JL FOG LIGHTS, OUR PROVIDED LIGHT BRACKETS (06011) MOUNT BAJA DESIGNS SQUADRON SERIES AND S2 SERIES AUX LIGHTS INTO THE FOG LIGHT LOCATION. FOR A FORWARD LIGHT POSITION, USE BAJA DESIGNS MOUNTING HARDWARE TO MOUNT SQUADRON LIGHTS AS SHOWN IN **FIG. 9A**. FOR RECESSING LIGHTS WITHIN THE BUMPER SHELL, MOUNT SQUADRON LIGHTS AS SHOWN IN **FIG. 9B** USING BAJA DESIGNS MOUNTING HARDWARE. **FIG. 9C** SHOWS LIGHTS MOUNTED IN THE FORWARD LIGHT POSITION.

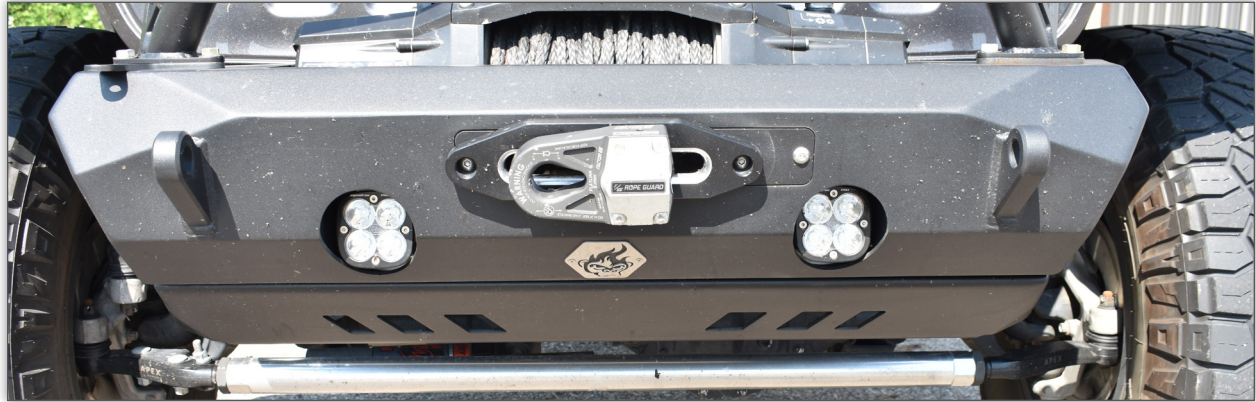



**FIGURE 9A**



**FIGURE 9B**



**FIGURE 9C**

**STEP 13:**

MOUNT LIGHT & BRACKET ASSEMBLY TO BUMPER. ENSURE NYLON NUTS ARE INSTALLED INTO FOG LIGHT MOUNT (STEP 7) THEN FASTEN ASSEMBLY WITH PROVIDED SCREWS IN C0064 BOLT PACK (**FIG 9D**). WIRE LIGHTS ACCORDING TO BAJA DESIGN WIRING INSTRUCTIONS.

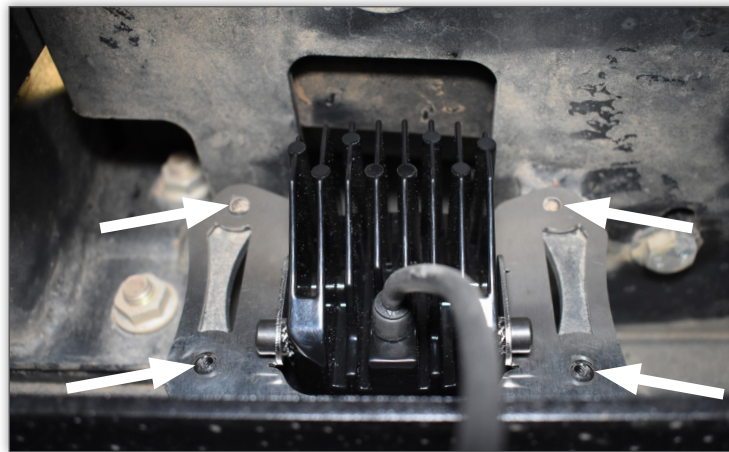

**FIGURE 9D**





## PRE-PYRO FRONT BUMPER INSTALLATION

### STEP 14: (OPTIONAL):

INSTALL WINCH ON TO BUMPER ASSEMBLY WITH BOLTS SUPPLIED FROM WINCH MANUFACTURER. (FIG. 10)

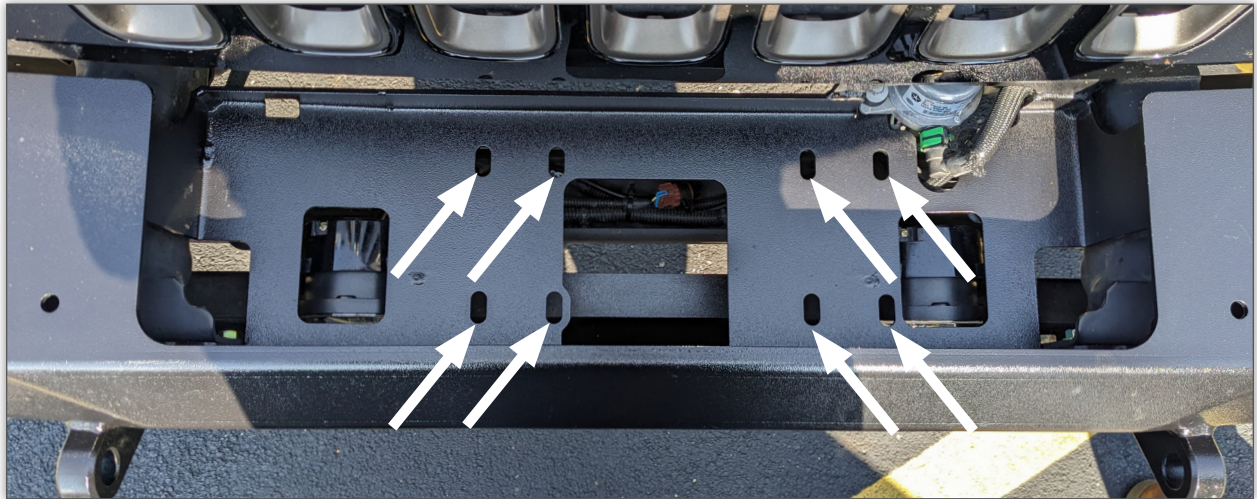

FIGURE 10

## INSTALLATION OF THE PYRO FRONT BUMPER

### STEP 15:

RECONNECT FOG LIGHT HARNESSES AND SET BUMPER ONTO FRAME RAILS. USING A SLIGHT UPWARD ANGLE TILT THE BACK OF THE BUMPER BACK AND OVER THE FRAME HORNS. IF YOU ARE INSTALLING A WINCH YOU MAY NEED A HELPER, AS THE WINCH AND BUMPER ASSEMBLY ARE HEAVY.

### STEP 16:

LIFT ONE SIDE OF THE BUMPER AT A TIME INTO POSITION AND INSTALL A 7/16" BOLT AND WASHER FROM THE REAR OF THE BUMPER THROUGH THE FRAME HORNS AND INTO THE BUMPER. ATTACH 7/16" SERRATED FLANGE NUT TO BOLT AND TIGHTEN.

### STEP 17:

INSTALL THE REVERSIBLE FAIRLEAD BRACKET WITH THE 3/8 BUTTON HEAD AND FLANGE NUT. IF YOU INSTALLED A WINCH, INSTALL YOUR FAIRLEAD USING THE SUPPLIED HARDWARE. (FIG. 11)



FIGURE 11





**STEP 18: (OPTIONAL)**

CRAWLTEK HAWSE (CWLCT10100, NOT INCLUDED) INSTALLS OVER REVERSIBLE FAIRLEAD BRACKET. **(FIG. 12)**

**NOTE:** ALUMINUM FAIRLEAD IS INTENDED TO BE USED WITH SYNTHETIC WINCH LINE ONLY. DO NOT USE WITH STEEL CABLE, STEEL CABLE WILL DESTROY THE ALUMINUM SURFACE.



**FIGURE 12**

**STEP 19:**

INSTALL INCLUDED JAX LOGO BADGE USING THE PROVIDED RIVETS IN C0042 **(FIG 13)**.

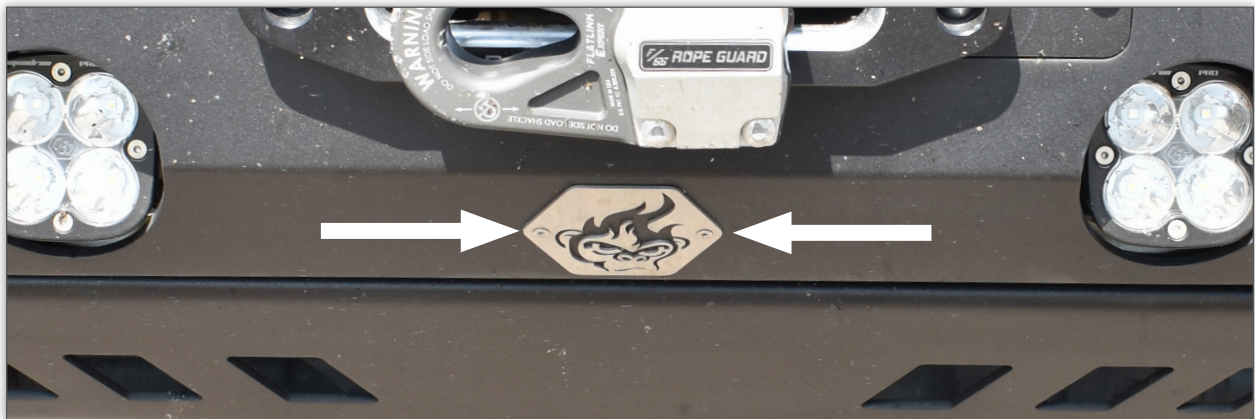

**FIGURE 13**



## BOLT-ON STINGER INSTALLATION (OPTIONAL)

### STEP 20:

FOR ADDED WINCH AND FRONT END PROTECTION, BOLT-ON BULL BAR, FLAT TOP STINGER, OR STINGER ARE COMPATIBLE WITH JK/JL/JT PYRO SERIES FRONT BUMPERS (NOT INCLUDED: CWLJK15101 - BULL BAR, CWLJK15201 - FLAT TOP STINGER, CWLJK15301 - STINGER). FOLLOW RESPECTIVE INSTRUCTIONS FOR CORRECT MOUNTING INSTALLATION.

**FIGURE 14A** - BULL BAR

**FIGURE 14B** - FLAT TOP STINGER

**FIGURE 14C** - STINGER (JK VERSION SHOWN)



**FIGURE 14A**







**FIGURE 14B**



**FIGURE 14C**







## YOU'RE NOT DONE YET!

*Thank you for your new CrawlTek Revolution purchase! Follow us on facebook for up to date coverage of new product releases. We love feedback, if you have any questions about the installation or parts were missing please contact us at [sales-crawltek@ridefox.com](mailto:sales-crawltek@ridefox.com) or call us at 517.278.1039.*

*Be sure to show off your jeep to the rest of the CrawlTek Revolution online.  
Find us on facebook and instagram to keep up on new products, upcoming events and more action.  
Tag us @crawltek for a chance to get featured*

