



DESTROYER SERIES

JL JEEP

REAR BUMPER

+ TIRE CARRIER

REAR VIEW CAMERA KIT

**INSTALLATION
INSTRUCTIONS**

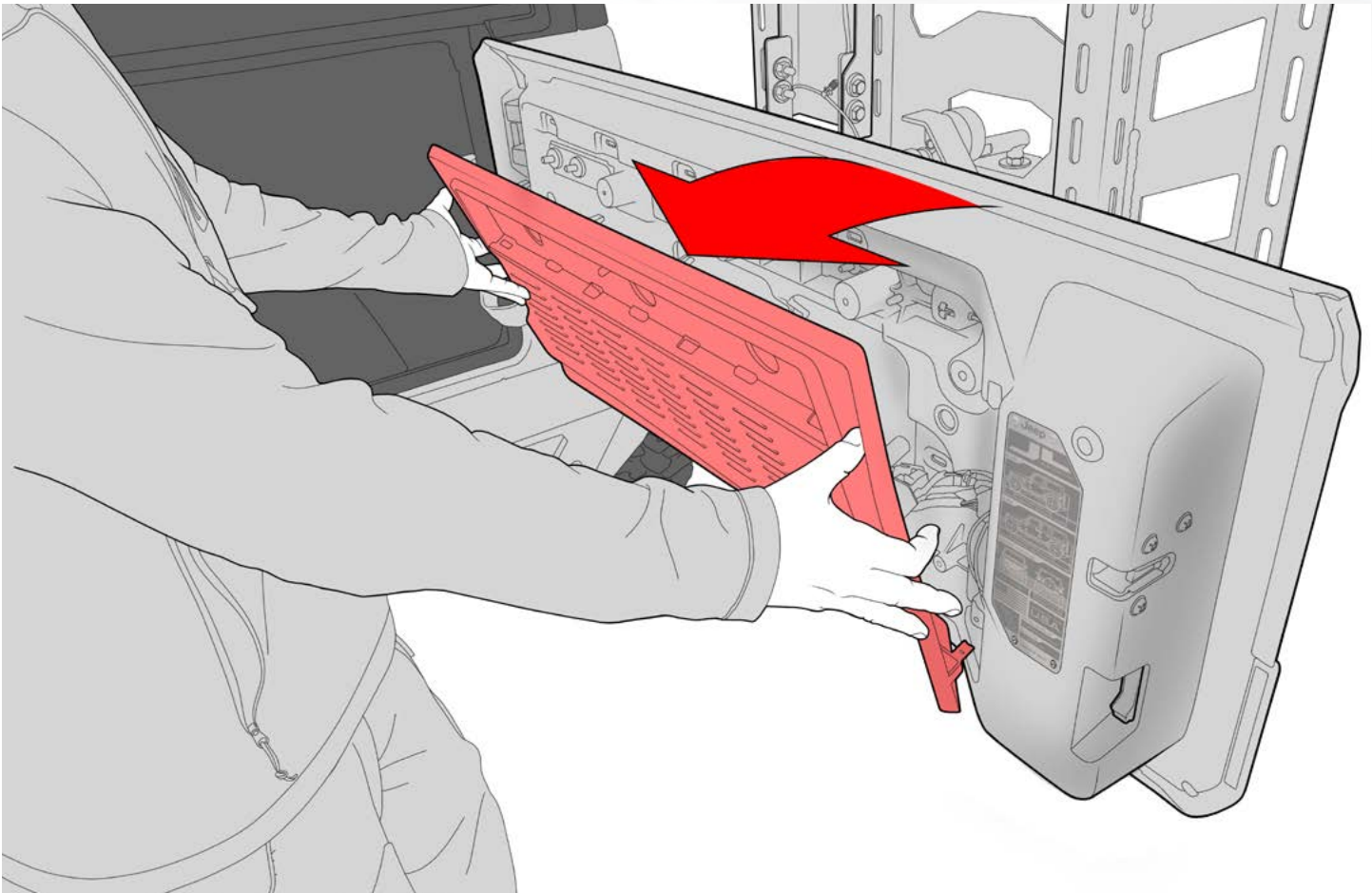

Remove the tailgate liner to access the wires underneath.



Disconnect the white camera connector and the third brake light (top two connectors).

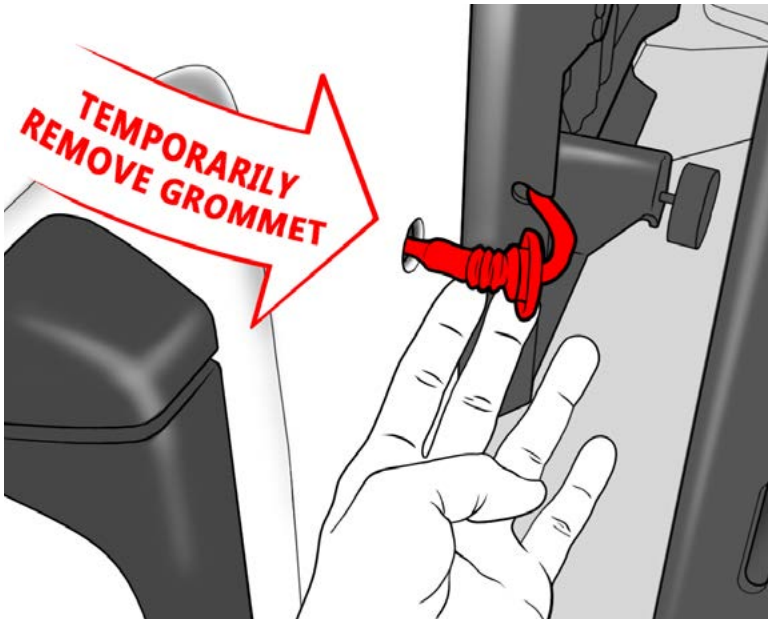

Next, you will separate the third brake light and camera from the stock tire mount.

You will need to pull the wire grommet and pull the third brake light and stock camera wire connectors out through the hole in order to detach the stock tire mount.

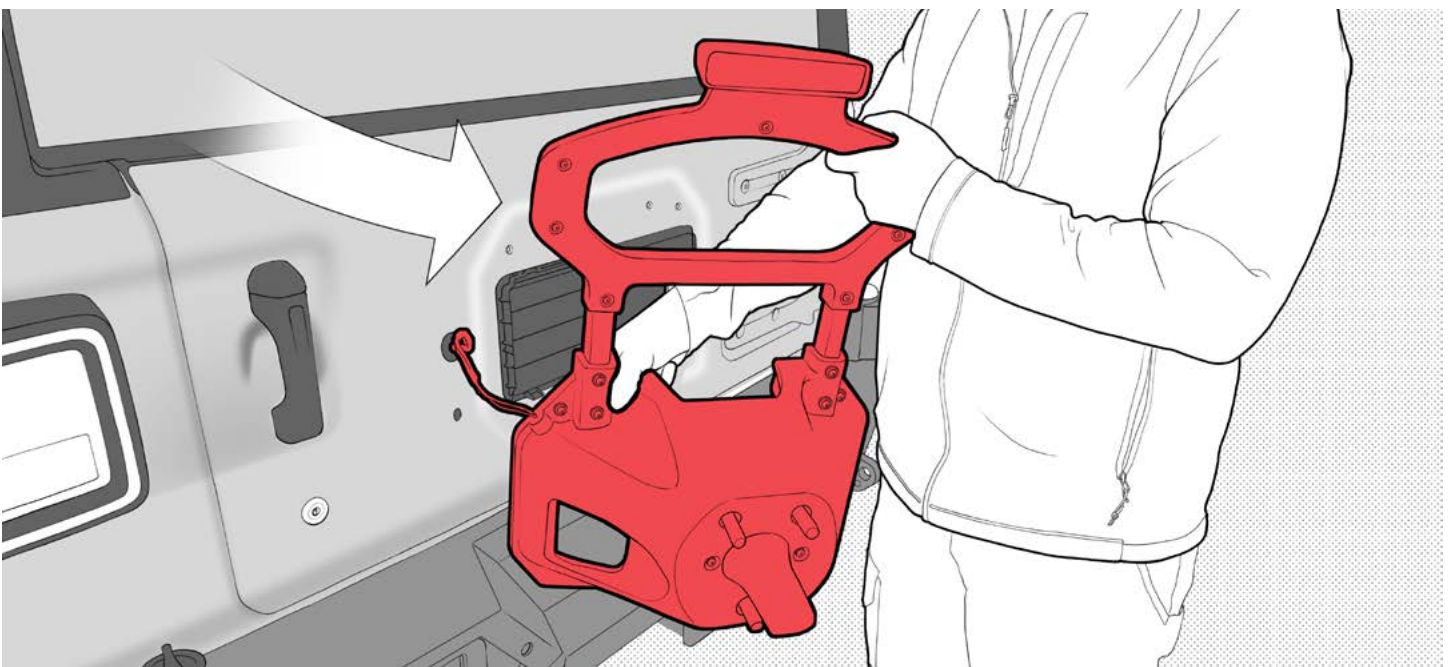

You can now remove the stock tire carrier and disassemble it to remove the camera and the third brake light + the corresponding wire.

Relocating The Camera

This diagram shows the removal of the camera system from the stock tire carrier.

1

Remove the two small screws.

2

Thread on lug nuts 0.5" and push down on them to pop out the insert in step 3.

Use a T-25 Torx bit, remove the seven bolts that secure the plastic cover.

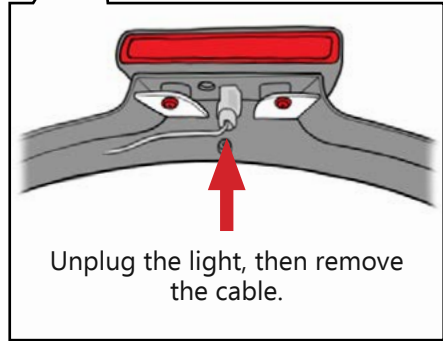
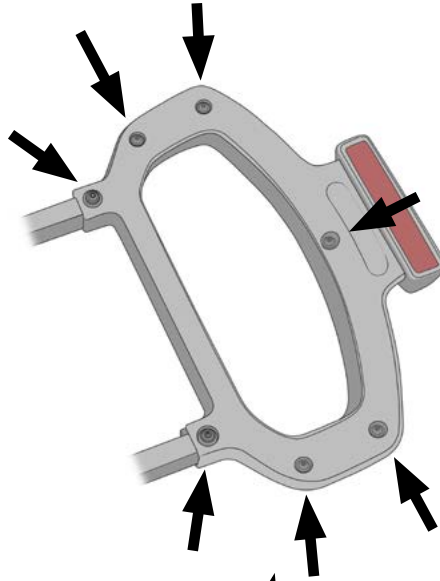

Unplug the light, then remove the cable.

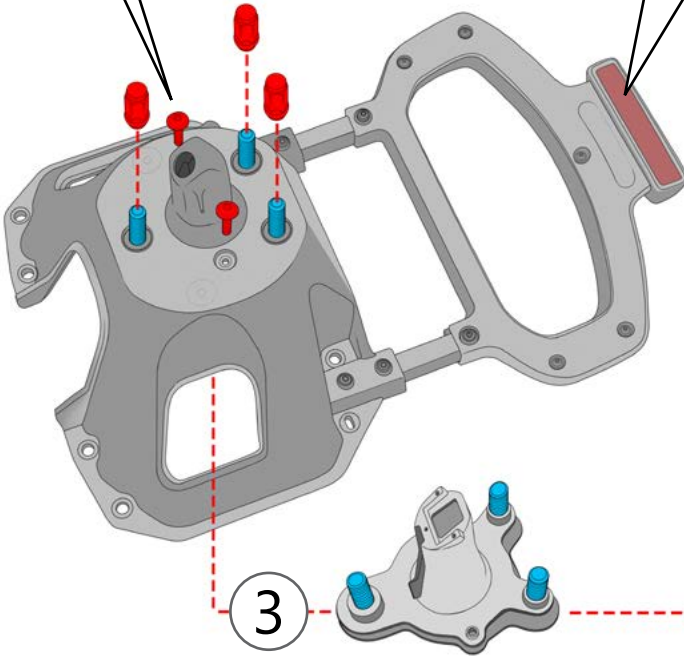

3

Remove insert

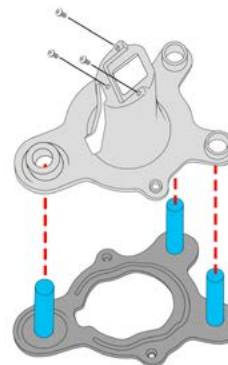

4

Remove second insert
Remove the small T-8 Torx screws to remove the camera



Pull off the interior trim cover on the passenger side, then remove the plastic tail light retaining bolt. This will allow you to pull off the light.

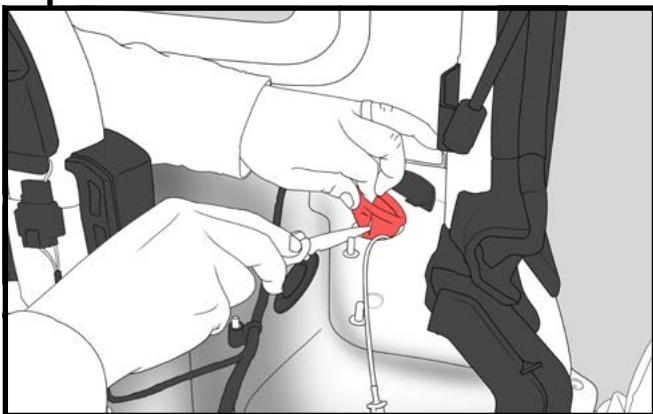
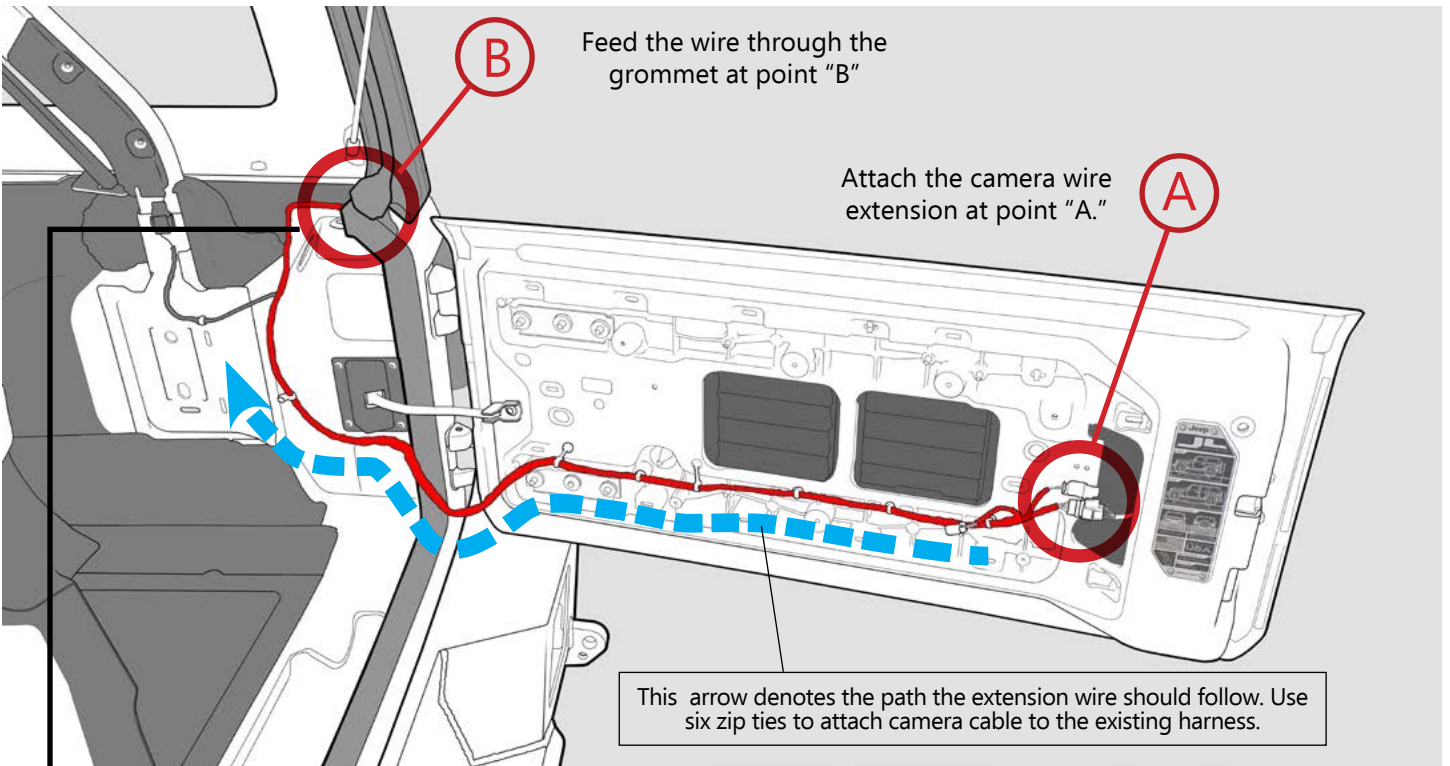

You will need to make an incision/small hole in the grommet shown (on top) in order to feed the wire extension through the tail light area.

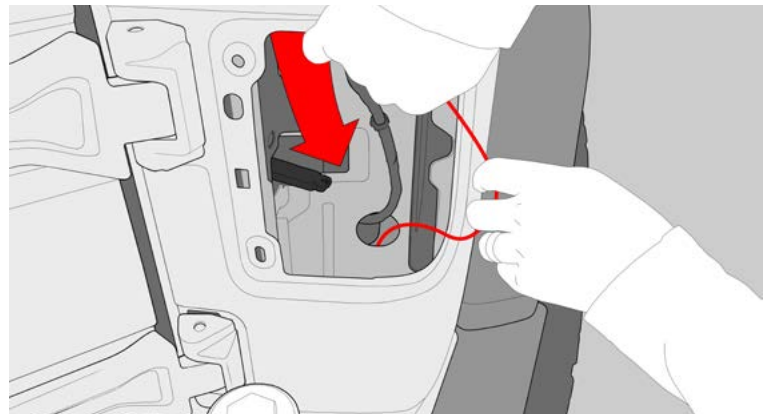

Feed the extension wire down through the hole indicated, you should see the wire come out under the Jeep. You can use a flashlight to help find it.

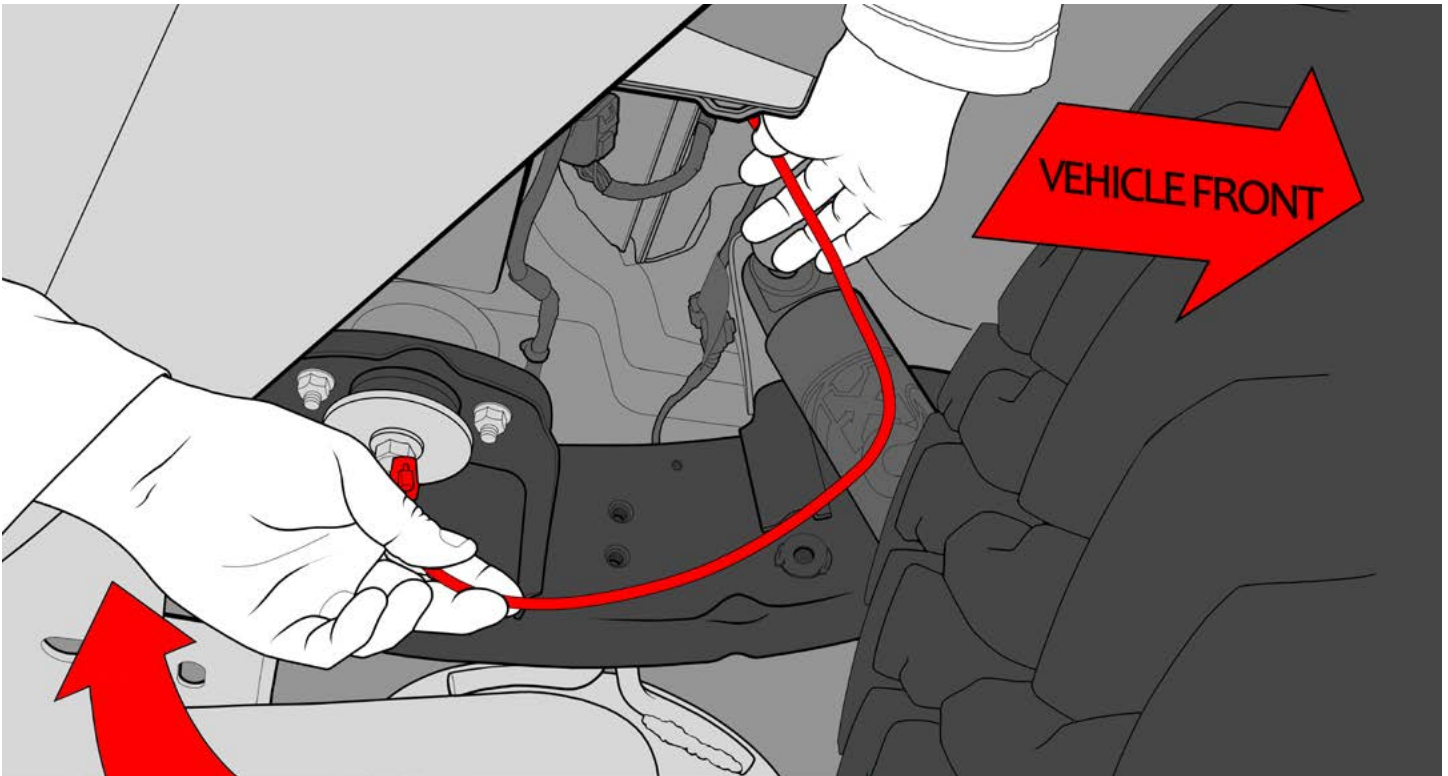

Underneath, feed the wire back up. You can use cable ties to fix it in place on nearby parts.

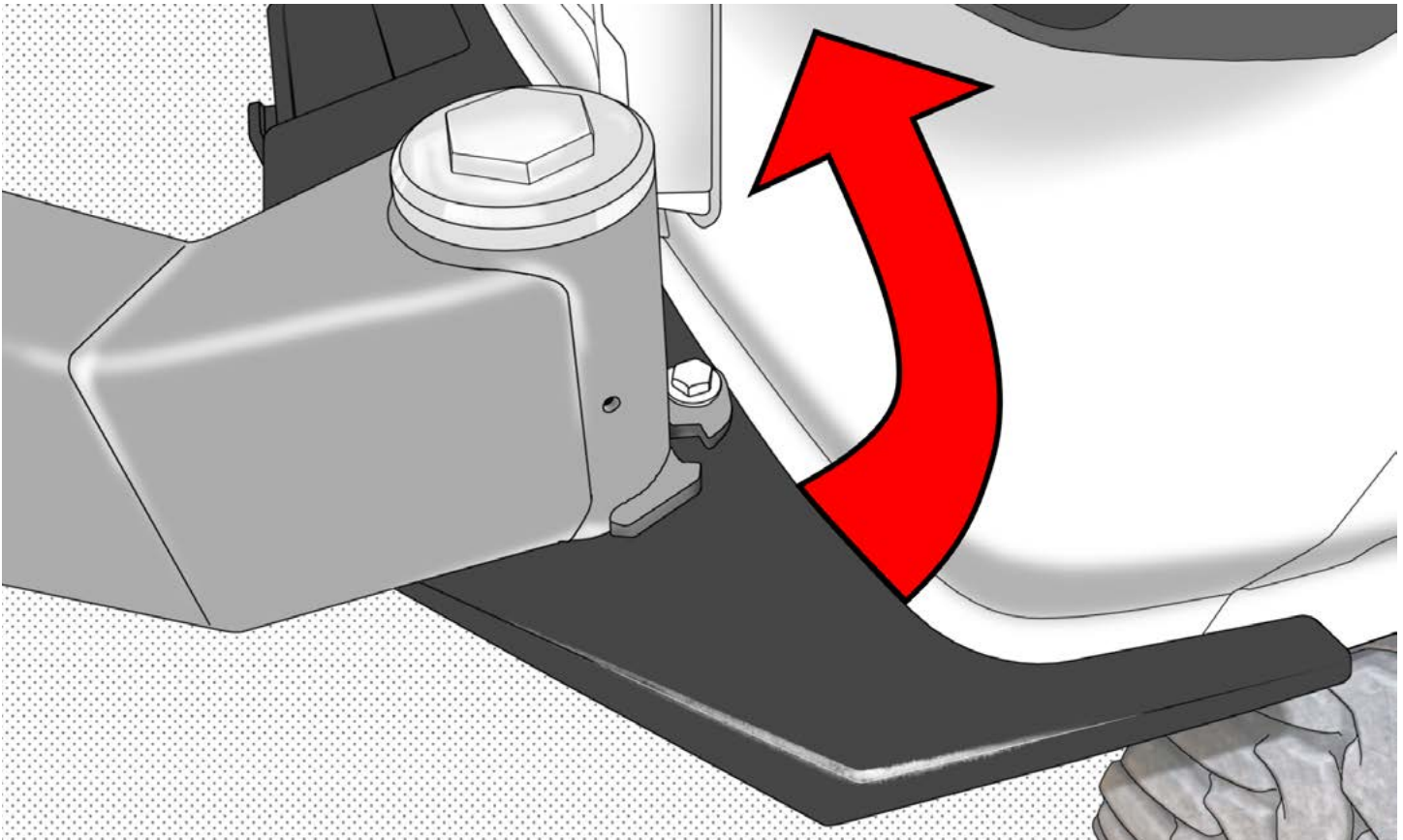

The wire should come up between the Jeep and the bumper, close to the base of the swing arm. Make sure the wire is fully uncurled and not kinked or twisted anywhere. Leave it hanging for now.

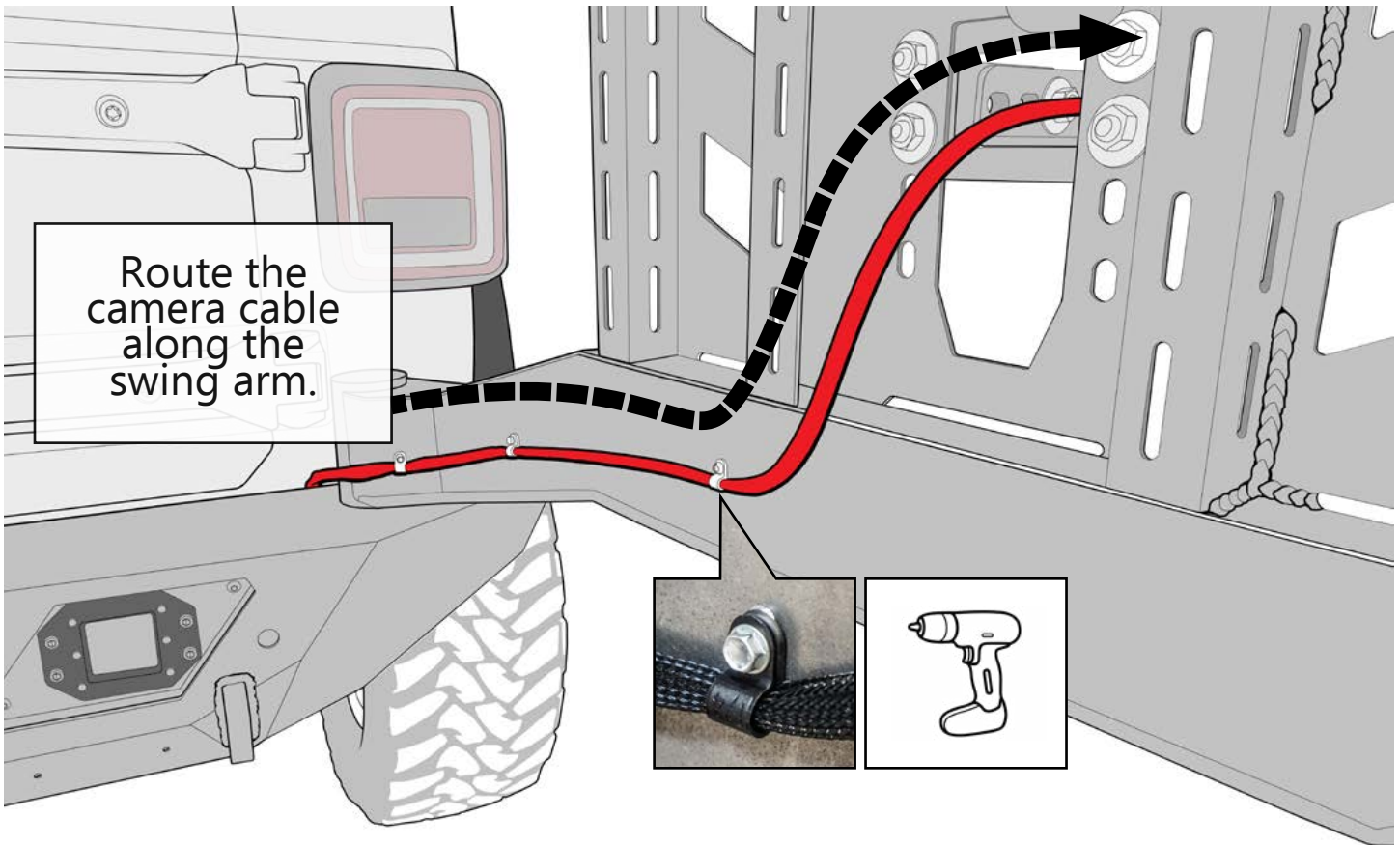

Attach the extension wire to at least 3 points with the provided cable loops and self-tapping screws. You may use a bead of silicone to seal the hole in order to prevent water from entering the carrier arm.

- ① First, attach the camera to the provided mount plate via the three (3) #2-56 x 0.5" screws and nuts.
- ② Plug the extension wire into the camera.
- ③ Attach the assembly to the main tube with the 1/4"-20 x 0.5" button head screw.

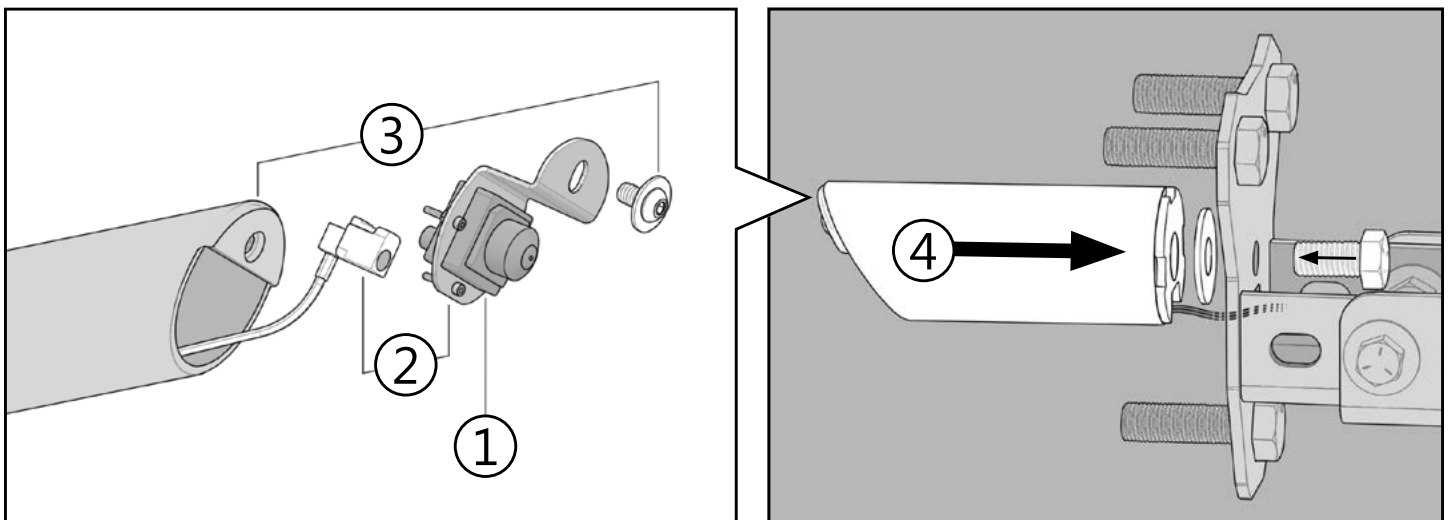

- ④ Attach the camera tube assembly to the tire mount via the provided 1/2"-13 x 1" hex bolt and washer.

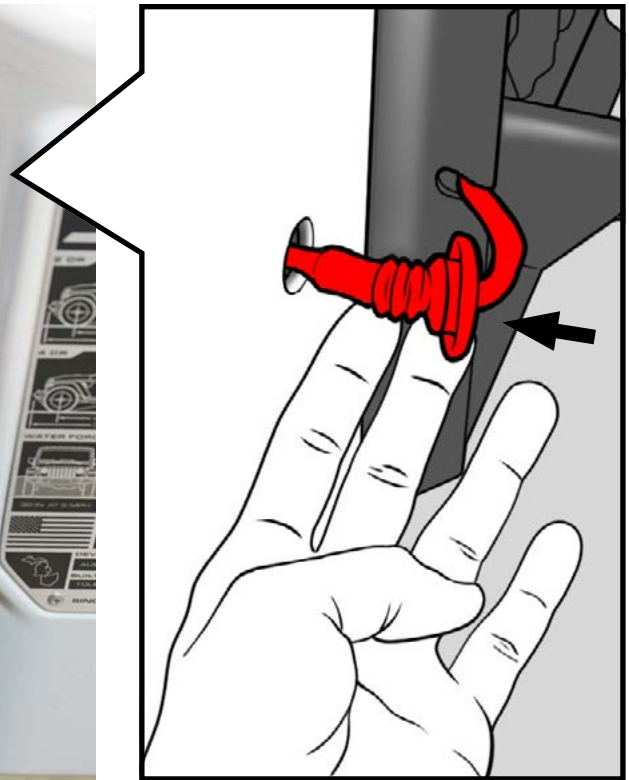

Plug the extension in, replace the grommet back into the hole.

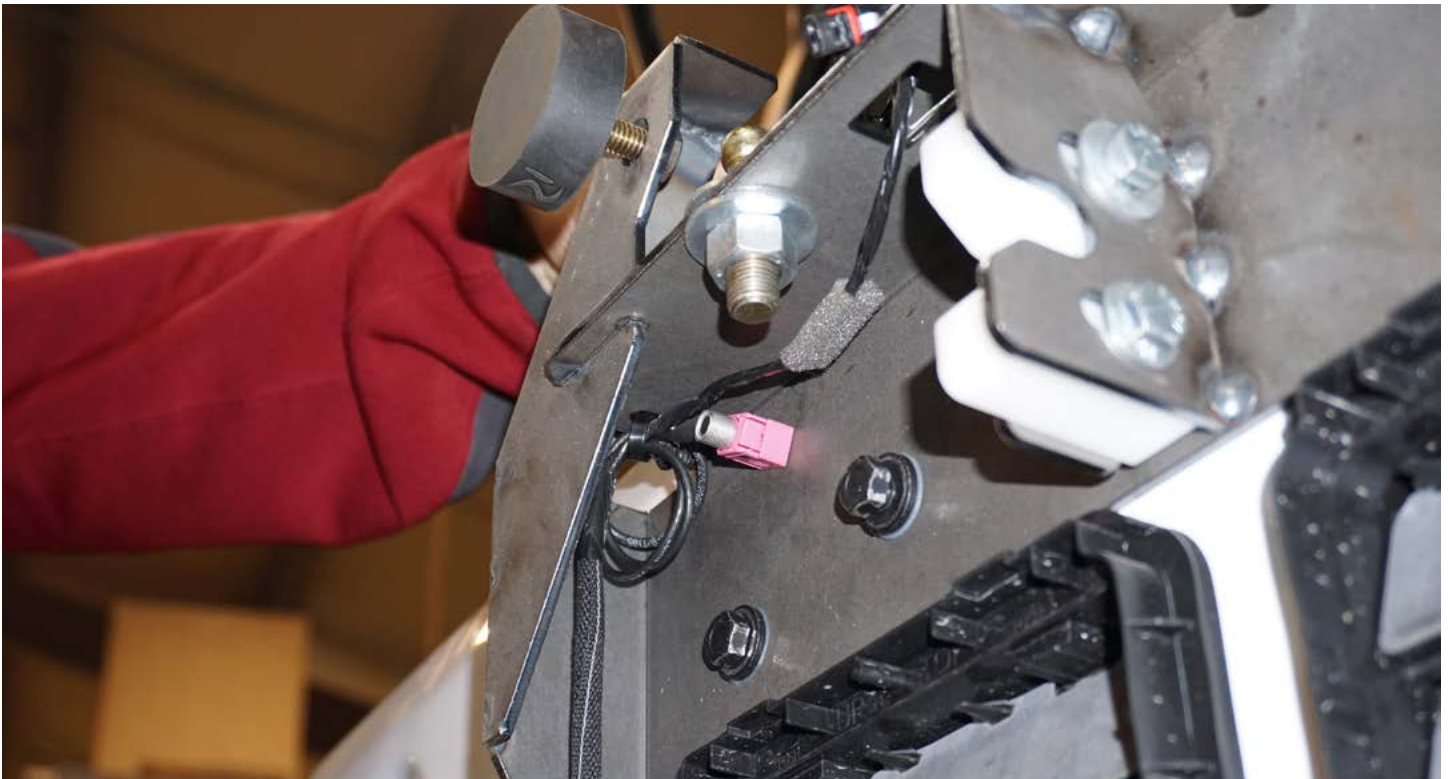

Tie up the old camera wire inside the door plate as shown.

If you are running a third brake light, run it through the indicated hole. If not, also tie it up.

ITEM NO.	PART NUMBER	DESCRIPTION	QTY.
1	4JRC1801-01	CAMERA TUBE WELDMENT	1
2	2JRC1801-04	CAMERA MOUNT CLIP	1

HARDWARE

ITEM NO.	PART NUMBER	DESCRIPTION	QTY.
3	HN0256SS	HEX NUT Ø2-56 STAINLESS STEEL	3
4	BHSCS252008SS	BHSCS 1/4-20 X 0.50 STAINLESS STEEL	1
5	FW2510ZP	FLAT WASHER Ø1/4" X .625 ZINC PLATE	1
6	HB501316ZPGR5	HEX BOLT 1/2-13 X 1.00 HEX BOLT ZINC PLATE GR5	1
7	FW5022ZP	FLAT WASHER Ø1/2" X 1.375" ZINC PLATE	1
8	SHSCS025608SS	SHSCS #2-56 X 0.50 STAINLESS STEEL	3
9	CAB1000	JEEP JL REARVIEW CAMERA CABLE	1
10	SL1000	EXPANDABLE POLYESTER SLEEVE Ø3/8" 10FT	1
11	WT1000	WIRE TIE - BLACK - 5 1/2" LG	8
12	WL1000	WIRE LOOP, BLACK 1/4" ID X 13/16" LG	3
13	HH081808SDZP	HEX HEAD #8 X .50 SELF DRILLING SCREW ZINC PLATE	3

ITEMS NOT SHOWN

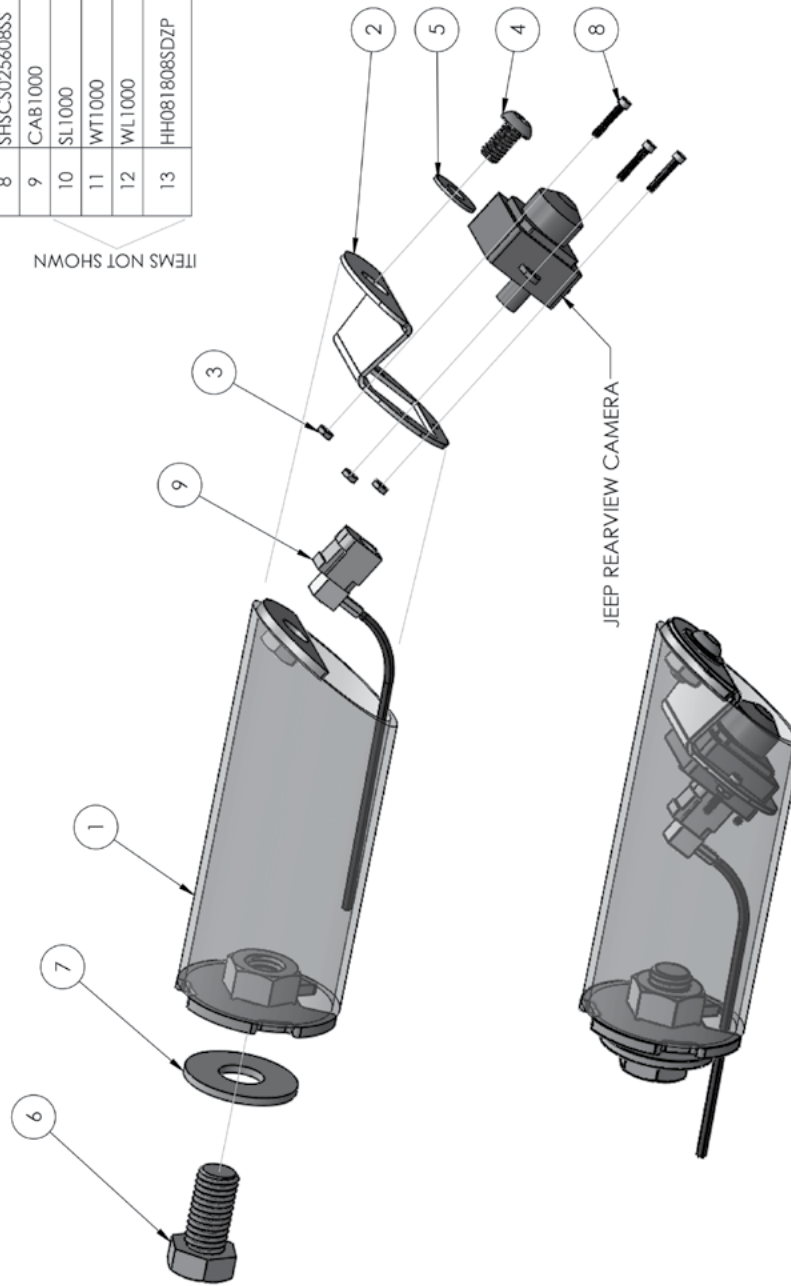

JEEP JL REARVIEW CAMERA KIT
JRC1801



JL Jeep
DESTROYER SERIES
 Rear Bumper + Tire Carrier
 Rear View Camera Kit
 SHIPPING SHEET
 Packaged by:

On: _____



Instruction
 Booklet



(3)
 Cable Loop

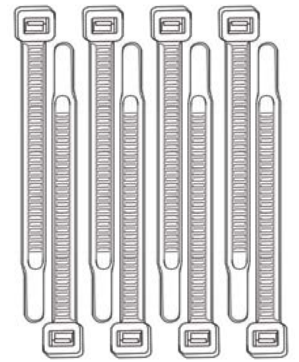

(8)
 5.5" Zip Ties

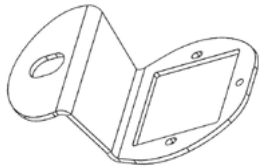

(1)
 Camera Mount
 Clip

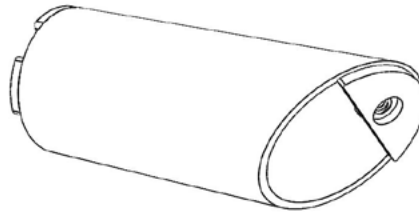

(1)
 Camera tube weldment

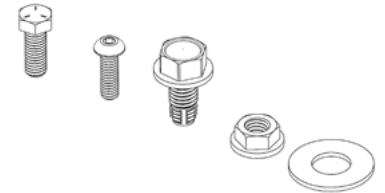

Bolt Kit
 (contents may vary from
 image)

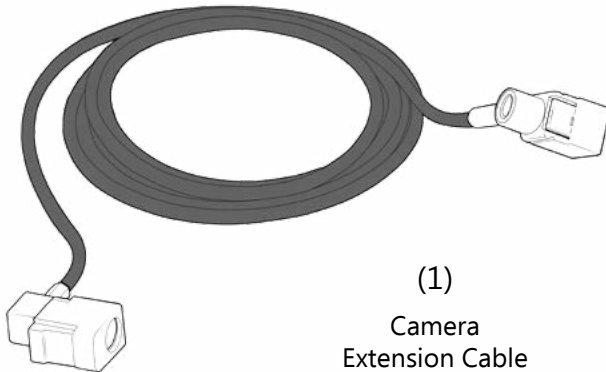

(1)
 Camera
 Extension Cable
 actual appearance may vary



(1)
 10ft Camera
 Cable
 Sheath





JL Jeep
DESTROYER SERIES
Rear Bumper + Tire Carrier
Rear View Camera Kit
Bolt Kit
Packaged by:

On:

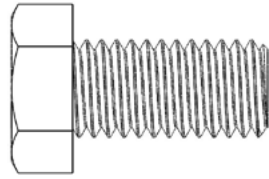

(1)
Hex Bolt
1/2"-13 x 1"

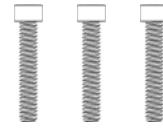

(3)
Socket Cap Screws
#2-56 x 0.5"



(3)
Hex Nuts
#2-56

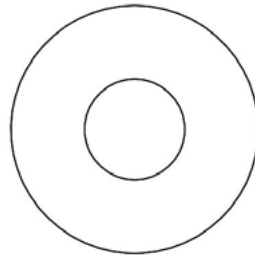

(1)
Washer
1/2"

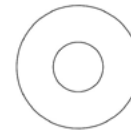

(1)
Washer
1/4"

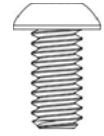

(1)
Button
Head Screw
1/4"-20 x 0.5"

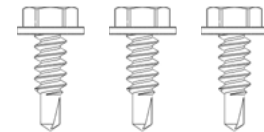

(3)
Self-Tapping
Hex Screw
#8 x 0.5"

