



DESTROYER SERIES



JEEP JK 4DR
BASE ROOF RACK



WEB LINK: <http://lodoffroad.com/assets/pdfs/JRR0704 JK 4DR Base Roof Rack.pdf>

VERIFY YOU HAVE ALL THE COMPONENTS BEFORE STARTING THE INSTALLATION. REFER TO THE ENGINEERING DRAWINGS AT THE END OF THIS DOCUMENT FOR A COMPLETE PARTS LIST

PLEASE READ THROUGH THE ENTIRE INSTRUCTION SET BEFORE BEGINNING THE INSTALLATION PROCESS

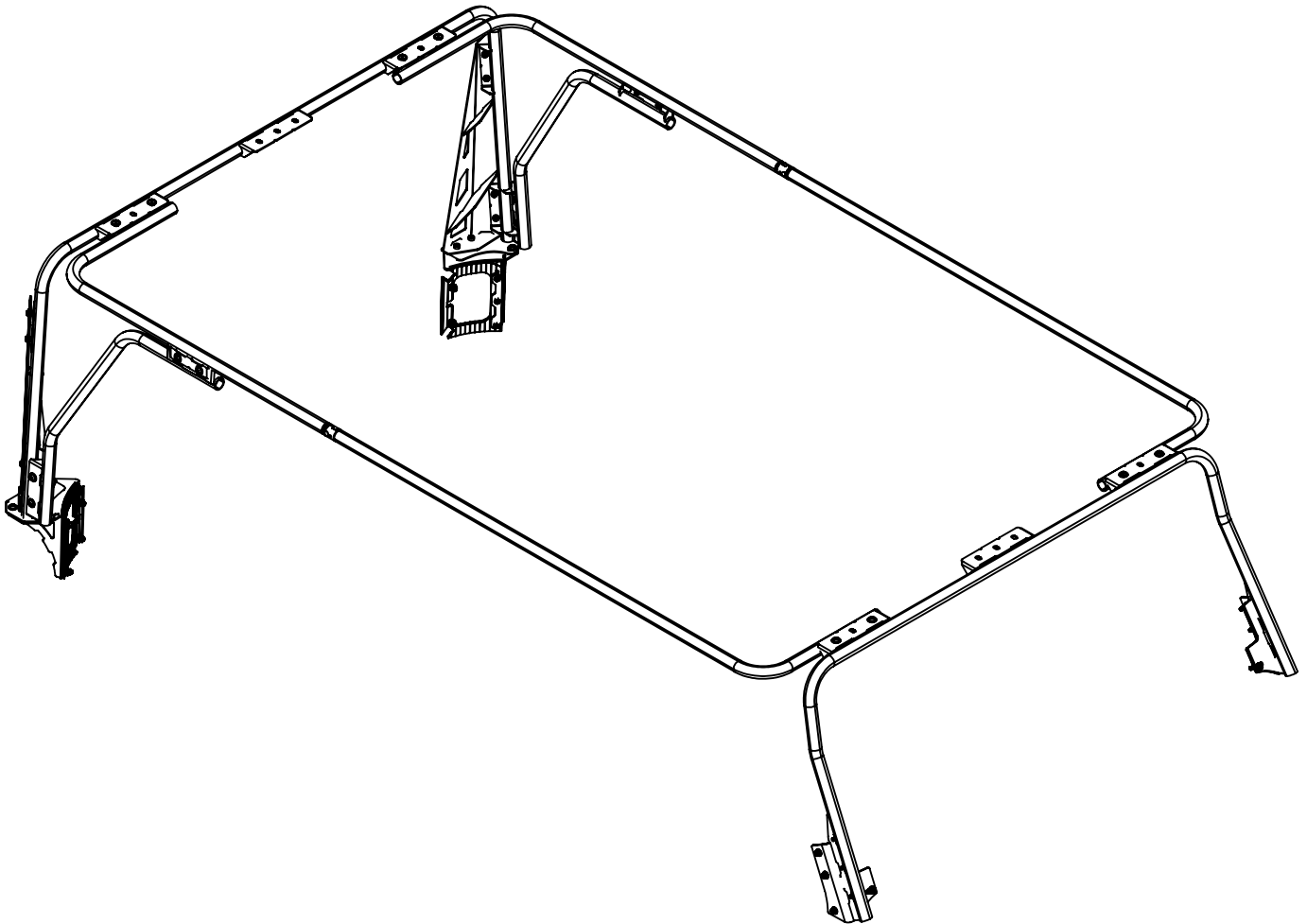

Refer to the Engineering drawings included with this document for the correct hardware required at each step of the installation.

Start by removing your Jeep JK tail lights. Use the JK Tail Light Mount DS (driver side) as a template. Align the mount with the tail light opening making sure its level.



Use a marker to mark the 5 mounting holes for drilling. Repeat the process for the passenger side.



With all holes marked, use a transfer punch to mark the very center of the holes for drilling.



Drill each hole using a 5/16" diameter drill bit. To improve your drilling accuracy, it is a good idea to drill these holes starting with a small diameter drill bit and get progressively larger.

Be sure to use the JK Tail Light Gasket when installing the JK Tail Light Mount.



Securely fasten the Tail Light Mount using 5/16" Flat Head Screws, Washers and Nuts.

On the outboard side of the Tail Light Mount, use the Inside Tail Light Bracket to provide additional support to the body.

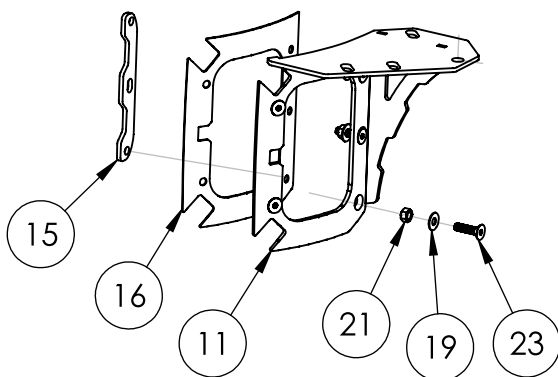

Inside Tail Light Bracket

Place the Rear Hoop Weldment on top of the Tail Light Mounts. Loosely fasten in the two locations shown with 3/8" Button Head Screws, Nuts and Washers. Do this on both the driver and passenger side.



Be sure to use the JK Windshield Gasket when installing the JK Front Hoop Weldment.

Remove the 4 existing M8 screws that fasten to your windshield A pillar.



Securely fasten the JK Front Hoop Weldment using 4 M8 Socket Head Screws and Washers on each side.

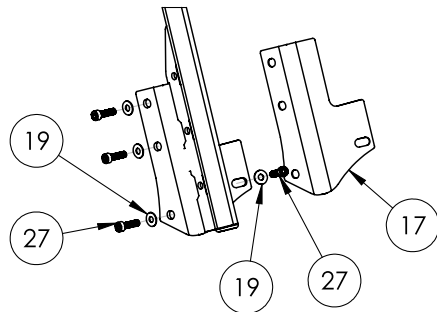

Install the Hole Plugs into the open tube ends of the Front Hoop Weldment.

We recommend using black or clear Silicone to seal the hole plug into the tube end.



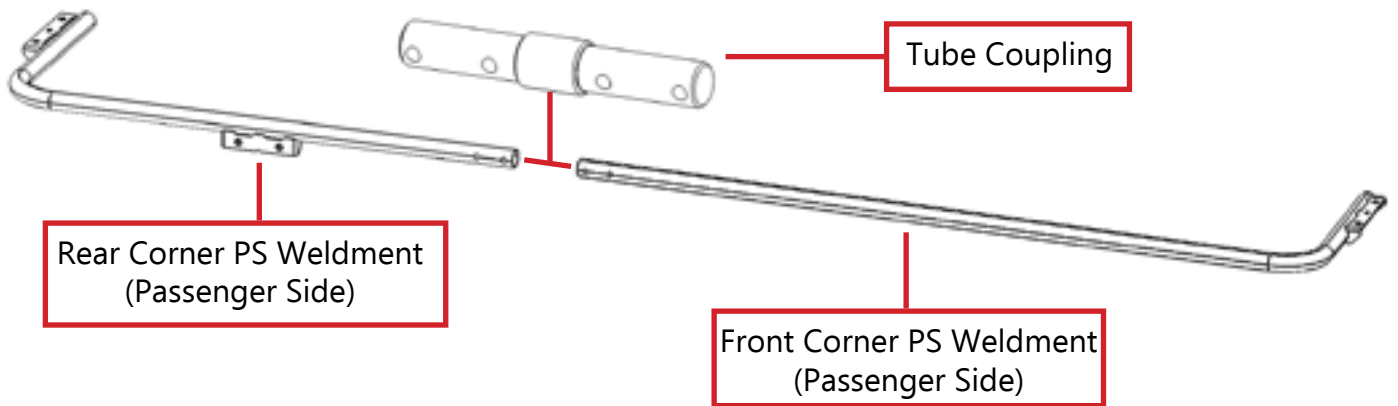

** Add sealant onto the Tube Coupling before installing into the Front and Rear Corner Weldments. **

Install the Tube Coupling into the Rear Corner PS Weldment and the Front Corner PS Weldment using 5/16" Button Head Screws, Nuts and Washers.

Install the Hole Plugs with sealant into the open tube ends of the Front and Rear Corner Weldments.

Loosely install this assembly onto the Front and Rear Hoops using 3/8" Button Head Screws and Washers.

The Jeep pictured here our JLU and not the JKU, however the instructions from this point on are the same for both.



Repeat the steps above for the Driver Side Front and Rear Corner Weldments.



Loosely Install the Rear Bar Gusset PS (Passenger Side) onto the rack using 3/8" Button Head Screws and Washers. Repeat the installation for the Drivers Side.

Be sure to install Hole Plugs with sealant into the open tube ends!



Loosely install Rear Corner Gusset Weldment (PS) Passenger Side onto the Tail Light Mount and Rack as shown using 3/8" Button Head Screws and Washers.

Repeat the Installation for the Driver Side.



****Once all components are installed, tighten all screws and bolts!**
Do this BEFORE installing your Front Stabilizers!**

Install the Front Stabilizers on both the driver and passenger side using 3/8" Button Head Screws and Washers.

Install the Leveling Bumper and Threaded Knob. The JK Front Stabilizer only has one on each side. Use a 5/16" Hex Nut to lock the Leveling Bumper to the Threaded Knob.

Adjust the knobs on both sides equally to add pressure to the Front Windshield Hoop.



In order to reinstall the tail lights, you will need to trim the two small hook features of the tail light assembly.

View of Passenger Side Tail Light and Hook Feature Shown Here

Use a Dremel Rotary tool to carefully cut as shown below.

Make sure you clamp the tail light to a table top or have someone hold it while cutting.

A smaller diameter Dremel bit is easier to control, we used 1/16" diameter bit, but a slightly large bit would also work well.

Remove the hook feature that is directly beside the Brake lamp.

Trim Hook beside Reverse Light

Trim the hook feature that is directly beside the Reverse lamp. You will want to trim approx. 1/16"-1/8" of plastic from the hook. See the image below for the area which should be trimmed.

Remove Hook beside Brake Light

Trim this area



****The Base Rack Installation is now complete! We recommend after a few days to check all screws and bolts to make sure they are tight.****

****Base Rack Specifications****

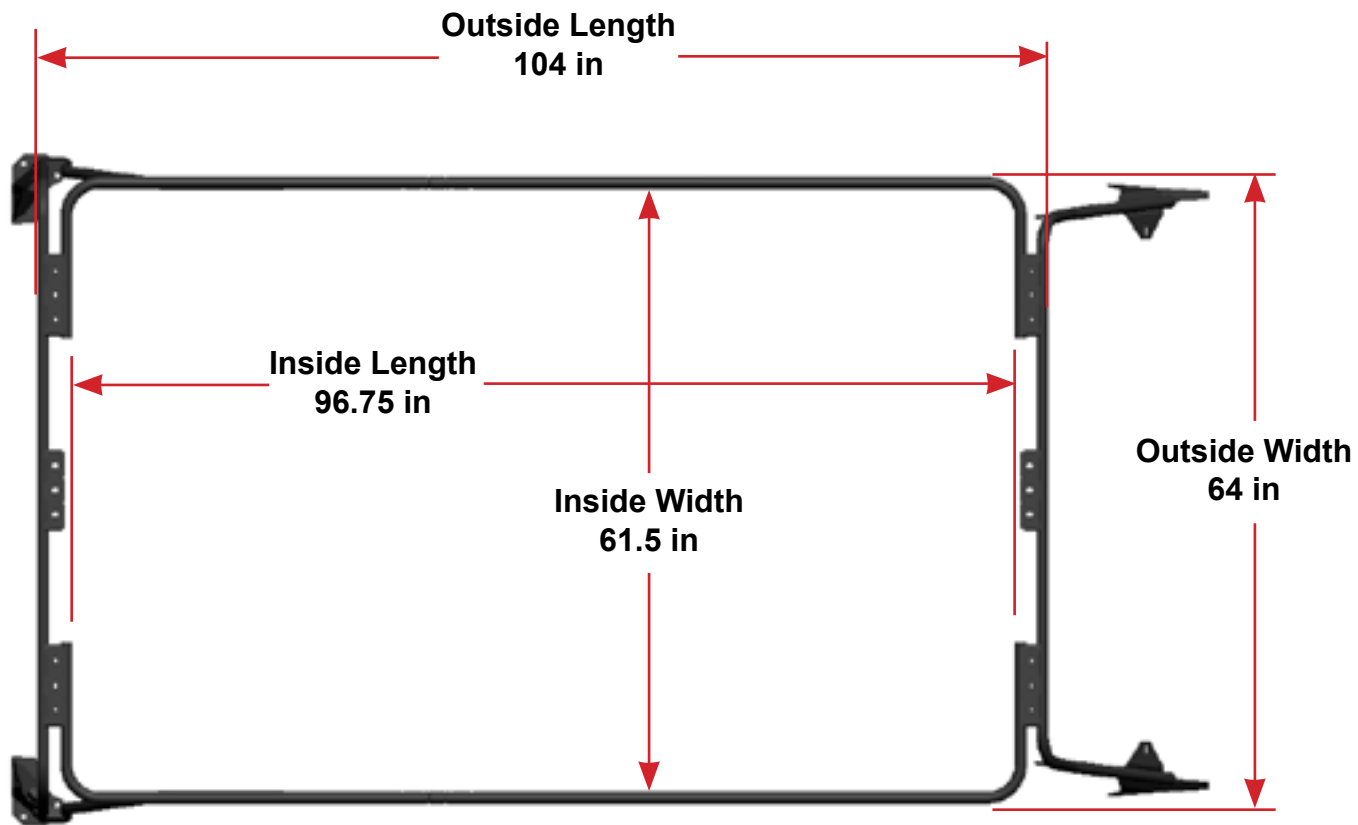

JK / JL Base Rack Dimensions

**800 Lbs Static
300 lbs Driving
Evenly Distributed Load**

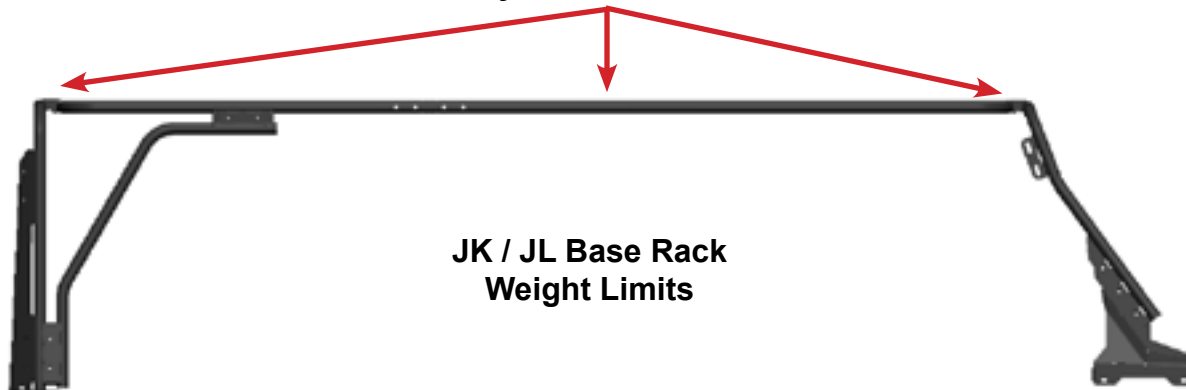

**JK / JL Base Rack
Weight Limits**

ITEM NO.	PART NUMBER	DESCRIPTION	QTY.
1	4JRR0704-01	JK FRONT HOOP WELDMENT	1
2	4JRR0704-03	FRONT CORNER DS WELDMENT	1
3	4JRR0704-11	FRONT CORNER PS WELDMENT	1
4	4JRR0704-18	REAR CORNER PS WELDMENT	1
5	4JRR0704-19	REAR CORNER DS WELDMENT	1
6	4JRR0704-24	REAR HOOP WELDMENT	1
7	4JRR0704-20	REAR BAR GUSSET PS	1
8	4JRR0704-21	REAR BAR GUSSET DS	1
9	4JRR0704-22	REAR CORNER GUSSET WELDMENT PS	1
10	4JRR0704-23	REAR CORNER GUSSET WELDMENT DS	1
11	4JRR0704-25	JK TAIL LIGHT MOUNT PS	1
12	4JRR0704-26	JK TAIL LIGHT MOUNT DS	1
13	4JST0791-01	JK FRONT STABILIZER WELDMENT PS	1
14	4JST0791-02	JK FRONT STABILIZER	1
15	2JRR0704-18	INSIDE TAIL LIGHT BRACKET	2
16	2JRR0704-09	JK TAIL LIGHT GASKET	2
17	2JRR0704-51	JK WINDSHIELD GASKET	2
18	2JRR0704-79	TUBE COUPLING	2

HARDWARE

ITEM NO.	PART NUMBER	DESCRIPTION	QTY.
19	FW2512ZP	FLAT WASHER Ø11/4" X .75 ZINC PLATE	34
20	FW3114ZP	FLAT WASHER Ø5/16" X .875" ZINC PLATE	40
21	HN3118ZPGR5	HEX NUT 5/16-18 ZINC PLATE GR5	20
22	HN3816ZPGR5	HEX NUT 3/8-16 ZINC PLATE GR5	4
23	FHSCS311820CZ	FHSCS 5/16-18 X 1.25 CZ	10
24	BHSCS381612ZP	BHSCS 3/8-16 X .75 ZINC PLATE	28
25	BHSCS381616ZP	BHSCS 3/8-16 X 1.00 ZINC PLATE	8
26	BHSCS311828ZP	BHSCS 5/16-18 X 1.75 ZINC PLATE	8
27	SHSCS08125M30ZP	SHSCS M8-1.25 x 30mm ZINC PLATE CL8.8	8
28	HP1003	HOLE PLUG Ø1.25" 10-14GA (MOCAP RN1-1/4DBK1)	10
29	KNI1004	KNOB, 5/16-18 x 1.56" LG THREADED STUD	2
30	BP1002	LEVELING BUMPER, 5/16-18	2

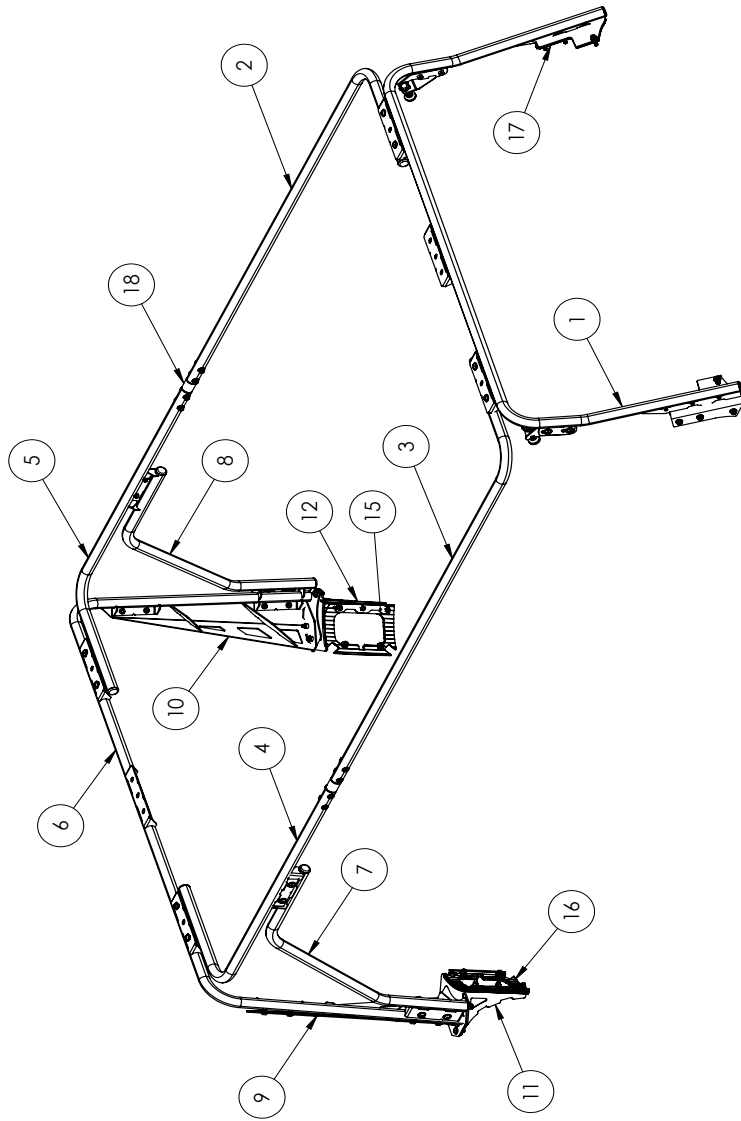

- NOTES:**
 1. JRR0704 = BARE STEEL OPTION
 2. JRR0714 = BLACK POWDER COAT OPTION

UNLESS OTHERWISE SPECIFIED:		NAME	DATE
DIMENSIONS ARE IN INCHES		MCH	7/26/2019
TOLERANCES: ±0.010	DRAWN	LOD LLC.	
ANGULAR: MACH: ±1°	CHECKED	DESCRIPTION: JEEP JK 4DR BASE ROOF RACK	
TWO PLACE DECIMAL ±0.015	ENG APPR.	MFG APPR.	
THREE PLACE DECIMAL ±0.005		MATERIAL: N/A	
PROPRIETARY AND CONFIDENTIAL			
THE INFORMATION CONTAINED IN THIS DRAWING IS THE SOLE PROPERTY OF LOD LLC. NO REPRODUCTION IN PART OR AS A WHOLE WITHOUT THE WRITTEN PERMISSION OF LOD LLC IS PROHIBITED.			
DWG. NO.		SCALE: 1:14	
JRR0704		SHEET SIZE: B	
JRR0714		REV	
		A	
		SHEET 1 OF 2	



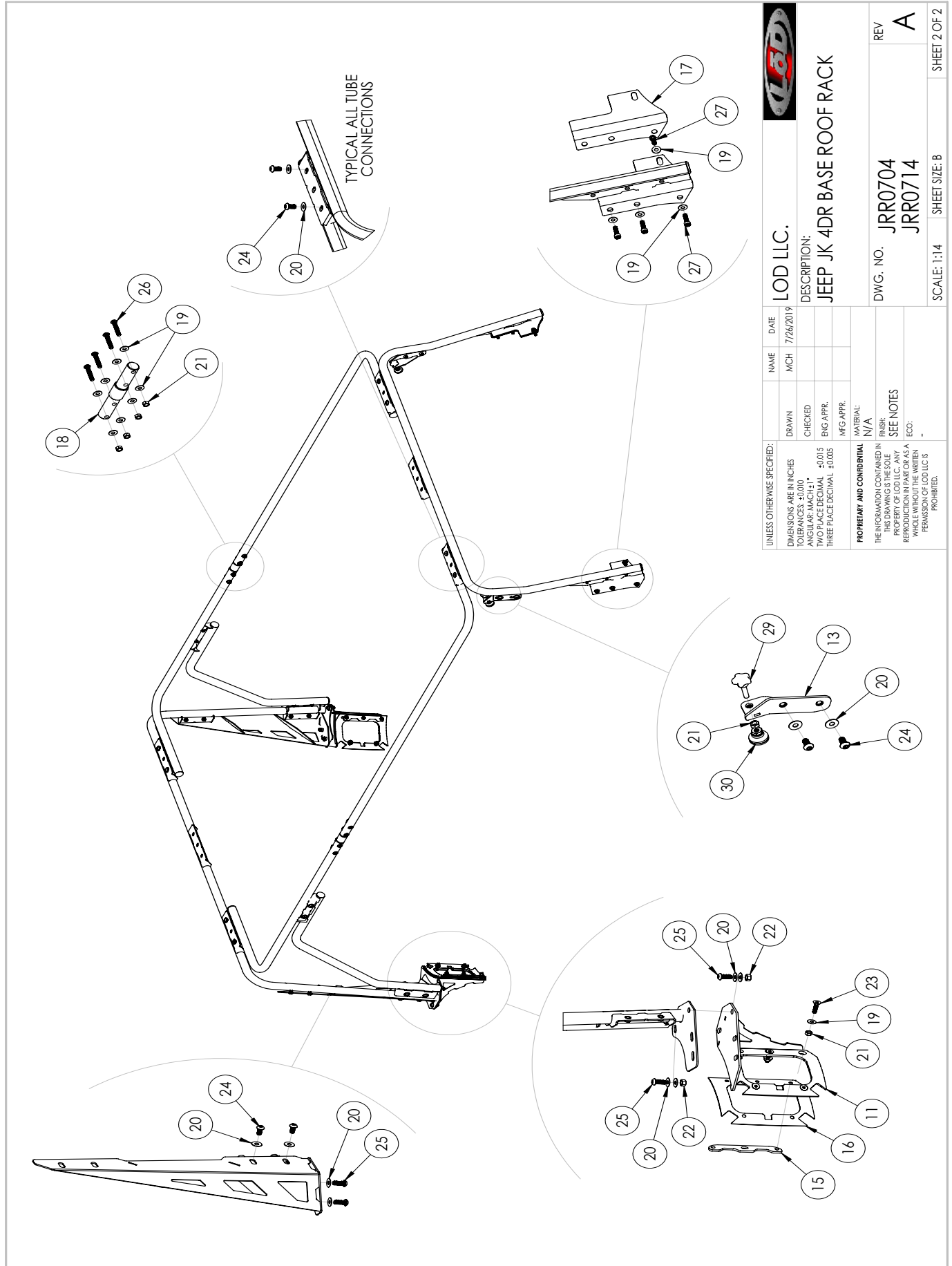

UNLESS OTHERWISE SPECIFIED:		NAME	DATE
DIMENSIONS ARE IN INCHES		MCH	7/26/2019
TOLERANCES: ±0.00	DRAWN		
ANGULAR: MACH 1°	CHECKED		
TWO PLACE DECIMAL ±0.015	ENG APPR.		
THREE PLACE DECIMAL ±0.005	MFG APPR.		
MATERIAL:		N/A	
FINISH:		SEE NOTES	
ECCO:		SEE NOTES	
PERMISSION OF LOD LLC IS PROHIBITED.			

LOD LLC.

DESCRIPTION:
JEEP JK 4DR BASE ROOF RACK

DWG. NO. **JRR0704**
JRR0714

SCALE: 1:14 SHEET SIZE: B

REV **A**

SHEET 2 OF 2



JK Jeep

DESTROYER SERIES

JEEP JK 4DR
BASE ROOF RACK
SHIPPING SHEET

Packaged by:

On:

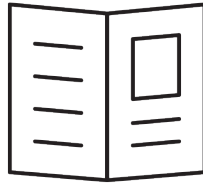

Instruction
Booklet

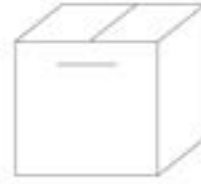

Hardware Kit
(contents
may vary)



JK FRONT HOOP WELDMENT
4JRR0704-01

(x1)



FRONT CORNER DS WELDMENT
4JRR0704-03

(x1)

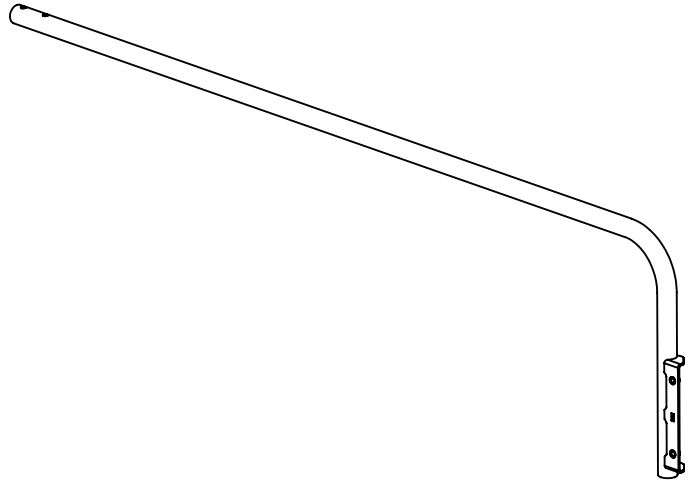

FRONT CORNER PS WELDMENT
4JRR0704-11

(x1)

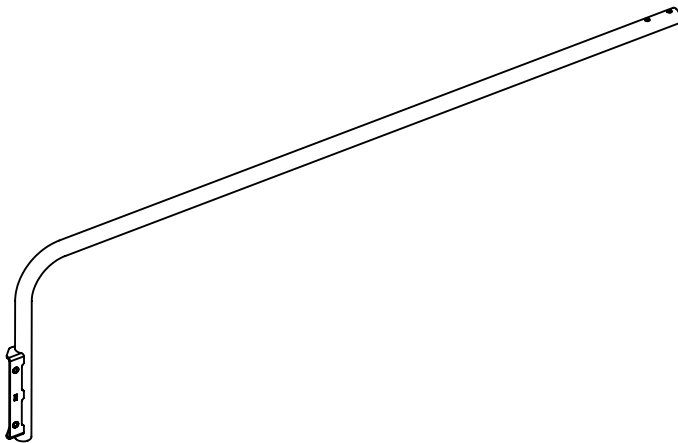

REAR CORNER PS WELDMENT
4JRR0704-18

(x1)

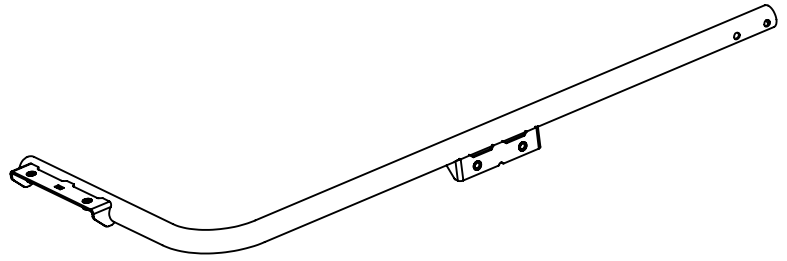

REAR CORNER DS WELDMENT
4JRR0704-19

(x1)

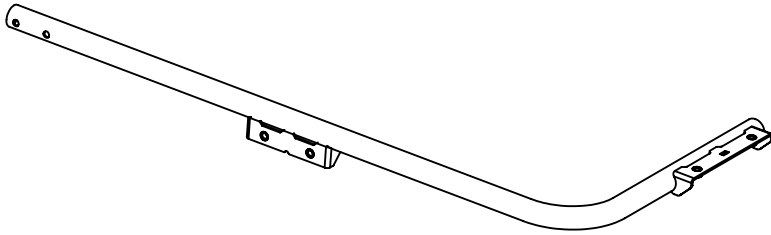

REAR HOOP WELDMENT
4JRR0704-24

(x1)

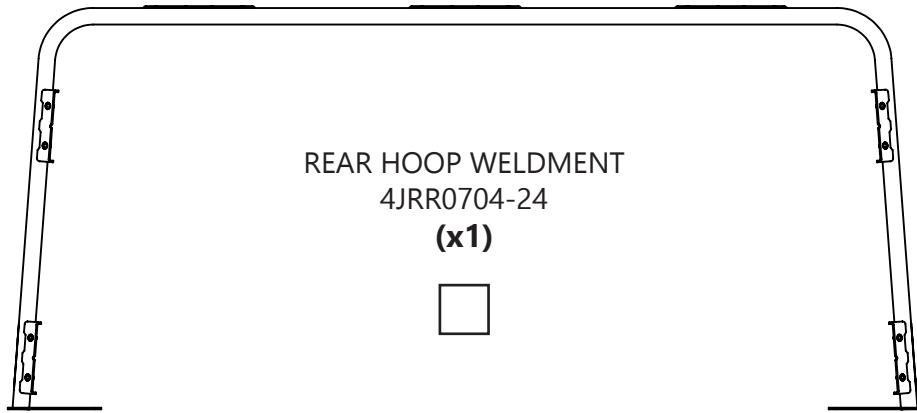

REAR BAR GUSSET PS
4JRR0704-20

(x1)

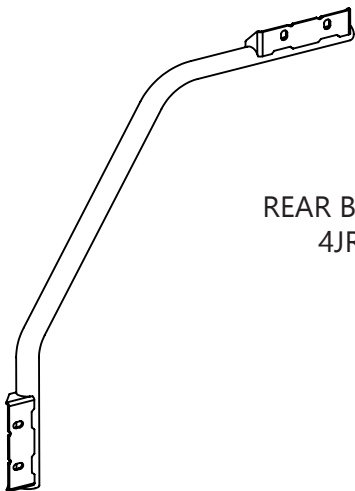

REAR BAR GUSSET DS
4JRR0704-21

(x1)

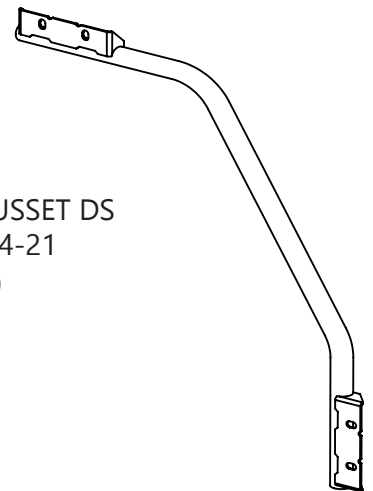



JK Jeep
DESTROYER SERIES
 JEEP JK 4DR
 BASE ROOF RACK
 HARDWARE KIT

Packaged by:

On:

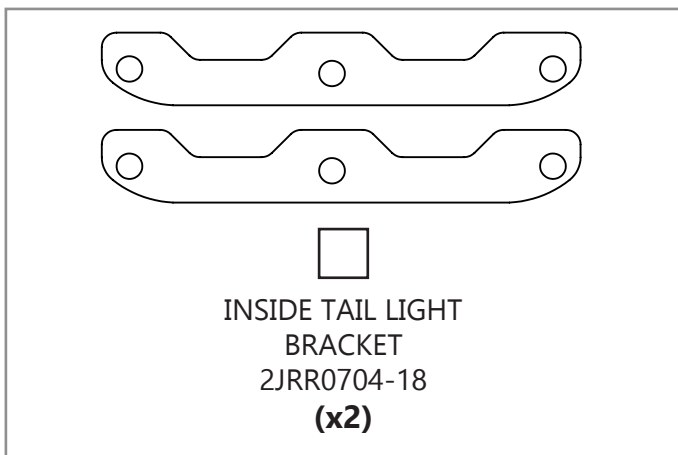
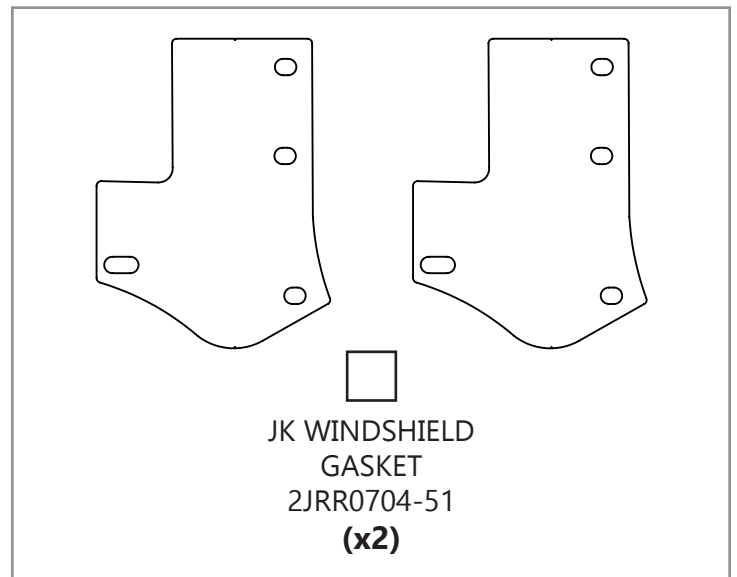
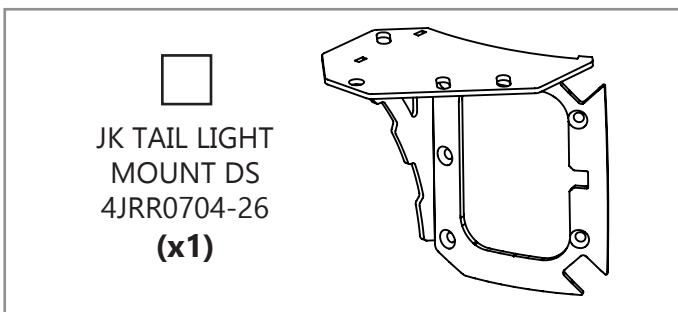
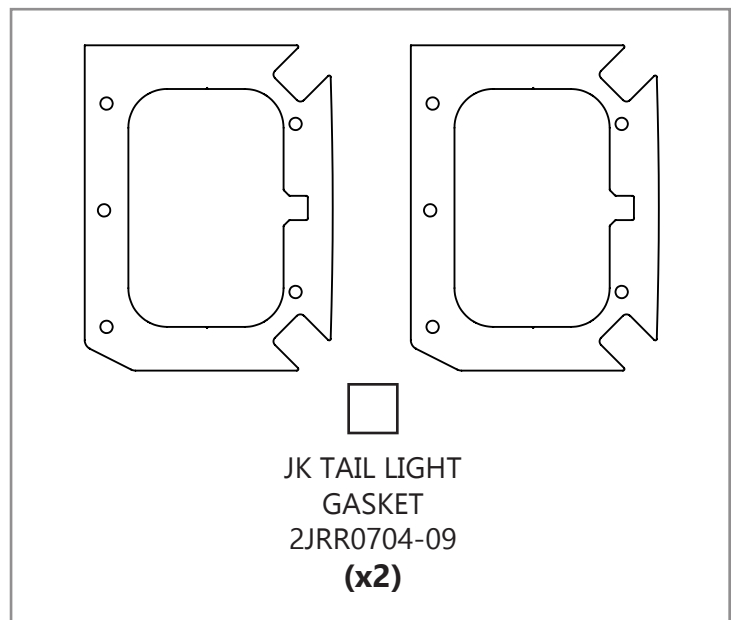
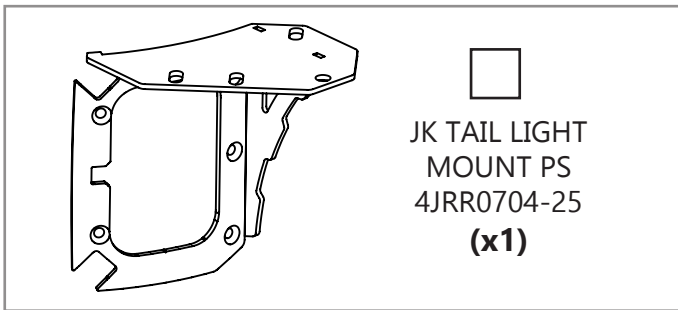
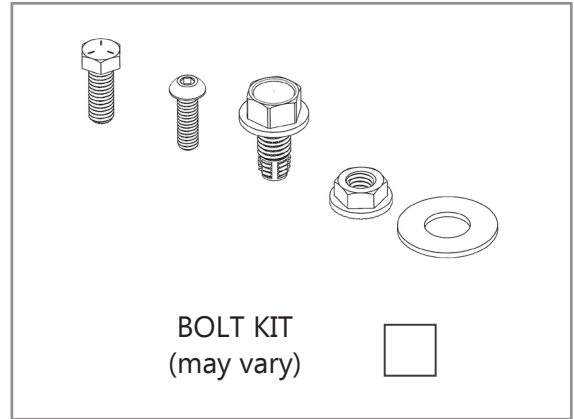

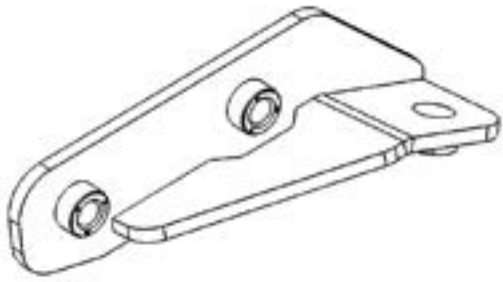

JK FRONT STABILIZER
WELDMENT PS
4JST0791-01
(x1)

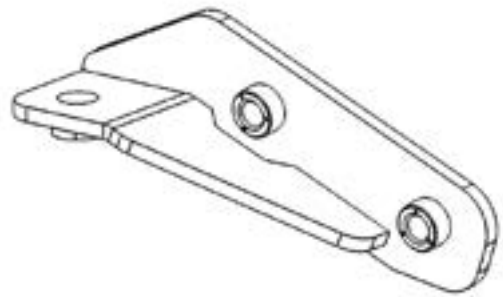

JK FRONT STABILIZER
WELDMENT DS
4JST0791-02
(x1)

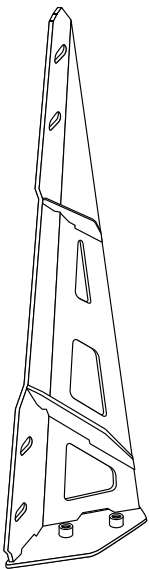

REAR CORNER
GUSSET
WELDMENT PS
4JRR0704-22
(x1)



REAR CORNER
GUSSET
WELDMENT DS
4JRR0704-23
(x1)

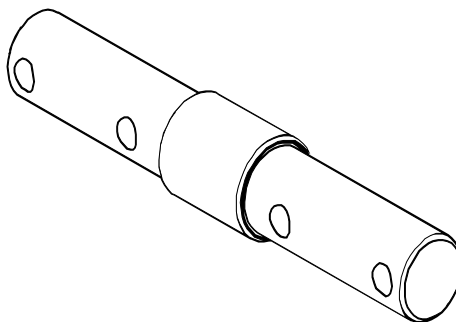
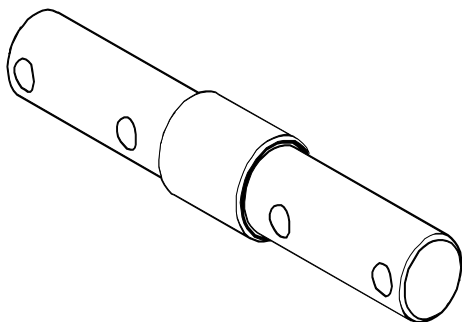
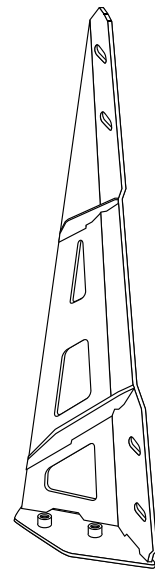

TUBE COUPLING
2JRR0704-79
(x2)





**JK Jeep
DESTROYER SERIES**

JEEP JK 4DR
BASE ROOF RACK
BOLT KIT

Packaged by:

On:

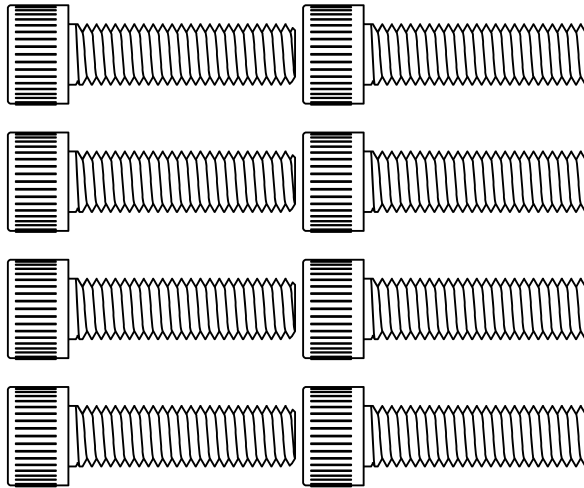

SOCKET HEAD SCREW
M8-1.25 X 30mm
(x8)

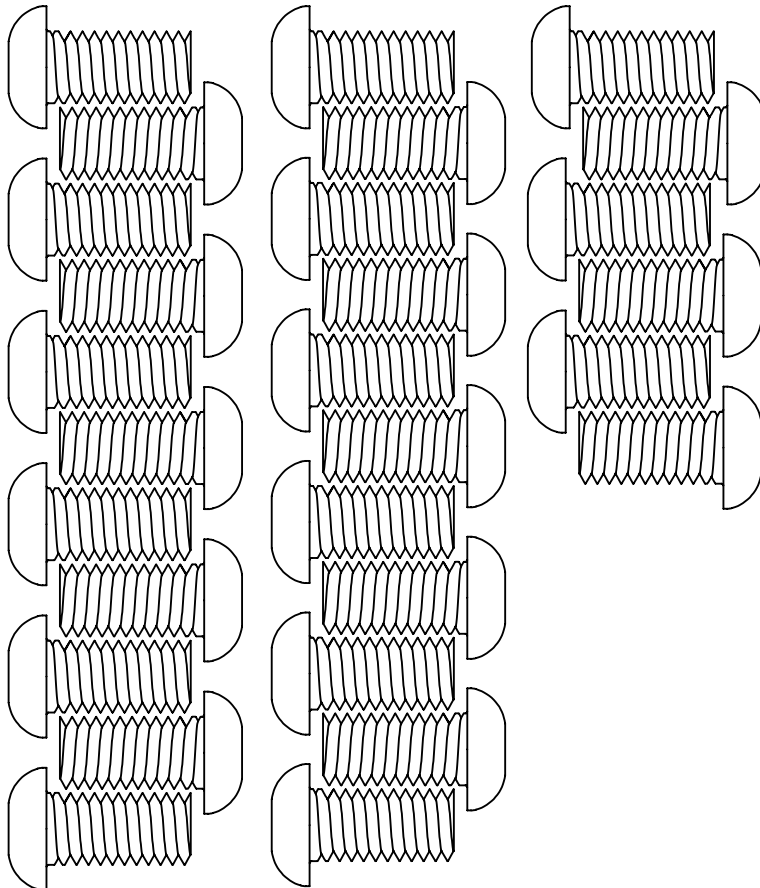

BUTTON HEAD SCREW
3/8-16 X .75
(x28)

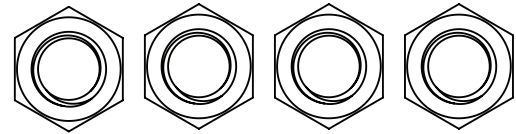

HEX NUT
3/8-16
(x4)

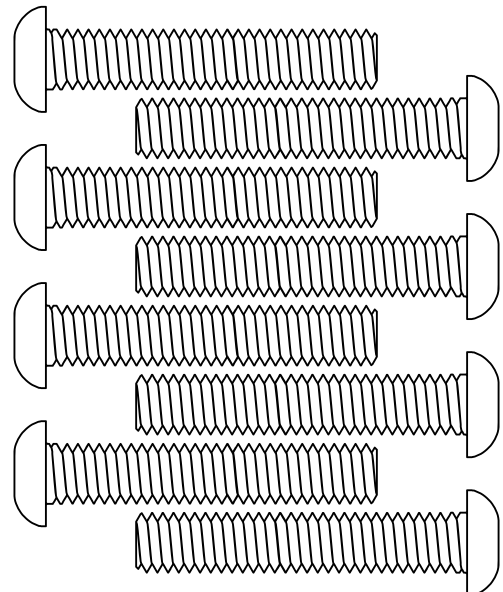

BUTTON HEAD SCREW
5/16-18 X 1.75
(x8)



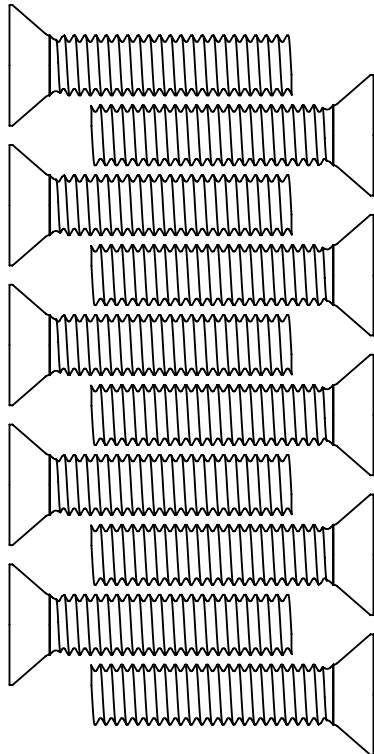

FLAT HEAD SOCKET SCREW
5/16-18 X 1.25
(x10)

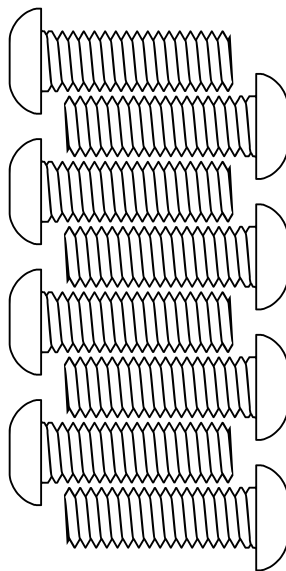

BUTTON HEAD SCREW
5/16-18 X 1
(x8)



LEVELING BUMPER, 5/16-18
BP1002
(x2)

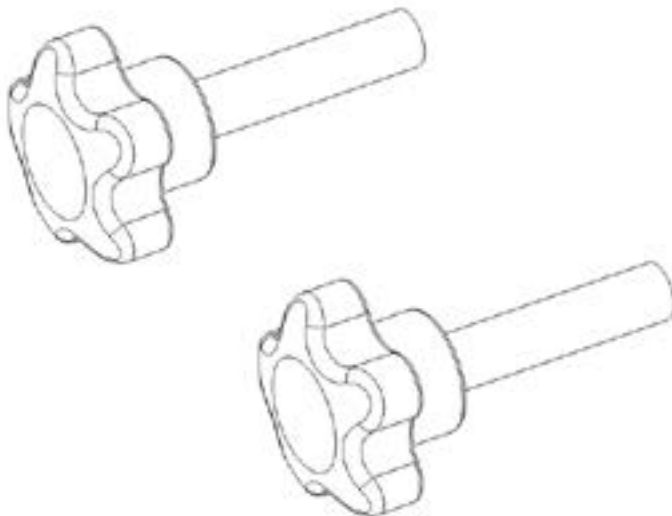

KNOB, 5/16-18 x 1.56" Lg
THREADED STUD
KN1004
(x2)

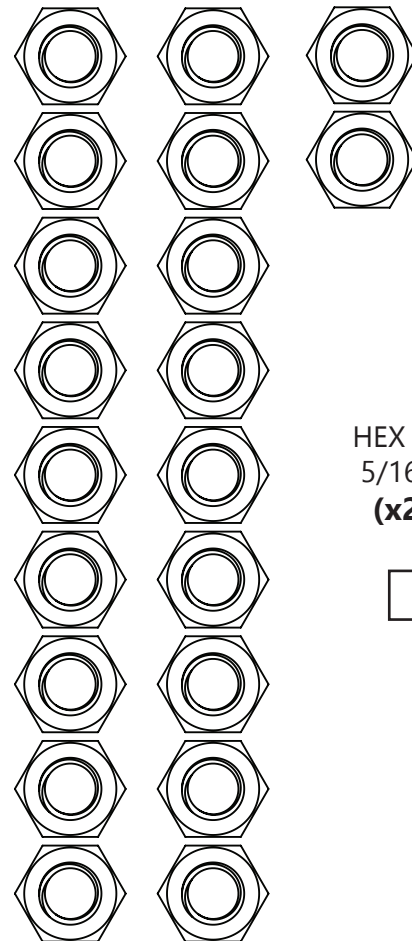

HEX NUT
5/16-18
(x20)



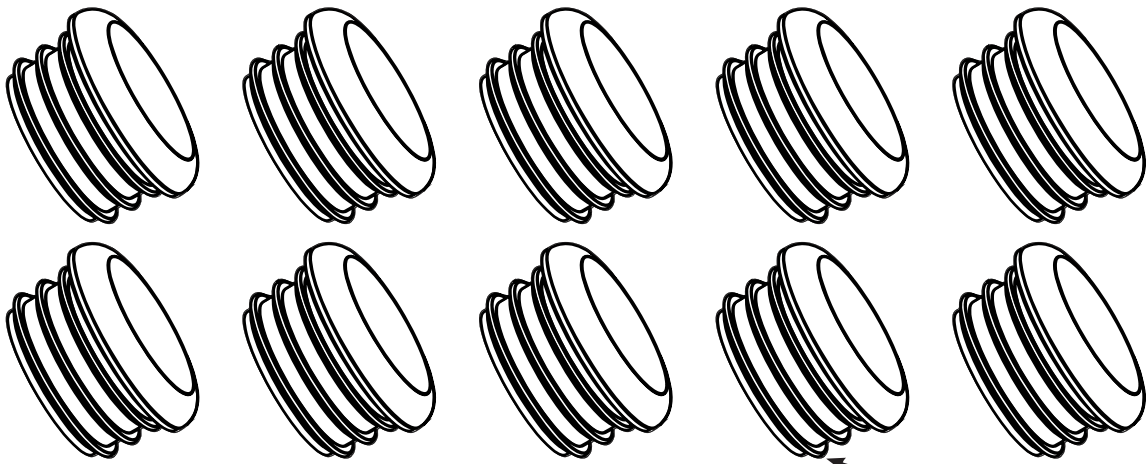

Hole Plug
HP1003
(x10)



Smaller Diameter

Mocap Part #
RN1-1/4DBK1

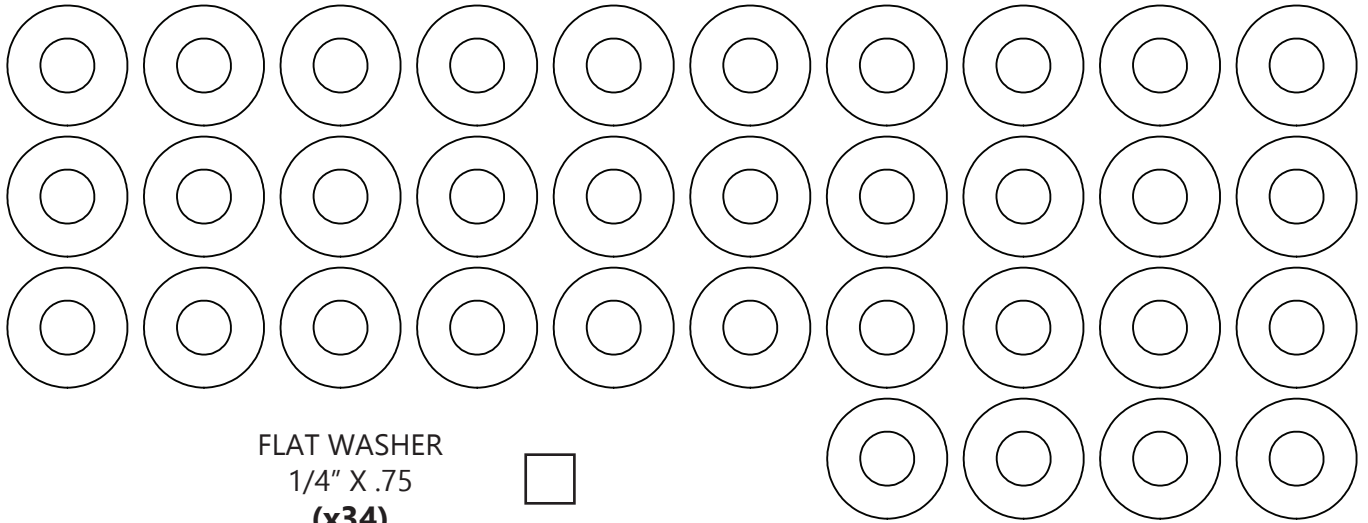

FLAT WASHER
1/4" X .75
(x34)



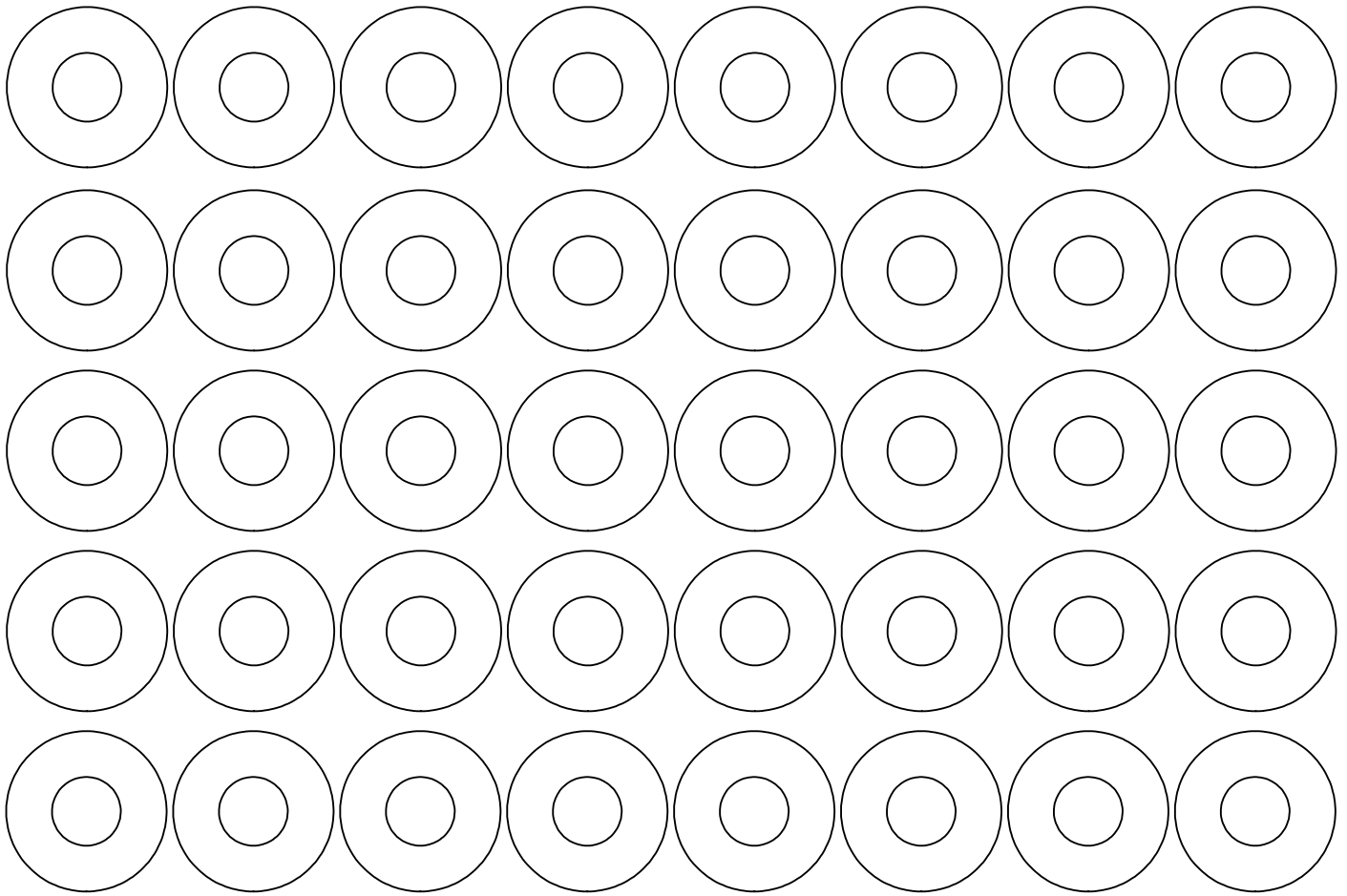

Flat Washer
5/16" X .875
(x40)

