



DESTROYER SERIES

JK/JL

JEEP JK/JL 4DR
SLIDING RACK KIT



WEB LINK: <http://lodoffroad.com/assets/pdfs/JSR0790 JK-JL SLIDING RACK KIT.pdf>

VERIFY YOU HAVE ALL THE COMPONENTS BEFORE STARTING THE INSTALLATION. REFER TO THE ENGINEERING DRAWINGS AT THE END OF THIS DOCUMENT FOR A COMPLETE PARTS LIST

PLEASE READ THROUGH THE ENTIRE INSTRUCTION SET BEFORE BEGINNING THE INSTALLATION PROCESS

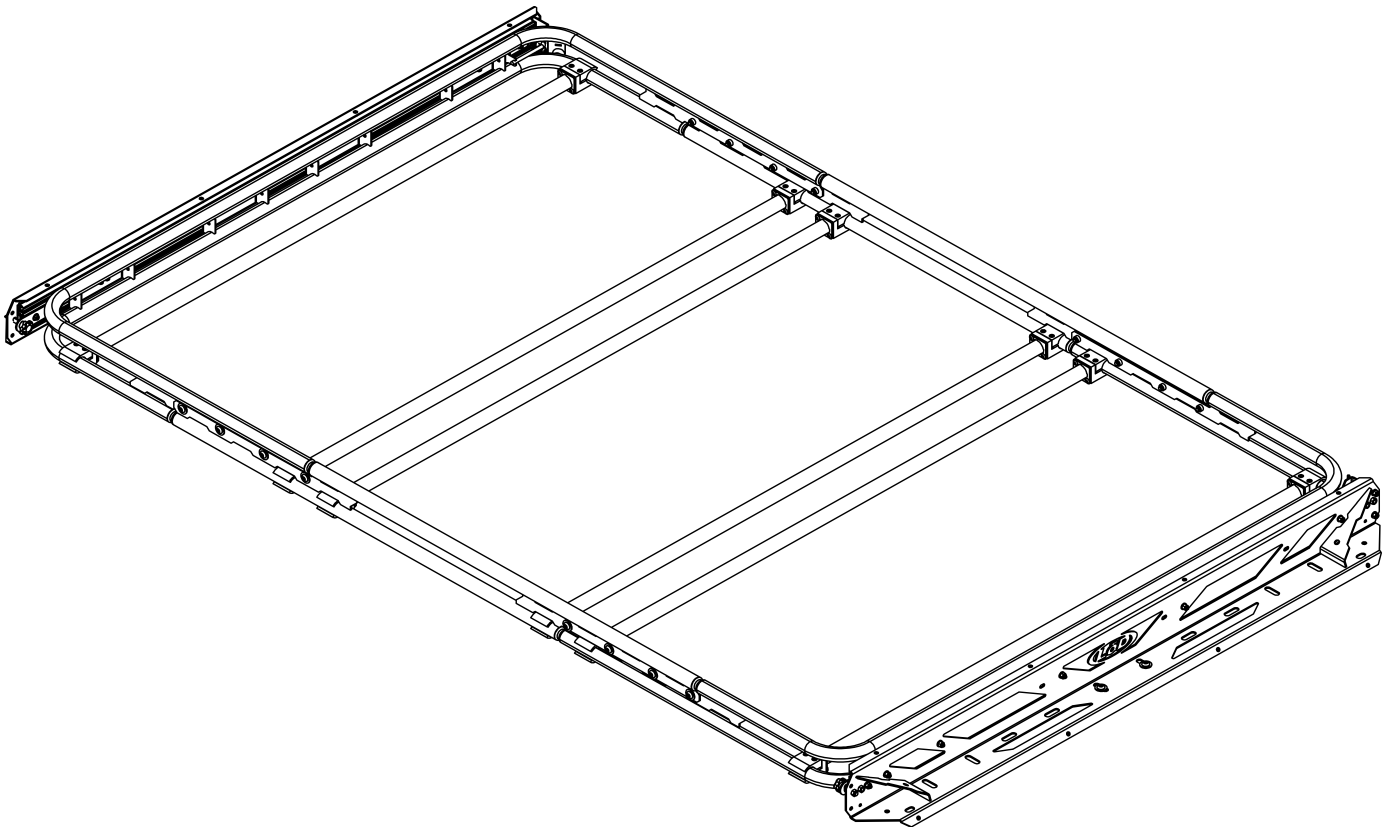

Refer to the Engineering drawings included with this document for the correct hardware required at each step of the installation.

Start by assembling the Drawer Slides to the Slide Beam Weldment.

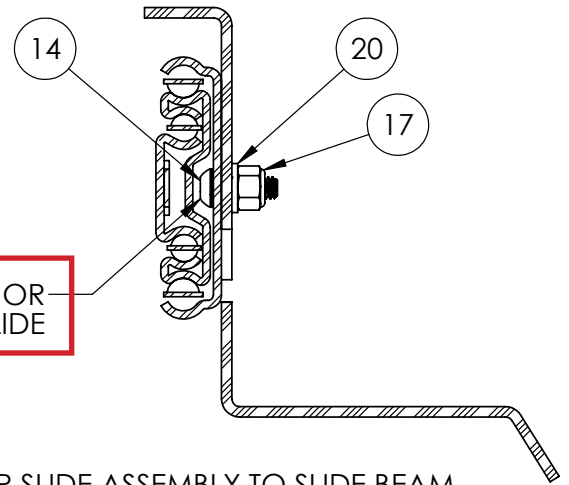

DRAWER SLIDE ASSEMBLY TO SLIDE BEAM

Clear a large flat area on the floor and lay the Drawer Slide and the Slide Beam Weldment parallel with each other.

You will need to open the Drawer slide completely to gain access to the mounting holes. Align the Drawer Slide with the holes shown and securely fasten using 1/4" Button Head Screws, Washers and Lock Nuts.

Build the second assembly exactly the same way, except lay the Drawer Slide so that it opens in the opposite direction.

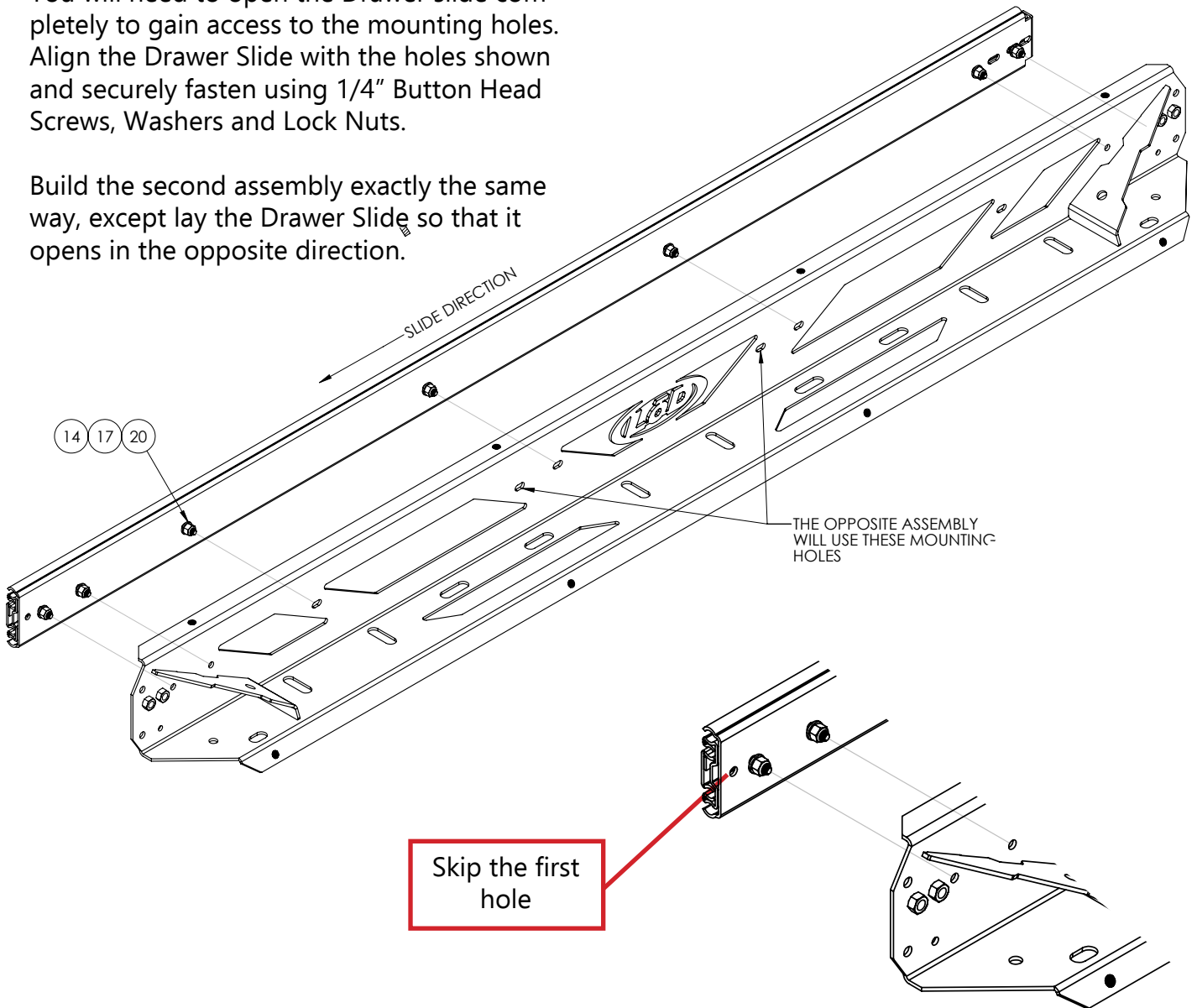

Install the Drawer Slide Assembly onto the (previously installed) Base Roof Rack.

Temporarily remove these fasteners



Temporarily remove the existing fasteners that holed the Corner Tube Weldments to the Front Windshield Hoop, two in each corner.

Choose whether you want the Sliding Rack to open towards the driver side or passenger side. On our Jeep we chose to open the Sliding Rack towards the passenger side.



Place the appropriate Drawer Slide assembly on the Front Windshield Hoop and loosely re-install fasteners.

Loosely install two additional 3/8" Button Head Screws, Washers and Nuts into the center slots as shown.

Additional mounting screws



Loosely install the second Drawer Slide assembly onto the Rear Hoop following the same steps show above.

Be sure that both Drawer Slide assemblies are loosely mounted, this important to achieve the proper spacing for the Basket assembly.

Once installed, verify that both drawer slides open in the direction you intended!



Install the Hole Plugs into all open tube ends of the End Basket Weldments and the Center Rail Weldments.

We recommend using black or clear Silicone to seal the hole plug into the tube end.

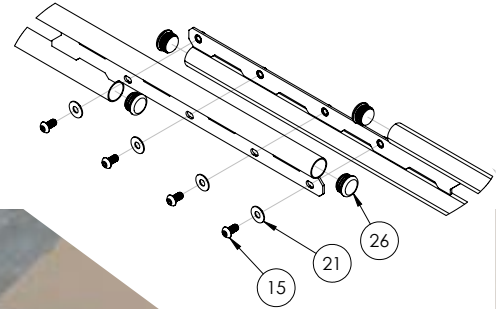
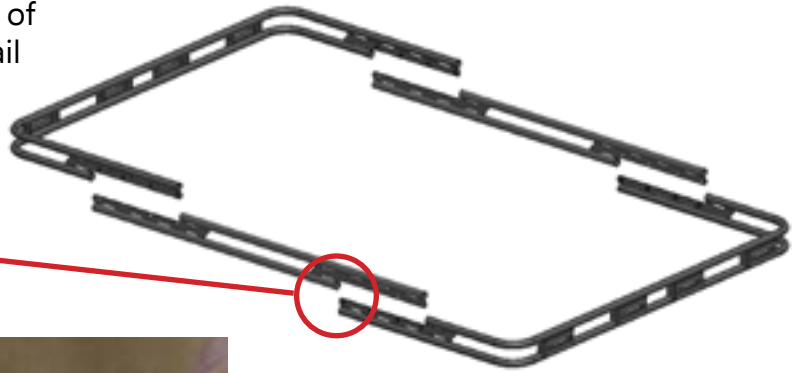

Layout two End Basket Weldments and two Center Rail Weldments as shown above and securely fasten with 3/8" Button Head Screws and Washers.



Extend the Drawer Slides and circle the mounting holes on the inside with a marker. Use the chart shown below to circle holes #6, 7, 8, 10, 11 and 12. This will help during installation of the Basket assembly.

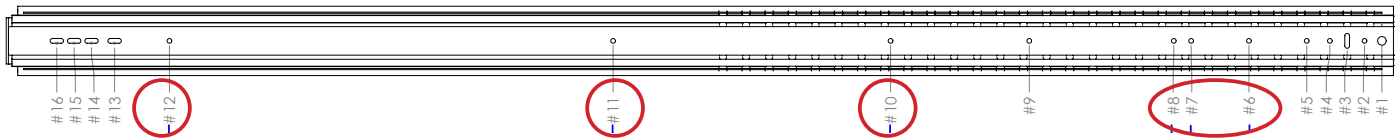

With both Drawer Slides fully extended. Carefully rest one side of the Basket assembly onto the Base Roof Rack.

While one person holds the Basket assembly in place, line up the mounting holes in the Drawer Slide that were circled in the previous step with the slots in the Basket mounting brackets. See the diagram below.

Be sure to line up the mounting holes with the ****LOWER SLOTS****.

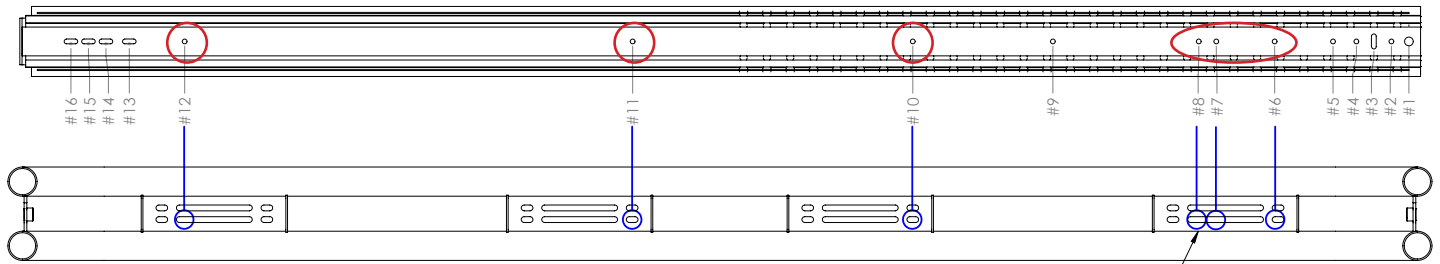

With the mounting holes and slots lined up, securely fasten the Basket assembly to the Drawer Slide using #10 Button Head Screws, Washers and Lock Nuts.

Its easiest to start with hole #6 on both Drawer Slides and work your way to #12.

The section view to the right shows the orientation of screw installed into the Drawer Slide from the "INSIDE".

You will need to "Slide" the Drawer Slide closed slightly to line up the access holes for mounting holes #11 and #12.

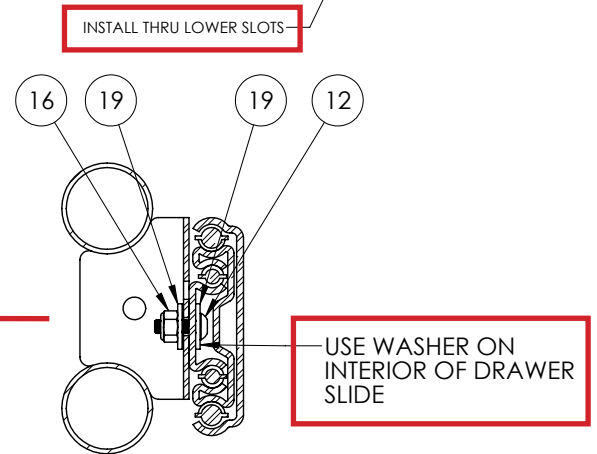

DRAWER SLIDE ASSEMBLY TO END BASKET



With the Sliding Rack in the "Closed" position, adjust the front and rear Slide Beam Weldments (which were installed loosely) so that the Sliding Rack is squared up with the Base Roof Rack.



Tighten the (6) 3/8" Button Head Screws on the front and rear Slide Beam Weldments. As you tighten them, check for smooth operation of the Sliding Rack. Open the Sliding Rack by pulling from the center of the rack only. It should slide easily with no sticking along its travel.



If you feel the rack stick while opening, try loosening the front or rear Slide Beam Weldment and re-tighten. It may take a couple of adjustments to get it perfect.

Assemble the Front and Rear Latch assemblies as shown using 1/4" Button Head Screws, Washers and Lock Nuts.



Securely fasten the Latch assemblies to the front and rear Slide Beam Weldments using 1/4" Button Head Screws, Washers and Lock Nuts. The Rubber Bumper should be in the lower position on both front and rear.

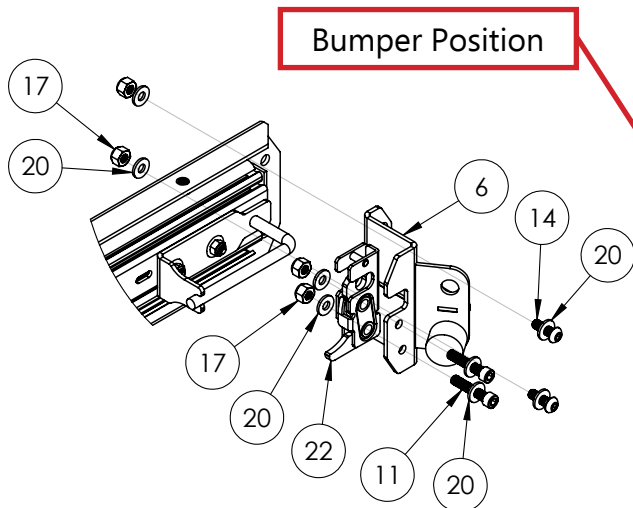

Securely fasten the Striker Weldment onto the front and rear Drawer Slides using #10 Button Head Screws, Washers and Lock Nuts as shown.

Be sure to install the Striker Weldment on the 2nd and 4th Slot.

You will need to open the Sliding Rack to the fully open position and use the access hole to install the Striker Weldment.



Access Hole

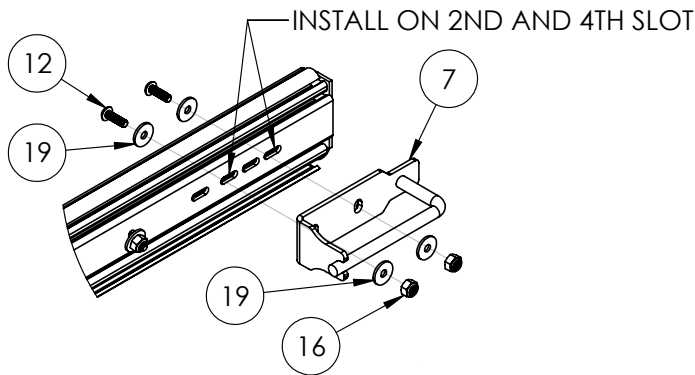

Adjust the Rubber Bumpers on the Latch assemblies so they DO NOT make contact. With both Strikers installed, slowly close the Sliding Rack, pushing from the center, until the Strikers engage the Latch assemblies.

Both Latches should engage at the same time, if not adjust the Strikers IN/OUT or UP/DOWN.

Verify the Latches are completely LOCKED by trying to open the Sliding Rack. Both Latches should be LOCKED. If one or both fail to lock, you may need to adjust the Strikers.

Adjust the Rubber Bumper until it makes contact with the Basket tubing then add 2 turns. If the Sliding Rack is difficult to latch, you can adjust the Rubber Bumpers Slightly.



Rubber Bumper

Securely Install the Safety Plate onto the ends of the Drawer Slides as shown using #10 Button Head Screws, Washers, and Lock Nuts.

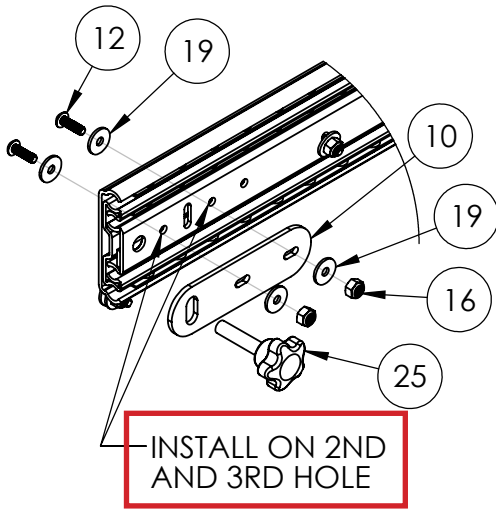

Install the Safety Knob w/Lanyard in the position shown. Attach the Lanyard using #10 Button Head Screw, Washers, and Lock Nut.

Always be sure your Safety Knob is installed prior to operating your vehicle. NEVER drive your vehicle without the Safety Knob installed.

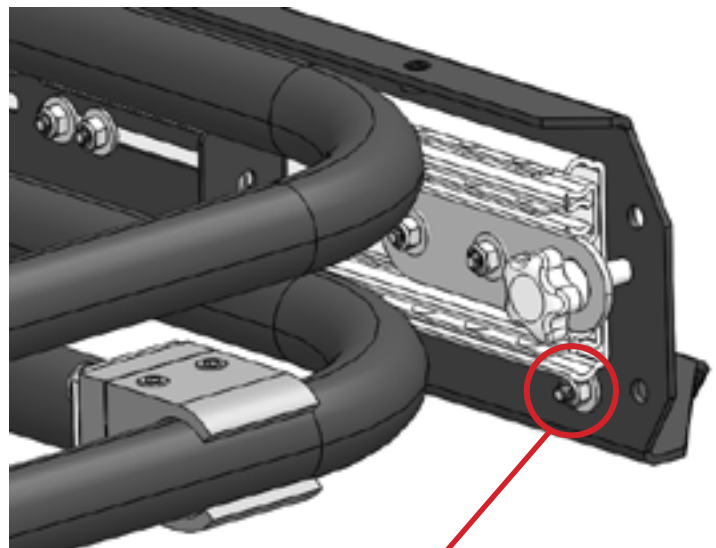

Lanyard Mounting Location

Assemble the Cross Bars and Bar Clamp Bottom as shown using 1/4" Button Head Screws and Washers. Wait to assemble the Bar Clamp Top until you have the Cross Bar assembly positioned on the rack, then securely tighten using 1/4" Socket Head Screws.

We recommend sealing the Cross Bar to the Bar Clamp Bottom as shown below using Clear or Black Silicone. Place a ring of sealant on the back of the Bar Clamp Bottom before assembling.

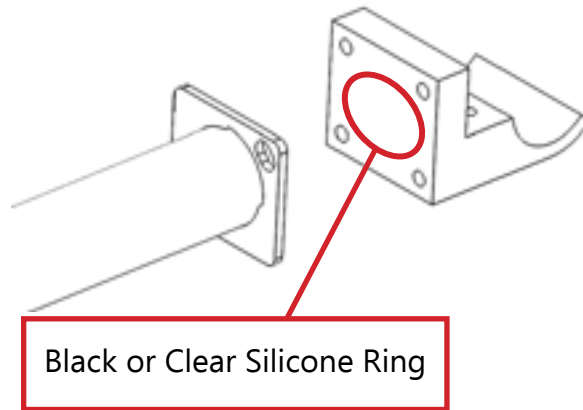
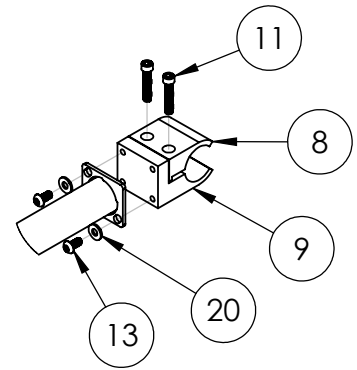

Bent tube has a tendency to relax a little over time causing the ends to spread apart slightly. If you find that your Cross Members are just a little too short, you can use a rope or ratchet strap to help pull then ends of the basket together. Once you get the first cross member in, the rest should install easily.



You may place the Cross Members in any position you want on the lower or upper rails of the Basket assembly.

If you plan to install the full 6 piece Floor Kit, use the locations marked below for each Cross Member.



****The Sliding Rack Installation is now complete! We recommend after a few days to check all screws and bolts to make sure they are tight.****

****JK / JL Sliding Rack Specifications****

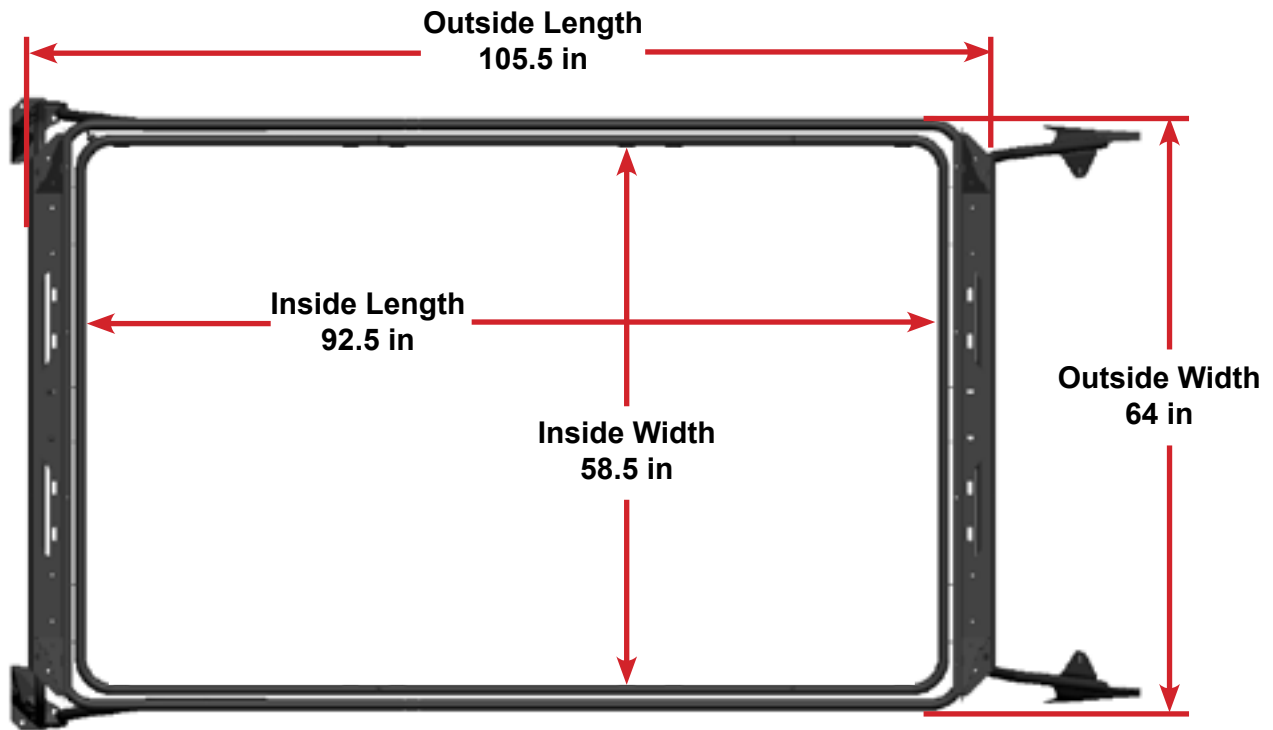

**800 Lbs Static - 300 lbs Driving
Evenly Distributed Load**

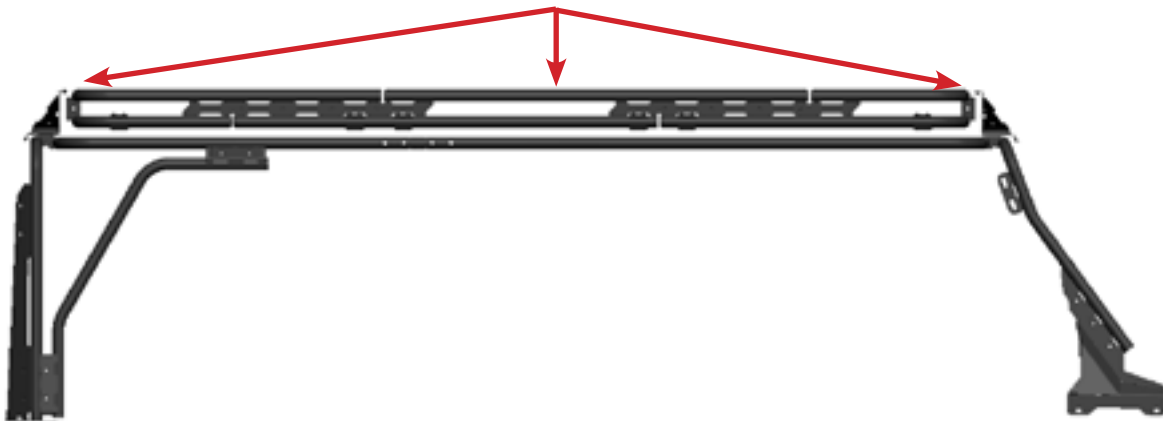

**250 lbs Open
Evenly Distributed Load**

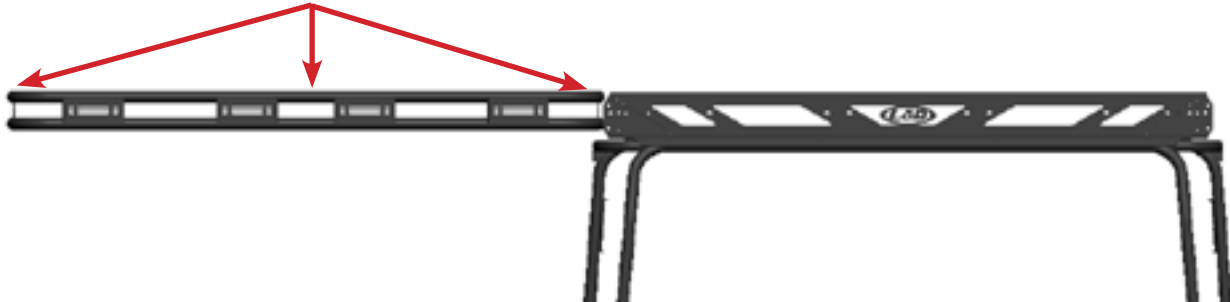

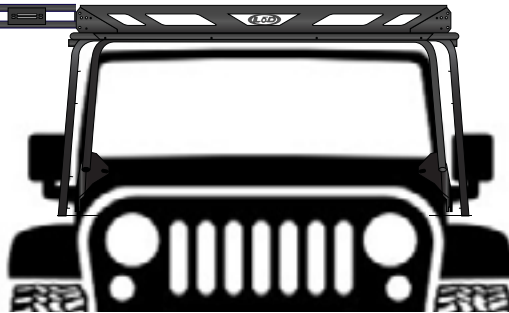

****WARNING****
Serious risk of injury



- Never stand on the Sliding Rack while in the open position. When loading or unloading contents from the rack, always make sure Sliding Rack is in the closed and latched position and safety screws are in place.
- Never open the Sliding Rack with a roof top tent deployed.
- Never camp in a roof top tent with Sliding Rack in the open position. Even with the use of support poles.

****Maintenance****

Slides and Latching mechanisms:

Regularly inspect and clean the Slide mechanism and Latching mechanism, especially during winter or dry/dusty conditions. If you notice any grinding, sticking or debris within the Slide or Latch mechanism, clean thoroughly using a hose with spray attachment or pressure washer on low pressure. Be sure to reapply lube to the Slides and Latches to maintain proper operation.

Depending on your weather or environmental conditions, you may choose either a wet or dry wax lube.

Choose a dry wax lube for dry conditions as it does not attract dirt. You will likely need to reapply a dry lube more often and after wet conditions.

Choose a wet lube for wet or snowy conditions. Wet lubes are generally waterproof and are more durable than dry lube counterparts. However wet lubes do attract dirt and may require more frequent cleaning.

| ITEM NO. | PART NUMBER | DESCRIPTION | QTY. |
|----------|-------------|------------------------------------|------|
| 1 | 4JRR0704-05 | SLIDE BEAM WELDMENT | 2 |
| 2 | 4JRR0704-02 | END BASKET WELDMENT | 2 |
| 3 | 4JRR0704-04 | CENTER RAIL WELDMENT | 2 |
| 4 | 4JCM0796-01 | SLIDING RACK CROSS MEMBER WELDMENT | 6 |
| 5 | 4JRR0704-06 | FRONT LATCH WELDMENT | 1 |
| 6 | 4JRR0704-07 | REAR LATCH WELDMENT | 1 |
| 7 | 4JRR0704-14 | STRIKER WELDMENT | 2 |
| 8 | 2JRR0704-76 | BAR CLAMP TOP | 12 |
| 9 | 2JRR0704-75 | BAR CLAMP BOTTOM | 12 |
| 10 | 2JRR0704-77 | SAFETY PLATE | 2 |

HARDWARE

| ITEM NO. | PART NUMBER | DESCRIPTION | QTY. |
|----------|---------------|---|------|
| 11 | SHSCS252020CZ | SHSCS 1/4-20 X 1.25 ZINC PLATE | 28 |
| 12 | BHSCS103210ZP | BHSCS 10-32 X .62 ZINC PLATE | 20 |
| 13 | BHSCS252008ZP | BHSCS 1/4-20 X 0.50 ZINC PLATE | 24 |
| 14 | BHSCS252012ZP | BHSCS 1/4-20 X .75 ZINC PLATE | 18 |
| 15 | BHSCS381612ZP | BHSCS 3/8-16 X .75 ZINC PLATE | 20 |
| 16 | LHN1032ZPGR2 | NYLOK LOCKING HEX NUT 10-32 ZINC PLATE GR2 | 20 |
| 17 | LHN2520ZPGR5 | NYLOK LOCKING HEX NUT 1/4-20 ZINC PLATE GR5 | 22 |
| 18 | HN3816ZPGR5 | HEX NUT 3/8-16 ZINC PLATE GR5 | 4 |
| 19 | FW1010ZP | FLAT WASHER #10 X .625 ZINC PLATE | 40 |
| 20 | FW1209ZP | FLAT WASHER #12 X .56" ZINC PLATED | 54 |
| 21 | FW3816ZP | FLAT WASHER Ø3/8" X 1.00 ZINC PLATE | 24 |
| 22 | LAT1001 | LATCH, PUSH TO CLOSE | 2 |
| 23 | DSZ1000 | DRAWER SLIDE, 60" ZINC PLATE | 2 |
| 24 | BP1001 | RUBBER BUMPER, 5/16-18 X .62" LG THREADED STUD, 50D | 2 |
| 25 | KNI1003 | KNOB, 5/16-18 X 1.56" LG THREADED STUD W/LANYARD | 2 |
| 26 | HP1001 | HOLE PLUG Ø1.25" 14-20GA (MOCAP RNI-1/4CBK1) | 16 |

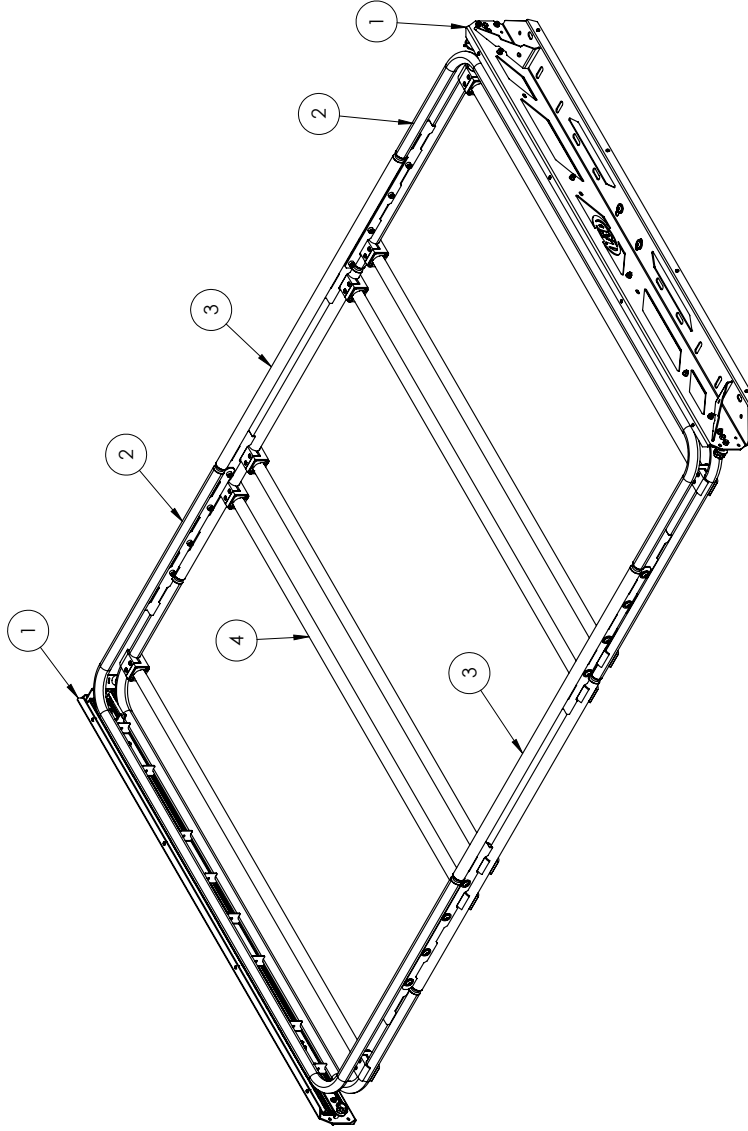

- NOTES:**
1. JSR0790 = BARE STEEL OPTION
2. JSR0791 = BLACK POWDER COAT OPTION

| | | | |
|--|-----------|----------|---------------|
| UNLESS OTHERWISE SPECIFIED: | NAME | DATE | LOD LLC. |
| DIMENSIONS ARE IN INCHES | MCH | 7/4/2019 | |
| TOLERANCES: ±0.010 | DRAWN | | |
| ANGULAR: MACH ±1° | CHECKED | | |
| TWO PLACE DECIMAL | ENG APPR. | | |
| THREE PLACE DECIMAL ±0.005 | MFG APPR. | | |
| PROPRIETARY AND CONFIDENTIAL | MATERIAL: | | |
| THE INFORMATION CONTAINED IN THIS DRAWING IS THE SOLE PROPERTY OF LOD LLC. ANY REPRODUCTION OR TRANSMISSION OF THIS DRAWING WITHOUT THE WRITTEN PERMISSION OF LOD LLC IS PROHIBITED. | N/A | | |
| | SEE NOTES | | |
| | DWG. NO. | JSR0790 | REV |
| | | JSR0791 | A |
| | SCALE: | 1:12 | SHEET SIZE: B |
| | | | SHEET 1 OF 4 |

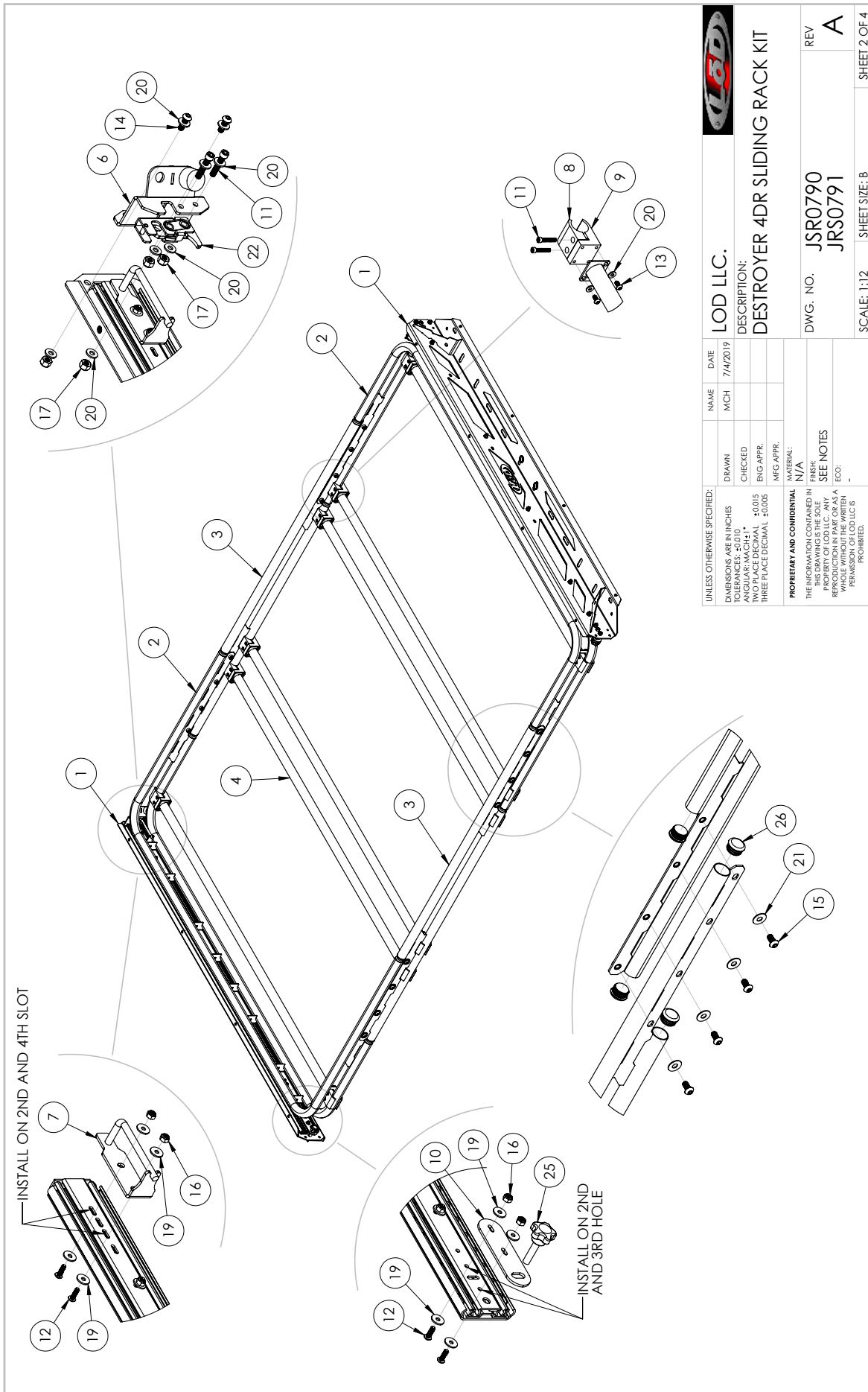

INSTALL ON 2ND AND 4TH SLOT

INSTALL ON 2ND AND 3RD HOLE

| | | | |
|--|--|--------------------------------|---------------|
| UNLESS OTHERWISE SPECIFIED: | | NAME | DATE |
| DIMENSIONS ARE IN INCHES | | MCH | 7/4/2019 |
| TOLERANCES: ±0.010 | | DRAWN | |
| ANGULAR: MACH ±1° | | CHECKED | |
| TWO PLACE DECIMAL | | ENG APPR. | |
| THREE PLACE DECIMAL ±0.005 | | MEG APPR. | |
| MATERIAL: | | LOD LLC. | |
| FINISH: | | DESCRIPTION: | |
| N/A | | DESTROYER 4DR SLIDING RACK KIT | |
| SEE NOTES | | DWG. NO. | REV |
| REPRODUCTION OF THIS DRAWING FOR ANY PURPOSES WITHOUT THE WRITTEN PERMISSION OF LOD LLC IS PROHIBITED. | | JSR0790 JRS0791 | A |
| | | SCALE: 1:12 | SHEET SIZE: B |
| | | SHEET 2 OF 4 | |

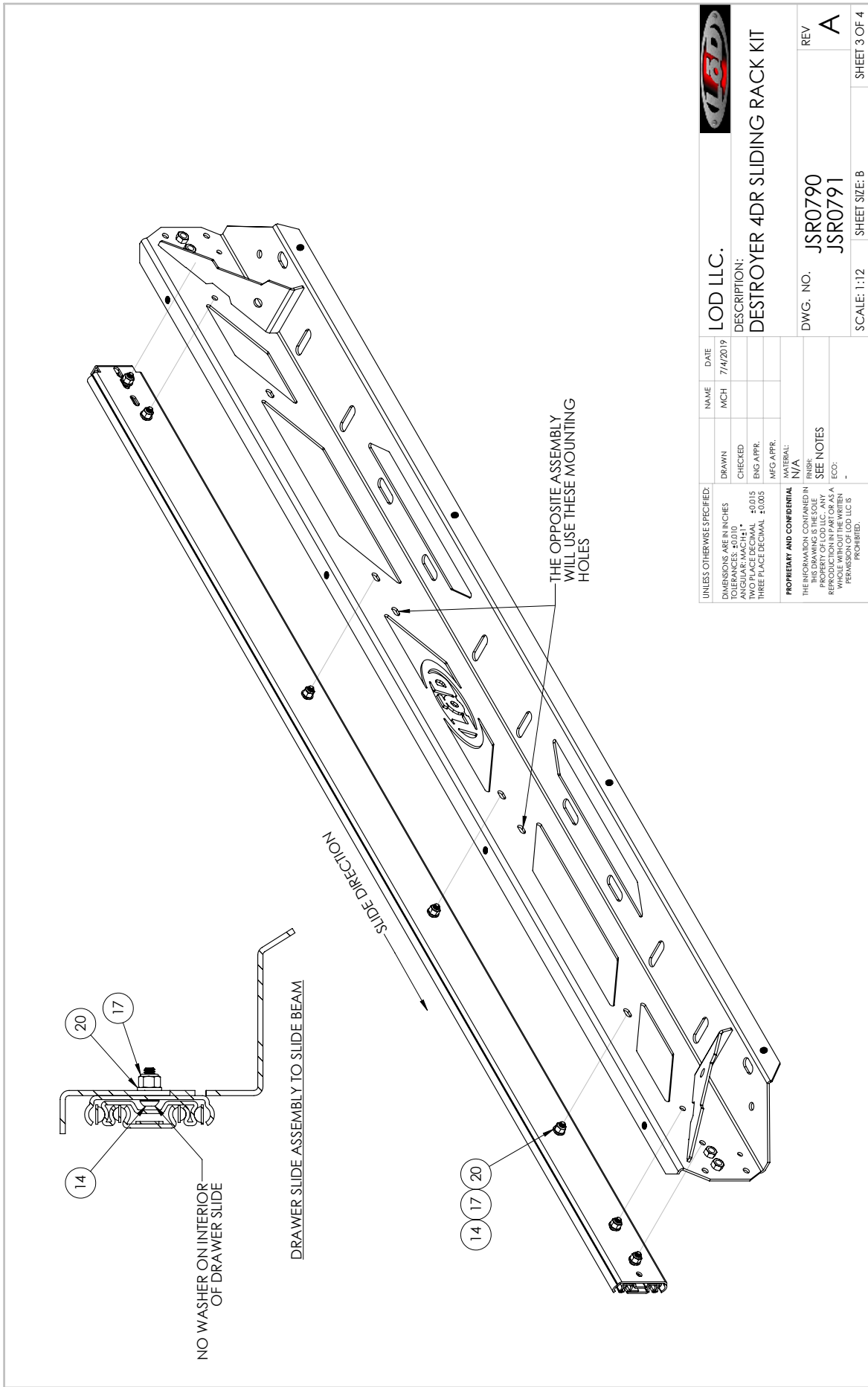

| | | | |
|--|-----------|-------------|--------------|
| UNLESS OTHERWISE SPECIFIED: | | NAME | DATE |
| DIMENSIONS ARE IN INCHES | | MCH | 7/4/2019 |
| TOLERANCES: ±0.010 | DRAWN | | |
| ANGULAR: MACH ±1° | CHECKED | | |
| TWO PLACE DECIMAL | ENG APPR. | | |
| THREE PLACE DECIMAL ±0.005 | MFG APPR. | | |
| PROPRIETARY AND CONFIDENTIAL | | MATERIAL: | |
| THE INFORMATION CONTAINED IN THIS DRAWING IS THE SOLE PROPERTY OF LOD. IT IS TO BE USED FOR THE PROJECT AND NOT TO BE REPRODUCED OR COPIED IN ANY MANNER WITHOUT THE WRITTEN PERMISSION OF LOD. USE IS PROHIBITED. | | N/A | |
| SEE NOTES | | DWG. NO. | JSR0790 |
| | | REV | A |
| | | SCALE: | 1:12 |
| | | SHEET SIZE: | B |
| | | | SHEET 3 OF 4 |



LOD LLC.
 DESCRIPTION:
 DESTROYER 4DR SLIDING RACK KIT

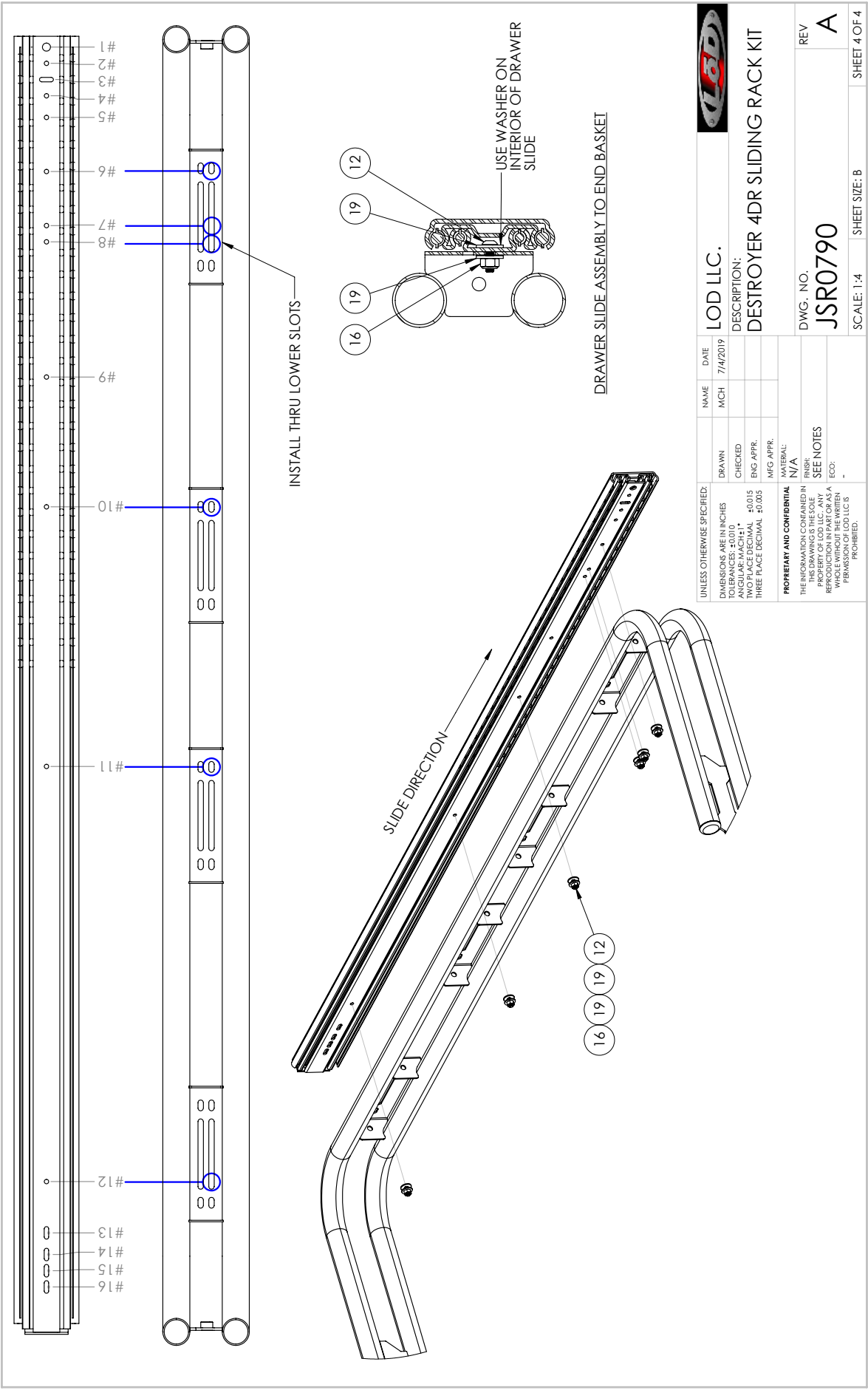

| | | | |
|---|--|-----------|-----------|
| UNLESS OTHERWISE SPECIFIED: | | NAME | DATE |
| DIMENSIONS ARE IN INCHES | | MCH | 7/14/2019 |
| TOLERANCES: ±0.010 | | DRAWN | |
| ANGULAR: MACH ±1° | | CHECKED | |
| TWO PLACE DECIMAL ±0.015 | | ENG APPR. | |
| THREE PLACE DECIMAL ±0.005 | | MFG APPR. | |
| PROPRIETARY AND CONFIDENTIAL THE INFORMATION CONTAINED IN THIS DRAWING IS THE SOLE PROPERTY OF LOD LLC. REPRODUCTION IN PART OR AS A WHOLE WITHOUT THE WRITTEN PERMISSION OF LOD LLC IS PROHIBITED. | | MATERIAL: | |
| | | N/A | |
| | | FINISH: | |
| | | SEE NOTES | |
| | | ECCO: | |
| | | | |

LOD LLC.
 DESCRIPTION:
DESTROYER 4DR SLIDING RACK KIT

DWG. NO.
JSR0790
 SCALE: 1:4
 SHEET SIZE: B
 SHEET 4 OF 4



JK/JL Jeep
DESTROYER SERIES
JEEP JK/JL 4DR
SLIDING RACK KIT
SHIPPING SHEET BOX 1

Packaged by:

On:

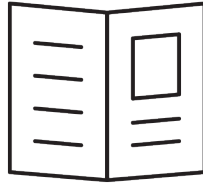

Instruction
Booklet

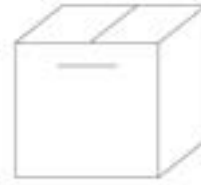

Hardware Kit
(contents
may vary)

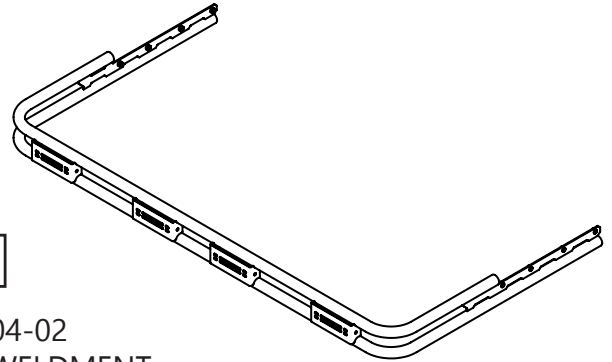
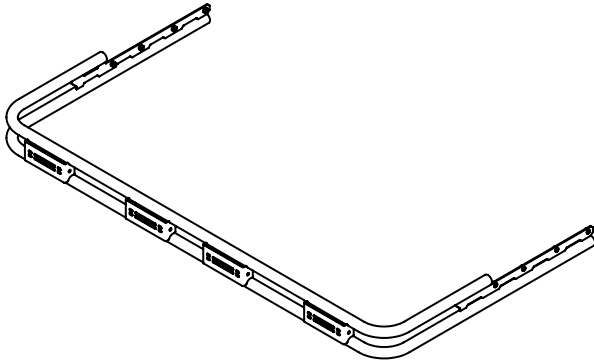

4JRR0704-02
END BASKET WELDMENT
(x2)



JK/JL Jeep

DESTROYER SERIES

JEEP JK/JL 4DR

SLIDING RACK KIT

SHIPPING SHEET BOX 2

Packaged by:

On:

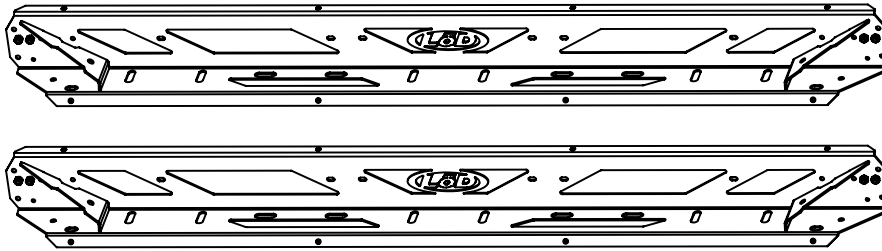

4JRR0704-05
SLIDE BEAM WELDMENT
(x2)

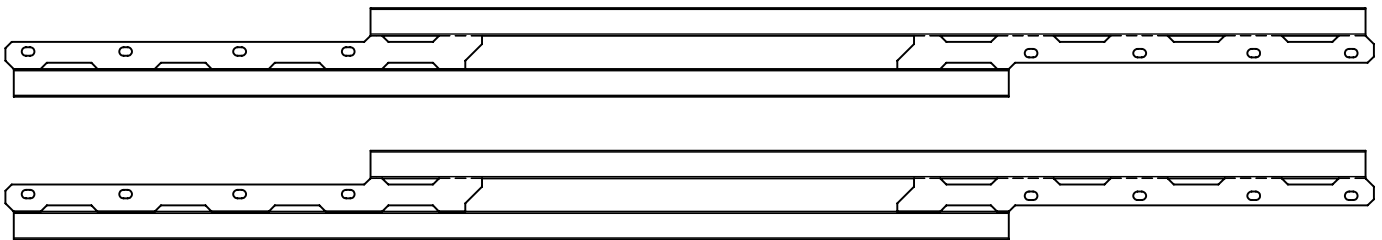

CENTER RAIL WELDMENT
4JRR0704-04
(x2)



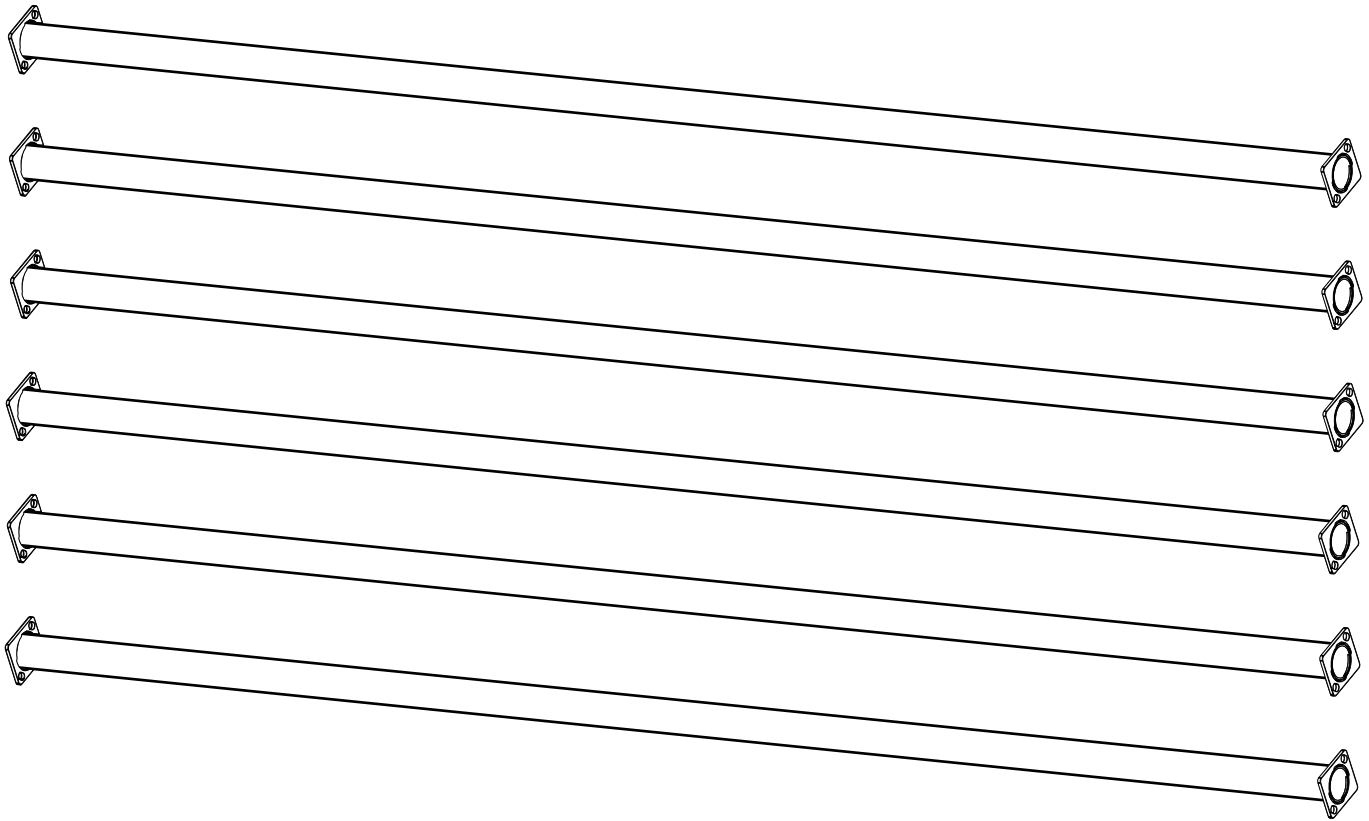

SLIDING RACK CROSS MEMBER WELDMENT
4JCM0796-01

(x6)

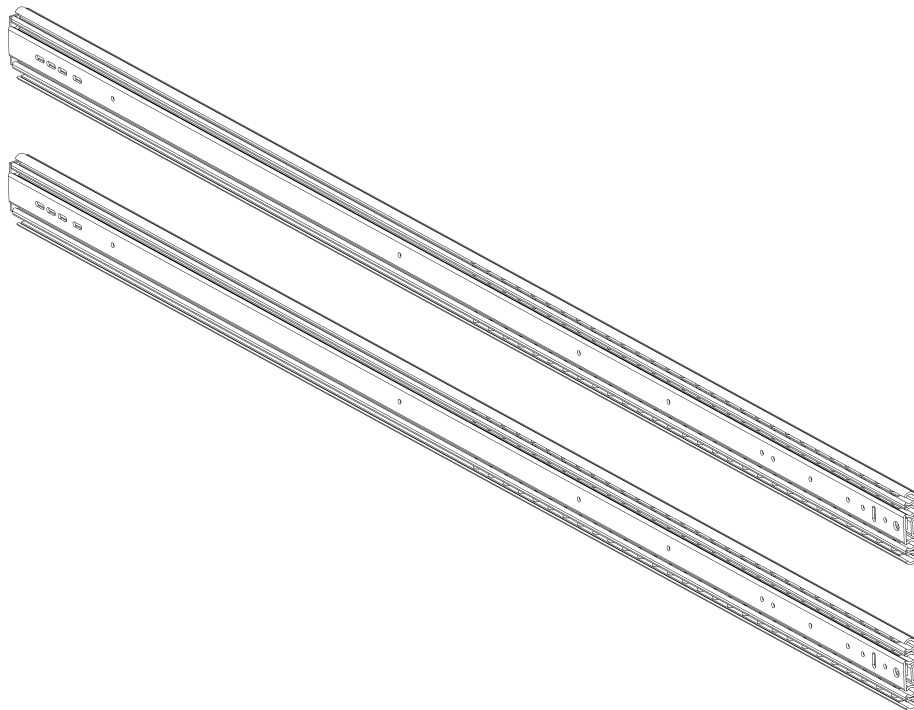

DRAWER SLIDE, 60"
DSZ1000

(x2)





JK/JL Jeep
DESTROYER SERIES
JEEP JK/JL 4DR
SLIDING RACK KIT
HARDWARE KIT

Packaged by:

On:

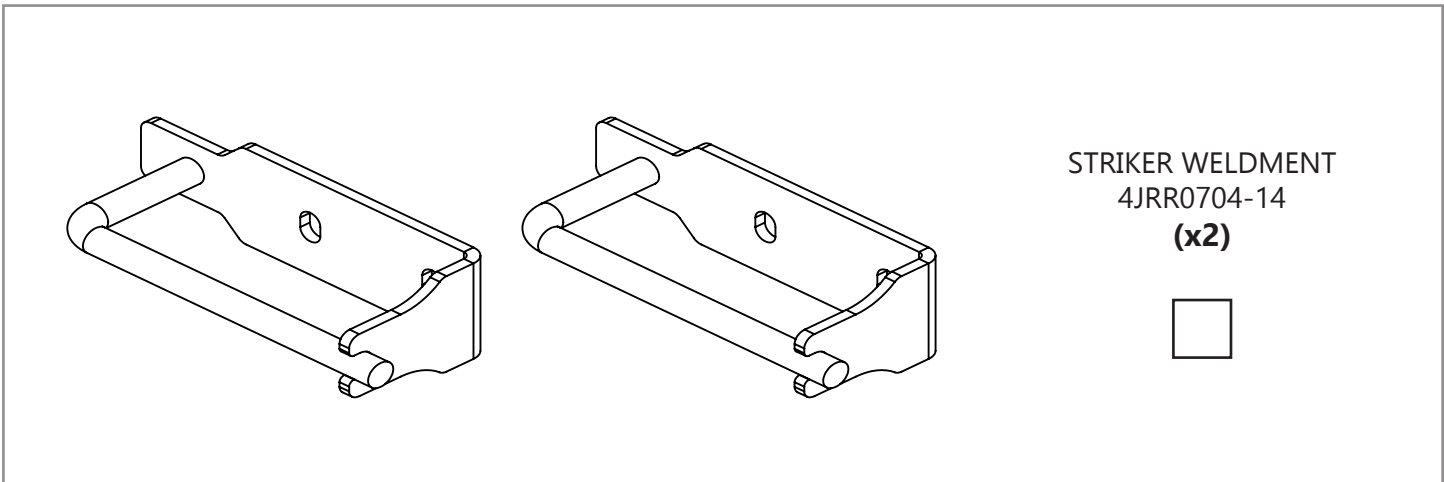
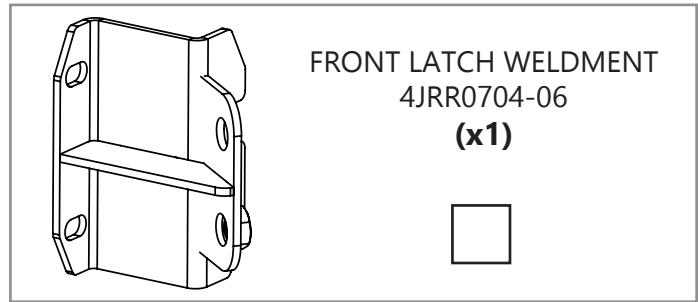
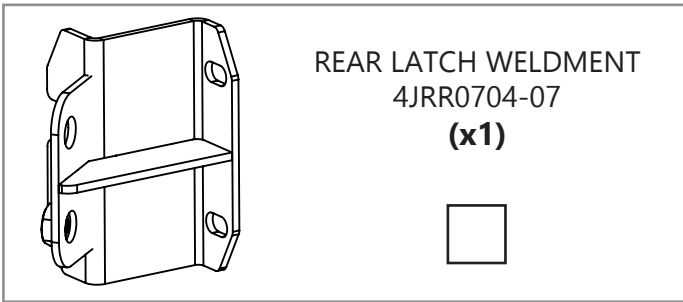
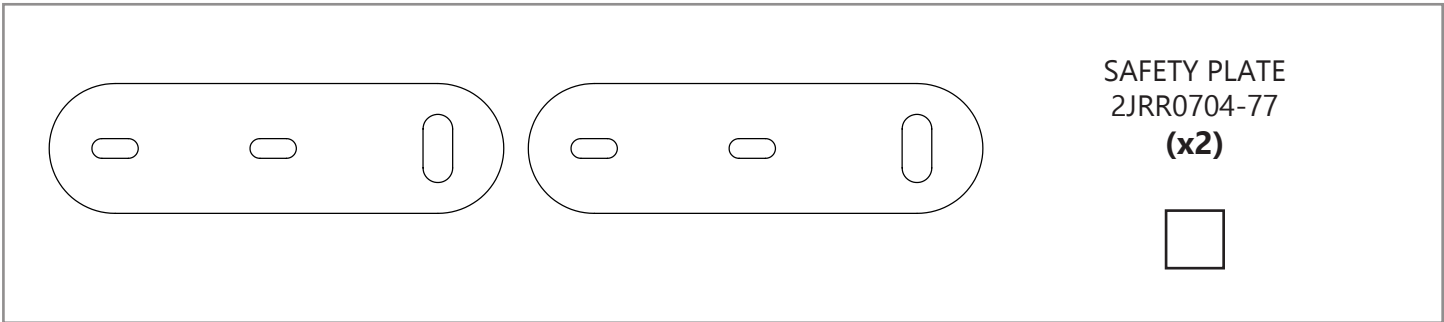
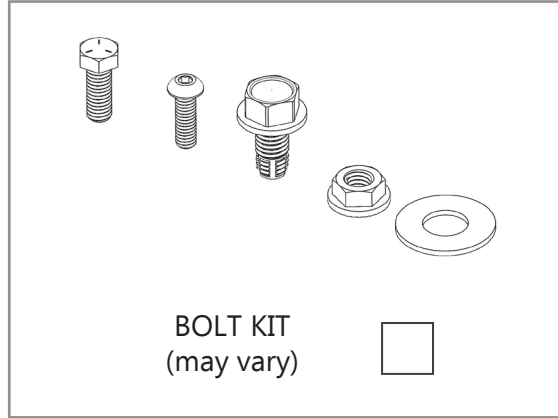

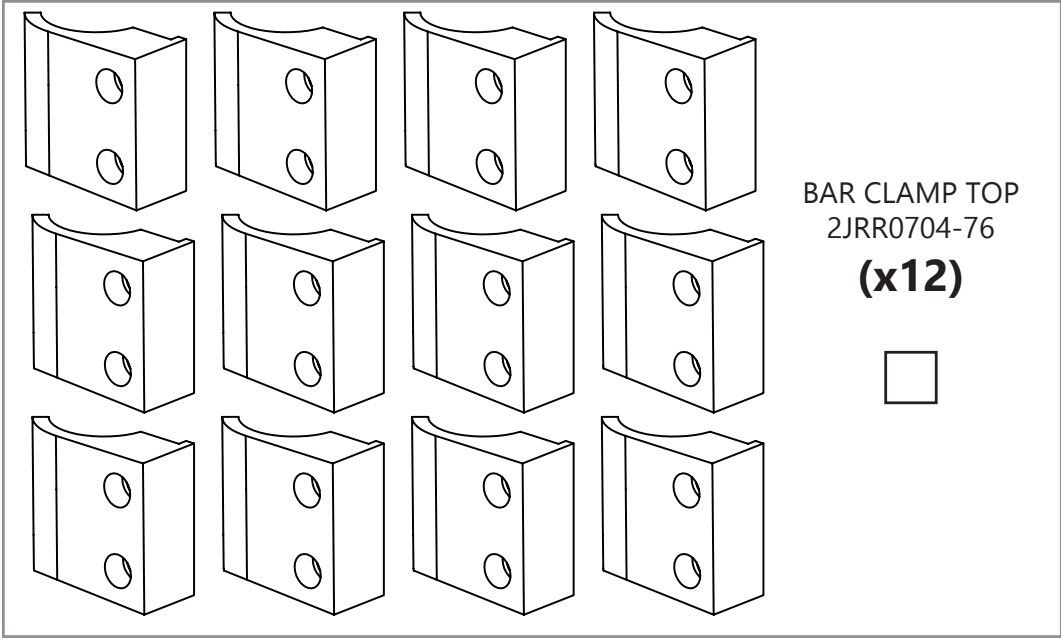

BAR CLAMP TOP
2JRR0704-76

(x12)

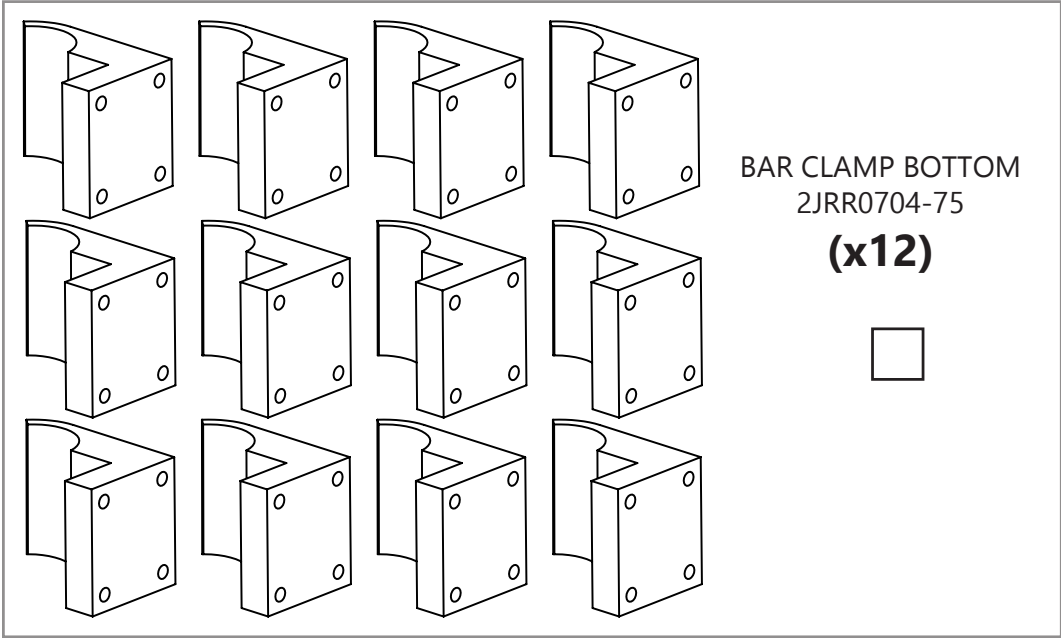

BAR CLAMP BOTTOM
2JRR0704-75

(x12)

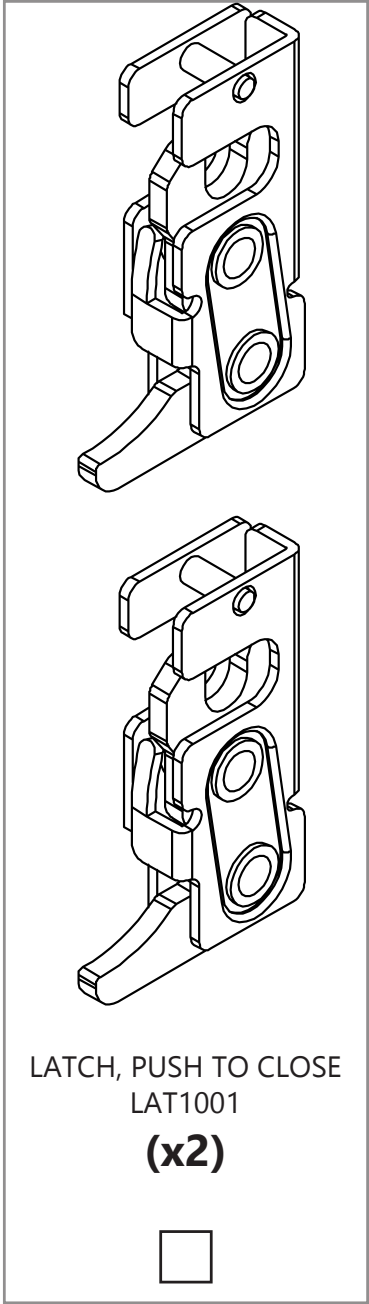

LATCH, PUSH TO CLOSE
LAT1001

(x2)





**JK/JL Jeep
DESTROYER SERIES**

JEEP JK/JL 4DR
SLIDING RACK KIT

BOLT KIT

Packaged by:

On:

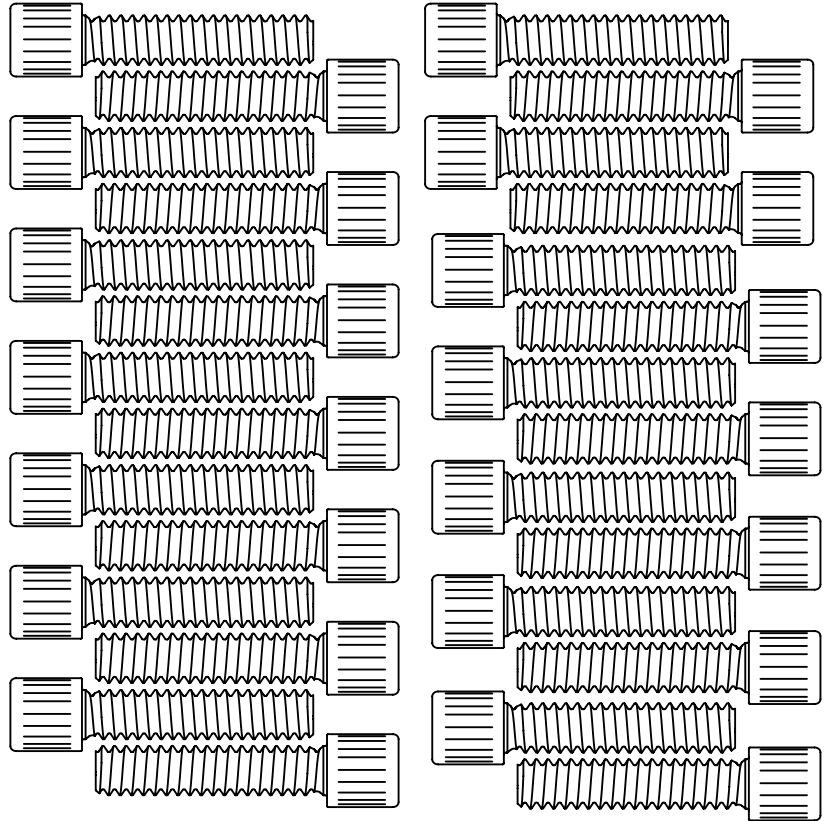

SOCKET HEAD SCREW
1/4-1.20 X 1.25
(x28)

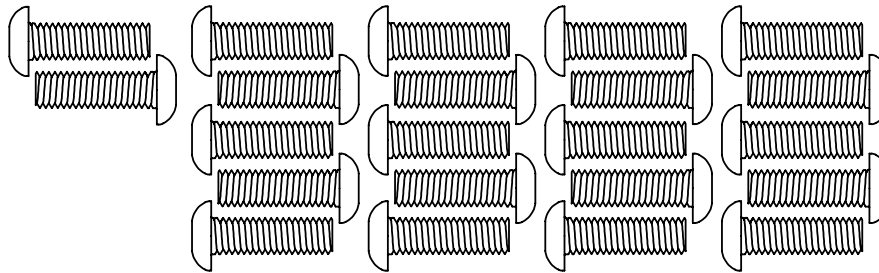

BUTTON HEAD SCREW
10-32 X .62
(x22)

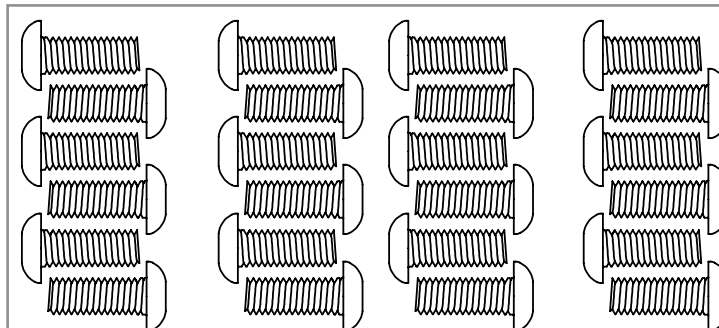

BUTTON HEAD SCREW
1/4-20 X .5
(x24)



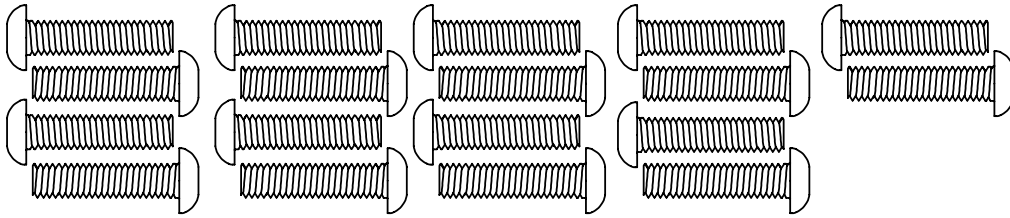

BUTTON HEAD SCREW
1/4-20 X .75
(x18)

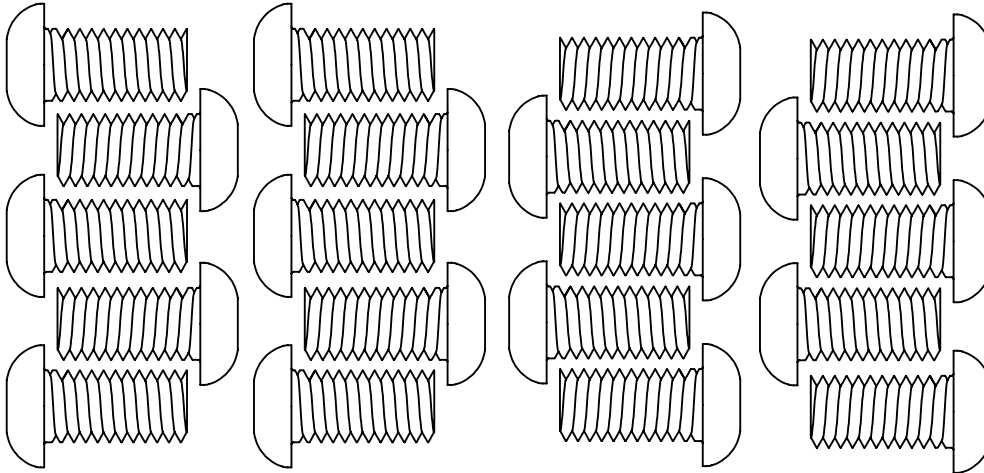

BUTTON HEAD SCREW
3/8-16 X .75
(x20)

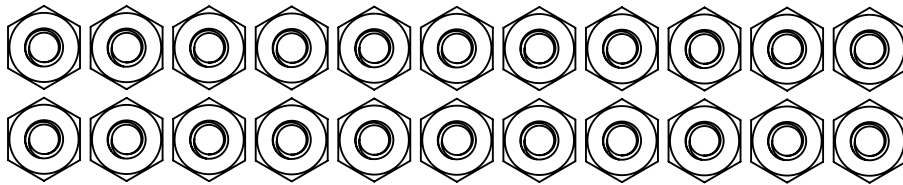

NYLOCK LOCKING
HEX NUT 10-32
(x22)

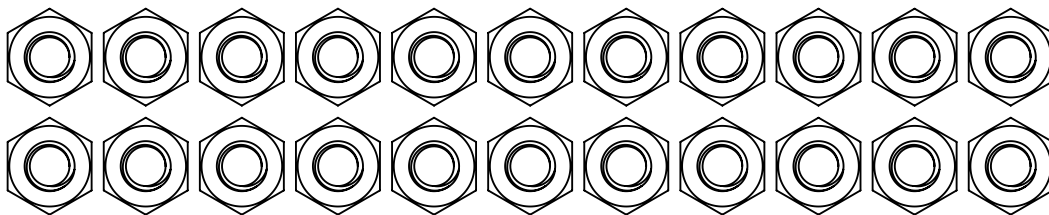

NYLOCK LOCKING
HEX NUT 1/4-20
(x22)

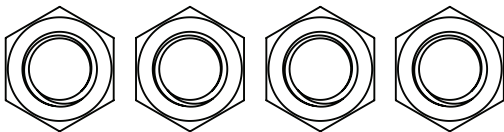

HEX NUT
3/8-16
(x4)

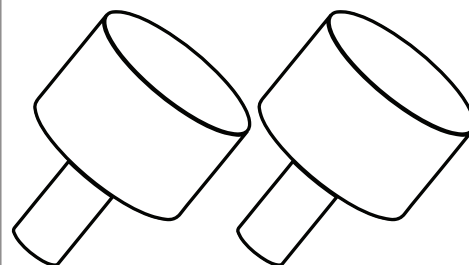

RUBBER BUMPER
THREADED STUD
BP1001
(x2)



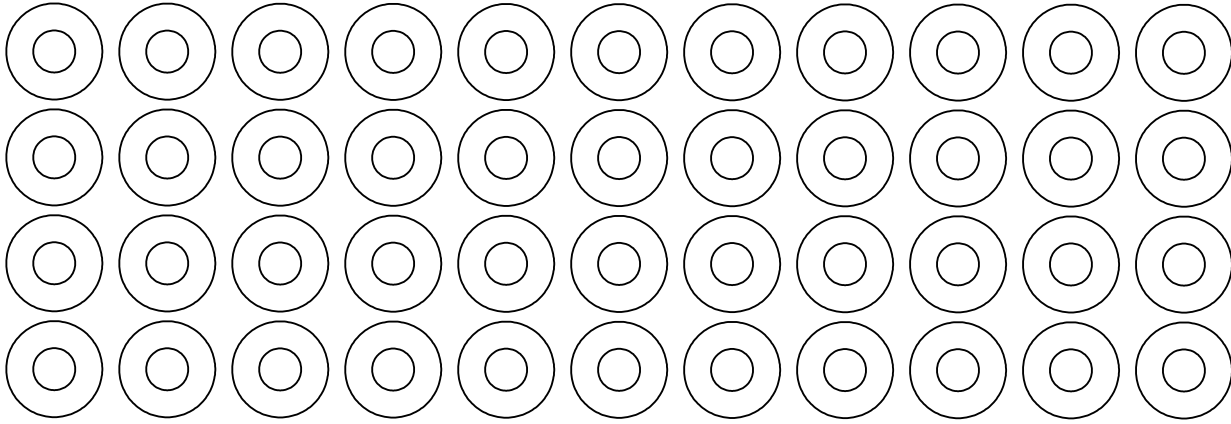

FLAT
WASHER
#10 X .625
(x44)

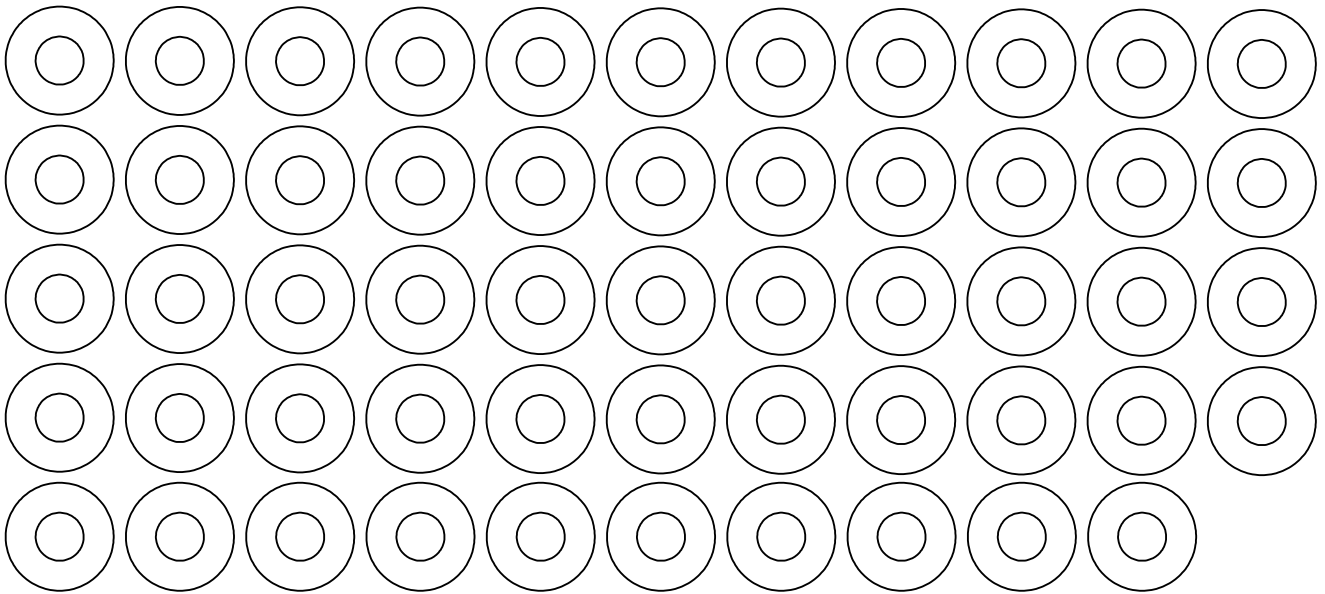

FLAT WASHER
#12 X .56
(x54)



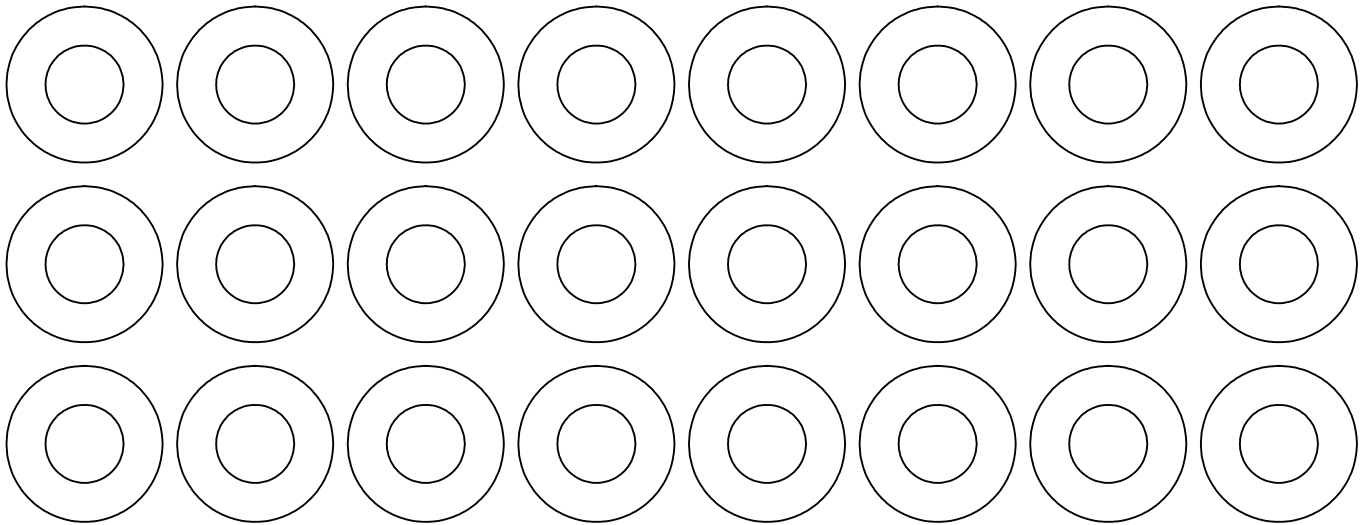

FLAT WASHER
3/8 X 1.00
(x24)

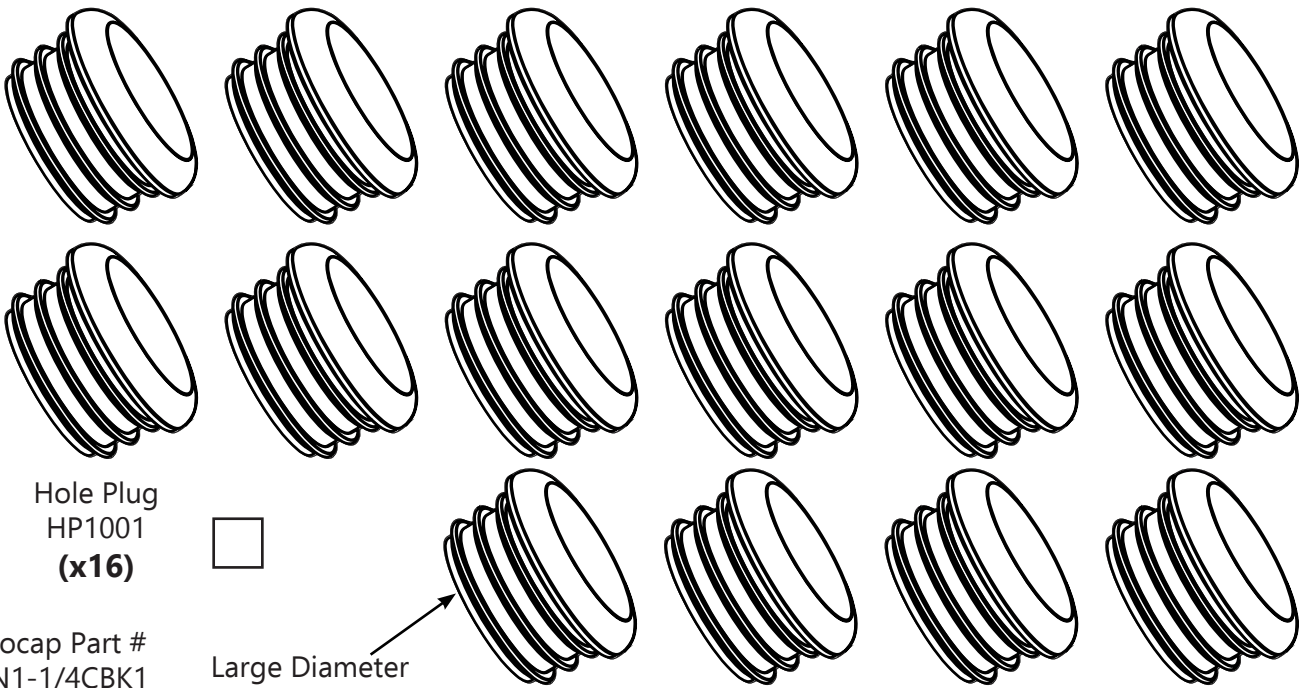

Hole Plug
HP1001
(x16)



Mocap Part #
RN1-1/4CBK1

Large Diameter



KNOB, THREADED STUD W/LANYARD
KN1003
(x2)