



Installation Instructions

SkyMaster[®] Fastback Complete Replacement Soft Top for 2007-2018 2 Door Jeep[®] Wrangler JK- Item #155013XX



Part List:

Top Deck/Header Assembly - Qty 1
Driver Side Quarter Window - Qty 1
Passenger Side Quarter Window - Qty 1
Rear Window - Qty 1
Driver Side Over Door Bow - Qty 1
Passenger Side Over Door Bow - Qty 1
Center Bow Assembly - Qty 1
Driver's Side Door Surround - Qty 1
Passenger Side Door Surround - Qty 1
Door Surround Knobs - Qty 4
Roll Bar Bow Mount Brackets - Qty 2

Required Tools:

Safety Glasses
Phillips Screw Driver
Flat Head Screw Driver
T-30 Torx Driver
Pliers

NOTICE

This Replacement Top kit is designed to fit on your 2 Dr Jeep[®] Wrangler when the original soft top or hard top has been completely removed. Before beginning your installation of this product, you will need to remove your existing soft top fabric, hardware or Hard top.

Loss of vehicle control involves risk of death or serious injury, particularly to parts of your body not restrained within vehicle. This product is intended for weather protection only and should not be relied upon to contain occupants in the event of an accident or to protect from either ground contact or falling objects. To reduce risk of accident or injury:

WARNING

- ALWAYS WEAR SEATBELTS
- Always keep head, arms & body parts within vehicle.
- Fully secure or stow the soft top before driving according to instructions. Never try to latch or fold soft top while driving. Do not use if damaged or worn.
- Read and follow all instructions & warnings accompanying this product, in your vehicle owner's manual and Off Road Driving Supplement.

CAUTION

RISK OF EYE INJURY. Safety glasses should be worn at all times while installing or maintaining this product.



Important Safety information

Your MasterTop® Replacement Top is intended to be used with other MasterTop Products to increase the fair weather enjoyment of your off-road capable vehicle. Before installation, please take a moment to review the following safety information and installation instructions. Important safety information is generally preceded by one of three signal words indicating the relative risk of injury. The signal words mean:

WARNING	a hazardous situation which, if not avoided, could result in death or serious injury. You CAN be KILLED or SERIOUSLY HURT if you don't follow instructions.
CAUTION	a hazardous situation which, if not avoided, could result in minor or moderate injury. You CAN be moderately HURT and also may suffer property damage if you don't follow instructions.
NOTICE	Careful attention is required to this instruction or operation but does generally not relate to personal injury. Damage to your MasterTop product or other property may result if you don't follow instructions.

Before you begin Installation:

We are excited that you have chosen the SkyMaster Replacement Top Kit. This high-quality soft top is designed to provide protection from the elements and a stylish look on your Jeep®. Please note that it is important that you become familiar with the installation process of this top reading the following instruction sheet and warnings thoroughly.

When unpacking, carefully check to make sure all parts are included. If any part is missing or broken, please call MasterTop customer service at 720-575-5440. When unpacking, check to make sure all parts are included.

NOTICE	For a smooth fit and ease of installation, this top should be installed at temperatures above 72 degrees. Below this temperature, the fabric may contract an inch or more making it difficult to install. We highly recommend taking the top out of the package and letting it sit inside a warm place or direct sunlight for 1-2 hours before you install the top. When warm, this top will install quickly.
---------------	---



FIG 1

Step 1: Install Over Door Bows to Front Header Assembly

Locate the Fabric/Header assembly and the two over door bows as shown in Figs 1 & 2 and place the assembly on a table top or on a soft towel with the underside facing up and the two "header legs" facing away from the header.

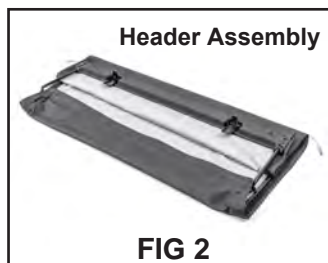

FIG 2



Over Door Bow

Locate the MasterTop over door bow assembly (Fig 3) and round bow/header sleeve (round tube).



Slide knuckle end into Header Leg with Quick Release Knob Facing Out



Quick Release Knuckle must be facing out when installed on header!

Slip the round door "sleeve" over the header leg and insert the "knuckle" installed on the over door bow into the Header leg on the Header Assembly (Fig 4) making sure the quick release knuckle is facing outward (Fig 5).

Note that the over door bow assembly are sided-left and right. The bow knuckle must be facing out when installed on the Header assembly. Secure the over door bow to the Header leg with the attached set screw (Fig 6).



Slide the Sleeve over the knuckle

Slide the bow sleeve over the knuckles as shown in Fig 7. Repeat this procedure on the opposite side. Set this completed assembly aside.



Step 2: Install Bow Mount Brackets to Roll Bar



Locate the (2) bow mounting brackets and (4) Torx head pivot bracket bolts shown in FIG 8. Carefully unzip the roll bar padding on the vertical side tube to expose the two factory holes in the roll bar. With a razor knife, trim the hard foam where the top of the bracket will sit (FIG 9). Locate the bow mounting brackets over the factory holes and using the T-30 Torx head pivot bracket bolts, install brackets to the roll bar (FIG's 10 & 11). Slip the roll bar padding back over the installed brackets carefully slipping the bracket mounts through the slits in the roll bar padding. Repeat on passenger side.

Step 3: Assemble and Install Door Surrounds

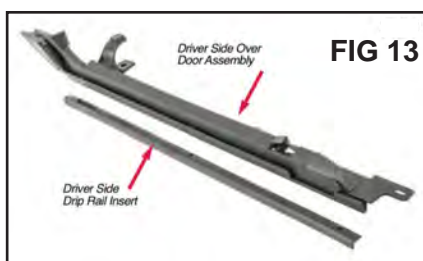
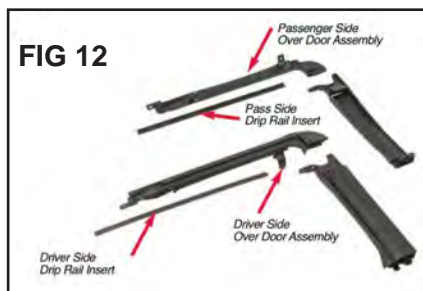

Locate the Drivers and passengers over door assemblies and the "drip rail" inserts shown in FIG12.

Separate out the driver's side over door assembly and corresponding drip rail insert as shown in FIG13.

Locate and line up the three round tabs on the drip rail with the holes located in the over door assembly as shown in FIG14.

Firmly Squeeze the round tabs down into the holes permanently securing them to the over door assembly (See FIG15).

NOTE: It may take a lot of force to squeeze these tabs into the over door assembly. You may need to use a rubber mallet or the edge of a table to secure them completely.

Repeat this procedure for the Passenger side over door assembly.





Pillar and Over Door Surround Assembly

Locate the driver's side Rear over door assembly and the driver's side Pillar assembly shown in FIG16.

Turn the two pieces over as shown in FIG17 and line up the slot on the pillar assembly with the "T" on the over door assembly. Notice in FIG 17 that there is a secondary "T" that will be lined up when you slide the long "T" into the long slot. Slide the two pieces together lining up both "T's" to secure the top over door assembly with the Pillar assembly. See FIGS 18 &19.

Locate the small screw packet in the hardware kit found in the door surround box. Using a Phillips head screw driver, install the screw into the two screw holes on the two assembled parts securing them permanently together. See FIG20

Repeat the above assembly on the Passenger side Rear over door and pillar assemblies.

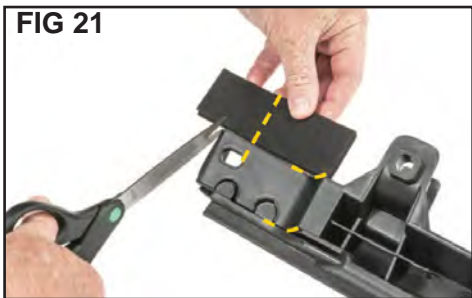
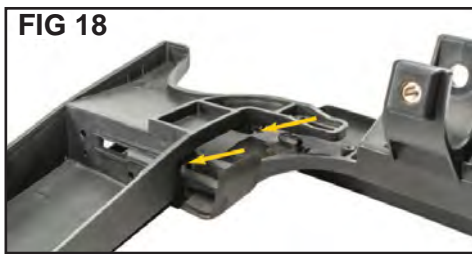

Install Foam to Front Door Surrounds

Locate the driver's side front door surround and the rectangular piece of foam found in the door surround hardware pack. Line up the foam with the rear of the door surround and measure the length between the rear of the door surround and the top of the curve (FIG21).



With a pair of scissors - sors, cut the foam to size. Remove the backing on the foam and secure it to the front of the door surround as shown in FIG22.

Make sure not to cover the hole in the door surround.

Repeat this procedure on passenger side door surround.



Install Door Surrounds to Jeep

Locate the assembled Driver's side rear door surround (Fig23). On the bottom of the vertical pillar portion of the assembled door surround is a pin that will be inserted into the body tub as shown in FIG 24. **NOTE:** as shown in Fig 25, if you have the rubber seal installed on the body tub, you must remove it before putting the door surround on!

Insert the door surround pin into the body tub as shown in FIG 26. After inserting the pin, locate the upper portion of the door surround "C" attachment and push onto roll bar (FIG's 27& 28).

Make sure the front seal is snug against the windshield seal as shown in FIG 29. The "C" should fit in the cutout of the roll bar pad. Line up the threads in the "C" with the top hole in the roll bar.

Repeat this procedure on the passenger side.



Secure Front Door Surrounds to Roll Bar

Locate the two sets of screw knobs in each Door surround box. There should be (2) sets of two knobs. Line up the door surround "C" attachment holes with the vertical holes in the roll bar. Slip the front knob through the hole in the front door surround (FIG30).

Tighten the knob securing the front door surround. Repeat this procedure on the back of the door surround and on the other side of the vehicle.

Finally, tighten all four knobs. All knobs on both sides of the vehicle should be secured to the roll bar.

This completes the installation of the door surrounds to your vehicle.

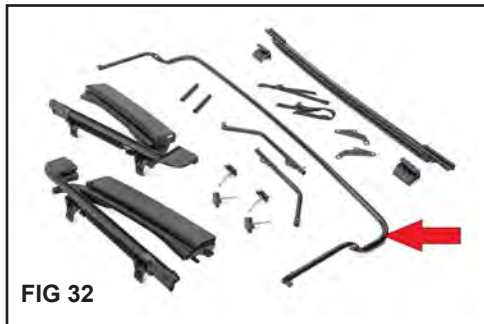

Step 4: Install Center Bow to the Vehicle

Locate the center bow assembly (Fig 32). With a friend, place the bow assembly over the roll bar and line up the assembly to the upper bow mount bracket (Fig's 33 & 34) that were left on the vehicle. The center of the bow should be towards the rear of the vehicle as shown in Fig 33.

Line up the Quick release knuckle with the upper bow mount bracket attachment and attach each side of the center bow assembly to the bracket (Figs 35, 36, 37 & 38).

Repeat on other side of vehicle.

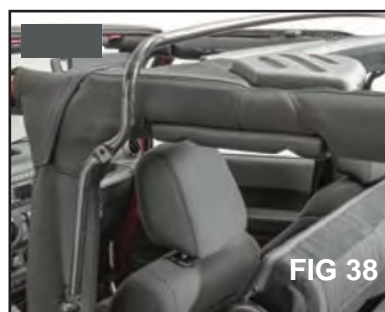

Step 5: Installing the Windshield Header/Deck Fabric Fabric to the Center Bow

With the help of a friend, locate the completed header and fabric assembly created in Step 4 and place this assembly over the windshield with the two "header legs" towards the rear of the vehicle. The over door Bow legs should fit inside the Door surrounds (Figs 39 & 40). Line the quick release knobs on the end of the header legs up with the Center bow mounting hole (Fig 41) and attach the quick release knuckles to the center bow (Fig 42). Repeat on other side of vehicle.



FIG 39



FIG 40



FIG 41



FIG 42



FIG 43



FIG 44



FIG 45



FIG 46

Note: FIG 47 Shows the Spring end going all the way through the Web strap hole. This is Extremely important

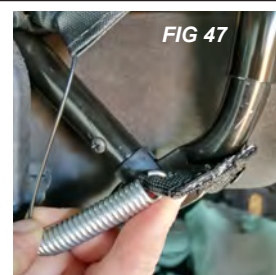

FIG 47

Step 6: Installing the Top Deck to the Jeep®

With the over door Bows secured, fold the fabric back from the windshield header (FIG 43). Locate the spring assembly attached to the over door cable (FIG 44). Attach the spring end to the webbing as shown in figs 46 and 47. Make sure the spring end goes all the way through the Web strap! Using pliers, crimp the spring end so it does not come loose. Do not tighten this strap yet.

With the header resting on the windshield and the over door bows installed, close the front header latches to secure the front of the top to the windshield. See FIG's 48, 49 & 50 below.

With the Top deck fabric draped over the back of the vehicle, go to the rear corner of the Top deck and locate the rear corner straps. Thread the straps down and under the seat belt mount as shown in FIG's 51 & 52 and thread the strap through the buckle (Figs 53 & 54). Repeat this on the other side of the vehicle. While pulling towards the rear of the vehicle, slightly tighten one strap and then the other side strap tightening up the top deck (Not completely tightened). When first tightening the rear straps notice the location of the rear bar sewn into the pocket on the top deck. It MUST be centered on the rear roll bar legs.



FIG 48



FIG 49



FIG 50





NOTE:
Do not completely tighten these straps yet.

They should be holding the top but not pulled as tight as possible. You will do final "tightening" after you install the windows.

NOTICE IMPORTANT: The top deck MUST be centered on the rear of the vehicle for the windows to fit properly.

Installation of Fabric Replacement Top



Step 7: Installing the Quarter and rear Windows to the top Deck

To ensure the top is centered on the vehicle you will be installing the two quarter windows and the rear window to the top deck and then to each other before securing it to the vehicle body.

Pro-Install TIP: To make this as easy as possible, you may have to release the front windshield header (release but not un-hook) and keep the rear corner straps installed in step 4 loosened. This will allow you to line up all window zippers and attachments. The rear corner straps and header will need to be re-tightened/clamped before using the top.

Locate the drivers rear quarter window. Line up the driver's side Quarter window to the zipper on the deck and zip it as shown in FIG's 55, 56 & 57 Repeat this on the passenger side of the vehicle.

Locate the rear window and line up and slide the rear window into the "C" Channel located at the top of the rear portion of the top deck and slide it across (FIGs 58, 59 & 60).

Once both quarter windows and the upper portion of the rear window are secured to the top deck, line up the driver's side rear zipper on the Quarter window to the zipper on the rear window and zip it down a few inches (FIG 61).

Repeat this on the passenger side of the rear window. You may have to lift the quarter window up to secure this second zipper a few inches. Once both side zippers are attached, zip the rear window zippers down about half way (Fig 62).

You will close these zippers completely at the end of the install.



NOTICE

When removing the quarter windows from the Top deck, make sure the zipper is completely out of the "zipper box" before removing the window. See fig 58

FIG 58**FIG 64****FIG 65****Step 8: Installing the Top to the Jeep Body**

Starting at the driver's side front, attach the side belt rail into the vehicle body by "rolling" the plastic into the slot (FIG 64). Once secure move to the rear driver's side corner and "roll" the plastic into the Jeep body corner belt rail as shown in FIG 65. Repeat this procedure on the passenger side.

**FIG 66**

NOTE: as shown in FIG 66 there is a web loop installed on the side of the quarter window. This is to be used for unhooking the quarter window only and is not designed to be pulled down on for installation!

Repeat the quarter window install on the passenger side of the vehicle. You may have to pull the corners around towards the front or back of the vehicle to center the top on the vehicle.

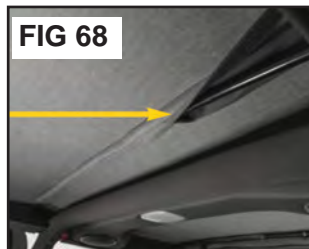
**FIG 67****FIG 68**

Go inside the Jeep and locate the long center bow flap. Wrap this bow flap tightly around the center bow and secure it with the hook and loop fastener (FIGs 67 & 68). you can now reach through the rear zipper on each side and tighten the corner straps. Alternate tightening to keep the top centered.

**FIG 69****FIG 70**

Seal hook and loop around windows (Figs 69 & 70).



Care instructions 9



Step 9: Installing the Tailgate Bar and Rear Window to the body of the Jeep®

Take the factory bar and orient the "C"-Channel with the round seal facing down and slide the "C" Channel onto the rear window retainer as shown in FIGs 71 & 72. After sliding the retainer all the way through the "C" Channel, roll the tailgate bar into the mounts with the outside of the fabric facing towards the rear of the Vehicle (Figs 73 & 74).

Once the Tailgate bar is secure, lower zippers on both sides of the rear curtain (FIG 75) and then secure the rear zipper cover flap as shown in Figs 76 & 77.

Using your SkyMaster Fastback Soft Top

Folding Back the Front Section of your Top:

To fold back your SkyMaster Soft Top: If driving, stop the vehicle and put in park. Unlatch the front header from the windshield (FIG's 48 & 49, on page 6) Pushing up from the middle, fold back the top.

WARNING

Make sure the hook and loop fastener are tightly secured to the center bow after the front sun roof is folded back. Both rear corner straps must also be secure when the top is folded back. These safety measures are designed to secure the top deck to the vehicle and if not adhered to can cause injury, death and a serious accident. Always wear your seat belts when using this product!

Care and Maintenance of your MasterTop® Product:

Your MasterTop Replacement Top is made of the finest materials available but to keep it looking new and for the maximum possible wear, it will need periodic cleaning and basic maintenance. The main threat to your soft top is pollutants, dirt and grime. By keeping your top clean you will prolong the life of your top.

We recommend the following to keep your top like new:

Washing:

The soft top fabric should be washed often using a mild soap, warm water and a soft bristle brush. You can also use special soft top cleaners available on our Distributors websites. Make sure that after cleaning you rinse with clear water to remove all traces of soap to avoid residue.

Water/Fabric:

In the event of seeping through the seams, 3M Scotchgard® may be applied on the inside of the seams to stop the seeping. Rips in the fabric may be repaired with Bondex® iron on patches. Iron the patches to the Inside of the top, carefully following the Bondex® instructions.

Windows:

It is very important that you keep your Soft Top windows clean! Use a mild soap and water solution to gently clean your windows. NEVER wipe your windows clean with a dry cloth! Dust and dirt on a dry cloth can scratch your windows causing "fogging" and permanent damage. When removing your windows, store them with a towel. If frost or ice forms on the outside of your windows during the winter, DO NOT use an ice scraper to remove this frost. Over time you will see small micro scratches in your windows which are natural wear and tear. These Micro scratches can be "polished" out using the window polish available at your MasterTop Distributor.

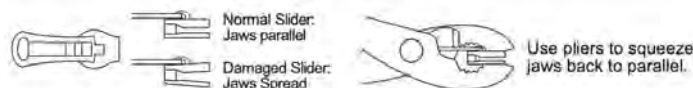

Zippers:

Keeping the zipper cleaned and lubricated with a silicone lubricant (available online) will help prevent damage and keep the zippers in a smooth working condition. If zipper opens behind the slider, the slider may have been spread apart. This problem can usually be fixed by using an ordinary pair of pliers to bring the sides back into parallel. Return slider to the end of the zipper in the normal Open position. Squeeze lightly at first and test zipper. If the zipper continues to remain open squeeze more firmly with pliers and try the zipper again. Repeat procedure until your zipper operates correctly.





Limited 3 Year Warranty

Your MasterTop® accessory is covered by the following Limited Warranty provided exclusively by MasterTop, Inc., 420 J Corporate Circle, Golden, CO 80401.

This Limited Warranty is the only warranty made in connection with your purchase. MasterTop neither assumes nor authorizes any vendor, retailer or other person or entity to assume for it any other obligation or liability in connection with this product or Limited Warranty. This Limited Warranty does not apply and is not cumulative to any accessory or part distributed by any MasterTop distributor for which the Manufacturer provides a separate written warranty.

What is Covered: Subject to the terms, exclusions and limitations herein and with respect only to MasterTop branded accessories first sold in the United States, MasterTop warrants to the initial retail purchaser only that your MasterTop accessory shall be free of defects in material and workmanship; **for a period of 3 years from date of initial retail sale.**

All other warranties are hereby disclaimed, except to the extent prohibited by applicable law in which case any implied warranty of merchantability or fitness for a particular purpose on this product is **limited to 3 years from date of initial retail sale.** MasterTop reserves the rights to: (a.) require invoice or other proof your product is within the terms of this Limited Warranty as a condition of warranty service and, (b.) make future revisions to this product and Limited Warranty without prior notice or obligation to upgrade your product.

What is Not Covered: Your MasterTop Limited Warranty does not cover products or parts MasterTop determines to have been damaged by or subjected to: (a.) installation damage, alteration, modification, failure to maintain or attempted repair or service by anyone not authorized by MasterTop, (b.) normal wear and tear, cosmetic damage or damage from water immersion, (c.) Acts of God, accidents, misuse, negligence, inadequate mounting or impact with vehicle(s), obstacles or other aspects of the environment, (d.) theft, vandalism or other intentional damage, (e.) fleet, rental or commercial use, (f.) use in competition or racing.

Remedy Limited to Repair/Replacement: The exclusive remedy provided hereunder shall, upon MasterTop inspection and at MasterTop's option, be either repair or replacement of product or parts (new or refurbished) covered under this Limited Warranty. Customers requesting warranty consideration on MasterTop Products should first contact MasterTop to obtain a RGA number (720-575-5440). All labor, removal, shipping and installation costs are customer's responsibility.

Other Limitations - Exclusion of Damages

- Your Rights Under State Law:

In consideration of the purchase price paid, neither MasterTop nor any independent MasterTop distributor /licensee are responsible for any time loss, rental costs, or for any incidental, consequential, punitive or other damages you may have or incur in connection with any part or product purchased. Your exclusive remedy hereunder for covered parts is repair/replacement as described above.

This Limited Warranty gives you specific rights. You may also have other rights that vary from state to state. For example, some states do not allow limitations of how long an implied warranty lasts and/or do not allow the exclusion or limitation of incidental or consequential damages, so the limitations and exclusions herein may not apply to you.

© MasterTop, Inc. 2020. All Rights Reserved. The terms MasterTop®, SkyMaster® and MasterTwill® are Registered Trademarks of MasterTop Incorporated, Registered in U.S. Patent and Trademark Office.

www.MasterTop.com

Part # 941048.01 Version 11.27.20 LTR

