

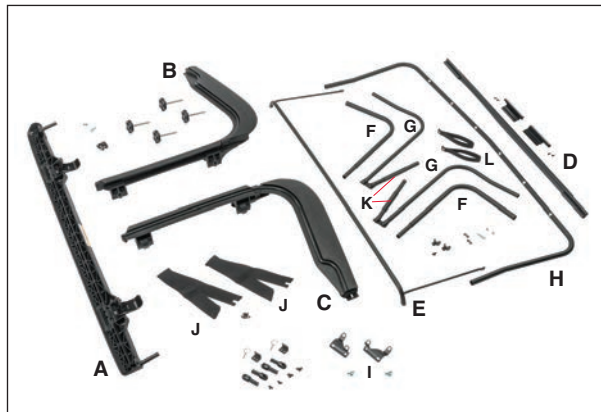

Installation Instructions

Complete Soft Top Hardware System for 1997-2006 Jeep® Wrangler TJ Item # 15430201



Parts List:

A) Windshield Header	QTY 1
B) Passenger Side Door Surround Kit	QTY 1
C) Driver Side Door Surround Kit	QTY 1
D) Tailgate Bar with Clips	QTY 1
E) Center Bow	QTY 1
F) Driver/Passenger Over Door bows	QTY 2
G) Driver/Passenger Rear Bow Legs	QTY 2
H) Rear Bow	QTY 1
I) Bow Brackets	QTY 2
J) Rear Bow Fabric	QTY 2
K) Over Door Metal Bow Door Sleeves	QTY 2
L) Rear Window Elastic Straps	QTY 2
M) Hardware Kit Detail (see P3)	QTY 1

Required Tools:

- Safety Glasses
- Phillips Head Screwdriver
- T30 Torx Socket & Driver
- 7/64" Drill Bit
- 11/32" Wrench
- Rubber Mallet (Optional)
- Power Drill
- 1/8" Drill Bit (Hardtop Models ONLY)
- Light Colored Marker

NOTICE

This Complete Bow and Door Surround kit is designed to fit on your TJ Jeep® Wrangler when the hard top or original soft top has been completely removed. Before beginning your installation of this product, carefully remove your hard top or current soft top hardware. During the installation of this product you will encounter several steps that will require two people to properly install the hardware. This hardware system is designed to be used with a MasterTop Fabric replacement top for a complete soft top installation. To install a soft top to this hardware, please reference the soft top installation manual for proper soft top installation.

⚠ WARNING ⚠

Loss of vehicle control involves risk of death or serious injury, particularly to parts of your body not restrained within vehicle. This product is intended for weather protection only and should not be relied upon to contain occupants in the event of an accident or to protect from either ground contact or falling objects. To reduce risk of accident or injury:

- ALWAYS WEAR SEATBELTS
- Always keep head, arms & body parts within vehicle.
- Fully secure or stow the soft top before driving according to instructions. Never try to latch or fold soft top while driving. Do not use if damaged or worn.
- Read and follow all instructions & warnings accompanying this product, in your vehicle owner's manual and Off Road Driving Supplement.

⚠ CAUTION ⚠

RISK OF EYE INJURY. Safety glasses should be worn at all times while installing or maintaining this product.



Important Safety information

Your MasterTop® Complete Soft Top Hardware System is intended to be used with other MasterTop Products to increase the fair weather enjoyment of your off-road capable vehicle. Before installation, please take a moment to review the following safety information and installation instructions. Important safety information is generally preceded by one of three signal words indicating the relative risk of injury. The signal words mean:

⚠ WARNING ⚠

A hazardous situation which, if not avoided, could result in death or serious injury. You CAN be KILLED or SERIOUSLY HURT if you don't follow instructions.

⚠ CAUTION ⚠

A hazardous situation which, if not avoided, could result in minor or moderate injury. You CAN be moderately HURT and also may suffer property damage if you don't follow instructions.

NOTICE

Careful attention is required to this instruction or operation but does generally not relate to personal injury. Damage to your MasterTop product or other property may result if you don't follow instructions.

Before you begin Installation:

We are excited that you have chosen the MasterTop Complete Soft top Hardware System. This high quality bow and door surround system is designed to provide a platform for the installation of a fabric soft top. Please note that it is important that you become familiar with the installation process of this top by reading the following instruction sheet and warnings thoroughly. When unpacking, carefully checks to make sure all parts are included. If any part is missing or broken, please call MasterTop customer service at 720-575-5440.

Hardware System Assembly for Wrangler TJ

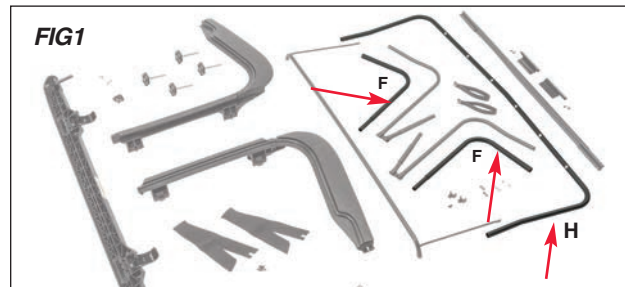

Step 1: Rear Bow Assembly

Put on safety glasses.

Locate the driver's and passenger side rear bow legs and the two sides of the rear bow as highlighted in FIG1.

Take the two rear bow legs and align the legs with the rear bow ends (bow with snaps installed) sliding one end of the bow into the other while lining up the pre-drilled hole in the bows (FIGS 2 & 3).

Note that the bow legs are "sided".

See FIGS 4 and 5 for correct alignment of the bow legs.

With the holes lined up, secure the rear bow and the bow legs with a #8 x1/2" self-tapping screw (FIGS 6 & 7).

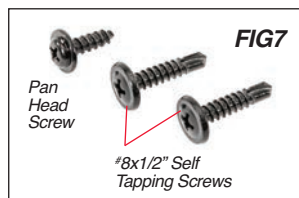
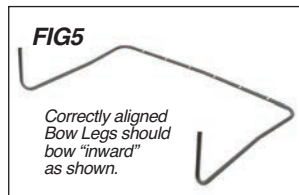
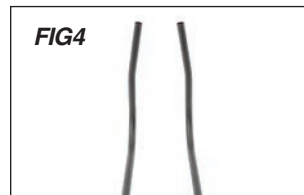

Hardware System Assembly for Wrangler TJ

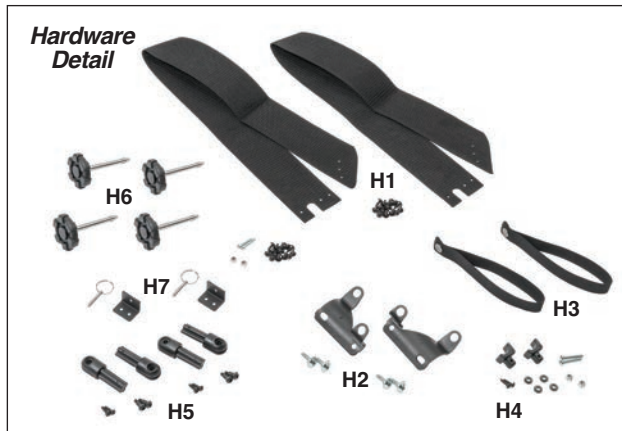

Parts List:

H1) Rear Bow Fabric	QTY 2
H2) Bow Brackets	QTY 2
H3) Rear Window Elastic Straps	QTY 2
H4) Center Bow Inserts	QTY 2
H5) Bow Inserts	QTY 4
H6) Door Surround Knobs	QTY 4
H7) Door Surround/Bow "L" Brackets with pins	QTY 2



Step 2: Install Rear Bow Leg Inserts

Locate two bow inserts (H5) as shown in Fig 8.

Insert the bow insert into the ends of the installed bow leg/rear bow assembly as shown in FIGs (9,10 & 11).



Note that the slot in the bow insert and the hole in the bow leg must be lined up (FIG 11).

With the bow insert in place, drill a small pilot hole through the pre-drilled hole in the bow leg using a 7/64" drill bit (FIG 12).



Using a #8 x1/2" self-tapping screw, secure the bow insert. (FIG 13)

Repeat on the other bow leg.

Set this assembly aside.

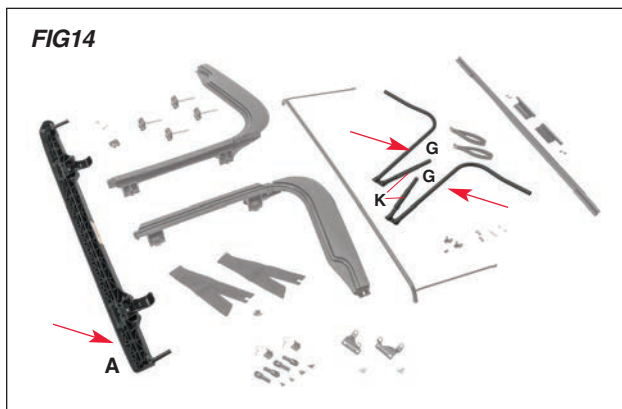

Step 3: Assemble Side Bows to Front Header

Locate the driver's and passenger side over door bows (G), the front header assembly (A) and the two metal tube "sleeves" (K) as highlighted in FIG 14.

See Next Page.

Hardware System Assembly for Wrangler TJ

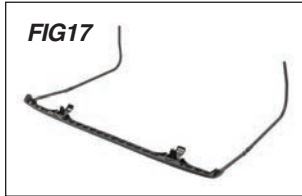

Step 3: Assemble Side Bows to Front Header

As highlighted in FIG 14, Locate the driver's and passenger side over door bows (G), the front header assembly (A) and the two metal tube "sleeves" (K).

Slide the metal tube sleeves over the short ends of the over door bows covering the "bow knuckle" (FIGs 15 & 16). Insert the over door bows into the two front header mounts making sure that the torx screw heads on the bow knuckle are facing out (FIG 17).

Using the pan head screw and lock nut, attach the over door bows with the windshield header (FIGs 18 & 19).



With a Phillips head screwdriver and 11/32" wrench, secure the screw and lock nut on each side of the windshield header (FIGs 20 & 21).

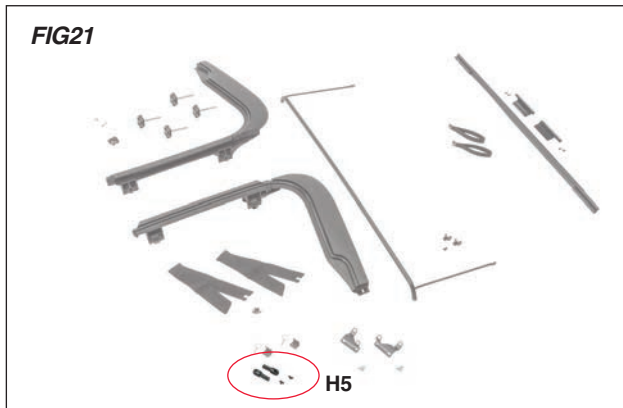

Step 4: Install Front Over Door Leg Inserts

Locate the two ends of the header and over door bows assembled in Step 3 along with the two remaining bow inserts (H5) highlighted in FIG 21.

As installed in Step 2, insert the bow insert into the ends of the installed front header/over door bow assemblies as shown in FIGs 23 and 24.

Note that the slot in the bow insert and the hole in the bow leg must be lined up (FIG 24).

With the bow insert in place, drill a small pilot hole through the pre-drilled hole in the bow leg using a 7/64" drill bit.

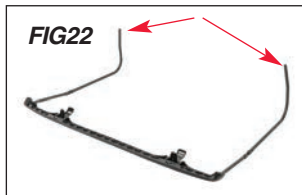

Using a #8 x1/2" self-tapping screw, secure the bow insert. Repeat on the other bow leg (FIG 25).

Set this assembly aside.



Hardware System Assembly for Wrangler TJ

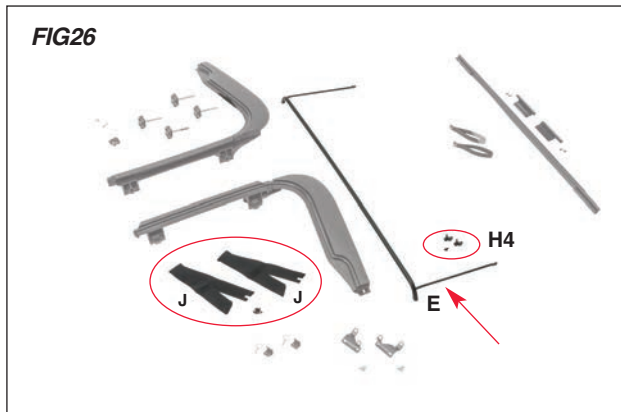

Step 5: Install Center/Rear Bow Fabric and Bow Ends to Center Bow

Locate the center bow (E), two bow fabric pieces (J) and the two center bow inserts as (H4) highlighted in FIG 26.

Lay the center bow assembly on its side with the smaller rod facing up. Locate the end of the fabric with the cutout in it and align it with the center bow assembly as shown in FIG27.

Using pan head screws, secure the fabric to the inside of the center bow on each side of the smaller rod (FIG 29) while only placing the third pan head screw in the end screw location.



Insert the center bow insert into the end of the center bow and secure it with the pre-positioned pan head screw (FIGs 29, 30, 31).

Repeat on other end of center bow.



Step 6: Install Center Bow to Over Door Bow/Front Header Assembly

Locate the front header/over door bow assembled in step 4 and the center bow assembled in Step 5.

On the over door bows you will find a 3/16" hole drilled in the bow just behind the "bow knuckle"(FIG 32).



With the header assembly laying right side up and the two over door bow ends facing down on the ground, place the installed center bow inserts on top of the bows and locate the end of the small rod on the inside of the located 3/16" hole. Using the pan head screw and lock nut, attach the center bow with the over door bows (Figs 33, 34, 35 & 36).



With a Phillips head screwdriver and 11/32" wrench, secure the screw, plastic washer and lock nut on each side of the tube as shown in FIGs 34 & 35.

Repeat this procedure on the other side of the center bow/Over door Bow header assembly.

Set this complete bow assembly to the side.



Hardware System Assembly for Wrangler TJ



Step 7: Install Bow Mounting Brackets to the vehicle

Locate the (2) bow mounting brackets (H2) and (4) torx head pivot bracket bolts highlighted in FIG 37. Carefully unzip the roll bar padding on the vertical side tube to expose the two factory holes in the roll bar (FIG 38).



Each bow mounting brackets are marked "L" and "R". The "L" marked bracket goes on the driver's side. Locate the bow mounting brackets over the factory holes and using the torx head pivot bracket bolts and a T30 torx head, install brackets to the roll bar (FIGs 39&40). Slip the roll bar padding back over the installed brackets carefully slipping the bracket mounts through the slits in the roll bar padding (FIG 41).

Repeat on passenger side.

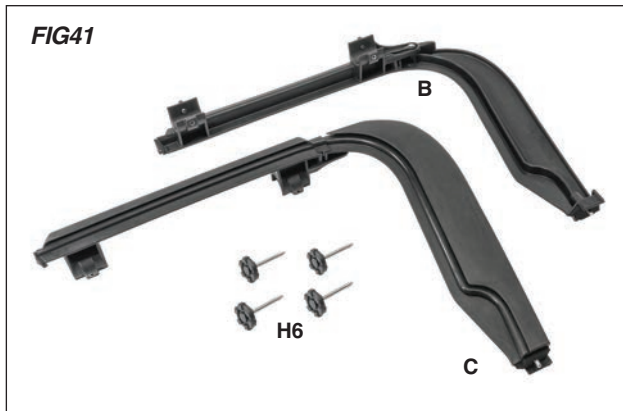

Step 8: Install Door Surrounds to Vehicle

Locate the (2) Door Surround assemblies B & C) and (4) door surround knobs (H6) highlighted in FIG 41.

Starting on the driver's side, insert the bottom of the door surround into the hole located just behind the front door (FIG 42).

Locate the "C" clamps on the upper horizontal over door section and line them up with the holes in the horizontal tubes of the roll bar. Press the "C" clamps onto the horizontal tubes and the front portion of the door surrounds forward into the rubber gasket on the windshield (FIGs 43 & 44).



With the door open, stand on the door sill and locate the two "C" clamp holes. Screw in a Door surround knob into each "C" clamp into the horizontal tube of the roll bar (FIGs 45 & 46).

Secure the knobs tight.

Repeat on passenger side.



Hardware System Assembly for Wrangler TJ

NOTICE

This step may require the help of another person. Placing the front header/bow assembly and the rear bows on the vehicle can be cumbersome. Use care when placing on vehicle as not to damage your paint



Step 9: Install Front & Rear Bows to Bow Mounting Brackets

Locate the rear bow assembly put together in steps 1 & 2. With the help of a friend, place the bow assembly in the rear of the vehicle behind the back seat with the installed bow mount ends facing up. Locate the ends of the rear bow into the bottom bow mount bracket and using the included T30 torx head screws and driver, mount the rear bow to the bracket (FIGs 47, 48 & 49).



Locate the center bow assembly from steps 5 & 6. With a friend, carefully place the assembly on top of the vehicle with the front header placed on the windshield and the side over door bows, resting on the door surrounds (FIG 50).



Note: it will be easier to handle this assembly if the metal tube sleeves are placed over the bow knuckles. This will "stiffen" the side bows making them easier to handle. Locate the ends of the over door bows into the top bow mount bracket and using the included T30 torx head screws and driver, mount the over door bows to the bracket (FIG 51).



Step 10: Installing remainder of Center/Rear Bow Fabric to Rear Bow

With the Front/Center and Rear Bows attached to the bow mount bracket, locate the loose end of the side fabric attached to the center bow in Step 5.

Fold Rear Bow upwards. Wrap the end of this loose fabric around the outside of the rear bow corner lining up the holes in the fabric with the holes in the corner of the bow (FIG 52). Using the included pan head screws (FIG 54), secure the fabric onto the rear bow (FIG 53).



Repeat this procedure on the other rear bow corner (FIG 55).

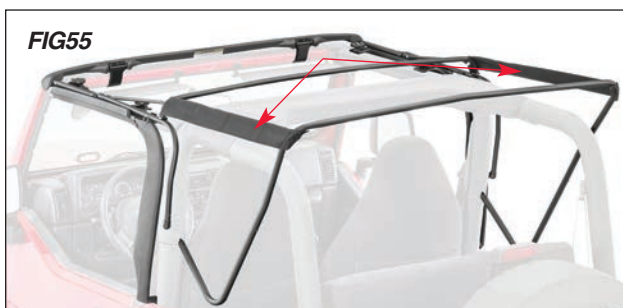

Hardware System Assembly for Wrangler TJ

WARNING

You **must** secure the side bows to the vehicle using the included bow bracket and pin. Failure to secure your bows while driving can result in serious injury or damage to your vehicle and or soft top.

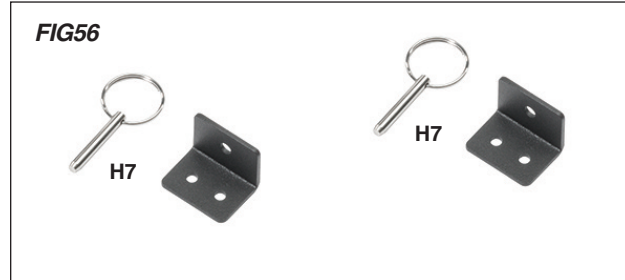

Step 11: Install the Over Door Bow Mounting Bracket

Your MasterTop Soft top hardware system features a fold back front portion over the driver and passenger. When folding back your soft top front portion, you must secure the side bows to the vehicle to prevent the entire hardware system from folding to the rear of the vehicle. This installation step attaches the over door bow mount brackets to the door surrounds which will be used to secure your bow system.



Locate the bow mount bracket kit included with the soft top hardware. (FIG 56) Fold the front header down to the windshield and latch it to the windshield from inside the vehicle. Locate the Bow mount bracket and with the two holes facing down, place the bracket under the bows lining the single hole up with the hole found in the over door bow. Install the pin through the bracket into the bows. See FIGs 57 & 58.



With a light colored marker, mark the location of the bow bracket on the top of the door surround. Unlatch the front header from the windshield and fold back the side bows to the rear of the vehicle. (FIG 58)



Line the bow bracket up with the marks on the door surrounds and drill two pilot holes through the bottom of the bow mount bracket (FIG 59) using a 7/64" drill bit and driver. Remove the bow bracket and drill a 1/8" deep hole into the door surrounds where the pilot holes are located (FIG 60).



Install the bow mount bracket to the door surround with the included screws (FIG 61) locate a spot just inside the bow mount bracket and drill a small 1/8" deep hole with the 7/64" drill bit and driver. Install the pin "lanyard" into this hole with the included screws (FIG 62).

Repeat the above on the other side of the hardware. When the front header is latched and the bows are lying on top of the bow mount bracket, secure the pin in through the bracket as shown in FIGs 63 & 64.



Hardware System Assembly for Wrangler TJ

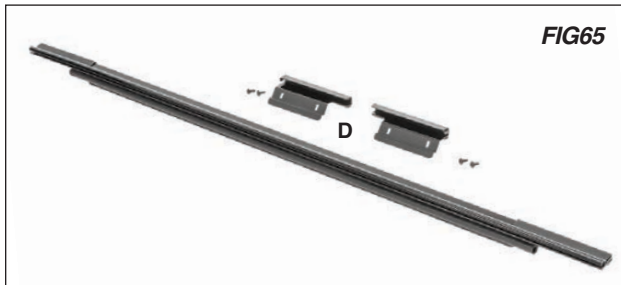

Step 12: Install the Rear Tailgate Bar Brackets

If the vehicle has previously had a tailgate bar bracket:

Place the Tailgate Bar Bracket on the outside of the tailgate opening lining up each hole (from previous Tailgate brackets) with the existing holes already drilled in the tailgate (FIGs 66 & 67). Hand tighten all provided #8 x 1/2" Pan Head washer screws into place holding the Tailgate bracket in place. Repeat on other side of Tailgate opening. Using a Phillips head screwdriver, tighten all four screws securing the tailgate bar bracket to the vehicle. Do not use a drill or screw gun to tighten. Doing so may over tighten the screws causing damage to your Jeep (FIGs 68, 69 & 70).



If the vehicle has not had a tailgate bar bracket on it before:

Line up the driver's side Tailgate Bar Bracket with the inside of the tailgate opening as shown in FIG 68.



Use the retainers as a template to mark and drill two 1/8" holes. Using a Phillips head screwdriver, tighten each screw until the Tailgate bar bracket is secure. Do not use a drill or screw gun to tighten. Doing so may over tighten the screws causing damage to your windshield (Figs 69 & 70). Repeat on Passenger side.

Your Factory Soft top Hardware system is now installed.



Please see Soft top instruction sheet for installation of your soft top to the hardware.



Using Your Soft Top Hardware



Folding Back the Front Section of your Top
Your MasterTop Soft top hardware system features a fold back front portion over the driver and passenger. When folding back your soft top front portion, you must secure the side bows to the vehicle to prevent the entire hardware system from folding to the rear of the vehicle. See the images at left illustrating how to secure the over door bows to the bow mount bracket.

⚠ WARNING ⚠ You must secure the side bows to the vehicle using the included bow bracket and pin. Failure to secure your bows while driving can result in serious injury or damage to your vehicle and or soft top.



Folding back the entire Bow system to the rear of the vehicle: If you wish to fold back the entire bow system to the rear of the vehicle (drive without the top up), follow the following steps:

1. **If driving, stop the vehicle and put in park.** Unlatch the two front windshield header latches from the windshield and unhook the entire soft top from the door surrounds and side of the body of the Jeep. The fabric can remain on the windshield header.
2. Make sure the metal Tube sleeve is slipped over the Bow knuckle on the over door bows:
3. Unhook the pins securing the over door bows to the door surrounds (see above)
4. With the help of a friend, fold back the entire top to the rear of the vehicle and secure it behind the rear seat

⚠ WARNING ⚠ You must secure the bows and attached soft top to the rear of the vehicle while driving. Failure to secure your bows while driving can result in serious injury or damage to your vehicle and or soft top.



Availability of Replacement Components and Parts

MasterTop Soft Top hardware systems are designed to be user friendly and serviceable with replacement parts if you need them in the future. The following is a list of the replacement components MasterTop will offer through our dealer network.

Part#	TJ Soft top Hardware Component List	Qty
13510.20	Door Surround, Right; 97-06 Jeep TJ	1
13510.21	Door Surround, Left; 97-06 Jeep TJ	1
13510.22	Header w/ Latch, Soft Top; 97-06 Jeep TJ	1
13510.25	Bow, Soft Top, Front; 97-06 Jeep TJ	1
13510.26	Bow, Door, Right; 97-06 Jeep TJ	1
13510.27	Bow, Door, Left; 97-06 Jeep TJ	1
13510.24	Bow, Soft Top, Rear; 97-06 Jeep TJ	1
13510.33	Strap, Rear Window, Pair; 97-06 Jeep TJ	1
13510.28	Knob, Door Surround; 97-06 Jeep Wrangler TJ	4
13510.29	Strap, Front Bow to Rear Bow, Pair; 97-06 Jeep TJ	1
13510.30	Bracket, Tail Gate Bar, Right; 97-06 Jeep TJ	1
13510.31	Bracket, Tail Gate Bar, Left; 97-06 Jeep TJ	1
13510.32	Tail Gate Bar, Soft Top; 97-06 Jeep TJ	1
13516.12	Bracket, Soft Top Bow, Right, 1&3, 97-06 TJ	1
13516.13	Bracket, Soft Top Bow, Left, 1&3, 97-06 TJ	1
11811.95	Tapping Screw M6-1.0x25mm	4

Questions?

If you have any questions, please call MasterTop customer service at 720-575-5440.

The screenshot shows the MasterTop website interface. At the top left is the MasterTop logo with the tagline 'SUPERIOR QUALITY'. To the right are navigation buttons for 'HOME', 'PRODUCTS', 'WHERE TO BUY', and 'CONTACT US'. The main content area features a large image of a green Jeep Wrangler with a black MasterTop soft top. Overlaid on the image is the text 'MasterTop Summer Accessories' and 'Made with MasterTwill Fabric for JK/JKU'. Below the image, there is a paragraph: 'Introducing MasterTop® — Premium Quality Soft Tops & Soft Accessories Created for Jeep Wrangler. Check out our options and features included.' and a yellow button labeled 'MasterTop Products'.

Updates and More Information are available at www.Mastertop.com





Limited 3 Year Warranty

Your MasterTop® accessory is covered by the following Limited Warranty provided exclusively by MasterTop, Inc., 420 J Corporate Circle, Golden, CO 80401.

This Limited Warranty is the only warranty made in connection with your purchase. MasterTop neither assumes nor authorizes any vendor, retailer or other person or entity to assume for it any other obligation or liability in connection with this product or Limited Warranty. This Limited Warranty does not apply and is not cumulative to any accessory or part distributed by any MasterTop distributor for which the Manufacturer provides a separate written warranty.

What is Covered: Subject to the terms, exclusions and limitations herein and with respect only to MasterTop branded accessories first sold in the United States, MasterTop warrants to the initial retail purchaser only that your MasterTop accessory shall be free of defects in material and workmanship; **for a period of 3 years from date of initial retail sale.**

All other warranties are hereby disclaimed, except to the extent prohibited by applicable law in which case any implied warranty of merchantability or fitness for a particular purpose on this product is **limited to 3 years from date of initial retail sale.** MasterTop reserves the rights to: (a.) require invoice or other proof your product is within the terms of this Limited Warranty as a condition of warranty service and, (b.) make future revisions to this product and Limited Warranty without prior notice or obligation to upgrade your product.

What is Not Covered: Your MasterTop Limited Warranty does not cover products or parts MasterTop determines to have been damaged by or subjected to: (a.) installation damage, alteration, modification, failure to maintain or attempted repair or service by anyone not authorized by MasterTop, (b.) normal wear and tear, cosmetic damage or damage from water immersion, (c.) Acts of God, accidents, misuse, negligence, inadequate mounting or impact with vehicle(s), obstacles or other aspects of the environment, (d.) theft, vandalism or other intentional damage, (e.) fleet, rental or commercial use, (f.) use in competition or racing.

Remedy Limited to Repair/Replacement: The exclusive remedy provided hereunder shall, upon MasterTop inspection and at MasterTop's option, be either repair or replacement of product or parts (new or refurbished) covered under this Limited Warranty. Customers requesting warranty consideration on MasterTop Products should first contact MasterTop to obtain a RGA number (720-575-5440). All labor, removal, shipping and installation costs are customer's responsibility.

Other Limitations - Exclusion of Damages - Your Rights Under State Law:

In consideration of the purchase price paid, neither MasterTop nor any independent MasterTop distributor /licensee are responsible for any time loss, rental costs, or for any incidental, consequential, punitive or other damages you may have or incur in connection with any part or product purchased. Your exclusive remedy hereunder for covered parts is repair/replacement as described above.

This Limited Warranty gives you specific rights. You may also have other rights that vary from state to state. For example, some states do not allow limitations of how long an implied warranty lasts and/or do not allow the exclusion or limitation of incidental or consequential damages, so the limitations and exclusions herein may not apply to you.

©MasterTop, Inc. 2019. All Rights Reserved. The term MasterTop® is a Registered Trademark of MasterTop Incorporated, Registered in U.S. Patent and Trademark Office.

www.MasterTop.com

Part #941032.01 Version 2.28.19 LTR

