

XKGLOW

MX-GPOD



XKMAX PRE-RUNNER STYLE GRILL LIGHT KIT **INSTALLATION INSTRUCTIONS**



xk@xkglow.com

(217) 679-1915

INPUT VOLTAGE	CONTROLLER MAX LOAD	MAX POWER PER GRILL POD
11-14V	5A PER CHANNEL	.5W

WARRANTY AND DISCLAIMER

Within **THREE** years after the purchase date, the original buyer may return any XKGLOW lighting product that has failed due to a defect in materials or workmanship to receive a replacement product.

Installation of this product must be performed by a licensed professional. Should the failure of the product be the result of damage occurring as a result of improper installation, alteration of the product or an act or omission on the part of the consumer, this warranty is void. XKGLOW Lighting shall not be responsible for any consequential damages which arise from the use and/or installation of the product. If the kit is installed in any manner other than specified, XKGLOW Lighting reserves the right to deny any warranty claims at the discretion of the technical support department. Any product return must include the original packaging, invoice number and a statement of the alleged defect. Upon receipt of the returned product, the company will test the product for defect. If the results of the testing do not support the warranty claim, do not reveal any defect or indicate consumer negligence in the installation and handling of the product, then the product will be returned to you and you will be charged a reshipping fee. If the product is returned from an address within the continental United States, within the first 30 days after purchase, and is found to be defective, XKGLOW Lighting will exchange or refund the original purchase expense. This offer does not extend to the cost for shipping charges on any international packages.

ADDITIONAL DISCLAIMER TERMS

Please check your local and state laws for the proper use of this product.

- Improper installation of electrical products such as lighting may cause damage to any vehicle or device to which the improperly handled or installed lighting is attached.
- Improperly installed product may cause electrical injury to persons.
- It is recommended that the kit should be installed by a licensed professional.
- XKGLOW assumes no liability for the installation of the product.
- Warranty or liability will not exceed the product purchase price, which shall be buyer's sole and exclusive remedy.

RETURN/EXCHANGE PROCEDURE

1. Email [xk@xkglow.com] to notify us of the product issue as well as the item number and name of customer on invoice.
2. We will send you the trouble-shooting guide to fix the issue, or to narrow down which of the component(s) need to be replaced. If the issue still exists, we will ask you to send back the defective items to be replaced.
3. Please send the returned item as instructed, along with claims and a telephone number where you can be reached.
4. After the returned item(s) have been accepted and inspected, we will issue a refund or replace the items ASAP. For refunds, item(s) must be sent to XKGLOW within 30 days from date of purchase. Original shipping charges are not refundable.

We always stand behind our products and are committed to our customers! For questions you may have, please contact xk@xkglow.com. We normally respond within 24 hours. (Monday-Friday).

WIRING INSTRUCTIONS

1. Test Grill Pods Before Mounting: To test the XKmax grill lights, plug them all into a series, then to Channel A on the controller. Connect the **RED** wire of the controller to the ignition fuse or **POSITIVE** pole of 12V DC battery and the **BLACK** wire to **NEGATIVE** pole. Turn on the switch button to test all lights. If the grill pods show any defects, please contact us immediately.

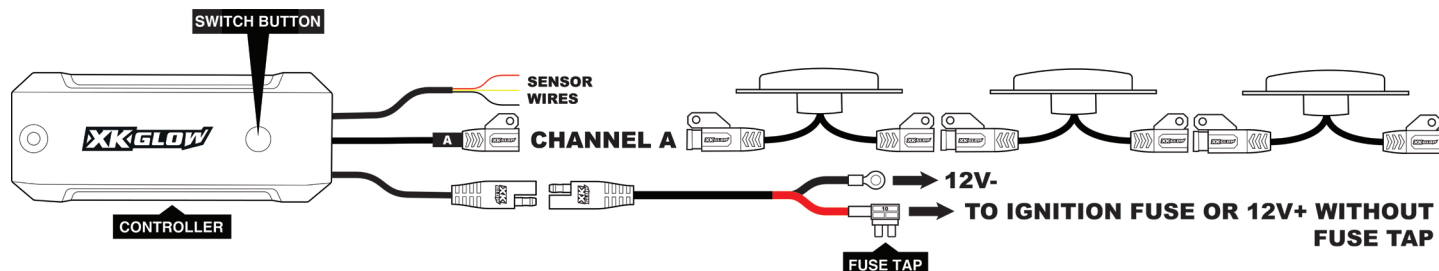

2. Mount Lights in Grill: Insert the pod into the front of the grill, tucking the wires through the same honeycomb opening the light is covering. Use the provided zip ties to secure the pod to the grill.

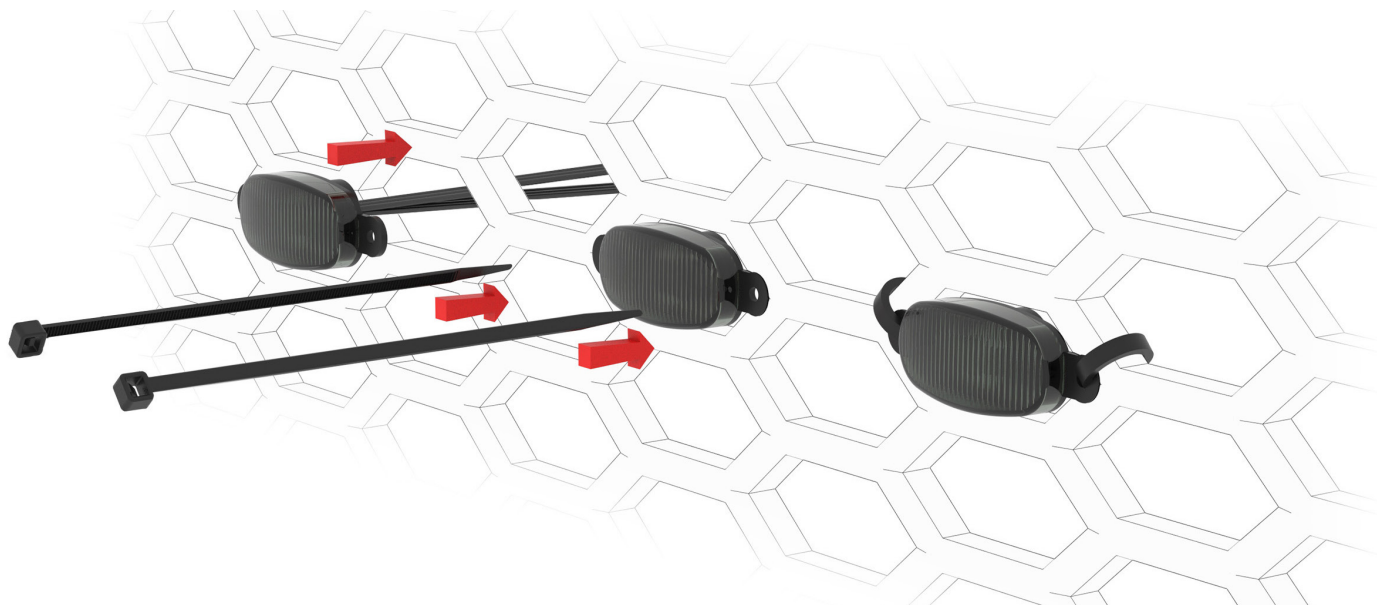

3. Wiring: Connect all of the pod wires and the power wiring harness. **WARNING-** Do not force the plugs together! If they don't snap together, verify that all the pins line up. If a pin is out of place, it must be straightened for the plug to snap together.

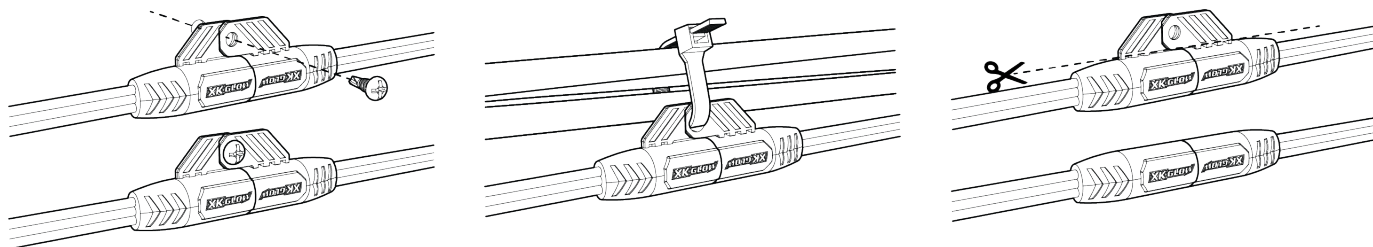

4. Tap Sensor Wires: (Optional) If you tap the sensors as specified below, the lights can act as turn signals. If you would like to use the lights as turn signals, you must split the lights into 2 zones in the app. Refer to the **Customize Light Map** in the *App Instructions* to set up zones. Use the diagram below to tap wires using included T-tap connectors.

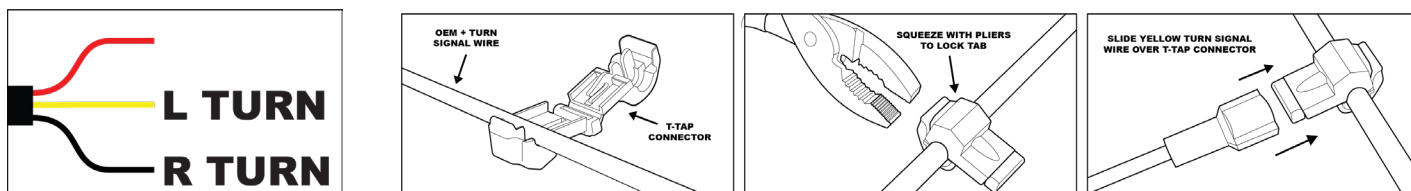

5. Connect to 12v DC Power: Firmly connect the wire terminals to the positive and negative poles of the battery. Power on and download the XKmax app. If you are adding more lights, they will need to be configured in the app. View **Adding Lights** section below.

ADDING LIGHTS

If you are adding additional pods, you will need to configure them to the controller. Follow the steps below to add the lights to the map.



Go to the Configuration Page

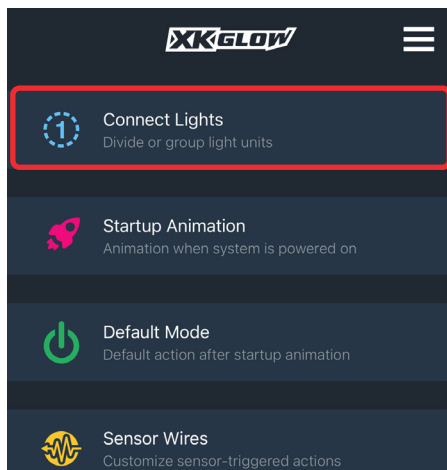

Select Connect Lights

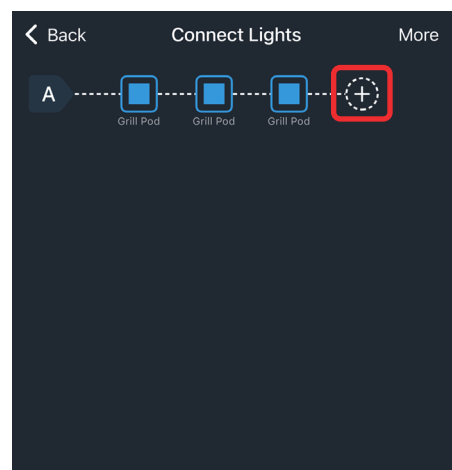

Tap plus sign



Select "Pods"

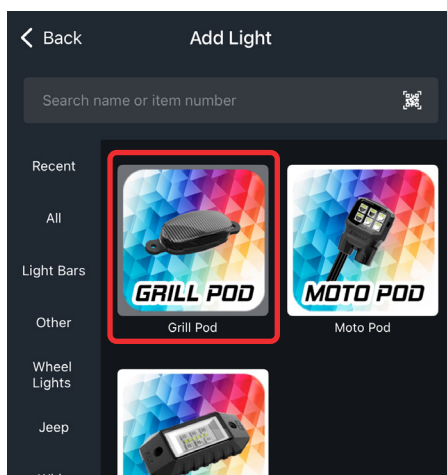

Tap Grill Pod

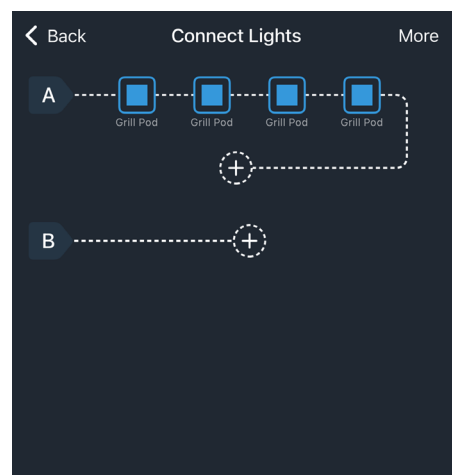

Repeat this process for each additional grill pod

DOWNLOAD XKMAX

Scan the QR code below to download the XKmax App



SCAN TO ADD POD



MX-GPOD

NEED MORE LIGHTS?



UPGRADE ACCESSORIES

PRODUCT FEATURES



+ INSTALL VIDEOS

MONTHLY PHOTO CONTEST:
POST YOUR
BEST PHOTO OR
VIDEO FOR A
CHANCE TO WIN
\$150!

JOIN THE CIRCLE!
CREATE. CONNECT. COMMUNITY.

Here at XK GLOW, we value the **COMMUNITY** built around our products. So we developed our own social media platform into all XK GLOW apps! **CREATE** a Circle account to share photos of your ride, see exclusive sneak peaks into product development, and **CONNECT** with the entire XK GLOW family!