



# Installation Instructions

## Complete Soft Top Hardware System for 2007-2018 Jeep® Wrangler JK 4 Door Item # 15433411

Complete  
hardware  
system without  
soft top fabric



### Parts List:

Rear Bow System - Qty 1  
Door Surround Passenger Side- Qty 1  
Door Surround Driver Side- Qty 1  
Door Surround Knobs- Qty 6  
Tailgate Bar with Clips - Qty 1  
Front Header- Qty 1  
Over Door Bows- Qty 2  
Center Bow- Qty 1  
Center Bow Mounts-Qty 2  
Rear Bow Mounts- Qty 2  
Roll Bar Mounts-Qty 2  
Quick Release knobs-Qty 2

### Required Tools:

Safety Glasses  
T30 Torx Socket & Driver  
Phillips Head Screwdriver  
3/32 drill bit and drill

### NOTICE

This Complete Bow and Door Surround kit is designed to fit on your 4 Door JK Wrangler when the hard top or original soft top has been completely removed. Before beginning your installation of this product, carefully remove your hard top or current soft top hardware. During the installation of this product you will encounter several steps that will require two people to properly install the hardware. This hardware system is designed to be used with a MasterTop Fabric replacement top for a complete soft top installation. To install a soft top to this hardware, please reference the soft top installation manual for proper soft top installation.

### ⚠ WARNING ⚠

Loss of vehicle control involves risk of death or serious injury, particularly to parts of your body not restrained within vehicle. This product is intended for weather protection only and should not be relied upon to contain occupants in the event of an accident or to protect from either ground contact or falling objects. To reduce risk of accident or injury:

- ALWAYS WEAR SEATBELTS
- Always keep head, arms & body parts within vehicle.
- Fully secure or stow the soft top before driving according to instructions. Never try to latch or fold soft top while driving. Do not use if damaged or worn.
- Read and follow all instructions & warnings accompanying this product, in your vehicle owner's manual and Off Road Driving Supplement.

### ⚠ CAUTION ⚠

RISK OF EYE INJURY. Safety glasses should be worn at all times while installing or maintaining this product.



### Important Safety information

Your MasterTop® Complete Soft Top Hardware System is intended to be used with other MasterTop Products to increase the fair weather enjoyment of your off-road capable vehicle. Before installation, please take a moment to review the following safety information and installation instructions. Important safety information is generally preceded by one of three signal words indicating the relative risk of injury. The signal words mean:

#### **⚠ WARNING ⚠**

A hazardous situation which, if not avoided, could result in death or serious injury. You CAN be KILLED or SERIOUSLY HURT if you don't follow instructions.

#### **⚠ CAUTION ⚠**

A hazardous situation which, if not avoided, could result in minor or moderate injury. You CAN be moderately HURT and also may suffer property damage if you don't follow instructions.

#### **NOTICE**

Careful attention is required to this instruction or operation but does generally not relate to personal injury. Damage to your MasterTop product or other property may result if you don't follow instructions.

### Before you begin Installation:

We are excited that you have chosen the MasterTop Complete Soft top Hardware System. This high quality bow and door surround system is designed to provide a platform for the installation of a fabric soft top. Please note that it is important that you become familiar with the installation process of this top by reading the following instruction sheet and warnings thoroughly.

When unpacking, carefully check to make sure all parts are included. If any part is missing or broken, please call MasterTop customer service at 720-575-5440.

### Un-packing and Organizing the Door Surrounds



Put on safety glasses. Carefully remove all the contents of the large shipping box onto a table top or onto the ground on top of a soft towel.

Once the components are removed from the shipping box, locate the two long rectangle boxes that house the door surrounds. Each box contains a front and rear door surround and hardware.

Carefully remove the contents of each box organizing them as shown in FIG1 making sure the passenger side and driver's side components are separated.

#### **NOTICE**

This Door Surround kit is designed to fit 07-2018 JK 4 door Wranglers. If you own a Soft Top designed for a 07-09 Wrangler without a cable style attachment system, skip to step 3. If you are using a MasterTop Soft top on this hardware system or a 2010-2018 fabric replacement soft top with a cable style attachment, proceed as follows with step one.



## Section 1: Door Surround Assembly

FIG2



### Step 1: Rear Door Surround Assembly

Locate the Driver's side over door assemblies and the "drip rail" inserts shown in FIG2.

Separate out the driver's side Rear over door assembly and corresponding drip rail insert as shown in FIG3.

Locate and line up the three round tabs on the drip rail with the holes located in the over door assembly as shown in FIG4.

Firmly Squeeze the round tabs down into the holes permanently securing them to the over door assembly (See FIG5).

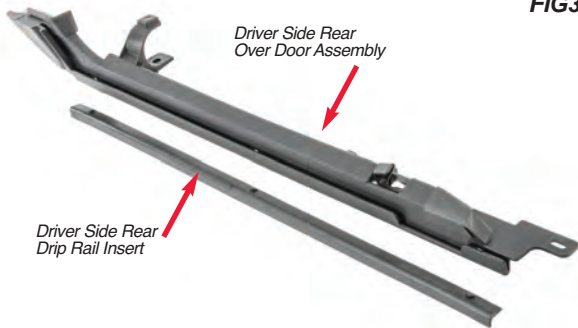

FIG3

NOTE: It may take a lot of force to squeeze these tabs into the over door assembly. You may need to use a rubber mallet or the edge of a table to secure them completely.

Repeat this procedure for the Passenger side rear over door assembly.



**Section 1: Door Surround Assembly**

**FIG2A**

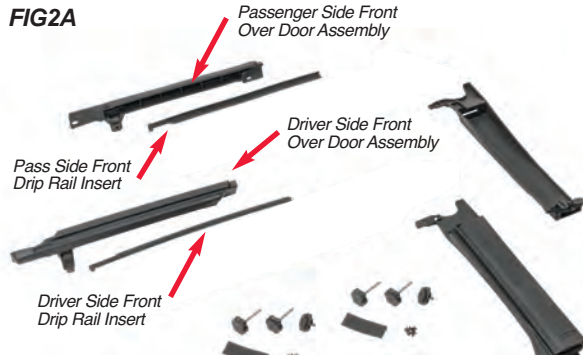

**Step 2: Front Door Surround Assembly**

Locate the driver's side Front over door assembly and corresponding drip rail insert as shown in both FIG2A and FIG6.

**FIG6**



Locate and line up the two round tabs on the drip rail with the holes located in the over door assembly as shown in FIG7. While lining up the two holes, also line up the half circle on the drip rail with the half circle on the over door assembly as shown in FIG8.

Firmly Squeeze the round tabs down into the holes permanently securing them to the over door assembly while making sure the half circle is properly located in the cutout (See FIG9).



**FIG7**

**NOTE:** It may take a lot of force to squeeze these tabs into the over door assembly. You may need to use a rubber mallet or the edge of a table to secure them completely.

**Repeat this procedure for the passenger side front over door assembly.**

**FIG8**

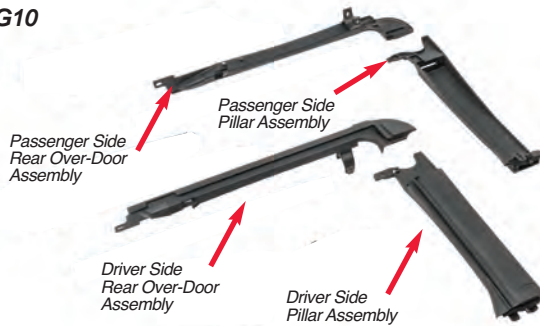

**FIG9**



## Section 1: Door Surround Assembly

FIG10



### Step 3: Pillar and Rear Over Door Surround Assembly

Locate the driver's side Rear over door assembly and the driver's side Pillar assembly shown in Fig 10.

Turn the two pieces over as shown in FIG11 and line up the slot on the pillar assembly with the "T" on the over door assembly. Notice in Fig11 that there is a secondary "T" that will be lined up when you slide the long "T" into the long slot. Slide the two pieces together lining up both "T's" to secure the top over door assembly with the Pillar assembly. See FIGs 12 & 13.

Locate the small screw packet in the hardware kit found in the door surround box. Using a Phillips head screw driver, install the screw into the screw hole on the two assembled parts securing them permanently together. See FIGs 14, 15 & 16.

Repeat the above assembly on the Passenger side Rear over door and pillar assemblies.

FIG11



FIG12

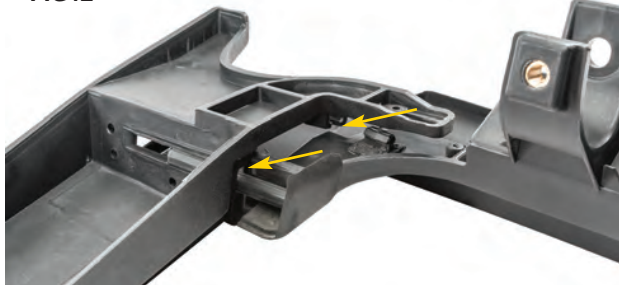

FIG13



FIG14



FIG15

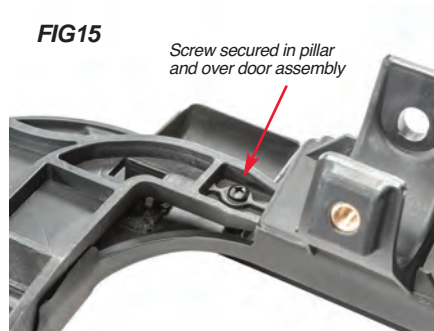

Screw secured in pillar and over door assembly

FIG16



## Section 1: Door Surround Assembly



### Step 4: Install Rear Door Surrounds to Jeep

Locate the assembled Driver's side rear door surround (Fig 17). On the bottom of the vertical pillar portion of the assembled door surround is a pin that will be inserted into the body tub as shown in FIG18.

Insert this pin into the body tub as shown in FIGs 19 & 20. After inserting the pin, locate the upper portion of the door surround "C" attachment and push onto roll bar (Figs 21 & 22).

The "C" should fit in the cutout of the roll bar pad. Line up the threads in the "C" with the top hole in the roll bar. **Repeat this procedure on the passenger side.**



### Step 5: Install Foam to Front Door Surrounds

Locate the driver's side front door surround and the rectangular piece of foam found in the door surround hardware pack. Line up the foam with the rear of the door surround and measure the length between the rear of the door surround and the top of the curve (Fig 23). With a pair of scissors, cut the foam to size. Remove the backing on the foam and secure it to the front of the door surround as shown in FIG24. Make sure not to cover the hole in the door surround. **Repeat this procedure on the passenger side door surround.**



## Section 1: Door Surround Assembly



**Step 6: Install Front Door Surrounds to Jeep**  
 Locate the driver's side front door surround on which you just installed the foam and line up the rear end with the front of the rear door surround as shown in FIG25. Make sure the Door seals are not caught under the door surrounds (See FIG26)

Push the seal between the front and rear door surround together and then, as you did with the rear door surround, push the "C" channel onto the roll bar between the padding (cutout) and line up the holes in the "C" with vertical holes in the roll bar (FIGs 27, 28 & 29).

Repeat this procedure on the passenger side.

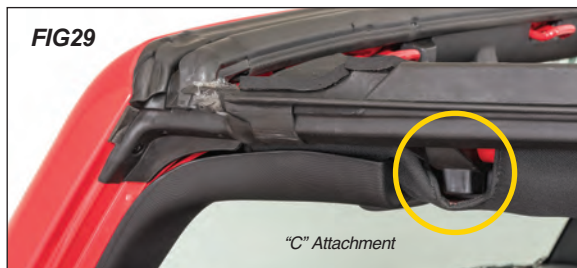

### Step 7: Secure Front & Rear Door Surrounds to Roll Bar

Locate the two sets of screw knobs in each Door surround box. There should be (2) sets of three knobs with two the same length and one shorter length. The shorter knob attaches to the center hole on the door surrounds and the (2) longer knobs go on the front and rear holes.

Line up the door surround "C" attachment holes with the vertical holes in the roll bar. Slip the front knob through the hole in the front door surround (FIG30). Tighten the knob securing the front door surround. Repeat this procedure on the back of the rear door surround. Finally, with the short knob secure the "sandwiched" front & rear door surrounds with the short knob and tighten all three knobs (FIGs 31 & 32). All knobs on both sides of the vehicle should be secured to the roll bar. **This completes the installation of the door surrounds to your vehicle.**

## Section 2: Installation of The Soft Top Bow Assemblies

### ⚠ CAUTION ⚠

The following steps will require the help of another person. The bow assembly is pre-assembled and quite large. To prevent damage to your vehicle and to ensure your safety, you must have two people to install your bow assembly to your vehicle.

### Step 8: Installing the Center Bow Mount Brackets and Center Bow

FIG 34



FIG 35



FIG 36



Rectangle cut-out goes over oval mount

FIG 37



FIG 38



FIG 39



FIG 40



Locate the center bow and two center bow mount brackets as called out in FIG 34. The center bow mount brackets will be installed using the door surround knobs previously installed in step 7. As circled in Fig 35, the oval mount is located towards the rear of the vehicle. Take the drivers side center bow mount bracket and place the rectangle cutout over the oval mount as shown in Fig 36. Note the location of the bracket when properly placed in Fig 37. Locate the short Door Surround knob and install the knob through the oval opening into the “C” channel on the door surround. Note that you will have to press down hard to get the knob to engage (Figs 38 & 39). Tighten the knob leaving it loose so the bracket can slightly shift (Fig 40). Repeat on the other side of the vehicle.







FIG 41



FIG 42



FIG 43

With the center bow mount brackets loosely installed, Locate the center bow and (with the help of a friend) place the Quick release end on the bottom of the bow leg on the rear-most vertical bracket (Fig 41). Pull the quick release knob out and push the bow down mounting the quick release to the bracket (Fig 42). The quick release knob is spring loaded so you should here a “click” when it is secure in the bracket (Fig 43). Repeat this bow mounting on the other side of the vehicle and then tighten down the door surround knobs on each side of the vehicle.

## Step 9: Mounting the Rear Bow Mount Brackets to the Door Surrounds



FIG 44



FIG 45



FIG 46



FIG 47



FIG 48



FIG 49



FIG 50

Locate the two rear bow mount brackets as circled in Fig 44. On the rear door surround, remove the rear-most door surround knob loosely installed to hold the door surround on the vehicle (Figs 45 & 46). Locate the proper rear bow mount bracket with the flat steel tab facing down and place the bracket over the door surround hole with the quick release knob facing the rear of the vehicle (Fig 47). Notice that the quick release knob is facing inwards (Fig 48). Install the bracket using the door surround knob to secure it to the “C” Channel in the door surround (Figs 47, 48, 49 & 50). Repeat on the other side of the vehicle.

### Step 10: Mounting the Roll Bar Mounting Brackets to the Rear Roll Bar

FIG 51



FIG 52



FIG 53



FIG 54



FIG 55



FIG 56



FIG 57



FIG 58

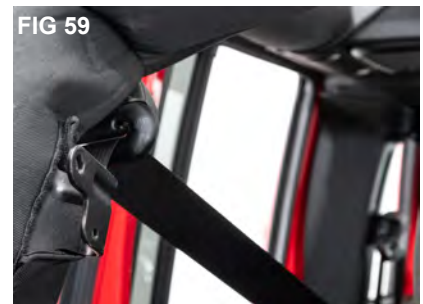

FIG 59

Locate the two Roll Bar Mount Brackets circled in Fig 51. These brackets will be installed on the inside of the rear roll bar under the roll bar padding. When installed, the long “leg” of the bracket will be on the top and the bracket will be on the inside of the roll bar as shown in Fig 52. On the rear roll bar, un-hook the roll bar padding Velcro at the top of the roll bar and unzip the padding (Fig 53) which will expose the two factory mounting points on the inside of the roll bar. Place the roll bar mounting bracket over the holes and using the enclosed mounting bolts (T-30 Torx bolts) hand tighten the bracket in place (Figs 54 & 55). Using a T-30 Socket and driver, tighten the two bolts securing the bracket to the roll bar (Fig 56). Replace the roll bar padding back over the bracket slipping the “leg” of the bracket through the factory cutout in the padding (Fig 57). Zip up the roll bar padding (Figs 58 & 59). Repeat on the other side of the vehicle.

#### **CAUTION**

The following steps will require the help of another person. The bow assembly is pre-assembled and quite large. To prevent damage to your vehicle and to ensure your safety, you must have two people to install your bow assembly to your vehicle.



## Step 10: Mounting the Rear Bow Assembly to the Vehicle

FIG 60



FIG 61



FIG 62

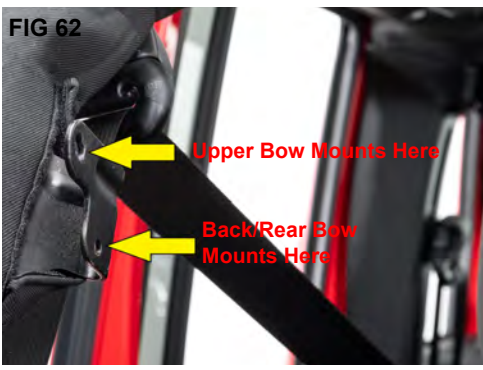

FIG 63



FIG 64



FIG 65



FIG 66

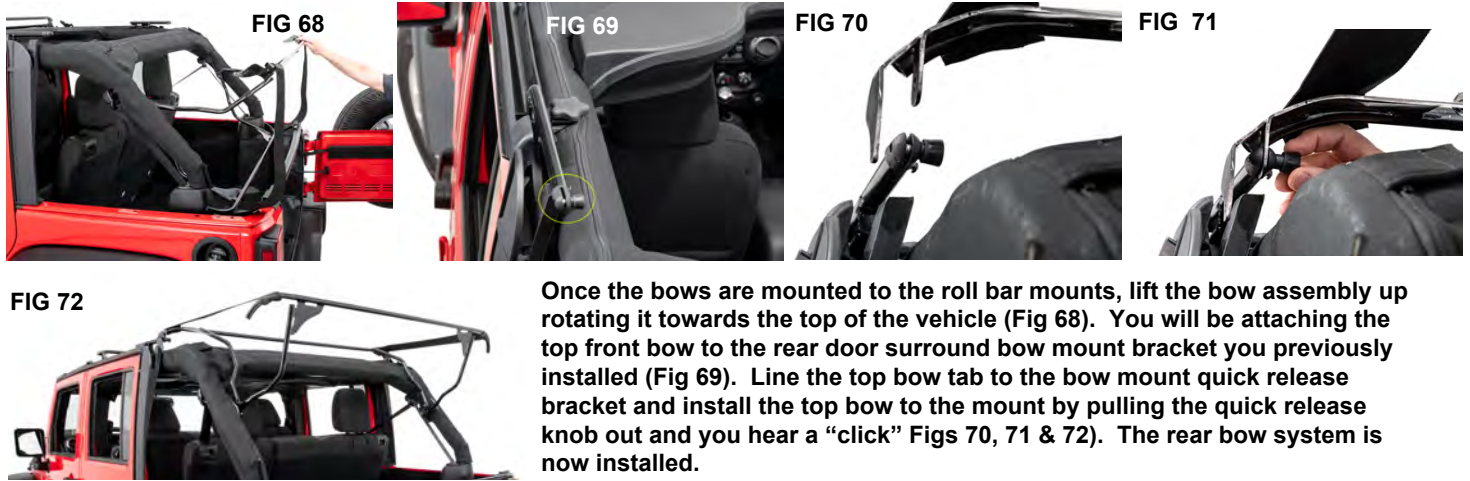

FIG 67



Locate the large bow assembly shown in Fig 60. With the help of a friend, place the bow assembly in the rear of the vehicle and lift up the upper bow section. The upper bow section has two large bent brackets on the ends as circled in Fig 61. Line up the quick release bow ends on the upper bow with the Top hole in the bow mount bracket (Fig 62) and attach the top bows to the bracket by pulling out the quick release knob and placing the slot of the quick release over the bow mount (Fig 63) until you hear a “click”. Repeat on other side bow mount. **Pro installer Tip:** to make the mounting of the Quick Release knob easier, lift the bow end up perpendicular to the mount so it comes straight into the end of the mount vs. from the bottom or top. Fig 64 shows the correct angle to attach the quick release. Once the top bow is mounted, locate the rear bow mounts and install them as you did the top bow to the lower hole location on the roll bar mount (figs 65, 66 & 67) repeat on the other side of the vehicle.





Once the bows are mounted to the roll bar mounts, lift the bow assembly up rotating it towards the top of the vehicle (Fig 68). You will be attaching the top front bow to the rear door surround bow mount bracket you previously installed (Fig 69). Line the top bow tab to the bow mount quick release bracket and install the top bow to the mount by pulling the quick release knob out and you hear a “click” Figs 70, 71 & 72). The rear bow system is now installed.

### Step 11: Mounting the Quick Release Knobs To the Header Assembly



Quick Release Knobs should be facing out when installed

Locate the front header assembly and two quick release knobs (Fig 73). The quick release knobs will be installed on the end of the header assembly over door bows with the knob portion facing out (Fig 74). Slip the end of the Quick release knob into the end of the over door bows with the knob portion facing out. Using a 3/32” drill bit and drill, drill a pilot hole into the quick release knob through the hole in the bow (Fig 75). **Important:** The Quick release insert must be all the way in the bow, the knob facing out and the slot in the quick release must be facing up before you drill the pilot hole! Once the pilot hole is drilled, mount the quick release assembly to the bow end using a Philips head screw driver (Figs 76, 77 & 78). Repeat this procedure on the other bow mount end.

**Pro Installer Tip:** At this point in the installation if you are installing a soft top to this hardware system, we HIGHLY recommend you install the soft top fabric to the header at this point. It will be much easier to install the fabric to the front header with the Header assembly off the vehicle. Please see your soft top installation instructions for the proper procedure to install the soft top fabric to the front header.



## Step 12: Mounting the Front Header Assembly to the Vehicle

FIG 79



FIG 80



FIG 81



FIG 82



FIG 83



FIG 84



Locate the complete front header assembly from step 11. The header assembly will install to the front bow mount bracket located on the top of the door surrounds (Figs 79 & 80). With the help of a friend, lift the assembly over the vehicle and line up the over door bow end quick release knobs with the bow mount bracket location shown in Fig 81. Notice in Fig 81 that the end of the over door bows comes straight down into the bracket. This is important as it will make installation much easier. Once lined up with the bow mount bracket, install the header assembly by pulling out the quick release knob and push over the mount until you hear a “click” (Figs 82 & 83). Repeat this on the other side of the vehicle and then fold the assembly down onto the windshield (Fig 84).



FIG 85

## Step 13: Attaching the Tailgate Brackets and Tailgate Bar

Locate the Tailgate bar and brackets (FIG 85). Locate the driver's side bracket with the lip to the outside of the vehicle, line up the bracket with the slot in the body tub, hook the rear portion of the bracket to the body tub and roll the bracket forward until it clicks.

See FIG's 86, 87 & 88. Repeat this procedure on the passenger side. See the Soft top or Soft accessory instruction sheet for the proper installation of the tailgate bar into these brackets.



FIG 86



FIG 87



FIG 88

# Use Instructions

## Using Your Soft Top Hardware

FIG 89



### Fold Back Feature Use:

Your Soft top hardware has both a front fold back feature, (FIG 89) and the ability to be folded all the way back to the rear of the vehicle (FIG 90).

### Folding Back the Front Section

Unlatch the two front Windshield latches. With the help of a friend, lift up the Front header and fold it back until it seats on the top of your soft top.

### Folding Back the Rear Bows

To fold back your rear bows, remove the rear and quarter windows from your soft top. Unlatch the quick release knobs (both sides) found on the top of the roll bar (Fig 91 & 92). Once un-latched, the rear bow assembly should fold back just inside the rear tailgate area (FIG's 93 & 94).

See Caution Below:

FIG 90



FIG 91



FIG 92



FIG 93



FIG 94



### **CAUTION**

When Folding back your Soft Top Hardware always make sure it is secured to the vehicle and that the quick release knobs are secure. Failure to do so may result in damage to your vehicle, hardware system, soft top and your person.





## Limited 3 Year Warranty

Your MasterTop® accessory is covered by the following Limited Warranty provided exclusively by MasterTop, Inc., 420 J Corporate Circle, Golden, CO 80401.

This Limited Warranty is the only warranty made in connection with your purchase. MasterTop neither assumes nor authorizes any vendor, retailer or other person or entity to assume for it any other obligation or liability in connection with this product or Limited Warranty. This Limited Warranty does not apply and is not cumulative to any accessory or part distributed by any MasterTop distributor for which the Manufacturer provides a separate written warranty.

**What is Covered:** Subject to the terms, exclusions and limitations herein and with respect only to MasterTop branded accessories first sold in the United States, MasterTop warrants to the initial retail purchaser only that your MasterTop accessory shall be free of defects in material and workmanship; **for a period of 3 years from date of initial retail sale.**

All other warranties are hereby disclaimed, except to the extent prohibited by applicable law in which case any implied warranty of merchantability or fitness for a particular purpose on this product is **limited to 3 years from date of initial retail sale.** MasterTop reserves the rights to: (a.) require invoice or other proof your product is within the terms of this Limited Warranty as a condition of warranty service and, (b.) make future revisions to this product and Limited Warranty without prior notice or obligation to upgrade your product.

**What is Not Covered:** Your MasterTop Limited Warranty does not cover products or parts MasterTop determines to have been damaged by or subjected to: (a.) installation damage, alteration, modification, failure to maintain or attempted repair or service by anyone not authorized by MasterTop, (b.) normal wear and tear, cosmetic damage or damage from water immersion, (c.) Acts of God, accidents, misuse, negligence, inadequate mounting or impact with vehicle(s), obstacles or other aspects of the environment, (d.) theft, vandalism or other intentional damage, (e.) fleet, rental or commercial use, (f.) use in competition or racing.

**Remedy Limited to Repair/Replacement:** The exclusive remedy provided hereunder shall, upon MasterTop inspection and at MasterTop's option, be either repair or replacement of product or parts (new or refurbished) covered under this Limited Warranty. Customers requesting warranty consideration on MasterTop Products should first contact MasterTop to obtain a RGA number (720-575-5440). All labor, removal, shipping and installation costs are customer's responsibility.

### **Other Limitations - Exclusion of Damages - Your Rights Under State Law:**

In consideration of the purchase price paid, neither MasterTop nor any independent MasterTop distributor /licensee are responsible for any time loss, rental costs, or for any incidental, consequential, punitive or other damages you may have or incur in connection with any part or product purchased. Your exclusive remedy hereunder for covered parts is repair/replacement as described above.

This Limited Warranty gives you specific rights. You may also have other rights that vary from state to state. For example, some states do not allow limitations of how long an implied warranty lasts and/or do not allow the exclusion or limitation of incidental or consequential damages, so the limitations and exclusions herein may not apply to you.

©MasterTop, Inc. 2021. All Rights Reserved. The term MasterTop® is a Registered Trademark of MasterTop Incorporated, Registered in U.S. Patent and Trademark Office.

[www.MasterTop.com](http://www.MasterTop.com)

Part #941058.01 Version 5.17.21LTR

