

**WARNING:**

This product can expose you to chemicals including vinyl chloride and lead, which is known to the state of California to cause cancer and birth defects other reproductive harm. For more information go to [www.P65Warnings.ca.gov](http://www.P65Warnings.ca.gov)

**CUSTOM JL CB ANTENNA KIT****MODEL # JL ANTMK-P****Jeep Wrangler JL 2018 & UP**

rev

**P65****Parts Included**

1. Stainless Steel Antenna Mount (Passenger Side)
2. Custom Antenna Cable with 2 Piece Connector
3. One Ground Cable & 6mm Ground Screw
4. One Trim Stick
5. One 4ft Firestik Antenna
6. Eight 8" Tie Straps

**Installation Preparation**

1. Remove Spare Tire.
2. Open the Tailgate and use the supplied Trim Stick to remove the Upper Plastic Panel with the Jeep Logo from the Tailgate as shown in picture #1.
3. Use the Trim Stick to remove the Large Plastic Panel from the Tailgate as shown in picture #2.
4. Remove the Access Panel from the floor of the Jeep as shown in picture #3.
5. Remove the Tie Down Strip as shown in picture #4.
6. Use the Trim Stick to remove the Plastic Fender Well Cover from the rear passenger side of the Jeep. This will expose the Door Hinge Mount and inside of the Tailgate as shown in picture #2A.
7. Remove the 2 Screws from the Spare Tire Carrier on the passenger side as shown in picture #5.
8. Remove the Rubber Grommet on the passenger side of the Tailgate.

**Mount and Wiring Installation**

9. Install the Mount on the passenger side of the Jeep using the 2 Screws you just removed. Only tighten Hand Tight.
10. The Mount, Cables & Grommet are preassembled. Uncoil the Antenna Cable & Ground Wire. Feed them further through the Grommet until there is approximately 8" of Cable left between the Grommet and the Mount. (DO NOT PULL ON THE CONNECTORS)
11. Feed the Wires through the Grommet Hole in the Tailgate. Feed the Antenna Wire through First careful not to pull on the connector. The Wire will be accessible inside the Tailgate near the Lower Right Side by the Vent.
12. Feed the Ground Wire through the same way as shown in picture #2.
13. Install the New Grommet in the Tailgate Hole. Start by pushing in the Bottom Half of the Grommet first. Use the Trim Stick to push in the rest of the Grommet as shown in picture #5A.
14. Go Back and Tighten the Screws on the Antenna Mount.
15. Use the Supplied Tie Straps to Neatly run the Wires along with the Existing Wires already in the Tailgate as shown in picture #5.
16. Use the Supplied 6mm Bolt to attach the Ground Wire to the Tailgate Hinge as shown in picture #2A.
17. Run the Antenna Wire along the Floor on the Passenger side up to the Front of the Jeep.

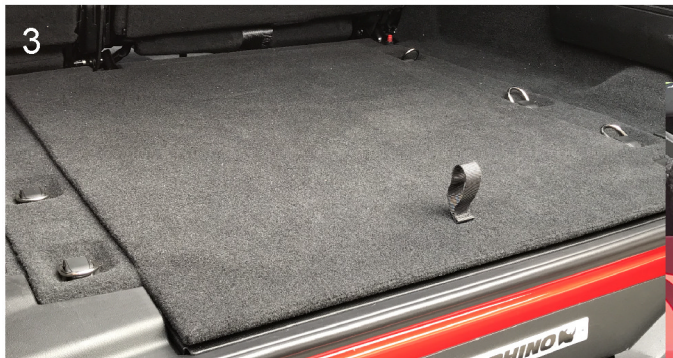
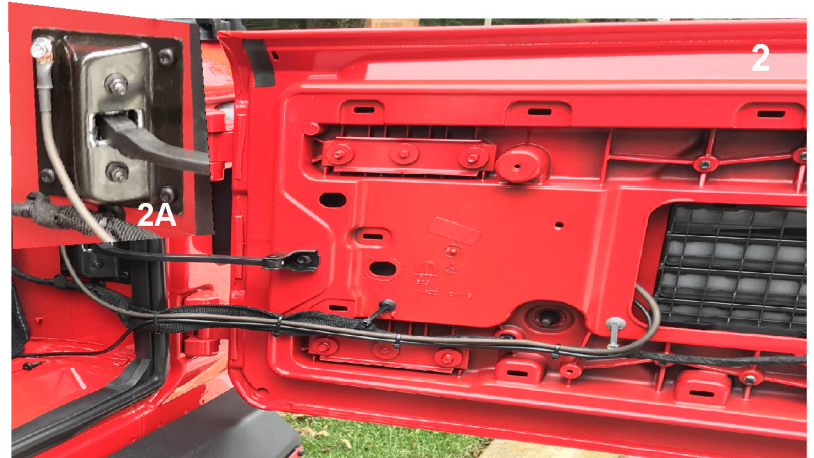



Questions or Comments ? call CFE PRODUCTS  
@ 610 358 1886 / ASK FOR BOB

- 17. Reinstall the Plastic Tailgate Panels, Fender Well Panel, Tie Down Strip and Floor Cargo Cover.
- 18. Close Tailgate and install the Antenna. Your Antenna comes Pre-Tuned to Match your Jeep.  
No further adjustments will be necessary.

*(Optional Quick Disconnects for the Antenna can be used with this Mount)*

- 19. Follow the steps below in picture #6 to install the PL-259 Connector on the Antenna Cable.
- 20. Attach the Antenna to your CB

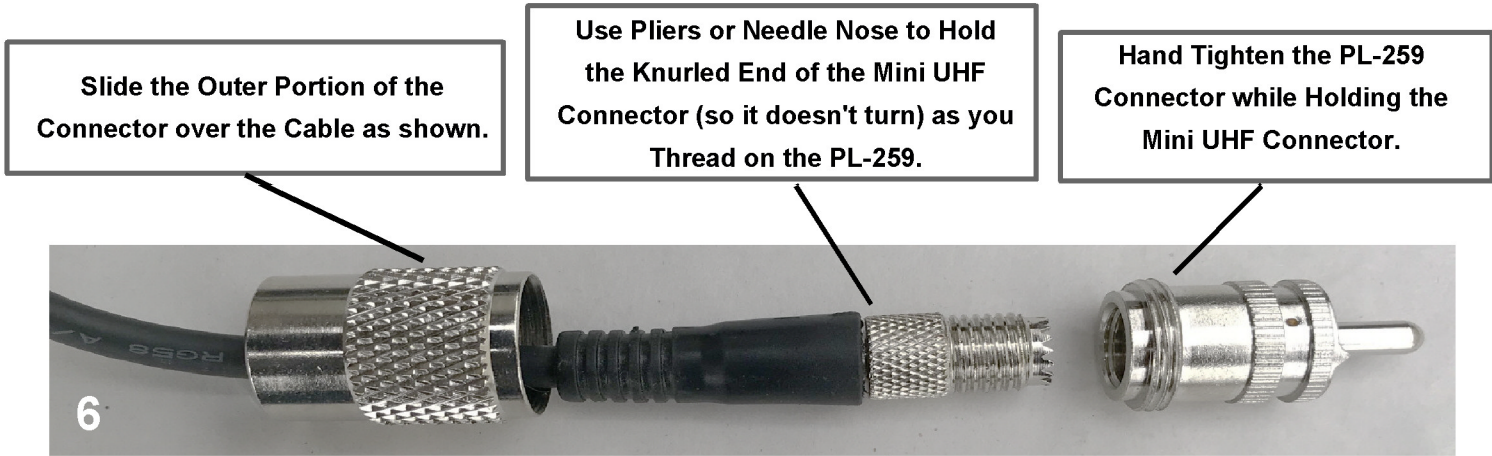

**Optional  
Antenna Quick Disconnect**



**Catalog #: 96081.005  
Quadrtec Part #: U-QD1**