



This product can expose you to chemicals including vinyl chloride and lead, which is known to the state of California to cause cancer and birth defects or other reproductive harm.

For more information go to [www.P65Warnings.ca.gov](http://www.P65Warnings.ca.gov)

**WARNING:**

**CFE PRODUCTS**

**MODEL : DKSD2 - MAESTRO JK**

**SONY RADIO INSTALL KIT**

**2007 to 2018 JK**

with or without STEERING WHEEL CONTROL  
or FACTORY SUB

- PARTS INCLUDED**  
 MAESTRO MODULE  
 PLUG & PLAY HARNESS  
 DASH ADAPTER (95-6511)  
 ANTENNA ADAPTER  
 2 BLACK CRIMP CAPS  
 48" BLUE WIRE w/ Insulated Male Spade Connector  
 Red Quick Tap

**IMPORTANT!**

**BEFORE GOING ANY FURTHER, YOU MUST GO TO QUADRATEC'S WEB SITE AND DOWNLOAD/VIEW THE MAESTRO PDF INSTUCTIONS FOR FLASHING THE MODULE. YOU MUST READ THE INSTRUCTIONS THOROUGHLY AND REFER BACK TO THIS PAGE UNTIL YOU HAVE A COMPLETE UNDERSTANDING OF THE INSTALL.**

**Special Note - While this installation kit is mostly plug & play, we strongly advise that you thoroughly read the instructions that came with your new radio before proceeding.**

*There are some wires that do not connect at this time, but may be used in the future.*

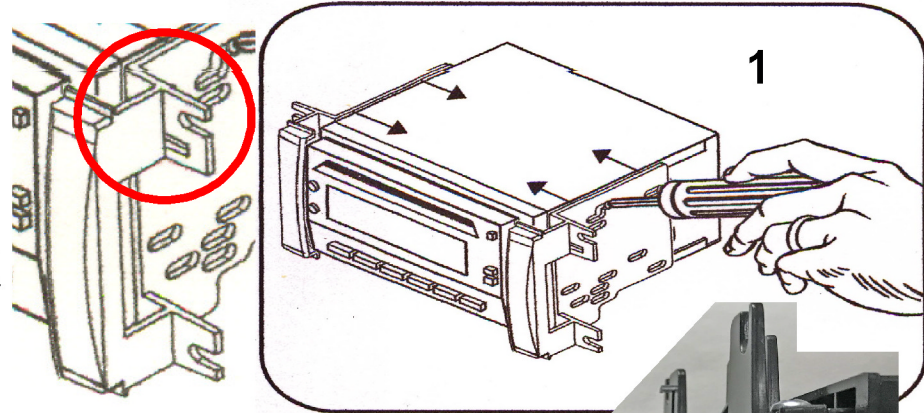

**2**

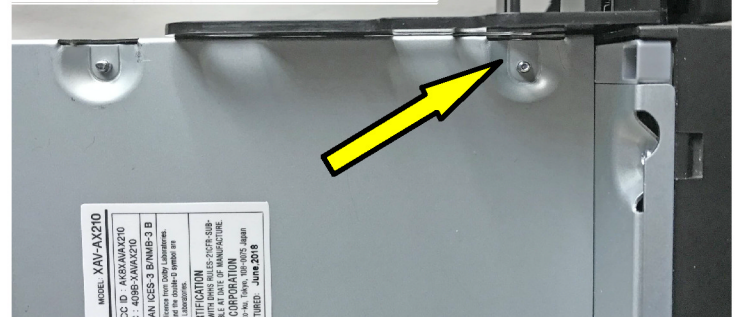

Wide Filler

Narrow Filler

1. Some Radios come with a Metal Sleeve that slides around the outside of the Radio. This will not be needed for your Jeep Installation. Remove the Sleeve. The Radio may also has a Plastic Trim Ring which snaps on the front. This will not be used for your Installation. Unsnap the Trim Ring and remove.

Take note the dash adapter comes with WIDE filler strips and NARROW filler strips. You will be using the narrow fillers as shown in picture # 3 { refer to dash adapter instructions if needed }

2. Attach the Double DIN Brackets/Trim Plates to the side of the Radio using the Screws supplied with the Radio as shown in picture #1. There is a Left and Right Side Bracket. The Mounting Ear with 2 Slots will be positioned at the Top as shown in the Red Circle in picture #1. If you have installed the right filler strips, the dash adapters will mount flush with the side of the radio as shown in picture # 2 Adjust the Brackets so that they are flush with the Radio in the front and tighten Screws.

3. Install the Hands Free Microphone (see instructions included with the Radio for recommended placement) Run wires behind Dash to the Radio Opening. ( One possible location is on the plastic cover around the Steering Column.)

4. Plug Antenna Adaptor into the New Radio location shown in picture # 4.

5. The other end of the Antenna Adaptor plugs into the Jeep Antenna Harness as shown in picture #5. ( This step won't be completed until you are ready to slide the Radio into the Dash.)

6. The Blue Butt Connector is a Remote Turn On Lead and will only be used if you are adding an Aftermarket Sub Woofer. system.

**IMPORTANT !**

**BEFORE GOING ANY FURTHER, YOU MUST GO TO QUADRATEC'S WEB SITE AND DOWNLOAD/VIEW THE MAESTRO PDF INSTUCTIONS FOR FLASHING THE MODULE. YOU MUST READ THE INSTRUCTIONS THOROUGHLY AND REFER BACK TO THIS PAGE UNTIL YOU HAVE A COMPLETE UNDERSTANDING OF THE INSTALL.**

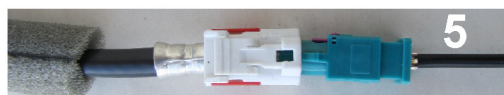
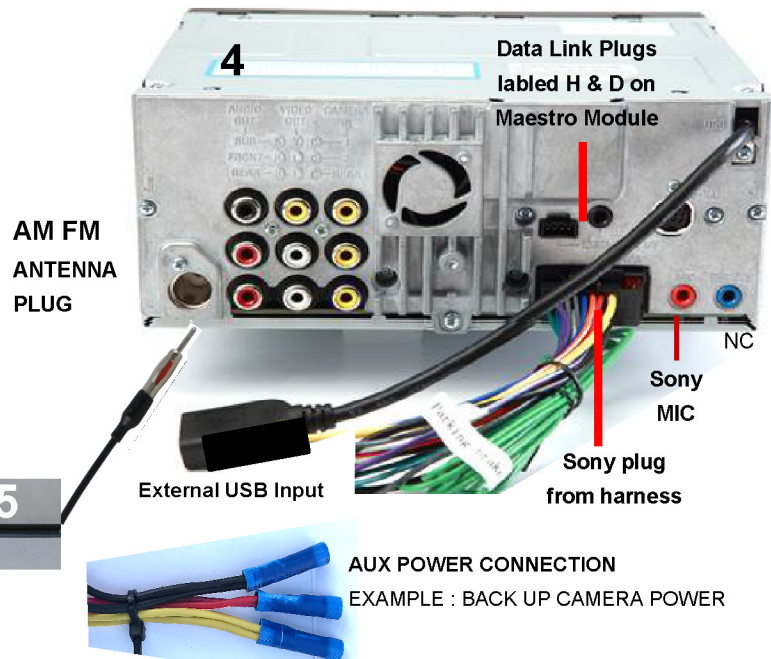

**5**

#### Radio Installation

1. Carefully Lift up Dash Trim Cover using a small flat edge tool. (Do not pull away from the Dash. A wire will stay connected under the Cover) Lift up the back of the Dash Trim as shown in picture #1. Pull forward and rest the Cover as shown in picture #2.
2. Remove the Upper Two Screws on the Dash Panel as shown in picture #3.
3. Using a flat edge tool, remove the Lower Trim Panel as shown in picture #4.
4. Remove the two Lower Screws on the Dash Panel as shown in picture #5.



# CFE PRODUCTS

## ALL MODELS

### 2007 to 2010 JK WRANGLER

#### Radio Installation Continued

5. Starting at the top and working your way down, pull the Dash Panel forward releasing the clips that hold it in place. ( The Panel will not be removed and the wires will not be disconnected) as shown in picture #6. Pull the Panel back far enough to remove the Factory Radio.
6. Using a 7mm socket remove the 4 screws and slide the Factory Radio out as shown in picture #7.
7. Remove the Factory Antenna Connector(s). You will only have the Yellow Connector if you have Factory Satellite Radio. Squeeze the side of the plug to release the Plug and remove as shown in picture #8. Repeat the same procedure for the White Plug ( am/fm antenna).
8. Remove the Gray Factory Radio Plug by Squeezing the bottom to release the Plug as shown in picture #9.



## Radio Installation Continued

9. Rest the New Radio/Dash Kit on the heater vents between the Dash and the Dash Trim Panel.

10. Plug the Gray 22 Pin Connector to the Jeeps corresponding Wiring Harness as shown in picture #10.

11. Tuck the Digital Adaptor Box into the Left Corner of the Dash cavity as shown in picture #11. This will allow room for the New Radio to slide into the Dash.

12. Slide New Radio into the Dash making sure that all Antenna Cables are accessible on top of the Radio as shown in picture #12. Partially install one of the screws to hold Radio in place

13. Connect the White Antenna Plug into the Black Antenna Cable coming from the New Radio as shown in picture #13. If you also have a Yellow Connector it will not be used.

14. Carefully tuck the Antenna Wires back into the Dash as shown in picture #14.

15. Before going any further, test the New Radio.

A. Install Radio Faceplate.

B. Turn on ignition key and verify that the Radio lights up.

C. Turn Radio on and tune in a station.

D. Adjust the volume up and down and check Radio for proper operation.

16. Install the remaining 3 screws for the Radio and reinstall the Dash.

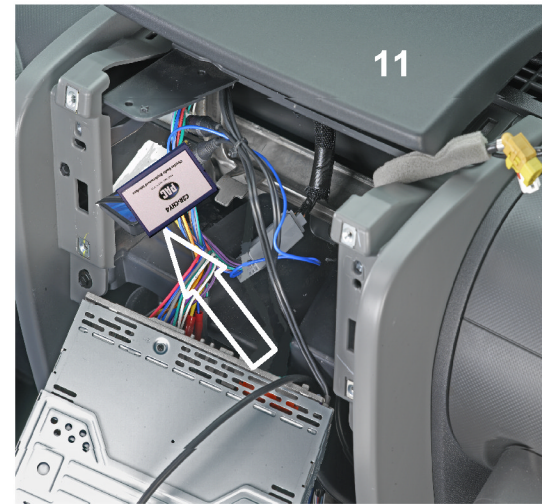
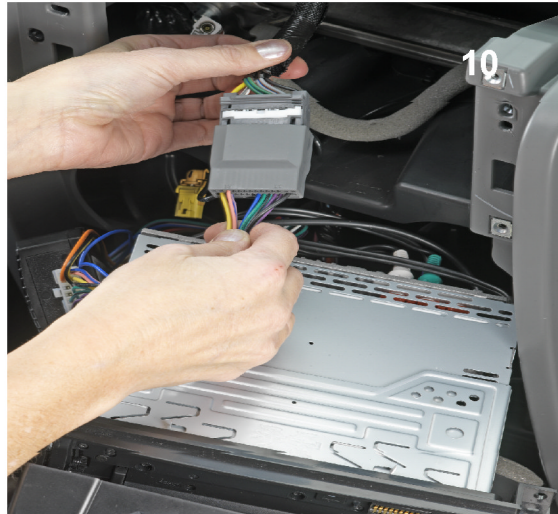

**WARNING :** This product can expose you to chemicals including vinyl chloride and lead, which is known to the state of California to cause cancer and birth defects or other reproductive harm.

For more information go to [www.P65Warnings.ca.gov](http://www.P65Warnings.ca.gov)