



CFE PRODUCTS

MODELS : DKSD2 - B , W , 11B & 11W

SONY RADIO INSTALL KIT

with or without STEERING WHEEL CONTROL

PARTS INCLUDED

P 1

Rev 2017

- DKSD2 PLUG & PLAY HARNESS
- DOUBLE DIN DASH ADAPTER (modified)
- ANTENNA ADAPTER
- black crimp cap

Special Note - While this installation kit is mostly plug & play, we strongly advise that you thoroughly read the instructions that came with your new radio before proceeding.

There are some wires that do not connect at this time, but may be used in the future.

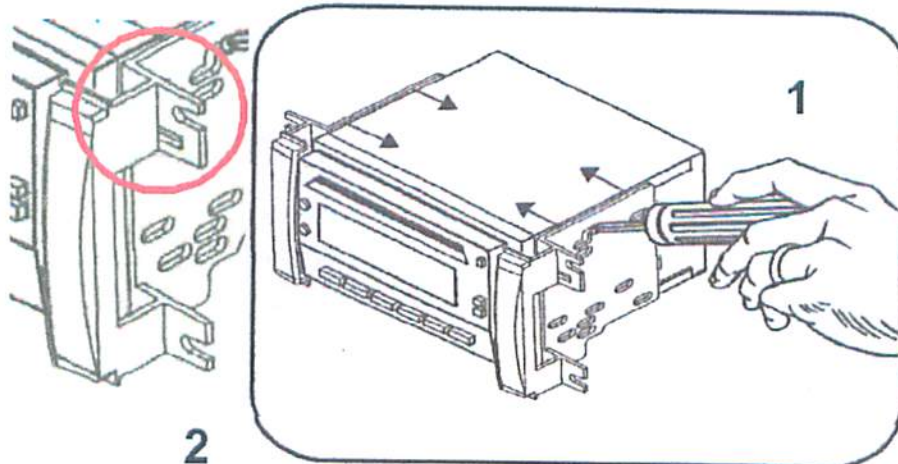

2

1

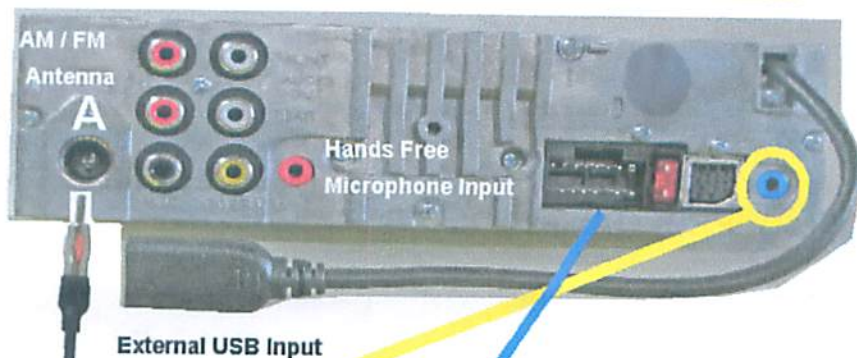

External USB Input

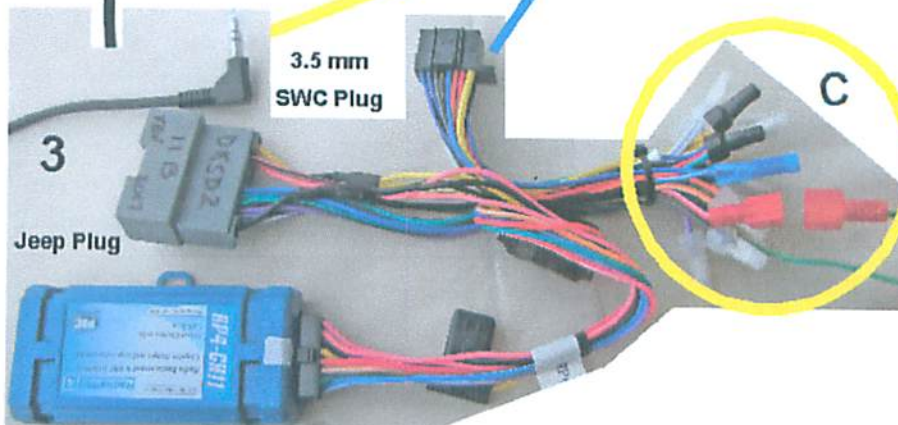

3

C



4

1. Some Radios come with a Metal Sleeve that slides around the outside of the Radio. This will not be needed for your Jeep Installation. Remove the Sleeve. The Radio may also have a Plastic Trim Ring which snaps on the front. This will not be used for your Installation. Unsnap the Trim Ring and remove.

2. Attach the Double DIN Brackets/Trim Plates to the side of the Radio using the Screws supplied with the Radio as shown in picture #1. There is a Left and Right Side Bracket. The Mounting Ear with 2 Slots will be positioned at the Top as shown in the Red Circle in picture #1. Adjust the Brackets so that they are flush with the Radio in the front and tighten Screws.

3. Install the Hands Free Microphone (see instructions included with the Radio for recommended placement) Run wires behind Dash to the Radio Opening. (One possible location is on the plastic cover around the Steering Column.)

4. Plug Antenna Adaptor into the New Radio location shown in picture # 2 A.

5. The other end of the Antenna Adaptor plugs into the Jeep Antenna Harness as shown in picture #4. (This step won't be completed until you are ready to slide the Radio into the Dash.)

6. If you are installing a Sony Radio with Steering Wheel Controls, plug the 3.5 mm SWC Connector into the back of the Sony Radio as shown in picture #3. Also verify that the Radio Select Switch is set on the #7 as shown in picture #5.

7. **VERY IMPORTANT!!** The Yellow Circle "C" indicates various connections you may need to make depending upon your Radio.

A. 2 Black Crimp Caps - Only if you install a Back Up Camera, the 2 Wires with Black Crimp Caps will need to be connected using the additional Black Cap included in the kit.

B. Two Red Connectors - Only if your Radio has an A/V Display similar to picture #6, these Two Connectors need to be plugged together.

C. The Blue Butt Connector is a Remote Turn On Lead and will only be used if you are adding an Aftermarket Sub Woofer. system.



6

SET RADIO SELECT SWITCH

	Alpine	Advent, BOYO, Dual, Vistar, Sony	Blaupunkt	Clarion	JVC	Kenwood	OEM	Pioneer	Valor
	1	7	8	4	2	3	6	7	5

5

ANY QUESTIONS OR COMMENTS CALL BOB 610-358-1886
CFE PRODUCTS 1485 WILMINGTON PIKE WEST CHESTER PA. 19382



WARNING Before Proceeding With The Dashboard Disassembly, Disconnect And Isolate The Negative Battery And Wait Two Minutes For The Airbag System Capacitor To Discharge. Failure To Follow These Instructions May Result In Possible Serious Or Fatal Injury.

Remove Steering Column Cover

1. Using a trim stick or a flat edge screw driver, release the upper clips as shown in picture 1. Rotate the steering column opening cover down and remove from lower tabs as shown in picture 2.



Remove 3 Air Outlets

(1 on drivers side & 2 below the radio) Each air outlet is secured by a retaining tab located on the outlet, and a stop tab located on the back of the trim panel.

1 Access the retaining tab from the inside of the air outlet, through the square openings provided.
2 Rotate the louvers of the air outlet in the instrument panel to the eleven-o'clock position (pic 3).
3 Adjust the louvers partly downward for best access.
4 Working from the inside of the air outlet, place a small screwdriver or equivalent through the square opening located at the one-o'clock position (pic 4).
5 Carefully pry the retaining tab toward the center of the air outlet and rotate the outlet counterclockwise until the tip of the screwdriver reaches the eleven-o'clock position as shown in picture 5.



6. Pull the air outlet straight out of the instrument panel as shown in picture 6.



Remove 4 Dash Screws.

1. Using a 7 mm socket remove the top screw located under the storage bin mat as shown in picture 7.
2. Unsnap the switch opening plate from below the radio. If your vehicle has power windows, unplug the wiring harness from the switch plate. Pay attention to the red locking tab on the switch plate. Use a flat head screwdriver to push it up from the bottom (pic 8).
3. Remove the plug as shown in picture 9.





4. Remove the dash screw from behind the switch plate as shown in picture 10. Remove the 2 dash screws on either side of the steering wheel as shown in picture 11.

CAUTION: Do not use tools to release the lower bezel retaining clips or damage to the bezel and reinforcement ring can occur.

Remove Dash Bezel

1. Using two hands, reach through the vent openings and firmly grasp the lower bezel. Carefully pull the bezel back to release the lower retaining clips as shown in picture 12.
2. Using two hands on either side of the dash bezel, pull the dash bezel toward you from the bottom and remove the bezel as shown in picture 13.
3. Using a 7mm socket remove the 4 screws and slide the Factory Radio out (picture not shown).
4. Remove the Factory Antenna Connector(s). You will also have a Yellow Connector if you have Factory Satellite Radio. Squeeze the side of the plug to release the Plug and remove as shown in picture #14. Repeat the same procedure for the White Plug (am/fm antenna).
5. Remove the Gray Factory Radio Plug by Squeezing the bottom to release the Plug as shown in picture #15.
6. Remove the factory radio and set aside.

Install New Radio

- 1 Reconnect the White Antenna Cable from your Jeep to the Antenna Adaptor Cable which was already installed on the New Radio as shown in #16. If you also have a Yellow Connector it will not be used.
2. Plug the Gray 22 Pin Connector to the Jeeps corresponding Wiring Harness as shown in picture #17. Carefully tuck the Digital Adaptor Box behind the New Radio (picture not shown). This will allow room for the New Radio to slide into the Dash. Slide New Radio into the Dash making sure that none of the wires are pinched.
3. Re-Install One of the Radio Screws to hold radio in place.
4. Before going any further, test the New Radio to verify that all Functions are Operating Properly including Steering Wheel Controls.
5. If the Radio operates properly, Install the remaining 3 screws for the Radio and reassemble the Dash.

