

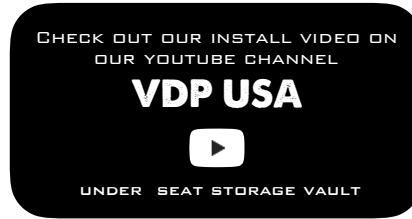

# UNDER SEAT STORAGE VAULT

JEEP WRANGLER 11-17 | 4 DOOR

## INSTALLATION INSTRUCTIONS



- RECOMMENDED TOOLS
- FLAT HEAD SCREWDRIVER
  - PLIERS
  - 18 MM SOCKET
  - TORX T-45 BIT
  - 1 1/32" WRENCH
  - ZIP TIES

### STEP 1

**A.** Attach front bracket to vault using the screws provided. Tightening the screws from underneath can be tricky so here's a helpful tip. **B.** Stick a small piece of heavy duty tape to one side of a size 11/32" wrench. **C.** Press the bolt into the tape with your finger. **D.** Place underneath to tighten the screw.

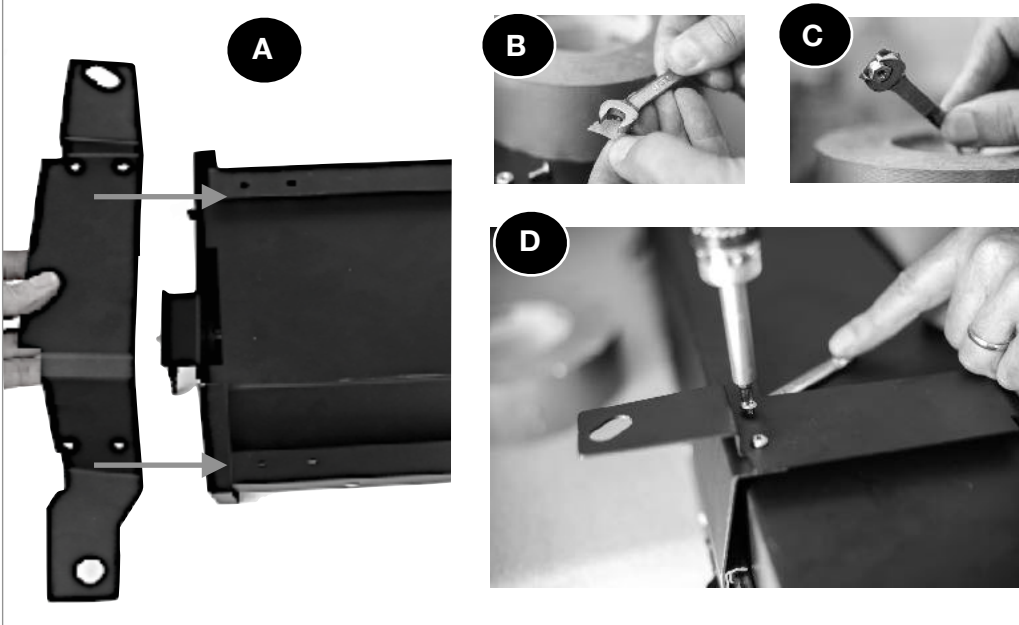

### STEP 2

Unhook the door nylon stop and wiring harness to allow door to fully open.

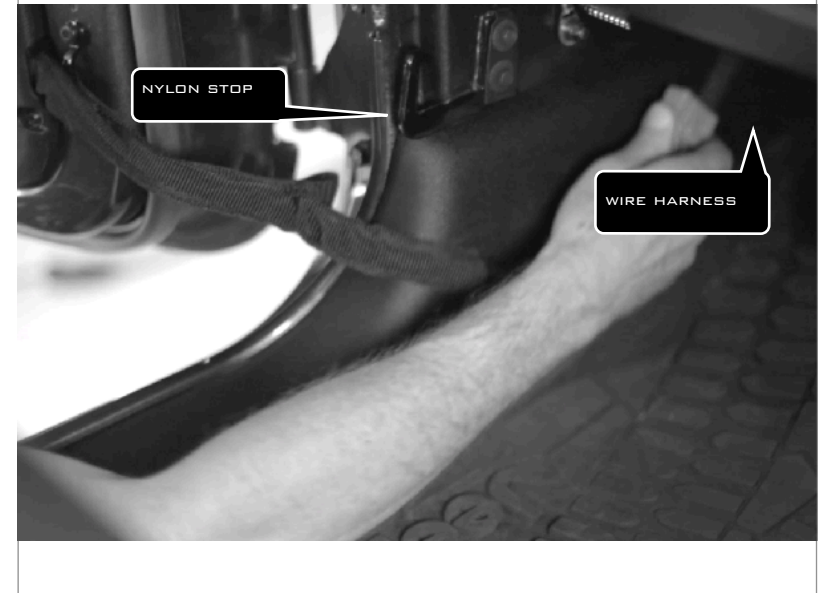

## STEP 3

Carefully unclip the wire connector(s) plastic clips from the under seat wire bracket. Depending on the vehicle, you will have 2 or 4 clips. Gently squeeze the clip together with pliers to pop it out. If they don't come out easily, try prying out with a flat head screwdriver. The clips will be reused so be careful not to break them. However, don't stress if one breaks or you can't get it out, just move onto the next step.

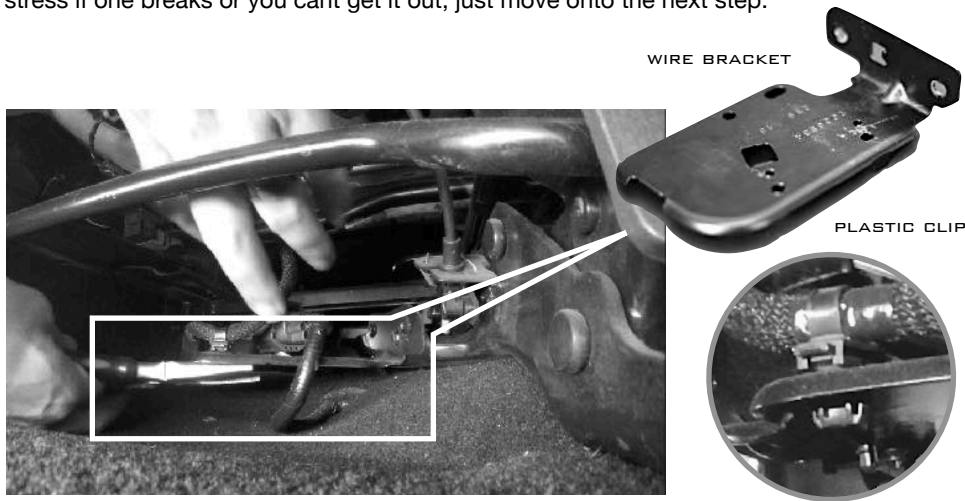

## STEP 4

Remove the wire mounting bracket with a T-30 Torx driver. **A.** There are 2 screws are located on the inner seat rail. Make sure the wires are out of the way as you remove the bracket. **B.** Allow wiring harness to rest on the floor.



## STEP 5

**A.** In a separate area gently pound out any remaining plastic clips from the bracket. **B.** Insert the plastic clips into the top of the vault. You can substitute the broken/missing plastic clips with zip ties. (Notice the mounting holes on the vault match the wire mounting bracket-for this reason the bracket will no longer be needed).

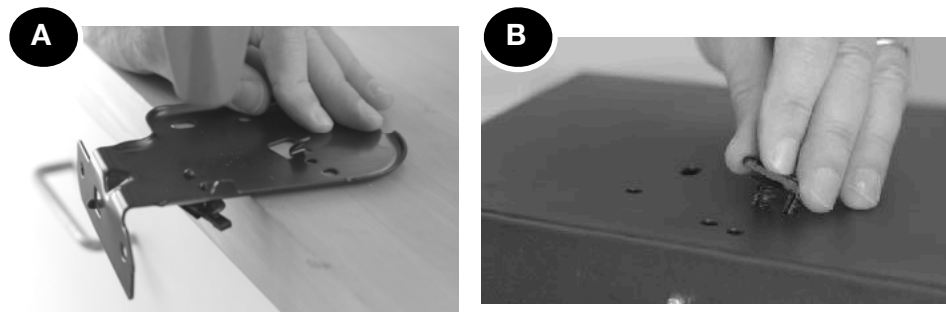

## STEP 6

Slide seat to the full rear position and with an 18mm socket wrench, remove the two front seat hold-down bolts.



## STEP 7

**A.** Place the vault on the floor in front of the seat and begin to push it back into position. **B.** Move the wire harness out of the way by placing it on top of the vault. **C.** Now check the rear seat rail hook making sure it is engaged with the left seat rail.



## STEP 8

Ensure that the outboard (left) bracket ear is under the left seat rail and the inboard (right) bracket ear is on top of the right seat rail. Align the outboard seat bolt holes and reinsert seat hold down bolt. Do not completely tighten at this point.



## STEP 9

Move seat to the full forward position. Secure the wiring harnesses to the top of the vault using the plastic clips. You can substitute zip ties for the broken or missing clips..



## STEP 10

Tighten both front seat hold-down bolts. Alternate side to side tightening the bolts until both secure.



## STEP 11

Move seat full travel and check that there is no crimping or pulling of wires. Position the seat for use and check the vault drawer operation.



## STEP 12

Reattach nylon door stop and wiring harness.



## HOW TO OPEN DRAWER

To open the vault, note the locking safety clip on the front left side of the unit. This safety feature prevents an unlocked drawer from sliding open and hitting your heels during sudden stops. The spring hook design enables you to spring open the hook with your left hand and open the drawer with your right.

