

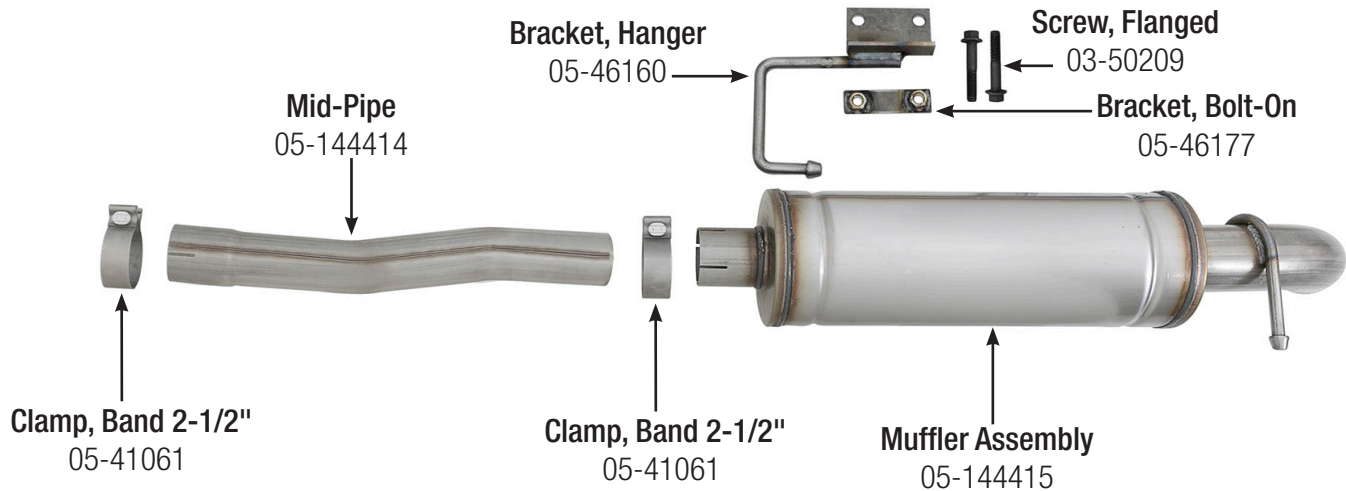

INSTALLATION INSTRUCTIONS

MAKE: Jeep
MODEL: Wrangler (JK)
YEAR: 2007-2018
ENGINE: V6-3.6L/3.8L (4DR)

**Cat-Back 2-1/2"-3"
409 Stainless Steel
49-48069**



Caution: Allow time for your vehicle to cool down prior to installation. When working on or under your vehicle proceed with caution. Exhaust systems reach high temperatures and may cause serious burns. Wear protective safety equipment; eye goggles and gloves to ensure a safe installation. **aFe recommends professional installation on our products.**

Step 1: (Read Instructions prior to installation). It may be helpful to lubricate all the factory isolation rubber mounts, before taking off stock exhaust and also before installing aFe exhaust. Always use a jack or stand for support when installing or uninstalling any exhaust system.

Step 2: Begin by removing your stock exhaust from the rear of your truck working your way forward. Remove the factory muffler assembly and mid-pipe. Take caution not to damage the factory isolation mounts as they will be reused

Step 3: For faster installation spread the pieces of the exhaust alongside of your vehicle, according to the diagram shown. It is recommended to not fully tighten any of the clamps until the entire system has been fully installed.

Step 4: Install the provided hanger bracket and OE rubber isolation mount. (See photo for reference)

Step 5: Install the front pipe onto the factory y-pipe and loosely tighten the provided 2.5" band clamp.

Step 6: Place a 2.5" band clamp over the front side of muffler assembly. Slide the muffler assembly into the front pipe and slip the hanger into rubber isolation mounts.

Step 7: Straighten all exhaust components and begin to tighten down all clamps beginning at the front and ending at the rear.

Step 8: Congratulations your exhaust is now complete.

NOTE: It is recommended to re-tighten all clamps after 50-100 miles.



NOTES:

- aFe recommends that the tailpipe be at least 1/2"-1" away from any body panels to avoid heat related body damage. **Tighten and secure.**