



THE AUTOMOTIVE LIGHTING BENCHMARK

# 2018+ JEEP JL 7" HEADLIGHT ADAPTER INSTALL GUIDE

**WARNING:** By reading this document, you agree it is only to be used as an educational guide. Morimoto Lighting nor its dealers make guarantees on any finished results, nor are they to be held responsible for any damage, misuse, or personal injuries. If you are unable to clearly understand and adapt the information below, professional installation is recommended.

## PACKAGE CONTENTS



2X 7" HOUSING ADAPTERS



2X WIRING ADAPTERS



2X HARDWARE BAGGIES

# INSTALLATION PROCESS

1. Park your Jeep on a flat surface approximately 10-15 feet from a clear wall (such as a garage door). Mark the height of the stock headlight beam pattern by marking it on the wall with masking tape. Do not move the Jeep until you are finished.
2. Start by removing the six clips along the top of the front grille. Once they are popped up, you can pull the grill forward and off the truck. There are some friction clips on the bottom that will pop out with moderate force.

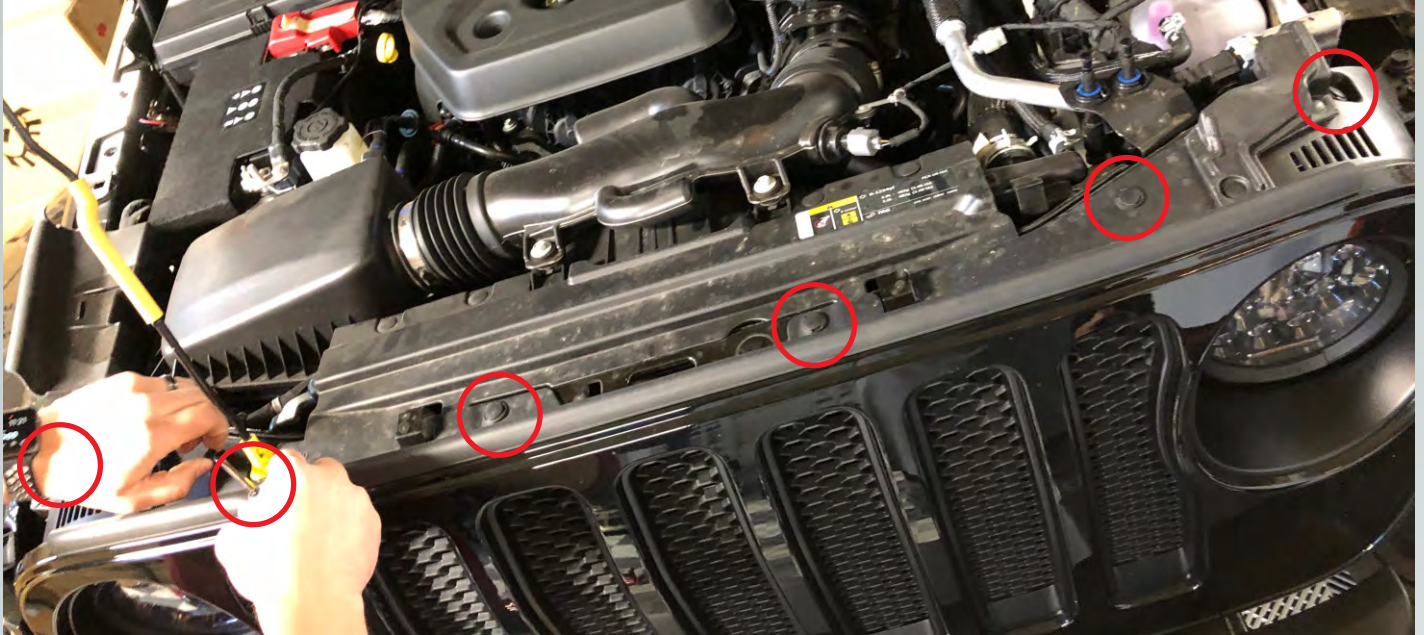



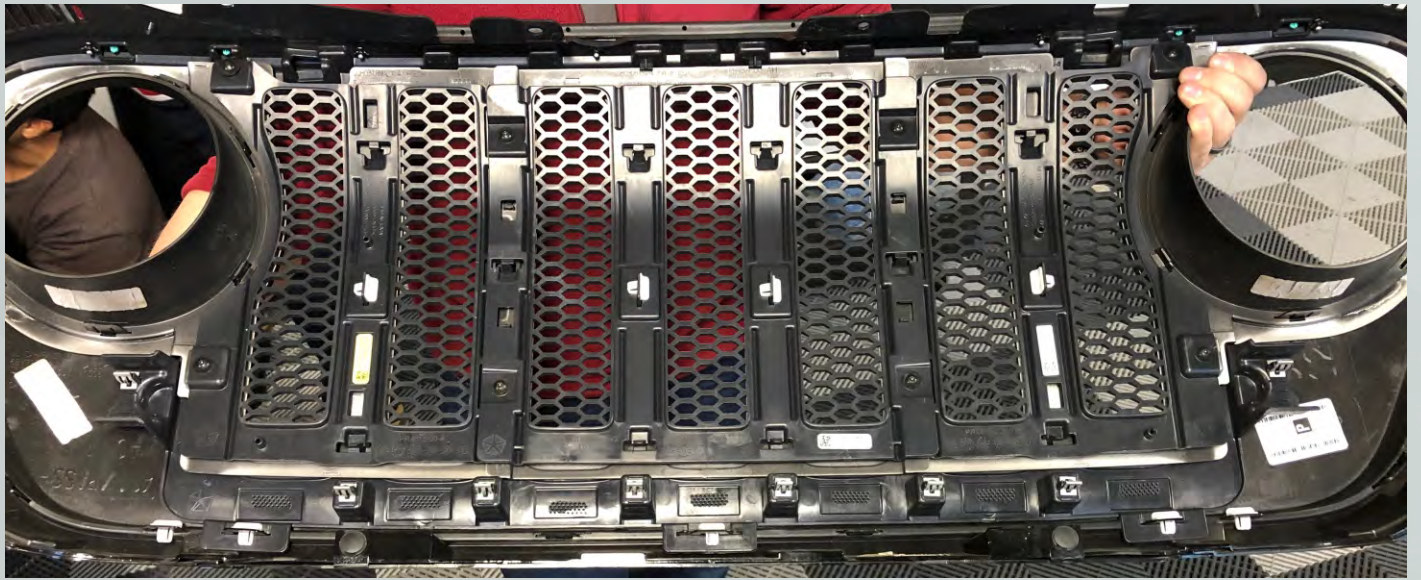

3. Remove stock headlights by undoing the 3x 10mm bolts visible on the front. Once loose, the housing can be pulled off the Jeep and unplugged with ease.





4. Identify all of the parts for each headlight per the image below.

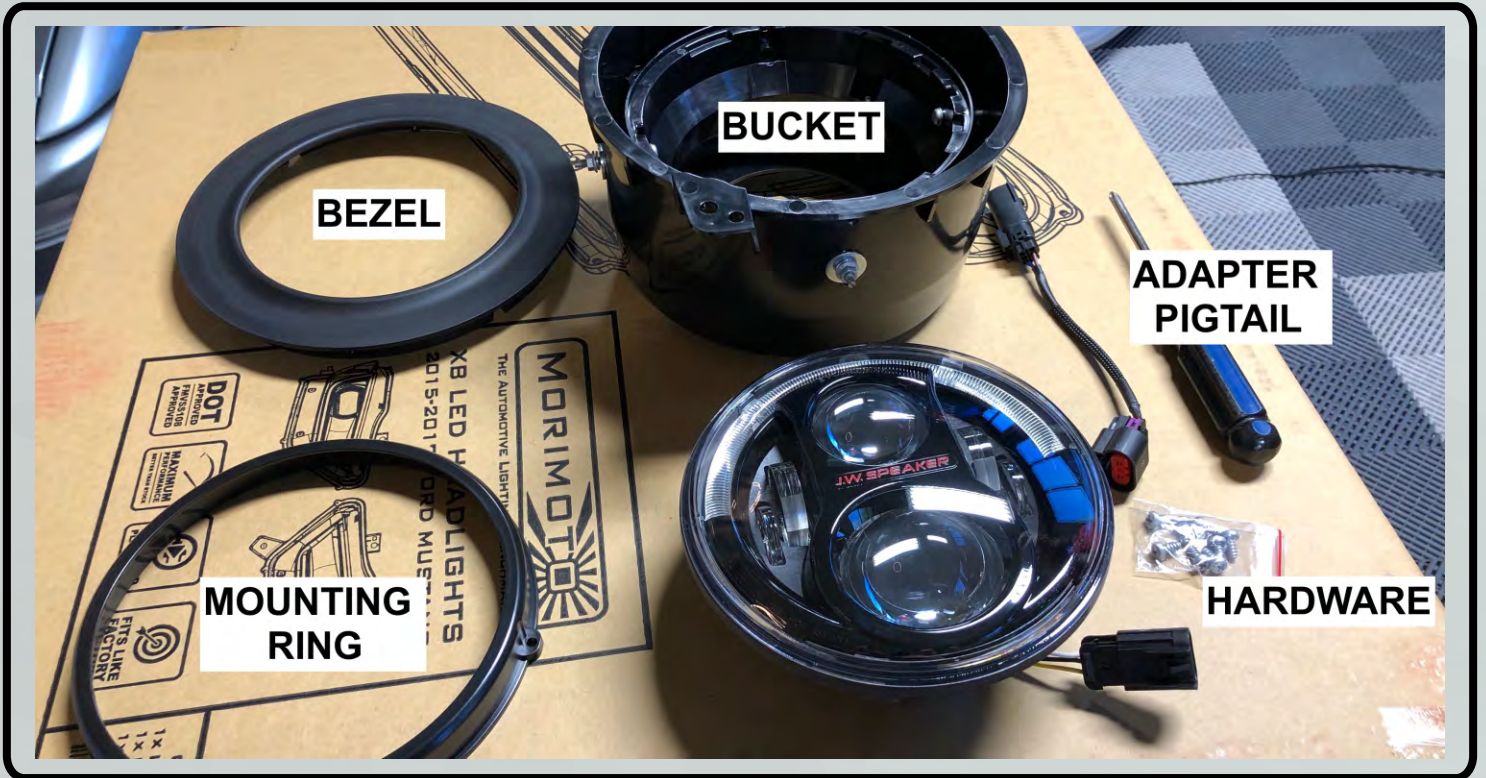

5. Place your 7" headlight into the bucket. There are three rotational alignment notches around the inside perimeter of the bucket that will correspond to three protrusions on the back of your 7" round headlight. If you position the top of the 7" light in between the top 2 mounting points on the 7" bucket, it should "drop in" to the bucket properly.





6. Install the mounting ring to affix the 7" headlight into the bucket. It is secured by 3x Philips screws from the front (use the smaller screws in the hardware bag)



7. Install the Bezel onto the bucket by first aligning the slots around the outside perimeter so that the screw holes align and then pushing it down. Secure the bezel using four Philips screws around the outside (use the bigger screws in the hardware bag).

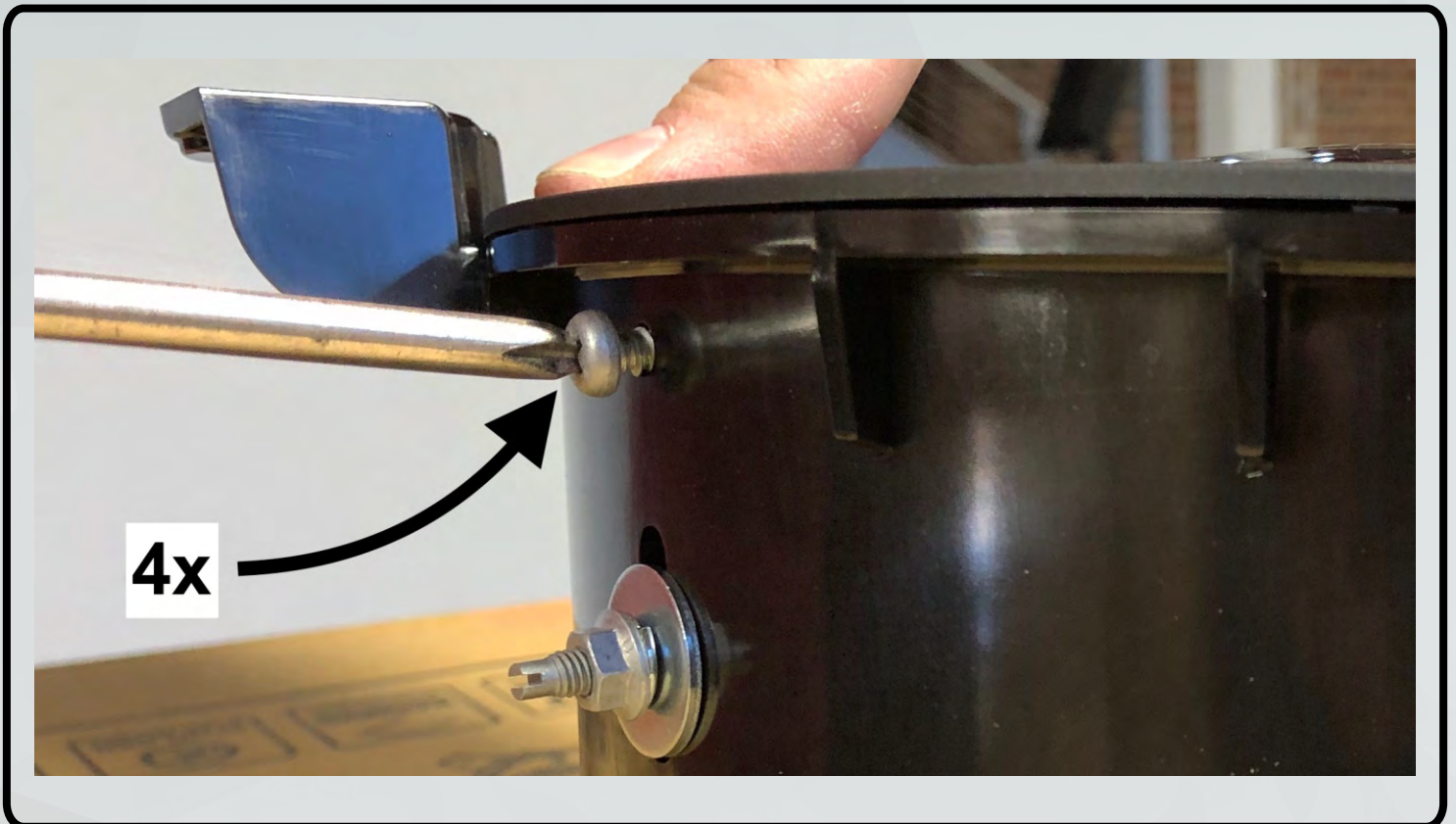



8. Plug the adapter pigtail into your 7" LED headlight, and then into the wiring coming from the Jeep. The entire housing can now be mounted on the Jeep.

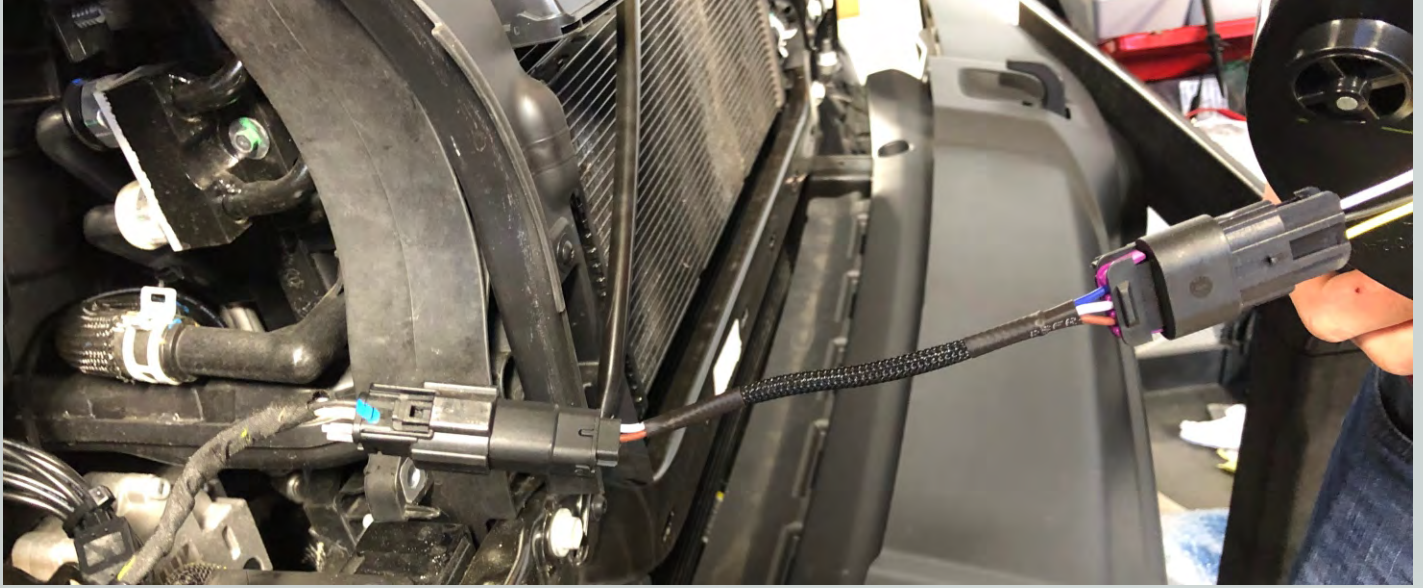

9. Re-install the 3x 10mm bolts on the front of the housing. Make sure that the alignment studs & holes are completely lined up before tightening.





10. Now that both headlights are mounted, you can aim them to the same height as the original beam pattern. The vertical adjuster is the one on the top of the housing, and it can be turned by inserting a Philips screw driver from the side, into the back of the adjuster gear, and turning.

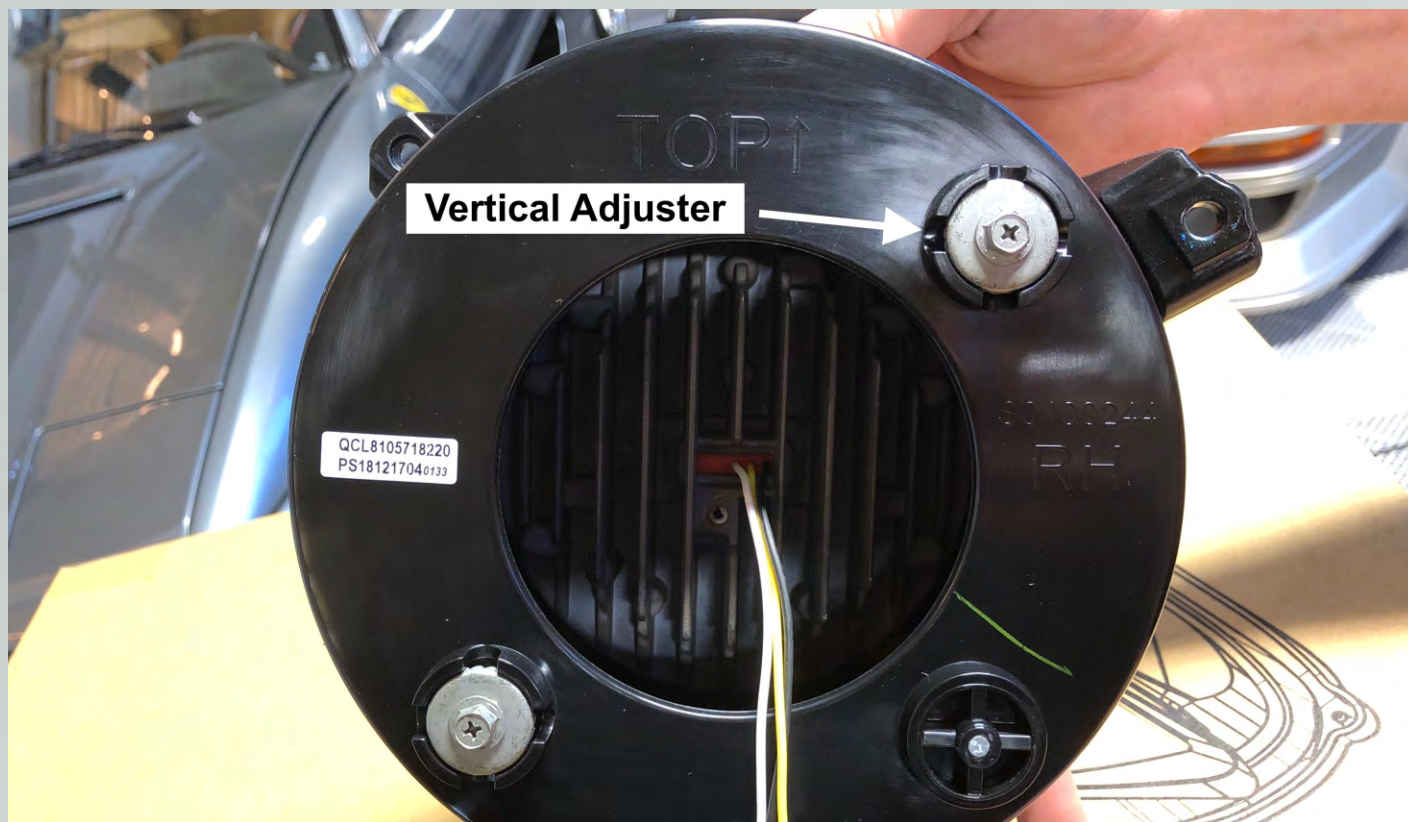





11. After fine-tuning the aim, remove the headlights once again and tighten the three bolts around the outside of the Buckets. These simply prevent the 7" headlight from vibrating/shaking, and should not be loose nor over-tightened.





12. Re-install the grille to complete your installation.



-END-