



American Made = American Jobs

IRON CROSS
AUTOMOTIVE INC.

GP-3000

Jeep Wrangler

Jeep Steps

www.ironcrossautomotive.com

Installation Instructions

Hardware	
4	Front Brackets
2	Rear Brackets
6	8mm x 25mm Bolts
24	5/16" Bolts
42	5/16" Flat Washers
42	5/16" Lock Washers
24	5/16" Nuts
6	Mounting plates

Step Installation

1) Separate the brackets in your kit, there are (4) front (**Fig 1** passenger side) and (2) rear (**Fig 2** passenger rear).

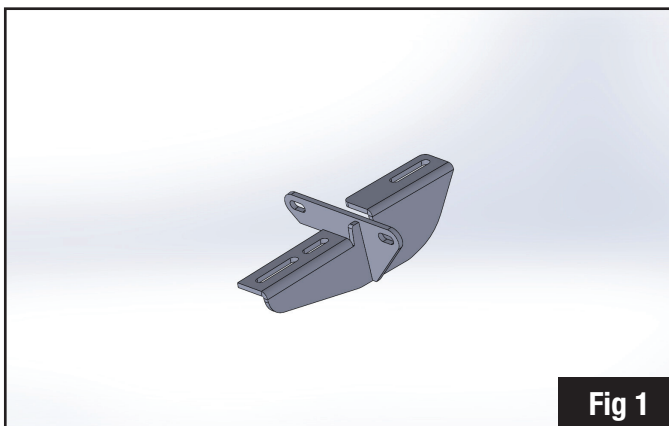

Fig 1

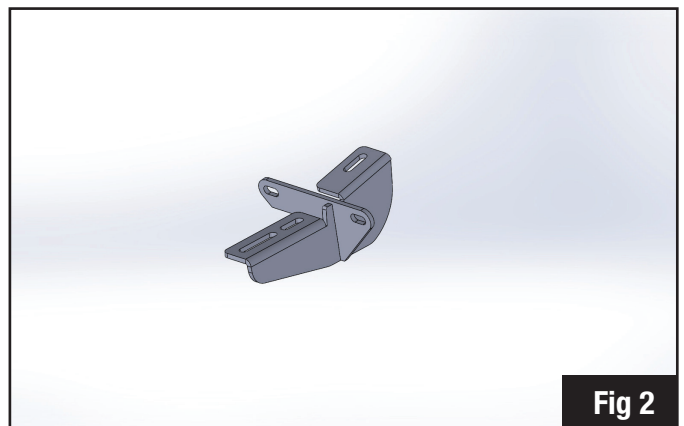

Fig 2



IRON CROSS AUTOMOTIVE
4942 E. 66th Street North,
Tulsa, OK 74117
www.ironcrossautomotive.com

Step Installation Continued...

2) Attach the brackets to the frame. Use the 8mm bolt, lock washer and flat washer to into the floorboard. The 8mm bolts will be stamped 8.8 on the head. **Fig 3.**



3) Use (2) 5/16" bolts, flat washers, lock washers, and nuts to attach the bracket to the pinch weld as shown in **Fig 4.**



4) Tighten brackets to the body at this time to 18 ft/lbs.

5) Place board on bracket and center on vehicle. Attach using the bracket clamps provided. **Fig 5a and Fig 5b.**

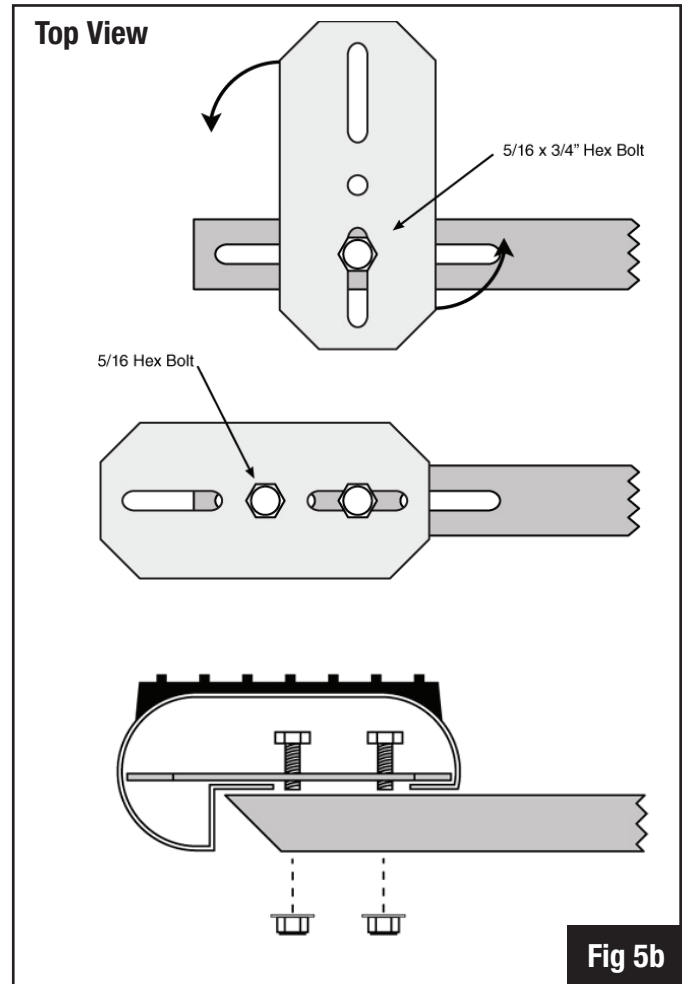
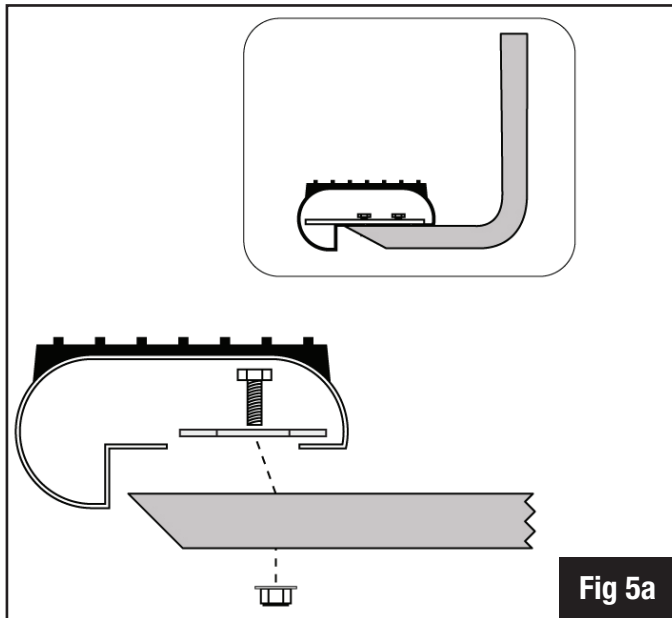

IRON CROSS AUTOMOTIVE
4942 E. 66th Street North,
Tulsa, OK 74117
www.ironcrossautomotive.com

6) Tighten bracket clamps to 18 ft/lbs.