



## Installation Instructions

**FITS:**  
07-18 Jeep Wrangler JK

**Tailgate Table**  
**Part#: 81-10105**

### TOOLS NEEDED

Ratchet	13mm Socket	Allen Wrench Set
---------	-------------	------------------

### COMPONENTS & HARDWARE

#	QTY		#	QTY	
A	1	Mounting Plate	B	1	Tailgate Table
C	2	M8x1.25x25mm Hex Head Bolt	D	2	M8x1.25 Nylon Lock Nut
E	4	M8 Flat Washers	F	6	M6x1.25 Nutserts
G	6	M6x1.25x25mm Button Head Bolt	H	6	M6 Flat Washer
I	2	Rubber Bump Stop	J	2	Spacer
K	1	M6x35mm Hex Head Bolt	L	1	M6 Flat Washer (for Nutsert Tool)
M	1	Spacer			

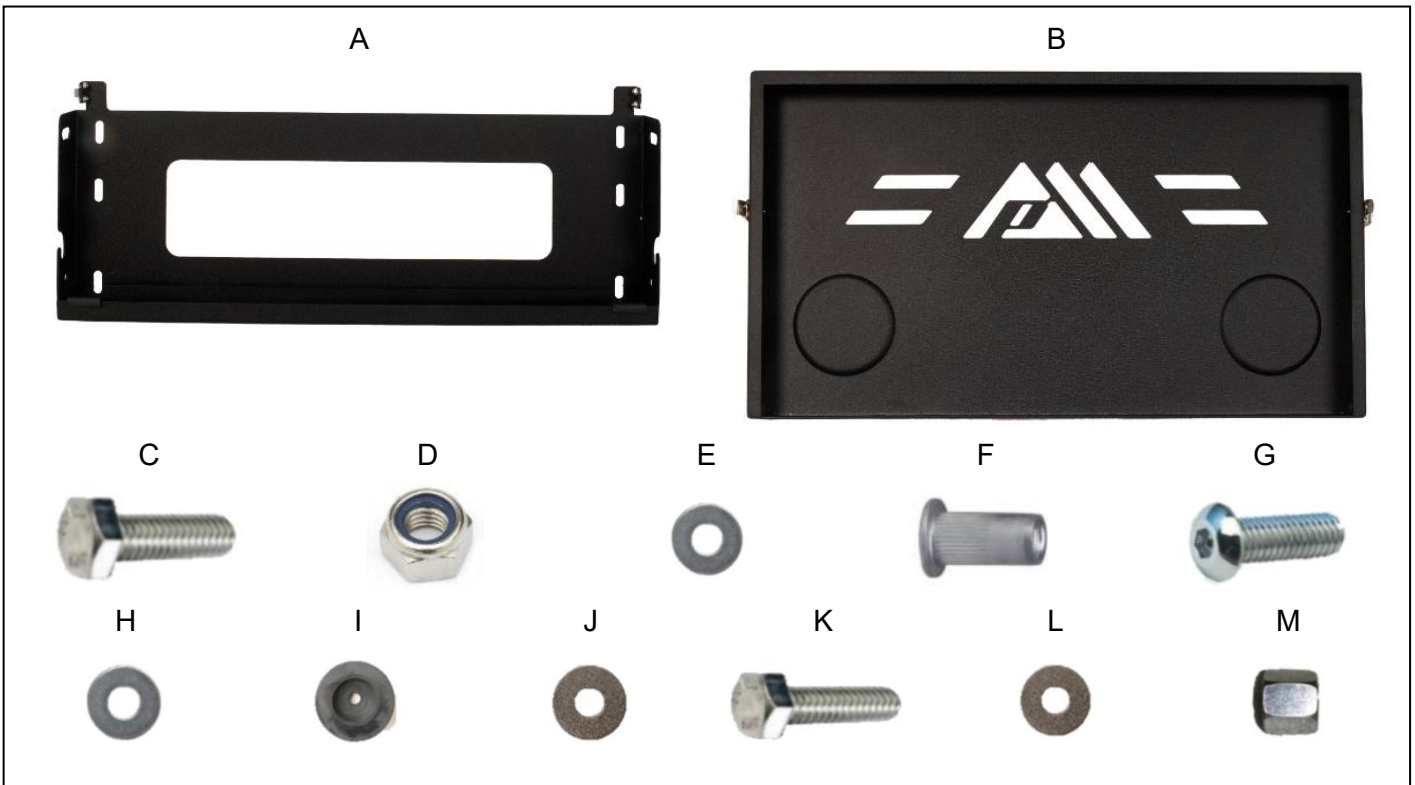

Please take a few minutes to read and thoroughly familiarize yourself with the installation procedures outlined in this manual. Following the steps as outlined will save you time and help reduce mistakes. Once the instructions are reviewed, if you feel that you are not capable of safely installing the parts seek the help of a qualified installation expert to help you complete the job. The manufacture is in no way responsible for any personal injury or vehicle damage that may occur during the installation.

#### California Proposition 65 Warning!

This product may contain one or more chemicals known to the State of California to cause cancer and birth defects or other reproductive harm. For more information go to [www.P65Warnings.ca.gov](http://www.P65Warnings.ca.gov).

## Installing Tailgate Table

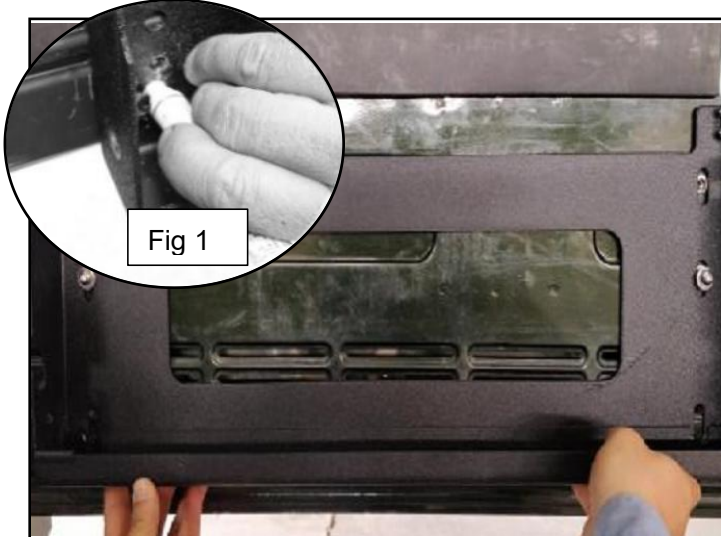

### Step 1.

Open vehicle tailgate. Place supplied mounting plate onto the jeep tailgate.

Make sure the mounting plate is centered and is clear from hitting against rear cargo mat.

Once satisfied with the fit of the mounting plate, mark the holes on the mounting plate with a white marker for drilling fig 1.



### Step 2.

Using a 11/32 " drill bit drill the previous marked holes. Repeat step for remaining marks.

## Using the Nutsert Tool

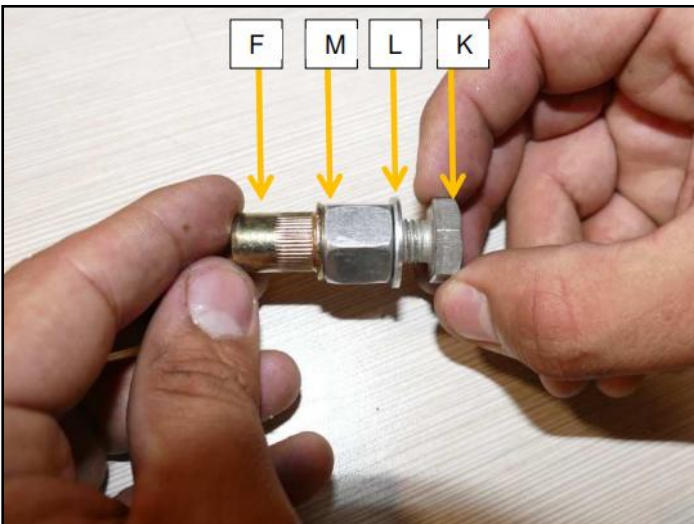

### Step 1.

Assemble nutsert tool as shown supplied M6x35 hex head bolt with supplied M6 flat washer with supplied spacer and into supplied M6 nutsert.



### Step 2.

Place supplied nutsert into the previously drilled holes.

## Using the Nutsert Tool Continued

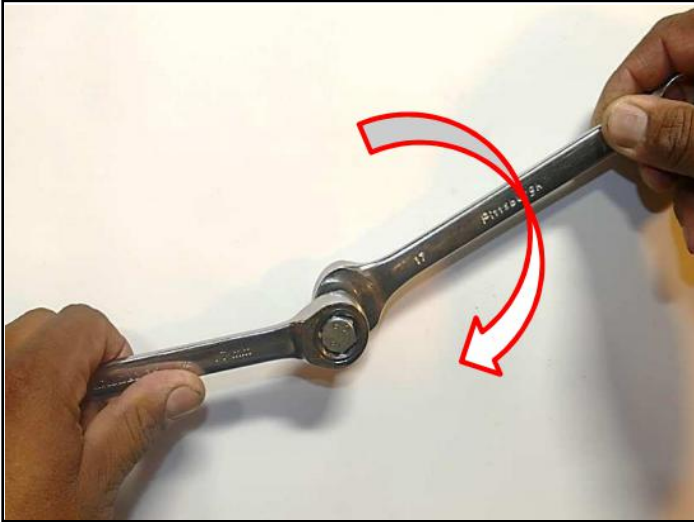

### Step 3.

Using wrenches hold the supplied bolt in place while turning the supplied spacer clockwise with a wrench. As you turn the wrench, the bolt will draw the far end of the nutsert towards the inside of the sheet metal, gripping it with the knurled outside edge of the nutsert as it deforms. Continue to turn the wrench until the nutsert is fully pressed against the sheet metal.

**Note:** DO NOT over tighten nutsert as you can damage the nutsert and cause it to lose its grip.

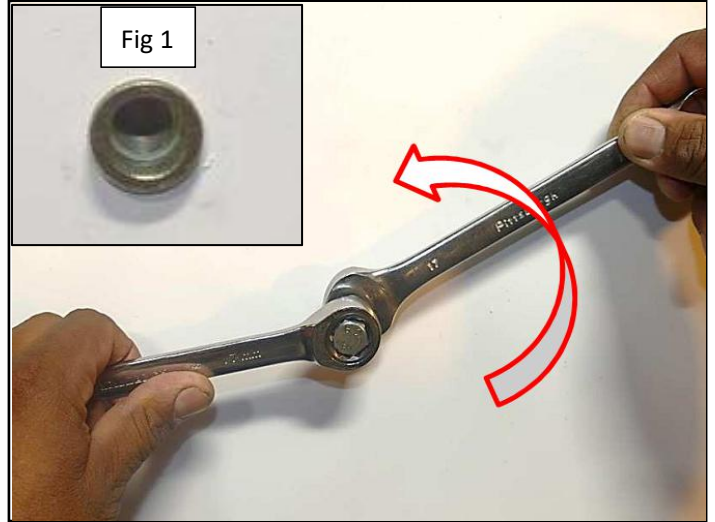

### Step 4.

Once the nutsert is installed, loosen the spacer by turning the wrench counter clock wise then remove it and the rest of the tool from the nutsert. Inspect the nutsert to make sure it is properly seated against the vehicle sheet metal fig 1. Repeat step 1-4 for remaining nutserts.

## Installing Tailgate Table Continued



### Step 3.

Place mounting plate onto the vehicle as shown. Line up the slots on the mounting plate with the previous installed nutserts.



### Step 4.

While holding the mounting plate into position, place a supplied M6x25mm button head bolt with supplied M6 flat washer through the slot on the mounting plate and onto the nutserts. Finger tighten only. Repeat step for remaining lower button head bolts as shown above.

## Installing Tailgate Table Continued

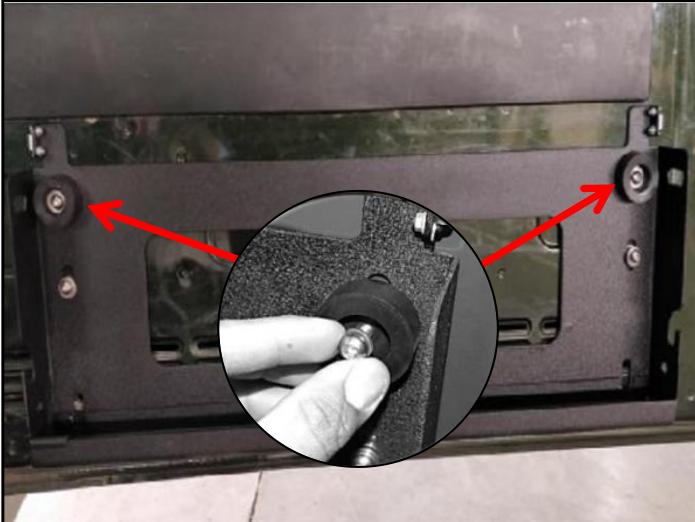

**Step 5.**  
Place a supplied M6x1.25x25mm button head bolt with supplied M6 flat washer and with supplied rubber bump stop through the top slot on the mounting plate and onto the nutserts. Repeat step for remaining button head bolt. Tighten down all bolts using a allen wrench.



**Step 6.**  
Place supplied tailgate table onto the mounting plate as shown. Line up the lower holes on the tailgate table with the holes on the lower holes in the mounting plate.

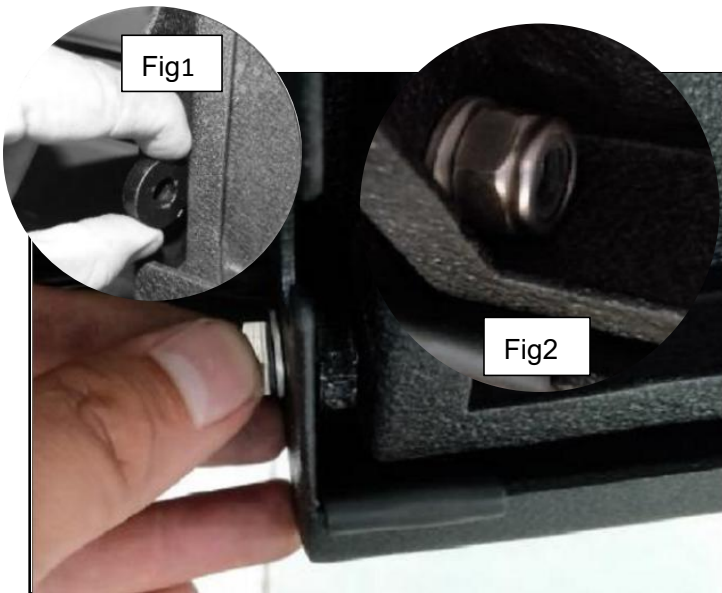

**Step 7.**  
Place a supplied M8x1.25x25mm hex head bolt with a supplied M8 flat washer through the lower hole on the mounting plate. Place a supplied spacer between the tailgate plate and tailgate table fig 1. Place the hex head bolt through the hole in the spacer and through the hole in the tailgate table. Place supplied M8 flat washer at the end of the bolt. Start a supplied M8x1.25 nylon nut at the end of the bolt. Tighten down using a 13mm socket. Repeat step for other side bolt and spacer.



**Step 8.**  
This completes the installation