



QuadraTop SkyLite Installation Instructions

Congratulations on your purchase of a high quality Quadratop product. Should you need any application or technical assistance, feel free to call us at: 1-800-701-3666

Contact your Quadratec for other quality accessories.

Please read all instructions before installation and to check to see that all parts are included.

CONTENTS:	
Description	Qty.
Quadratop SkyLite Panel	1
M8 Knob	4
Bolt cover	4

Tools Needed:

- 6mm Hex Key





IMPORTANT SAFETY INFORMATION

Your QuadratoTop SkyLite replacement top is intended to be used to increase the fair weather enjoyment of your off-road capable vehicle. Before installation, please take a minute to review the following safe-ty information and instructions.



Loss of vehicle control involves risk of death or serious injury, particularly to parts of your body not restrained within the vehicle. This product is intended for weather protection only and should not be relied upon to contain occupants in the even of an accident. To reduce the risk of injury:

- Always wear your seat belts.
- Always keep head, arms and body parts within the vehicle.
- Fully secure or stow the SkyLite before driving according to the instructions. Never try to latch or unlatch the top while the vehicle is moving. The vehicle should be parked.
- Do not use the top if damaged.
- Read and follow all instructions and warnings accompanying this product and in your vehicles owner manual.



RISK OF EYE INJURY. Safety glasses should be worn at all times while installing or maintaining this product.

QuadraTop®

Installation Instructions:

1. Remove the front section of the factory hard top.

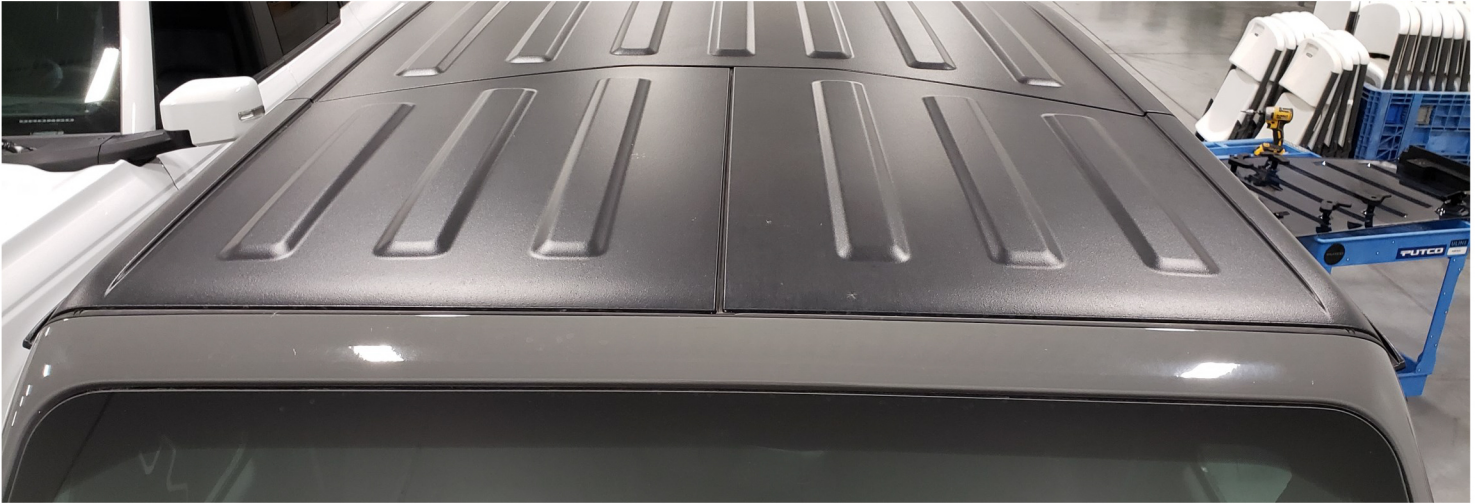

QuadraTop®

Installation Instructions Continued:

2. Place the SkyLite panel on the top of the vehicle.



Caution: Leave the RED bolt covers on while installing the SkyLite to avoid scratching paint while installing the SkyLite lid.

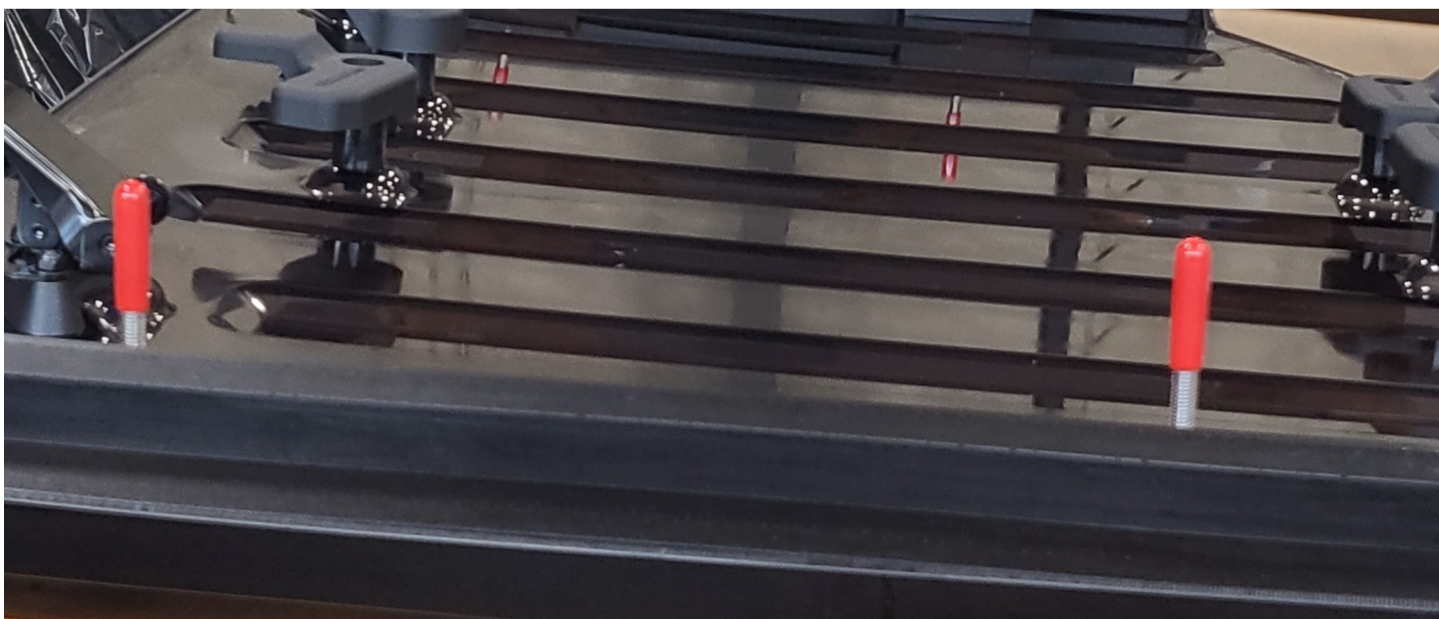

QuadraTop®

Installation Instructions Continued:

3. Slide the M8 studs through the roll bar having them protrude out the bottom hole. Once the bolts are protruding through, remove the red thread covers, and screw the M8 knobs onto the studs



4. Tighten the M8 knobs leaving a small gap between the SkyLite hardware and the roll bar on the vehicle. Do not overtighten.

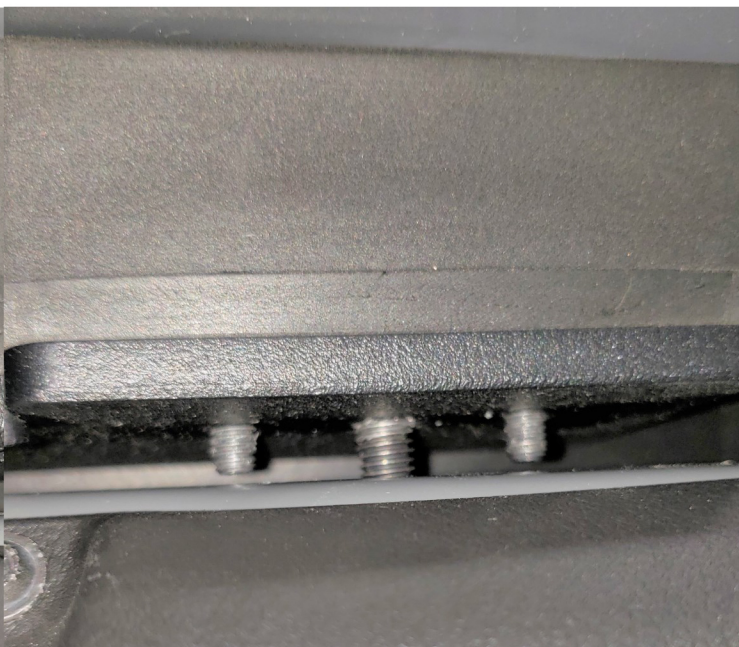

QuadraTop®

Installation Instructions Continued:

5. Close the two front clamps,. Then close the two front L-shaped clamps.

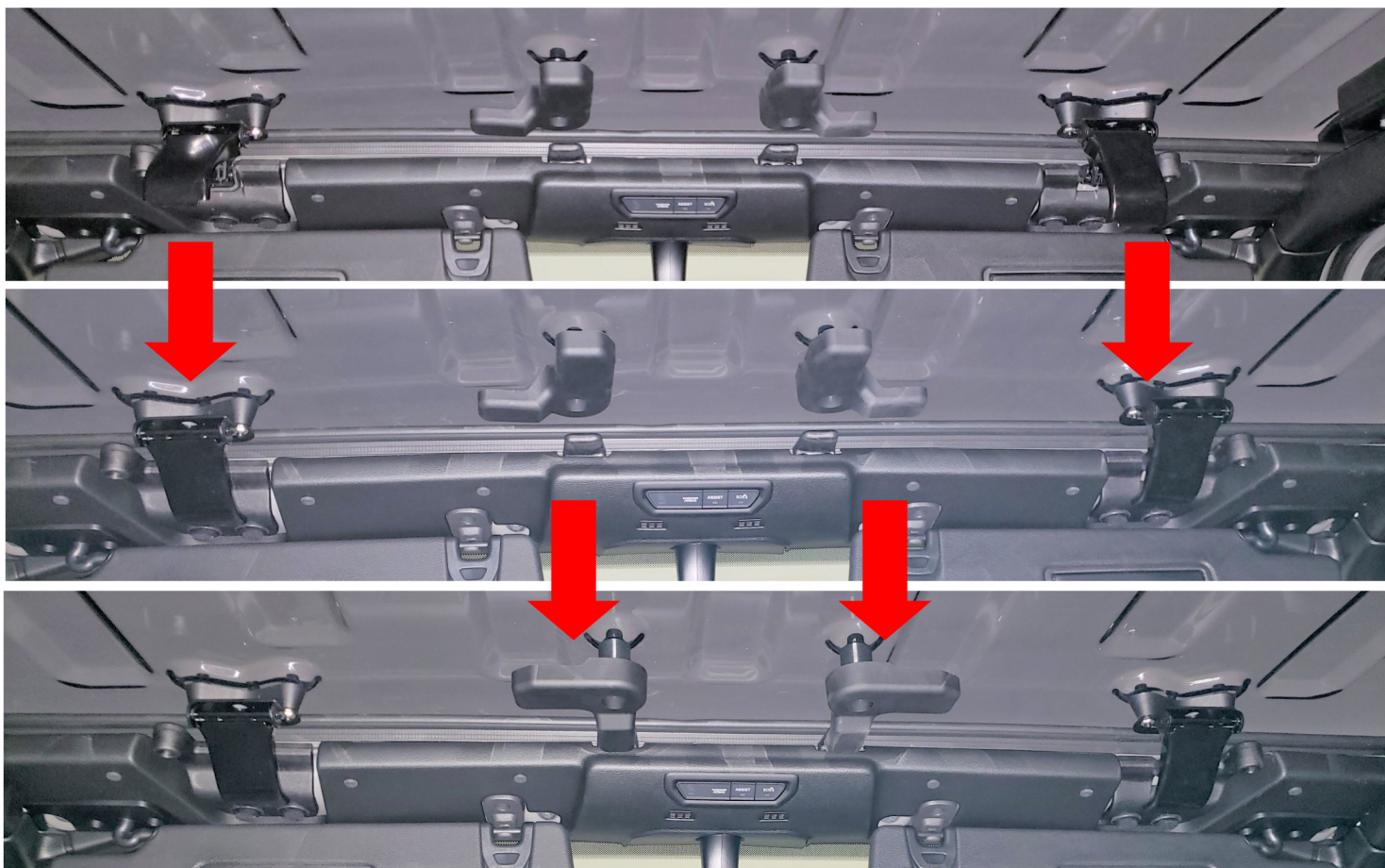

6. Close the rear two L-shaped clamps. (picture pointing to the rear clamps)



***Your new Quadratop SkyLite Panel is
now successfully installed on your
vehicle! We truly appreciate your
business and enjoy your new top!***

Quadratop SkyLite

PANEL CARE INSTRUCTIONS

- Do NOT use chemicals or abrasives on your SkyLite panel.
- Use only water and wipe GENTLY with a microfiber towel for cleaning. Applying too much pressure can scratch the SkyLite panel.
- When taking the SkyLite panel through a car wash, use only a TOUCHLESS car wash. The brushes in a regular car wash can scratch the SkyLite panel.

