



Rusty's Off-Road Products  
7161 Steele Station Road  
Rainbow City, AL 35906  
1-256-442-0607  
[www.rustysoffroad.com](http://www.rustysoffroad.com)

## Rusty's JL Wrangler Full Width Front Trail Bumper RJB9900-JL INSTALLATION INSTRUCTIONS

Last Revised: 8/3/2018

### Introduction:

Rusty's recommends that this installation be performed by a certified automotive technician or a person with professional mechanical knowledge. Installing this kit without this expertise may jeopardize the handling and safety of the vehicle.

Read instructions several times before starting. Be sure you have all the needed parts and know where they install. Read each step completely as you go. Exhaust modifications may be necessary. Prior to drilling or cutting, check behind the surface being worked on for any wires, lines, or hoses that could be damaged. After any drilling or cutting, remove burrs and grind smooth any surfaces. An inclinometer or similar tool may be needed to measure driveshaft angles before and after the installation.

### Warning:

- It is the owners' responsibility to inspect all Rusty's products for proper torque specs to prevent loosening of components.
- Seat belts and shoulder harnesses should be worn at all times.
- Re-check all bolts and nuts after the first 100 miles and after any off-road usage during the first 300 miles.
- Although all of our products are made from the highest quality materials possible, they are not a substitute for Safe and Careful driving. In other words, have good safe on-road / off-road sense. Know the terrain, the speed limitations, and any obstacles that may lie ahead. Please remember to preserve our right to enjoy public land through the proper use of off-road vehicles.

### Before Starting Installation:

1. Carefully Read all warnings and instructions completely before beginning.
2. Verify all parts have been received in this kit by checking the parts list on page#2 of this document.
3. Only install this kit on the vehicle for which it is specified.
4. Park the vehicle on a clean, dry, flat, level surface and block the tires so the vehicle cannot roll in either direction.
5. Be certain the vehicle is safely secured on jack stands or a vehicle lift prior to working around or under a vehicle. Never rely on a jack alone to support a vehicle's weight; use appropriately rated stands to support the vehicle's frame and any other heavy components.



For Questions or Suggestions, contact our Tech Department (256-442-0607)



Rusty's Off-Road Products  
7161 Steele Station Road  
Rainbow City, AL 35906  
1-256-442-0607  
[www.rustysoffroad.com](http://www.rustysoffroad.com)

### Compatible Winch Model Information

**Note:** Please read the following information carefully to ensure fitment of winch.

Please ensure that your winch is no larger than any of the listed dimensions. If larger, we can not ensure product fitment.

**Winch Dimensions:** 21.8" (555mm) Length x 6.3" (160mm) Depth x 7.6" (193mm) Height

**The following winch models have been confirmed to fit!**

- Warn VR Series
- Warn M8 Series
  - Warn 9.0RC
  - Warn XDi
  - Warn XD
- Superwinch Tiger Shark
- Superwinch LP Series
- Ramsey REP Series
- Ramsey Patriot Series
  - Smittybilt XRC
- Quadratic Q9000
- Quadratic Q9500

### Parts List:

**Note:** Please be sure that you have all the provided parts listed below before continuing with the installation.

<b><u>Part #</u></b>	<b><u>DESCRIPTION:</u></b>	<b><u>Quantity</u></b>
RJB9900-JL	Rusty's JL Wrangler Full Width Front Trail Bumper	1
67426007	7/16"-14 x 1-1/4" Length Grade 8 Hex Head Cap Screw	8
05724638	7/16" SAE Flat Washer	8
67563007	1/4"-20 x 1/2" Length Button Head Cap Screw	4
09172735	#6 x 1/4" Hex Washer Head Sheet Metal Screw	2
93881670	#8 x 1/4" Hex Washer Head Sheet Metal Screw	4



For Questions or Suggestions, contact our Tech Department (256-442-0607)



### Front Bumper Removal Process

Note: Save all factory components and hardware for reuse, unless noted.

1. Using a flat head screw driver remove the eight plastic push pins that secure the lower plastic valance/air dam from the front bumper.
2. Using a 8mm socket remove the two bolts that hold the lower plastic valance/air dam to the frame. Remove the lower plastic valance/air dam from the vehicle at this time and discard.
3. Using a flat head screw driver remove the two plastic push pins to remove the plastic filler panel located between the front bumper and the grille. Remove the plastic filler panel by carefully lifting up on each side of the filler panel to from the vehicle at this time and discard.
4. Unplug the factory fog lights by disconnecting the wiring harness from the back of each of the factory fog lights.
5. Remove the eight nuts that secure the factory front bumper to the frame with the use of a 18mm socket. (**Note:** Use caution not to damage the factory fog lights when removing the factory bumper.)
6. Remove the factory front bumper by pulling it forward and away from the vehicle and place on a soft work surface.
7. With the use of a 16mm socket, remove the factory 10mm bolts that secure the frame tie-in bracketry to the frame. These are located on the inside of the frame rails as pictured below. This only applies to the inside frame rail tie-in bracketry. Retain the bolts as they will be reused.





Rusty's Off-Road Products  
7161 Steele Station Road  
Rainbow City, AL 35906  
1-256-442-0607  
[www.rustysoffroad.com](http://www.rustysoffroad.com)

## Installation Instructions

Note: Save all factory components and hardware for reuse, unless noted.

1. Remove the factory fog lights from the factory bumper.
2. Place the supplied front bumper on a soft work surface.
3. Install the factory fog lights by aligning the fog light mounting holes with the correct bolt pattern on the fog light mount surface of the bumper.
4. Secure the fog lights using the supplied hardware for your application. To determine the correct mounting hardware refer to the diagram below. (**Note:** If you are installing an aftermarket fog light we have also provided a tab mounting point that will work with most aftermarket fog light mounting options.)

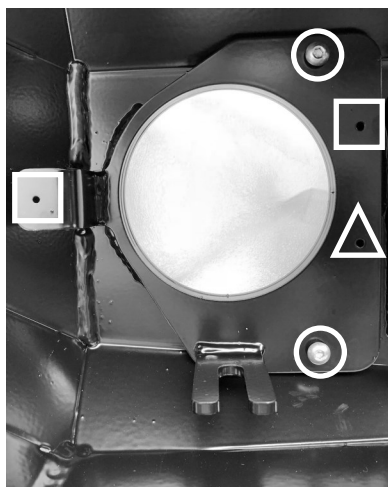

Install the correct hardware that aligns with the factory fog light mounting points.



(Qty:2 Per Side) 1/4"-20 x 1/2" Length Button Head Cap Screw



(Qty:1 Per Side) #6 x 1/4" Hex Washer Head Sheet Metal Screw



(Qty:2 Per Side) #8 x 1/4" Hex Washer Head Sheet Metal Screw

5. With the help from an assistant, install the front bumper to the vehicle by tilting the bumper forward as you are installing the bumper then rotate up to align the mounting points of the bumper with the factory bumper mounting points as shown in image 2.

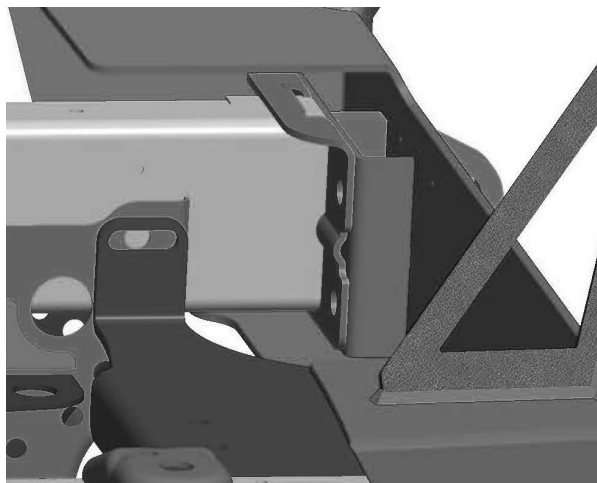
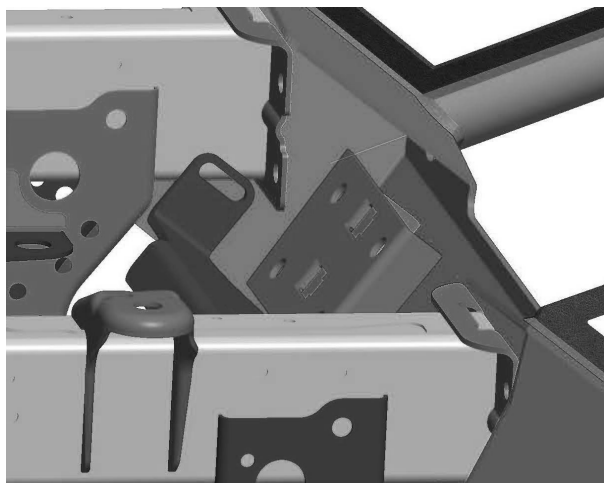

For Questions or Suggestions, contact our Tech Department (256-442-0607)

## Installation Instructions

6. Install the supplied (Qty:8) 7/16"-14 x 1-1/4" Length Grade 8 Hex Head Cap Screws and (Qty:8) 7/16" SAE Flat Washers with the use of a 5/8" wrench to secure the front bumper to the factory mounting points as shown in the image below. (Torque: 70 Ft.lbs.)

(Qty:8) 7/16"-14 x 1-1/4" Bolts  
(Qty:8) 7/16" Flat Washers

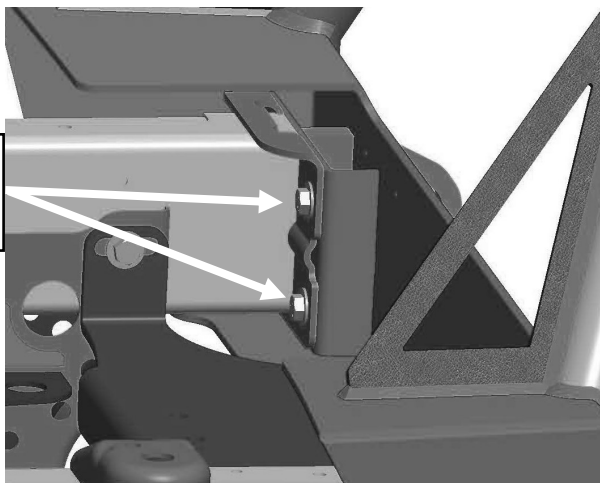

7. Using a 16mm wrench reinstall the factory hardware through the slotted hole locations on each side of the new winch mounting point to the factory mounting points on the inside of the frame rails as shown below.

(Qty:2) Factory Bolts

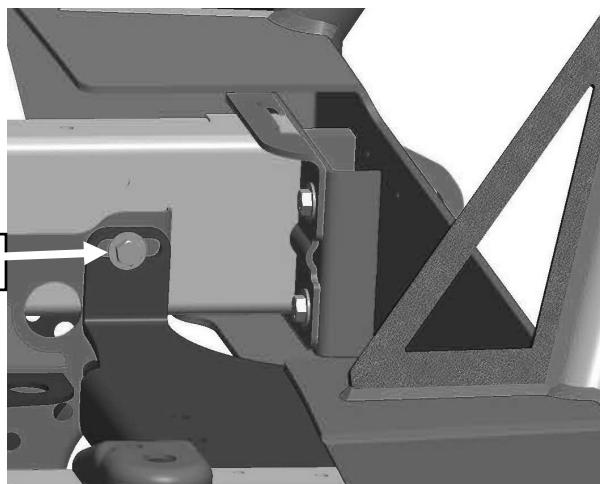

8. Reconnect the factory fog lights by connecting the wiring harness to the back of each of the factory fog lights.
9. Double check that all hardware has been tighten and reinstalled.
10. The installation of the front bumper is now complete.



Rusty's Off-Road Products  
7161 Steele Station Road  
Rainbow City, AL 35906  
1-256-442-0607  
[www.rustysoffroad.com](http://www.rustysoffroad.com)

## Installation Instructions

### WARNING

It is the owners' responsibility to inspect all Rusty's products for proper torque specs to prevent loosening of components. Seat belts and shoulder harnesses should be worn at all times. Re-check all bolts and nuts after the first 300 miles and after any off-road usage during the first 300 miles. Although all of our products are made from the highest quality materials possible, they are not a substitute for Safe and Careful driving. In other words, have good safe on-road / off-road sense. Know the terrain, the speed limitations, and any obstacles that may lie ahead. Please remember to preserve our right to enjoy public land through the proper use of



For Questions or Suggestions, contact our Tech Department (256-442-0607)