

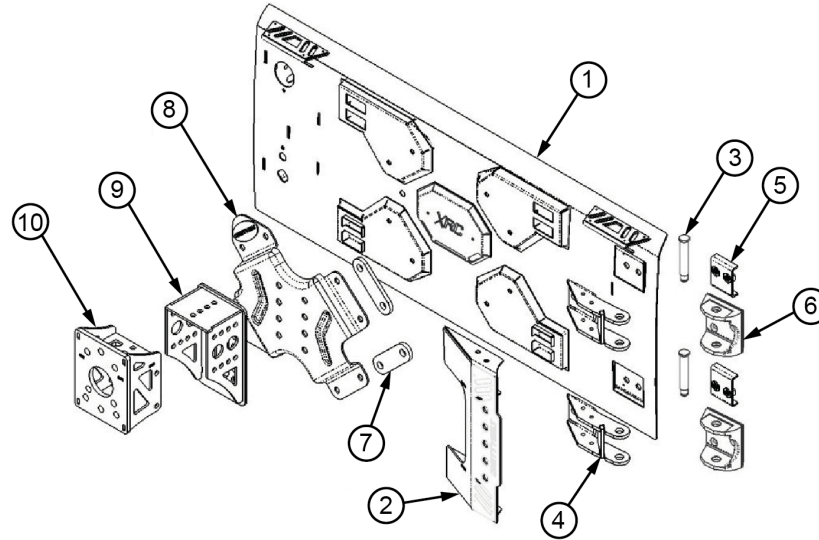

Installation Instructions:

(Part # SB76410)
2007-2018 Jeep JK Tailgate

NOTE: Carefully read entire instructions thoroughly before attempting to install this part.



Parts Included	Qty.	ID
93-112TU201 Tailgate	1	1
93-112TU204 Hinge Cover	1	2
35-112TU206 Hinge Pin	2	3
93-112TU208 Tailgate Hinge	2	4
93-112TU209 Nut Plate	2	5
93-112TU211 HD Tire Gate Hinge	2	6
93-112TU216 Spacer	2	7
93-356CA100 HD Tire Carrier Mount	1	8
93-9183 Stationary Bracket	1	9
93-9187 Adjustable Bracket	1	10
93-315TU001 Brake Light Mount	1	
90-76410-0 Brake Light	1	
90-76410-1 Hardware Pack	1	
M5x.80x30 button head screw	2	
5mm Flat washer	2	
90-76410-2 Hardware pack	1	
M4x.70x10 button head screw	18	
4mm Split ring lock washer	18	
4mm Flat washer	18	
90-76410-3 Hardware Pack Exterior covers	1	
M6x16mm button head socket cap screw	8	
M6 Flat washer	8	
90-76410-4 Hardware Pack Latch	1	
M6x16mm Flat head socket cap screw	3	

Parts Included	Qty.	ID
90-76410-5 Hardware Pack Tire carrier	1	
M8x25 Hex bolt GR 8.8	8	
M8 Flat washer	8	
90-76410-6 Hardware Pack Hinge	1	
Snap rings	2	
90-76410-7 Hardware Pack Hinge bracket	1	
M12x25 Hex bolt GR 8.8	4	
90-76410-8 Hardware Pack Carrier bracket	1	
M12x25 Hex bolt GR 10.9	4	
M12 Flat washer	8	
M12 Nylock nut	4	
90-76410-9 Hardware Pack Tire carrier	1	
M10x25 Hex bolt GR 10.9	5	
M10 Flat washer	10	
M10 Nylock nut	5	
90-76410-10 Hardware Pack Wheel studs	1	
1/2x20 Serrated lug studs	3	
1/2x20 Extended length lug studs	3	
90-76410-11 Hardware pack	1	
16mm Flat washer	2	
90-76410-12 Hardware pack	1	
Rubber gasket	5	
24mm push in panel plug	1	
401TU050B	1	

Tool Required:

Torque wrench's (in-lbs. & ft-lbs.)	Pliers	Screwdrivers, flat and Philips head	Torx bit set (S/B2830 or similar)
Auto trim tool set/Plastic prybars	Metric Allen bit set	Metric socket & wrench set	Stud press

For Technical Support/Warranty Information please call 310-762-9944

Smittybilt, 400 W. Artesia, Compton, CA 90220



Installation Instructions:

(Part # SB76410)
2007-2018 Jeep JK Tailgate

INSTALLATION:

Check all four wheels and make sure parking brake is engaged before starting this installation procedure.

Step 1 : Remove the spare tire from OE tire carrier (**Fig. 1**). Consult your owner's manual if needed.

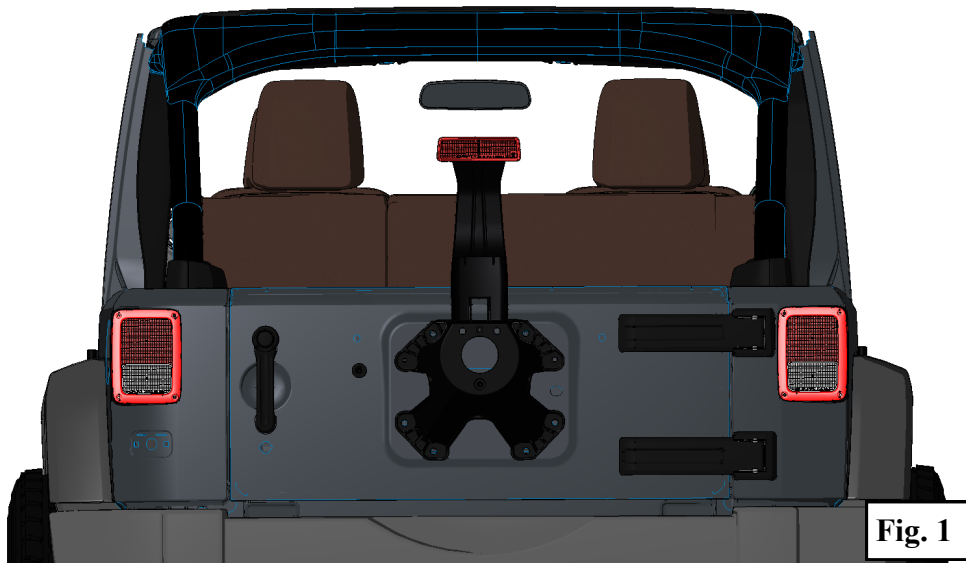

Step 2 : Open the tailgate, using a trim tool or plastic prybar. Pry outwards along the underside of the **Wiring cover** and the inside edge of the **Latch cover** to release the retaining clips. Be careful not damage the locating tabs on the opposing side (**Fig. 2**).

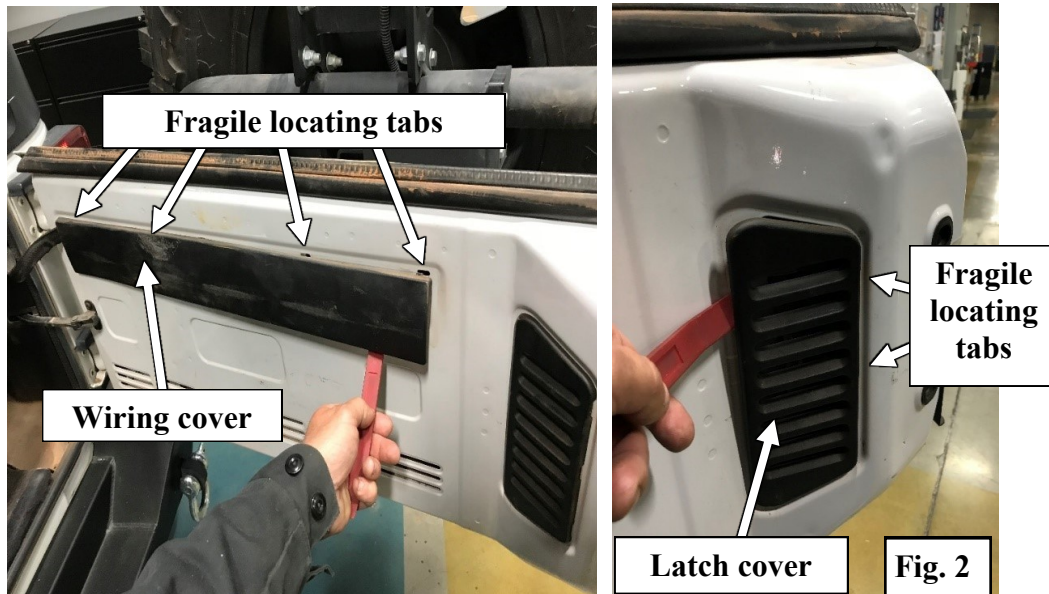

For Technical Support/Warranty Information please call 310-762-9944



Installation Instructions:

(Part # SB76410)
2007-2018 Jeep JK Tailgate

Step 3 : After removing the latch cover, disconnect the **3rd brake light** and **power door lock harness** (if equipped), by depressing the tabs (marked with arrows) and pulling the connectors apart (**Fig. 3**). With a panel tool, remove the **3rd brake light plug** and **(4) harness retainers**, (**Fig. 4**) then remove the wiring harness from the tailgate.

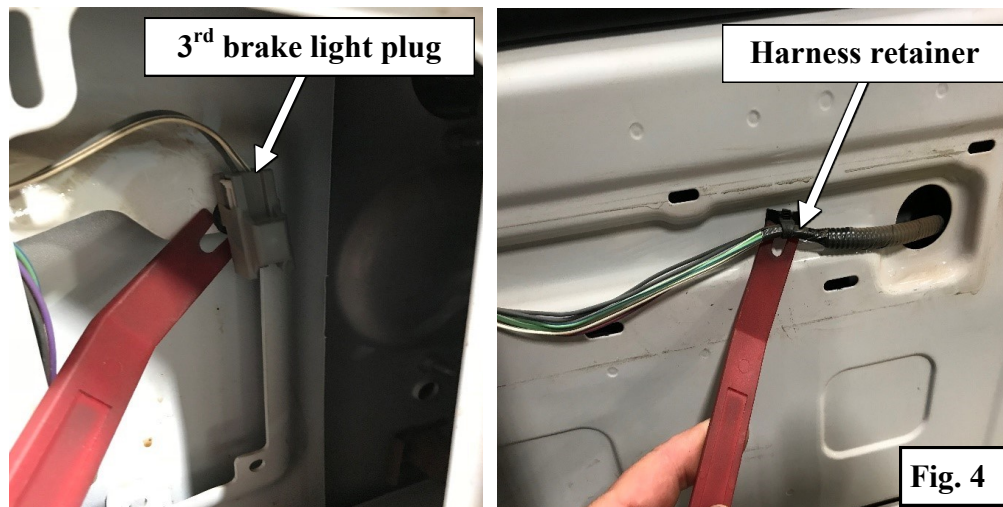
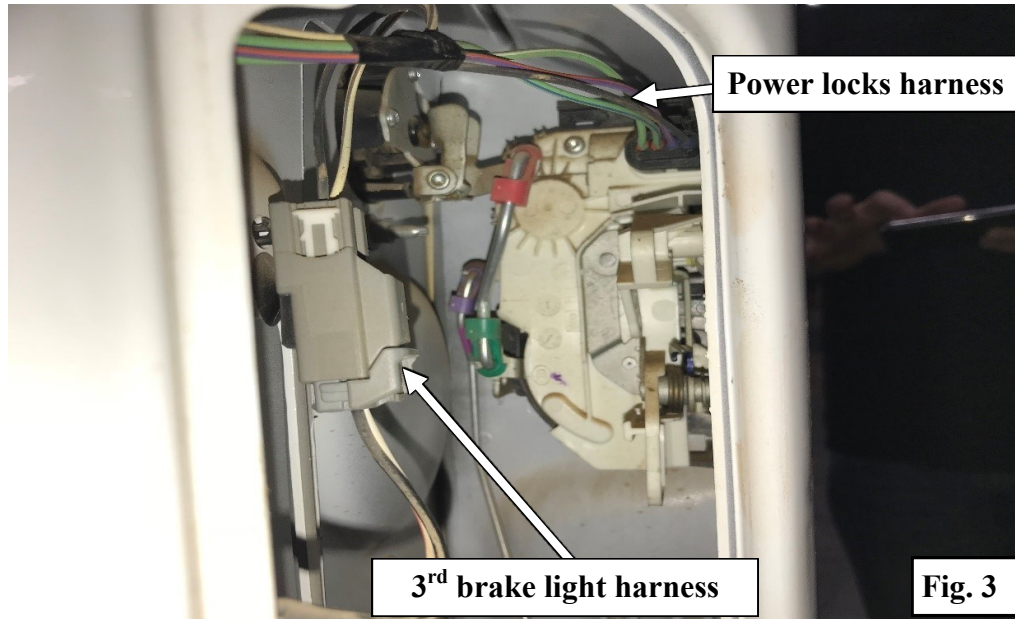

For Technical Support/Warranty Information please call 310-762-9944



Installation Instructions: (Part # SB76410) 2007-2018 Jeep JK Tailgate

Step 4 : On the face of the tailgate, using a plastic pry tool, lift out the 3rd brake light wiring grommet and fish the brake light cable through the outer seal hole (**Fig. 5**).



Step 5 : Using a T20 Torx bit, remove the (4) Screws on the backside of the 3rd brake light pillar (**Fig. 6**). Save these screws and carefully remove the 3rd brake light assembly, set aside for re-installation.

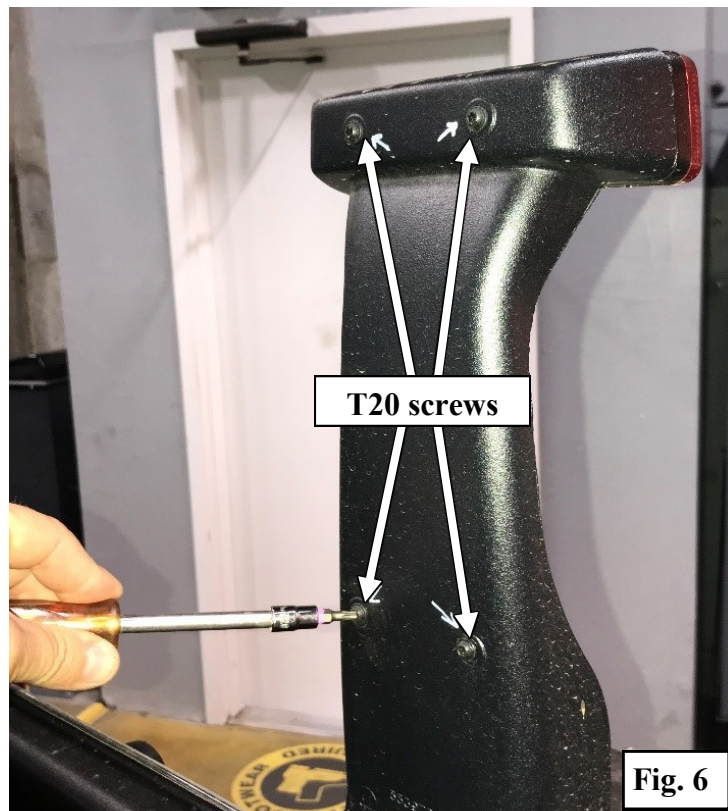

For Technical Support/Warranty Information please call 310-762-9944



Installation Instructions:

(Part # SB76410)
2007-2018 Jeep JK Tailgate

Step 6 : If you have a hardtop, open the rear glass or roll up the soft top if applicable. Fully close and latch the tailgate, then using a T30 Torx bit, remove the (2) Screws securing the tailgate check/strap (Fig. 7). Save the screws for re-installation.

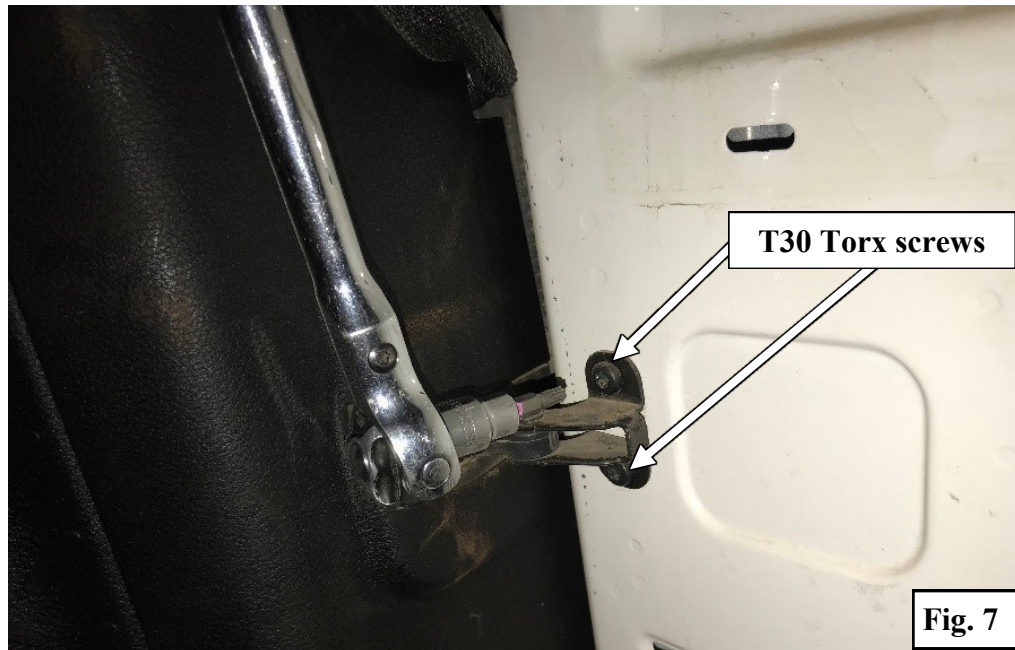

Step 7 : Starting with the longer hinge covers, use a plastic prybar to lift up the back edge to release the tabs that hold them in place and pull the cover away from the hinge point (Fig. 8).

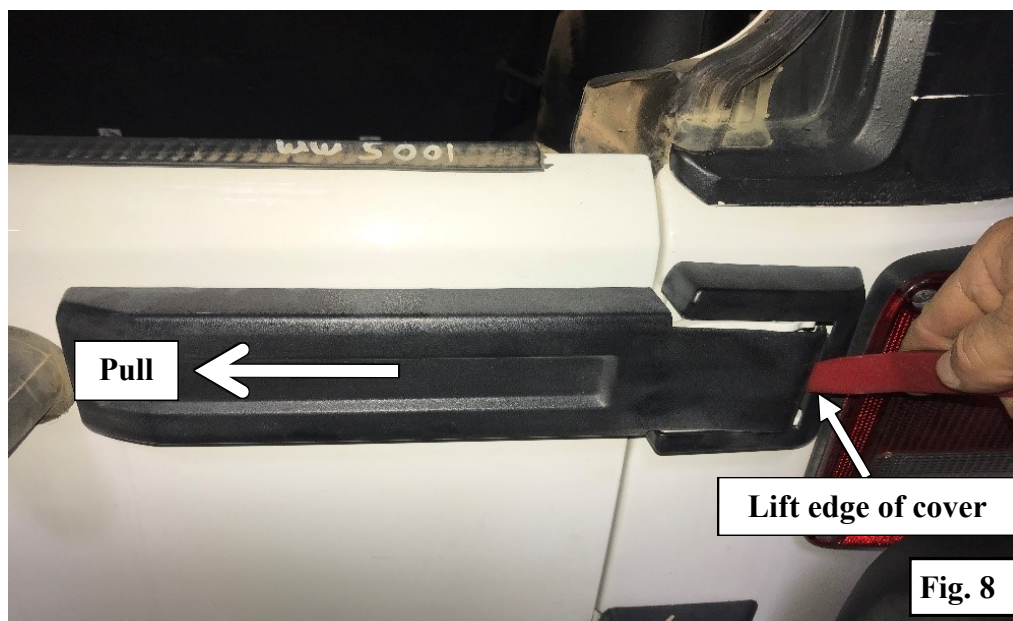

For Technical Support/Warranty Information please call 310-762-9944



Installation Instructions: (Part # SB76410) 2007-2018 Jeep JK Tailgate

Step 8 : Remove the smaller pivot covers by gently prying the two “legs” away from the hinge and pulling the cover away from the hinge point (**Fig. 9**).

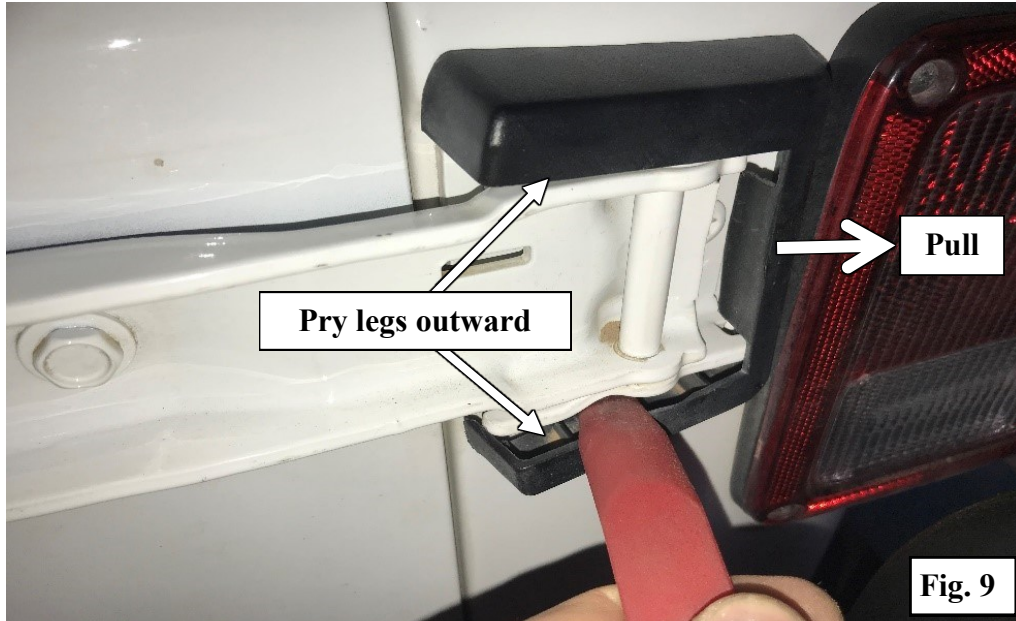

Step 9 : With a 13mm socket, remove the (2 each) Bolts holding the hinges to the tailgate and open the hinges perpendicular the vehicle (**Fig. 10**). Next remove the (3 each) T50 Torx bolts holding the hinges to the body (**Fig. 11**).

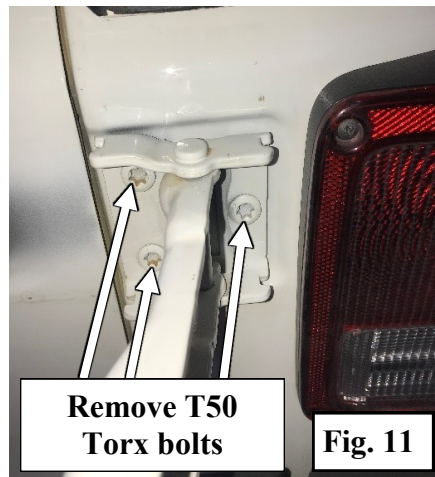
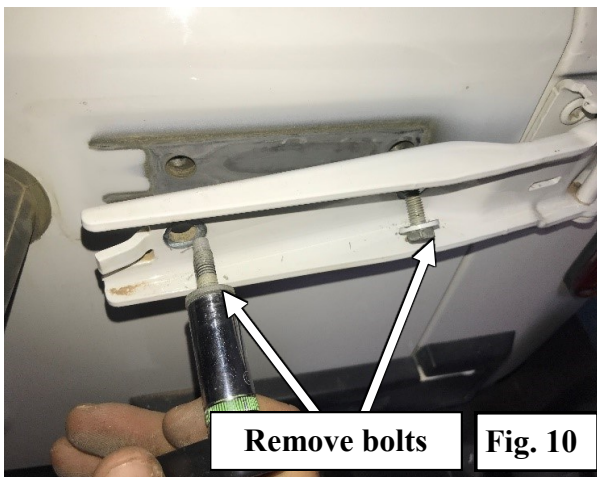

For Technical Support/Warranty Information please call 310-762-9944



Installation Instructions: (Part # SB76410) 2007-2018 Jeep JK Tailgate

Step 10: Carefully remove the tailgate from the back of the vehicle, by gripping the tire mount in your right hand, while using the handle in your left, to hold and unlatch the tailgate (**Fig. 12**). Place the **OE tailgate** on a flat surface, in a position that allows easy access to the inside of the latch box.

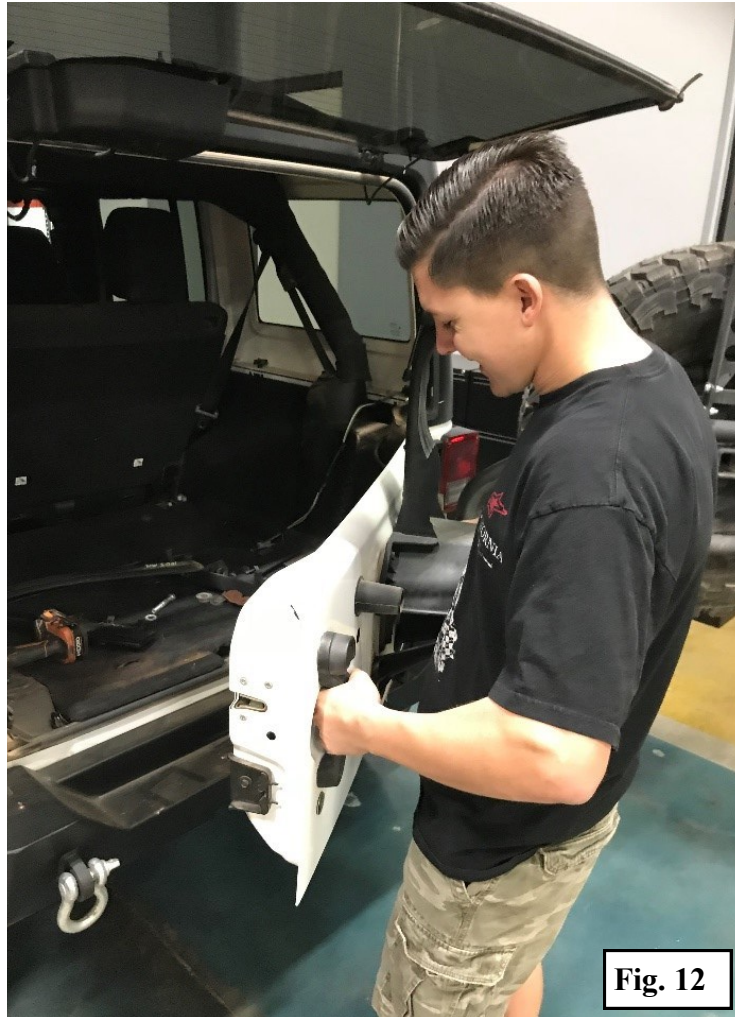

For Technical Support/Warranty Information please call 310-762-9944

Smittybilt, 400 W. Artesia, Compton, CA 90220



Installation Instructions:

(Part # SB76410)
2007-2018 Jeep JK Tailgate

Step 11: Your Smittybilt tailgate is designed to re-use the **OE latch**, handle and lock from your vehicle.

Perform the following steps on the inside of the latch, (**Fig. 13**)

(Action A) : Only unclip the retainers securing the handle and lock cylinder connecting rods, leave latch assembly alone. Carefully remove the rods from the retainers.

(Action B) : With an **8mm** wrench, remove the **(2)** nuts securing the handle.

(Action C) : Remove handle and set these aside. Using pliers, remove the horseshoe shaped spring clip securing the cylinder by pulling straight back in linear motion, remove cylinder and set aside.

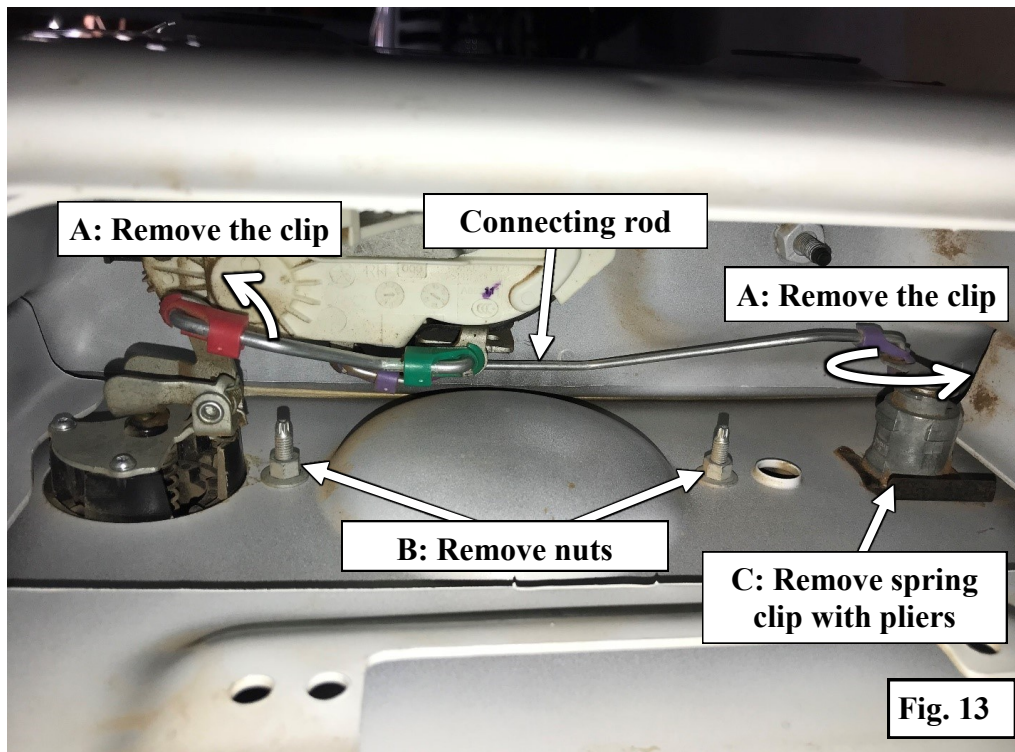

For Technical Support/Warranty Information please call 310-762-9944



Installation Instructions:

(Part # SB76410)
2007-2018 Jeep JK Tailgate

Step 12: On the outside of the latch box, (**Fig. 14**) using a **10mm** socket wrench, remove the (**2qty. M6**) **Screws** securing the tailgate bumper, set bumper and screws aside. Next, use a T30 Torx bit to remove the (**3**) **Screws** securing the **Latch mechanism** to the inside of the tailgate. Carefully remove the latch mechanism from inside the latch box and set aside with the screws.

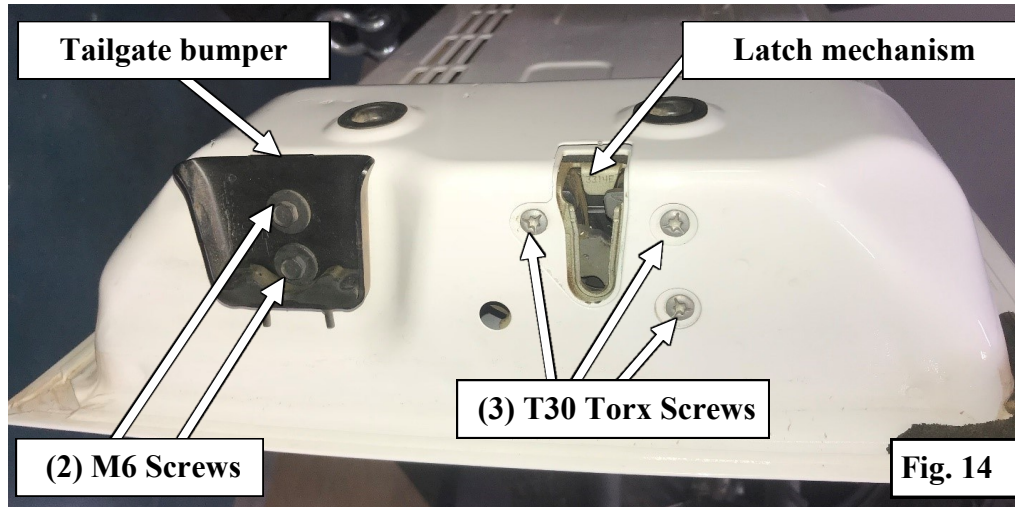

Step 13: Unbox your new Smittybilt Tailgate (**Fig. 15**). Check all contents against the bill of materials list. If anything is missing, please call technical support immediately.



For Technical Support/Warranty Information please call 310-762-9944



Installation Instructions:

(Part # SB76410)
2007-2018 Jeep JK Tailgate

Step 14: Using a packing blanket on a work bench, or similar table (to prevent marring). Unpack your new tailgate (112TU201).

NOTE: *Be careful, as the new latch box may be unsecured.*

Place it face down as shown (Fig. 16). Set the new latch box off to one side. Using a **4mm** Allen bit, remove the **(8)** Allen screws securing the back cover and set these aside as well.

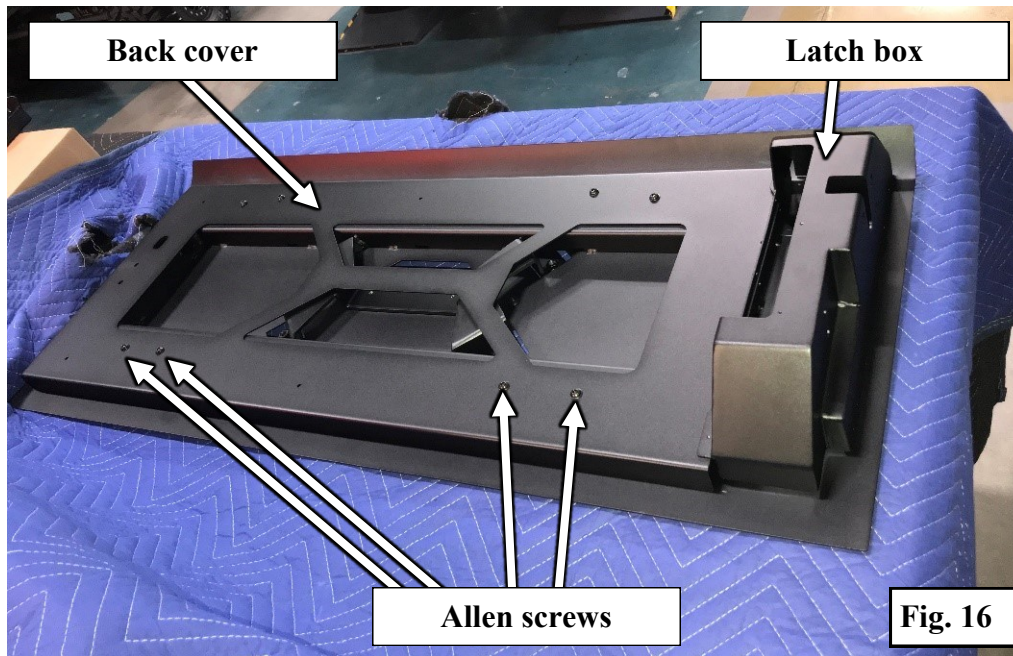

Step 15: Latch box assembly: using Step 12 as a guide, install the OE latch mechanism into the new latch box, re-using the OE **T30 Torx** screws. Install the tailgate bumper re-using the **OE M6 bolts** with a **10mm** socket wrench. Tighten the **(3)** **T30 Torx** screws and **(2)** **M6 bolts** to **8ft-lbs. or 96in-lbs.** (Fig. 17).

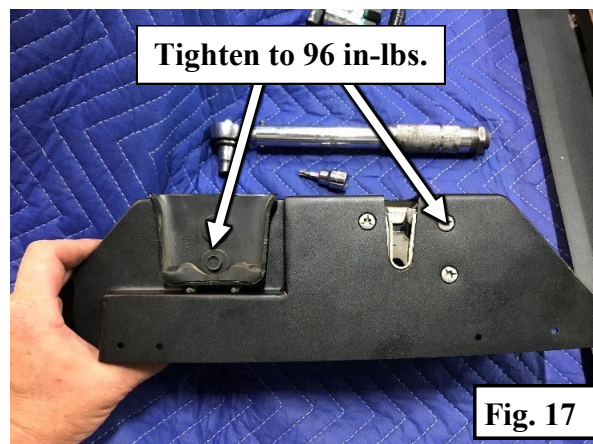

For Technical Support/Warranty Information please call 310-762-9944



Installation Instructions:

(Part # SB76410)
2007-2018 Jeep JK Tailgate

Step 16: On your new Smittybilt tailgate: Using **Step 11** as a guide, note the orientation and install the **OE lock cylinder** with the **OE horseshoe shaped spring clip**. Install the **OE handle**, re-using the **OE nuts** with an **8mm socket wrench (Fig 18)**. Tighten the nuts to **8ft-lbs. or 96 in-lbs.**

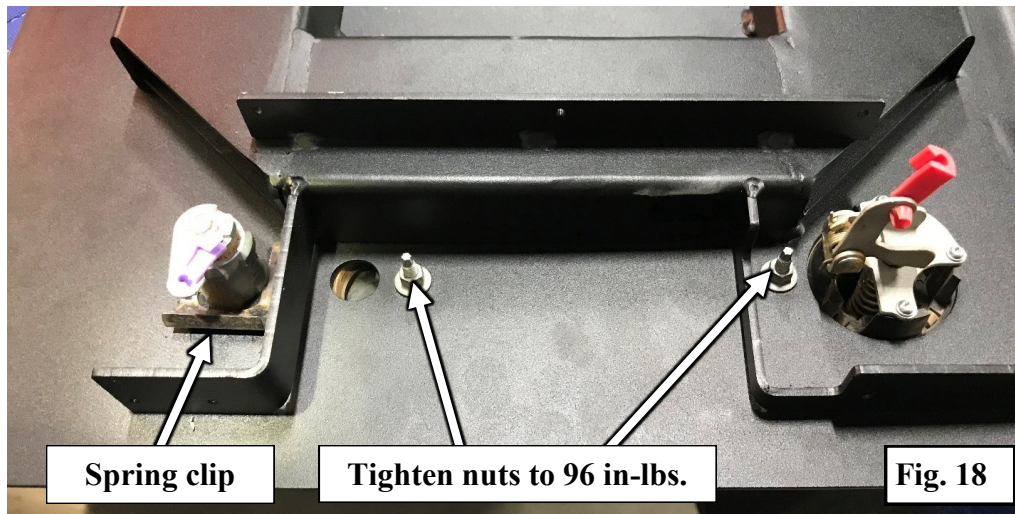

Step 17: Place the latch cover assembly onto the tailgate (**don't install screws yet**). Re-install the **Connecting rods** to the lock cylinder and handle retainers. Fold the **Retaining clips** over and click them into place (**Fig. 19**).

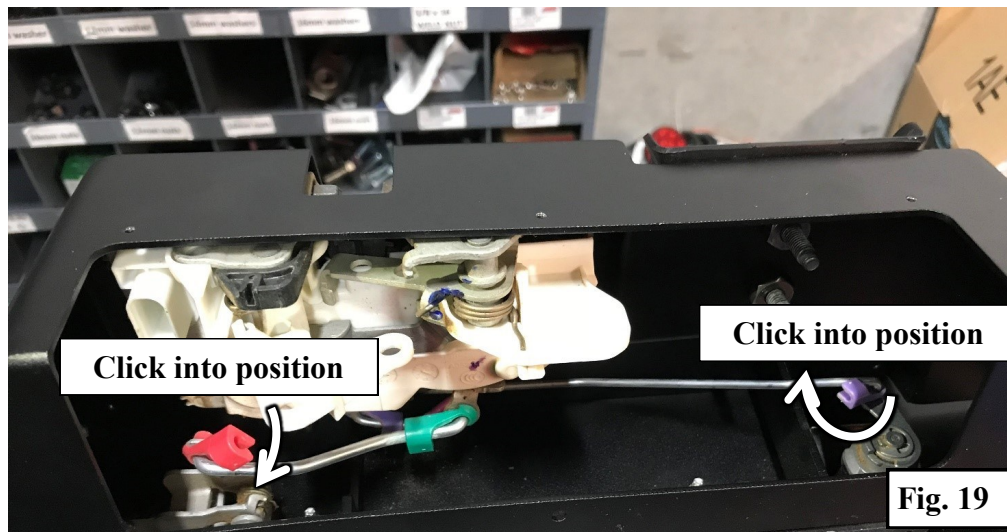

For Technical Support/Warranty Information please call 310-762-9944



Installation Instructions:

(Part # SB76410)
2007-2018 Jeep JK Tailgate

Step 18: Position the latch box assembly over the (3) Mounting flanges of the tailgate. Locate the Latch access cover box (76410-05). Place the cover in position on top of the latch assembly box (Fig. 20). Make sure that the mounting holes align with the (3) Holes on top of the latch box and that the (3) Lower holes align with the latch box to the tailgate mounting flange. Locate small box (76410-09 hardware 01), find the bag of M4 hardware. The latch access cover will be attached using (6 each) M4x.70 Allen screws, split ring washers & flat washers (Fig. 20a). Loosely install the lower (3) screws through the tailgate mounting flange first, then install the top (3) screws & washers. Tighten all of these screws and then torque to 10 in-lbs.

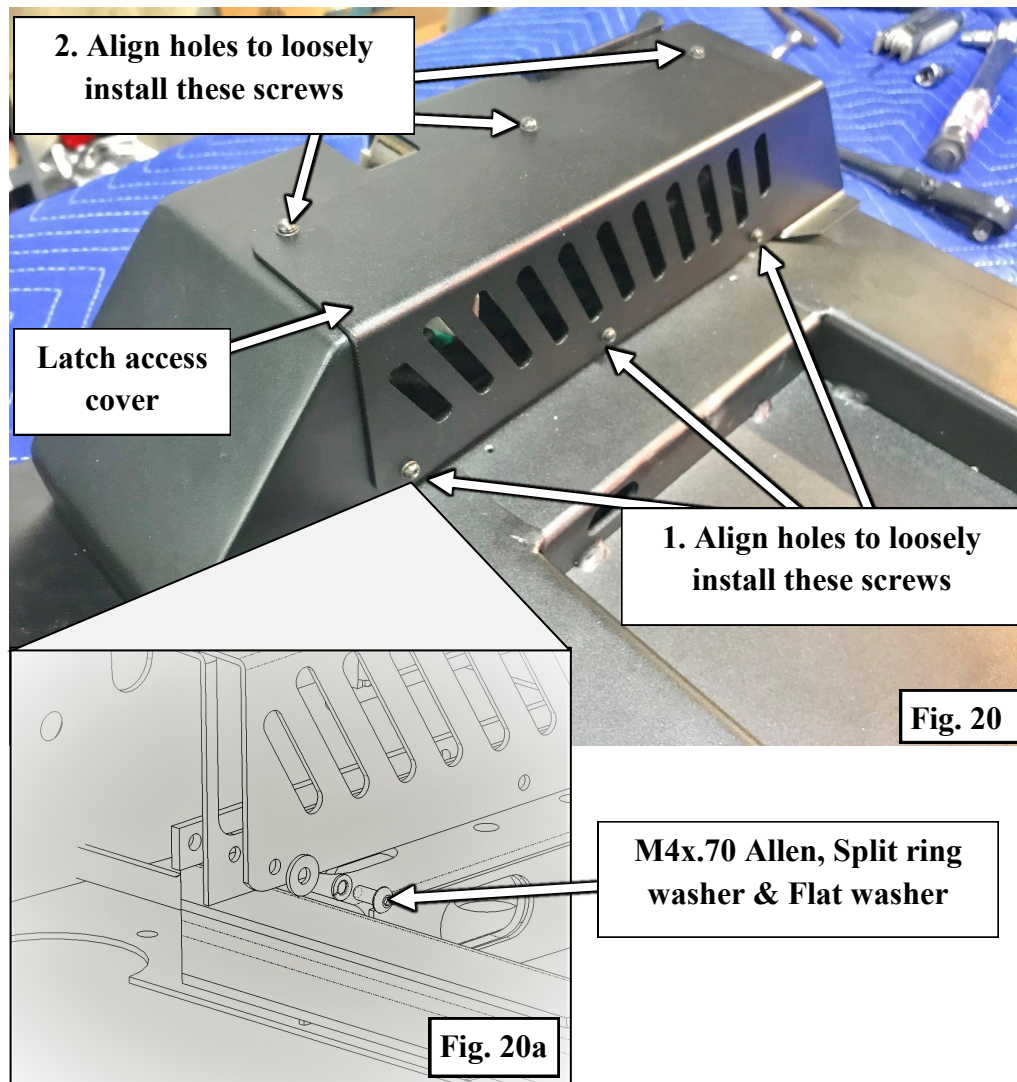

For Technical Support/Warranty Information please call 310-762-9944



Installation Instructions: (Part # SB76410) 2007-2018 Jeep JK Tailgate

Step 19: Moving to the other side of the latch box assembly, (**Fig. 21**) use **(4 each) M4x.70 Allen screws, split ring washers & flat washers** to secure the latch assembly box to the two mounting flanges.

NOTE: *You may have to apply some pressure to the latch box and tailgate to align these holes.*

After these screws are installed, tighten to 10 in-lbs.

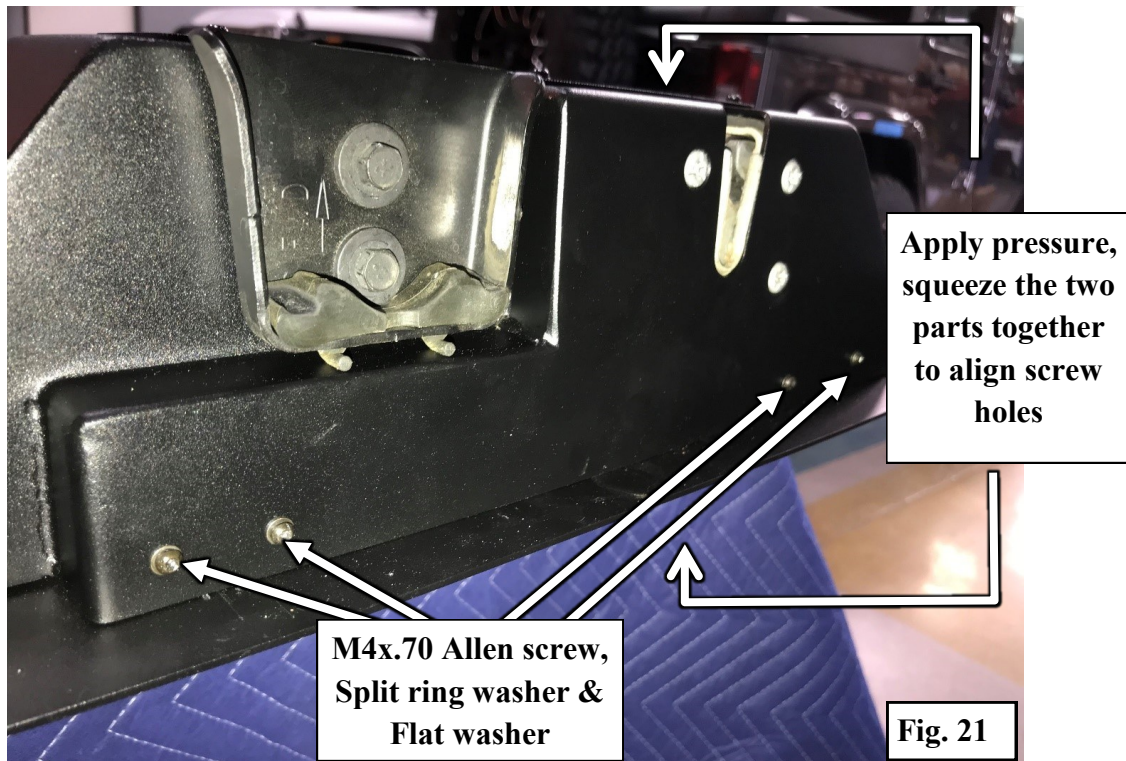

For Technical Support/Warranty Information please call 310-762-9944

Smittybilt, 400 W. Artesia, Compton, CA 90220



Installation Instructions:

(Part # SB76410)
2007-2018 Jeep JK Tailgate

Step 20: Locate box (76410-09 hardware 02), in it you will find (2) Nut plates (112TU209), insert them into the end of the tailgate, smooth side facing out, as shown (Fig. 22).

NOTE: Be sure to match the orientation of the nut plates, to the mounting holes in the tailgate.

Locate box (76410-08 tailgate hinge) install the (2) Tire gate hinges (112TU208) to the tailgate and nutplates, using the supplied (4 qty.) M12x1.5x25mm bolts & flat washers found in box (76410-09 hardware 01). Tighten finger tight at this time.

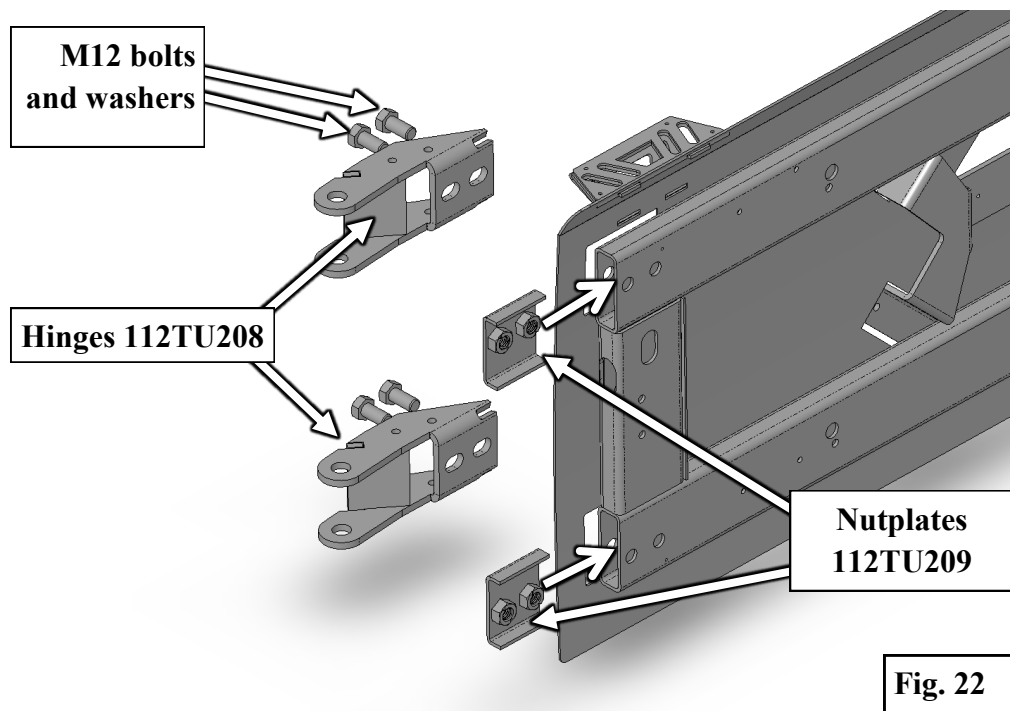

For Technical Support/Warranty Information please call 310-762-9944



Installation Instructions:

(Part # SB76410)
2007-2018 Jeep JK Tailgate

Step 21: Turn the tailgate face up on your workbench. Locate box (76410-07 carrier mounts). Open the package and lay the contents out as shown, (Fig. 23) you will notice that two of the mounts are slightly thicker than the other two (Fig. 23a), these two will install in the upper locations on your new tailgate.

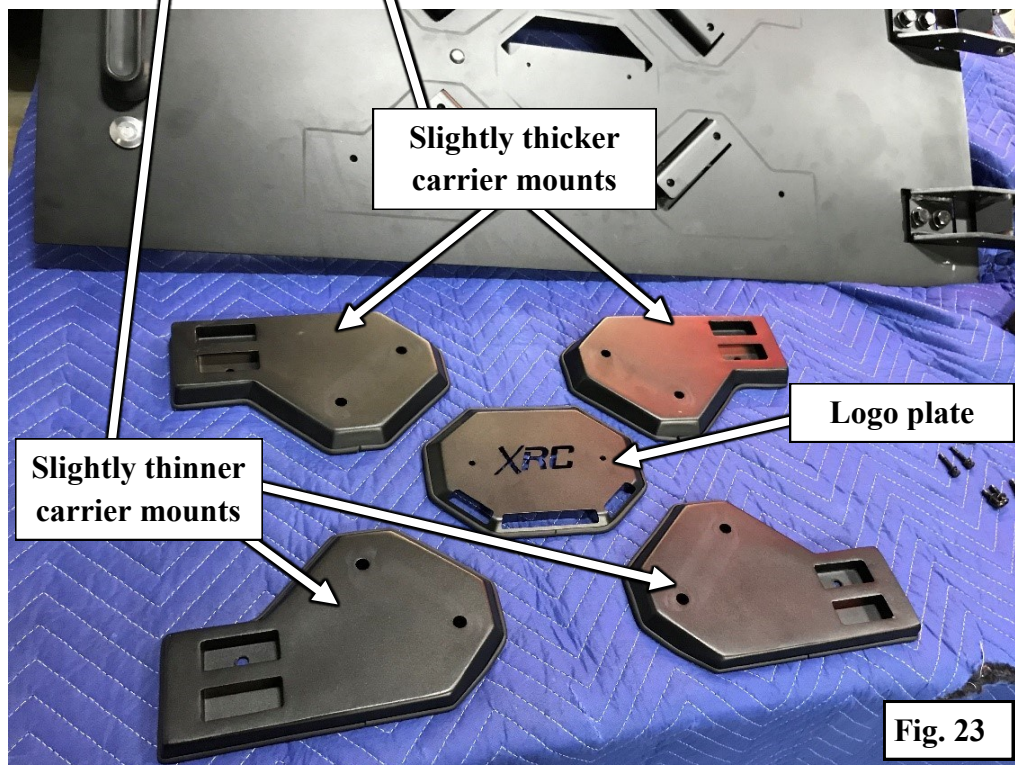
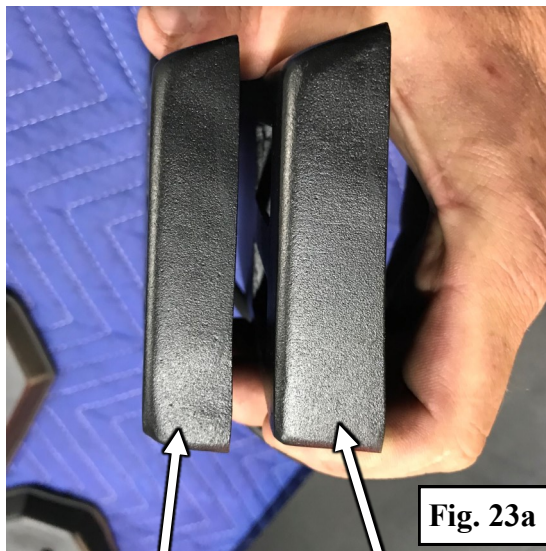

For Technical Support/Warranty Information please call 310-762-9944



Installation Instructions: (Part # SB76410) 2007-2018 Jeep JK Tailgate

NOTE : For Step 22, a dab of superglue will help hold gasket in position.

Step 22: Look in the larger hardware box (46410-09 hardware-02) and find the roll of gasket material (Fig. 24a). Install the gasket around the edges of the carrier mounts and the logo plate (Fig. 24b). Start and end at the middle of the bottom side of each part (Fig. 24c).

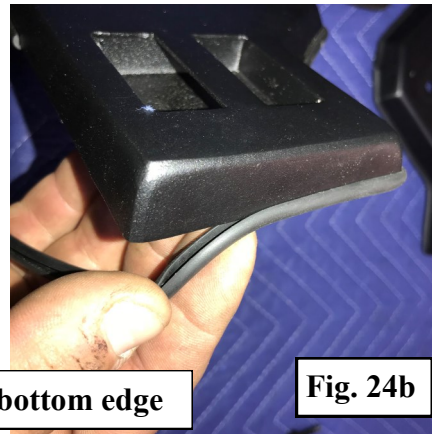

For Technical Support/Warranty Information please call 310-762-9944



Installation Instructions:

(Part # SB76410)
2007-2018 Jeep JK Tailgate

Step 23: In the small hardware box (76410-09 hardware-01), locate the bag of (4qty. M6x1.0x20mm) button head screws, washers, along with a bag of (2qty. M5x0.8x25mm) bolts, split ring washers & flat washers.

Install the carrier mounts onto the tailgate using the M6 button head screws and washers. Make sure that all mounting holes are aligned with the corresponding holes in the tailgate before tightening screws (Fig. 25). In the larger hardware box (46410-09 hardware-02), locate the rubber dust flap for the logo plate (Fig. 25a). Place the rubber dust flap over the crescent shaped hole on the tailgate and align the mounting holes. Mount the logo plate over the dust flap and secure using the M5 bolts, split ring washers and flat washers (Fig. 26). When satisfied with fitment, tighten the (4) M6 screws to 4 ft-lbs. or 48 in-lbs. and (2) M5 bolts to 15 in-lbs.

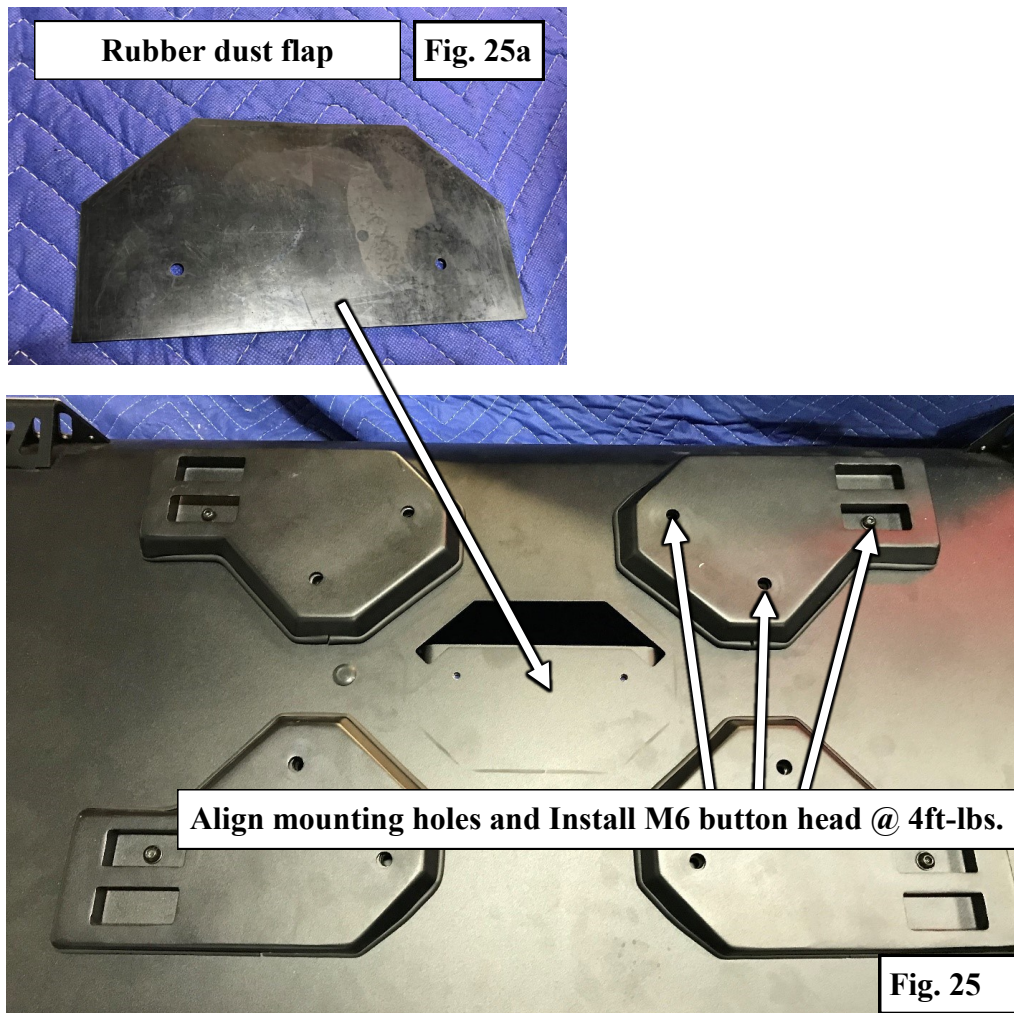

For Technical Support/Warranty Information please call 310-762-9944



Installation Instructions:

(Part # SB76410)
2007-2018 Jeep JK Tailgate

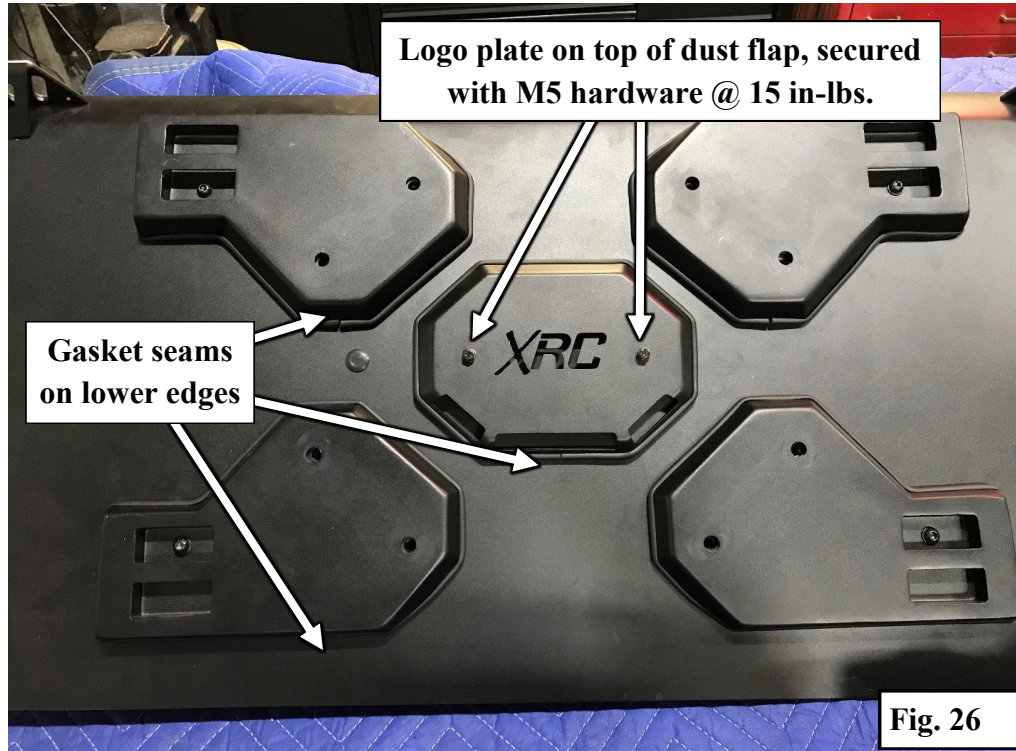

Step 24: Locate box (76410-04 hinge pair), Re-using the OE T50 Torx hardware (Use Step 9 as a guide) Install the (2) hinge mounts (112TU211) on the vehicle. Tighten finger tight at this time (Fig. 27).

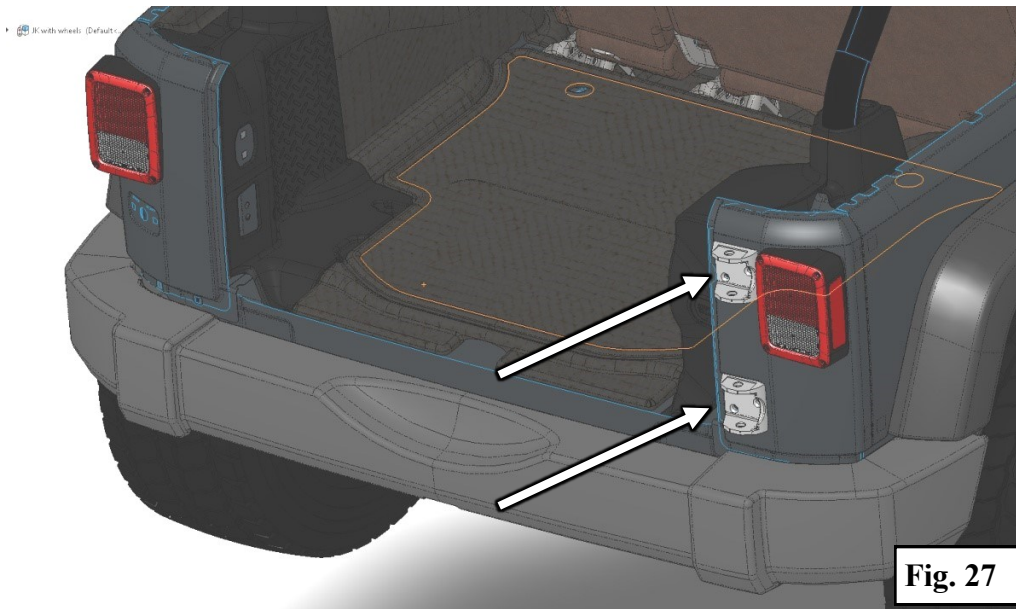

For Technical Support/Warranty Information please call 310-762-9944



Installation Instructions:

(Part # SB76410)
2007-2018 Jeep JK Tailgate

Step 25: *NOTE; This may require two people.*

Install the tailgate onto the vehicle by lifting the tailgate into the closed position, latching it onto the striker and align the hinges into the hinge mounts (**Fig. 28**).

In the small hardware box (76410-09 hardware-01), locate the (2) **snap rings** and (2) **16mm flat washers**. Install (1 each) **16mm washers** between the bottom of the hinge and the mount. Install the **hinge pins** through the mounts, **hinges and washers**. When the pins are fully seated, install the (1 each) **snap rings** onto the bottom groove of the pin (**Fig. 28a**).



Fig. 28

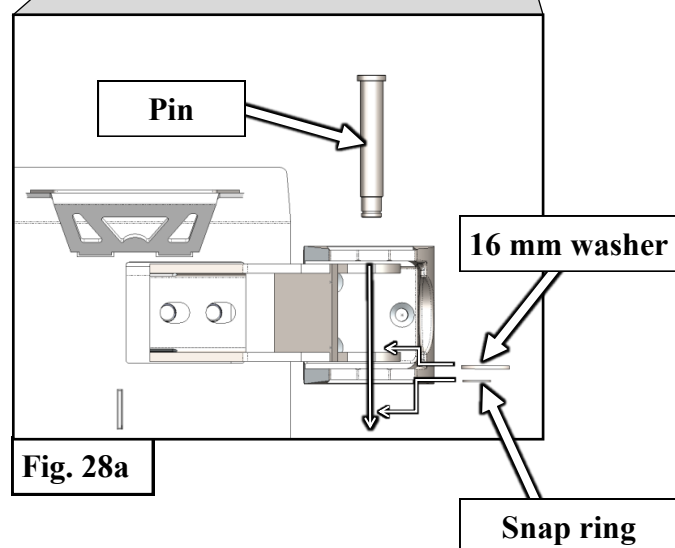

Fig. 28a

For Technical Support/Warranty Information please call 310-762-9944



Installation Instructions:

(Part # SB76410)
2007-2018 Jeep JK Tailgate

Step 26: On the hinge side of the tailgate, place some cardboard on the bottom edge to protect the finish. With a pry bar gently lift the tailgate up to center the hinges and fit it to the body lines of your vehicle (**Fig. 29**). Once you have confirmed that the hinges and mounts are properly aligned, firmly tighten the (**2 each hinge**) **M12 bolts** (**these will be adjusted and torqued in the next step**). Tighten the exposed (**1 each hinge**) **T50 Torx bolts** hand tight, then open the tailgate and tighten the remaining (**2 each hinge**) **Torx bolts**. Torque the **Torx bolts** to **24 ft-lbs**.

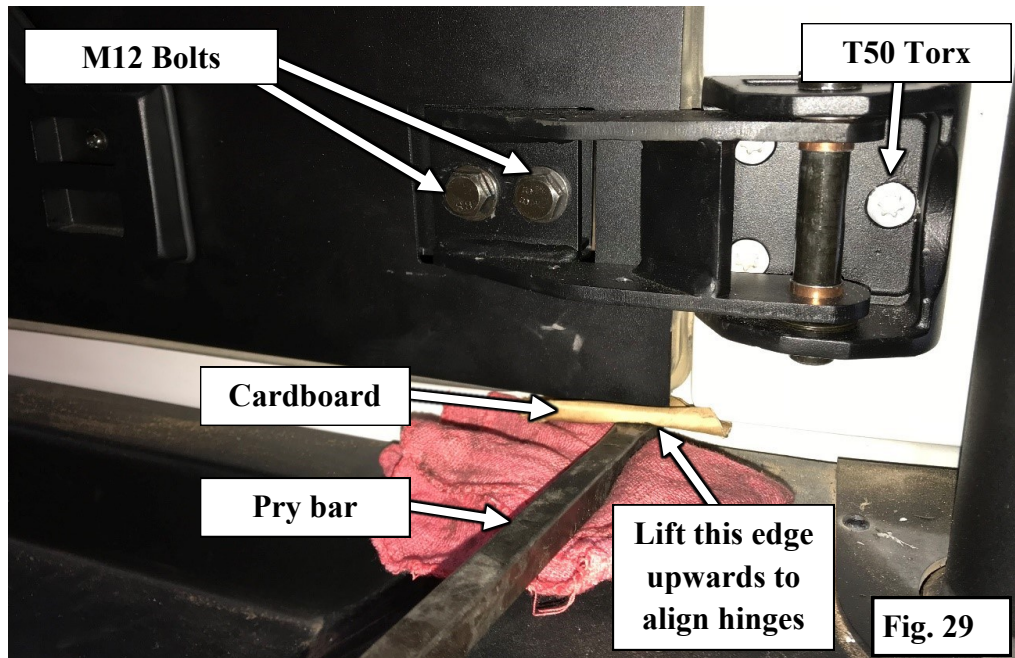

Step 27: To Adjust the tailgate on the latch side, loosen the (**2**) **lower M12 hinge bolts**. Grasp the handle and raise the tailgate until the latch is just above center on the striker (**Fig. 30**). When in position, re-tighten the **Lower hinge bolts**. Re-check the operation of the tailgate and make adjustments as necessary, then torque the (**4**) **M12 hinge bolts** to **78 ft-lbs**.



For Technical Support/Warranty Information please call 310-762-9944



Installation Instructions: (Part # SB76410) 2007-2018 Jeep JK Tailgate

Step 28: Locate box (76410-06) containing the hinge cover plate, along with (4) M6 mounting screws and washers from the small hardware box (76410-09 hardware-01). Install the cover over the hinges and tighten the M6 hardware to 6 ft-lbs (Fig. 31).

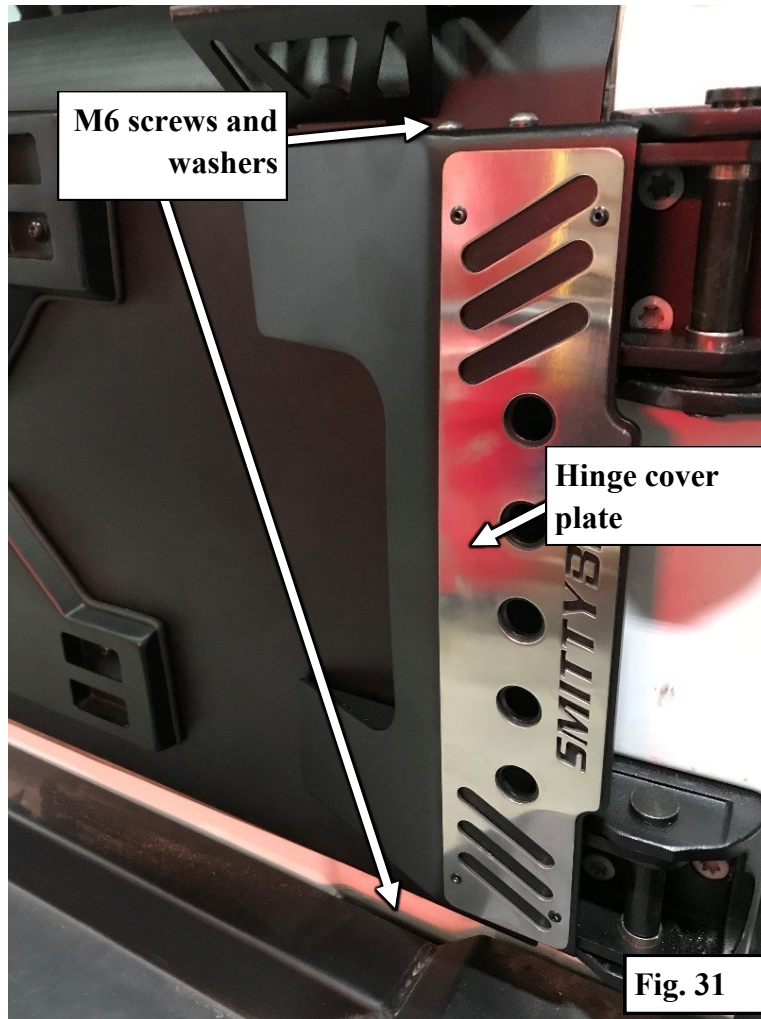

For Technical Support/Warranty Information please call 310-762-9944



Installation Instructions:

(Part # SB76410)
2007-2018 Jeep JK Tailgate

Step 29: Locate box (76410-06 hardware) containing the 3rd brake and the **mounting bracket (315TU001)**. Loosely install the round brake light onto the 3rd brake light bracket using the **supplied hardware on the light (Fig. 32)**.

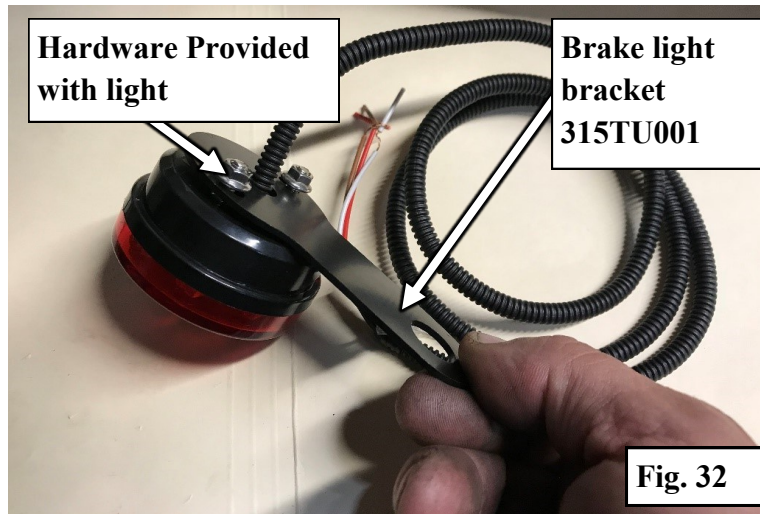

Step 30: *NOTE: A hydraulic press or wheel stud installation tool is required for this step.* Locate tire carrier mount box (76410-03A), in the small hardware box (76410-09 hardware-01) locate a bag of (3) 1/2x20 lug studs & lug nuts. Install the 3rd brake light assembly into the large center hole of the tire carrier bracket (93-9187), install the (3) 1/2x20 lug studs in the 5 on 5" configuration shown (Fig. 33). Press the studs through the brake light bracket into the adjustable tire carrier bracket being careful not to damage the threads.

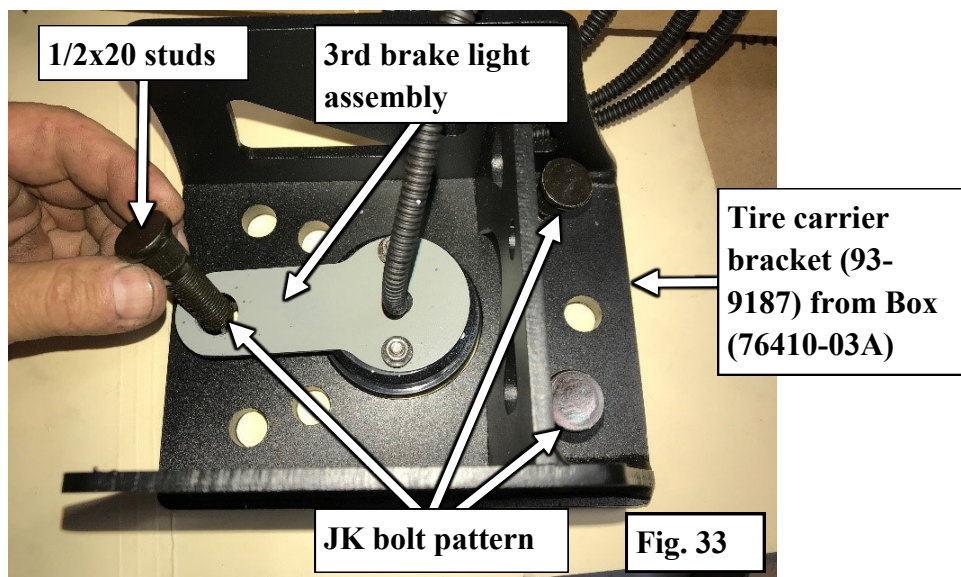

For Technical Support/Warranty Information please call 310-762-9944



Installation Instructions:

(Part # SB76410)
2007-2018 Jeep JK Tailgate

Step 31: Locate the stationary mount bracket (93-9183) in box (76410-03B) along with HD tire carrier mount (93-356CA100) in box (76410-02 carrier base plate). From the small hardware box (76410-09 hardware-01) locate a bag containing (4) M12x1.5x40mm bolts, washers & nuts. Bolt the stationary mount bracket to the HD carrier with the M12 hardware hand tight, as shown in (Fig. 34).

Note: Use this as a starting point, depending on tire size, you can adjust the stationary mount to your personal preference.

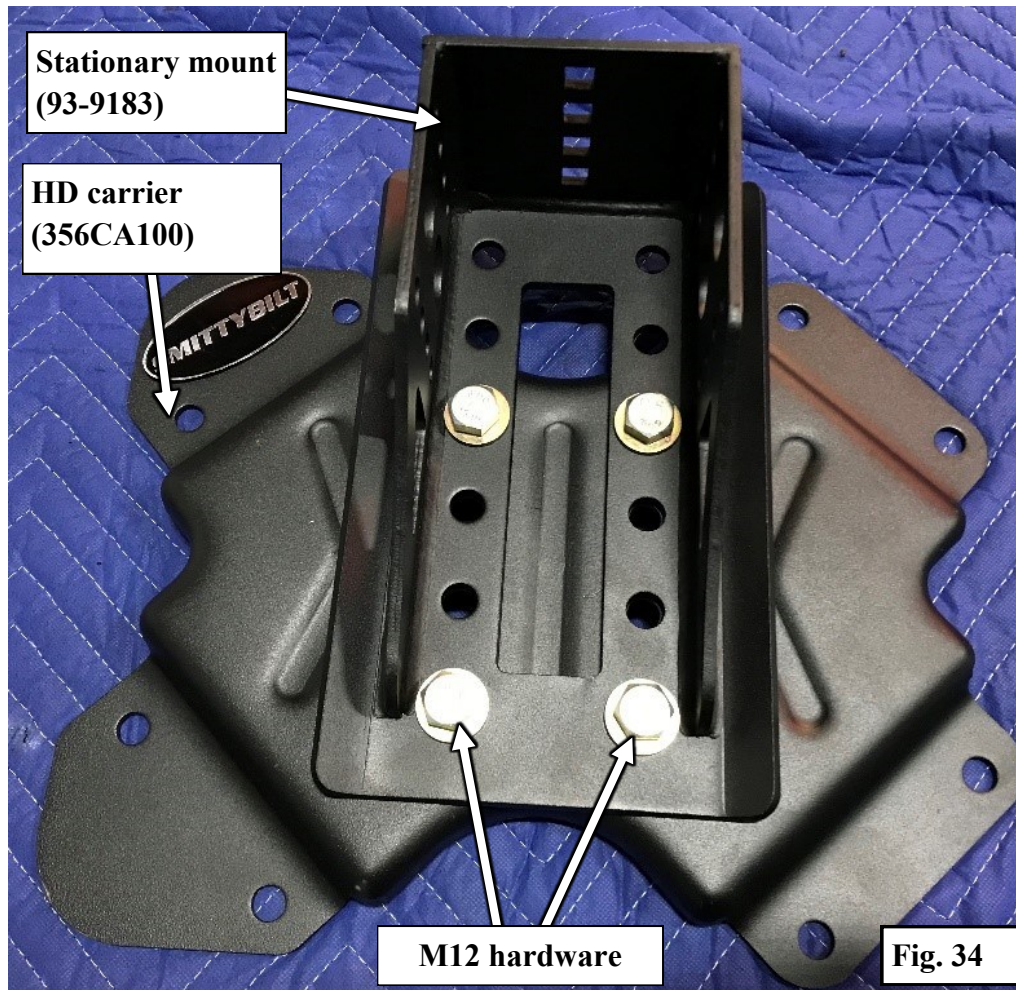

For Technical Support/Warranty Information please call 310-762-9944



Installation Instructions:

(Part # SB76410)
2007-2018 Jeep JK Tailgate

Step 32: From the small hardware box (76410-09 hardware-01) locate bag containing (7) M8x1.25x25mm bolts, split ring washers & flat washers. From the larger hardware box (46410-09 hardware-02) locate the (2) spacers (93-112TU216) and (4) rubber gaskets. Install the HD carrier assembly, spacers, and gaskets on the tailgate as shown (Fig. 35). Tighten the hardware to 24 ft-lbs.

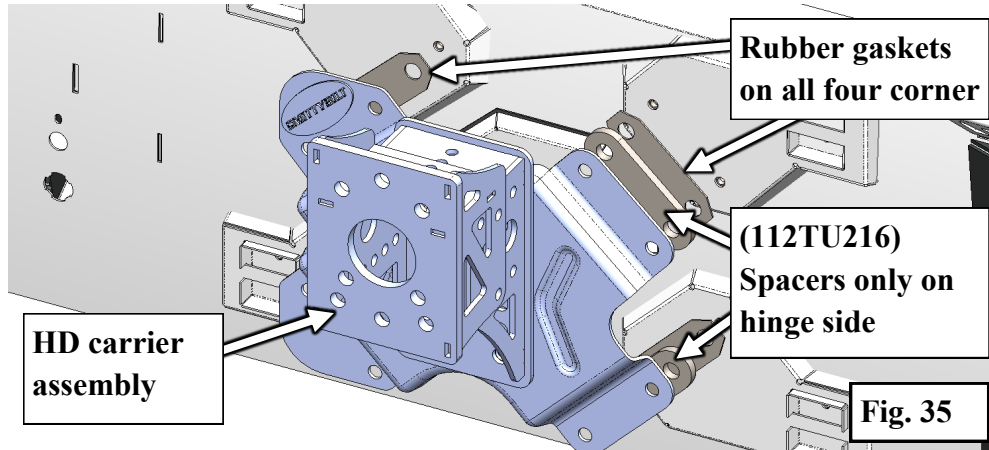

NOTE : The size of the spare tire will determine the mounting height of the bracket. If possible, it is better to have the tire fit tighter against the straight edge/tire gate to avoid excess vibration. **TIP:** For off-road applications, raise the tire position for more departure angle. For street driven applications, lower the tire position for greater rear window vision.

Step 33: To figure the proper mounting depth for the adjustable tire mount bracket assembly (93-9183), place your spare tire face down, lay a straight edge across the tire and measure from the rim face to the bottom edge of the straight edge (Fig. 36).

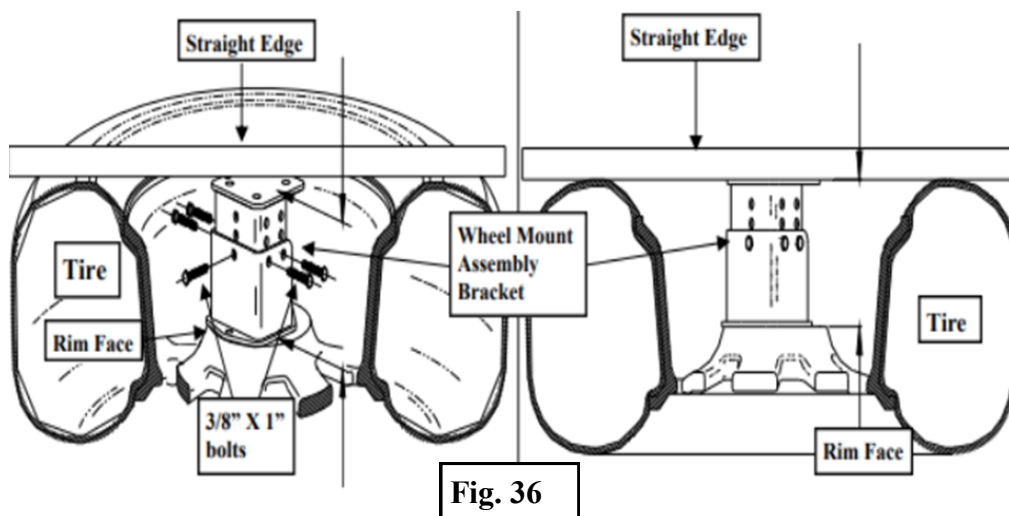

For Technical Support/Warranty Information please call 310-762-9944



Installation Instructions:

(Part # SB76410)
2007-2018 Jeep JK Tailgate

Step 34: From the small hardware box (76410-09 hardware-01) locate bag containing (5) M10x1.5x30mm bolts & (10) flat washers. Using the measurement from Step 33. Install the adjustable tire mount bracket assembly (93-9183) onto the tailgate as close to your measurement as possible, if measurement is slightly short of the mounting point, use the next outward hole. (Older versions) Run the 3rd brake light wiring through the mounts and into the hole in the tailgate under the HD bracket assembly thru the internal braces to the latch box. (Newer version) Cut a small hole in the 24mm plug located on the upper left of the tailgate and run the wires to the latch box (Fig. 37). When satisfied with all adjustments, tighten the M10 hardware to 45 ft-lbs.

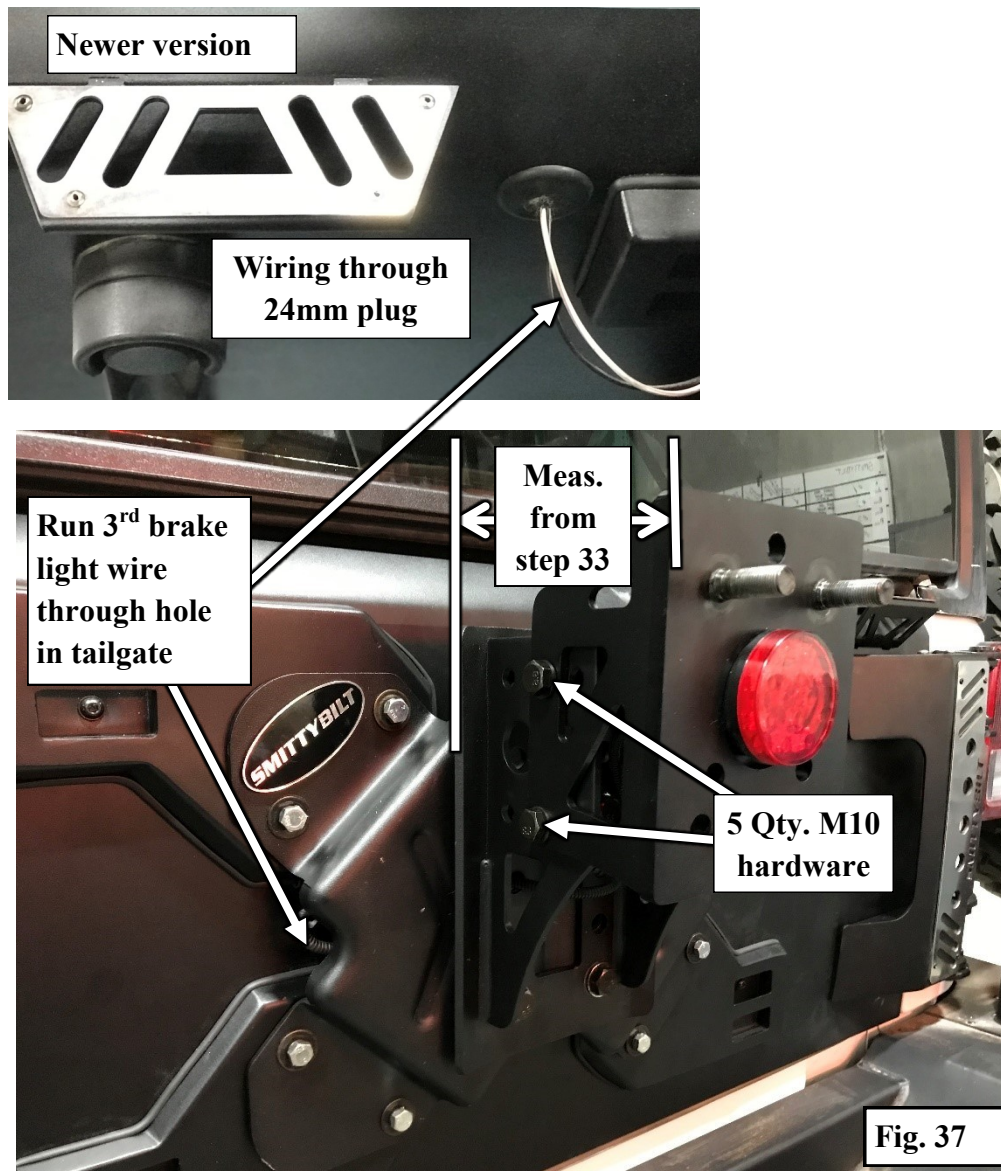

For Technical Support/Warranty Information please call 310-762-9944



Installation Instructions:

(Part # SB76410)
2007-2018 Jeep JK Tailgate

Step 35: Locate the Smittybilt tailgate rear cover from **Step 14, (Fig. 16)**. Early Smittybilt tailgate models did not have an access hole for the OE wiring harness, it may be necessary to drill and/or notch a hole on the upper rear portion of the cover as shown **(Fig. 38)**. To prevent rust, be sure to paint or apply silicone to raw edges.

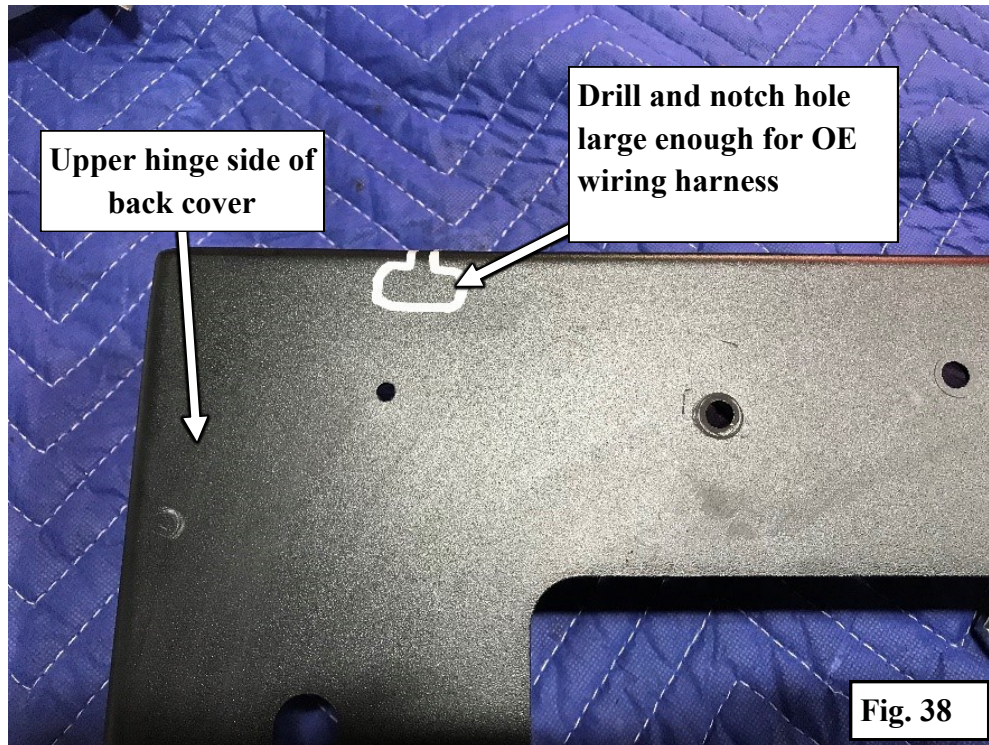

For Technical Support/Warranty Information please call 310-762-9944



Installation Instructions:

(Part # SB76410)
2007-2018 Jeep JK Tailgate

Step 36: Run the OE wiring harness along the top edge of the upper brace into the latch box, use some tape to help hold it in place (Fig. 39). Then re-install the cover on the tailgate, running the OE harness through the notch (Fig. 40). First install the (4) **M4x.70 button heads, split ring washers & flat washers** securing the rear cover to the latch box assembly, then install the (8) **M6x1.0 button head screws & washers** securing the rear cover to the tailgate braces, being careful not to pinch the wiring harness. Install the remaining (4) **M4 screws and washers** and tighten the **M4 hardware** to **10 in-lbs**. Tighten the **M6 hardware** to **7 ft-lbs**.

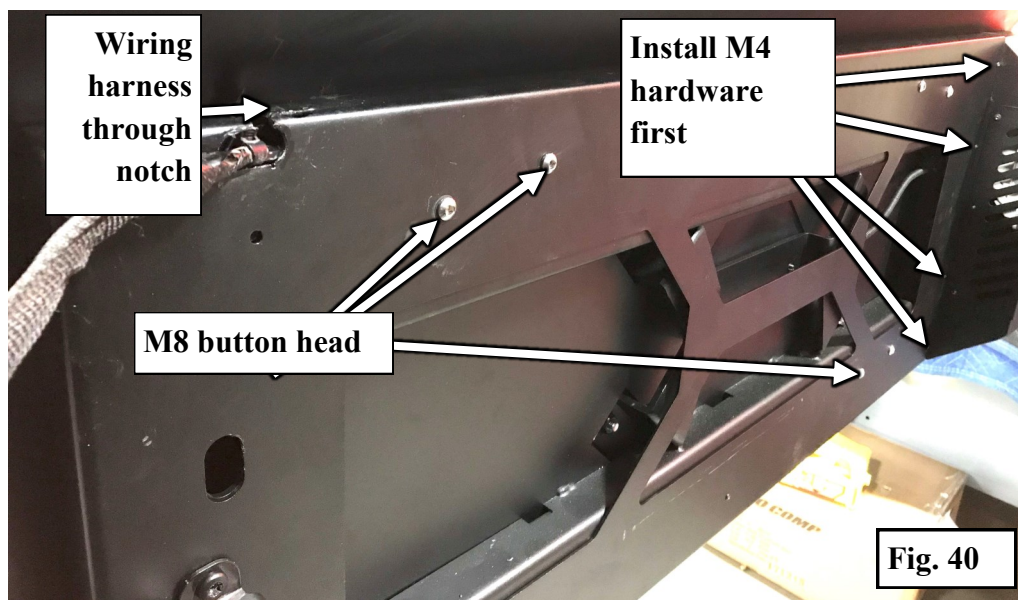
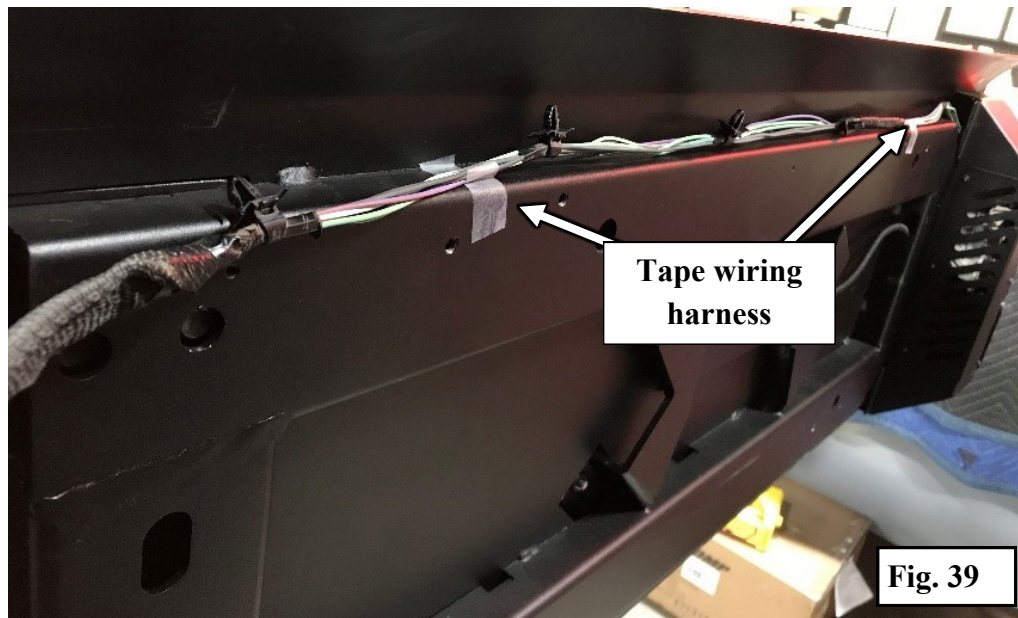

For Technical Support/Warranty Information please call 310-762-9944



Installation Instructions:

(Part # SB76410)
2007-2018 Jeep JK Tailgate

Step 37: Remove the latch access cover and re-connect the OE power locks harness to the OE latch. Connect the 3rd brake light to the OE plug (Fig. 41), (If the 3rd brake light is not supplied with an OE style connector, have a qualified automotive electrician splice the wiring together with a waterproof connection). Re-install the latch access cover and tighten the M4 hardware to **10 in-lbs.**

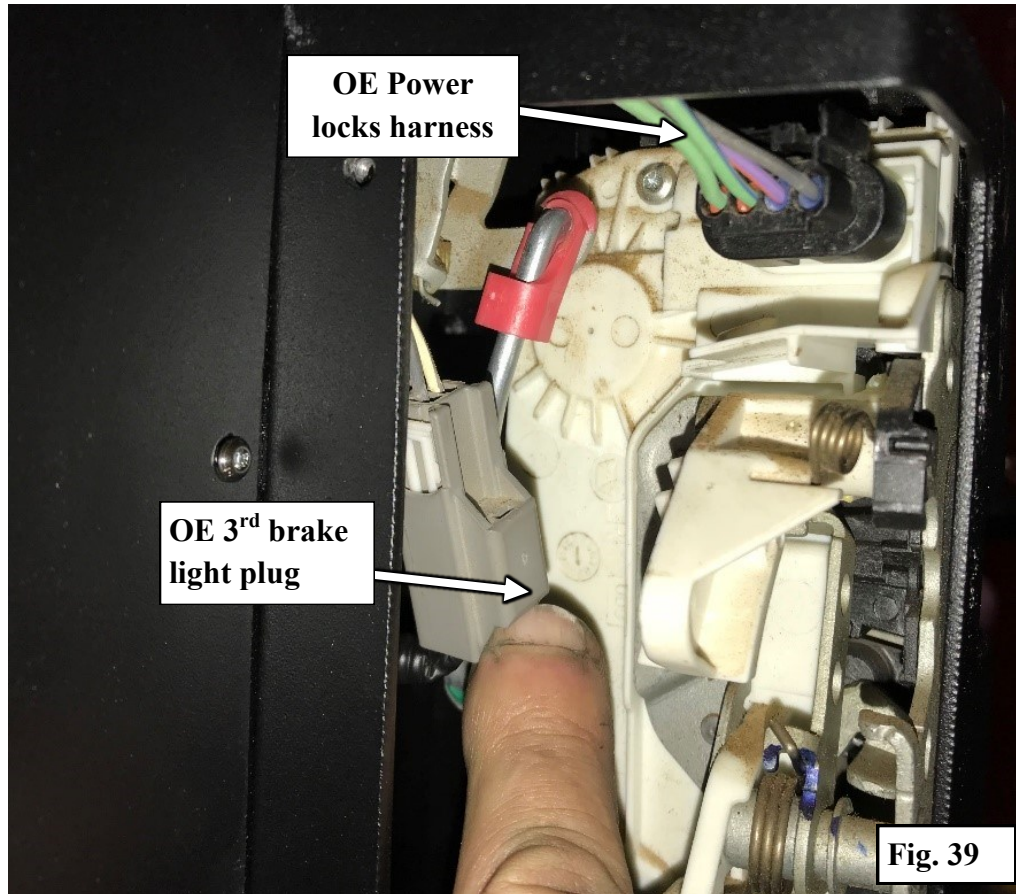

Step 38: Close the tailgate and re-install the check strap with the OE Torx screws. See **Step 6**, (Fig. 7). Tighten these (2) Torx screws to **7 ft-lbs.**

For Technical Support/Warranty Information please call 310-762-9944



Installation Instructions: (Part # SB76410) 2007-2018 Jeep JK Tailgate

Step 39: Following the vehicle manufacturer's instructions, remove and disconnect the passenger side tail light..

Step 40: Looking inside the fender where the tail light was, you will see the backside of the OE tailgate strap. Notice the small horseshoe shaped area of bare metal at the very end. With a 90° drill and a short 0.20" drill bit, drill through the center of the semi-circle area of bare metal (**Fig. 40**).

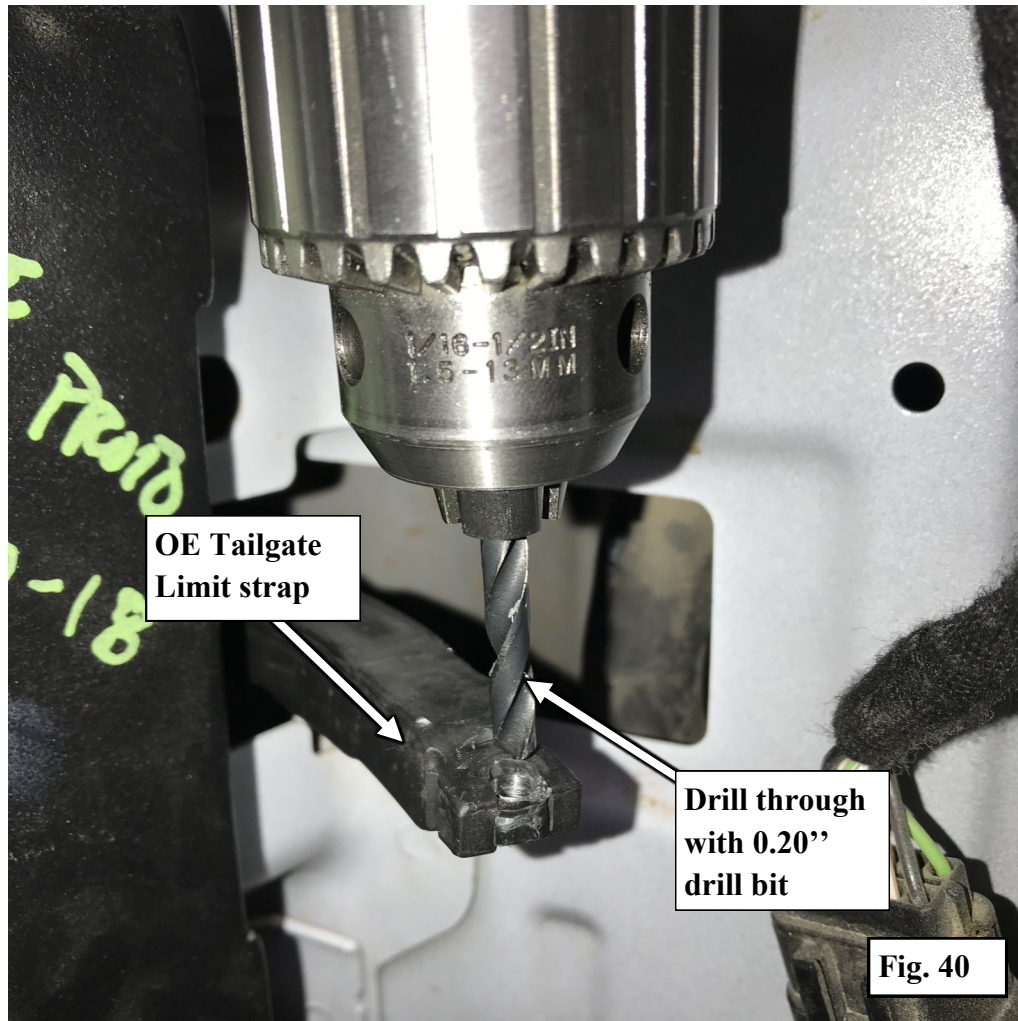

For Technical Support/Warranty Information please call 310-762-9944



Installation Instructions: (Part # SB76410) 2007-2018 Jeep JK Tailgate

Step 41: Install (1) rubber bumper (9541K901) onto the shorter end of the pin (401TU050) with the cone shape towards the flange (Fig. 41).

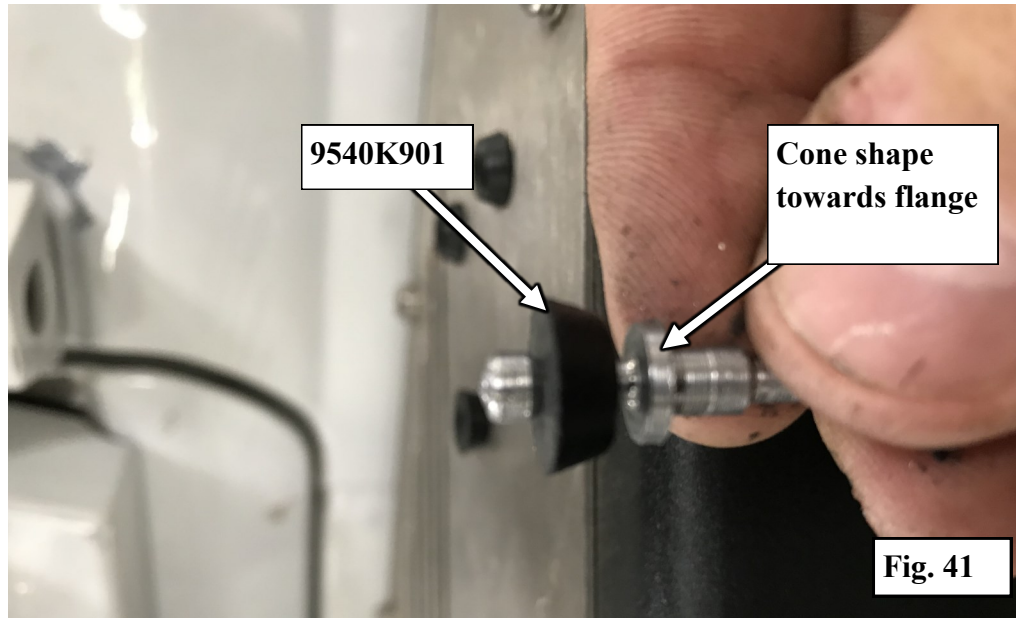

Step 42: Install one more rubber bumper (9541K901) on top with the cone shape pointing outwards (Fig. 42).

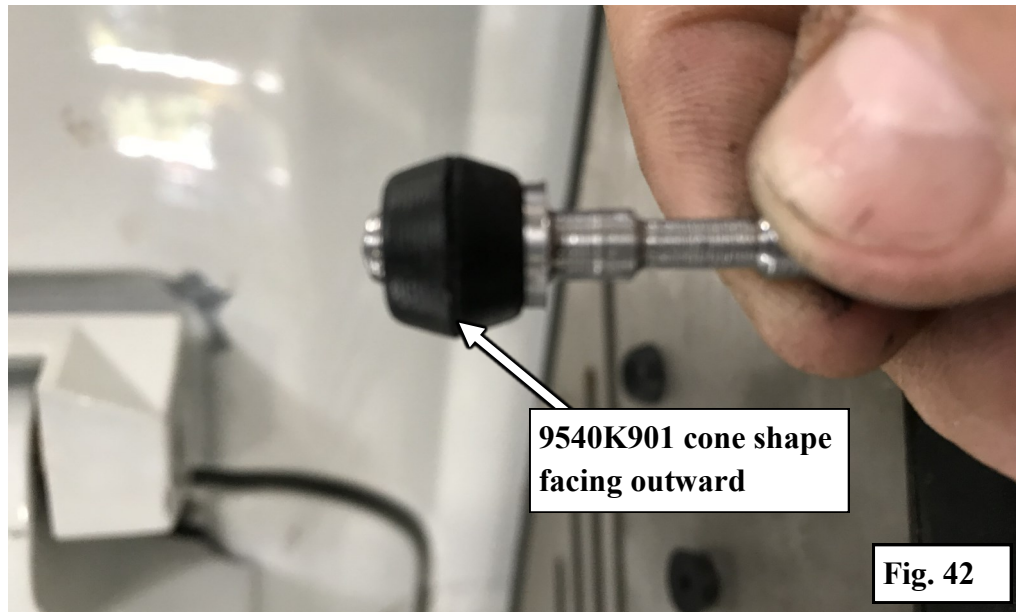

For Technical Support/Warranty Information please call 310-762-9944



Installation Instructions: (Part # SB76410) 2007-2018 Jeep JK Tailgate

Step 43: Install this pin assembly into the hole previously drilled in the OE tailgate strap (Fig. 43).

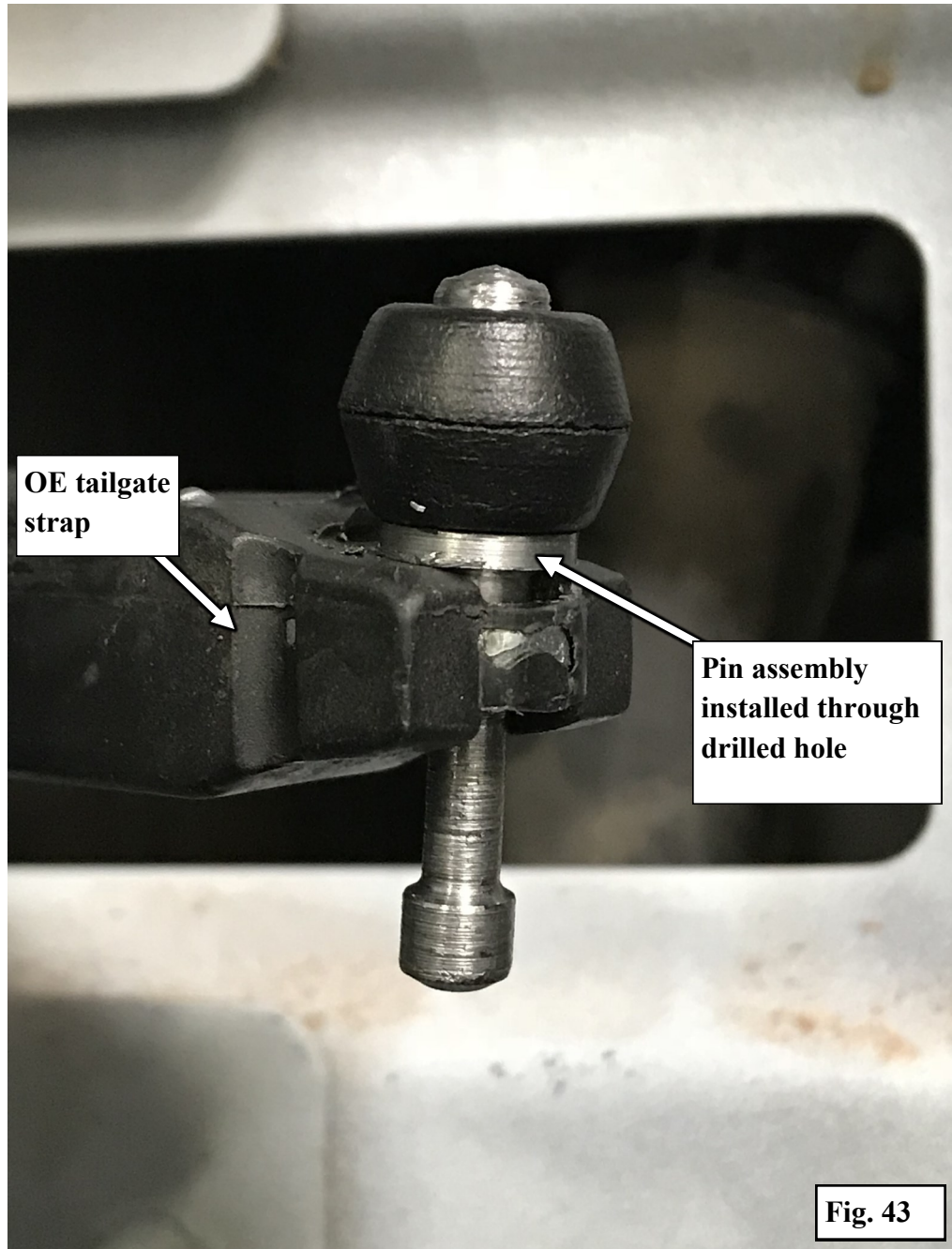

For Technical Support/Warranty Information please call 310-762-9944



Installation Instructions: (Part # SB76410) 2007-2018 Jeep JK Tailgate

Step 44: Install the remaining (2) bumpers (9541K901) onto the bottom portion of the installed pin, in the same fashion as before (Fig. 44).

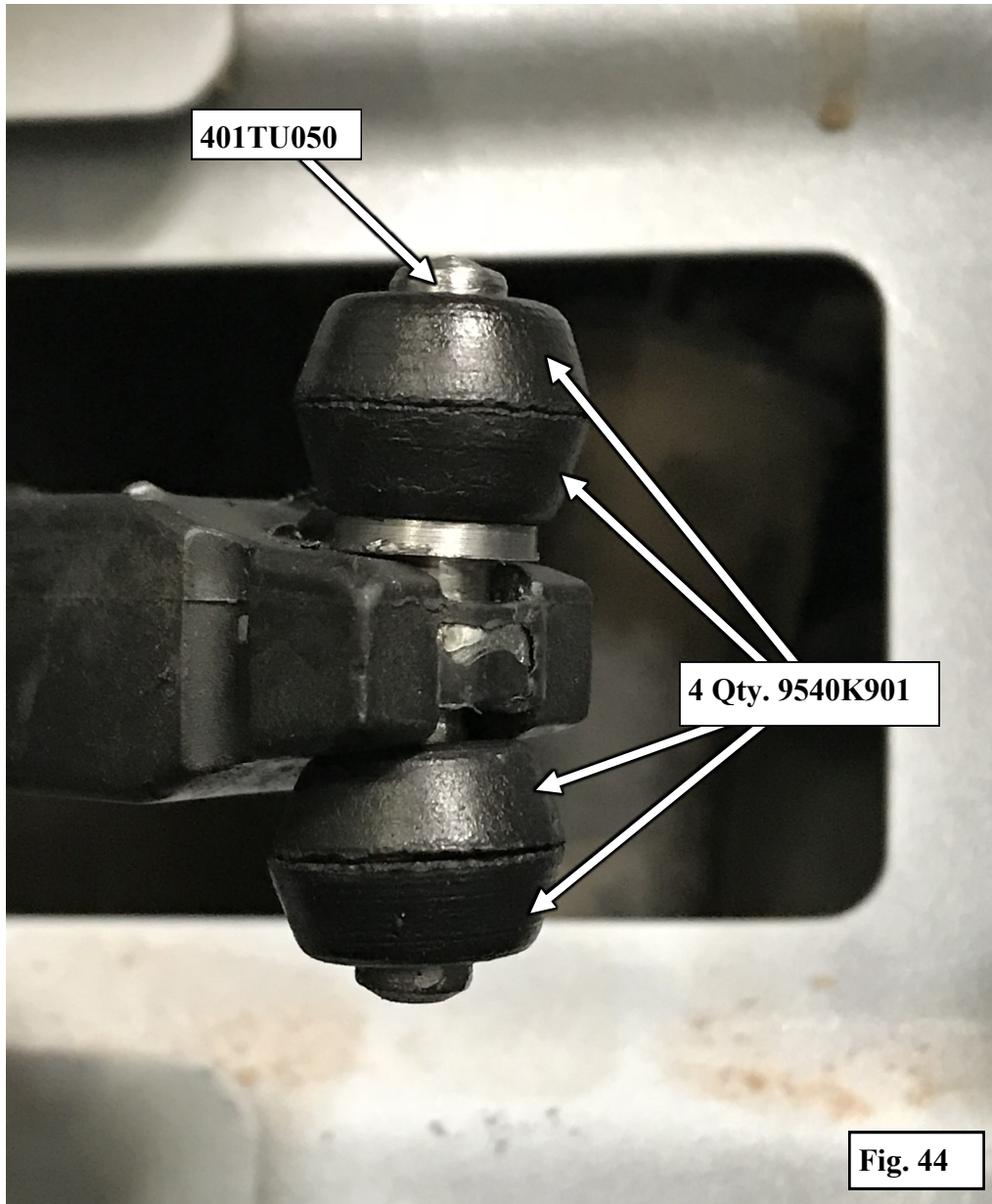

For Technical Support/Warranty Information please call 310-762-9944



Installation Instructions: (Part # SB76410) 2007-2018 Jeep JK Tailgate

Step 45: Fully open and close tailgate to check function. Re-connect and re-install tail light.

Step 46: Carefully install your spare tire on the tailgate using the extended length lug nuts provided (**Fig. 45**). Open and close the tailgate, noting any difficulty in operation. Adjust your tailgate as needed by removing the spare tire, removing the hinge cover and loosening the hinge bolts slightly, move the tailgate slightly up or down. Double check all the hardware and torque to the specs given in these instructions before re-installing the spare tire. When satisfied with operation of the tailgate, tighten the lug nuts to **50 ft-lbs**. Your install is complete.



For Technical Support/Warranty Information please call 310-762-9944



Installation Instructions:

(Part # SB76410)
2007-2018 Jeep JK Tailgate

Use this only as a guide for hardware without a called out torque specification in the instruction manual.

Bolt Torque and ID						
Decimal System			Metric System			
All Torques in Ft. Lbs. Maximums						
Bolt Size	Grade 5	Grade 8	Bolt Size	Class 9.8	Class 10.9	Class 12.9
5/16	15	20	M6	5	9	12
3/8	30	45	M8	18	23	27
7/16	45	60	M10	32	45	50
1/2	65	90	M12	55	75	90
9/16	95	130	M14	85	120	145
5/8	135	175	M16	130	165	210
3/4	185	280	M18	170	240	290

<p>1/2-13x1.75 HHCS</p> <p>Grade 5 Grade 8</p> <p>(No. of Marks + 2)</p> <p>D T L X</p>	<p>M12-1.25x50 HHCS</p> <p>D T L X</p>
<p>G = Grade (Bolt Strength)</p> <p>D = Nominal Diameter (Inches)</p> <p>T = Thread Count (Threads per Inch)</p> <p>L = Length (Inches)</p> <p>X = Description (Hex Head Cap Screw)</p>	<p>P = Property Class (Bolt Strength)</p> <p>D = Nominal Diameter (Millimeters)</p> <p>T = Thread Pitch (Thread Width, mm)</p> <p>L = Length (Millimeters)</p> <p>X = Description (Hex Head Cap Screw)</p>

For Technical Support/Warranty Information please call 310-762-9944



Installation Instructions:

(Part # SB76410)
2007-2018 Jeep JK Tailgate

Product cleaning and maintenance instructions

Stainless Steel Finish – Aluminum polish may be used to polish small scratches and scuffs on the finish. Mild soap, window or glass cleaner may be used to clean the finish. Dual state powder coat finish – Mild soap, window or glass cleaner may be used to clean the finish. In order to protect the finish, you may wax your product on a regular basis with pure carnauba automotive wax. Do not use any types of soap, polish or was that contains abrasive that could damage the finish. Textured coated finishes should be cleaned with a mild soap on a damp sponge. Do not apply polish or was that requires to be removed by means of buffing. This type of wax is commonly used at car wash facilities. Chrome Finish – Mild soap, window or glass cleaner may be used to clean the finish. In order to protect the finish, you should wax your product on a regular basis with pure carnauba automotive wax. Do not use any types of soap, polish or was that contains abrasive that could damage the finish.

Limited Warranties

Smittybilt's products are covered under the following limited warranties only. Note that the duration of the limited warranty differs according to the material and finish of the product purchased. Subject to the duration and conditions of the limited warranty stated below, Smittybilt warrants to the original retail purchaser that its products are free from defects in material and workmanship. All other warranties and representations express or implied, are hereby disclaimed, including fitness for merchantability and buyer's intended use or purpose. All parts are sold "AS IS" except for the limited warranties granted herein. Buyer assumes all risks as to the selection, suitability and performance of all goods and products selected. This limited warranty does not cover damage or impairment in any part due to misuse, improper installation, accident or contact with on-road or off-road hazards, product modification, improper or inadequate cleaning and/or maintenance. Smittybilt is not responsible for items damaged during shipping. This warranty is not transferable from the original buyer. For the original Buyer to be eligible for the limited warranty coverage, the Buyer must provide proof of purchase. Smittybilt strongly recommends returning the warranty registration card.

Customer's remedy hereunder shall be limited only to repair or replacement (at Smittybilt's option) of any defective part(s) returned to Smittybilt at customer's expense. The determination of whether or not a returned part is defective or subject to coverage under the limited warranties stated herein shall be made at Smittybilt's sole discretion.

To assure product quality, Smittybilt reserves the right to change product design, material, specification and finishes without prior notice to customers. This limited warranty gives you specific legal rights and you may also have other rights, which may vary from state to state. Some states do not allow limitations on how long an implied warranty lasts, so the above limitations may not apply as to you. Also, some states do not allow the exclusion or limitation of incidental or consequential damages, so the above limitations or exclusions may not apply to you. Smittybilt reserves the right to discontinue product lines and substitute products or provide other remedies than those listed in this limited warranty for those discontinued products.

Warning

Rollover and other types of vehicle accidents may result in serious injury or death to you, your passengers and others sharing the road. Smittybilt accessories are decorative and are not intended to reduce or avoid injury or damage in the event of an accident. The weight and location of Smittybilt accessories may affect your vehicles' handling, stability and performance, creating an increased risk of accident or rollover. Before installing any accessory, check state laws and assure that the accessory will not obscure any lights or interfere with proper operation on your vehicle's safety equipment. Consult your owner's manual and the Smittybilt instructions, or additional safety information. Smittybilt products, nor the warnings contained herein, are not a substitute for your safe driving. Don't drink and drive, always use seat belts and don't drive faster than conditions permit.

For Technical Support/Warranty Information please call 310-762-9944

Smittybilt, 400 W. Artesia, Compton, CA 90220