



**IF YOU'RE MISSING
HARDWARE OR
COMPONENTS OR IN
NEED OF TECHNICAL
ASSISTANCE CONTACT
SMITTYBILT
DIRECTLY AT
1-800-776-0767**

info@smittybilt.com



Installation Instructions:

SRC Bumper (Part # SB77714)

2018 Jeep JL 4 Door SRC Rear Bumper Kit

XRC Bumper (Part # SB77858)

2018 Jeep JL 4 Door XRC Rear Bumper Kit

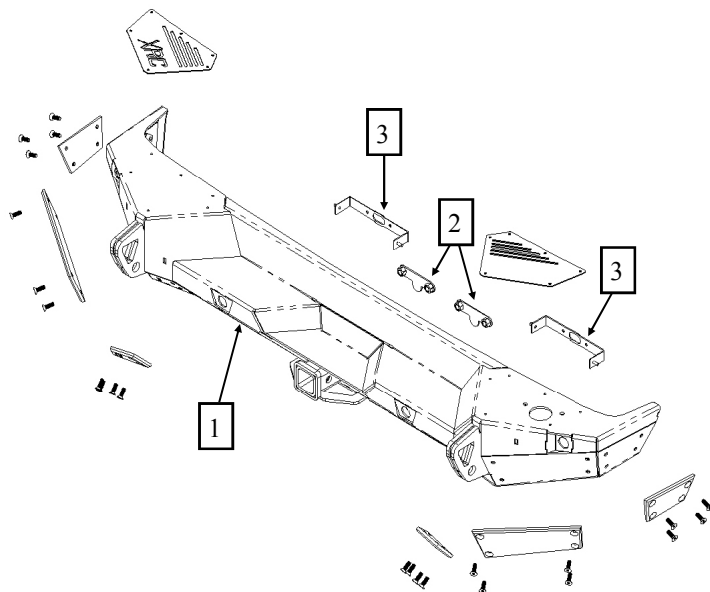
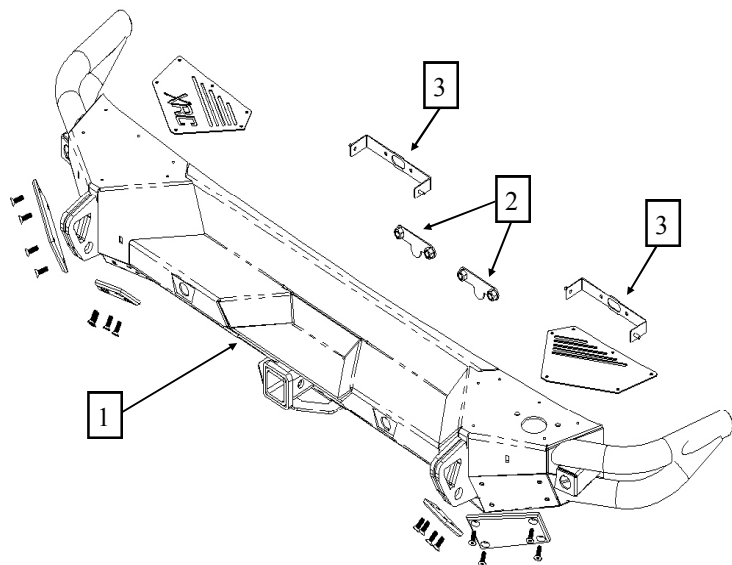

SB77714 PARTS INCLUDED	QTY	BOM I.D.
93-401TU010 REAR SRC BUMPER	1	1
93-315DV002 NUT PLATE	2	2
84-401TU006 LIGHT BRACKET	2	3
90-77858-01 HARDWARE PACK: Cover Plates	1	-
6MM-1.0 12MM S.S BUTTON HEAD BOLT	12	-
90-77858-02 HARDWARE PACK: Crossmember	1	-
12mm X 100mm HEX BOLT Gr. 10.9	4	-
12mm FLAT WASHER Gr. 10.9	4	-
90-77858-03 HARDWARE PACK: Crossmember	1	-
PLASTIC PLUG	4	-
90-77858-04 HARDWARE PACK: Light Mount	1	-
6mm-1.0 BLACK NYLOCK NUT Gr. 10.9	4	-
6mm BLACK FLAT WASHER	4	-
SB7734 LICENSE PLATE RELOCATION BRACKET	1	-
612800-04 LIGHT BAR KIT	1	-
90-RM42550 SPACER	2	-

SB777858 PARTS INCLUDED	QTY	BOM I.D.
93-401TU002 REAR XRC BUMPER	1	1
93-315DV002 NUT PLATE	2	2
84-401TU006 LIGHT BRACKET	2	3
90-77858-01 HARDWARE PACK: Cover Plates	1	-
6MM-1.0 12MM S.S BUTTON HEAD BOLT	12	-
90-77858-02 HARDWARE PACK: Crossmember	1	-
12mm X 100mm HEX BOLT Gr. 10.9	4	-
12mm FLAT WASHER Gr. 10.9	4	-
90-77858-03 HARDWARE PACK: Crossmember	1	-
PLASTIC PLUG	4	-
90-77858-04 HARDWARE PACK: Light Mount	1	-
6mm-1.0 BLACK NYLOCK NUT Gr. 10.9	4	-
6mm BLACK FLAT WASHER	4	-
SB7734 LICENSE PLATE RELOCATION BRACKET	1	-
612800-04 LIGHT BAR KIT	1	-
90-RM42550 SPACER	2	-

For Technical Support/Warranty Information please call 310-762-9944

Smittybilt, 400 W Artesia, Compton, CA 90220



Installation Instructions:

*SRC Bumper (Part # SB77714)
2018 Jeep JL 4 Door SRC Rear Bumper Kit
XRC Bumper (Part # SB77858)
2018 Jeep JL 4 Door XRC Rear Bumper Kit*

NOTE: These instructions were performed on a Rubicon model equipped with metal bumpers, Sport and Sahara models with plastic bumpers may differ slightly. If your Jeep has plastic bumpers with sensors, you will need to purchase OE Rubicon backup sensor sockets and retainers from your local dealership, as they are not removable.

Rubicon OE rear bumper sensor parts needed if you have a plastic bumper with sensor .

6MH85RXFAB 1 68295603AB 1 6MH83RXFAB 1 68295601AB 1 6MH82RXFAB 1
68295600AB 1 6MH84RXFAB 1 68295602AB 1 68289851AA 4

Step 1: Park the vehicle on a flat level surface. Apply the parking brake and chock all 4 wheels.

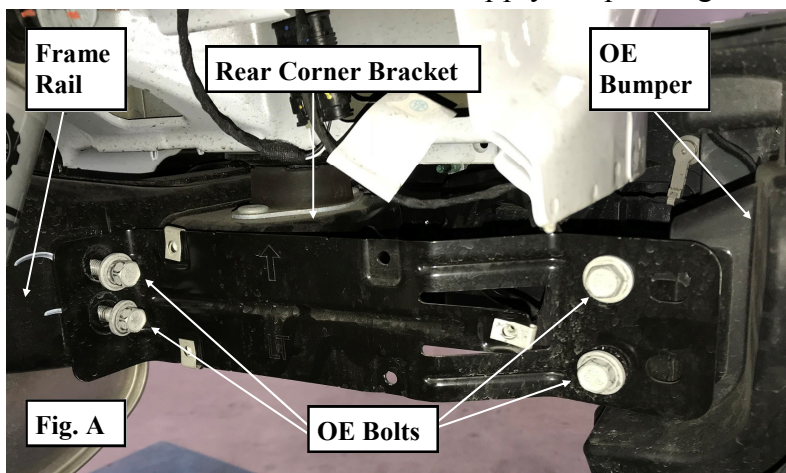

Step 2: Remove the (4 per side) OE bolts securing the driver and passenger side rear corner brackets to the frame rails. (Fig. A)

Step 3: **NOTE:** Configuration will vary per model and options package. Using an 18mm wrench, remove the (4) OE bolts securing the OE rear bumper to the OE frame crossmember. (Fig. B)

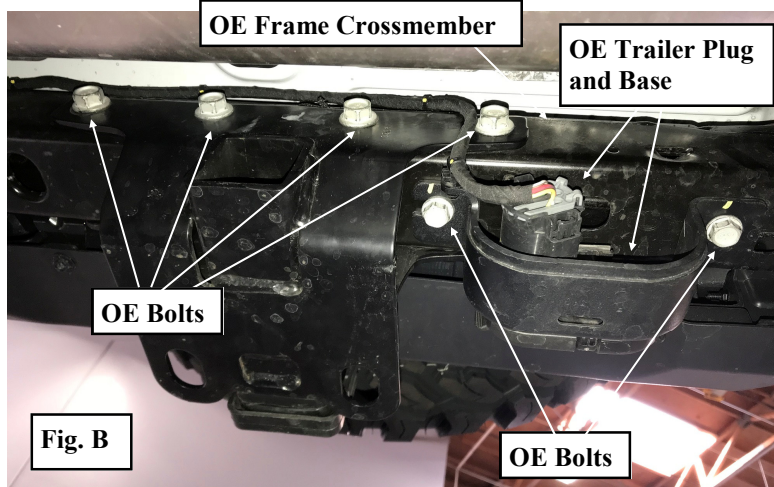

Step 4: If equipped, disconnect the trailer plug and unbolt the base from the frame. (Fig. C)

For Technical Support/Warranty Information please call 310-762-9944



Installation Instructions:

*SRC Bumper (Part # SB77714)
2018 Jeep JL 4 Door SRC Rear Bumper Kit
XRC Bumper (Part # SB77858)
2018 Jeep JL 4 Door XRC Rear Bumper Kit*

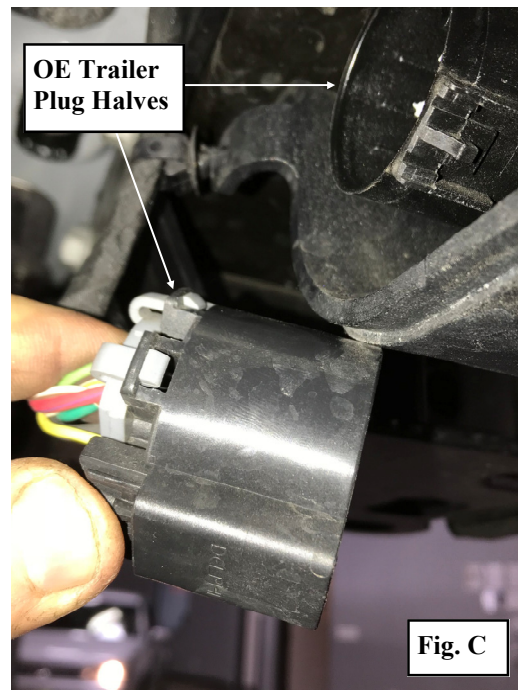

Step 5: On the driver side, remove the (4) OE bolts and remove the tow hook from the frame. On the passenger side, remove the (2) OE bolts securing the OE front bumper to the side of the frame rail. (Fig. D)

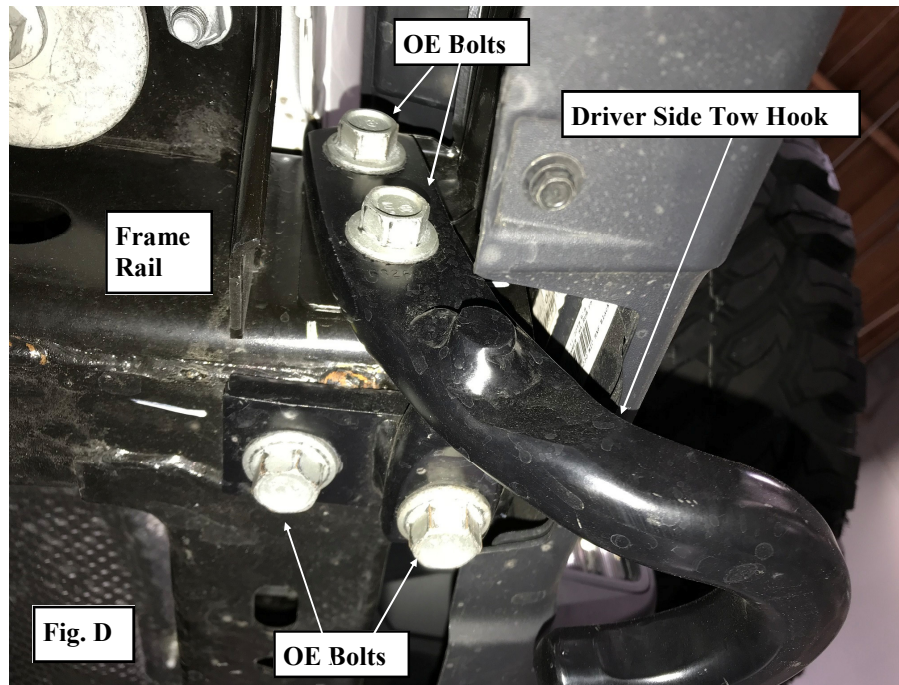

For Technical Support/Warranty Information please call 310-762-9944

Smittybilt, 400 W Artesia, Compton, CA 90220



Installation Instructions:

*SRC Bumper (Part # SB77714)
2018 Jeep JL 4 Door SRC Rear Bumper Kit
XRC Bumper (Part # SB77858)
2018 Jeep JL 4 Door XRC Rear Bumper Kit*

Step 6: Under the driver side rear quarter panel, disconnect the backup sensor wiring harness connectors.

Step 7: Carefully remove the **OE** rear bumper from the vehicle. Save the **OE** hardware for reinstallation.

Step 8: Unplug the **OE** wiring harness from the **OE** backup sensors and remove the **OE** backup sensors by spreading the back of the sockets, where clipped over the sensor tabs, while pushing the sensors out from the front. **(Fig E)**

NOTE: *Be sure the OE backup sensor O-rings are not lost during removal.*

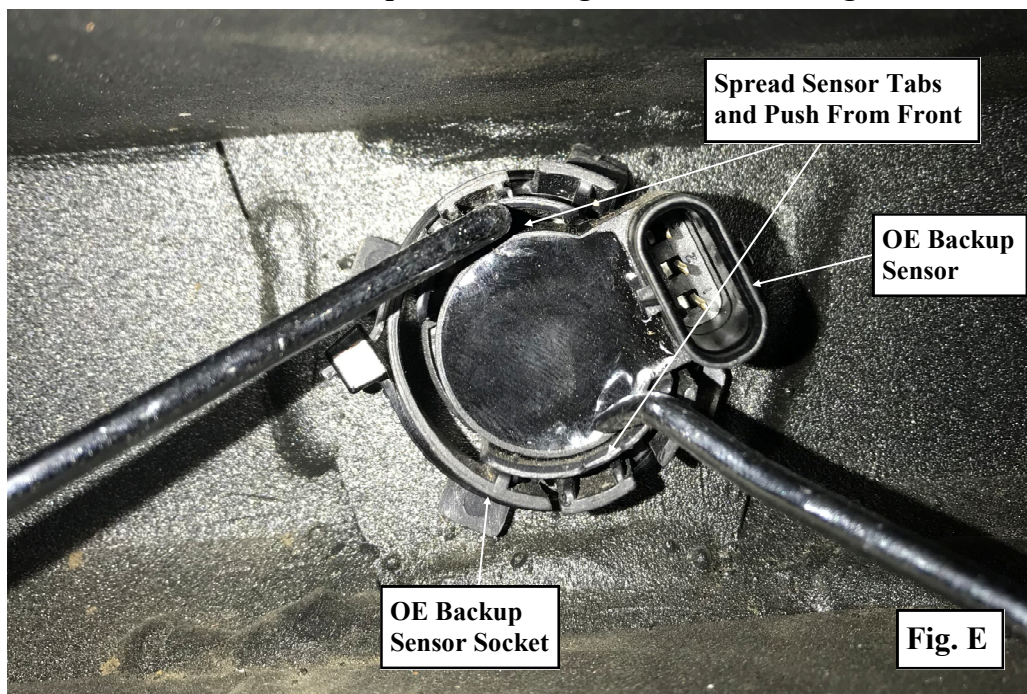

Step 9: Metal Rubicon Bumper Only: Disengage the locking tabs securing the outer retaining ring to the socket. Carefully push the sockets out from the backside and remove from the **OE** rear bumper.

NOTE: *Be sure to note the orientation of the back-up sensor retainers in the OE bumper prior to removal for reinstallation.*

Step 10: Install the **OE** back-up sensor sockets into the mounting holes on the rear bumper (93-401TU010 SRC or 93-401TU002 XRC) according to their original orientation in the **OE** bumper. **(Fig F)**

NOTE: *For vehicles without back-up sensors, install block off plugs into the SRC/XRC bumper instead.*

For Technical Support/Warranty Information please call 310-762-9944

Smittybilt, 400 W Artesia, Compton, CA 90220



Installation Instructions:

*SRC Bumper (Part # SB77714)
2018 Jeep JL 4 Door SRC Rear Bumper Kit
XRC Bumper (Part # SB77858)
2018 Jeep JL 4 Door XRC Rear Bumper Kit*

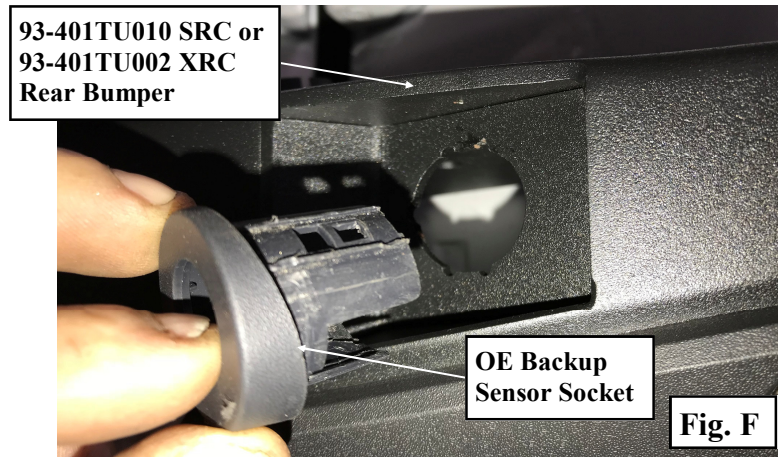

Step 11: Install the previously removed OE back-up sensors into the OE backup sensor sockets, using the OE retainers, according to their original orientation in the OE bumper. (Fig G)

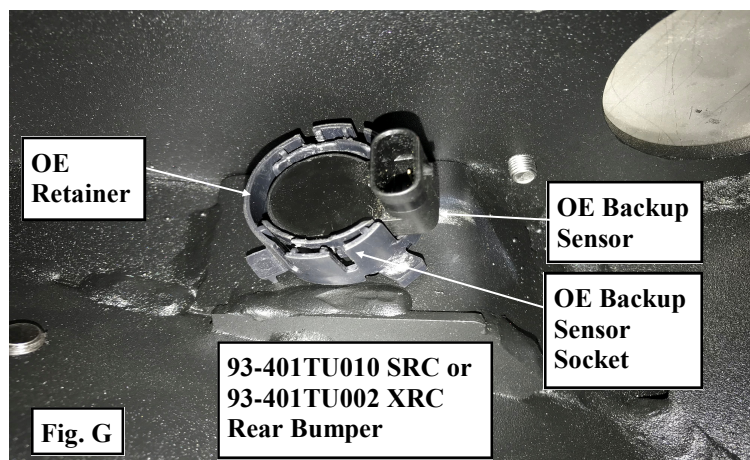

Step 12: Install the (2) 6" LED light bars from lighting kit (612800-4 included with the bumper). Using an open end 10mm wrench (A box end wrench or socket won't have enough bite), remove the (2 Per Light) mounting studs. (Fig H)



For Technical Support/Warranty Information please call 310-762-9944



Installation Instructions:

*SRC Bumper (Part # SB77714)
2018 Jeep JL 4 Door SRC Rear Bumper Kit
XRC Bumper (Part # SB77858)
2018 Jeep JL 4 Door XRC Rear Bumper Kit*

Step 13: Install the adapter brackets (**84-401TU006**) to the **(2) 6"** LED light bars and reinstall the previously removed mounting studs. Torque the mounting studs to 6 ft./lbs. (Fig. I)

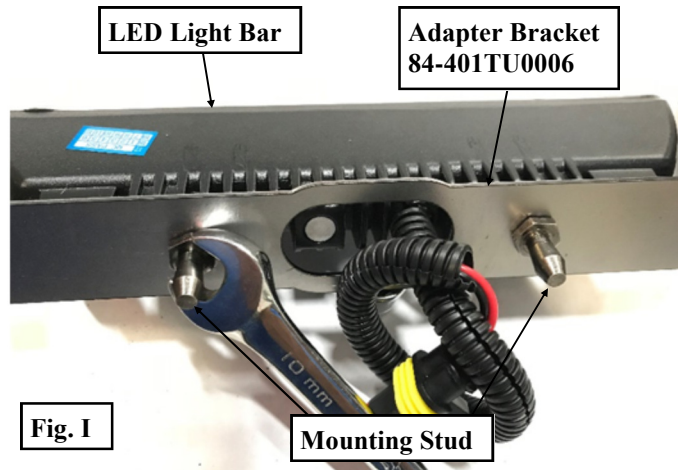

Step 14: Install the **(2) 6"** LED light bars assemblies to the rear bumper (**93-401TU010 SRC or 93-401TU002 XRC**) using the **(2 Per Side)** supplied **6mm** nuts and washers. Be sure the light bar wiring is pointing toward the center of the bumper.

Step 15: *NOTE: This step might require 2 people.* Carefully raise the rear bumper (**93-401TU010 SRC or 93-401TU002 XRC**) against the outer frame rails and align the mounting holes. Secure the rear bumper to the outer frame rails using the previously removed **OE**

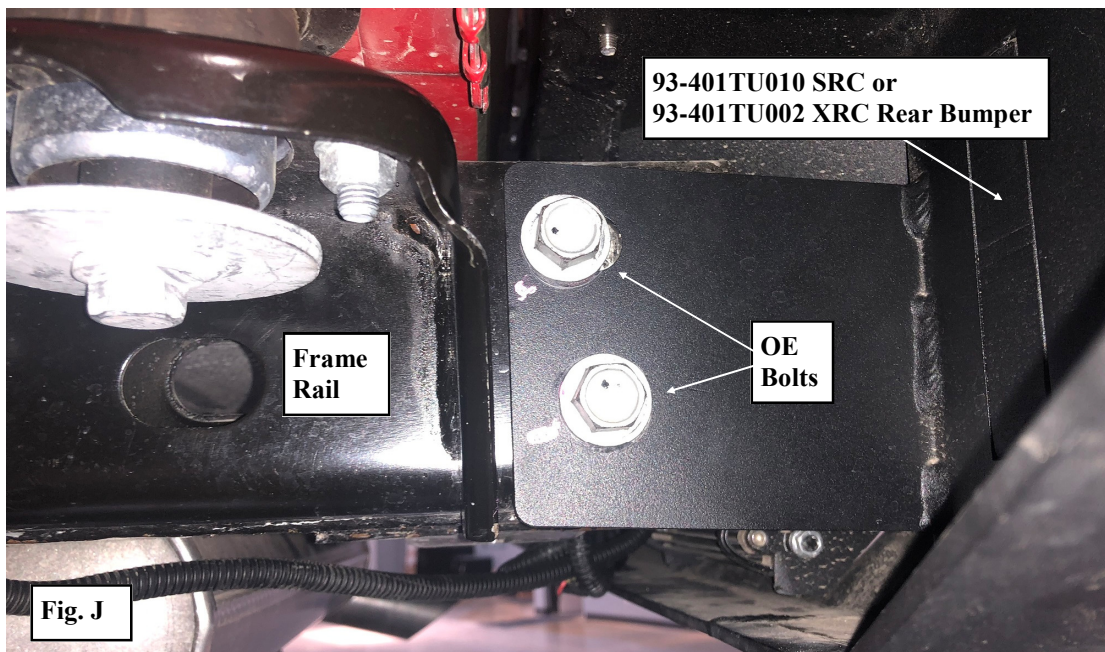

For Technical Support/Warranty Information please call 310-762-9944

Smittybilt, 400 W Artesia, Compton, CA 90220



Installation Instructions:

*SRC Bumper (Part # SB77714)
2018 Jeep JL 4 Door SRC Rear Bumper Kit
XRC Bumper (Part # SB77858)
2018 Jeep JL 4 Door XRC Rear Bumper Kit*

bolts. Leave the bolts loose at this time. (Fig. J)

Step 16: Insert the (2) nut plates (90-315DV002) into the center (2) holes in the rear bumper

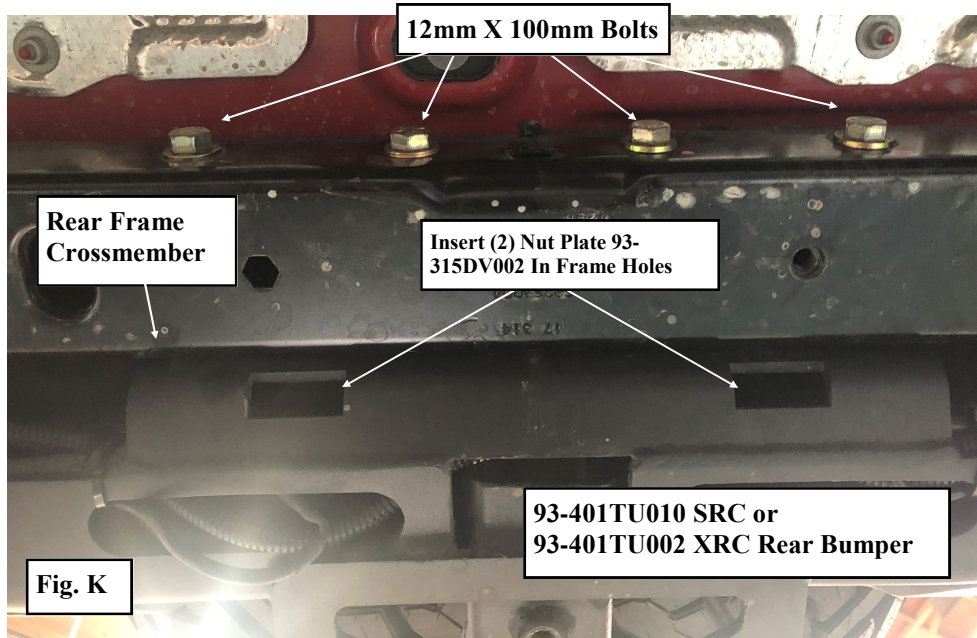

(93-313AR001 SRC or 93-315DV001 XRC). (Fig K)

Step 17: Secure the rear bumper (93-401TU010 SRC or 93-401TU002 XRC) to the rear frame crossmember using the (4) supplied 12mm X 100mm bolts, washers and previously installed (2) nut plates (90-315DV002). Level the rear bumper and torque the 12mm bolts to 80 ft./lbs. (Fig K)

Step 18: Torque all the OE bumper mounting hardware to manufacturer's specifications.

Step 19: If applicable, reinstall the trailer plug base to the frame using the (2) provided 10mm X 45mm bolts and spacers (90-RM42550) and reconnect the trailer plug. Torque

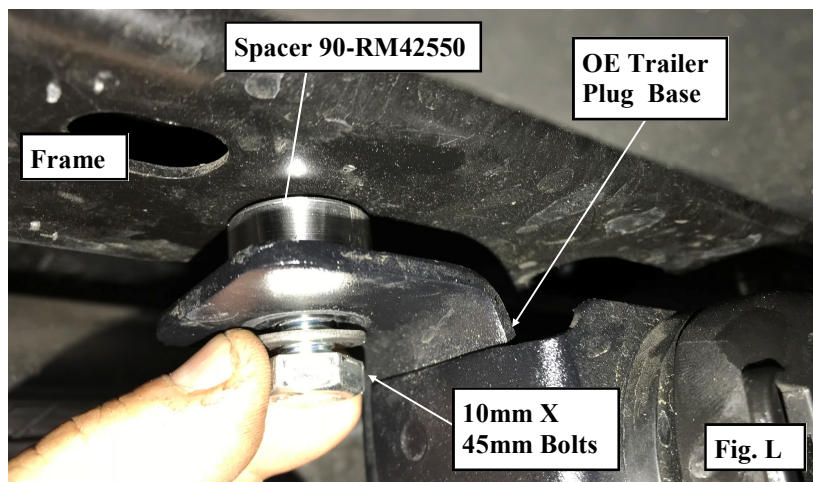

For Technical Support/Warranty Information please call 310-762-9944



Installation Instructions:

*SRC Bumper (Part # SB77714)
2018 Jeep JL 4 Door SRC Rear Bumper Kit
XRC Bumper (Part # SB77858)
2018 Jeep JL 4 Door XRC Rear Bumper Kit*

the 10mm bolts to 40 ft./lbs. (Figs. C and L)

Step 20: If you are planning on wiring the LED lights to a dash switch; use the hardware and instructions provided with the LED light kits. Test, aim & adjust the LED lights at this time.

IMPORTANT!: If planning on wiring LED lights into the OE reverse light circuit; it is recommended this task is performed by qualified automotive electrician.

Step 21: Install license plate relocation bracket (SB7734) according to the instructions included with kit.

Step 22: Recheck all hardware for proper torque at this time. Torque all hardware according to manufacturer's specifications or chart on page 9.

Step 23:
Installation is complete.



Fig. M

SRC Bumper Installation Complete

Installation is complete.
(Fig. M)



Fig. M

XRC Bumper Installation Complete

For Technical Support/Warranty Information please call 310-762-9944



Installation Instructions:

SRC Bumper (Part # SB77714)
2018 Jeep JL 4 Door SRC Rear Bumper Kit
XRC Bumper (Part # SB77858)
2018 Jeep JL 4 Door XRC Rear Bumper Kit

Use this only as a guide for hardware without a called out torque specification in the instruction manual.

Bolt Torque and ID						
Decimal System			Metric System			
All Torques in Ft. Lbs. Maximums						
Bolt Size	Grade 5	Grade 8	Bolt Size	Class 9.8	Class 10.9	Class 12.9
5/16	15	20	M6	5	9	12
3/8	30	45	M8	18	23	27
7/16	45	60	M10	32	45	50
1/2	65	90	M12	55	75	90
9/16	95	130	M14	85	120	145
5/8	135	175	M16	130	165	210
3/4	185	280	M18	170	240	290

1/2-13x1.75 HHCS

D T L X

Grade 5 Grade 8

(No. of Marks + 2)

M12-1.25x50 HHCS

D T L X

P = Property Class (Bolt Strength)

D = Nominal Diameter (Millimeters)

T = Thread Pitch (Thread Width, mm)

L = Length (Millimeters)

X = Description (Hex Head Cap Screw)

Product cleaning and maintenance instructions

Stainless Steel Finish – Aluminum polish may be used to polish small scratches and scuffs on the finish. Mild soap, window or glass cleaner may be used to clean the finish. **Dual state powder coat finish** – Mild soap, window or glass cleaner may be used to clean the finish. In order to protect the finish, you may wax your product on a regular basis with pure carnauba automotive wax. Do not use any types of soap, polish or was that contains abrasive that could damage the finish. **Textured coated finishes** should be cleaned with a mild soap on a damp sponge. Do not apply polish or was that requires to be removed by means of buffing. This type of wax is commonly used at car wash facilities. **Chrome Finish** – Mild soap, window or glass cleaner may be used to clean the finish. In order to protect the finish you should wax your product on a regular basis with pure carnauba automotive wax. Do not use any types of soap, polish or was that contains abrasive that could damage the finish.

For Technical Support/Warranty Information please call 310-762-9944

Smittybilt, 400 W Artesia, Compton, CA 90220



Installation Instructions:

(Part # SB7734)

Jeep JL Tailgate Spare Tire License Plate Bracket

NOTE : Carefully read entire instructions thoroughly before attempting to install this part.

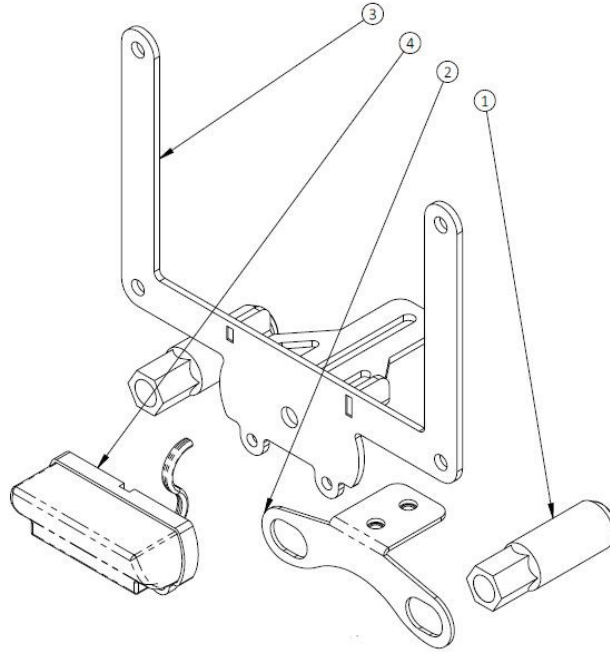

Parts Included	Qty.	ID
31-401TU007 14MM WHEEL LUG	2	1
84-401TU008 LICENSE PLATE BRACKET A	1	2
84-401TU009 LICENSE PLATE BRACKET	1	3
90-TY000556 LICENSE PLATE LIGHT	1	4
90-7734-01 HARDWARE PACK LICENSE PLATE	1	
M6(1.0) X 12MM BHCS GRADE 5 SSTL	4	
M6 FLT WASHER, SSTL	8	
M6 NYLOCK NUT, GRADE 5 SSTL	4	
90-7734-02 HARDWARE PACK MOUNT	1	
M14(1.5) X 16 HEX BOLT, GRADE 5 BLACK ZINC	2	

Parts Included	Qty.	ID
M14 FLT WASHER, BLACK ZINC	2	
BLUE THREAD LOCK	1	
90-7734-03 HARDWARE PACK PLATE LIGHT	1	
M4(0.7) X 14MM FHCS GRADE 5 SSTL	2	
M4 FLT WASHER, SSTL	4	
M4 NYLOCK NUT, GRADE 5 SSTL	2	
90-7734-04 HARDWARE PACK SLIDE	1	
M6(1.0) X 12MM BHCS GRADE 5 SSTL	2	
M6 FLT WASHER, SSTL	2	

Tools Required:

M4 Hex. Allen socket

M2.5 Allen wrench

7mm Socket

10mm Wrench

22mm Socket

19mm Socket after market Lug nut socket

4mm Allen wrench

For Technical Support/Warranty Information please call 310-762-9944

Smittybilt, 400 W. Artesia, Compton, CA 90220



Installation Instructions:

(Part # SB7734)

Jeep JL Tailgate Spare Tire License Plate Bracket

INSTALLATION:

Step 1 : Install **license plate bracket A (84-401TU008)** to **license plate bracket (84-401TU009)** with the (2) **M6(1.0)x12mm BHCS** and washer provided in the hardware pack. Do not tighten. You will need to adjust when installed in car, use **4mm allen wrench (Fig. A)**.

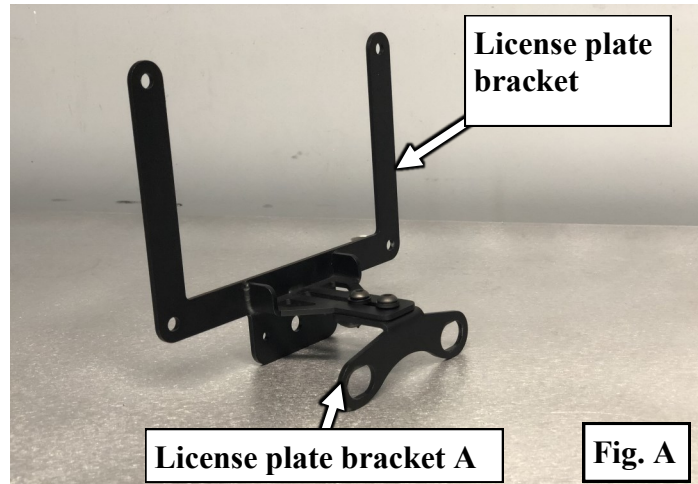

Step 2 : Install **license plate light (90-TY000556)** to **license plate bracket (84-401TU009)** with the (2) **M4(0.7)x14mm FHCS**, (2) **M4 washer**, (2) **M4 nylock nut** provided in the hardware pack. Use **2.5mm allen wrench** and a **7mm socket (Fig. B)**.

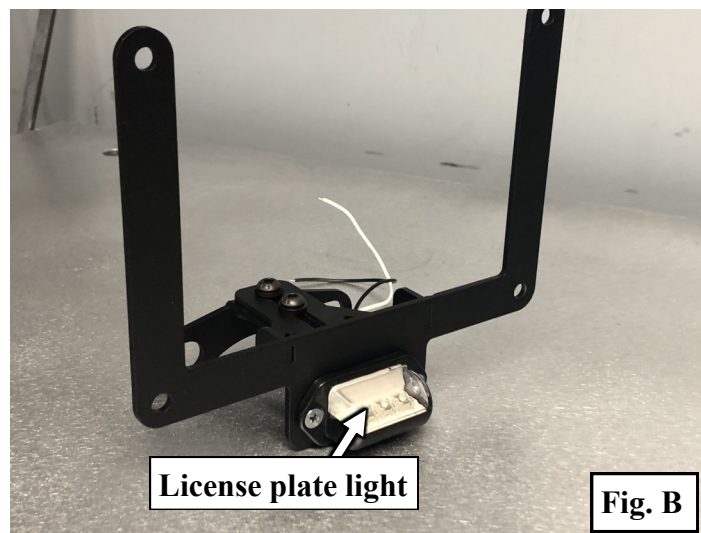

For Technical Support/Warranty Information please call 310-762-9944



Installation Instructions:

(Part # SB7734)

Jeep JL Tailgate Spare Tire License Plate Bracket

Note : Do not over tighten the license plate light screws you may damage the light.

Step 3 : Remove the (2) top lug nuts off from your spare tire. Use 22mm socket to remove lug nuts or your after market lug nut socket (Fig. C).

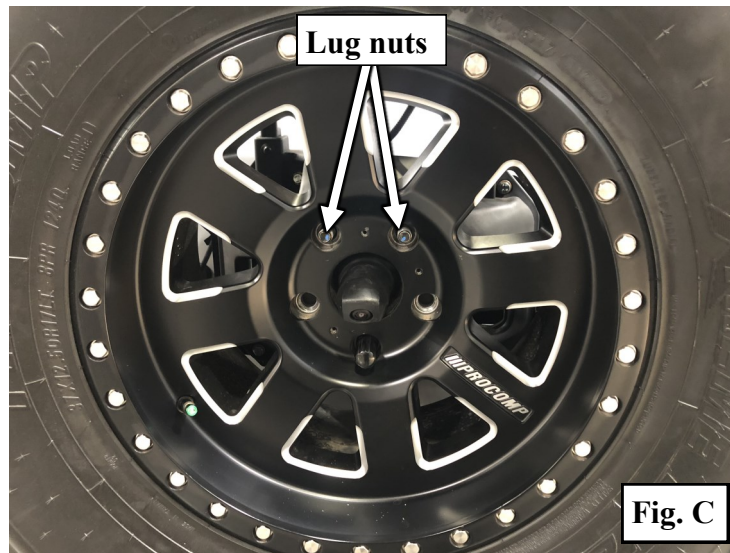

Step 4 : Install the (2) 14mm wheel lugs (31-401TU007) to the (2) top studs with a 19mm socket. Be sure to torque lugs (See chart) (Fig. D).



For Technical Support/Warranty Information please call 310-762-9944

Smittybilt, 400 W. Artesia, Compton, CA 90220



Installation Instructions:

(Part # SB7734)

Jeep JL Tailgate Spare Tire License Plate Bracket

Step 5 : Install the **license plate bracket** to the top **14mm wheel lugs (2)** with the **(2) 14mm(1.5)x20 hex bolts** and **(2) Flt washers** use a **22mm socket (Fig. E)**.

IMPORTANT!: *Be sure to wire the license plate light at this time. Depending on application your routing may vary; it is recommended this task is performed by qualified automotive electrician.*

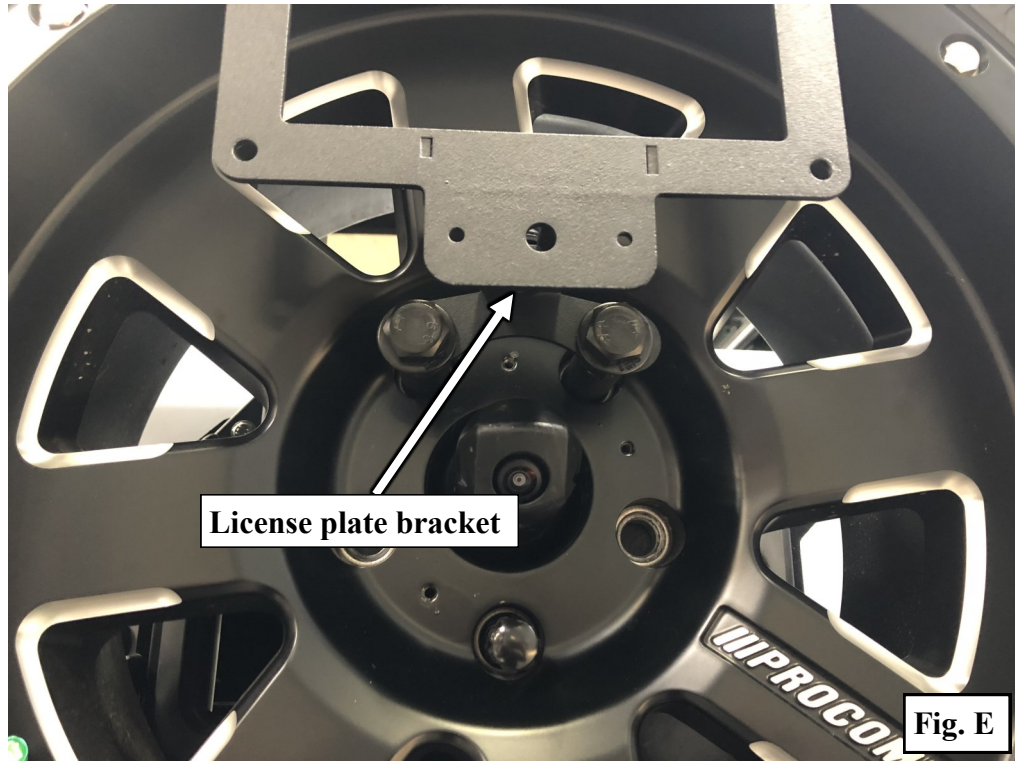

Step 6 : Install your **license plate** in the **license plate bracket** with the **(4) M6(1.0)x12mm BHCS**, **(8) M6 Flt washers**, **(4) M6 nylock nuts**. Use **4mm Allen wrench** and **10mm wrench**.

Step 7 : Installation is now complete.

For Technical Support/Warranty Information please call 310-762-9944

Smittybilt, 400 W. Artesia, Compton, CA 90220



Installation Instructions:

(Part # SB7734)

*Jeep JL Tailgate Spare Tire
License Plate Bracket*

Use this only as a guide for hardware without a called out torque specification in the instruction manual.

Bolt Torque and ID						
Decimal System			Metric System			
All Torques in Ft. Lbs. Maximums						
Bolt Size	Grade 5	Grade 8	Bolt Size	Class 9.8	Class 10.9	Class 12.9
5/16	15	20	M6	5	9	12
3/8	30	45	M8	18	23	27
7/16	45	60	M10	32	45	50
1/2	65	90	M12	55	75	90
9/16	95	130	M14	85	120	145
5/8	135	175	M16	130	165	210
3/4	185	280	M18	170	240	290

1/2-13x1.75 HHCS

D

T

L

X

Grade 5 Grade 8

(No. of Marks + 2)

M12-1.25x50 HHCS

D

T

L

X

P = Property Class (Bolt Strength)

D = Nominal Diameter (Millimeters)

T = Thread Pitch (Thread Width, mm)

L = Length (Millimeters)

X = Description (Hex Head Cap Screw)

For Technical Support/Warranty Information please call 310-762-9944

Smittybilt, 400 W. Artesia, Compton, CA 90220



Installation Instructions:

*SRC Bumper (Part # SB77714)
2018 Jeep JL 4 Door SRC Rear Bumper Kit
XRC Bumper (Part # SB77858)
2018 Jeep JL 4 Door XRC Rear Bumper Kit*

Limited Warranties

Smittybilt's products are covered under the following limited warranties only. Note that the duration of the limited warranty differs according to the material and finish of the product purchased. Subject to the duration and conditions of the limited warranty stated below, Smittybilt warrants to the original retail purchaser that its products are free from defects in material and workmanship. All other warranties and representations express or implied, are hereby disclaimed, including fitness for merchantability and buyer's intended use or purpose. All parts are sold "AS IS" except for the limited warranties granted herein. Buyer assumes all risks as to the selection, suitability and performance of all goods and products selected. This limited warranty does not cover damage or impairment in any part due to misuse, improper installation, accident or contact with on-road or off-road hazards, product modification, improper or inadequate cleaning and/or maintenance. Smittybilt is not responsible for items damaged during shipping. This warranty is not transferable from the original buyer. For the original Buyer to be eligible for the limited warranty coverage, the Buyer must provide proof of purchase. Smittybilt strongly recommends returning the warranty registration card.

Customer's remedy hereunder shall be limited only to repair or replacement (at Smittybilt's option) of any defective part(s) returned to Smittybilt at customer's expense. The determination of whether or not a returned part is defective or subject to coverage under the limited warranties stated herein shall be made at Smittybilt's sole discretion.

To assure product quality, Smittybilt reserves the right to change product design, material, specification and finishes without prior notice to customers. This limited warranty gives you specific legal rights and you may also have other rights, which may vary from state to state. Some states do not allow limitations on how long an implied warranty lasts, so the above limitations may not apply as to you. Also, some states do not allow the exclusion or limitation of incidental or consequential damages, so the above limitations or exclusions may not apply to you. Smittybilt reserves the right to discontinue product lines and substitute products, or provide other remedies than those listed in this limited warranty for those discontinued products.

Warning

Rollover and other types of vehicle accidents may result in serious injury or death to you, your passengers and others sharing the road. Smittybilt accessories are decorative and are not intended to reduce or avoid injury or damage in the event of an accident. The weight and location of Smittybilt accessories may affect your vehicles' handling, stability and performance, creating an increased risk of accident or rollover. Before installing any accessory, check state laws and assure that the accessory will not obscure any lights or interfere with proper operation on your vehicle's safety equipment. Consult your owner's manual and the Smittybilt instructions, or additional safety information. Smittybilt products, nor the warnings contained herein, are not a substitute for your safe driving. Don't drink and drive, always use seat belts and don't drive faster than conditions permit.

For Technical Support/Warranty Information please call 310-762-9944

Smittybilt, 400 W Artesia, Compton, CA 90220



NOTE: Please take time to fill in the information requested below. It is highly recommended to keep this with the instructions and warranty information in a safe location. This will help with any warranty or customer service issues if they should arise. Please write down the DOP# that is located on the outside of the box and or on part or hardware box. (Pictured Below)



Part Number: _____
Date of Purchase: _____
Where did you purchase this product? _____
Store or catalog name: _____
Store Location: _____
Invoice # _____
DOP# _____
Who installed or will install your Smittybilt product? _____

For Technical Support/Warranty Information please call 310-762-9944

Smittybilt, 400 West Artesia Blvd, Compton, CA 90220